



The Challenge

- 1) Download the **what3words** app.
- 2) Use this flyer to record information.
- 3) Hike the Ausable River Valley and Mystery Falls Trails.
- 4) Find and stop at each of the eight (8) map signs along the Ausable River Valley and Mystery Falls Trails.
- 5) While standing in front of the numbered post for the map sign, use the **what3words** app to determine the unique three-word combination for the spot. Record in the space provided.

You do NOT need to complete the challenge in a single hike. You may wish to hike the trail in sections in order to visit the eight (8) map signs.

The Trails (see map)

Ausable River Valley - Difficult to Extremely Difficult – 6.8 km one-way – white blazes

Mystery Falls - Moderate – 3.3 km loop – white and blue blazes

This trail network is **RUGGED** and **DIFFICULT**, with numerous ascents and descents, and narrow passage in many spots. Slopes can be muddy and slippery, especially in spring and fall. Proper footwear is a must! Minors should be accompanied by a responsible adult.

STAY ON MARKED TRAILS. Trespassing will not be tolerated.

Access

- from the west end of MacDonald Drive in North Middlesex (for Ausable River Valley Trail from the north)

MacDonald Drive: <https://w3w.co/headphone.sushi.veterinary>

- from the west end of Elm Tree Drive in North Middlesex (for Mystery Falls or Ausable River Valley Trail from the south)

Elm Tree Drive: <https://w3w.co/annotated.tunes.lamest>

Use the parking lots. Be advised that MacDonald Drive and Elm Tree Drive are **NOT MAINTAINED** in the **winter**.

How to Claim Your Patch

Once you have collected the **what3words** for all eight (8) map signs, you can claim your FREE patch. Mail your flyer, along with a self-addressed, stamped envelope to:

LSNT **what3words**
C/O Mary Lou Tasko
10158 Meadowlily Crescent
Grand Bend, Ontario
N0M 1T0

One (1) patch per person, while quantities last.

Be sure to record all three words in the correct order.

Post #1 _____

Post #2 _____

Post #3 _____

Post #4 _____

Post #5 _____

Post #6 _____

Post #7 _____

Post #8 _____

Emergency access

- Foot bridge
- Turning point
- Ladder
- Parking
- Trailhead
- Waterfall

ABCA property boundary

- Watercourse
- Contour interval 5 m

Trail - distance to junctions in metres

- Trail - white blaze
- Trail - blue blaze
- Emergency access only - blue blaze
- Road

- Access point:**
1. 415 MacDonalld Drive, Parkhill, North Middlesex
 2. 176 Elm Tree Drive, Parkhill, North Middlesex
- Emergency Access:**
3. North End of Broken Front Road, North Middlesex
43.109746 N 81.795334 W

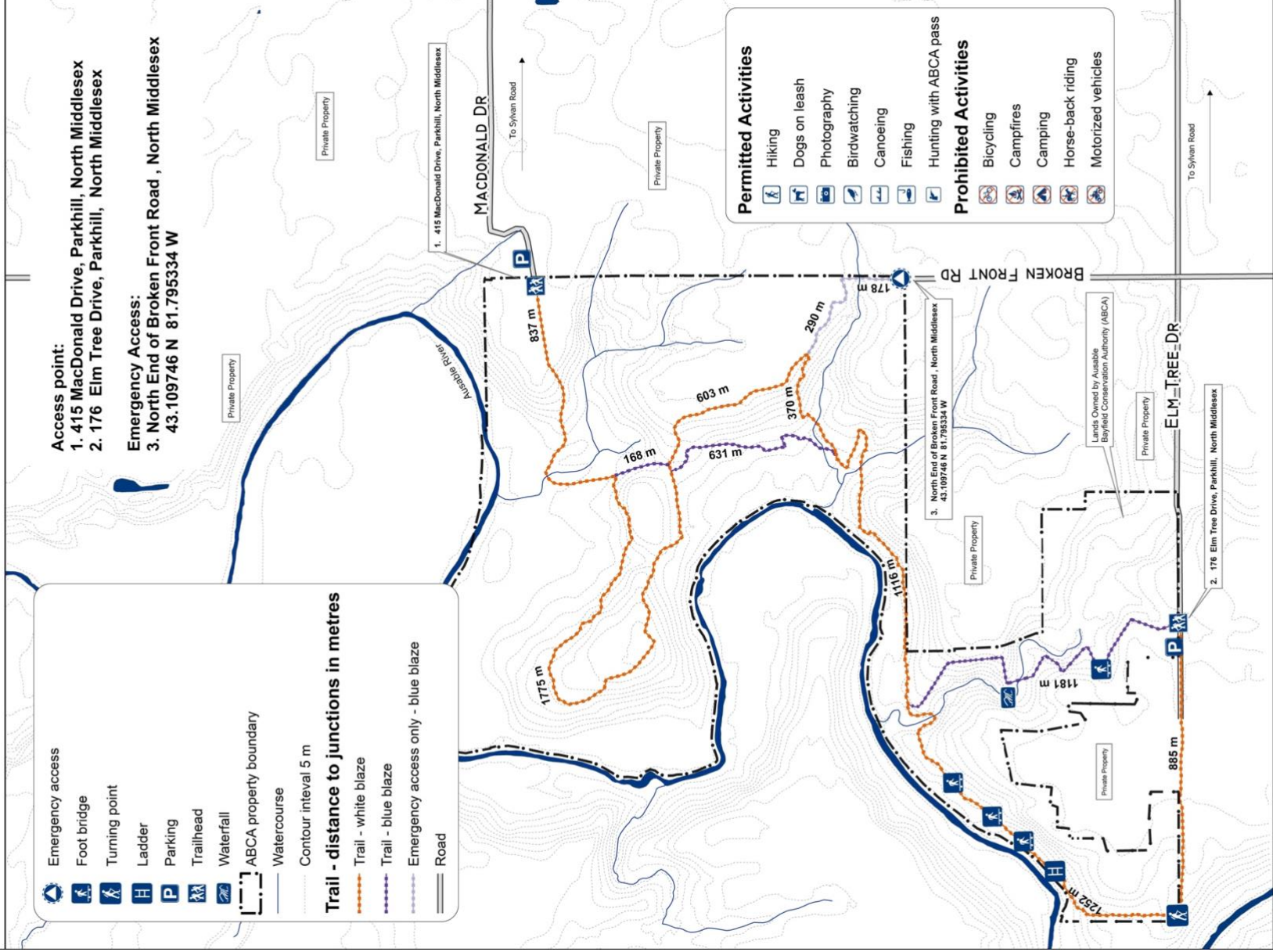

Permitted Activities	Prohibited Activities
<ul style="list-style-type: none"> Hiking Dogs on leash Photography Birdwatching Canoeing Fishing Hunting with ABCA pass 	<ul style="list-style-type: none"> Bicycling Campfires Camping Horse-back riding Motorized vehicles



This is a Recreational Trail - Use at your own Risk
Property is open to the public from sunrise to sunset.