

Parcel ID: 21236
Address: 326 BROAD ST
Owner: WRIGHT MYRTLE W HEIRS
Mail-To: WRIGHT KIRBY
 2601 N MAIN ST
 DANVILLE, VA 24540



Value Information	
Land / Use:	\$2,000
Improvement:	\$89,700
Total:	\$91,700.00

Building Information	
Year Built:	1972
Total Rooms:	0
Bedrooms:	0
Full Bathrooms:	0
Half Bathrooms:	0
Finished Square Feet:	2,460

Additional Information			
State Code:	3131 MultiFam 4+units 1 Bldg	Approx Acres:	0
Land Use:	Residential	Legal Description:	52.15 FT W PT NO 172 BROAD ST
Tax Map:	1715-006-000012.000	Zone:	OTR Old Town Residential
Notes: Apartments: 4 units, 1 br & 1 bath each. Avg Lot: 50.0 X 95.0 WB 13-215: Myrtle died 4/19/13 & 14 lists. WB 09-174: Robert Sr. died 6/18/09 & 12 lists. (Map 68-2-21)			

Building

Building Information - 1			
Property Class:	Commercial	Finished Square Feet:	2,460
Style:	No Data	Basement Square Feet:	0
Year Built:	1972	Total Rooms:	0
Condition:	No Data	<i>* Bathrooms are not included in total room count.</i>	
Story Height:	No Data		
Bedrooms:	0		
Dining Rooms:	0		
Family Rooms:	0		
Living Rooms:	0		
Full Bath:	0		
Half Bath:	0		
Features:		Size:	
Concrete Block		80 %	
Forced Air Unit		100 %	
No HVAC		100 %	
Brick with Block Back-up		20 %	

Improvements

There are no improvements.

Land

Land Code:	CAL10 Com Apt Land 1000	Rate:	\$1,000
Acres:	4	Adj. Rate:	\$1,000
Sq. Ft.:	0	Base Value:	\$4,000
Front:	<i>No Data</i>	Adj. Amount:	-\$2,000
Effective Front:	0	Value:	\$2,000
Depth:	0		

Transfers

Deed	Page	Sale Price	Sale Date	Previous Owner	Owner
W 13	215	\$0	7/18/2013	WRIGHT MYRTLE W	WRIGHT MYRTLE W HEIRS
W 09	174	\$0	6/29/2009	WRIGHT ROBERT C	WRIGHT MYRTLE W
D 501	318	\$0	12/15/1971	<i>No Data</i>	<i>No Data</i>

Assessments

Year	Land	Use	Improvements	Total
2018	\$2,000	\$0	\$89,700	\$91,700
2017	\$2,000	\$0	\$78,500	\$80,500
2016	\$2,000	\$0	\$78,500	\$80,500
2015	\$2,000	\$0	\$79,300	\$81,300
2014	\$2,000	\$0	\$79,300	\$81,300
2013	\$2,000	\$0	\$79,400	\$81,400
2012	\$2,000	\$0	\$79,400	\$81,400
2011	\$2,000	\$0	\$79,800	\$81,800
2010	\$2,000	\$0	\$79,800	\$81,800
2009	\$2,000	\$0	\$83,600	\$85,600
2008	\$2,000	\$0	\$83,600	\$85,600
2007	\$2,000	\$0	\$79,600	\$81,600
2006	\$2,000	\$0	\$79,600	\$81,600
2005	\$2,000	\$0	\$66,600	\$68,600
2004	\$2,000	\$0	\$66,600	\$68,600
2003	\$2,000	\$0	\$63,900	\$65,900
2002	\$2,000	\$0	\$63,900	\$65,900
2001	\$2,000	\$0	\$63,200	\$65,200
2000	\$2,000	\$0	\$50,000	\$52,000

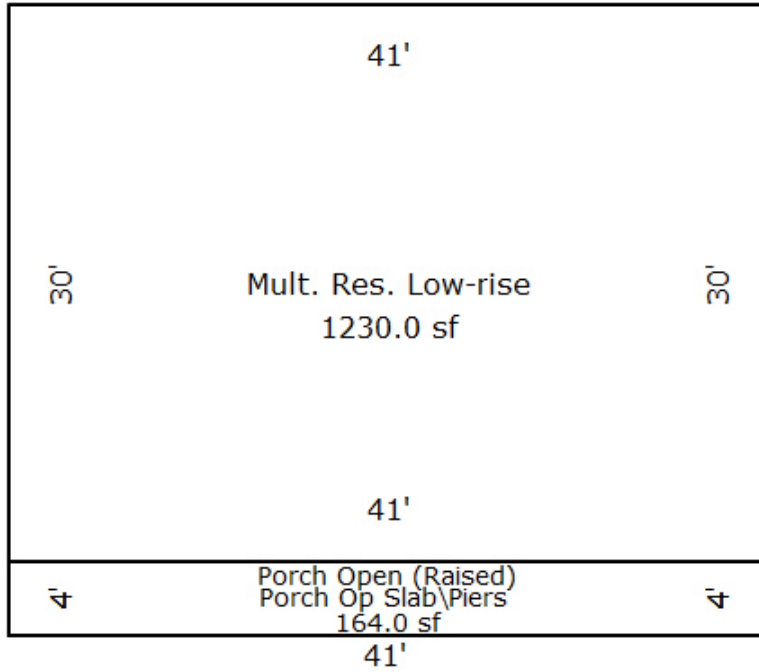

Sketch by Apex Medina™

Parcel ID: 21236



- Buildings
- Parcels
- Street Names
- House Numbers
- Parcel Numbers

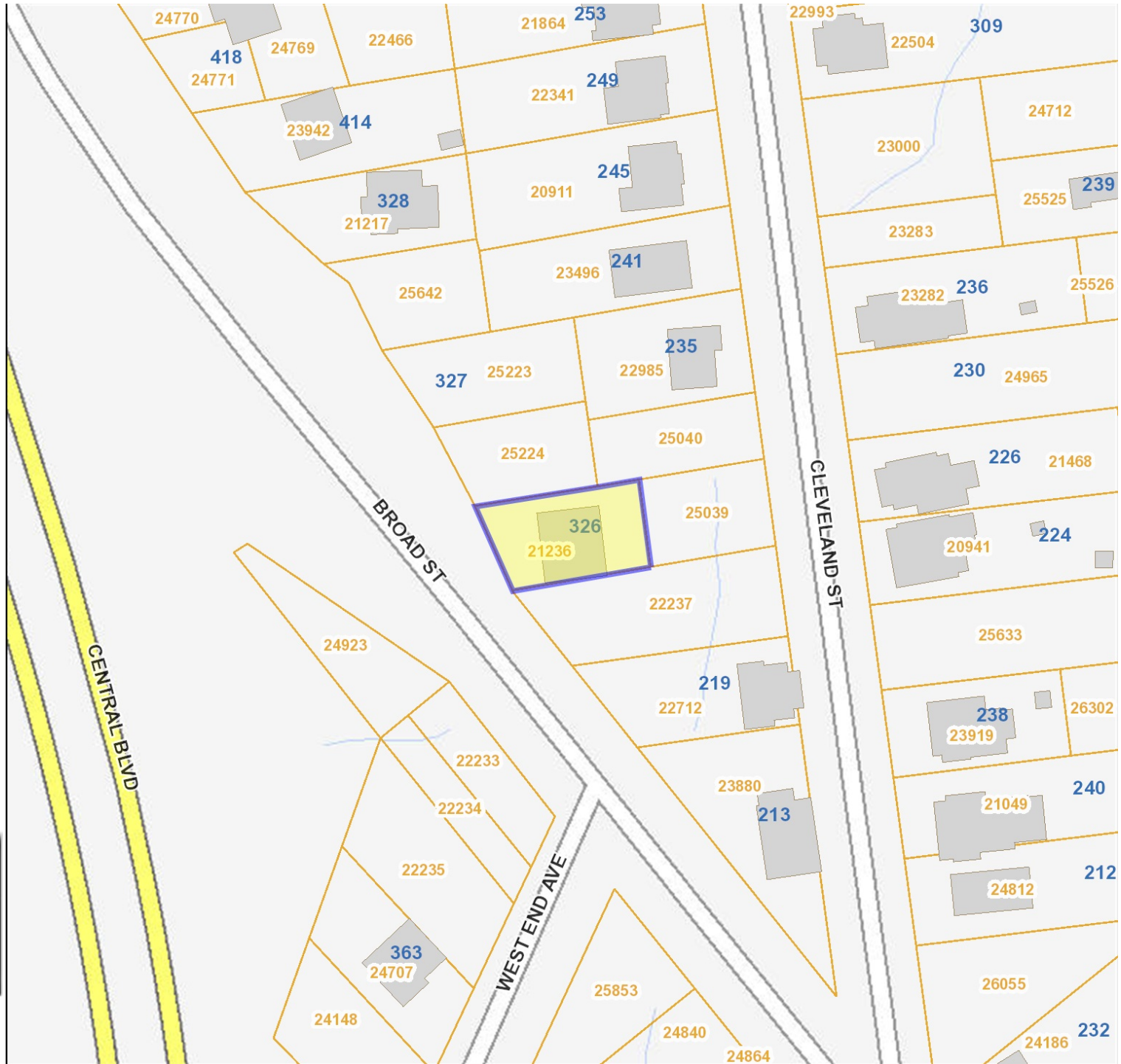

Information contained on this map is to be used for reference purposes only. The City of Danville is not responsible for any inaccuracies herein contained. The City of Danville makes no representation of warranty as to this map's accuracy, and in particular, its accuracy in labeling, dimensions, contours, property boundaries, or placement or location of any map features. No responsibility is assumed for damages or other liabilities due to the accuracy, availability, use or misuse of the information herein provided.

Date: 3/13/2019