

Parcel ID: 55273
Address: 18 SELMA AVE
Owner: WRIGHT MYRTLE W HEIRS
Mail-To: WRIGHT KIRBY
 2601 N MAIN ST
 DANVILLE, VA 24540



Value Information	
Land / Use:	\$4,800
Improvement:	\$15,400
Total:	\$20,200.00

Building Information	
Year Built:	1906
Total Rooms:	1
Bedrooms:	0
Full Bathrooms:	1
Half Bathrooms:	0
Finished Square Feet:	2,064

Additional Information			
State Code:	1101 Single Fam Res-1 Dwlng	Approx Acres:	0.2
Land Use:	Residential	Legal Description:	70 FT NO 21 SEC W SELMA AVE
Tax Map:	1605-009-000010.000	Zone:	OTR Old Town Residential
Notes: Met bldg 10x10-NCV & 10% econ due to size.Avg Lot: 70.0 X 125.0WB 13-215: Myrtle died 4/19/13 & 14 lists.WB 09-174: Robert Sr. died 6/18/09 & 12 lists.DB 09-1001: 5 lists. (Map 42-5-21)			

Building

Building Information - 1			
Property Class:	Residential	Finished Square Feet:	2,064
Style:	No Data	Basement Square Feet:	0
Year Built:	1906	Total Rooms:	1
Condition:	No Data	<i>* Bathrooms are not included in total room count.</i>	
Story Height:	1 1/2 Story Finished		
Bedrooms:	0		
Dining Rooms:	0		
Family Rooms:	0		
Living Rooms:	0		
Full Bath:	1		
Half Bath:	0		
Features:		Size:	
Frame, Cement Fiber		100 %	
Raised Slab Porch with Roof		144 SF	
Foundation - Cinder Block		0	
Forced Air Furnace		100 %	
Metal, Formed Seams		100 %	

Improvements

There are no improvements.

Land

Land Code:	R10 Res FF (75)	Rate:	\$75
Acres:	0.2	Adj. Rate:	\$69
Sq. Ft.:	8,750	Base Value:	\$4,830
Front:	70	Adj. Amount:	-\$30
Effective Front:	70	Value:	\$4,800
Depth:	125		

Transfers

Deed	Page	Sale Price	Sale Date	Previous Owner	Owner
W 13	215	\$0	7/18/2013	WRIGHT MYRTLE W	WRIGHT MYRTLE W HEIRS
W 09	174	\$0	6/29/2009	WRIGHT ROBERT C	WRIGHT MYRTLE W
D 09	1001	\$0	3/24/2009	NEGRIL INCORPORATED	WRIGHT ROBERT C
D 06	2670	\$47,000	6/8/2006	HORSLEY JR DENNY LEE	NEGRIL INCORPORATED
D 96	392	\$42,000	1/30/1996	<i>No Data</i>	HORSLEY DENNY LEE JR & TUJO LORI M

Assessments

Year	Land	Use	Improvements	Total
2018	\$4,800	\$0	\$15,400	\$20,200
2017	\$4,800	\$0	\$29,000	\$33,800
2016	\$4,800	\$0	\$29,000	\$33,800
2015	\$4,800	\$0	\$32,700	\$37,500
2014	\$4,800	\$0	\$32,700	\$37,500
2013	\$4,800	\$0	\$35,300	\$40,100
2012	\$4,800	\$0	\$35,300	\$40,100
2011	\$4,800	\$0	\$38,100	\$42,900
2010	\$4,800	\$0	\$38,100	\$42,900
2009	\$4,800	\$0	\$43,100	\$47,900
2008	\$4,800	\$0	\$43,100	\$47,900
2007	\$4,800	\$0	\$41,400	\$46,200
2006	\$4,800	\$0	\$41,400	\$46,200
2005	\$4,800	\$0	\$40,400	\$45,200
2004	\$4,800	\$0	\$40,400	\$45,200
2003	\$4,800	\$0	\$38,700	\$43,500
2002	\$4,800	\$0	\$38,700	\$43,500
2001	\$4,800	\$0	\$36,500	\$41,300
2000	\$4,800	\$0	\$36,500	\$41,300

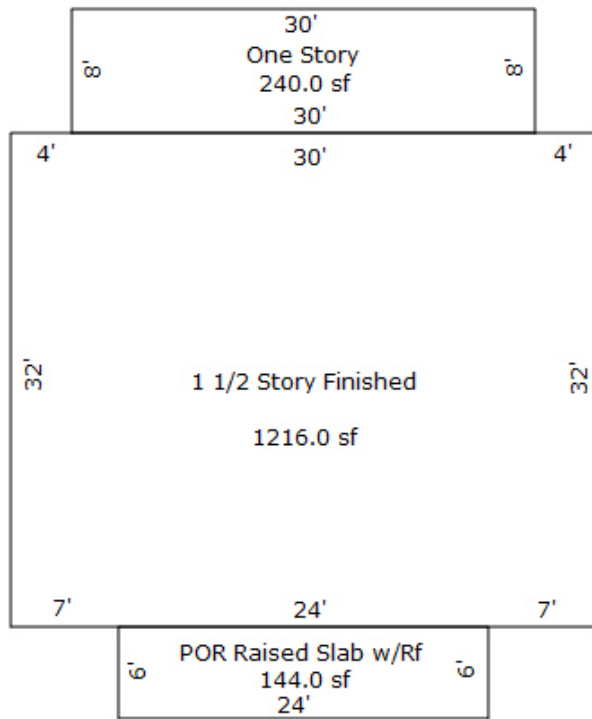

Sketch by Apex Medina™

Parcel ID: 55273



- Buildings
- Parcels
- Street Names
- House Numbers
- Parcel Numbers

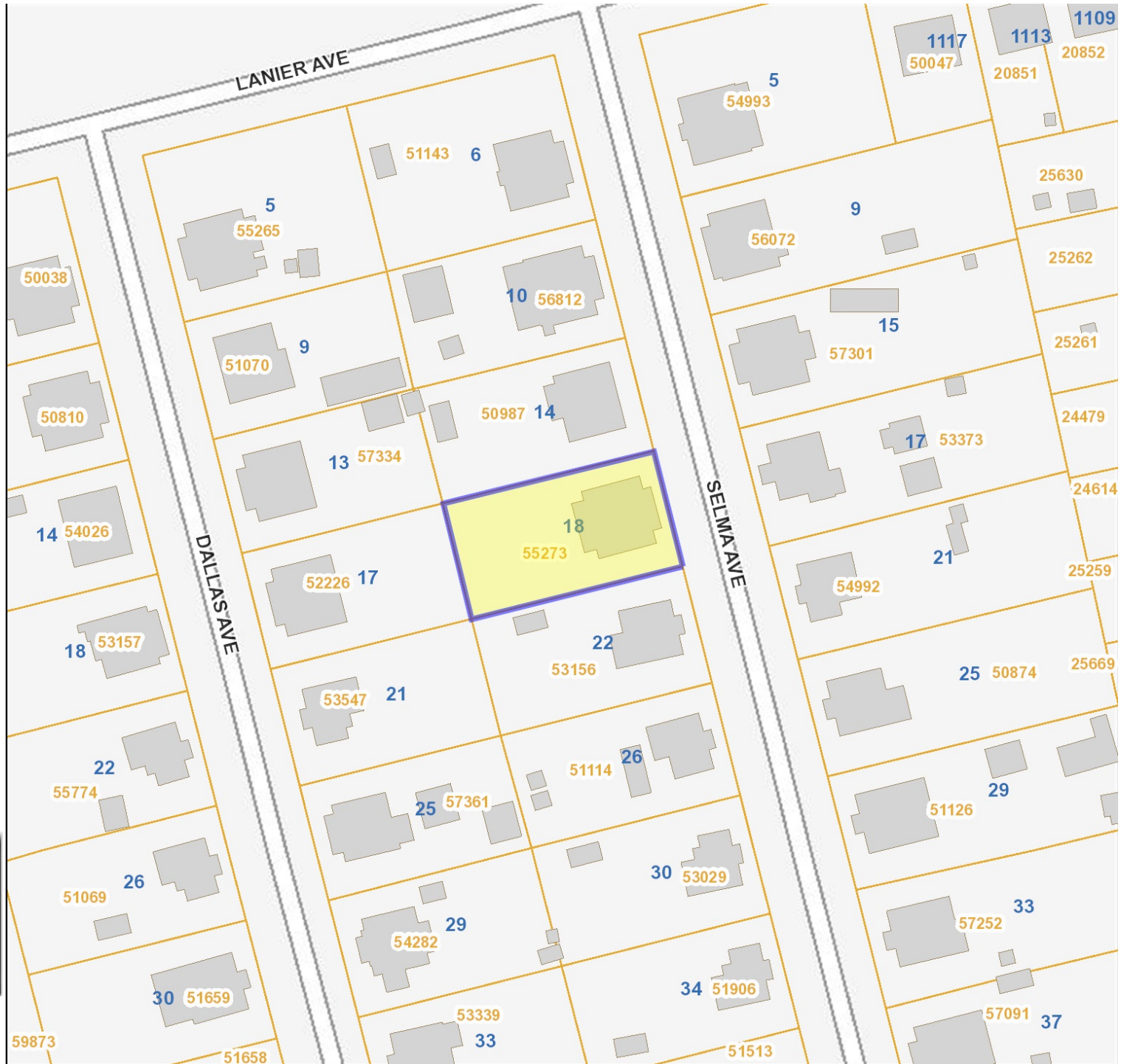

Information contained on this map is to be used for reference purposes only. The City of Danville is not responsible for any inaccuracies herein contained. The City of Danville makes no representation of warranty as to this map's accuracy, and in particular, its accuracy in labeling, dimensions, contours, property boundaries, or placement or location of any map features. No responsibility is assumed for damages or other liabilities due to the accuracy, availability, use or misuse of the information herein provided.

Date: 3/11/2019