

AirBim Double Front Bimini Lift Kit Installation Instructions (All Seadoo Switch Models)

What is in your kit:

2 lower mounts	2 lower rail gaskets 2-7/8	8 upper arm mount bolts
2 upper arm mounts	2 upper arm gaskets	4 Ball end studs
2 upper arm top mounts	2 Airbim Gas Struts 15 in	4 lower mount bolts w/nuts

Tools Needed:

Quick Grip C-Clamp	Pencil	
5/32 Allen Wrench	13 mm Socket	
Tape Measure	Crescent Wrench	

Begin by lifting the bimini and locking in the support arm on both sides, It is very important to do all measuring with support arms locked in place even when you have a side complete. We will begin installation on the Starboard (Driver Side)

Lower Mount Installation: DO NOT USE A BATTERY DRILL TO TIGHTEN YOUR BOLTS

1. With both support arms locked in place we will get a measurement on the lower rail. From the center of the mount measure over 4 $\frac{3}{4}$ inches and place a pencil mark on this measurement.
2. Next place your lower mount 3/32 gasket (The thinner gasket) around the rail. It should tuck nicely all the way under the rail on both sides. Your lower gasket is 4" x 2 $\frac{7}{8}$ inches, the gasket will go around your rail and tuck up underneath the whole rail. If it is not long enough to tuck under both sides of the rail you have the gasket material in the wrong direction, change the direction so it wraps completely under the rail.



3. Place the edge of the gasket on the line you marked. The mark and the edge of the gasket will be in this direction.



4. **Important: Place the mount in the center of the gasket. The gasket should have a small amount of overhang on each side of the mount.**
5. Insert your lower rail mount at an angle, you want the lower part of the rail mount to go in first and then press the mount upward over the top of the rail. Making sure the is fully wrapped around the rail
6. Insert the outside mount the same as the inside mount making sure your gasket is fully wrapped around the rail. Make sure your bolt holes line up and are extremely close to lining up.
7. You can possibly do this by hand but Using a c-clamp or quick grip clamp works best. You will compress the two sides together enough to start your bolts. The bolts should go through each part. If you are very close but the bolt is a little hard to get completely through you can use an allen wrench to thread it through. (You must be very very close) If you have a metal c-clamp be sure to put some protection on it so you dont scratch your mount. A quick grip clamp with rubber feet works best.



8. Place the lock nuts into their slots and begin to tighten the bolts, being careful not to cross thread, just get them both snug. Once they are snug you can begin to tighten the bolts.

Important: It is very important to tighten each bolt a turn or two rotating between each bolt. Fully tightening one bolt at a time will cause a bolt to break. The gap between the two mounts should be fully closed with no gap between them. Do NOT use any power tools when tightening your bolts

Ball Stud Bolts:

1. Insert your strut ball stud and nut and tighten, the ball stud should be facing the outside of the boat.

Your lower mount is now complete. Move to the upper mount and complete. We would suggest you complete one full side at a time.

Upper Mount Installation:

1. From the upper mount weld point measure over 7 $\frac{3}{8}$ and place a pencil mark.



2. Place your upper mount gasket (The thicker gasket) on the edge of the pencil mark. Notice how the gasket meets in the middle of the rail.
3. Next slide the lower mount over the gasket. Note: This is a very tight fit and you might want to use your c-clamp again to put this on. Once you have the lower mount over the gasket double check your measurement and the edge of the mount should be at 7 $\frac{3}{8}$. If it is not, take it off and adjust. Again this is a tight fit and if you need to remove it you can use a flat head screwdriver under the gasket and rail to wiggle it down being very careful not to scratch or damage your mount.

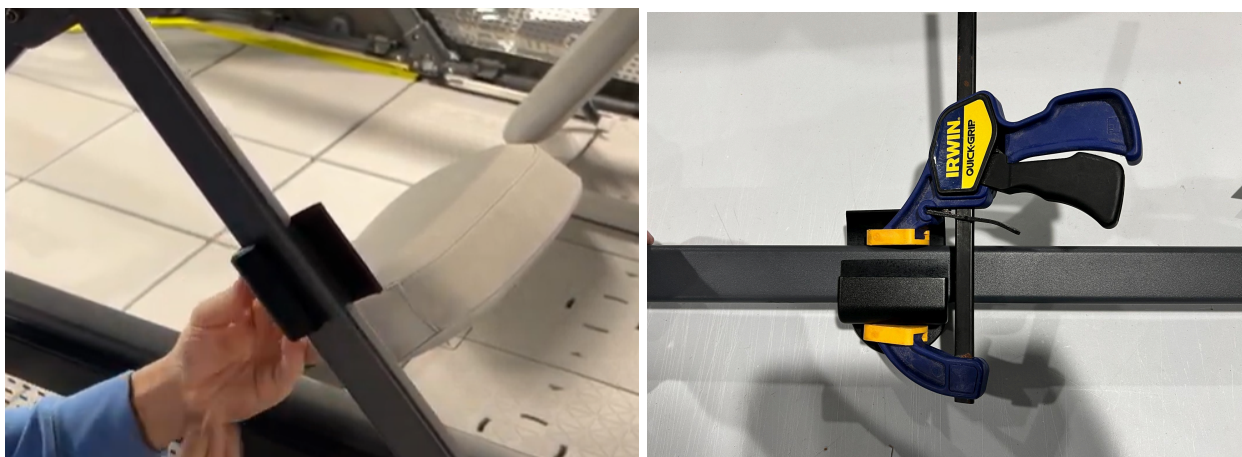

4. Place your upper mount over the top, try to line it up as close as possible to the bolt holes in the lower bracket. Then insert the bolts and thread them into the lower bracket. Be sure you are not cross threading the bolts. When lined up properly they should go in rather easily.
5. Snug up each of the 4 bolts, once all are snug you can tighten down the bolts using a cross tightening pattern, It is very important to NOT tighten down one at a time but use the cross tightening pattern. You will tighten them until the gap closes completely.
6. Next Insert your strut ball stud and nut and tighten, the ball stud should be facing the outside of the boat.

Measuring your mounts:

1. With the bimini still open and support arms still locked in place. We need to take a measurement from the center of the upper ball stud to the center of the lower ball stud. This measure meant should $14\frac{1}{4}$ to $14\frac{3}{8}$. If your measurements are not within this range you should adjust your lower rail mount forward or back slightly.

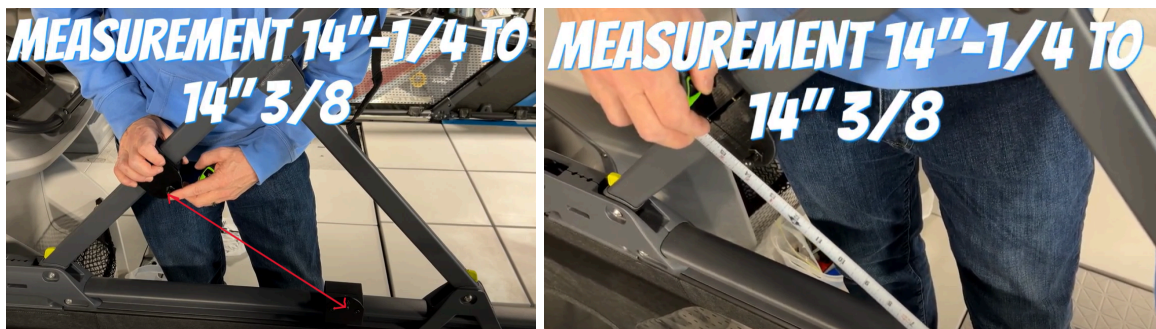

Gas Strut Install and test: Before you install your struts be sure both ends of the struts ball ends are fully screwed into the threaded ends of the struts.

1. Snap your gas struts onto the lower mount first, The strut should be placed with the base closest to the lower mount as shown here. Then you will need to lift your bimini arm up a little bit to get the strut onto the upper mount, snap the upper in as well. It is designed this way to over extend making your zipper process very simple.



2. With the struts connected remove your arm supports, but **be careful because the bimini can come down at this point**. Lower the bimini to test the motion of the system. When testing the motion be sure to lower it very slowly and watch the strut as you go all the way down slowly.

When fully lowered you should have a small or very small gap between the base of the strut and the ball stud end shown below. As long as it does not make contact with the base you are good. If when lowering it you determine it will not close fully and will hit the base you will need to move the lower mount further forward by an 1/8th inch and tighten and repeat the lowering test process.



Installation is now complete; you can repeat the process on the other side.

You now have fully completed the installation on one side of the boat, you will repeat the process on the other side. Be sure you begin the other side with BOTH support arms locked in place.

Always be sure your support arms are locked in place when boating. The AirBim is NOT intended for use while the boat is in motion.

Care and Maintenance:

1. Although your mounts are using a UV treated in the anodized process and will last a long time with proper care, they will not hold up if in direct sunlight when stored.

Many use an aftermarket cover and your mounts are covered well but there are also many that use the seadoo mooring cover which does not cover our mounts and they need to be covered. You should always keep your mounts and boat fully covered when not in use to avoid any discoloration of the mounts due to some harsh UV climate areas.

Unfortunately due to the wide variation of customer care storage we do not warranty any discoloration.

2. We recommend cleaning your mounts with after each use with a soft cloth and fresh water
3. Once a month we recommend using WD-40 on a soft cloth and wipe down your gas strut rods. For long periods of storage this process should be added to your winterization process/s

