

Vi017-1E

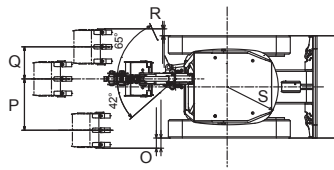

Dimensions - Vi017-1E

A 7'7" (2,310 mm)	K 10" (260 mm)
B 7' 11" (2,410 mm)	L 3'1" (950 mm) / 4' 1" (1,280 mm)
C 3' (930 mm)	M 10" (250 mm)
D 12'6" (3,810 mm)	N 7" (175 mm)
E 11'5" (3,480 mm)	O 5" (125 mm)
F 5' (1,525 mm)	P 2'1" (640 mm)
G 11'3" (3,440 mm)	Q 1'4" (400 mm)
H 8'6" (2,590 mm)	R 3" (85 mm)
I 5'6" (1,670 mm)	S 2'1" (640 mm)
J 7'7" (2,300 mm)	

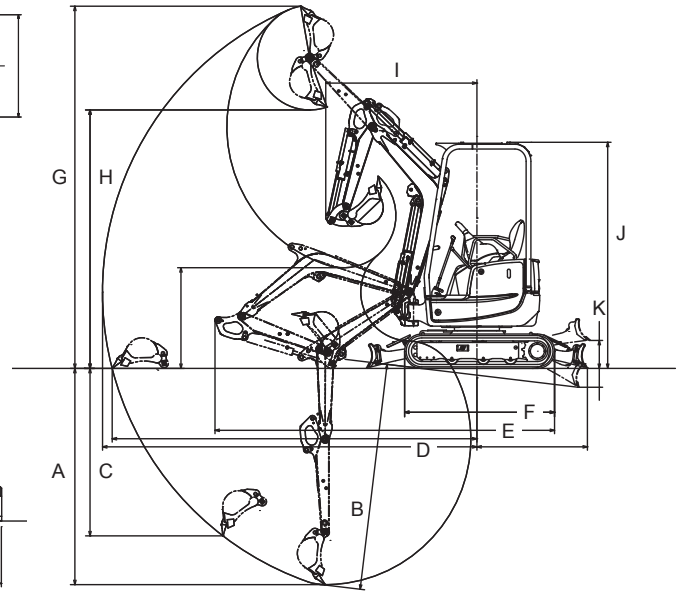
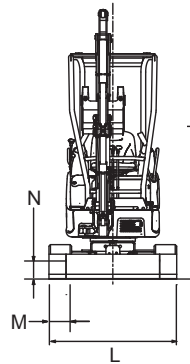

Specifications

Model		Vi017-1E	
Operating Weight	Rubber track	lbs (t)	4,023 (1.8)
Engine	Type	-	Water-cooled 3-cylinder diesel
	Model	-	YANMAR 3TNV74F-SPBV
	Output	HP (kW)/rpm	14.5 (10.8) / 2,400
Performance	Max Digging Force, Bucket / Arm	lbs (kN)	3,474 (15.5) / 1,993 (8.9)
	Traveling Speed	MPH (km / h)	2.6 / 1.3 (4.2 / 2.1)
	Swing Speed	RPM	9.5
	Boom Swing Angle, (L / R)	degrees	42° / 65°
Ground Contact Pressure (Rubber Track)		PSI (kPa)	4.1 (28.6)
Hydraulic System	Pump Capacity	GPM (L / min)	Double Variable Displacement Pump: 2 X 4.6 (2 X 17.6) Gear Pump: 3.5 (13.2)
	Main Relief Set Pressure	PSI (MPa)	2,986 (20.6)
Blade Dimensions	Width x height	ft-in (mm)	4'2"3'1" x 9" (1,280/950 x 235)
Fuel tank capacity		Gals (L)	5.3 (20)

Standard Equipment

- Blade
- Boom Swing Function
- Rubber Tracks
- 2-way Pattern Control
- Arm End Auxiliary Valve
- Cylinder Rod Guards (boom, arm, bucket, blade)
- ROPS / FOPS canopy
- Joystick Pilot Controls
- Arm Rests (adjustable)
- High Back Seat
- Seat Belt
- Travel Levers and Pedals
- Traveling Alarm
- Built-in Boom Light
- Variable Track Width
- Operation Manual
- PTO Quick Connect Fittings
- 4-Point Tie Down

Hydraulic PTO

Model	Vi017-1E	
	Output	PSI (MPa)
Specification		GPM (L / min) 2,200RPM
Combined Flow, Double Actions	2,175 (15)	8.5 (32.2)

Lifting Capacity

LIFT POINT HEIGHT h:in (mm)	r:REACH in (mm)											
	RATED LIFT CAPACITY OVER END BLADE DOWN lbs (kg)				RATED LIFT CAPACITY OVER END BLADE UP lbs (kg)				RATED LIFT CAPACITY OVER SIDE BLADE UP lbs (kg)			
	MAX	98.5 (2,500)	78.7 (2,000)	59.1 (1,500)	MAX	98.5 (2,500)	78.7 (2,000)	59.1 (1,500)	MAX	98.5 (2,500)	78.7 (2,000)	59.1 (1,500)
(2,000)	683 (310)	617 (280)			485 (220)	815 (370)			529 (240)	595 (270)		
(1,500)	705 (320)	694 (315)			418 (190)	694 (315)			473 (215)	694 (315)		
(1,000)	727 (330)	870 (395)	1058 (480)		396 (180)	650 (295)	848 (385)		440 (200)	694 (315)	1047 (475)	
(500)	760 (345)	1003 (455)	1410 (640)		396 (180)	584 (265)	815 (370)		429 (195)	628 (285)	903 (410)	
(0)	793 (360)	1091 (495)	1598 (725)	2171 (985)	396 (180)	562 (255)	793 (360)	1102 (500)	451 (205)	617 (280)	881 (400)	1311 (595)
(-500)	837 (380)	1157 (525)	1543 (700)	2325 (1055)	429 (195)	573 (260)	749 (340)	1146 (520)	485 (220)	628 (285)	848 (385)	1333 (605)
(-1,000)	870 (395)	1025 (465)	1477 (670)	2182 (990)	485 (220)	551 (250)	749 (340)	1157 (525)	551 (250)	617 (280)	826 (375)	1300 (590)

Please note that the standard equipment may vary from this list. Consult your YANMAR dealer for confirmation.