



140MT-C Frame



140MT-D Frame



140UT- D Frame

140MT, 140UT Overview



expanding **human possibility**®

Ashwin Patel – June 2021



PUBLIC

Glossary of Terms

MCCB, MPCB/MPSD, MCP - Functions

- **Molded Case Circuit Breaker - MCCB**

- Feeder Distribution and Branch Circuit Protection (conductors, bus and cable)
 - Short Circuit Protection
 - Overcurrent Protection - calibrated for distribution conductor applications
 - Disconnect Applications

- **Motor Protection Circuit Breaker - MPCB / Motor protection Switching Device - MPSD**

- Motor Protection
 - Disconnect for motor branch circuit
 - Short Circuit Protection (Type E)
 - Overload Protection - calibrated for motor overload applications
 - Manual Controller (ON/OFF)

- **Motor Circuit Protector - MCP**

- Motor Branch Circuit Protection
 - Short Circuit Protection Only (magnetic trip only)
 - Motor Overload protection that is provided with separate overload relay (e.g. 193-E)

Glossary of Terms

Application Ratings

- **Self-protected combination motor controller (construction type E)**

Combination motor controller with coordinated protection, so as to permit continuity of service up to its rated short-circuit current. A self-protected combination motor controller is evaluated as a complete unit whether comprised of a single or multiple components. The coordinated protection may be inherent or obtained by correct selection of components or accessory parts in accordance with the manufacturer's instructions. In North America, a Type E or self protected motor controller can be used in place of the branch circuit protection in a motor circuit.

- **Group Motor Installation (NEC Article 430.53)**

A type of installation where a group of loads, consisting of two or more motors, or one or more motors and other loads, are able to be protected by a single set of branch circuit fuses or inverse – time circuit breaker. Refer to NEC 430.53 for detailed requirements of Group installation. Manual Motor Controllers are listed as suitable for group motor installation.

- **Tap Conductor Protection**

A manual motor controller listed for tap conductor protection in group motor installations is permitted to have conductors that are no smaller than 1/10 the ampacity of branch circuit protective device. Refer to NEC 430.53 (D) for other restrictions



Glossary of Terms

MCCB, MPCB/MPSD, MCP

- **Motor Protection Circuit Breaker – MPCB**

Manual motor controllers are also commercially referred to as Motor Protection circuit breaker or Motor protective circuit breaker. Some other manufacturer refers to these devices as Manual motor protector or Manual starter protector etc. But now IEC has defined term as MPSD.

- **Motor Protective Switching Device MPSD (IEC 60947-4-1 reference 3.4.31))**

Manually operated motor starter additionally providing resettable short-circuit protection to the motor and the circuit

-Note 1: A MPSD can also be used as a manual starter, a protected starter or a combination starter.

-Note 2: A MPSD can be used as a SCPD within the motor branch when rated as Type E

-Note 3: In North America, this device is also called manual motor controller.

- **Type 2 Short Circuit Coordination:**

A listed motor controller with Type 2 Short Circuit Coordination meets the following criteria at the voltage and current it is rated at. The user must not exceed fuse or circuit breaker as recommended by the manufacturer.

1. The contactor or starter must not endanger persons or plant in the event of a short circuit.

2. No damage to the motor protection device or other parts may occur with the exception of welding of the contactor or starter contacts if these can be easily separated without appreciable deformation (such as with a screwdriver).



The evolution of the Motor Control & Protection portfolio

Complete renewal and expansion of our starter combinations

FY19



FY20



140M and New 140MP

- **NEW** 140MP = Basic Tier Portfolio (price / simple applications)
- 140M = Global Performance

FY21



140MP and New 140MT

- 140MP = Basic Tier Portfolio
- **NEW** 140MT = Global Performance (repl. 140M)
 - **FY23** 140ME = Electronic (future SubNet, flexibility)



100-C and New 100-E

- 100-C = Global Value Portfolio (productivity)
- **NEW** 100-E = Global Performance (universal coil, future SubNet)



E200, E300 and New E100

- **NEW** E100 EE = Basic (productivity, flexibility)
- **NEW** E100 EF = Advanced (flexibility, future Subnet)
- E200 = Stand-alone High Performance
- E300 = Global Architecture (Data, Application)

Tiered Portfolio

- Basic Tier - 140MP
- Global Performance - 140M/140MT
- Advanced - 140ME Electronic (Future)

140MT – Why a new MPCB?

- 140M is 20+ year old product line.
- No possibility of improving product features at reasonable cost with 140M anymore.
- Renewal of the full Motor Control Portfolio → MCS2.0
- Enhance performance and certifications
- Future 140ME platform will be based on 140MT design (Subnet Enabler)

140MT and 140UT Overview

Current Range extension & Improved thermal performance, Application Ratings

- 140MT-C frame is up to 32 A and 140MT-D frame is extending current range up to 40A
- 140UT are very compact UL 489 and IEC 60947-2 MCCB extending up to 40A
- Higher short circuit ratings and application coverage (tap conductor protection and Type E ratings) for 140MT-D
- Improved thermal performance compared to existing product line (Lower heat loss)
- Different product variants (MCP, High inrush version, D9V for application at output of Drives) are covered by single frame size D.
- Lockable knob and anti-tamper shield as standard offering for 140MT-D
- Connecting modules and Combination SCCR tested with 100-E, 100-C and 100-K contactors.
- Back feeding capability 140UT
- Expanding global certifications (UL, CE, ATEX, IECEx, CCC, EAC, Morocco, KC, CB Scheme)

140MT Product line Overview

Extended Current Ratings – High Short Circuit performance

- **140MT Product line**

- 140MT MPCB Magnetic S/C & Thermal Overload Protection
- 140MT MCP w Magnetic S/C protection

- **Product Attributes**

- 140MT – C up to 32A, D Frame up to 40A
- Short circuit protection $14 \times I_e$, 65kA @ 480V / 100kA @ 400V
- Overload Protection – Trip Class 10
- Common Electromechanical and Expansion Accessories
- Group motor installation, Tap conductor Protection, Type E Ratings
- Type F ratings, Type 1 and Type 2 SCCR testing
- Expanded certifications – CE, cULs, EAC, Marine, ATEX, CCC etc.
- New Auxiliaries and Accessories

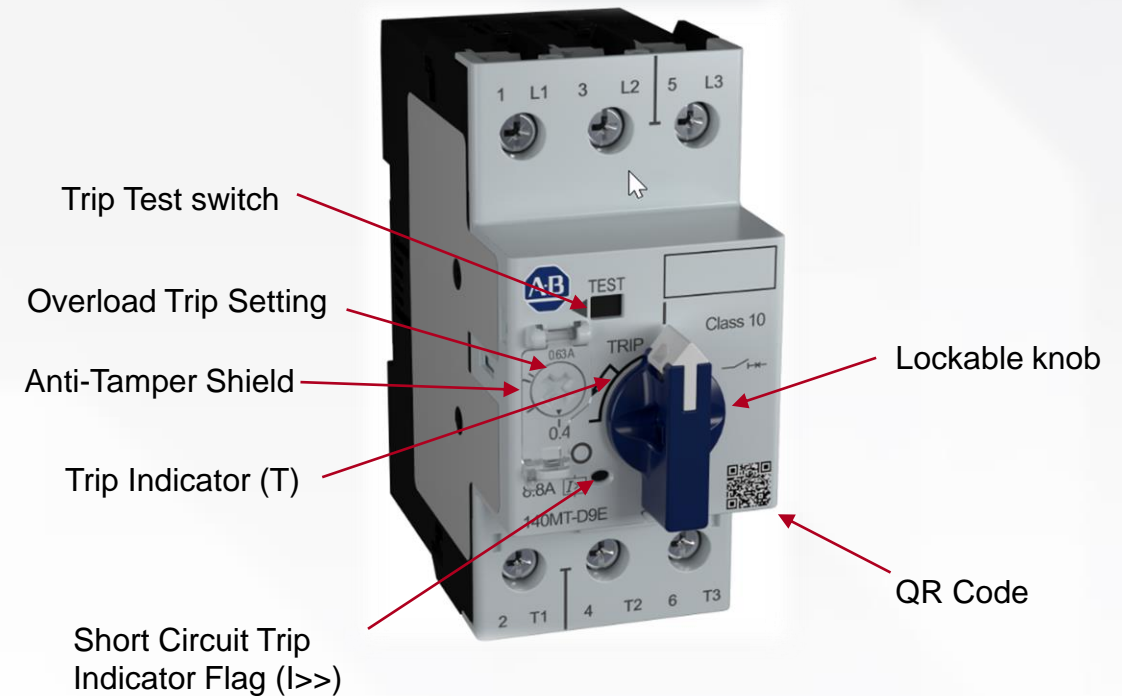

Protection and Control Functions - MPCB
Disconnect for Motor Branch Circuit
Branch Circuit, Short Circuit Protection
Overload Protection (Thermal Protection)
Switching (Manual)

140MT Product line Variants

All Variants part of D Frame

45 mm



140MT-C Frame 0.1 – 32 A

- MPCB - S/C & Overload Protection

45 mm



140MT-D Frame 0.1 – 40 A

- Standard MPCB (14 x Ie)(MPCB)
- High Inrush version (19...22 x Ie) MPCB
- MPCB for application at output of VFD
- Motor Circuit Protector (MCP) – No thermal trip
- Standard lockable knob
- Standard Anti-Tamper shield

45 mm



140UT- D Frame 0.5 – 40 A

- MCCB version replacing 140U-D

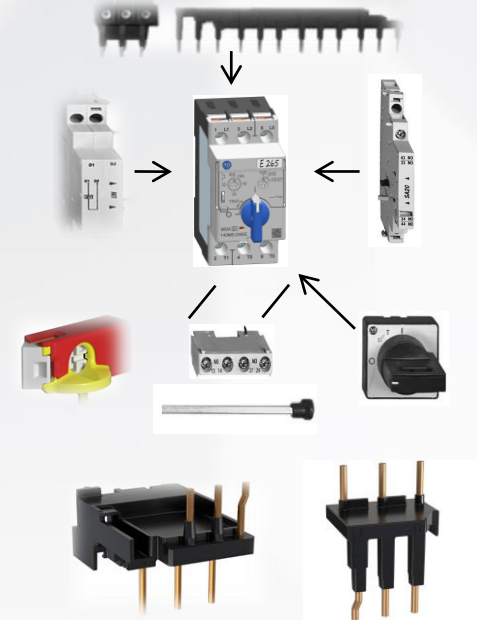

140MT /UT- Accessories (NEW)

140MT MPCB / MPSD

Motor Protection Circuit Breaker / Motor Protective Switching Devices

- **Protection and Control Functions - MPCB**
 - Disconnect for Motor Branch Circuit
 - Branch-Circuit, Short Circuit Protection (Magnetic Protection)
 - Overload Protection (Thermal Protection)
 - Switching (Manual)
- **Features**
 - Fixed Magnetic Trip - C3E, D9E, F8E (13...14 x I_e)
 - High Inrush MPCB - D9T & F8T (16...21 X I_e)
 - Motor overload protection, Trip Class 10
 - High Current limiting, Visible Trip Indication
 - Version for application at **output of VFD (D9V)**
 - Group motor installation, Tap conductor Protection and Type E ratings



140MT, 140MP Applications

MPCB/MPSD Applications – North America

MPCB/MPSD



140MT, 140MP



Contactor



100-C, E, K

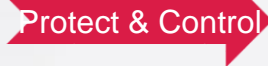

Load



- 140MT & 140MP both are listed for **Group motor application**
- SCCR combination tested with 100-E, 100-C & 100-K contactors
- 140MT are listed for Tap conductor protection enables in tap conductor size reduction (140MP are not listed for this)

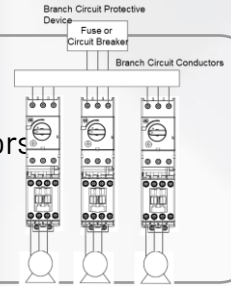

MPCB



140MT



Contactor



100-C, E



Load



- Type F Combination controller 140MT+100-C, E
- 140MT are listed as **Type E** (Self protected combination motor controller)
- Can be applied without BCPD (branch circuit protection)



At motor disconnect
/ Manual motor starter

140MT, 140MP



- 140MT and 140MP both are rated as motor disconnect
- 140MP is economical and competitive
- 140MP have enclosures as accessories

Definition on Group motor and Type E refer to below link -
140M Application UL NEC IEC V2

140MT, 140MP Applications

With Drives - North America

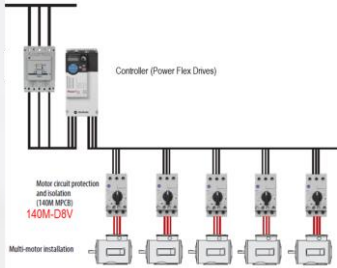

- Application at output of Drives for multi motor application
- Need special design due to **voltage wave reflections**
- 140MT-D9V are design and tested for these applications

AFC- To be communicated

MPCB/MCCB



140MT/140UT



VFDs (PF 520)



Protect & Control

Load



- **Type E** rated device can be applied for input protection of Drives
- To be tested in combination with Drives & Listed in Drives manuals
- 140MT are Type E rated and will be tested with PowerFlex® 520 Drives

140MT Group motor & Tap conductor ratings

UL SCCR for Group motor

140MT UL Listed for Group motor installation

- A Group motor installation removes the requirement to provide a circuit breaker or fuse for each motor circuit which helps to reduce cost and save space.
- Tap conductor protection ratings allows reduction in conductor sizing
- The contactor provides for remote control
- Lockable handles (accessory) provide a disconnecting means for individual motor circuits.
- Adding compact busbar and feeder terminal accessories ...
 - Provides efficient power distribution to each motor circuit.
 - Eliminates time and cost of additional wiring
- This type of installation allows for non motor loads to be connected to same BCPD as well.
- 140MT UL Listed for Group motor installation with 100-C, 100-E and 100-K contactors also

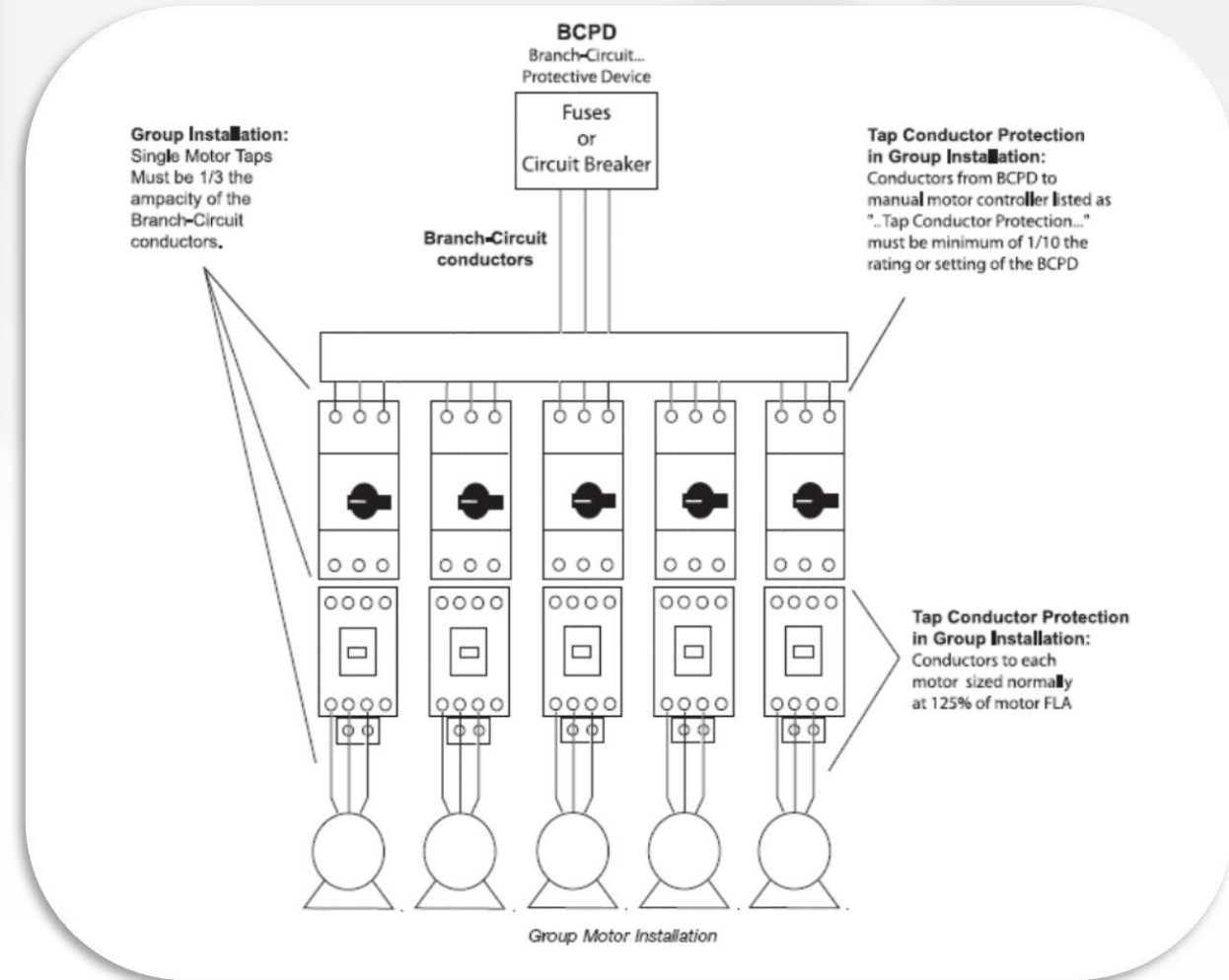

140MT Type E ratings

Self-protected Combination motor controller Type E & Type F ratings with contactors

140MT UL Listed Manual, Self-Protected Combination Motor Controllers

- 140MT (Type E Listed) provides all the necessary NEC/CEC requirements for the protection and control of individual Motor Branch Circuits without additional protective devices.
- Can be directly connected to feeder circuit
- Type F combination motor controller consists of a Type E manual self protected combination motor controller and a magnetic or solid-state motor controller (such as a Bulletin 100-C, 100-E contactor or an SMC™).
- 140MT UL Listed as Type F combination motor controller with 100-C, 100-E and 100-K contactors

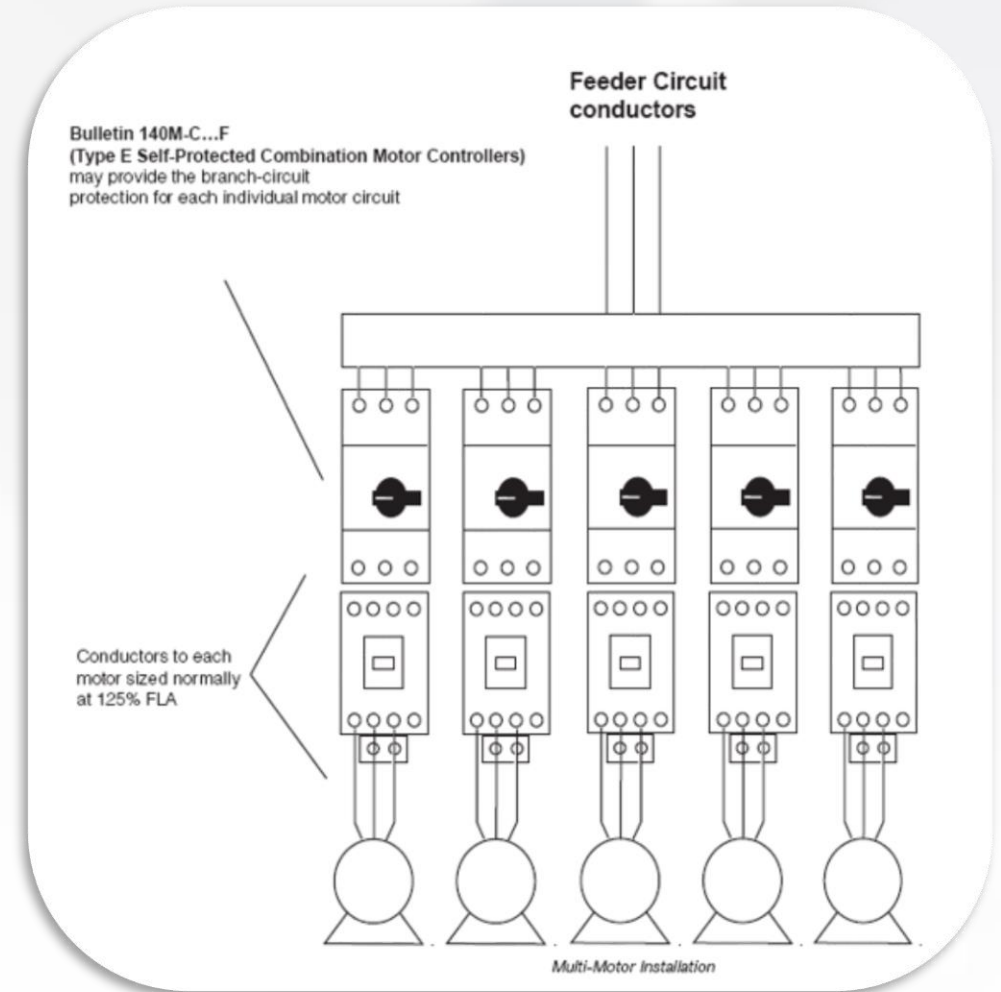

140MT Type 2 ratings

Type 2 Short Circuit Coordination with 100-C, 100-E

- **Type 2 Short Circuit Coordination:**
- The contactor or starter must not endanger persons or plant in the event of a short circuit.
- No damage to the motor protection device or other parts may occur with the exception of welding of the contactor or starter contacts if these can be easily separated without appreciable deformation (such as with a screwdriver).
- In the event of short circuit, fast-opening, current-limiting Bulletin 140M Motor Protection Circuit Breakers make it possible to build economical, fully short-circuit coordinated starter combinations with Type 2 coordination.



140MT-D9V

At output of VFD

Application

- In multiple motor applications, **NEC §430, part III**, requires individual motor **overload protection**, that is (thermal) overload function, on the load side of a VFD only
- Rated to provide short circuit protection for individual motor circuit Tap conductors where required.
- **140MT-D9V are suitable for application at output of VFDs in multi-motor installation**
 - PWM frequency ≤ 4 kHz
 - VFD output frequency ≤ 400 Hz
 - Current setting = rated motor current
 - Maximum cable length of drive instruction manual apply
 - Preferred location of MPCB installations is as close to the motor as possible

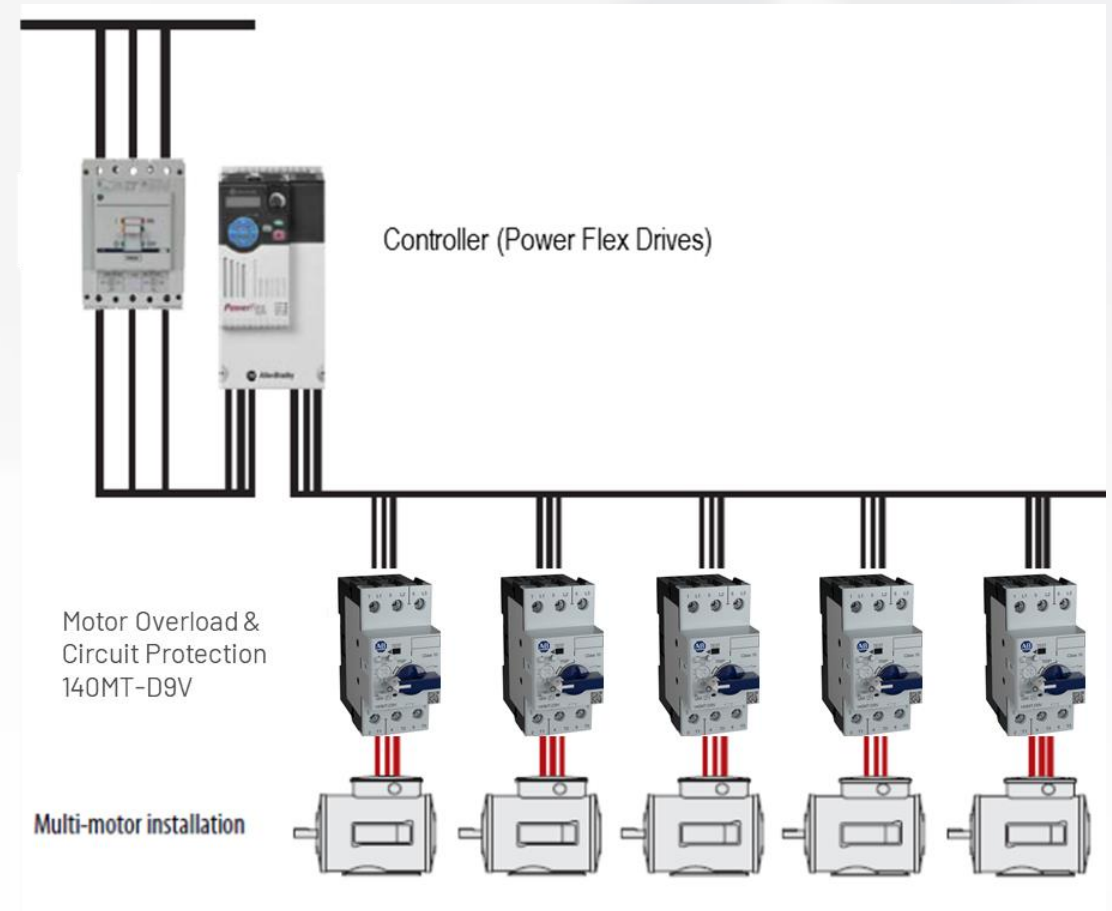

140MT-D9V

At output of VFD

- Recommendations for **VFD**:
- VFD Sizing: Add FLA and add at least 20% due to lower leakage inductance.
- On PowerFlex® 520 don't go below 3 hp due to capacitive coupling (cable charging current).
- Adding a common mode core and using XLPE cable will minimize cable charging current
- Drives must be set in VHz motor control
- If motor cables are long a PowerFlex® 750 and 1204-RWR would be recommended due to the lower dv/dt of drive
- Do not "line start/stop" motor when VFD is running

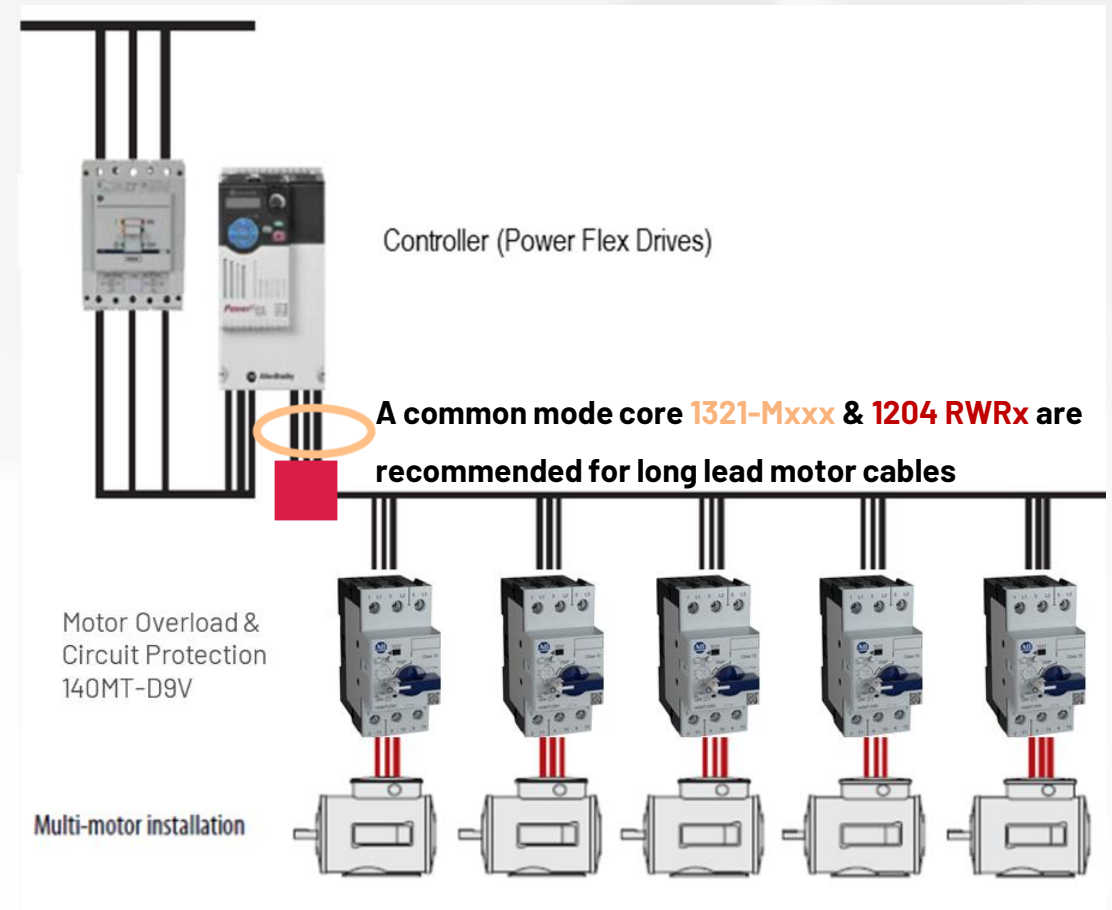

*Please contact Drive Technical Support for additional information if needed 1.440.646.3434

140MT MCP & Application

MCP – Motor Circuit Protector

- **140MT Motor Circuit Protectors (MCP)**
 - 140MT D Frame 0.16 – 40 A
 - 140M F Frame 25 – 45 A
- **140MT MCP Product Overview**
 - Motor Circuit Protector – MCP (D9N, F8N)
 - Fixed Magnetic Trip – (13....14 x I_e)
 - Provides short circuit protection for 3-components starter
 - No motor overload protection
 - For Trip Class 10 application
 - Need derating for heavy duty starting (Trip class 15,20,30)



MCP



140MT-D9N

Contactor



100-C,E

Overload



E100

Protect & Control







Load



- For 3 component starter **MCP variants** with magnetic trip only is required to provide short circuit protection
- 140MT-D9N are only MCP version (not available in 140MP)
- Tested as 3 component combination starters

140M, 140MP, 140MT

Comparison overview

						
Bulletin No.	140MP-A	140M-C	140MT-C	140M-D	140MT-D	140M-F
Frame Size	-	C-Frame	C-Frame	D-Frame	D-Frame	F-Frame
Dimensions (mm)	45x90x85.5 ⁽¹⁾	45x92x75	45x96x84	45x92x85	45x96x94	54x111x115
Current Range (A)	0.1 - 32	0.1 - 32	0.1 - 32	1.6 - 32	0.4 - 40	6.3 - 45
SCCR @ 480V (kA)	18-30	25-65	30-65	30-65	30-50-65	65
SCCR @ 400V (kA)	15-50-100	15-65-100	15-65-100	50-65-100	50-65-100	65-100
Short Cir. Protection	✓	✓	✓	✓	✓	✓
Overload Protection	✓	✓	✓	✓	✓	✓
Overload Trip Class	10A	10	10	10	10	10
Phase Loss Sens.	✓	✓	✓	✓	✓	✓
Short Circuit Indication	✗	✓	✓	✓	✓	✓
Lockable knob	Optional	Optional	Optional	Optional	Standard	Optional
Compatible at output of VFD	✗	✗	✗	✓ ⁽²⁾	✓ ⁽²⁾	✓ ⁽²⁾
MCP Version, High Inrush version	✗	✓	✗	✓	✓	✓

140M, 140MP, 140MT

Comparison overview

UL 60947-4-1 Application Ratings

Bulletin No.	140MP-A	140M-C	140MT-C	140M-D	140MT-D	140M-F
Motor Disc. Rated	✓	✓	✓	✓	✓	✓
Group Motor Rated	✓	✓	✓	✓	✓	✓
Tap Conduct. Prot.	✗	✓	✓	✓	✓	✓
Man/Self Protected (Type E)	✗	✓	✓	✓	✓	✓
UL Type F Ratings	✗	100-C, 100-K	100-C, 100-E, 100-K	100-C, 100-K	100-C, 100-E, 100-K	100-C

Standards Compliance and Certifications

Bulletin No.	140MP-A	140M-C	140MT-C	140M-D	140MT-D	140M-F
cULus Listing ⁽³⁾	✓	✓	✓	✓	✓	✓
IEC/EN 60947-2	✓	✓	✓	✓	✓	✓
IEC/EN 60947-4-1	✓	✓	✓	✓	✓	✓
CE	✓	✓	✓	✓	✓	✓
ATEX	✗	Up to 25 A ⁽²⁾	✓	Up to 25 A ⁽²⁾	✓ ⁽²⁾	✗
IECEX	✗	✗	✓	✗	✓ ⁽²⁾	✗
EAC	✓	✗	✓	✗	✓	✓
CCC	✓	Up to 25 A ⁽²⁾	✓	Up to 25 A ⁽²⁾	✓	✓
KC	✓	✗	✗	✗	✗	✗
CB Scheme	✓	✓	✓	✓	✓	✓

(1) - Dimension is for up to 16A. Dimensions for 20-32A: 45x96.8x85.5.

(2) - See technical documents for more details.

(3) UL 60947-4-1, CSA C22.2, No. 60947-4-1.

140UT Product line Overview

Current Limiting Circuit Breakers

• 140UT Product line

- 140UT MCCB – Short circuit protection, Thermal overcurrent protection
- 2 Pole & 3 Pole versions
- Replaces 140U-D

• Product Attributes

- 140UT – D Frame 40 A
- Short circuit protection up to 100kA @ 480Y/277V, 100kA @ 400V
- Common Electromechanical and Expansion Accessories with 140MT
- Current limiting
- Suitable for back feeding
- 100% rated up to 12A
- UL 489 & IEC 60947-2

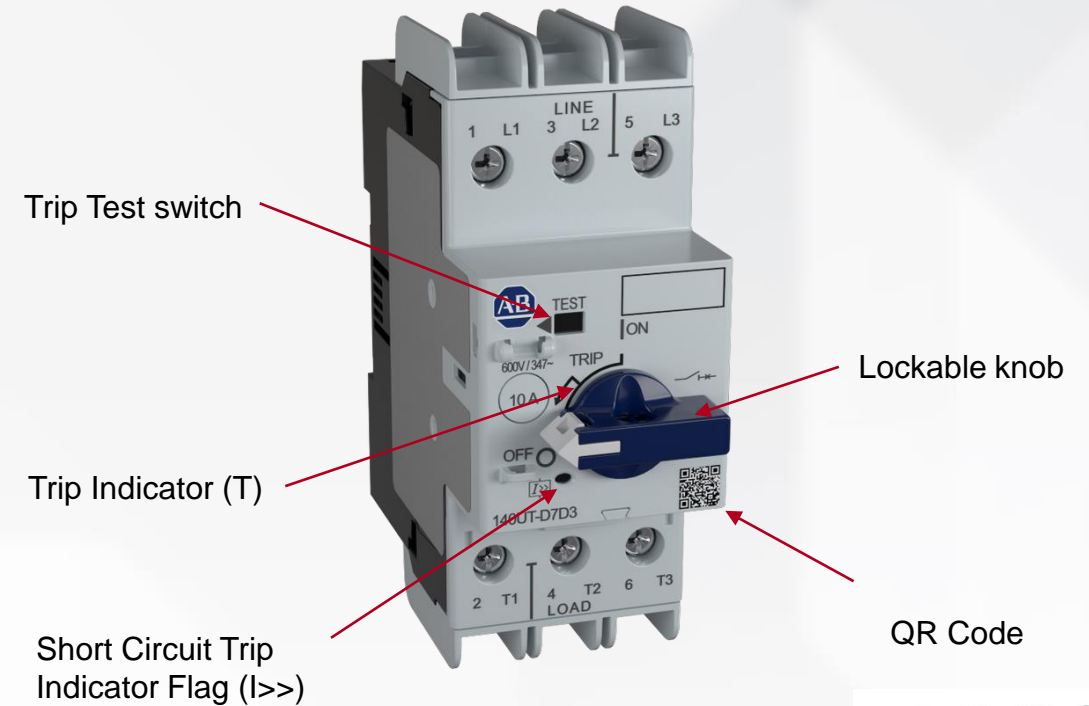

2 Pole



140UT Accessories

All Aux and Handles common with 140MT

- 140UT Compact busbar 64A
- 140UT Connection Modules
 - Eco connection module 25A
- Common Accessories from 140MT line
 - Front mount auxiliary contacts
 - Lockable knobs
 - Door handles
 - Shunt and under voltage trip units

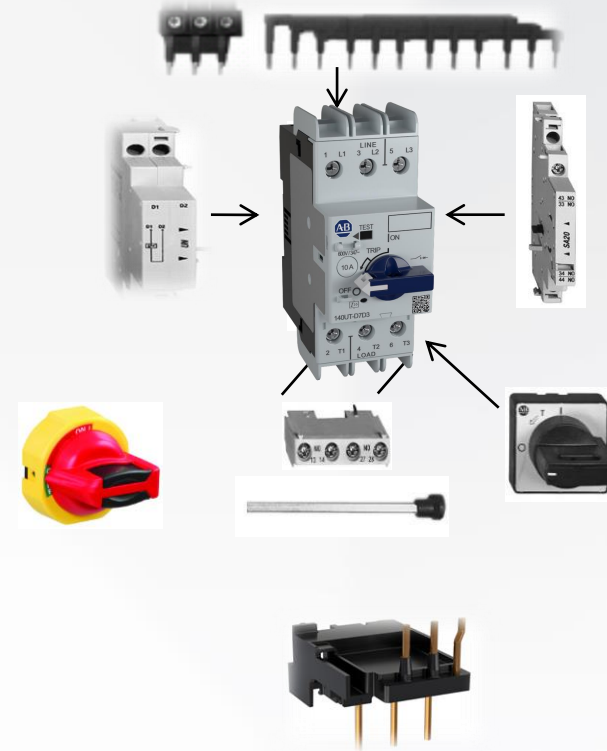

14UT-D Applications

MCCB Application

MCCB



140UT-D

Protect & Control

Non- motor load

Heaters
Transformers
Control Circuit
Lighting

- Requires **UL 489** certified MCCB for non-motor loads
- 140UT-D are UL 489 listed
- Heating, air conditioning and refrigeration (HACR), HID & SWD ratings

MCCB



140UT-D

Protect & Control

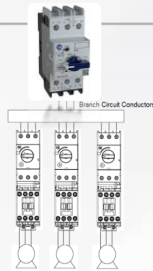

- Requires **UL 489** certified MCCB as BCPD
- Small Panels

140UT Advantage:

- Space saving – Very compact MCCB
- Current limiting
- High interrupting rating
- 2 & 3 pole devices
- Compact busbar accessories & connection modules for contactors
- Suitable for back feeding

140M to 140MT Migration

- 140MT C/D Frame AFC –August 2021
- 140UT MCCB AFC - August 2021
- 140M-F Lifecycle status remains Active



**140M- C & D
Frame**



140MP



140MT – C&D Frame



140U- D MCCB



140UT- D MCCB

Remains Active



**140M -F Frame
6.3 - 45 A**

Current Range

140M current range

Frame C –

Normal break (C2E)
32A

Normal break, high Inrush (C2T) 0.10 – 16A

MCP Normal break (C2N)
2.5A

Frame D –

High break (D8E) 1.6 – 32A

High break, high Inrush (D8T) 16 – 20A

High break for VFD output (D8V) 1.0 – 32A

MCP High break (D8N) 1.6 – 32A

Frame F –

Unchanged 6.3 – 45A

140MT current range

Frame C –

Normal break (C3E) 0.10 – 32A

Frame D –

High break (D9E) 0.40 – 40A

High break, high Inrush (D9T) 0.1 – 25A

High break for VFD output (D9V) 1.0 – 40A

MCP High break (D9N) 0.1 – 40A

(Frame F –)

No Change (use 140M-F) 6.3 – 45A

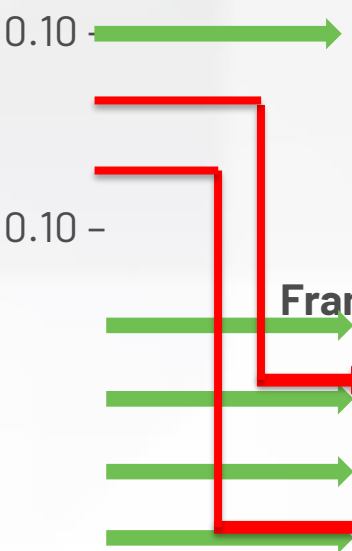

Accessories – Auxiliary contacts

140M aux. contacts

140M-C-AFA10

140M-C-AFA01

140M-C-AFA11

140M-C-AFA20

140M-C-AFA02

140M-C-ASA20

140M-C-ASA02

140M-C-ASA11

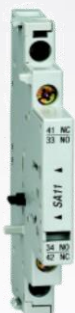

140MT aux. contacts

140MT-C-AFA10

140MT-C-AFA11

140MT-C-AFA20

140MT-C-ASA20

140MT-C-ASA02

140MT-C-ASA11

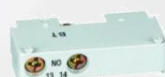

140M Trip contacts

140M-C-AFAR10A10

140M-C-AFAR10A01

140M-C-ASAR10M10

140M-C-ASAR10M01

140M-C-ASAR01M10

140M-C-ASAR01M01

140M-C-ASAM11



140MT Trip contacts

140MT-C-AFAR10A10

140MT-C-AFAR10A01

140MT-C-AFAR01A10

140MT-C-AFAR10M10



- Red = to be discontinued
- Green = new type

Accessories – Undervoltage- and Shunt Trips

Undervoltage Trip units

140M - 140M-C-UX / UC(*)

24V, 60 Hz

24V, 50 Hz

120V, 60 Hz

110V, 50 Hz

208V, 60 Hz

220...230V, 50 Hz

240...260V, 60 Hz

277V, 60 Hz

380...400V, 50 Hz

480V, 60 Hz/415V, 50 Hz

575V, 60 Hz/500V, 50 Hz

140MT - 140MT-C-UX

(*)Undervoltage trip units with early make contacts will not be offered with 140MT

24V, 50 Hz

120V, 60 Hz

220...230V, 50 Hz

240...260V, 60 Hz

380...400V, 50 Hz

480V, 60 Hz/415V, 50 Hz

Shunt Trip units

140M - 140M-C-SN

24V, 60 Hz

24V, 50 Hz

110V, 50 Hz/120V, 60 Hz

208V, 60 Hz

220...230V, 50 Hz

240...260V, 60 Hz

277V, 60 Hz

380...400V, 50 Hz

480V, 60 Hz/415V, 50 Hz

575V, 60 Hz/500V, 50 Hz

600V, 60 Hz

24V DC

140MT - 140MT-C-SN

24V, 50 Hz

110V, 50 Hz/120V, 60 Hz

220...230V, 50 Hz

240...260V, 60 Hz

277V, 60 Hz

380...400V, 50 Hz

480V, 60 Hz/415V, 50 Hz

24V DC

• Red = to be discontinued

Accessories – Others

	140M	140MT
Anti-Tamper Shield	X	X
Lockable Twist Knob	X (1 Padlock 5mm) Black, R/Y	X (1 Padlock 4-6mm) Blue, Black, R/Y
Locking Tag	X	X
Door Coupling Handle	X (Black, R/Y)	X (Black, R/Y)
Extension Shaft & Support	X	X
Legend Plate	X	X
Screw Adapter	X	X
IP65 Non-Metallic Enclosure	X	Late 2021(TBD)
Compact Busbar System (2-5 connections 45mm & 54mm)	X	X
ECO Connecting Modules	100-K, -C	100-K, -C and -E
Standard Connecting Modules	100-C	100-C



Documentation & Actions

Early Announcement

Documentation

Migration guide – Now in Literature Library and Seismic
Tech Specification Draft – Now on Seismic
Drawings, 3D stp files (Main devices) – Now on Seismic
Product Presentation – Now on Seismic
140M Lifecycle Status letter – Now on Seismic
FAQ – Now on Seismic
Combination SCCR Specification Draft – in Tech Spec
SCCR tool updates– Aug
ProposalWorks™ – Aug

Others

Early announcement of discontinuation to selected customers – June
Seismic Link for documentation – Now
Incentivize early transition through discount – Aug
Conversion report – Power BI report for TBL – Ready now
GRM Communication to Distributors – Done

Seismic link: [140M to 140MT Pre-Launch Migration Information](#)

Bulletin 140M to 140MT Motor Protection Circuit Breakers

Pre-Launch Migration Information

Overview

With the launch of the new 140MT Motor Protection Circuit Breaker and 140UT Molded Case Circuit Breaker by mid of August 2021, Rockwell Automation will announce the discontinuation of the existing 140M (C- and D-frame) and 140U (D-frame) Products with short migration time line (Discontinuation date of ~March 2022)

The new 140MT-C, D frame & 140UT-D replaces the 140M-C,D Frames & 140U-D that is being discontinued. With the introduction of the new 140MT C & D frame MPCB and 140UT-D MCCB, we can serve customer applications that were previously served by the bulletin 140M & 140U-D. The balance of the 140M that is F frame up to 45A, we will continue to serve our customers with existing product line.



140MT and 140UT

- 140MT-C frame is up to 32A and 140MT-D frame is extending current range up to 40A
- 140UT are very compact UL 489 and IEC 60947-2 MCCB up to 40A
- Higher short circuit ratings and application coverage (tap conductor protection and Type E ratings) for 140MT-D
- Improved thermal performance compared to existing product line (Lower heat loss)
- Different product variants (MCP, High inrush version, D9V for application at output of Drives) are covered by single frame size D
- Lockable knob and anti-tamper shield as standard offering for 140MT-D
- Connective modules and Combination SCCR tested with 100-F, 100-T

140MT Factory Configuration – Aux & Handles

140MT + Accessories

- Factory Configured 140MT with Aux, Knobs etc. – Dec 2021 (working on early launch)
 - E.g 140MT-C3E-B63-CX-KRY



140MP 140MT Comparison

	140MP-A	140MT-C	140MT-D
Trip Class	10A	10	10
Current Range	32	32	40
FLA Range	1.6:1	1.6:1	1.6:1
SC Trip Indication	No	Yes	Yes
Switch Position	ON/OFF	ON/OFF/Trip	ON/OFF/Trip
Phase loss Protection	Yes	Yes	Yes
Instantaneous SC Setting	12.5Xle (up to 6.3A), 15Xle	14 X le	14 X le
SC Ratings 400V	50kA (up to 10A), 25/15 KA	100kA (up to 10A), 65/ 50 / 15KA	100kA (up to 20A), 65/ 50KA
SC Ratings 480V (group install)	30KA (up to 2.5A) 18 kA	65kA (up to 10A) , 30 / 25KA	65kA (up to 20A) , 50 / 30KA
Group Installation	Yes	Yes	Yes
Motor Disconnect	Yes	Yes	Yes
Tap Conductor Protection	No	Yes	Yes
Type E	No	Yes	Yes
Type F Rating with 100-C/E	No	Yes	Yes
Locakable knob	Optional	Optional	Yes
Lifecycle Mechanical -Cycles	100000	100000	100000
	100000 (up to 16A)		
Lifecycle Electrical - Cycles	50000 (20..32A)	100000	100000
High Inrush version	No	No	Yes (D9T)
Application at ouput of VFD	No	No	Yes (140MT-D9V)
MCP for 3Component Starter	No	No	Yes (D9N)
Input protection of VFD	No	Yes*	Yes*
* Combination testing pending with VFDs, see drives manual for specific combinations			

Documentation & Actions

Initiating release to– Literature Library

Documentation – Now on Seismic

Migration guide
Tech Specification Draft – 140MT
Tech Specification Draft – 140UT
Drawings, 3D stp files (Main devices)
Installation Instructions
Product Presentation
Migration letter
FAQ Document
140M 140MT Comparison Overview
Combination SCCR Specification Draft – in Tech Spec

Seismic link: [140M to 140MT Pre-Launch Migration Information](#)

Others

Website update – 16 August
SCCR tool updates (Type F) – 30 Aug
ProposalWorks™ – 30 Aug
IDEA Update – 16 Aug

Bulletin 140M to 140MT Motor Protection Circuit Breakers

Pre-Launch Migration Information

Overview

With the launch of the new 140MT Motor Protection Circuit Breaker and 140UT Molded Case Circuit Breaker by mid of August 2021, Rockwell Automation will announce the discontinuation of the existing 140M (C- and D-frame) and 140U (D-frame) Products with short migration time line (Discontinuation date of ~March 2022)

The new 140MT-C, D frame & 140UT-D replaces the 140M-C,D Frames & 140U-D that is being discontinued. With the introduction of the new 140MT C & D frame MPCB and 140UT-D MCCB, we can serve customer applications that were previously served by the bulletin 140M & 140U-D. The balance of the 140M that is F frame up to 45A, we will continue to serve our customers with existing product line.



140MT and 140UT

- 140MT-C frame is up to 32A and 140MT-D frame is extending current range up to 40A
- 140UT are very compact UL 489 and IEC 60947-2 MCCB up to 40A
- Higher short circuit ratings and application coverage (tap conductor protection and Type E ratings) for 140MT-D
- Improved thermal performance compared to existing product line (Lower heat loss)
- Different product variants (MCP, High inrush version, D9V for application at output of Drives) are covered by single frame size D
- Lockable knob and anti-tamper shield as standard offering for 140MT-D
- Connective modules and Combination SCCR tested with 100-F, 100-T



**Rockwell
Automation**

expanding **human possibility**[®]



www.rockwellautomation.com