

**CONTROL VALVE BODY REPLACEMENT...**

**CONTROL VALVE BODY REPLACEMENT (AUTOMATIC TRANSMISSION - 6T30/6T40/6T45/6T50)  
Control Valve Body Replacement**

Document ID#  
2165579

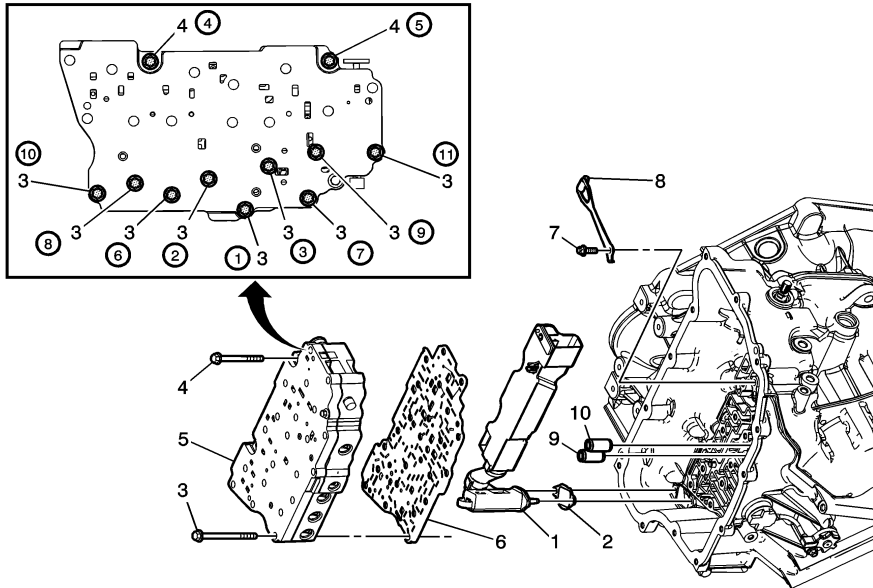

**Control Valve Body Replacement**

Callout	Component Name
<p><b>Preliminary Procedures</b> Remove the control solenoid valve and the transmission control module assembly. Refer to <a href="#">Control Solenoid Valve and Transmission Control Module Assembly Replacement</a>.</p>	
1	Fluid Level Control Valve
2	Fluid Level Control Valve Gasket <b>Procedure</b> DISCARD the gasket. Use a NEW gasket only.
3	Control Valve Body Bolt M6 x 60 (Qty: 9) <b>Caution:</b> Refer to <a href="#">Fastener Caution</a> . <b>Procedure</b> Tighten in specified sequence. <b>Tighten</b> 12 (106 lb in)
4	Control Valve Body Bolt M6 x 53 (Qty: 2) <b>Procedure</b> Tighten in specified sequence. <b>Tighten</b> 12 (106 lb in)

Callout	Component Name
5	Control Valve Body Assembly <b>Procedure</b> 1. After repairs, refer to <a href="#">Control Module References</a> for programming and set up procedures. 2. Perform the transmission adaptive values learn. Refer to <a href="#">Transmission Adaptive Values Learn</a> .
6	Control Valve Body Spacer Plate Assembly
7	Manual Shaft Detent Spring Bolt M6 x 16 (Qty: 1) <b>Tighten</b> 12 (106 lb in)
8	Manual Shaft Detent Lever Spring Assembly
9	1-2-3-4 Clutch Fluid Passage Seal <b>Procedure</b> DISCARD the seal. Use a seal NEW seal only.
10	Low/Reverse Clutch Fluid Passage Seal <b>Procedure</b> DISCARD the seal. Use a seal NEW seal only.

© 2014 General Motors. All rights reserved.

Portions of materials contained herein are sourced from General Motors Inc., Co.

Copyright 2007 - 2014 Service Repair Solutions, Inc.