

ABERNETHY & SPENCER SCAVENGER HUNT

Don't forget to share your adventure with #abernethyspencer on social media



Stop 1: Houseplant, Tropical Plants & Succulent Greenhouse

You're standing in a greenhouse with two stories - and both are worth telling.

The original greenhouse on this site was a Lord & Burnham, installed in 1949 by the Gregg family. It grew spring flowers and chrysanthemums. Pansies were transplanted into baskets in the attached white "Packing Building" and shipped across the country.

The structure you're in now? It originally lived at Blue Mount Nursery and was replanted here piece by piece in 2024 after their closure.



Scavenger Hunt: *There is a tall cactus in the back corner of the greenhouse. What type of cactus is it?* _____



Stop 2: Meet the Flock

Head over to the bird house and say a friendly "Hi" to our five rescued parrots - Juliet, Lola, Sunshine, Norman and Maxi! Each one has their own personality- some love to chat while others prefer to show off their best dance moves!



Scavenger Hunt: *What year was Norman born?* _____



Stop 3: 12 Perennial Houses

Wander through the 12 perennial houses, where each plant returns to bloom year after year in the garden's yearly show. When you reach the bottom corner of Perennial House P12, be sure to stop and read an article from the Blue Ridge Herald, dated May 13, 1948.



Scavenger Hunt: *How many pansies did Hill Top Garden grow in 1948?* _____



Stop 4: Arlington Experimental Greenhouses

Before they found a home in Lincoln, VA, these two greenhouses stood where the Pentagon sits today!

In the early 1940s, the nursery's founders relocated three greenhouses from the Arlington Experimental Farm to what was then known as Hill Top Gardens. One greenhouse was removed by the Moscarillo's in the early 1980's to make space for what is now the Big Greenhouse.

Step inside and find the metal cranks in the center-these were used to open the rooftop vents by hand. Until the 2025 renovation, they were still in use! Today, those same vents open and close automatically, keeping the environment just right for plants.



Scavenger Hunt: *Over the years, these greenhouses have been used to grow:* _____



Stop 5: Holmes Gregg Native Walking Trail & Tree Yard

Stroll along a peaceful native walking trail loop that encircles 20 rows of trees, honoring Holmes Gregg's love for this land. Listen for birds, breathe in fresh air, and connect with nature.



Scavenger Hunt: *What is the first tree listed on the sign of tree row T5:* _____



Stop 6: Native Perennial Houses

The buzz of the bees and the beauty of native blooms fill these houses- designed with both pollinators and garden lovers in mind!

In 2025, five Native Perennial Houses were added to showcase native perennials that are not only beautiful but vital to the ecosystem. Native plants are specially adapted to local conditions, help maintain soil fertility, reduce erosion, and provide food and shelter for native insects.



Scavenger Hunt: *The native house with 3 gables (N1-N3) is home to sun or shade loving Native Perennials?* _____



Stop 7: Glassroom

Not your average greenhouse! The Glassroom is a bright and beautiful space where friends can gather, learn and grow together. Once part of the greenhouse at Blue Mount Nursery, this greenhouse now serves as a welcoming space for gardening classes and private gatherings with fellow plant lovers and friends.



Scavenger Hunt: *There is a large planter in the Glassroom, what plant is planted in here?* _____



Stop 8: “Big Greenhouse”

Abernethy & Spencer began in 1925 as a simple vegetable stand called Hill Top Garden, founded by E.B. Gregg and his son Holmes Gregg.

Step into the back of the Big Greenhouse, and you’ll find some of the same vegetables that helped the nursery’s roots grow 100 years ago.

The original Big Greenhouse was added by the Moscarillo family in the early 1980s. It stood strong for decades until 2016, when it collapsed under heavy snow. It was rebuilt soon after, and the roof was replaced in 2025, continuing a legacy of growth and renewal.

Today, you shop for your favorite annuals, herbs and vegetables in this space, but it also serves as our Production Greenhouse - where all the magic happens! Before you exit out the front doors, you’ll see where we grow, prep, and care for plants before they’re distributed throughout the property.



Scavenger Hunt: *What vegetable would you find on table 13 Left?* _____



Stop 9: Shrub Rows & Ball and Burlap Trees

Browse the rows of shrubs and trees - tall and small, each one waiting to find its perfect place in your landscape.

From evergreens that stay green year-round, to roses bursting with color, and fruit trees and shrubs offering tasty harvests - there’s something here for every garden dream. Some plants provide privacy, others beauty, and a few even create the perfect leafy hideaway.



Scavenger Hunt: *What is the first shrub listed on Shrub row S4:* _____



Stop 10: Lola’s Coffee Cart

Stop by Lola’s Coffee Cart for a Norman Mint Tea or a Lola’s Chai. Certified Bird-Friendly by the Smithsonian means this coffee is grown under shade trees that provide critical habitat for migratory birds. It’s also 100% organic and sustainably sourced - so every cup you sip supports healthier ecosystems.



Scavenger Hunt: *What does Lola say?* _____



Final Stop 11: The Conservatory

Step into a storybook scene at the Tea Party Fountain, surrounded by lush tropical blooms and shelves of thoughtful gifts for your favorite gardener.

This enchanting greenhouse has quite a history - it originally stood atop a swimming pool on a private estate in The Plains, Virginia before being moved to Hill Top Gardens in the early 1950s. In 2025, a major renovation restored this unique and charming space, preserving its legacy while adding new life to a timeless structure.



Scavenger Hunt: *Who is watching the Mad Hatter and the White Rabbit at the tea party?* _____

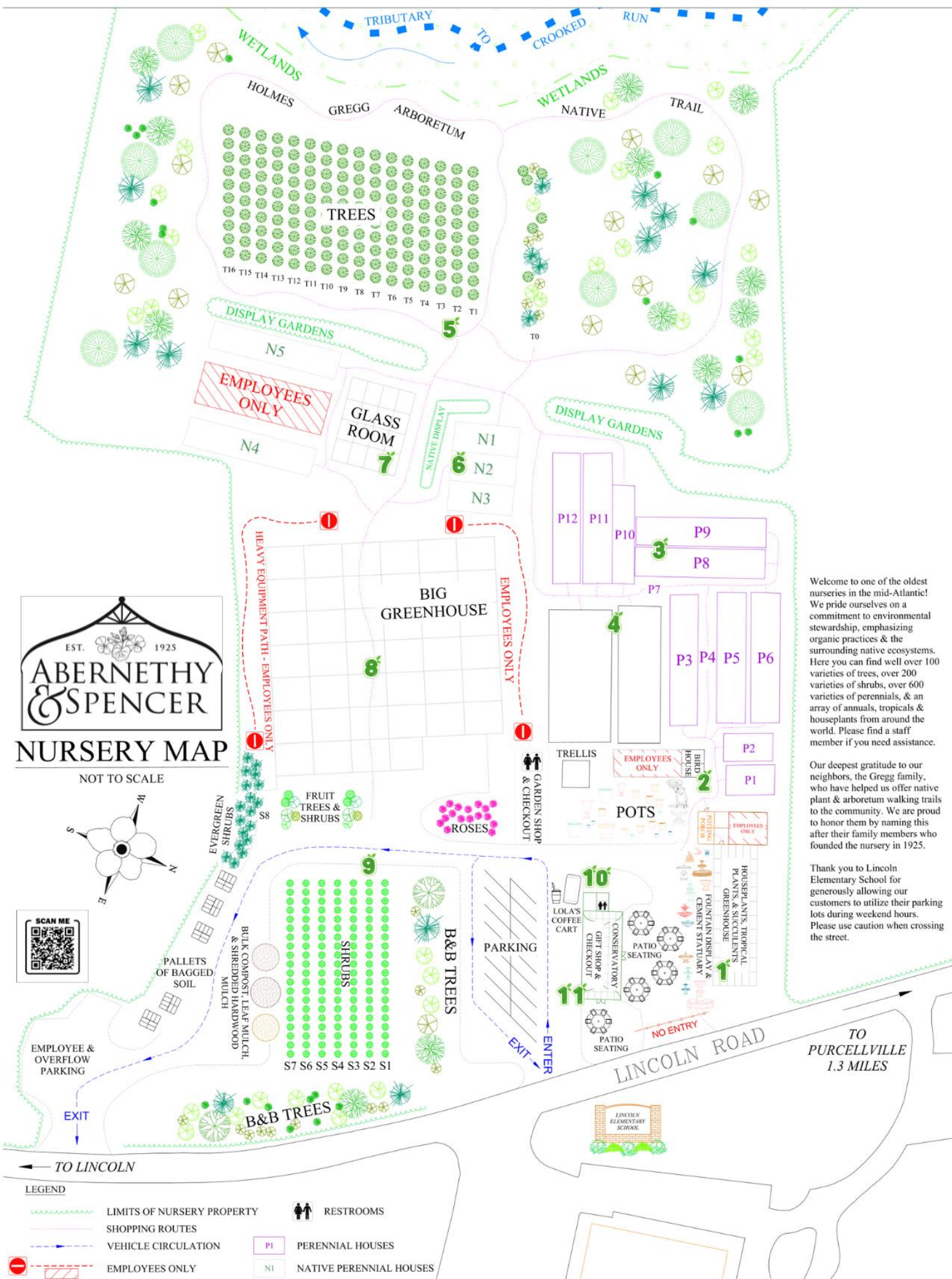

Welcome to one of the oldest nurseries in the mid-Atlantic! We pride ourselves on a commitment to environmental stewardship, emphasizing organic practices & the surrounding native ecosystems. Here you can find well over 100 varieties of trees, over 200 varieties of shrubs, over 600 varieties of perennials, & an array of annuals, tropicals & houseplants from around the world. Please find a staff member if you need assistance.

Our deepest gratitude to our neighbors, the Gregg family, who have helped us offer native plant & arboretum walking trails to the community. We are proud to honor them by naming this after their family members who founded the nursery in 1925.

Thank you to Lincoln Elementary School for generously allowing our customers to utilize their parking lots during weekend hours. Please use caution when crossing the street.