

1

Groundplan

Scale: 1/4" = 1'-0"

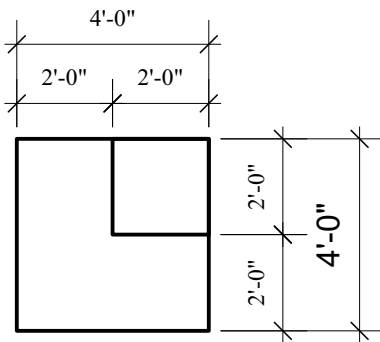

1

Side Elevation

Scale: 1/4" = 1'-0"

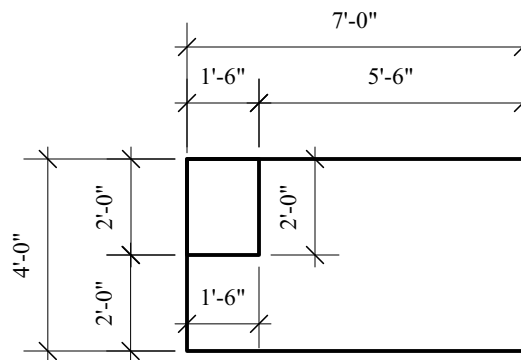

1

Front Elevation

Scale: 1/4" = 1'-0"

This drawing is confidential. The reproduction or use of ideas, arrangements, designs, and plans are prohibited without written consent of the designer. Written dimensions will always override scale should a conflict arise. Responsibility falls solely on the vendors to notify the designer of any discrepancies between this drawing and actual dimensions. This drawing represents concepts and suggestions only. The design team is not responsible nor held liable for the structural, mechanical or electrical execution of this drawing. Any structural components within this drawing must be approved by a qualified engineer before installation begins. Furthermore any other work done is to be performed by qualified personnel only. Equipment and installation must conform to all local and federal codes and fire safety regulations.



The University of Alabama
Dept of Theatre and Dance

Allen Bales Theatre

Benjo Verge

Drafter

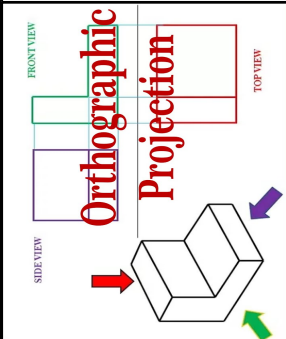

Director
Matt Reynolds

Technical Director
Matt Stratton

Props Master
Teila Vochatzer

Project #3

Plate: 1/1

Scale: 1/4"=1'-0"

Date: 02-09-2022