

FOREST COUNTY FORESTRY DEPARTMENT
200 EAST MADISON STREET
CRANDON, WI 54520
715-478-3475

TO: PROSPECTIVE BIDDERS OF FOREST COUNTY TIMBER SALES

SUBJECT: 2020 TIMBER SALE OFFERINGS

BID DEADLINE: 8/10/2020

9:00 AM – Forestry Department Office Courthouse – Crandon, WI

FORESTRY MEETING: 8/10/2020

5:30 PM – County Board Room – Courthouse – Crandon, WI

Enclosed are timber sale maps of this year's sales, with a timber sale bid form listing the minimum bids for each timber sale.

I am including one timber sale bid form with each timber sale map. Separate bid forms are necessary for each timber sale. Please compare the tract number at the top of each map with the tract number at the top of the timber sale bid form to be sure you are bidding on the correct timber sale. Your bid must meet or exceed the total timber sale value that was advertised. **Bid bonds are not required.**

Please list the tract number of the sale on your envelope when submitting bids. All timber sale contracts will be three years in length. The Forestry Committee may grant a one-year contract extension with a 10% stumpage price increase with prior approval. No contract will exceed four years in length. Failure to sign the timber sale contract will prohibit you from bidding on future timber sales. If you are the successful bidder, you will be required to pay a performance bond of 25% of the total bid price prior to contract signing. You will also be required to provide copies of your SFI training and liability/workman's compensation certificates prior to signing the timber sale contract. **Contracts will not be issued without the 25% performance bond, SFI training certificate and liability/workman's compensation certificate, submitted prior to signing.**

NOTICE: SFI and Insurance certificates must be maintained through the duration of the contract. At least one person working on the sale must be SFI Certified. Please note the payment method for each sale. Lump Sum sales require payment in full prior to starting the sale, or arrangements must be made with the seller to make block payments. Sales using the Mill Scale Ticket System will require the Purchaser to have load tickets sent directly from the receiving mill to the Seller within (10) days. Late load tickets will be invoiced by the Seller at 20 cords per load. *****Please note: Purchaser will have 15 days to pay stumpage invoices from date of billing (previous contracts allowed 30 days).**

****IMPORTANT**** To allow Forestry Department staff time to complete reference checks on timber sale bidders, all timber sale bids will be opened at 9:00 a.m. on 8/10/2020. The opening of bids will be held in the Forestry Department Office on the second floor of the Courthouse in Crandon at 9:00 a.m. The bid opening will have County staff present, a Forestry and Recreation Committee member, a DNR representative and any member of the public wishing to attend the opening and recording of bids. No bids will be awarded at this time. All timber sale bids will be summarized and presented to the Forestry and Recreation Committee on 8/10/2020 at 5:30 p.m. in the County Board Room of the Courthouse in Crandon. At this time, the Forestry and Recreation Committee will review and award timber sale contracts to successful bidders.

All Forest County timber sale maps, bid forms and bid results are also posted online by logging onto www.forestcountywi.com. Click on "2020 Spring Bid Packet".

Sincerely,



Carly DeVet
County Forest Administrator

Mapped by Katie Schallock 7/06/2020

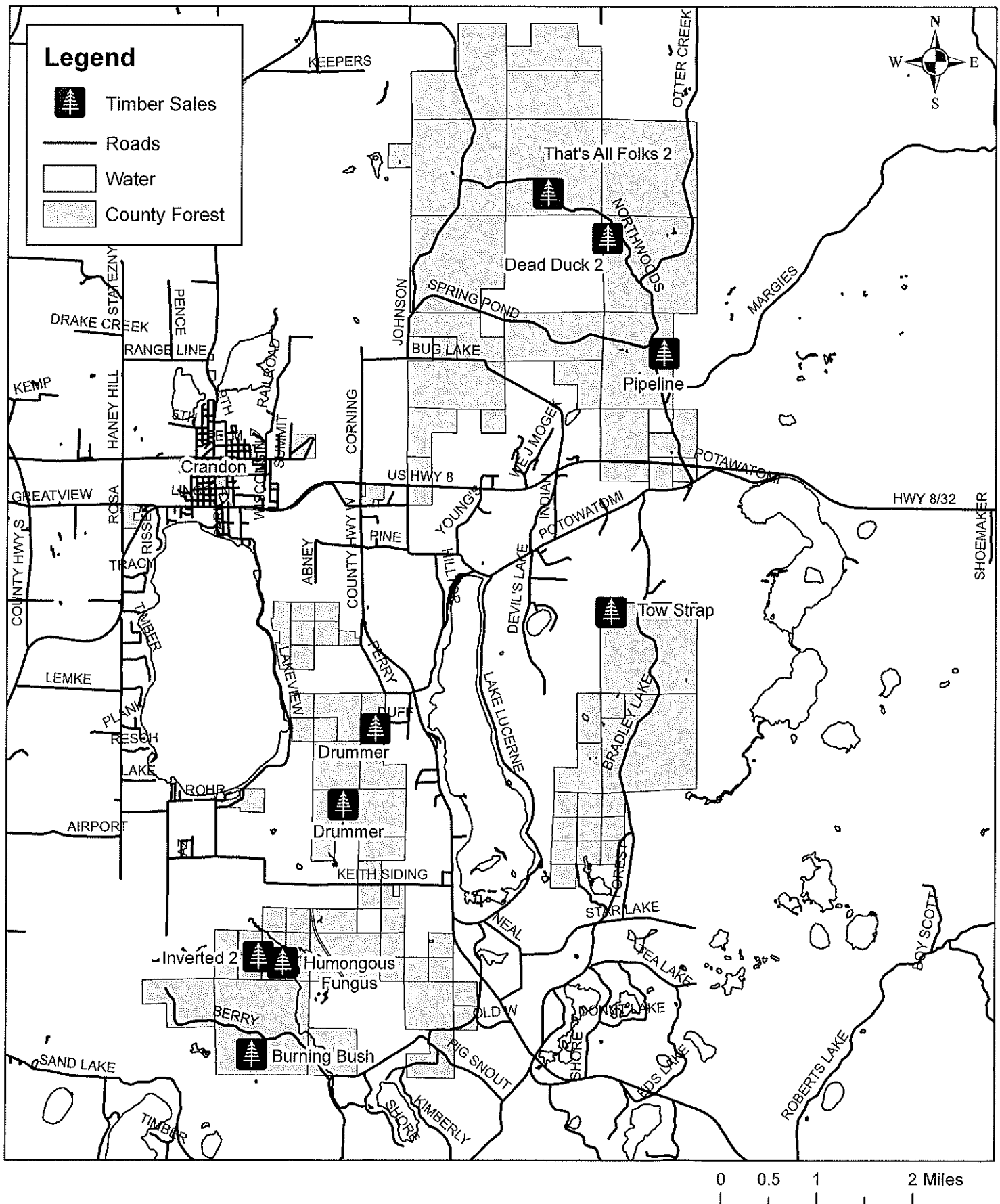

**Forest County Forest
Dead Duck 2 Timber Sale – Tract 1-20**

Parts of SWSW, Sec.1, NENE, Sec. 11, NW1/4, NE1/4, NESE, NWSE, NESW Sec. 12, T.35N. R.13.E.

**Sale area 42 acres
(Mapped by Dan Peters 1/18/18)**

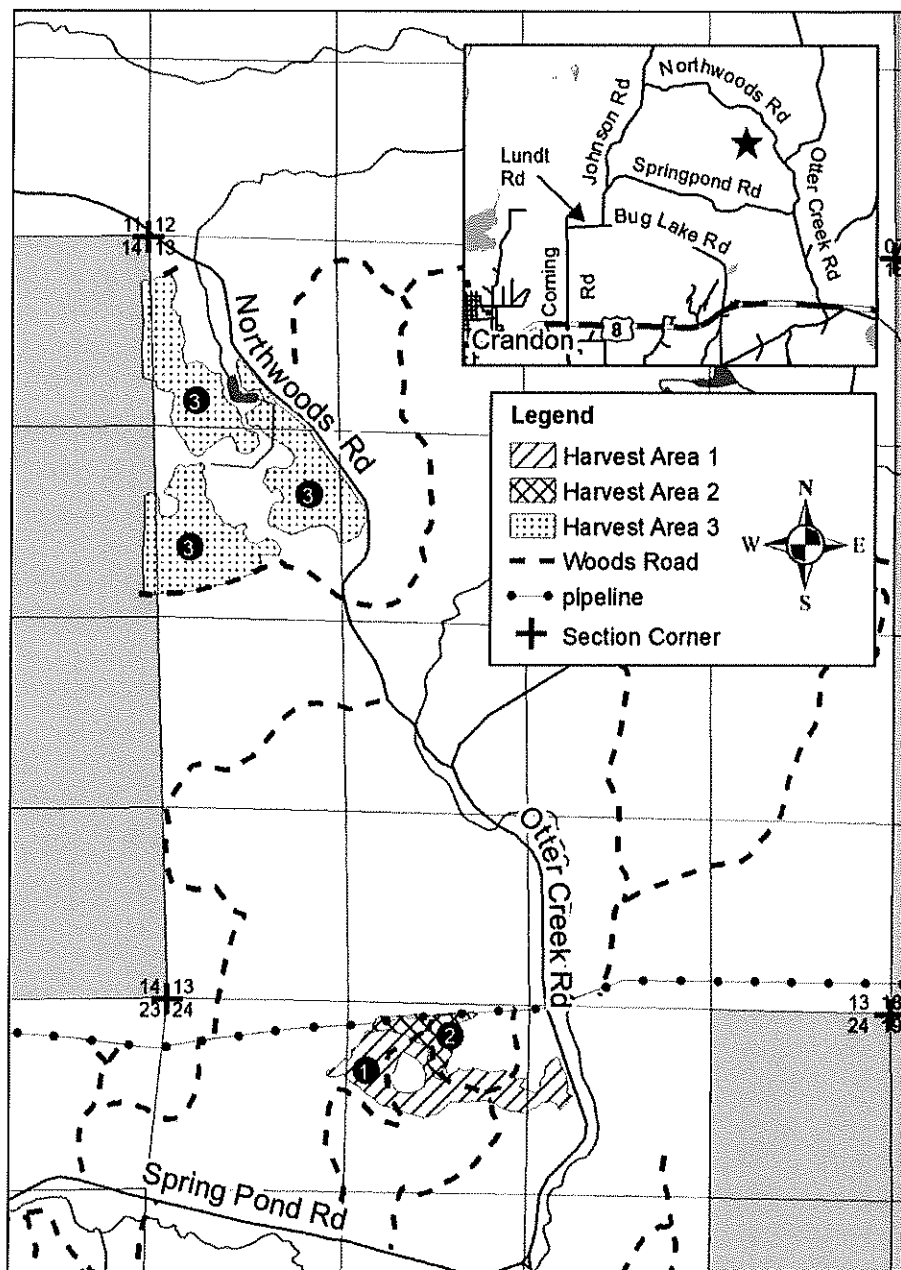

Harvest Specifications:

Block 1 – Northern Hardwood, 10 acres

- Cut all trees marked with orange paint. In addition, harvest all merchantable aspen, balsam fir, white birch and ironwood.

Block 2 – Aspen, 3 acres

- Cut all trees 2 inches and larger, **EXCEPT** red oak, white pine, cedar, hemlock and trees marked with green paint.

Block 3 – Hardwood, 29 acres

- Cut all trees 2 inches and larger, **EXCEPT** red oak, yellow birch, white pine, cedar, hemlock and trees marked with green paint.

All Blocks

- No cutting, skidding or trucking will be allowed during spring break up or wet soil conditions.
- No tree length or pole skidding is allowed without prior approval.
- All wood will be sorted by species and categories as listed in table below.
- All species and products shall be cut concurrently.
- Reasonable care shall be used to avoid unnecessary damage to reserve trees.
- **Do not cut dead trees unless marked with orange paint or, if they pose a safety hazard.**
- No equipment use or slash disposal in wetlands.
- Any gates, rocks, berms or other barriers removed for access will be repaired or replaced.
- All slash and logging debris must be lopped to within 2 feet of the ground and pulled back 25 feet from road.

Sale Information:

- Pulp & Bolts - Mill Ticket
- Saw Logs – Field Scale
- Other Products – Determined by County
- Seasonal Restrictions:
 - Frozen or Dry Ground
 - March 15 – July 1
- Completion Date: June 1, 2023
- Notify County in advance of starting
- Forestry Department: 715-478-3475

ESTIMATED VOLUME

Pulpwood / Bolts		Sawlogs	
Species	Tons (Cords)	Species	BDFt
Mixed Hardwood	1,500 (625)	Mixed Hardwood	15,500
Aspen	315 (140)	Sugar Maple	13,500
Basswood	100 (52)	Basswood	10,000
Balsam Fir	20 (9)		
White Spruce	10 (5)		
Total	1,595 (831)	Total	39,000

FOREST COUNTY FOREST TIMBER SALE BID SHEET

Dead Duck 2 Tract 1-20

Expires 6-1-2023	Mill Scale Pulp & Bolts	All sawlogs field scaled	
Species/Product	Units	Bid/ Unit	Species Total
Mixed Hardwood Pulp & Bolts	1,500 Tons		
Aspen Pulp & Bolts	315 Tons		
Basswood Pulp & Bolts	100 Tons		
Balsam Fir Pulp & Bolts	20 Tons		
White Spruce Pulp & Bolts	10 Tons		
Mixed Hardwood Sawlogs	15.5 MBF		
Sugar Maple Sawlogs	13.5 MBF		
Basswood Sawlogs	10 MBF		
"MINIMUM BID	\$19,264.00	TOTAL	

All products must have a bid price.

Bids need to be per ton.

Bid sheets that are incomplete or have errors which make intent of bid unclear may be rejected. All products must have a bid price.

Bid bonds will be waived for 2020. If you are the successful bidder, you will be required to pay a performance bond of 25% of the total bid price at contract signing. You will also be required to provide copies of your SFI training and liability/workman's compensation certificates prior to signing the timber sale contract. At least one (1) person working on the sale must be SFI Certified. **Contracts will not be issued without the 25% performance bond, SFI training certificate and liability/workman's compensation certificate.**

The Seller has the right to reject any and all bids. Volumes are estimates. All bidders are encouraged to examine sale to verify volumes and quality of all timber. Bidders should be prepared to submit a performance bond and references upon request.

I hereby submit the above bid for the above described timber sale.

Bidders Name (Please print)

Address

City, State, Zip Code

Bidders signature

Date

Forest County Forest
That's All Folks 2 Timber Sale – Tract 2-20
Parts of NENW, SENW, NWNE, SWNE, NWSE, NESE Sec. 11, T.36N. R.13.E.
Sale area 26 acres
(Mapped by Dan Peters 3/10/16)

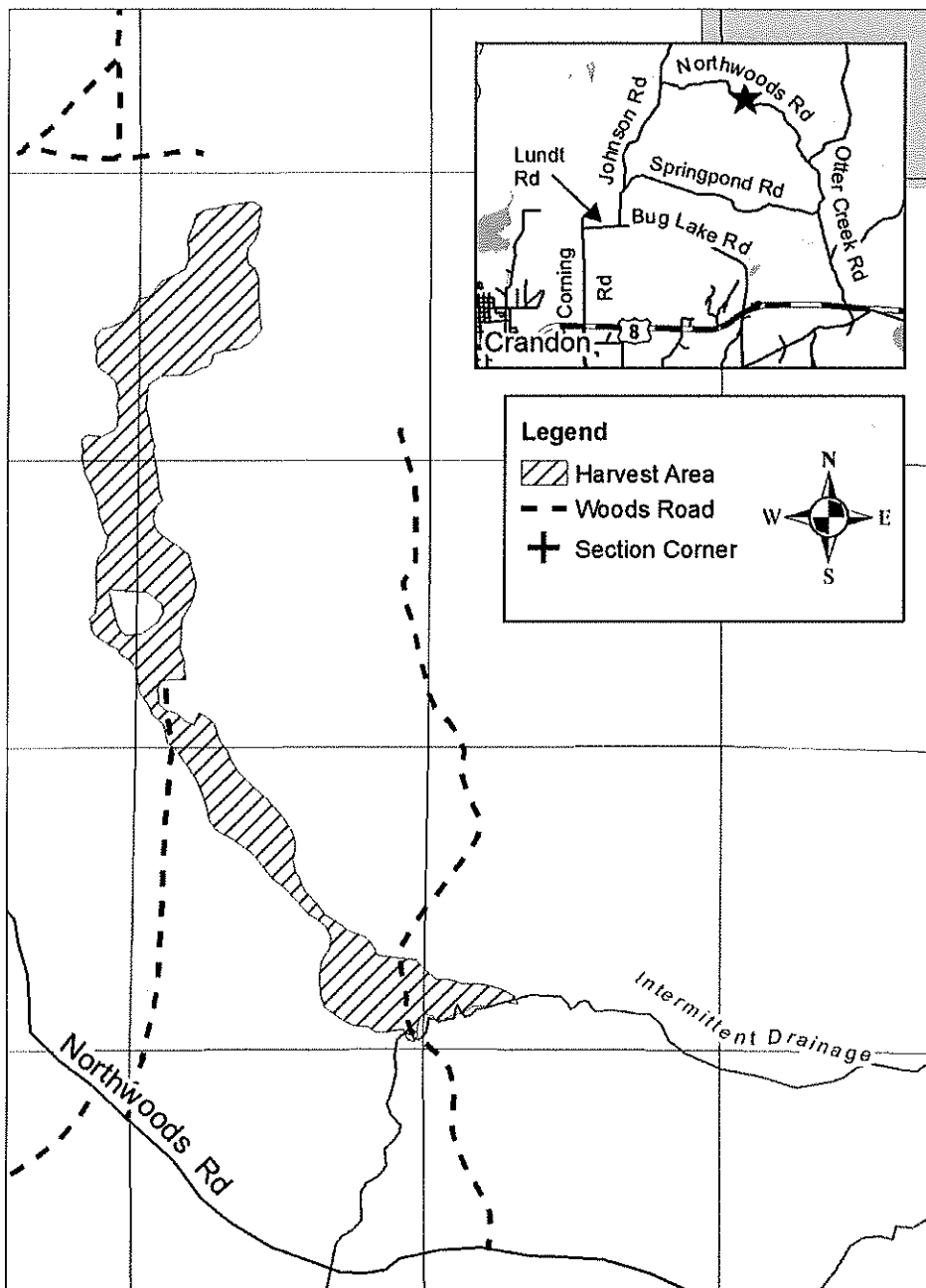

Harvest Specifications:

- Cut all trees 2 inches and larger, **EXCEPT** red oak, white pine, cedar, hemlock, and trees marked with green paint.
- No cutting, skidding or trucking will be allowed during spring break up or wet soil conditions.
- No tree length or pole skidding is allowed without prior approval.
- All wood will be sorted by species and categories as listed in table below.
- All species and products shall be cut concurrently.
- Reasonable care shall be used to avoid unnecessary damage to residual trees and regeneration.
- Do not cut dead trees unless marked with orange paint or, if they pose a safety hazard.
- No equipment use or slash disposal in wetlands.
- Any gates, rocks, berms or other barriers removed for access will be repaired or replaced.
- All slash and logging debris must be lopped to within 2 feet of the ground and pulled back 25 feet from roads
- Do not cut trees marked with green paint.

Sale Information:

- Pulp & Bolts - Mill Ticket
- Saw Logs – Field Scale
- Other Products – Determined by County
- Seasonal Restrictions:
 - Winter only
 - March 15 – July 1
- Completion Date: June 1, 2023
- Notify County in advance of starting
- Forestry Department: 715-478-3475

ESTIMATED VOLUME

Pulpwood / Bolts		Sawlogs	
Species	Tons (Cords)	Species	BDFT
Aspen	1,300 (578)	Sugar Maple	5,000
Mixed Hardwood	280 (117)	Mixed Hardwood	5,000
Basswood	40 (21)	Basswood	1,000
Balsam Fir	20 (9)		
Black Spruce	10 (5)		
Total	1,650 (730)	Total	11,000

FOREST COUNTY FOREST TIMBER SALE BID SHEET

That's All Folks 2 Tract 2-20

Expires 6-1-2023	Mill Scale Pulp & Bolts	All sawlogs field scaled	
Species/Product	Units	Bid/ Unit	Species Total
Aspen Pulp & Bolts	1300 Tons		
Mixed Hardwoods Pulp & Bolts	280 Tons		
Basswood Pulp & Bolts	40 Tons		
Balsam Fir Pulp & Bolts	20 Tons		
Black Spruce Pulp & Bolts	10 Tons		
Sugar Maple Sawlogs	5.2 MBF		
Mixed Hardwood Sawlogs	4.5 MBF		
Basswood Sawlogs	1.4 MBF		
"MINIMUM BID	\$16,580.00	TOTAL	

All products must have a bid price.

Bids need to be per ton.

Bid sheets that are incomplete or have errors which make intent of bid unclear may be rejected. All products must have a bid price.

Bid bonds will be waived for 2020. If you are the successful bidder, you will be required to pay a performance bond of 25% of the total bid price at contract signing. You will also be required to provide copies of your SFI training and liability/workman's compensation certificates prior to signing the timber sale contract. At least one (1) person working on the sale must be SFI Certified. **Contracts will not be issued without the 25% performance bond, SFI training certificate and liability/workman's compensation certificate.**

The Seller has the right to reject any and all bids. Volumes are estimates. All bidders are encouraged to examine sale to verify volumes and quality of all timber. Bidders should be prepared to submit a performance bond and references upon request.

I hereby submit the above bid for the above described timber sale.

Bidders Name (Please print)

Address

City, State, Zip Code

Bidders signature

Date

Forest County Forest
Inverted 2 Timber Sale – Tract 3-20
Parts of SW1/4, SWSE, NWSE Sec. 20, T.35N. R.13.E.
Sale area 108 acres
(Mapped by Katie Schallock 07/20/20)

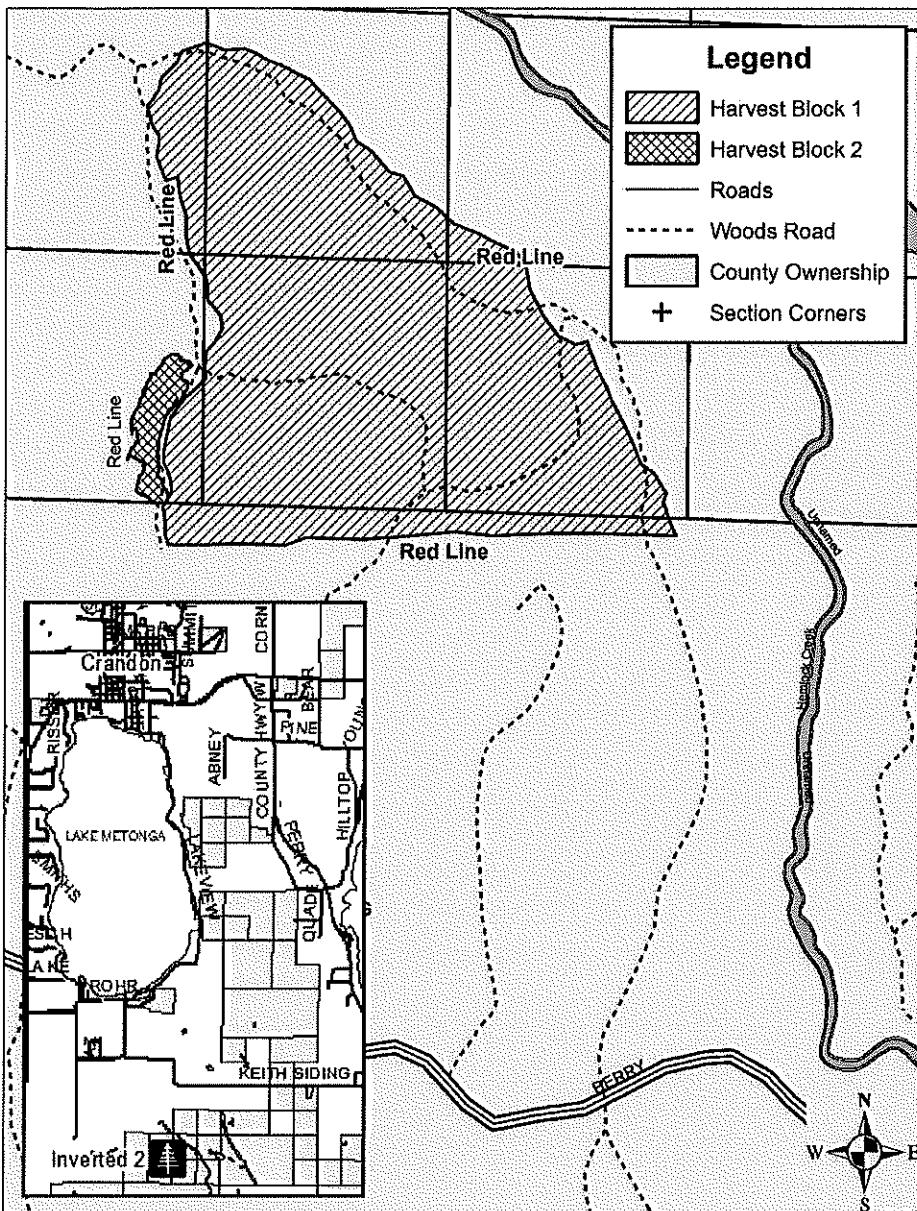

Harvest Specifications:

- **Block 1 – Northern Hardwood, 105 acres**
 - Cut all trees marked with orange paint. In addition, harvest all merchantable aspen, balsam fir, white birch, and ironwood.
- **Block 2 – Aspen, 3 Acres**
 - Cut all trees 2 inches and larger, EXCEPT red oak, white pine, cedar, hemlock, yellow birch and trees marked with green paint.
- No cutting, skidding or trucking will be allowed during spring break up or wet soil conditions.
- No tree length or pole skidding is allowed without prior approval.
- All wood will be sorted by species and categories as listed in table below.
- All species and products shall be cut concurrently.
- Reasonable care shall be used to avoid unnecessary damage to residual trees and regeneration.
- Do not cut dead trees unless marked with orange paint or, if they pose a safety hazard.
- No equipment use or slash disposal in wetlands.
- Any gates, rocks, berms or other barriers removed for access will be repaired or replaced.
- All slash and logging debris must be lopped to within 2 feet of the ground and pulled back 25 feet from roads
- Do not cut trees marked with green paint.

Sale Information:

- Pulp & Bolts - Mill Ticket
- Saw Logs – Field Scale
- Other Products – Determined by County
- Seasonal Restrictions:
 - Frozen or Dry Ground
 - March 15 – July 1
- Completion Date: June 1, 2023
- Notify County in advance of starting
- Forestry Department: 715-478-3475

ESTIMATED VOLUME

Pulpwood / Bolts		Sawlogs	
Species	Tons (Cords)	Species	BDFT
Mixed Hardwood	1,550 (646)	Basswood	55,000
Basswood	525 (273)	Sugar Maple	50,000
Aspen	10 (4)	Mixed Hardwood	35,000
Balsam Fir	2 (1)		
Total	2,087 (924)	Total	140,000

FOREST COUNTY FOREST TIMBER SALE BID SHEET

Inverted 2 Tract 3-20

Expires 6-1-2023	Mill Scale Pulp & Bolts	All sawlogs field scaled	
Species/Product	Units	Bid/ Unit	Species Total
Mixed Hardwood Pulp & Bolts	1,550 Tons		
Basswood Pulp & Bolts	525 Tons		
Aspen Pulp & Bolts	10 Tons		
Balsam Fir Pulp & Bolts	2 Tons		
Basswood Sawlogs	55 MBF		
Sugar Maple Sawlogs	50 MBF		
Mixed Hardwood Sawlogs	35 MBF		
"MINIMUM BID	\$37,829.40	TOTAL	

All products must have a bid price.

Bids need to be per ton.

Bid sheets that are incomplete or have errors which make intent of bid unclear may be rejected. All products must have a bid price.

Bid bonds will be waived for 2020. If you are the successful bidder, you will be required to pay a performance bond of 25% of the total bid price at contract signing. You will also be required to provide copies of your SFI training and liability/workman's compensation certificates prior to signing the timber sale contract. At least one (1) person working on the sale must be SFI Certified. **Contracts will not be issued without the 25% performance bond, SFI training certificate and liability/workman's compensation certificate.**

The Seller has the right to reject any and all bids. Volumes are estimates. All bidders are encouraged to examine sale to verify volumes and quality of all timber. Bidders should be prepared to submit a performance bond and references upon request.

I hereby submit the above bid for the above described timber sale.

Bidders Name (Please print)

Address

City, State, Zip Code

Bidders signature

Date

Forest County Forest
Pipeline Timber Sale – Tract 4-20
Parts of the SW ¼ SE ¼ Sec. 13, W ½ E ½ Sec. 24 T.36N. R.13.E.
Sale area 90 acres
(Mapped by Katie Schallock 07/06/20)

Harvest Specifications:

Block 1 – Northern Hardwood, 61 Acres

- Cut all trees marked with orange paint. In addition, harvest all merchantable aspen, balsam fir, white birch, and ironwood.

Block 2 – Aspen, 29 Acres

- Cut all trees 2 inches and larger, **EXCEPT** red oak, white pine, cedar, hemlock, yellow birch and trees marked with green paint.

All Blocks

- No cutting, skidding or trucking will be allowed during spring break up or wet soil conditions.
- No tree length or pole skidding is allowed without prior approval.
- All wood will be sorted by species and categories as listed in table below.
- All species and products shall be cut concurrently.
- Reasonable care shall be used to avoid unnecessary damage to reserve trees.
- **Do not cut dead trees unless marked with orange paint or, if they pose a safety hazard.**
- No equipment use or slash disposal in wetlands.
- Any gates, rocks, berms or other barriers removed for access will be repaired or replaced.
- All slash and logging debris must be lopped to within 2 feet of the ground and pulled back 25 feet from road.

Sale Information:

- Pulp & Bolts - Mill Ticket
- Saw Logs – Field Scale
- Other Products – Determined by County
- Seasonal Restriction:
 - Frozen or Dry Ground
 - March 15 – July 1
- Completion Date: June 1, 2023
- Notify County in advance of starting
- Forestry Department: 715-478-3475

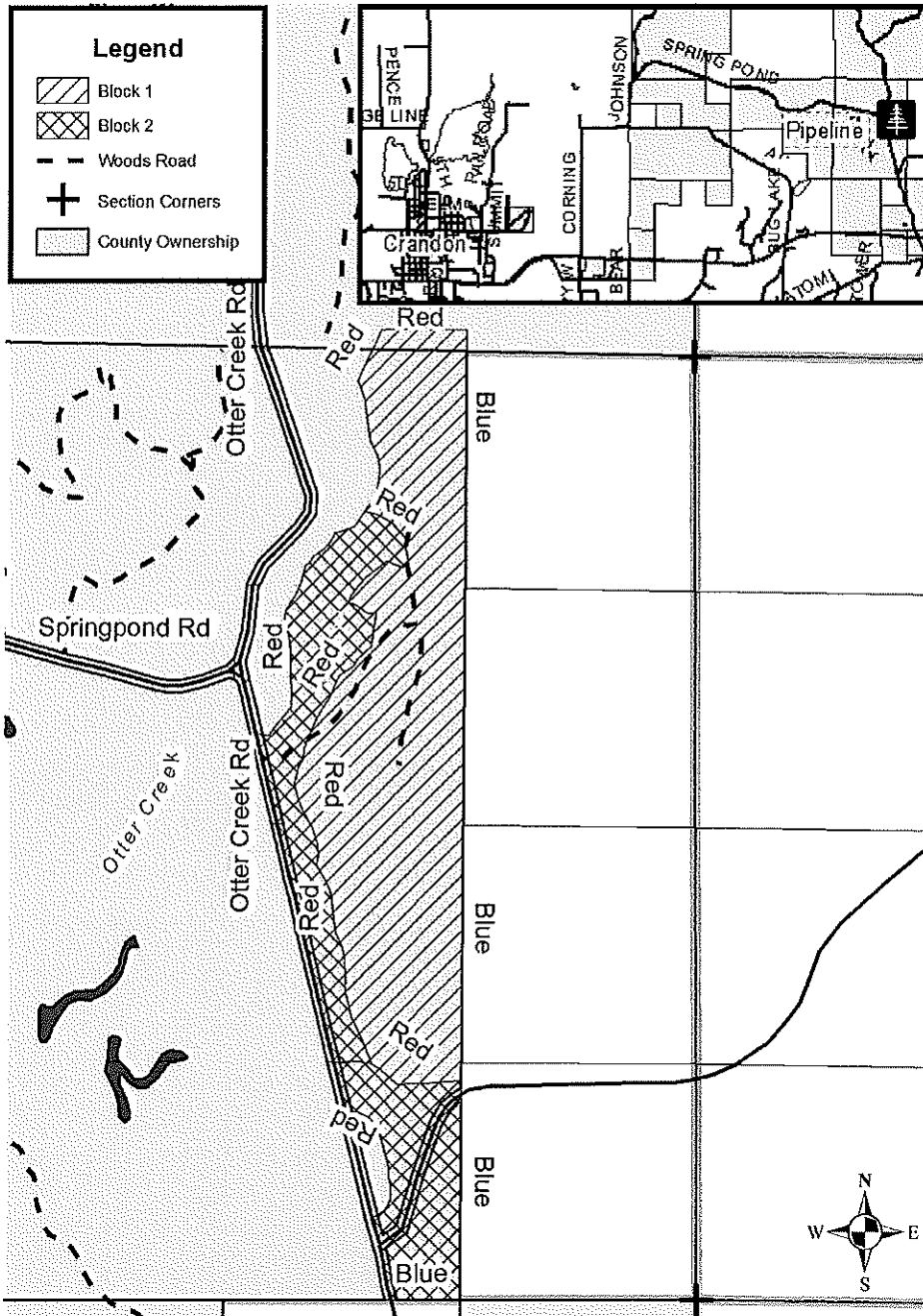

ESTIMATED VOLUME

Pulpwood / Bolts		Sawlogs	
Species	Tons (Cords)	Species	BDFT
Aspen	1,200 (533)	Basswood	40,000
Mixed Hardwood	950 (396)	Sugar Maple	30,000
Basswood	150 (78)	Mixed Hardwoods	20,000
Balsam Fir	80 (38)		
White Spruce	20 (10)		
Total	2,400 (1,055)	Total	90,000

FOREST COUNTY FOREST TIMBER SALE BID SHEET

Pipeline Tract 4-20

Expires 6-1-2023	Mill Scale Pulp & Bolts	All sawlogs field scaled	
Species/Product	Units	Bid/ Unit	Species Total
Aspen Pulp & Bolts	1,200		
Mixed Hardwoods Pulp & Bolts	950		
Basswood Pulp & Bolts	150		
Balsam Fir Pulp & Bolts	80		
Basswood Sawlogs	40 MBF		
Sugar Maple Sawlogs	30 MBF		
Mixed Hardwood Sawlogs	20 MBF		
"MINIMUM BID	\$35,039.00	TOTAL	

All products must have a bid price.

Bids need to be per ton.

Bid sheets that are incomplete or have errors which make intent of bid unclear may be rejected. All products must have a bid price.

Bid bonds will be waived for 2020. If you are the successful bidder, you will be required to pay a performance bond of 25% of the total bid price at contract signing. You will also be required to provide copies of your SFI training and liability/workman's compensation certificates prior to signing the timber sale contract. At least one (1) person working on the sale must be SFI Certified. **Contracts will not be issued without the 25% performance bond, SFI training certificate and liability/workman's compensation certificate.**

The Seller has the right to reject any and all bids. Volumes are estimates. All bidders are encouraged to examine sale to verify volumes and quality of all timber. Bidders should be prepared to submit a performance bond and references upon request.

I hereby submit the above bid for the above described timber sale.

Bidders Name (Please print)

Address

City, State, Zip Code

Bidders signature

Date

Forest County Forest
Burning Bush Timber Sale – Tract 5-20
Parts of the SWNW, SW ¼, W ½ SE Sec. 29, T.35N. R.13.E.
Sale area 123 acres
(Mapped by Katie Schallock 07/06/20)

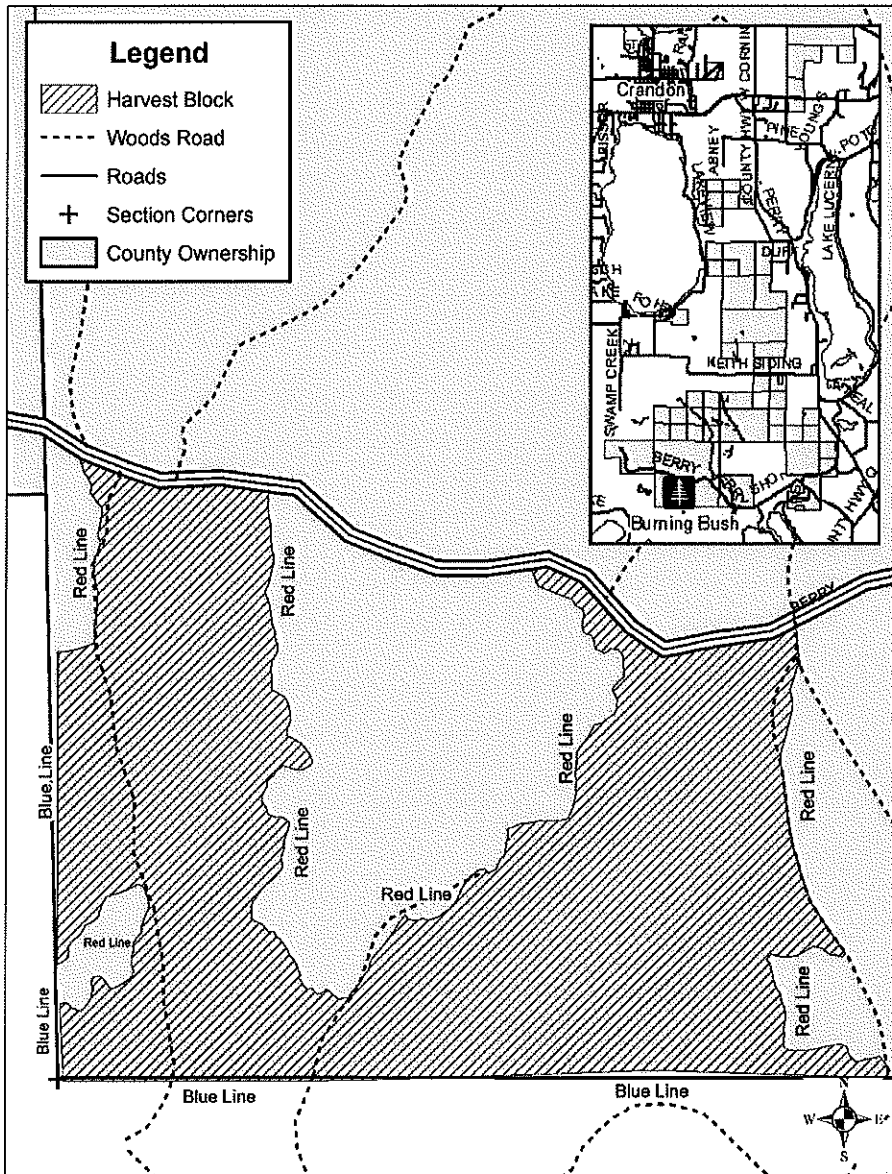

Harvest Specifications:

- Cut all trees marked in orange paint. **In addition, harvest all merchantable aspen, balsam fir, white birch, and ironwood.**
- No cutting, skidding or trucking will be allowed during spring break up or wet soil conditions.
- No tree length or pole skidding is allowed without prior approval.
- All wood will be sorted by species and categories as listed in table below.
- All species and products shall be cut concurrently.
- Reasonable care shall be used to avoid unnecessary damage to reserve trees.
- **Do not cut dead trees unless marked with orange paint or, if they pose a safety hazard.**
- No equipment use or slash disposal in wetlands.
- Any gates, rocks, berms or other barriers removed for access will be repaired or replaced.
- All slash and logging debris must be lopped to within 2 feet of the ground and pulled back 25 feet from road.

Sale Information:

- Pulp & Bolts - Mill Ticket
- Saw Logs – Field Scale
- Other Products – Determined by County
- Seasonal Restrictions: Frozen Ground
- Completion Date: June 1, 2023
- Notify County in advance of starting
- Forestry Department: 715-478-3475

ESTIMATED VOLUME

Pulpwood / Bolts		Sawlogs	
Species	Tons (Cords)	Species	BDFT
Mixed Hardwood	1,100 (458)	Basswood	90,000
Basswood	420 (218)	Sugar Maple	25,000
		White Ash	15,000
		Mixed Hardwood	7,000
		Bur Oak	1,000
Total	1,520 (676)	Total	138,000

FOREST COUNTY FOREST TIMBER SALE BID SHEET

Burning Bush Tract 5-20

Expires 6-1-2023	Mill Scale Pulp & Bolts	All sawlogs field scaled	
Species/Product	Units	Bid/ Unit	Species Total
Mixed Hardwood Pulp & Bolts	1,100 Tons		
Basswood Pulp & Bolts	420 Tons		
Basswood Sawlogs	90 MBF		
Sugar Maple Sawlogs	25 MBF		
White Ash Sawlogs	15 MBF		
Mixed Hardwood Sawlogs	7 MBF		
Bur Oak Sawlogs	1 MBF		
"MINIMUM BID	\$30,737.00	TOTAL	

All products must have a bid price.

Bids need to be per ton.

Bid sheets that are incomplete or have errors which make intent of bid unclear may be rejected. All products must have a bid price.

Bid bonds will be waived for 2020. If you are the successful bidder, you will be required to pay a performance bond of 25% of the total bid price at contract signing. You will also be required to provide copies of your SFI training and liability/workman's compensation certificates prior to signing the timber sale contract. At least one (1) person working on the sale must be SFI Certified. **Contracts will not be issued without the 25% performance bond, SFI training certificate and liability/workman's compensation certificate.**

The Seller has the right to reject any and all bids. Volumes are estimates. All bidders are encouraged to examine sale to verify volumes and quality of all timber. Bidders should be prepared to submit a performance bond and references upon request.

I hereby submit the above bid for the above described timber sale.

Bidders Name (Please print)

Address

City, State, Zip Code

Bidders signature

Date

Forest County Forest
Tow Strap Timber Sale – Tract 6-20
Parts of the NW ¼, Sec. 1, T.35N. R.13.E.
Sale area 62 acres
(Mapped by Katie Schallock 07/06/20)

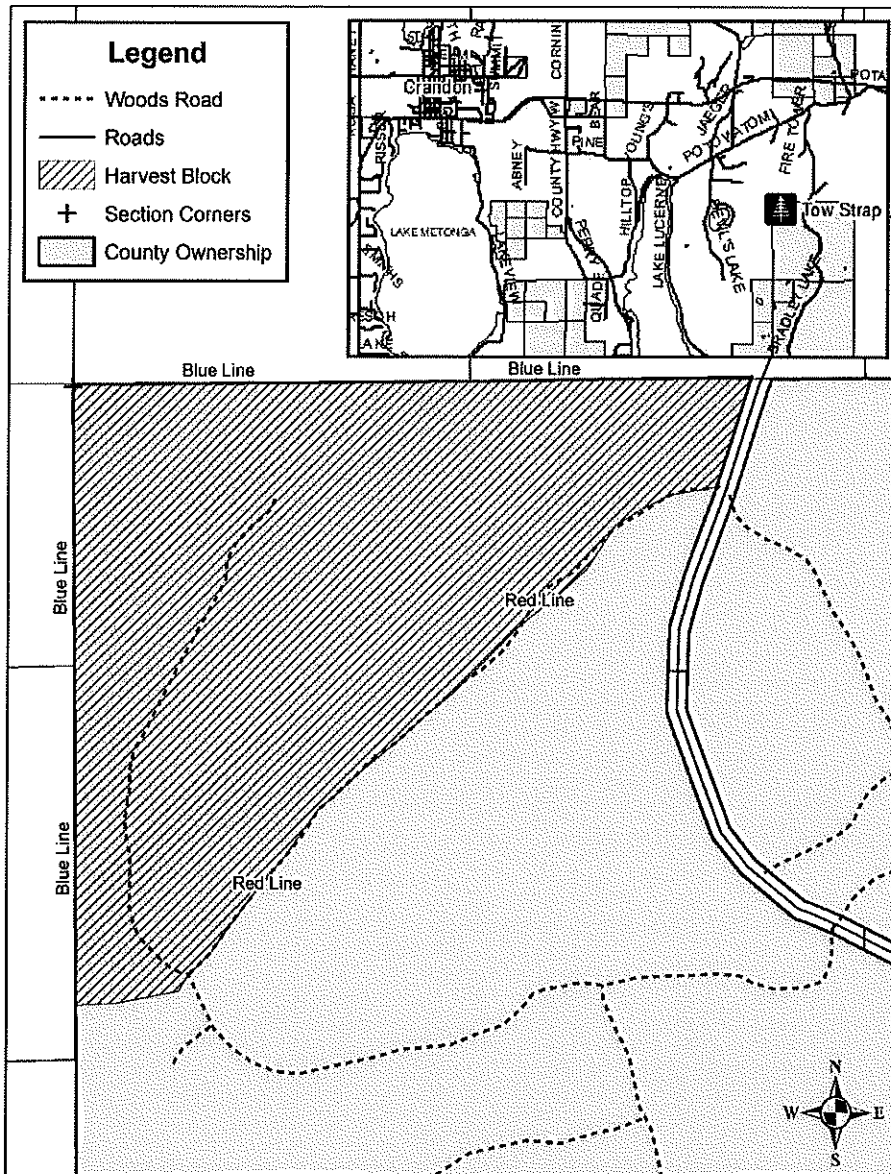

Harvest Specifications:

- Cut all trees marked in orange paint. **In addition, harvest all merchantable aspen, balsam fir, white birch, and ironwood.**
- No cutting, skidding or trucking will be allowed during spring break up or wet soil conditions.
- No tree length or pole skidding is allowed without prior approval.
- All wood will be sorted by species and categories as listed in table below.
- All species and products shall be cut concurrently.
- Reasonable care shall be used to avoid unnecessary damage to reserve trees.
- **Do not cut dead trees unless marked with orange paint or, if they pose a safety hazard.**
- No equipment use or slash disposal in wetlands.
- Any gates, rocks, berms or other barriers removed for access will be repaired or replaced.
- All slash and logging debris must be lopped to within 2 feet of the ground and pulled back 25 feet from road.

Sale Information:

- Pulp & Bolts - Mill Ticket
- Saw Logs – Field Scale
- Other Products – Determined by County
- Seasonal Restriction:
 - Frozen or Dry Ground
 - March 15 – July 1
- Completion Date: June 1, 2023
- Notify County in advance of starting
- Forestry Department: 715-478-3475

ESTIMATED VOLUME

Pulpwood / Bolts		Sawlogs	
Species	Tons (Cords)	Species	BDFT
Mixed Hardwood	480 (200)	Basswood	35,000
Basswood	90 (47)	Sugar Maple	25,000
Aspen	20 (9)	Mixed Hardwood	10,000
Total	590 (256)	Total	70,000

FOREST COUNTY FOREST TIMBER SALE BID SHEET

Tow Strap Tract 6-20

Expires 6-1-2023	Mill Scale Pulp & Bolts	All sawlogs field scaled	
Species/Product	Units	Bid/ Unit	Species Total
Mixed Hardwood Pulp & Bolts	480 Tons		
Basswood Pulp & Bolts	90 Tons		
Aspen Pulp & Bolts	20 Tons		
Basswood Sawlogs	35 MBF		
Sugar Maple Sawlogs	25 MBF		
Mixed Hardwood Sawlogs	10 MBF		
"MINIMUM BID	\$16,197.00	TOTAL	

All products must have a bid price.

Bids need to be per ton.

Bid sheets that are incomplete or have errors which make intent of bid unclear may be rejected. All products must have a bid price.

Bid bonds will be waived for 2020. If you are the successful bidder, you will be required to pay a performance bond of 25% of the total bid price at contract signing. You will also be required to provide copies of your SFI training and liability/workman's compensation certificates prior to signing the timber sale contract. At least one (1) person working on the sale must be SFI Certified. **Contracts will not be issued without the 25% performance bond, SFI training certificate and liability/workman's compensation certificate.**

The Seller has the right to reject any and all bids. Volumes are estimates. All bidders are encouraged to examine sale to verify volumes and quality of all timber. Bidders should be prepared to submit a performance bond and references upon request.

I hereby submit the above bid for the above described timber sale.

Bidders Name (Please print)

Address

City, State, Zip Code

Bidders signature

Date

Forest County Forest
Drummer Timber Sale – Tract 7-20
Parts of the NWNE, NW ¼, Sec. 16, T.35N. R.13.E.
Parts of the N ½ NE, Sec. 29, T.35N. R.13.E.
Sale area 56 acres
(Mapped by Katie Schallock 07/06/20)

Harvest Specifications:

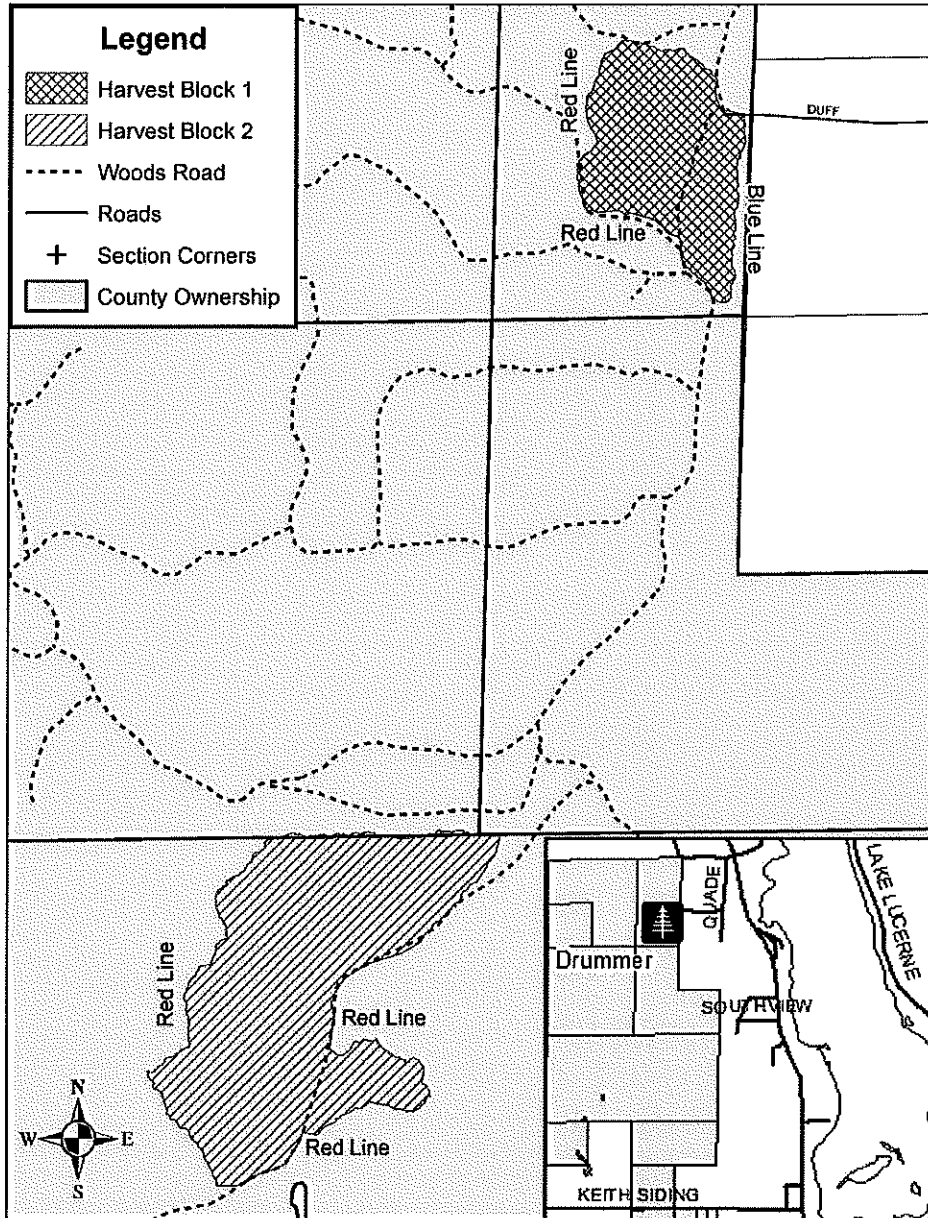

Block 1 – Northern Hardwood, 17 Acres

- Cut all trees 2 inches and larger, **EXCEPT** red oak, white pine, cedar, hemlock, yellow birch and trees marked with green paint.

Block 2 – Aspen, 39 Acres

- Cut all trees 2 inches and larger, **EXCEPT** red oak, white pine, cedar, hemlock and trees marked with green paint.

All Blocks

- No cutting, skidding or trucking will be allowed during spring break up or wet soil conditions.
- No tree length or pole skidding is allowed without prior approval.
- All wood will be sorted by species and categories as listed in table below.
- All species and products shall be cut concurrently.
- Reasonable care shall be used to avoid unnecessary damage to reserve trees.
- **Do not cut dead trees unless marked with orange paint or, if they pose a safety hazard.**
- No equipment use or slash disposal in wetlands.
- Any gates, rocks, berms or other barriers removed for access will be repaired or replaced.
- All slash and logging debris must be lopped to within 2 feet of the ground and pulled back 25 feet from road.

Sale Information:

- Pulp & Bolts - Mill Ticket
- Saw Logs – Field Scale
- Other Products – Determined by County
- Seasonal Restriction:
 - Frozen or Dry Ground
 - March 15 – July 1
- Completion Date: June 1, 2023
- Notify County in advance of starting
- Forestry Department: 715-478-3475

ESTIMATED VOLUME

Pulpwood / Bolts		Sawlogs	
Species	Tons (Cords)	Species	BDFT
Aspen	2,400 (1,067)	Basswood	35,000
Mixed Hardwood	750 (313)	White Ash	20,000
Basswood	270 (140)	Sugar Maple	10,000
Balsam Fir	20 (9)		
Total	3,440 (1,529)	Total	65,000

FOREST COUNTY FOREST TIMBER SALE BID SHEET

Drummer Tract 7-20

Expires 6-1-2023	Mill Scale Pulp & Bolts	All sawlogs field scaled	
Species/Product	Units	Bid/ Unit	Species Total
Aspen Pulp & Bolts	2400 Tons		
Mixed Hardwoods Pulp & Bolts	750 Tons		
Basswood Pulp & Bolts	270 Tons		
Balsam Fir Pulp & Bolts	20 Tons		
Basswood Sawlogs	35 MBF		
White Ash Sawlogs	20 MBF		
Basswood Sawlogs	10 MBF		
"MINIMUM BID	\$39,186.00	TOTAL	

All products must have a bid price.

Bids need to be per ton.

Bid sheets that are incomplete or have errors which make intent of bid unclear may be rejected. All products must have a bid price.

Bid bonds will be waived for 2020. If you are the successful bidder, you will be required to pay a performance bond of 25% of the total bid price at contract signing. You will also be required to provide copies of your SFI training and liability/workman's compensation certificates prior to signing the timber sale contract. At least one (1) person working on the sale must be SFI Certified. **Contracts will not be issued without the 25% performance bond, SFI training certificate and liability/workman's compensation certificate.**

The Seller has the right to reject any and all bids. Volumes are estimates. All bidders are encouraged to examine sale to verify volumes and quality of all timber. Bidders should be prepared to submit a performance bond and references upon request.

I hereby submit the above bid for the above described timber sale.

Bidders Name (Please print)

Address

City, State, Zip Code

Bidders signature

Date

(Mapped by Katie Schallock 07/06/20)

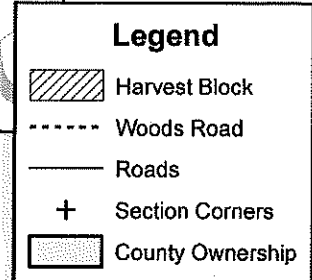

- **Cut all trees 2 inches and larger, EXCEPT red oak, white pine, cedar, hemlock and trees marked with green paint.**
- No cutting, skidding or trucking will be allowed during spring break up or wet soil conditions.
- No tree length or pole skidding is allowed without prior approval.
- All wood will be sorted by species and categories as listed in table below.
- All species and products shall be cut concurrently.
- Reasonable care shall be used to avoid unnecessary damage to reserve trees.
- **Do not cut dead trees unless marked with orange paint or, if they pose a safety hazard.**
- No equipment use or slash disposal in wetlands.
- Any gates, rocks, berms or other barriers removed for access will be repaired or replaced.
- All slash and logging debris must be lopped to within 2 feet of the ground and pulled back 25 feet from road.

- Pulp & Bolts - Mill Ticket
- Saw Logs – Field Scale
- Other Products – Determined by County
- Seasonal Restriction: Frozen Only
- Completion Date: June 1, 2023
- Notify County in advance of starting
- Forestry Department: 715-478-3475

Pulpwood / Bolts		Sawlogs	
Species	Tons (Cords)	Species	BDFT
Aspen	1,550 (689)	Mixed Hardwood	15,000
Mixed Hardwood	1,350 (563)		
White Spruce	160 (80)		
Balsam Fir	100 (47)		
Total	3,160 (1,379)	Total	15,000

FOREST COUNTY FOREST TIMBER SALE BID SHEET

Humongous Fungus Tract 8-20

Expires 6-1-2023	Mill Scale Pulp & Bolts	All sawlogs field scaled	
Species/Product	Units	Bid/ Unit	Species Total
Aspen Pulp & Bolts	1,550 Tons		
Mixed Hardwoods Pulp & Bolts	1,350 Tons		
White Spruce Pulp & Bolts	160 Tons		
Balsam Fir Pulp & Bolts	100 Tons		
Mixed Hardwood Sawlogs	15 MBF		
"MINIMUM BID	\$29,339.00	TOTAL	

All products must have a bid price.

Bids need to be per ton.

Bid sheets that are incomplete or have errors which make intent of bid unclear may be rejected. All products must have a bid price.

Bid bonds will be waived for 2020. If you are the successful bidder, you will be required to pay a performance bond of 25% of the total bid price at contract signing. You will also be required to provide copies of your SFI training and liability/workman's compensation certificates prior to signing the timber sale contract. At least one (1) person working on the sale must be SFI Certified. **Contracts will not be issued without the 25% performance bond, SFI training certificate and liability/workman's compensation certificate.**

The Seller has the right to reject any and all bids. Volumes are estimates. All bidders are encouraged to examine sale to verify volumes and quality of all timber. Bidders should be prepared to submit a performance bond and references upon request.

I hereby submit the above bid for the above described timber sale.

Bidders Name (Please print)

Address

City, State, Zip Code

Bidders signature

Date
