



Lightweight Diff Gear Instructions

All pictures and info contained herein are property of Klinik RC LLC

Recommended Plastic Gear Shimming:

Pulley Side



Screw Side

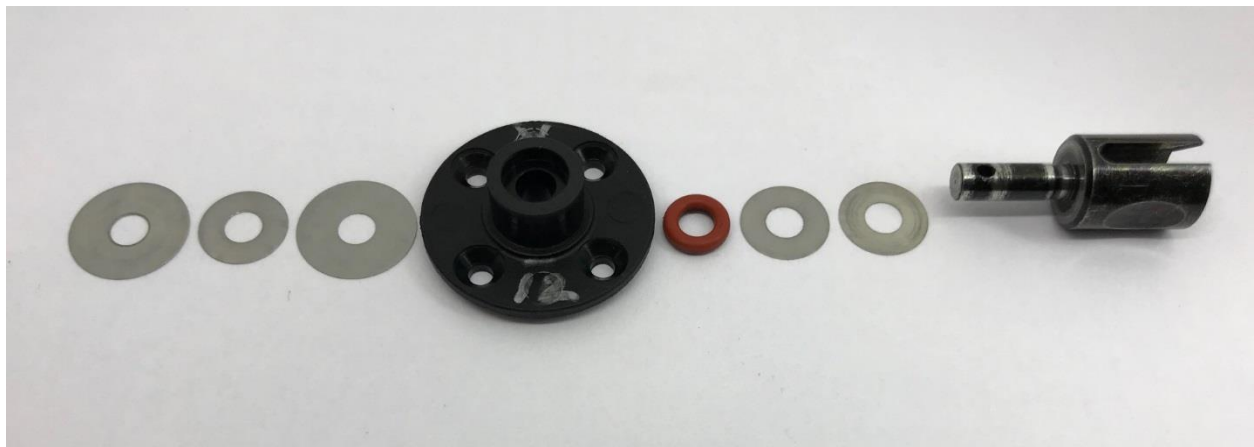

This has been the best starting point with the gearing. If you add shims on the outdrive side the internal mesh will loosen slightly. If you add shims behind the side gears the mesh will tighten. Shim to the best feel.

The first runs might be slightly notchy, don't worry they will seat in. Check backlash after a few runs and readjust as necessary. These are lightweight gears. They will not live long in a modified car. The life of the gears is highly dependent on the shimming. **Take your time!**