

How to print from and Android Phone or Tablet to a network printer (Mopria Compatible)

Printing from an Android phone to a network printer is now a standard, and often seamless, process. Unlike in the past where you needed specific third-party apps, modern Android versions (Android 9 and newer) have built-in print services that can automatically detect most network-connected printers. The key is that both your Android phone and the printer must be connected to the **same Wi-Fi network**.

Mopria is an open standard supported by many printer brands, and it is often pre-installed on Android devices. It can simplify the printing process by allowing you to connect to compatible printers on the network without any additional setup

What you'll need:

- An android Phone or Tablet running Android 9 or later.
- A Mopria enabled printer (check your printer's manual or manufacturer's website if you're unsure you can check the Mopria website <https://mopria.org/certified-products>)
- Both your mobile device and the printer connected to the **same Wi-Fi network**.

Step 1: Connect to Wi-Fi: Ensure your Android phone and the network printer are on the same Wi-Fi network.

Step 2: Open the Document or Photo
First, open the file you want to print. This could be a document in Google Docs, a webpage in Chrome, or a photo in your gallery app.

In this case we are using Chrome.



Step 2: Find the Print Option

Look for the menu icon within the app. This is typically one of the following:

- **Three vertical dots (:)** in the top or bottom right corner.
- A **"Share"** icon, which looks like an arrow pointing to the right or a stylized "less than" sign with a dot at each point.
- In some apps, the word **"Print"** may be directly visible.

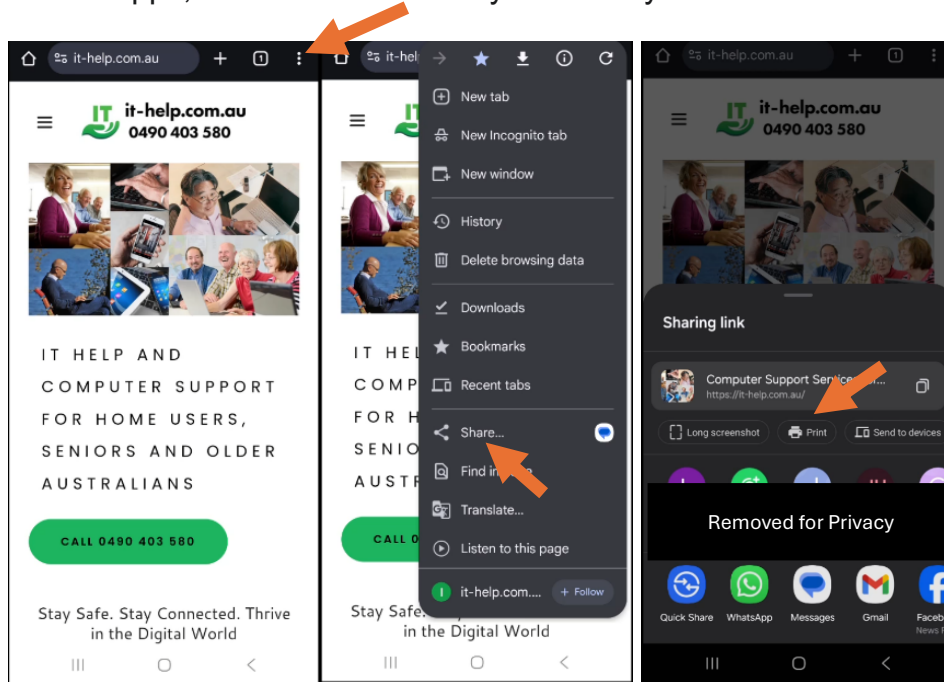

Step 3: Select Your Printer

When you tap "Print," a preview screen will appear. This screen allows you to configure your print job.

- At the very top of the screen, you will see a dropdown menu. It might say **"Save as PDF"** or show the name of a previously used printer. Tap this dropdown menu.
- A list of available printers will appear. This list should automatically populate with network printers that are discoverable on your Wi-Fi network. Tap on your printer's name from this list.

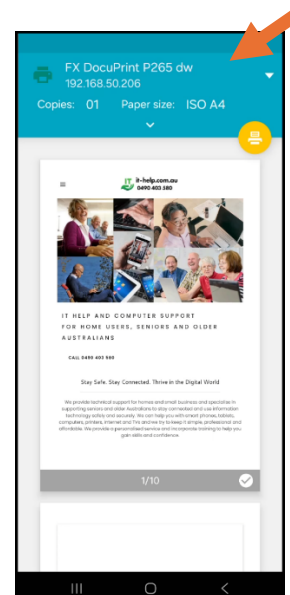

Step 4: Adjust Print Settings

Below the printer selection, you'll see a variety of settings.

A set of options with icons and toggles will appear, such as:

- **"Copies"**: A field where you can tap the plus (+) or minus (-) buttons to choose the number of copies.
- **"Colour"**: A toggle or dropdown to select **Colour** or **Black & White**.
- **"Paper Size"**: A dropdown to choose from options like Letter, A4, etc.
- **"Orientation"**: An icon showing a portrait or landscape view.

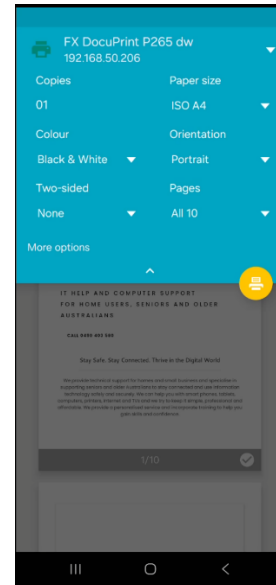

Step 5: Send the Print Job

Once all your settings are configured, you are ready to print.

- Look for a prominent button in the bottom right corner of the screen. It is often a **blue or colored circle with a white printer icon** inside, or a text button that says **"Print."**
- Tap this button. A small notification may appear on your screen, indicating that the print job has been sent to the printer.

