

THIS KEYPAD IS COMPATIBLE WITH AND USED ON THE FOLLOWING RAYPAK MODELS:

**R185B, R265B, R335B, R405B-DIGITAL
206A, 266A, 336A, 406A DIGITAL - ATMOSPHERIC
207A, 267A, 337A, 407A DIGITAL - LOW NOx**

IMPORTANT NOTICE

These instructions are primarily intended for the use by qualified personnel specifically trained and experienced in the installation of this type of heating equipment and related system components. Installation and service personnel may be required to be licensed in some states. Persons not qualified shall not attempt to install this equipment nor attempt repairs according to these instructions.

DANGER - SHOCK HAZARD

Make sure electrical power to the heater is disconnected to avoid damage to components, potential serious personal injury or death. Make sure the gas to the heater has been shut off.

SCOPE:

The components in this kit will provide suitable replacement for the above referenced models.



YOUR OLD KEYPAD SHOULD LOOK LIKE THIS:



THESE INSTRUCTIONS ARE GENERIC AND YOUR EXACT RAYPAK MODEL MAY NOT BE SHOWN IN THESE INSTRUCTIONS.

THE GOAL IS TO BE ABLE TO REMOVE YOUR OLD KEYPAD SWITCH FROM ITS PLASTIC BEZEL. CLEAN THE SURFACE OF ALL OLD ADHESIVE AND RESIDUE USING TAR REMOVER OR ISOPROPYL ALCHOL. LET DRY AND THEN INSTALL YOUR NEW KEYPAD.

CONTROL PANEL REMOVAL

1. Remove screw from front door. Set aside door for serviceability.

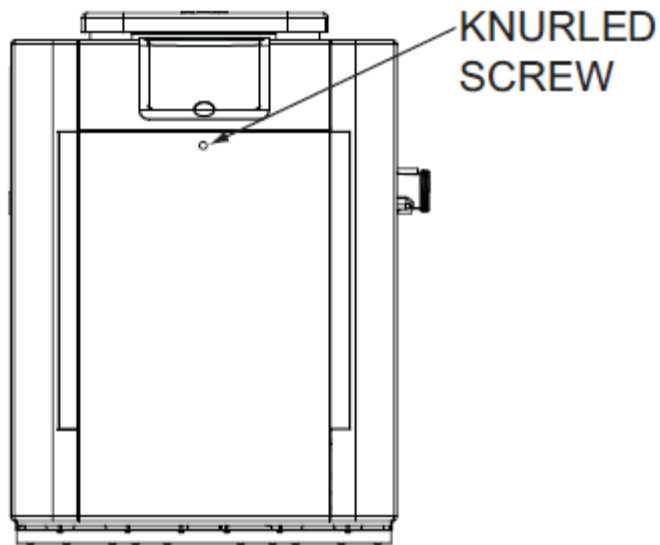

2. Remove (4) screws from sides of control panel.
3. Rotate control panel down until panel stops. Do not force.

NOTE: *Caution must be used to not damage controls or wiring.*

AVOID HANDLING YOUR CONTROL BOARDS AS THEY CAN BE DAMAGED BY ELECTRO STATIC DISCHARGE. ALWAYS TOUCH YOUR HAND TO METAL TO DISSIPATE ANY ENERGY BEFORE HANDLING BOARDS.

MAKE SURE POWER AND GAS IS TURNED OFF BEFORE STARTING ANY REPLACEMENTS

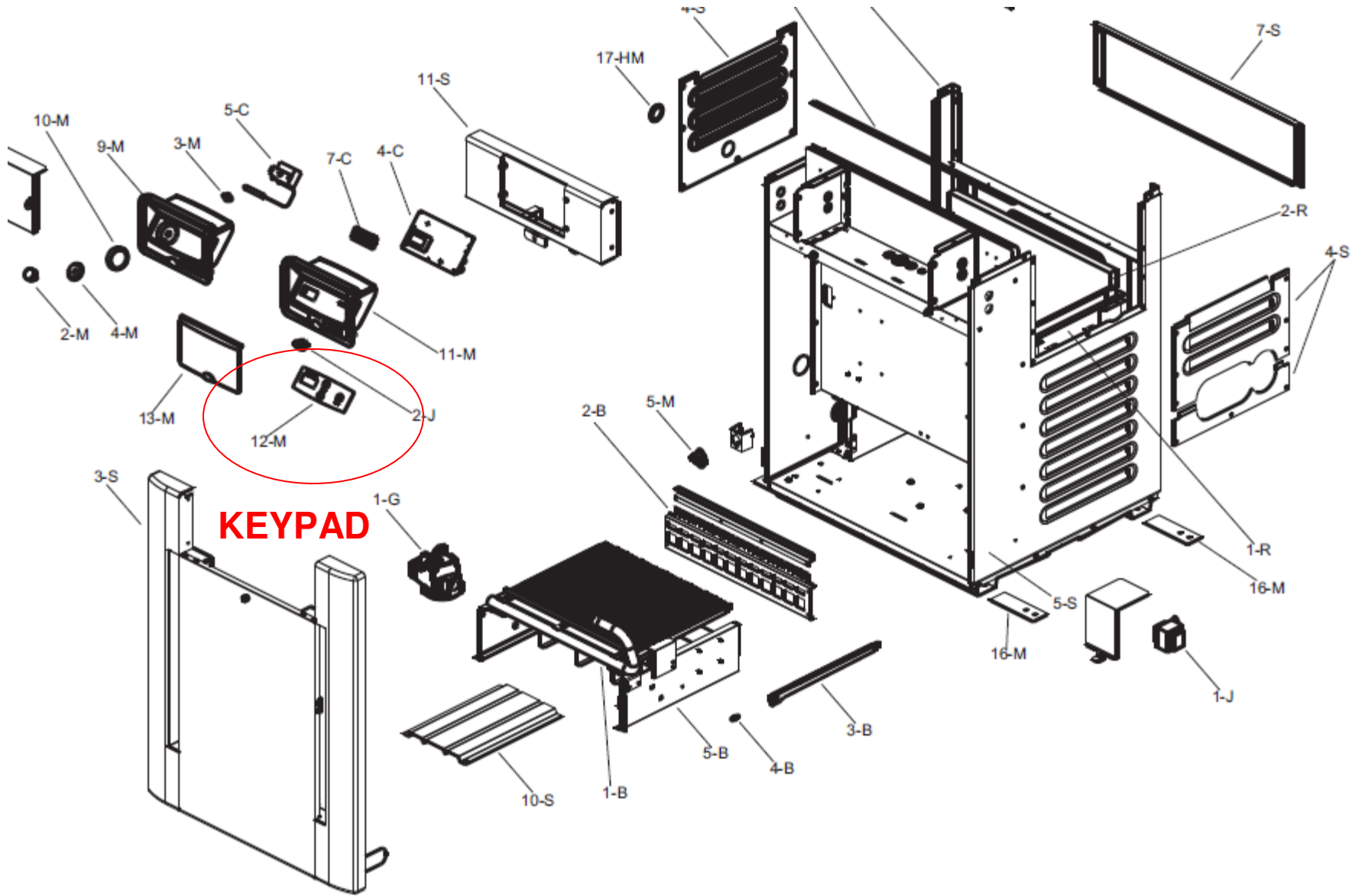

TYPICAL PARTS BREAKDOWN