

PRODUCT DESCRIPTION

Cobrahead Large Chassis

LUM100CLC Series
60W - 150W

Dark Sky Friendly LED Street Lamp

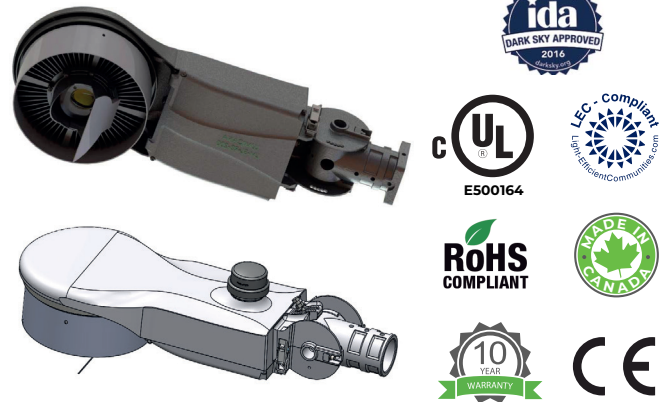

FEATURES

Optical

Replaces 100W-400W HPS or MH street and area lighting.

Variety of color temperatures and CRI available to suit your project.

Standard shields to prevent excessive backlight and glare and meet IDA (International Dark-Sky Association) full cut-off requirements. Customised shielding also available upon request.

Electrical

120-277V Driver with 0.98 Power Factor at 120V and <20% THD.

LED Chipset rated at >100,000 hours at 25°C, L70.

Efficient LED lighting saves 40-60% compared to standard HID lamps with extended lifespans and no maintenance.

All components rated -40°C to 40°C minimum.

Construction

Installer friendly toolless entry standard.

Aluminum housing for durability and corrosion resistance.

Proprietary cooling technology keeps even high wattage lights cool, extending lifespan and effective brightness.

Slipfitter for 2" pipe mounting standard.

APPLICATIONS

Municipalities

Parks

Roadways

Airports

Transportation Stations.

OPTIONS

10kVa & 20kVa Surge Protection

Opt Colors: White, Black or Bronze

Backlight Shield

347 VAC, 480 VAC

PRODUCT OVERVIEW

1: Improved light quality, lifespan, and efficiency is achieved through new proprietary heat transfer cooling technology.

2: Increased lighting control improves lighting efficacy allowing lower wattages for the same effective lumens with minimal backlight, uplight and glare.

3: Best Practices: This luminaire reduces light waste, trespass, and glare. The lens is well shielded and the light only reaches areas that need to be lit, improving visibility, security and safety.

FEATURES

This light is equipped with our proprietary (patent pending) **Heat Sync Hive™** cooling technology, which provides substantially more heat transfer capacity and efficiency when compared to traditional luminaires.

Lumican's luminaire uniquely addresses and solves issues regarding high blue light content and color temperature that affect all living organisms, without sacrificing CRI and Luminous Efficiency.

Lumicana's state of the art optics, reflectors and shields are designed to protect dark skies and prevent light pollution, trespass and glare. A modern design that meets the recommendations by the AMA (American Medical Association) for lowest blue light possible.

Lumicana street and outdoor lighting is designed with adherence to the highest light pollution guidelines and best practices to preserve dark skies for protection of the environment, human health, stargazing and improved roadway safety.

DARK SKY AND NEIGHBORHOOD FRIENDLY

Lumicana street and outdoor lighting is designed with adherence to light pollution guidelines to preserve dark skies, also following Light Efficient Communities (LEC) and American Medical Association (AMA) guidelines for protection of the environment, human health, stargazing and improved safety.

ORDERING INFORMATION

Sample Code: LUM100SL80W0-LV27K-T3

Series	Wattage	Voltage	CCT	Distribution Options
LUM100SL	60W	LV: 120 - 277V	2200K - 3000K	T2: Type I
	80W	HV: 347-480V		T3: Type III
	100W			T5: Type V
	120W			
	150W			

Note: not all wattage/distribution options are available with all CCT options. Please ask your representative for details.
Disclaimer: this is a preliminary data-sheet, all values subject to change upon final certification.

PENDING CERTIFICATIONS

This luminaire was designed to meet International DLC certification. Final certifications will be provided upon order confirmation.



DIMENSIONS

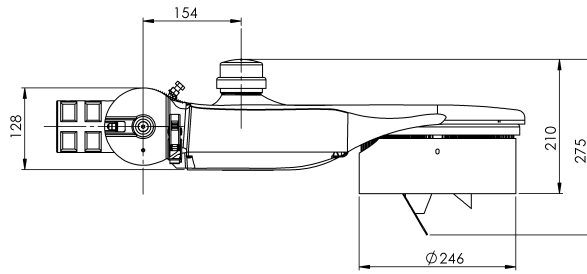
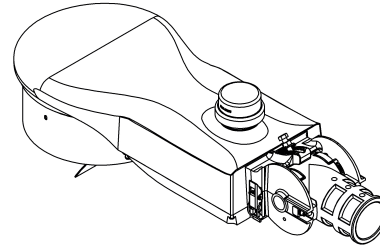
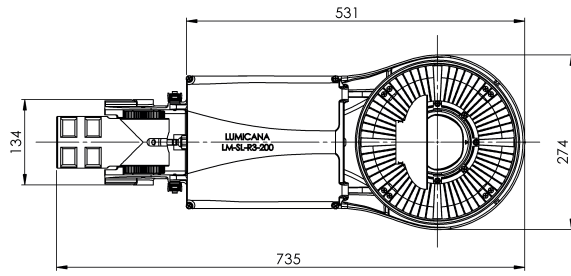

LIGHT DISTRIBUTION

Type II

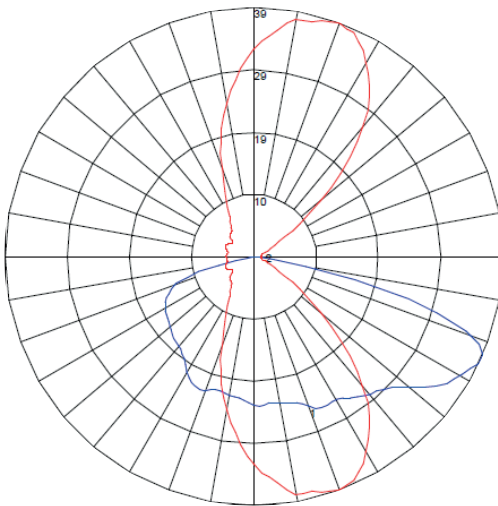

Type III

