

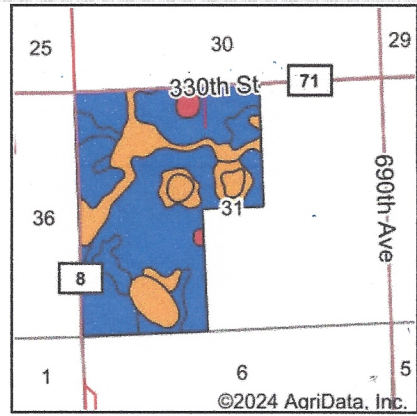

Soils Map

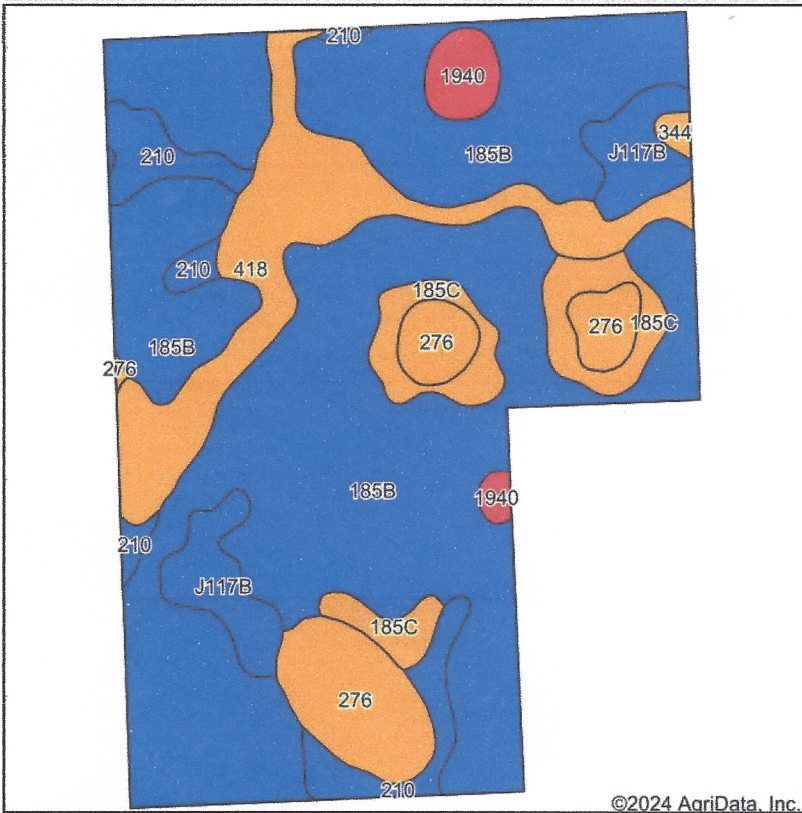

State: **Minnesota**
 County: **Big Stone**
 Location: **31-123N-45W**
 Township: **Malta**
 Acres: **400.74**
 Date: **10/17/2024**



Soils data provided by USDA and NRCS.

Area Symbol: MNO11, Soil Area Version: 22

Code	Soil Description	Acres	Percent of field	Non-Irr Class Legend	Non-Irr Class *c	Productivity Index	*n NCCPI Soybeans
185B	Hattie silty clay, 1 to 4 percent slopes	252.57	63.0%		Ils	80	54
418	Lamoure silty clay loam, 0 to 2 percent slopes, occasionally flooded	46.03	11.5%		IIIw	78	75
276	Oldham silty clay loam, occasionally ponded, 0 to 1 percent slopes	29.98	7.5%		IIIw	86	38
185C	Hattie silty clay, 4 to 10 percent slopes	22.53	5.6%		IIIe	75	48
210	Fulda silty clay, 0 to 2 percent slopes	20.42	5.1%		IIw	86	51
J117B	Hokans-Svea complex, 2 to 6 percent slopes	20.33	5.1%		Ile	99	70
1940	Bigstone silty clay loam, ponded	7.56	1.9%		VIIIw	5	2
344	Bigstone silty clay loam	1.32	0.3%		IIIw	77	65
Weighted Average					2.36	79.8	*n 54.6

*n: The aggregation method is "Weighted Average using all components"

*c: Using Capabilities Class Dominant Condition Aggregation Method

Soils data provided by USDA and NRCS.