

Codrington County, SD

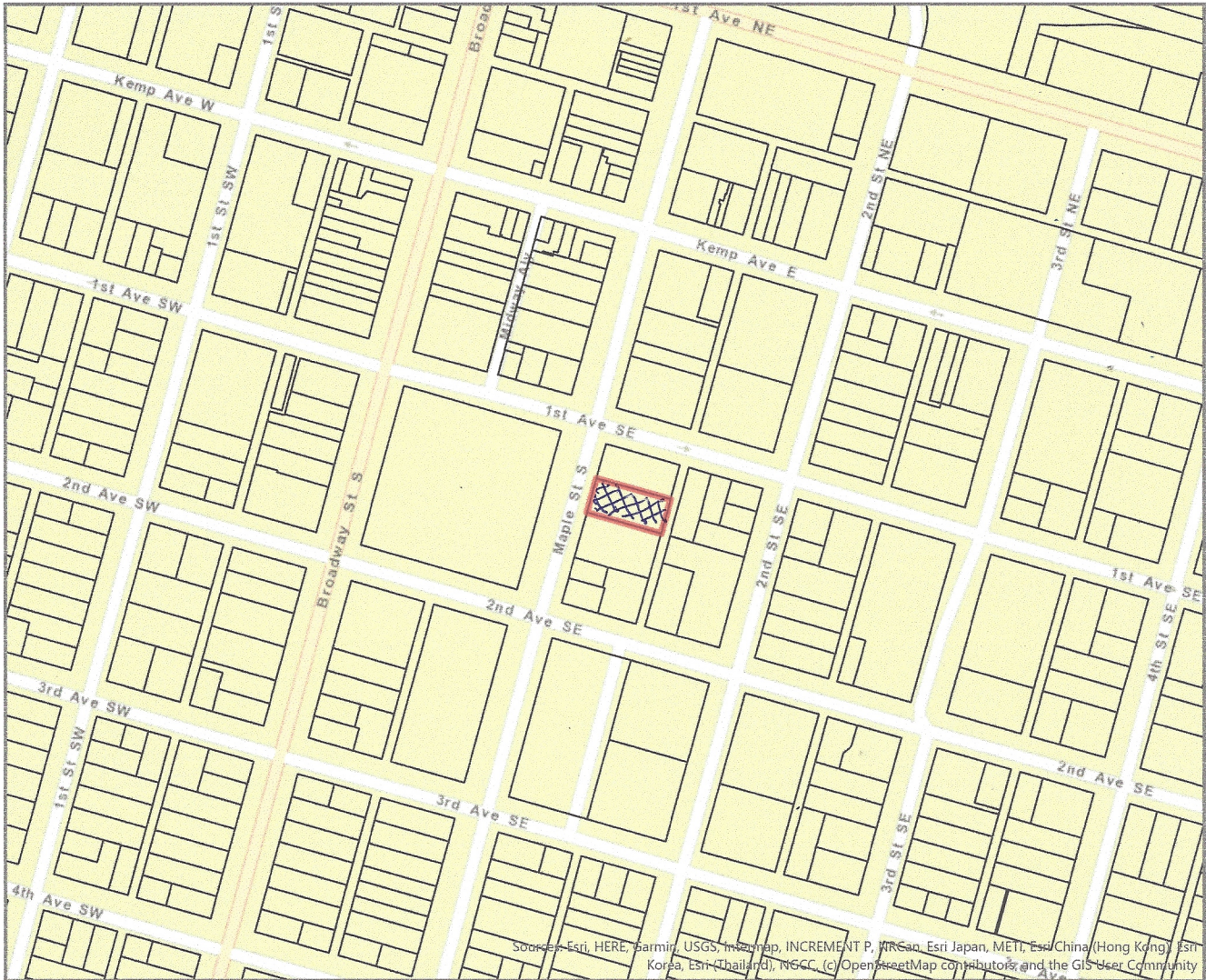

GIS Update	1/1/2009	Town/Township	WATERTOWN CITY
Record Number	9567	Addition	3523
Record Query	9567	Section	12
Legal	N5' LOT 12 & S45' LOT 12 & S25' LOT 13 BLK 15 ORIGINAL PLAT	Twp/Block	15
Legal Acres	000.00	Range	
Extent	12571.95905327	Quarter	0
Owner	HARP LLC	Sixteenth	0
Additional Owner		Split	
Owner Zip	57201-	School District	14-4
Property Address	112 S MAPLE		



Codrington County
South Dakota

Disclaimer: Map and parcel data are believed to be accurate, but accuracy is not guaranteed. This is not a legal document and should not be substituted for a title search, appraisal, survey, or for zoning verification.

Map Scale
1 inch = 376 feet
12/28/2023

Codington County, SD

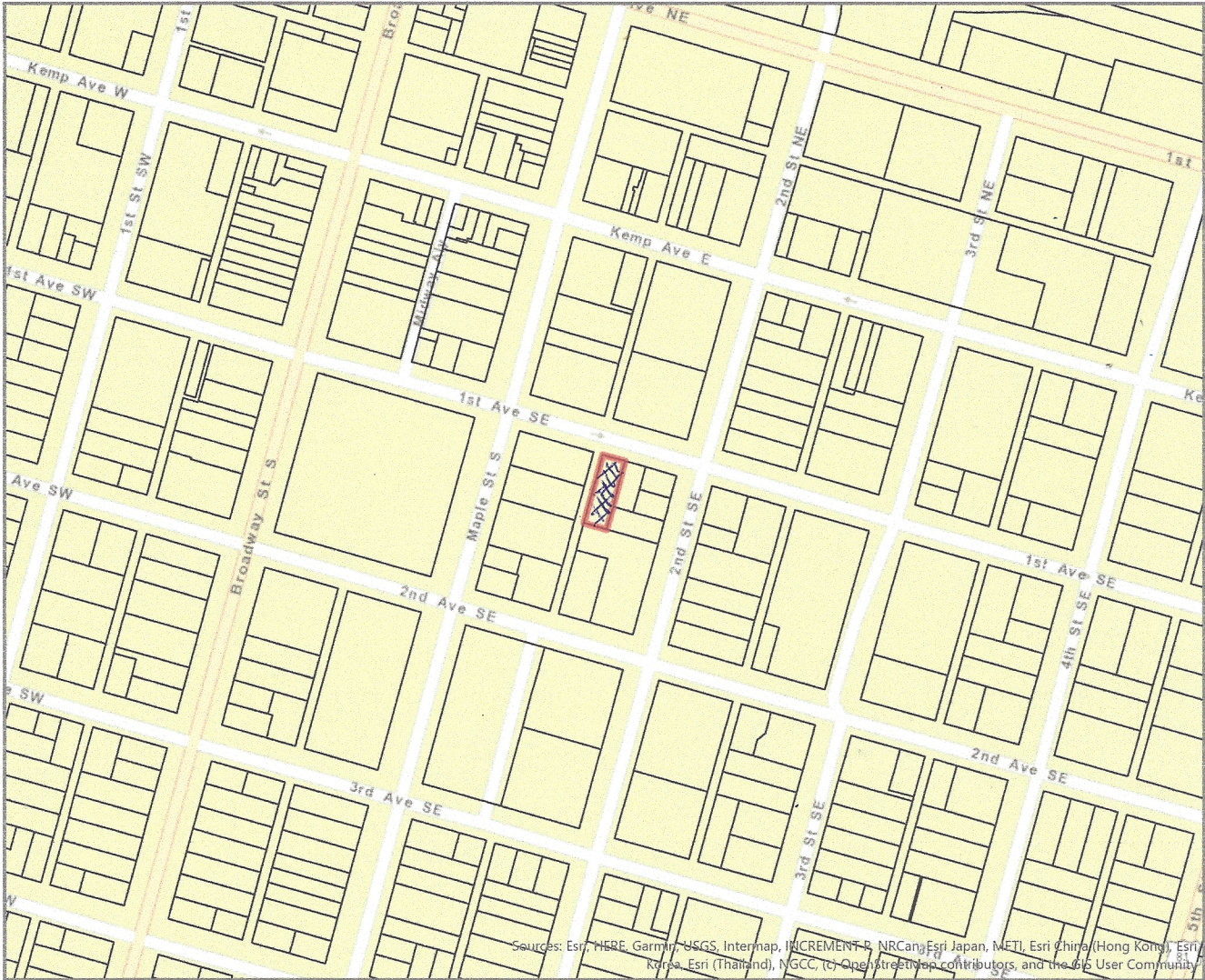

GIS Update	1/1/2009	Town/Township	WATERTOWN CITY
Record Number	9560	Addition	3523
Record Query	9560	Section	1
Legal	W50' LOTS 1-3 BLK 15 ORIGINAL PLAT	Twp/Block	15
Legal Acres	000.00	Range	
Extent	7679.77114083	Quarter	0
Owner	HARP LLC	Sixteenth	0
Additional Owner		Split	3
Owner Zip	57201-	School District	14-4
Property Address	114 1 AVE SE		



Codington County
South Dakota

Disclaimer: Map and parcel data are believed to be accurate, but accuracy is not guaranteed. This is not a legal document and should not be substituted for a title search, appraisal, survey, or for zoning verification.

Map Scale
1 inch = 376 feet
12/28/2023