

Block 6: Starburst

10" × 10" Finished

by Amber Elliot

alderwood-studio.com @alderwoodstudio

CONFETTI COTTON SOLIDS

BY RILEY BLAKE DESIGNS

C120-CLOUD

(Fabric 1)

C120-SEAGLASS

(Fabric 2)

C120-JADE

(Fabric 3)

C120-RILEYTEAL

(Fabric 4)

C120-SONGBIRD

(Fabric 5)

EXPRESSIONS HAND-DYES

BY RILEY BLAKE DESIGNS

BT21600-121 POWDERED

PASTELS (Fabric 1)

BT21000-279 SMOKY TEAL

(Fabric 2)

BT21000-275 CALYPSO

(Fabric 3)

BT21000-274 AQUAMARINE

(Fabric 4)

BT21600-312 SAGE

(Fabric 5)

CUTTING INSTRUCTIONS

Fabric 1:

- A – (4) 4" × 5" rectangles
- B – (2) 3" × 3" squares
- C – (8) 1 ½" × 2 ½" rectangles

Fabric 2:

- D – (2) 3" × 3" squares

Fabric 3:

- E – (4) 4" × 5" rectangles

Fabric 4:

- F – (2) 3" × 3" squares

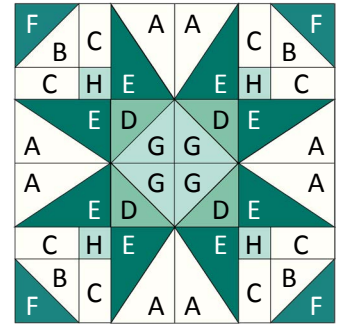

Fabric 5:

- G – (2) 3" × 3" squares
- H – (4) 1 ½" × 1 ½" squares

ADDITIONAL TOOLS RECOMMENDED:

2 ½", 4 ½", 10 ½" TRIM-IT™ RULERS

RILEY BLAKE DESIGNS QUILTY

TOOLS™ ¼" PLUS RULER

LORI HOLT SEW HANDY STICKERS

RILEY BLAKE DESIGNS QUILTER'S

CLAPPER

SUE DALEY DESIGNS ROTATING

CUTTING MAT

SEAMS SEW EASY™ SEAM GUIDE

RST = RIGHT SIDES TOGETHER

HRT = HALF RECTANGLE TRIANGLE

HST = HALF SQUARE TRIANGLE

Sew all seams RST and with a ¼" seam allowance. Press seams as desired unless stated otherwise. Dimensions listed in steps are unfinished sizes.

SEWING INSTRUCTIONS

1. Draw a diagonal line on the wrong side of (2) **B**-squares and (2) **G**-squares.
2. Place (1) marked **B**-square on (1) **F**-square, RST. Sew ¼" away from both sides of the drawn diagonal line. Cut along the drawn diagonal line and press to make (2) B/F HST units. Trim each unit to measure 2 ½" × 2 ½". Repeat to make (4) total units.

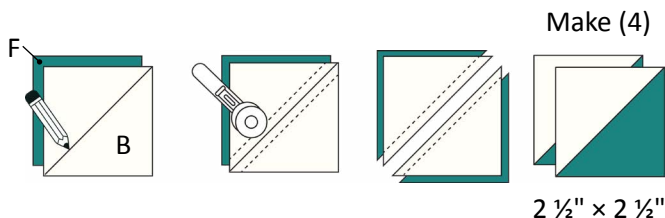

3. Repeat Step 2 using (2) marked **G**-squares and (2) **D**-squares to make (4) D/G HST units. Trim each unit to measure 2 ½" × 2 ½".

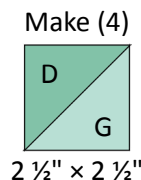

4. Arrange (1) B/F HST unit, (2) **C**-rectangles, and (1) **H**-square as shown below. (Pay attention to the orientation of the HST unit.) Sew the units together in pairs. Next, sew the pairs together to make (1) Corner Unit. Repeat to make (4) total units.

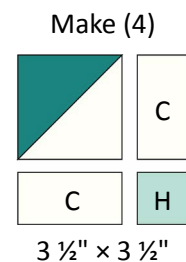

5. Arrange (4) D/G HST units as shown below. (Pay attention to the orientation of the HST units.) Sew the units together in pairs. Next, sew the pairs together to make (1) Center Unit.

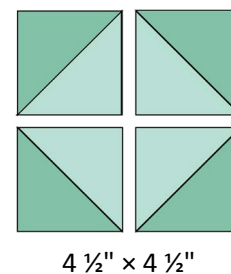

Block 6: Starburst

10" x 10" Finished

by Amber Elliot

alderwood-studio.com @alderwoodstudio

6. Mark a diagonal line on the wrong side of (1) **A**-rectangle from top right corner to the bottom left corner. Place (1) marked **A**-rectangle on (1) **E**-rectangle, RST, with opposite corners aligned. Stitch $\frac{1}{4}$ " away from both sides of the drawn diagonal line. Cut along the drawn diagonal line and press to make (2) HRT units. Cut out the template on page 2 and place the template on (1) sewn HRT, aligning the points of the corner squares with the diagonal seam. Pin in place if desired and trim the rectangle to the template size. Repeat with the second sewn HRT. Repeat to make (4) total units.

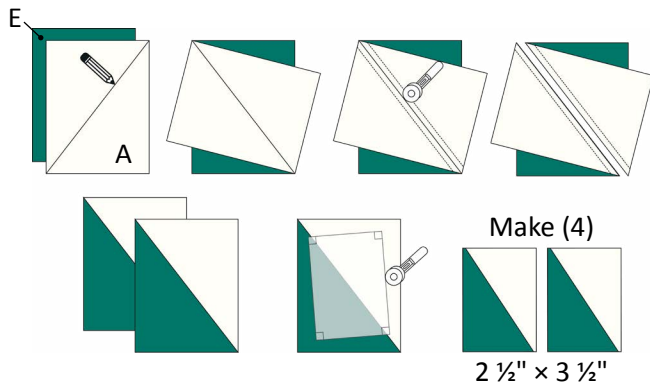

7. Repeat Step 6 using (2) **A**-rectangles and (2) **E**-rectangles to make (4) reversed HRTs following the diagram below, noting the different orientation of the drawn line and placement of the **A**-rectangle.

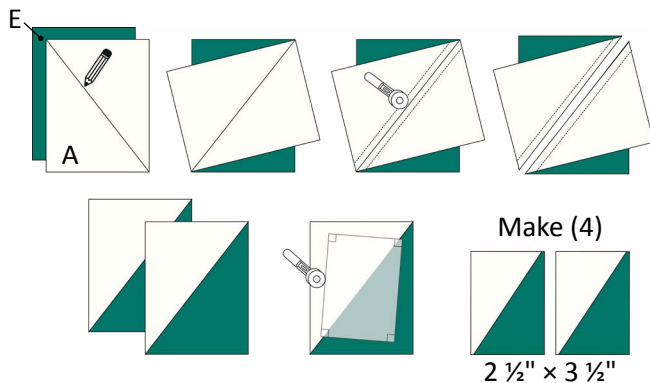

8. Sew (1) HRT unit from Step 6 and (1) reversed HRT unit from Step 7 together to make (1) Side Unit. Repeat to make (4) total units.

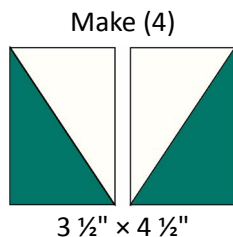

9. Arrange (4) Corner Units, (4) Side Units, and (1) Center Unit as shown below. Sew the units together into rows. Next, sew the rows together to make Block 6. Block 6 should measure $10 \frac{1}{2}$ " x $10 \frac{1}{2}$ " unfinished.

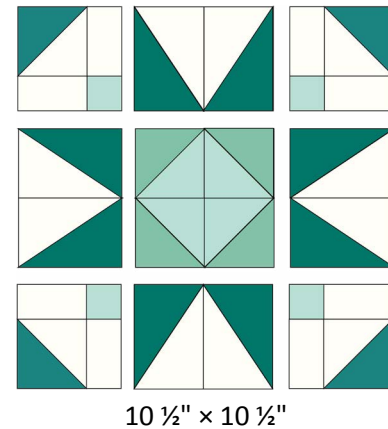

Your block is complete!



**Due to the hand-crafted nature of batiks, fabric may vary from images.*

