

Block 11: Crown Jewel

10" x 10" Finished

by Sandy Gervais

piecesfrommyheart.net @gervaisandy

CONFETTI COTTON SOLIDS

BY RILEY BLAKE DESIGNS

C120-CLOUD

(Fabric 1)

C120-RILEYCORAL

(Fabric 2)

C120-BEEHIVE

(Fabric 3)

C120-DENIM

(Fabric 4)

EXPRESSIONS HAND-DYES

BY RILEY BLAKE DESIGNS

BT21600-121 POWDERED

PASTELS (Fabric 1)

BT21000-191 PIGGY PINK

(Fabric 2)

BT21000-257 DIJON

(Fabric 3)

BT21800-297 STONE BLUE

(Fabric 4)

CUTTING INSTRUCTIONS

Fabric 1:

- A – (2) $3\frac{1}{2}" \times 3\frac{1}{2}"$ squares
- B – (4) $2\frac{1}{2}" \times 4\frac{1}{2}"$ rectangles
- C – (4) $2\frac{1}{2}" \times 2\frac{1}{2}"$ squares

Fabric 2:

- D – (1) $2\frac{1}{2}" \times 2\frac{1}{2}"$ square

Fabric 3:

- E – (2) $3" \times 3"$ squares

Fabric 4:

- F – (2) $3\frac{1}{2}" \times 3\frac{1}{2}"$ squares
- G – (6) $3" \times 3"$ squares

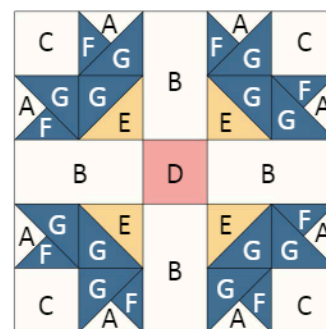

ADDITIONAL TOOLS RECOMMENDED:

$2\frac{1}{2}"$, $4\frac{1}{2}"$, $10\frac{1}{2}"$ TRIM-IT™ RULERS

RILEY BLAKE DESIGNS QUILTY

TOOLS™ $\frac{1}{4}"$ PLUS RULER

LORI HOLT SEW HANDY STICKERS

RILEY BLAKE DESIGNS QUILTER'S

CLAPPER

SUE DALEY DESIGNS ROTATING

CUTTING MAT

SEAMS SEW EASY™ SEAM GUIDE

RST = RIGHT SIDES TOGETHER

HST = HALF SQUARE TRIANGLE

Sew all seams RST and with a $\frac{1}{4}"$ seam allowance. Press seams as desired unless stated otherwise. Dimensions listed in steps are unfinished sizes.

SEWING INSTRUCTIONS

1. Draw a diagonal line on the wrong side of (2) A-squares, (2) E-squares, and (4) G-squares.
2. Place (1) marked E-square on (1) unmarked G-square, RST. Sew $\frac{1}{4}"$ away from both sides of the drawn diagonal line. Cut along the drawn diagonal line and press to make (2) E/G HST units. Trim each unit to measure $2\frac{1}{2}" \times 2\frac{1}{2}"$. Repeat to make (4) total units.

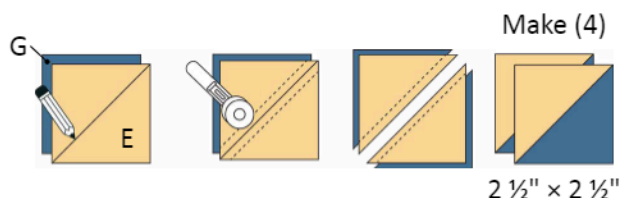

3. Repeat Step 2 using marked A-squares and F-squares to make (4) A/F HST units. Trim each unit to measure $3" \times 3"$.

Make (4)

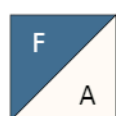

$3" \times 3"$

4. Align (1) marked G-square on (1) A/F HST unit, RST, with the marked line perpendicular to the seam line. Sew $\frac{1}{4}"$ away from both sides of the drawn diagonal line. Cut along the drawn diagonal line and press to make (2) triangle units. Trim each unit to measure $2\frac{1}{2}" \times 2\frac{1}{2}"$. Repeat to make (8) total units.

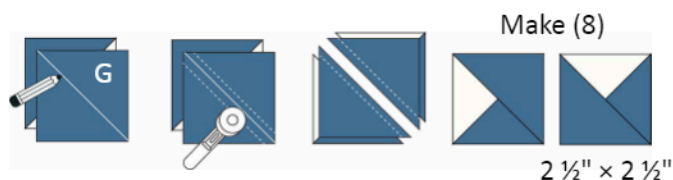

5. Arrange (1) C-square, (2) triangle units, and (1) E/G HST unit as shown below. Sew the units together in pairs. Next, sew the pairs together to make (1) Corner Unit. Repeat to make (4) total units.

Make (4)

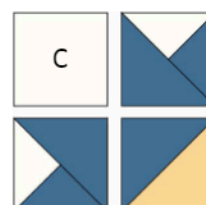

$4\frac{1}{2}" \times 4\frac{1}{2}"$

Block 11: Crown Jewel

10" × 10" Finished

by Sandy Gervais

piecesfrommyheart.net @gervaisandy

6. Arrange (4) Corner Units, (4) **B**-rectangles, and (1) **D**-square as shown below. Sew the pieces together into rows. Next, sew the rows together to make Block 11. Block 11 should measure 10 ½" × 10 ½" unfinished.

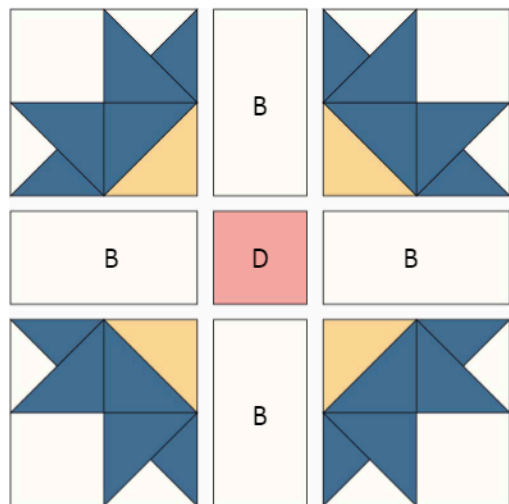

10 ½" × 10 ½"

Your block is complete!

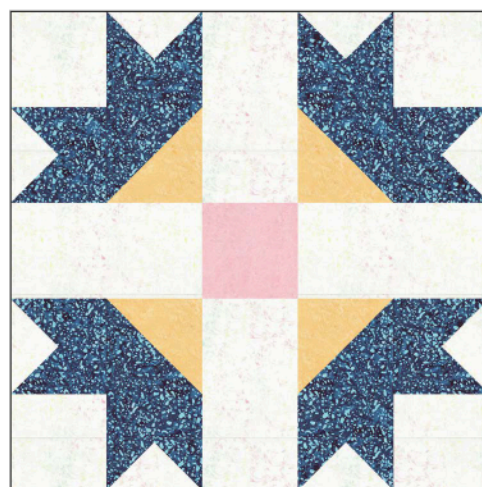
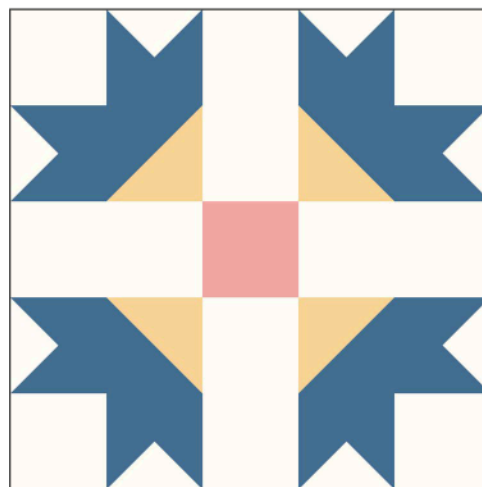

**Due to the hand-crafted nature of batiks, fabric may vary from images.*