

ZEST KAYAKS

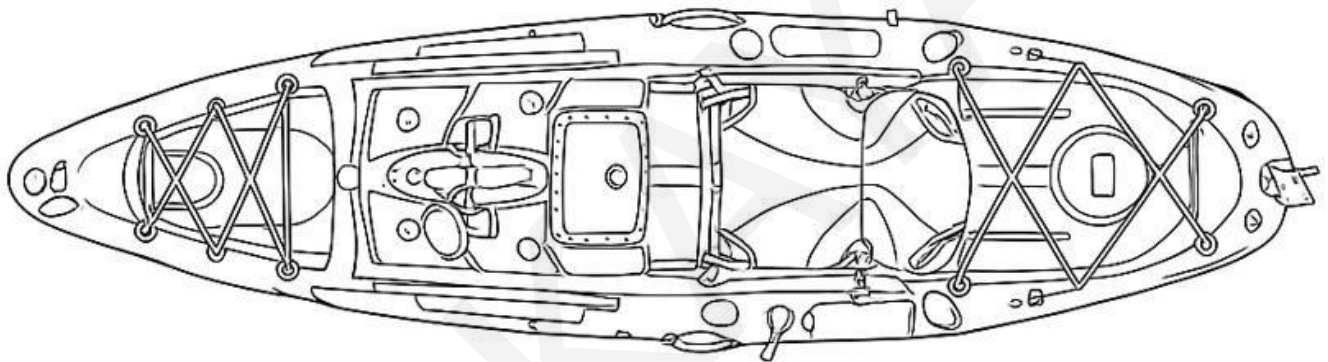

Pro Solo USER MANUAL

Contents

HERE IS YOUR KAYAK!	3
ASSEMBLE THE KAYAK	4
CONNECT THE RUDDER	5
FIN DRIVE ASSEMBLE	7
SAFETY GUIDELINES	8
CARE AND MAINTENANCE	10

We at Zest Kayaks extend our sincerest thanks to you for choosing our kayaking products and services for your adventure needs. We are committed to providing you with an exceptional experience on the water and appreciate the trust you place in us. Please read the user manual and follow each step to ensure correct installation.

Please contact us at info@zestkayaks.ca if you need any help!

HERE IS YOUR KAYAK!

Please review all the components of your kayak.

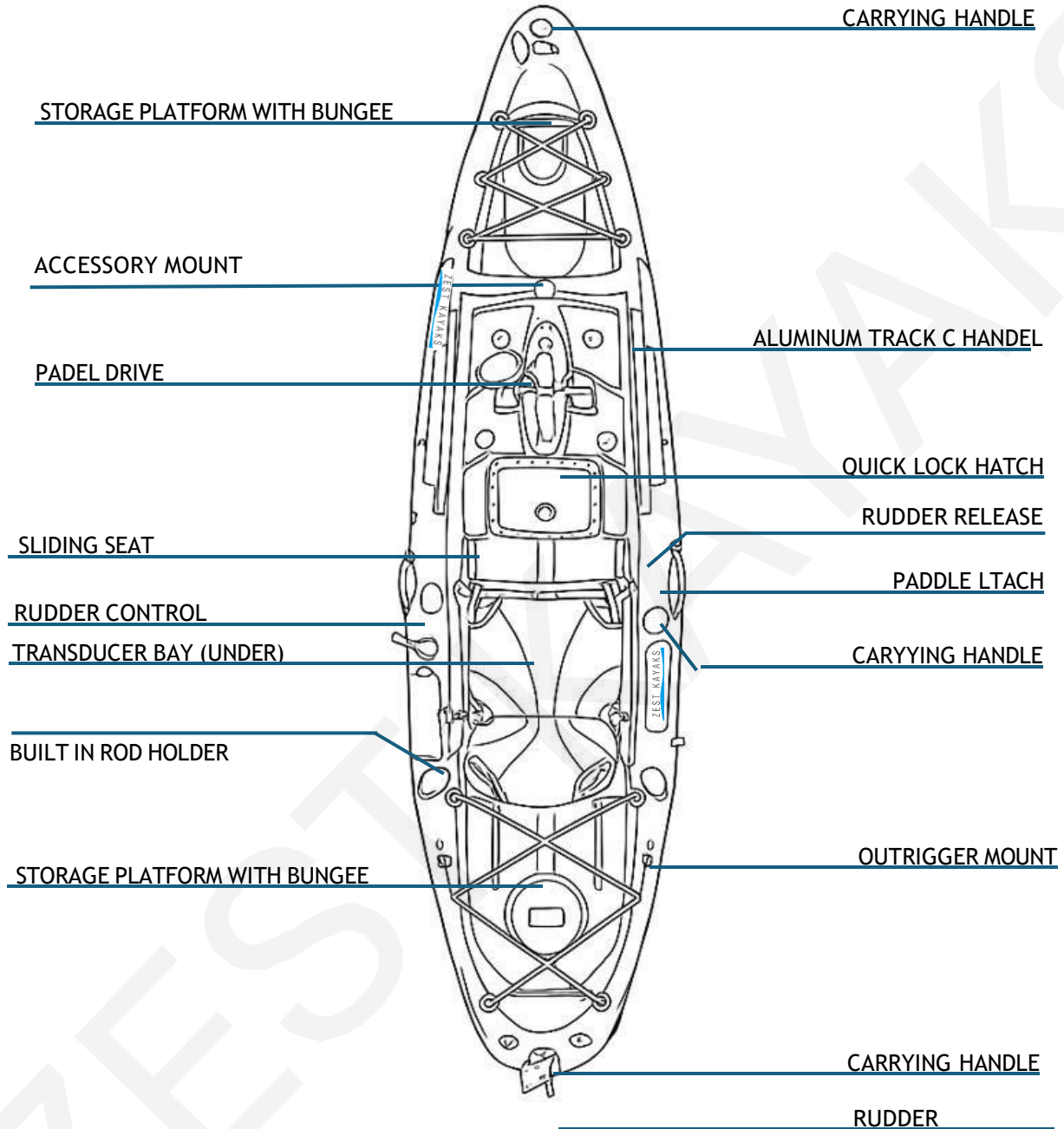

ASSEMBLE THE KAYAK

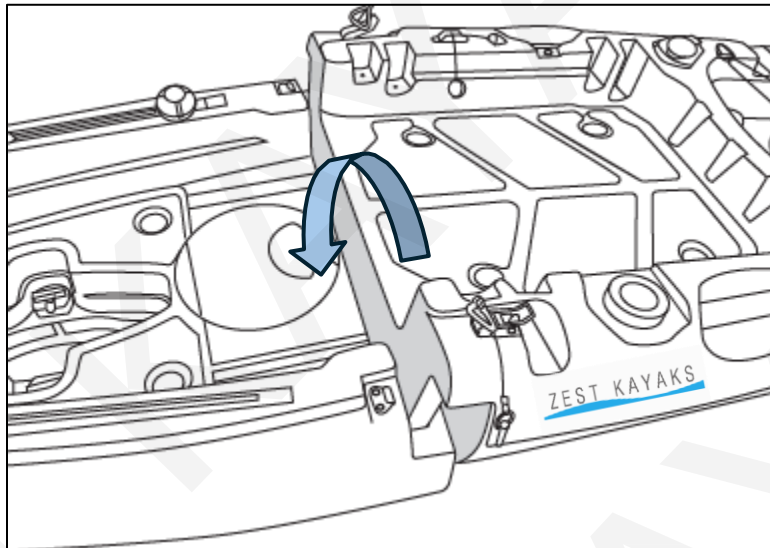

1-1 : Align and Connect the Sections

- Ensure both sections of the kayak are properly aligned.
- Lift the rear section and push it down firmly into place.

⚠ Important: Make sure the metal latch is not caught between the sections.

⚠ Important: Be aware of the latches at the bottom. Make sure they are not trapped between the plastic sections during assembly.

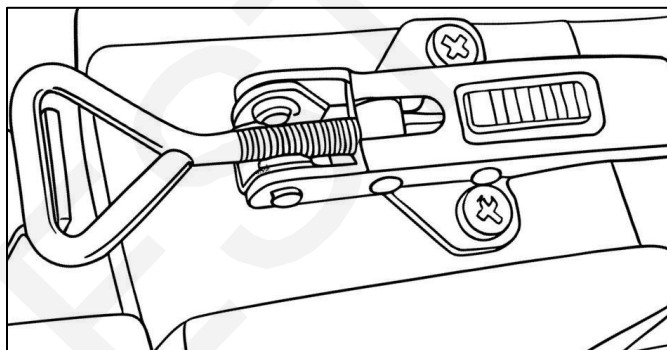

1-2 : Secure the Latches (There are 4 latches in total)

- Close the latches on both ends, and ensure the two latches underneath are not caught between the sections.
- You can adjust the latch tension by turning it.

⚠ Caution: Do not overtighten, as this may damage the latch.

I

CONNECT THE RUDDER

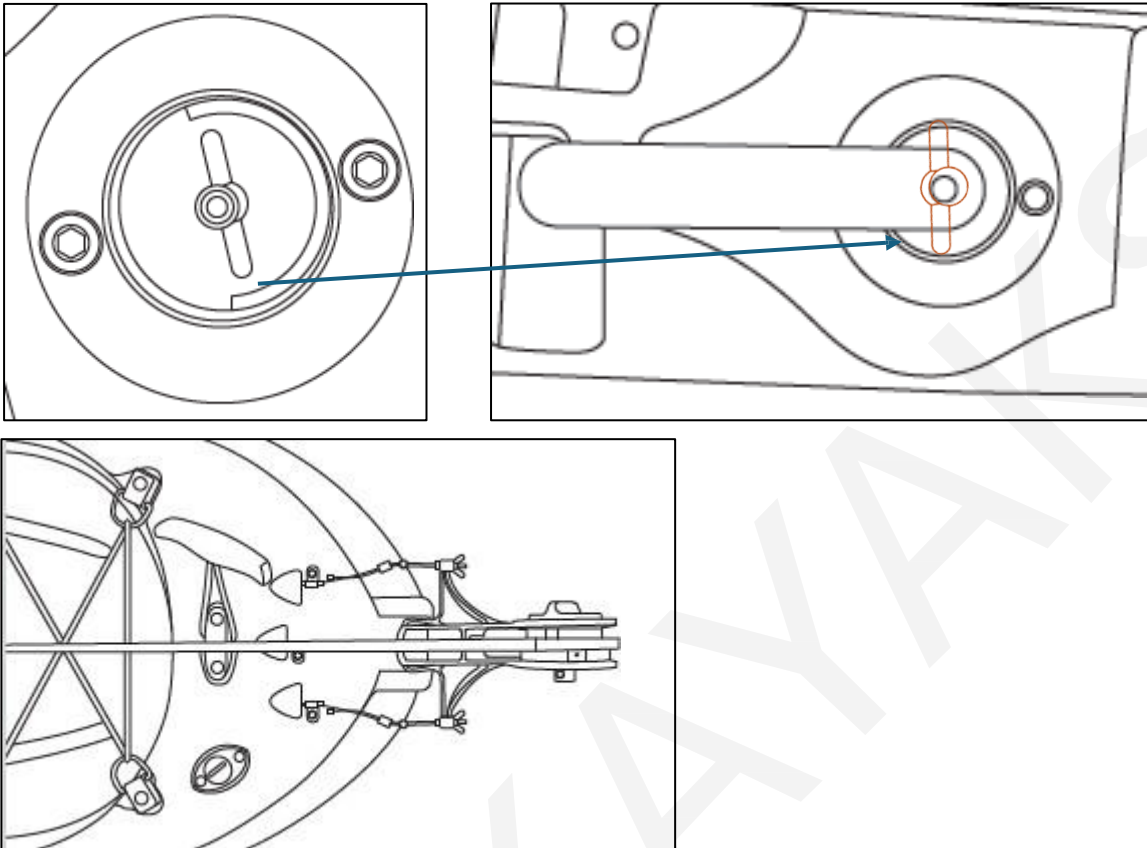

2-1 : Install the Handles Position the Rudder Control Wires

- The screw and handle are stored inside the dry storage box. Make sure the slot on the handle aligns with the metal bar on the base.
- Gently pull the wire at the rear of the kayak while keeping the rudder controller straight. Ensure both the rudder and controller stay aligned during this step.

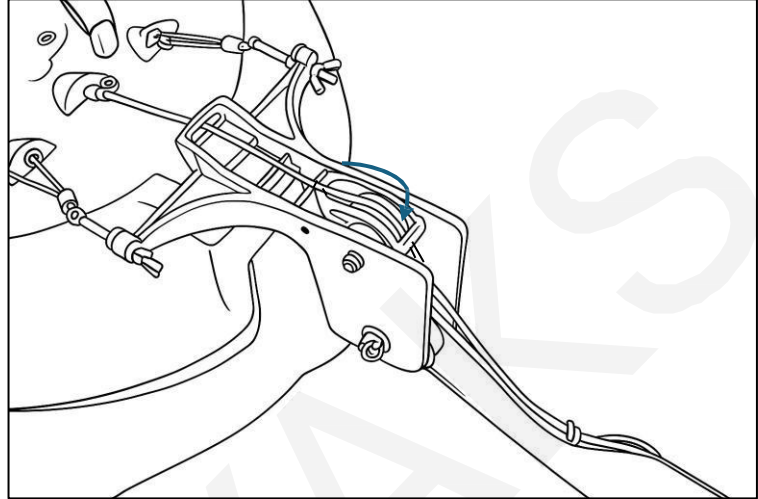
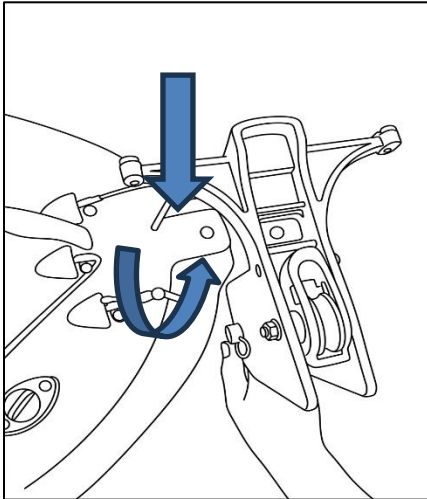

2-2. Rudder installation

- Rotate the rudder 90 degrees, then make sure the flat surface on the rudder pin is facing the screw inside the hole. Insert the rudder and rotate it back into position.
 - Connect the metal wires on the rudder. Make sure its neither too tight or loose.
 - After connecting the metal wires to the rudder, test the steering. If the handle cannot steer the rudder, it is not catching on the metal bar underneath.
- ⚠ **Caution:** Do not pull the wire into the kayak. While it is possible to re-thread it, doing so is very time-consuming.

FIN DRIVE ASSEMBLE

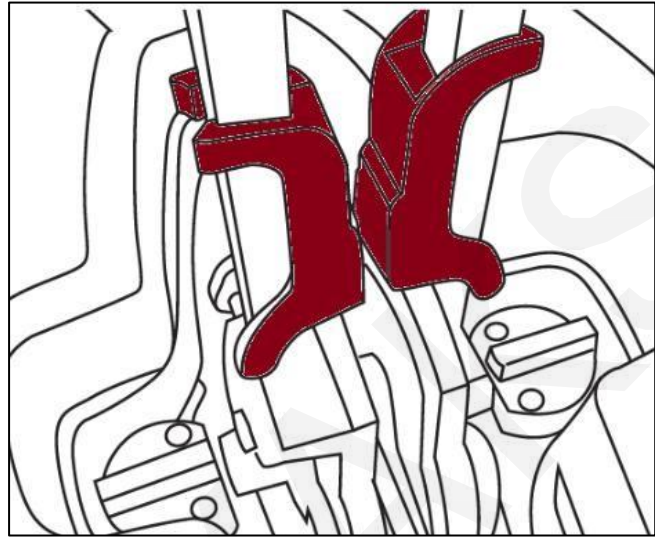
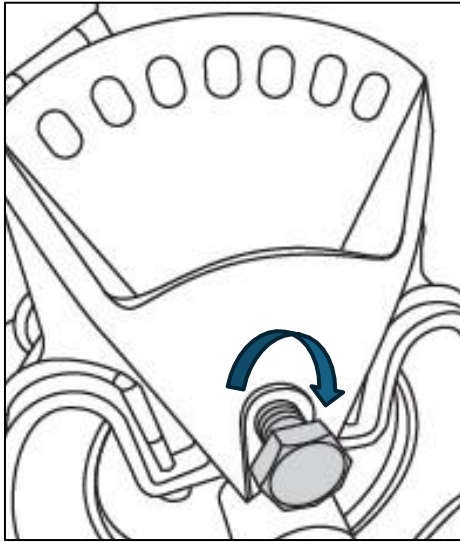

3-1. Assemble the fin drive system

Unscrew the main bolt, then slide the pedal into position while keeping the red handle pressed in. Once the pedal is correctly inserted, the red handle will pop back into place. Finally, tighten the main bolt securely.

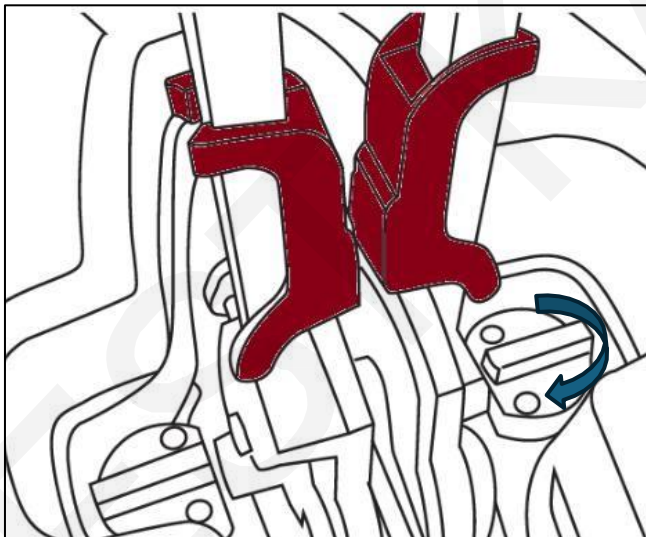

3-2. Install the fin drive on the kayak

Slide the fin drive into the slot once there is enough clearance in the water. Make sure **Position 1** is facing toward the seat. Then close the two side latches to lock it in place.

SAFETY GUIDELINES



Please read this information carefully before using your kayak. Kayaking is physically demanding and can be dangerous. Participation in paddle sports carries the risk of serious injury or even death. Before going on the water, seek qualified instruction in paddling techniques, water safety, and first aid.

1. **Weather and Water Conditions**

Always check weather and water conditions before boating. This kayak is designed for sheltered waters, lakes, and slow-moving streams only. It is **not** intended for whitewater use. Never paddle in severe winds, rain, thunderstorms, choppy waters, strong currents, flood conditions, or in tidal areas that could prevent you from steering or returning safely to shore.

2. **Wear a Personal Flotation Device (PFD)**

Every passenger must always wear a U.S. Coast Guard-approved PFD while using this kayak. Read the PFD manufacturer's instructions carefully and ensure you understand how to properly fit and wear it.

3. **Avoid Alcohol and Drugs**

Never use alcohol, drugs, or any substance that could impair your coordination, judgment, or ability to operate the kayak safely.

4. **Sound Signaling Device**

Regulations require boaters to carry a sound device to alert others of their presence. Keep one in your kayak at all times, ideally attached to your PFD.

5. **Remain Seated**

Never stand up in the kayak, as this may cause it to capsize. If the kayak capsizes, it is generally safer to stay with the boat than to attempt swimming to shore.

6. **Know Your Limits**

Be realistic about your physical ability—how far and how long you can paddle or swim—before setting out.

7. **Slippery Surfaces**

The hull can be extremely slippery when wet. Wear slip-resistant footwear and remain centered in the kayak.

8. Cold Water and Hypothermia

Cold-water accidents are highly dangerous. Hypothermia can occur within minutes in 35°F (2°C) water. Always dress for the conditions and use a wet or dry suit in cold weather.

9. Never Paddle Alone

Always paddle with a partner. Tell someone your trip plan, including your route, duration, and the number of people in your group.

10. Supervision of Minors

Children should never use this kayak without direct adult supervision.

11. Know the Waterway

Familiarize yourself with the body of water before paddling. Check boating hours, hazardous conditions, and emergency support locations.

12. Follow Laws and Regulations

Always comply with Coast Guard, state/provincial, and local boating laws, including requirements for safety equipment such as lights and sound devices.

13. Check Drain Plugs

On models equipped with a drain plug, ensure it is secure before launching. Drain any accumulated water from between the deck and hull after use.

CARE AND MAINTENANCE

STORAGE

- Store your kayak on a flat, soft surface to prevent warping.
- If storing outdoors, keep it covered to protect from weather.
- Minimize direct sunlight exposure while in storage.
- After use in salt water, thoroughly rinse the kayak and all metal parts with fresh water.

ⓘ **Warning: Salt water can cause corrosion, even on stainless steel. Wash carefully every time after use.**

TRANSPORT

- Secure the kayak firmly during transport.
- Avoid applying excessive pressure when strapping it to a rack. So, the joint will not receive too much pressure.
- For tandem setups, always strap/latch the middle section separately.
- Never drag the kayak on hard surface including gravel.