

ROBUST-AIRE™

Kasco®

MOVING WATER FORWARD, SINCE 1968

NEW

Aire-Guard Cabinet
Technology now
Available in Large and
Medium Cabinets

(patent pending)

ROBUST-AIRE™ DIFFUSED AERATION SYSTEMS

Restore your water body's natural ecosystem by adding beneficial water mixing and movement with Robust-Aire™. A shore-mounted compressor pushes air through self-weighted lines to a diffuser at the bottom of the pond, lake, or tank. This induces oxygen transfer and beneficial mixing to prevent weed overgrowth, algae, unpleasant odors, fish kills, and other issues.

kascomarine.com



The Longest Lasting,
Most Efficient Diffuser

Contact us today to learn more | 715.262.4488 | sales@kascomarine.com

VITAL MIXING

FOR YOUR WATER

- Includes 1-12 diffuser assemblies, compressor(s), and compressor mounting option (some models include tubing)
- No electricity required in water, making it safe for swimming
- Self-weighted diffuser will land right-side-up every time
- Lifetime warranty on diffuser and cabinet
- 15-year warranty on tubing
- 3-year warranty on compressor motor
- 2-year warranty on compressor piston cups and cylinders

Water is entirely mixed for consistent temperature and stable environment



Diffuser membrane will not clog, reducing maintenance



11-44% More efficient than competition
(3rd-party tested)

34% Quieter than previous models

Most efficient at 8 ft. or deeper

Dual loop diffuser provides high volumes of upward water movement

The longest-lasting, most efficient diffuser on the market

Great for residential, commercial or industrial settings with power nearby or a long distance away.

Improves water clarity, decreases muck, expands fish habitat, and much more.

Pair with Pond Probiotics for maximum water quality improvement.



NEW

SYSTEMS WITH AIRE-GUARD CABINET TECHNOLOGY

Introducing Robust-Aire™ with patent-pending Aire-Guard Cabinet Technology. With innovative airflow, these durable systems operate at lower internal temperatures, are easier to keep clean, and will withstand the toughest outdoor conditions.



Large cabinet



Medium cabinet

INSIDE AIRE-GUARD CABINET TECHNOLOGY

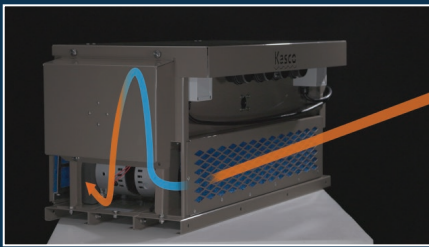

PURPOSEFUL AIRFLOW

Air is immediately filtered to remove dust and debris. This clean air is then pulled through the compressor allowing it to stay cooler and operate efficiently.



With Aire-Guard Technology

Without Aire-Guard Technology

SUPERIOR COOLING

The compressor on the left is using Aire-Guard Cabinet Technology and is almost 40° cooler than the compressor on the right.

Two cabinet sizes

Available in medium and large cabinet. Medium cabinets run 4 - 6 diffusers, large cabinets run 7 - 12 diffusers.

Built to last

Increased filtration and cooling abilities allow systems to withstand wind, heat, rain, and dust.

External filtration

Large filters mounted on the outside of the cabinet ensure clean air and a clean cabinet interior.

Innovative airflow

Powerful fans blow clean air through compressors for superior cooling.

Externally mounted indicators

Gauges (large cabinets), valves, and filter maintenance indicators are externally viewable for easy status checks.

No assembly required

Cabinets arrive fully assembled and ready for service.

Patent pending technology

New color blends with environment

Airflow safeguards compressor motor

Compressor cabinet details on next page.



EASY COMPRESSOR MAINTENANCE

Large air filters allow for easier, less frequent cleaning. A visual maintenance indicator on the air filter turns red when cleaning is needed.



EXPERT SIZING & LAYOUT ASSISTANCE

Contact our experts for a custom Robust-Aire™ layout at no charge. Using an aerial view of your pond or lake, our team will suggest the right system for your application.

COMPRESSOR CABINET DETAILS

NEW LARGE CABINET WITH AIRE-GUARD CABINET TECHNOLOGY

Kasco's largest cabinet option can accommodate 3 - 4 compressors and supplies air to 7 - 12 diffuser assemblies. Mount on shore, away from areas that may flood.

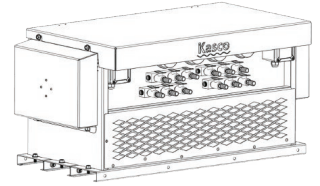

NEW MEDIUM CABINET WITH AIRE-GUARD CABINET TECHNOLOGY

Kasco's new medium cabinet option accommodates 2 compressors and supplies air to 4 - 6 diffuser assemblies. Mount on shore, away from areas that may flood.

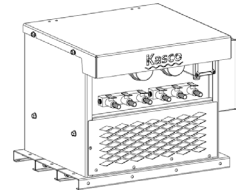

BASE MOUNT CABINET

Accommodates up to 2 compressors and supplies air to 1 - 6 diffuser assemblies. Mount on shore, away from areas that may flood.

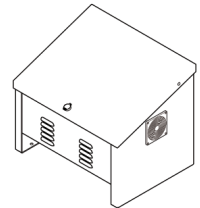

POST MOUNT CABINET

Accommodates 1 compressor and supplies air to 1 - 3 diffuser assemblies. Attach cabinet to post or vertical wall with included hardware.

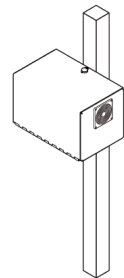

NO-CABINET

Accommodates 1 compressor and supplies air to 1 - 3 diffuser assemblies. Mount in a clean, dry location with protection from outdoor conditions.

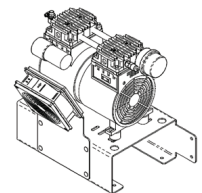

Contact Kasco today to determine the best Robust-Aire™ system for you.

Kasco®

MOVING WATER FORWARD, SINCE 1968

715-262-4488
kascomarine.com
sales@kascomarine.com