

The Wick 4-Weekly

What, When, Where, & Who of Village Life

Check out this month's village news, and share your news items with us –

EWVA_Committee@outlook.com



Printed copies of this newsletter available from the Village Pharmacy, Hair by Us, and the Corner Café

Welcome to November's edition of *The Wick*.

I think the biggest event this past month has been the Fireworks last weekend. An amazing bonfire and firework display put on by the Firework committee for the Eton Wick community. This year the committee selected the Youth Club to be the recipient of the donations from the night. About 10 Youth Club children with adult helpers turned up on the night, and, armed with charity buckets, sweets, and glow sticks, they collected more than £2000 for the Youth Club. This is an amazing amount and will be gratefully received by the club. It will be spent on activities, art equipment, cooking ingredients etc.

The hanging baskets have been taken down, and in their place are the lamppost poppies. The baskets have given an amazing floral display this summer. We were so lucky to have had so many people, and local businesses, donate money to pay for the 2024 display of 16 baskets on 8 lampposts. A few weeks ago, we had a community Bingo night which was open to all ages. It was such a lovely evening with lots of laughter and chats. The night raised £568 for next years basket displays and the money raised will be spent on brackets to support the baskets on the lampposts. In 2025 we want to try and extend the display along the length of the Eton Wick Road, from the church to the cattle grid. We will be having another Bingo fund raising event at Easter so please do try and come along. We will advertise this nearer the time.

Upcoming events:

- *The Remembrance Service in Eton Wick is on Sunday 10th November. At 2.30pm there will be wreath laying at the commemorative stone by the youth organisations of the village and Eton Wick Village Association. This will be followed by a 3pm service of remembrance at St John the Baptist church. All welcome.*
- *The Eton Christmas light switch on is on Thursday 14th November. The event starts around 5pm, and the light switch on is at 7pm in Jubilee Square. This is a very busy event with road closures so plan before you leave as I do not imagine there is any parking. It is good fun and is a gentle reminder that Christmas is on its way!!!*
- *The Eton Wick Christmas light switch on will be on Saturday 30th November at 5pm. There will be entertainment from 4pm by the Christmas tree at Bell Lane shops. The RCCG church choir will be singing Christmas songs for us, Era Academy of Performing Arts will be performing, and Santa himself will be coming along to start the festive season for everyone. Please do come along as it is a lovely event. Afterwards there will be refreshments served in the Village Hall. Mulled wine, tea, coffee, and mince pies will be available to all free of charge, however we would be grateful for donations to pay for next year's event. EWVA hope to see as many of you as possible from the village.*

Lucy Ludovici

Chair, Eton Wick Village Association



Eton Wick Youth Club meets from 6pm to 7.45pm every Monday during term time on the ground floor of Eton Wick Village Hall. Ages from 8-14, subs only £1.50 per session, and an excellent value tuck shop. No additional charge for any activities.



EWYC was a chosen charity for the Eton Wick Fireworks which took place on Saturday 26th October. What a fantastic display and great evening. Our young members, ably assisted by their parents and our volunteers, shook collection buckets, and handed out glow sticks and chocolate bars to children.



Our winter term will have our usual mix of festive activities, including opportunities to make decorations and greeting cards. Hopefully, some culinary creativity too - decorating biscuits proved extremely popular last year as these photos show ... although only a few Christmas cookies made it home.

EWYC-Committee@Outlook.com

<https://www.facebook.com/EWYouthClub>



Weed growth throughout the period of 2023 to 2024 demonstrated to Thames Water (TW) that if weed cutting is not undertaken flooding will remain an issue. TW organised for a specialist company to clear the weed this year at a cost to them of circa £60k, which covered two cuts. The Environment Agency (EA) would not allow access for weed clearance until the end of the fish spawning season and work commenced on 17th June 2024 which was the earliest allowed date. The second cutback and removal of weed, which we expected to take place in September or October, will now start w/c 4th November.

We have an update from TW regarding planned improvements to the Slough Treatment Works (STW). TW acknowledges that STW is due for an upgrade and state that whilst it may seem that no work has been happening, behind the scenes a lot of engineers and designers have been working to find a solution that does not just shift the problem from location A to location B. The original proposal to route the wastewater through a tunnel from STW directly to the Thames has been shelved, and the revised plans are to implement a robust solution to process and treat the incoming sewage on a flow to fall basis.

So, what does that mean? TW advise that whilst the amount of effluent discharged will increase, the output will be much lower in ammonia, lower in phosphorus, and lower in particulates. There will be greater odour control and the high nutrient levels that have fed the weed growth resulting in spring and summer flooding will be removed before the water is released into the Roundmoor to make its journey to the Thames.

New storage and treatment tanks and other infrastructure are proposed to be built at STW as can be seen from the plan (existing in black, new in red). TW advise that this is a complicated build in a live working environment with hazardous areas so there are risks for which they must plan. This is not only for the safety of the live operations staff, the builders, and engineers, but also to ensure that no part of the facility is taken out of service without that process being able to run in a safe manner to protect the works and the environment.

Slough STW Site Layout

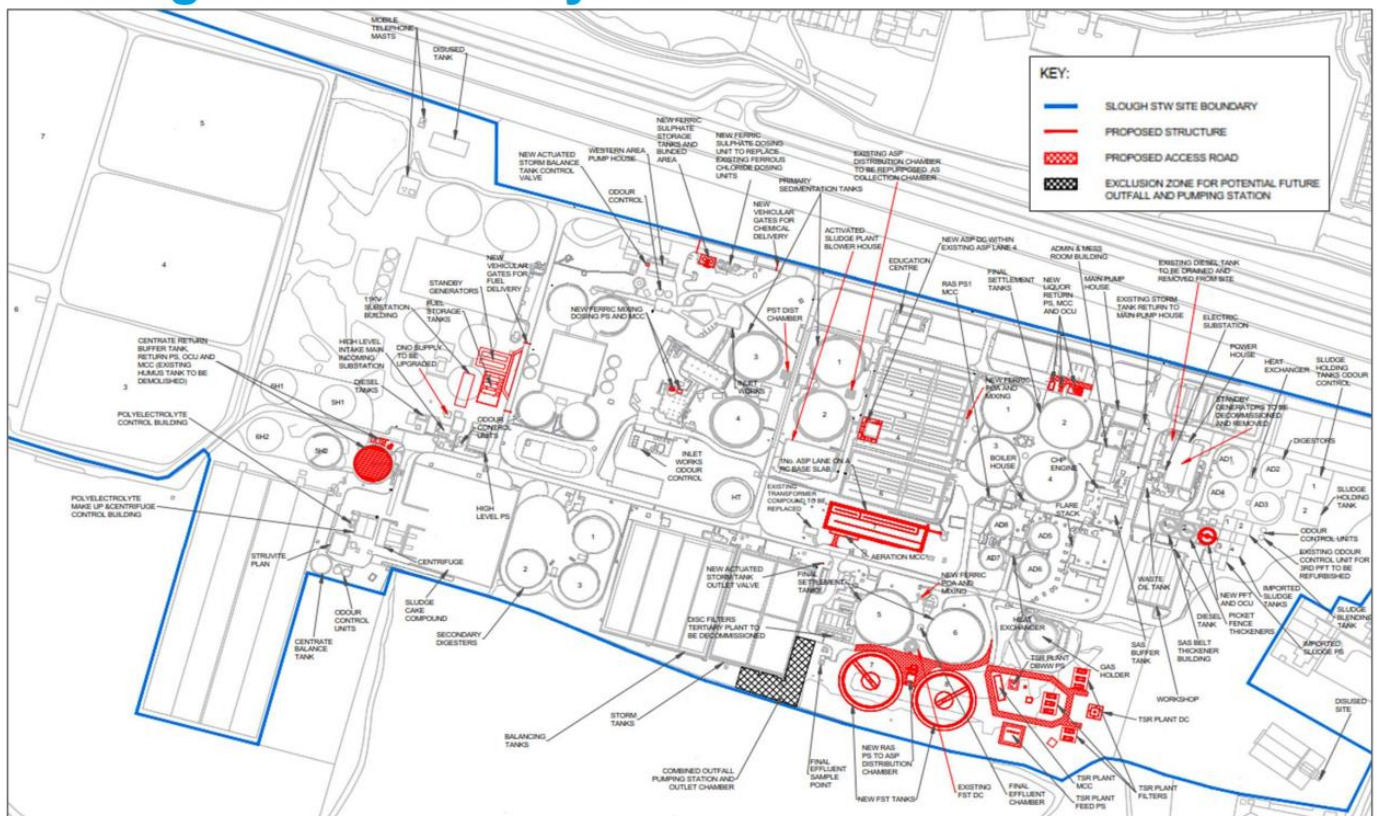

They plan to make their final contractor selection for these works at the back end of 2024 with contract award around March 2025. There will then be 12 months of designing from the contractor with the build starting in 2026. Some works have already started on site as you might have seen. Meetings between senior project managers at TW and SSE (energy provider) have resulted in an earlier date for the additional power supply installation.

Visit the EWWG page of the village website for more detail from TW on the STW project – [click here](#). EWWG will keep you informed as more information from TW becomes available.

Please contact us at info@etonwickwaterwaysgroup.org if you would like to join us in campaigning or volunteering in any capacity. Plus, find us on the village website, and on Facebook, links below.

<https://ewva.org.uk/ew-waterways-group>

<https://ewva.org.uk/https://www.facebook.com/EtonWickWG>

Environment Agency incident hotline – call 0800 80 70 60 (24-hour service)



We had a great term exploring colour and the seasons and have welcomed many new faces into our setting. The children loved exploring our very own pumpkin patch in the environmental garden and got to take them home to decorate. We look forward to seeing everyone's creations.

Thank you to the firework committee who took delivery of our very own Guy Fawkes created by the children. He looked fab on top of the bonfire on

Saturday with the Guy from Eton Wick Youth Club. We are excited to be approaching the festive season with lots planned so keep your eyes peeled on our social media for what we are up to.

Facebook: [littlepreschool&wraparoundcare](#)

Instagram: [littleme.preschool_etonwick](#)

Tik-Tok: [little.me.preschool.23](#)

We look forward to welcoming many more families into our setting. Please feel to contact us for all your childcare needs. Littlepreschool9@gmail.com

**Wreath making
Workshop**

**30TH NOVEMBER 2024
2PM - 4PM
ETON WICK COFE FIRST SCHOOL HALL**

£20 PER PERSON
includes all materials and a free drink

*all proceeds go to Friends of
Eton Wick School Charity*

*registered charity number:
309540*

Come along to the **Eton Wick Football & Social Club**, open Wednesday to Sunday every week. It is great value and brings regular community activities and live music to our village. Opening hours as below.

Monday & Tuesday – closed
Wednesday & Thursday – 4pm to 10.30pm
Friday – 4pm to 11pm
Saturday – 12 noon to 11pm
Sunday – 12 noon to 9.30pm

See the EWF&SC Facebook page for information on forthcoming social and soccer events.

<https://www.facebook.com/groups/391970034327592/>



Local Crime Incidents

Please find below the incidents reported in Eton and Eton Wick during the last month. If you have any information around these incidents, or would like to report a different incident, please call 101 or visit the police website - <https://www.thamesvalley.police.uk/> If it is an emergency, please call 999.

30 September – Rural Crime – Cornwall Close, Eton Wick

Reports of ‘lamping’. The neighbourhood team are aware and are dealing with this. The Rural Crime team have also been informed. Investigations are ongoing.

2 October – Suspicious Vehicle – Meadow Lane Car Park, Eton

A vehicle was reported left with its doors open.

7 October – Criminal Damage – Tudor Stores, High Street, Eton

Bike damaged, it appears someone had tried to steal the wheels.

Below is a link to the email address to sign up to get ‘TV ALERT’ emails with crime prevention advice and neighbourhood updates. Please register for information relevant to where you live and in what you are interested. Our local police sergeant posts bi-weekly updates on the neighbourhood team’s activity.

[Home Page - Thames Valley Alert](#)

[Windsor Central | Your area | Thames Valley Police | Thames Valley Police](#) – this is you can report ASB, and other non-emergency crime on-line.



For details of local planning applications, the link below takes you to the “Find a planning application” page of the RBWM website.

<https://www.rbwm.gov.uk/home/planning-and-building-control/find-planning-application>

You need to enter the reference, shown below, to find details for each individual application, or you can type Eton Wick into the location search bar and view a summary of all current applications.

Reference - 24/02489/Full – application validated 17 October 2024 – awaiting decision

9 Inkerman Road, Eton Wick, Windsor SL4 6LE

Part single part two storey side/rear extension following demolition of existing elements.

(No other new applications since the October newsletter.)

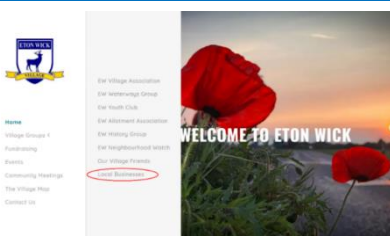

Are you a village resident and local trader? A beautician, plumber, electrician, mechanic, hairdresser, gardener, financial adviser, or something else. Do you want to advertise your services to our community? If yes, contact us for space on the Eton Wick Village website. PLUS, we can add a local trader’s section to the bottom of this e-newsletter, again please contact us if you want to promote your services to the Eton Wick community.

EWA_Committee@outlook.com

CHRISTMAS FAIR
Santa, Shop & Sip!

RAFFLE. GAMES. STALLS. FOOD & DRINK.
Free Entry

Santa's Grotto
£6 per child to meet Santa*
£3 per additional child

Scan here to book your Santa's Grotto Ticket
(includes 1 group photo with Santa & 1 gift per child)



or visit pta-events/friendsotetwonwickschool

Eton Wick CofE School Hall
Saturday 7th December
12pm - 2.30pm

*Fully DBS checked
Registered charity number: 309540
All money raised goes to Eton Wick CofE First School

Eton Wick Village Hall
Regular hirers and their contact details

	Morning	Afternoon	Evening
Mon		Short Mat Indoor Bowls 2 ~ 4pm Chris 01753 863190 Dave 01753 863710	6 ~ 7pm Yoga/Pilates 7.15 ~ 8.15pm Yoga/Pilates Michelle Jones 07791 346 298
Tue	9.30am ~ 10.30am Pilates		6.30pm ~ 8pm Ashley Jansen School of Traditional Karate 07963 433 643
Wed	9am ~ 10am Body Conditioning Michelle Jones 07791 346 298		The History Group 7.30pm (5 events per year)
			Eton Wick Village Association 7.30pm several times a year
Thu	Art Group 10am ~ 12 noon Sandra Drummond 01753 857492		Susan Handy School of Dance 07515 270 432 Modern & Tap Classes and Commercial and Theatre Jazz
Fri	9.45am ~ 10.45am Fit Steps Fab No partner needed. For all who love to dance and keep fit Michelle Jones 07791 346 298	[Private booking] Art Tutorials Two 8-week courses Spring & Autumn	Enchanted School of Dance 07702 268 729 Junior Musical theatre (4-6 years) 3.45 ~ 4.15pm Senior Musical theatre (6-10 years) 4.30 ~ 5.15pm Senior Cheerleading (6-10 years) 5.15 ~ 6pm
Sat	Available for hire *		
Sun	Available for hire *		

If you are interested in any of the groups/classes held in the hall, they would be pleased to hear from you. For more information or to book the hall please visit our website: www.etonwickschool.com or phone 07949 147 846

***Please note it is often necessary to book months in advance to hire the hall for a Saturday or Sunday booking.**



If you have a neighbour who is not online, please let them know they can collect paper copies of this newsletter from Eton Wick Pharmacy, Hair by Us, and the Corner Café in the village centre. You could pick up a copy for them to help them stay connected with local information.

If you are a member of a local group that would like to be included in this newsletter, please do get in touch. Our vision is for the newsletter to be all-inclusive, collaborative, and mutually supportive ... representing our whole community.

We include useful local information links at the end of the newsletter for your information and convenience. Thank you for reading.

Secretary EWVA - Helen Branscombe-Davies



CONTACT DETAILS FOR VILLAGE SHOPS & LOCAL SERVICES

The Village Pharmacy – 01753 863575

South Meadow Surgery, Eton – 01753 864545

Hair By Us – 01753 831957

Jade Garden Fish & Chips + Chinese Takeaway – 01753 850991

Royal Spice – 01753 830260

Pipedreams – 01753 865682

Ella's Party Shop – 01753 378418

Eton Wick Post Office (located inside Nisa) – 01753 863631

Little Me Preschool and Wrap Around Care – 07526 303103

GingerJolley Pre-School – 07716 664933

The Greyhound – 01753 868633

More information on the “local retailers and businesses” page of the village website, link below:

<https://ewva.org.uk/local-businesses>

USEFUL LINKS

Eton Town Council

<https://www.etoncouncil.gov.uk/>

RBWM Report-It

<https://www.rbwm.gov.uk/home/apply-pay-report/report-it>

Thames Valley Police - Report a Crime

<https://www.thamesvalley.police.uk/ro/report/ocr/af/how-to-report-a-crime/>

Local Bus Services

<https://www.rbwm.gov.uk/home/transport-and-streets/public-transport/bus-routes>

<https://www.thamesvalleybuses.com/services>

<https://www.slough.gov.uk/buses>

RBWM Highways Works

<https://www.rbwm.gov.uk/home/transport-and-streets/roads-and-pavements/council-works-highway-week>

For all local roadworks, including work by utility firms visit One Network

<https://one.network/>

Household Waste Collection Information + Bin Collection Day

<https://www.rbwm.gov.uk/home/environment-and-waste/recycling-and-rubbish/household-rubbish-collections>

<https://www.rbwm.gov.uk/binday>

Thames Water – Report a Problem

<https://www.thameswater.co.uk/help/report-a-problem#/view-and-report-problems>

Reporting environmental incidents, including pollution and damage to the natural environment.

<https://www.gov.uk/report-an-environmental-incident> - or call the 24/7 hotline 0800 80 70 60

Age UK may be able to provide you with direct support. The services and facilities on offer vary from area to area, but can include: • information and advice • help at home schemes • befriending schemes • advocacy services • handy person schemes • nail-cutting services • transport schemes • help with claiming benefits • exercise classes • day centres.

www.ageuk.org.uk – or call 0800 169 6565

Citizens Advice have a national network of centres offering free, confidential, and independent advice, face-to-face or by telephone. Visit the website for full information and to find the nearest Citizens Advice Bureau.

www.citizensadvice.org.uk – or call 0800 144 8848

MoneyHelper - gives impartial information about financial products and services and offers tips on everyday money management.

www.moneyhelper.org.uk – or call 0800 138 7777

Action Fraud - National reporting centre for fraud and internet crime. Use the online fraud reporting service and get a police crime reference number. Call the helpline for advice on preventing fraud and how to report it if it happens to you. www.actionfraud.police.uk – or call 0300 123 2040

