

Promix Isolated CANBus Sniffer & Extension Harness - 190829

1. Please insure the CANBus Protocol is available for the Truck you are installing the module too. First located the CANBus Body Builder Plug normally a Green and Yellow wires as shown. If you're not sure contact WoodTech Electronics or your truck manufacture.

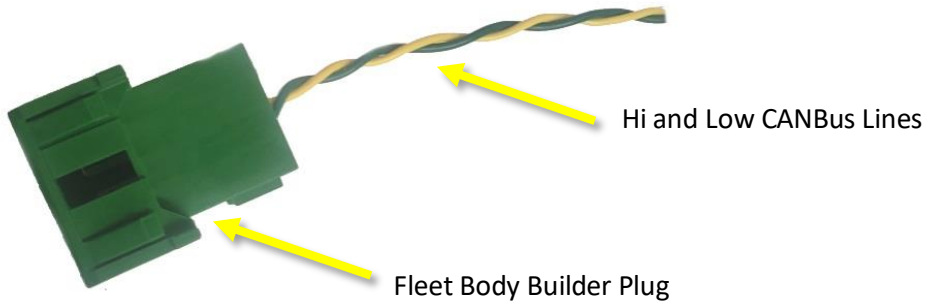

2. Grab the Promix Isolated CANBus Reader Module you will see marked on each side of the board is CAN L(Low) and CAN H(High)

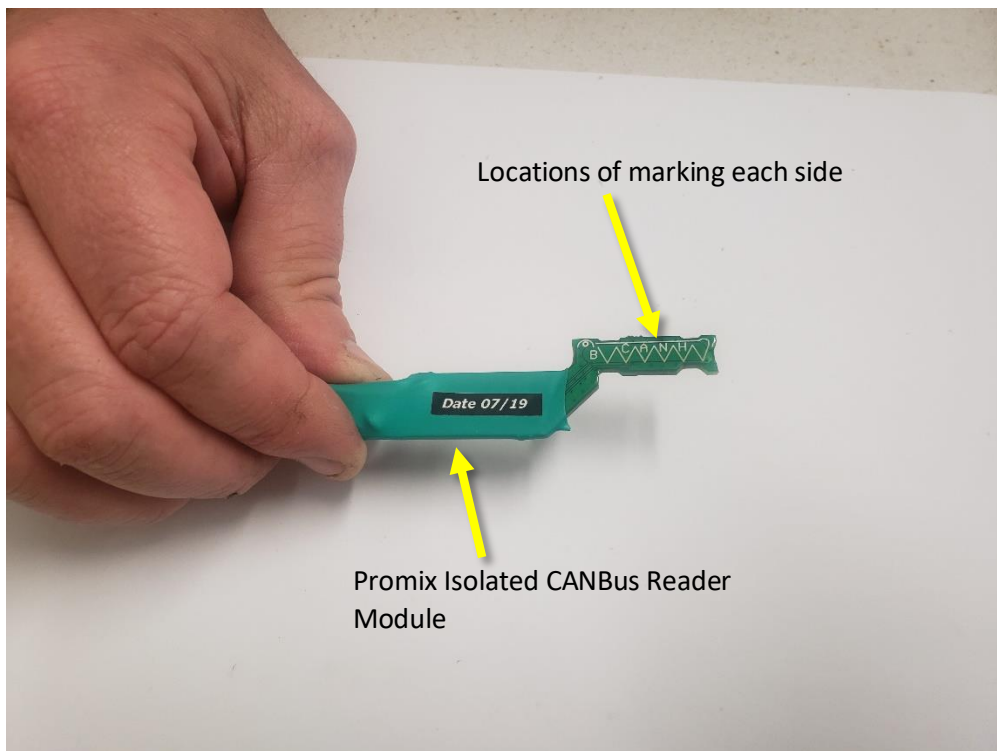

Promix Isolated CANBus Sniffer & Extension Harness - 190829

3. Place the Yellow Wire (CAN Hi) over the CAN H (High) side of the board as shown
Important Note: Do not place wires together on the same side or place them incorrectly.

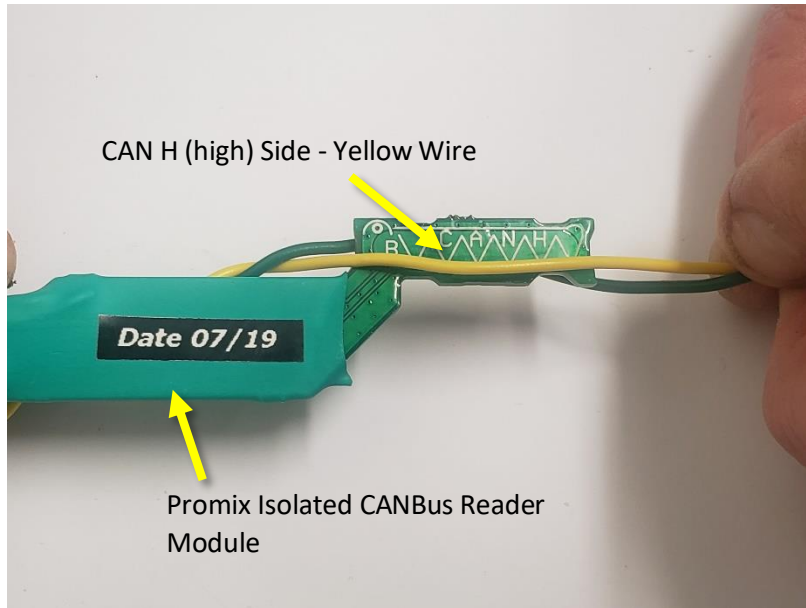

4. Place the Green Wire (CAN Lo) over the CAN L (Low) side of the board as shown
Important Note: Do not place wires together on the same side or place them incorrectly.

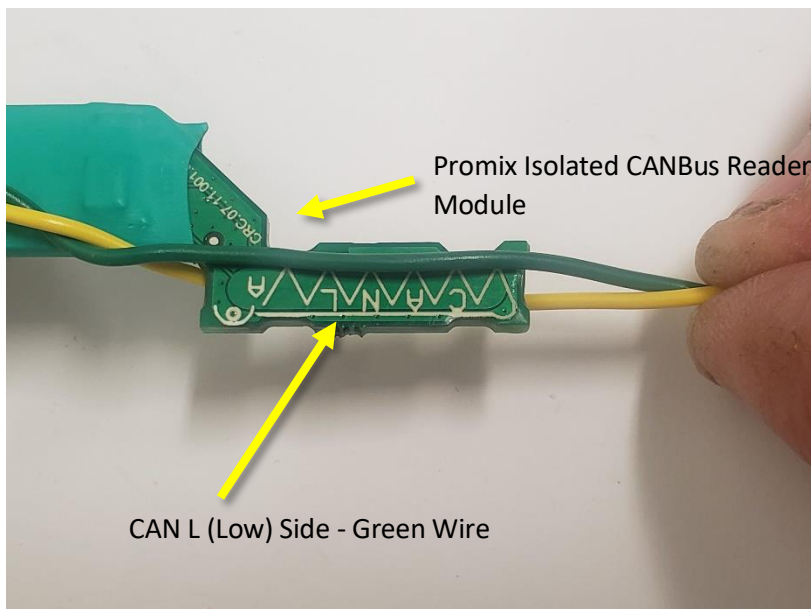

Promix Isolated CANBus Sniffer & Extension Harness - 190829

- Using the 2 small zip ties supplied in the cable kit, place them around the wires and inside the grooves as shown this secure the 2 wires onto the Promix Isolated CANBus Reader Module.

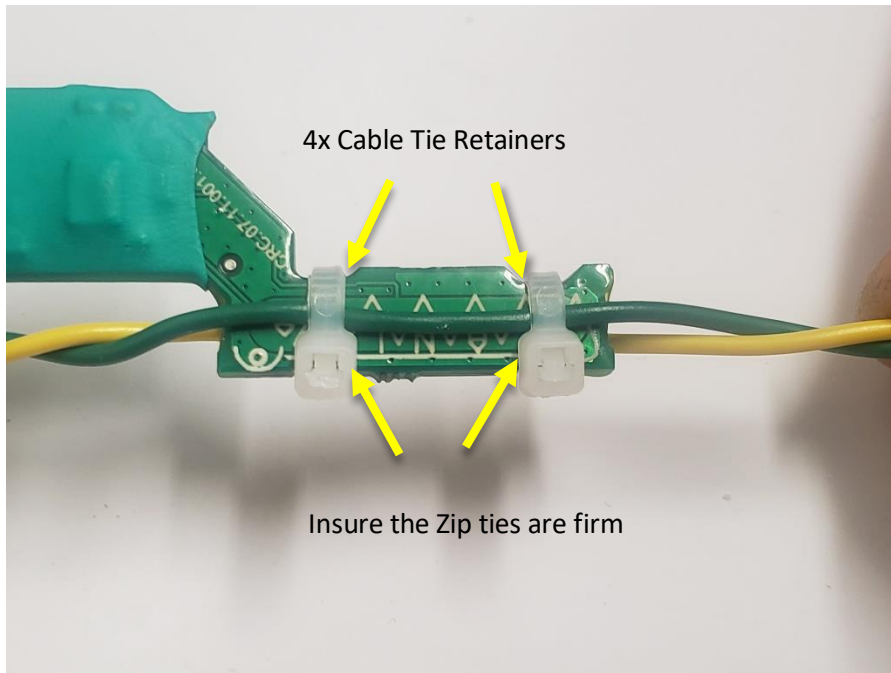

- Please secure the other side of the Promix Isolated CANBus Reader Module with a small zip tie supplied in the cable kit.

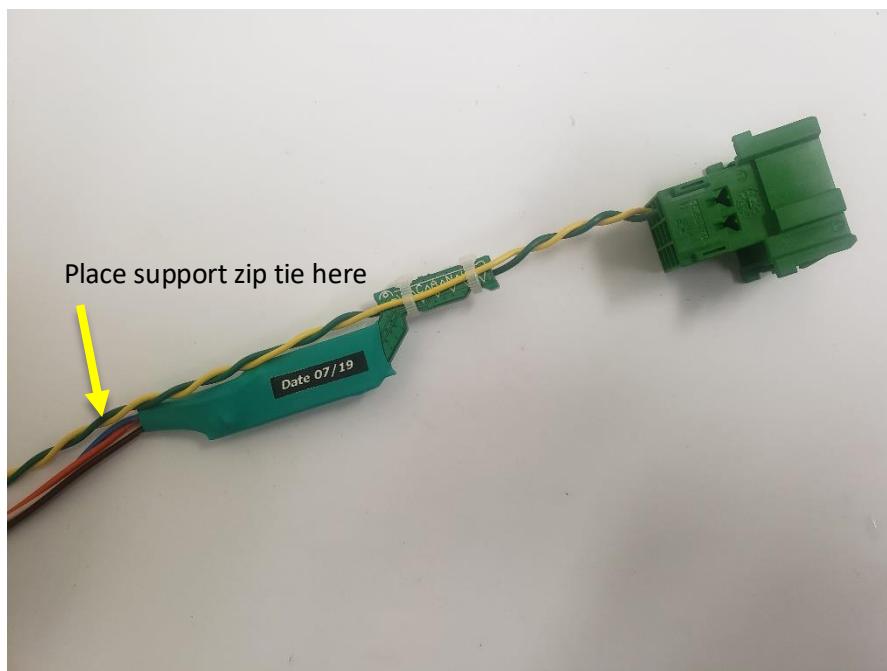

Promix Isolated CANBus Sniffer & Extension Harness - 190829

CANBus Reader Module Harness to Promix Vehicle Hardness Connections as shown

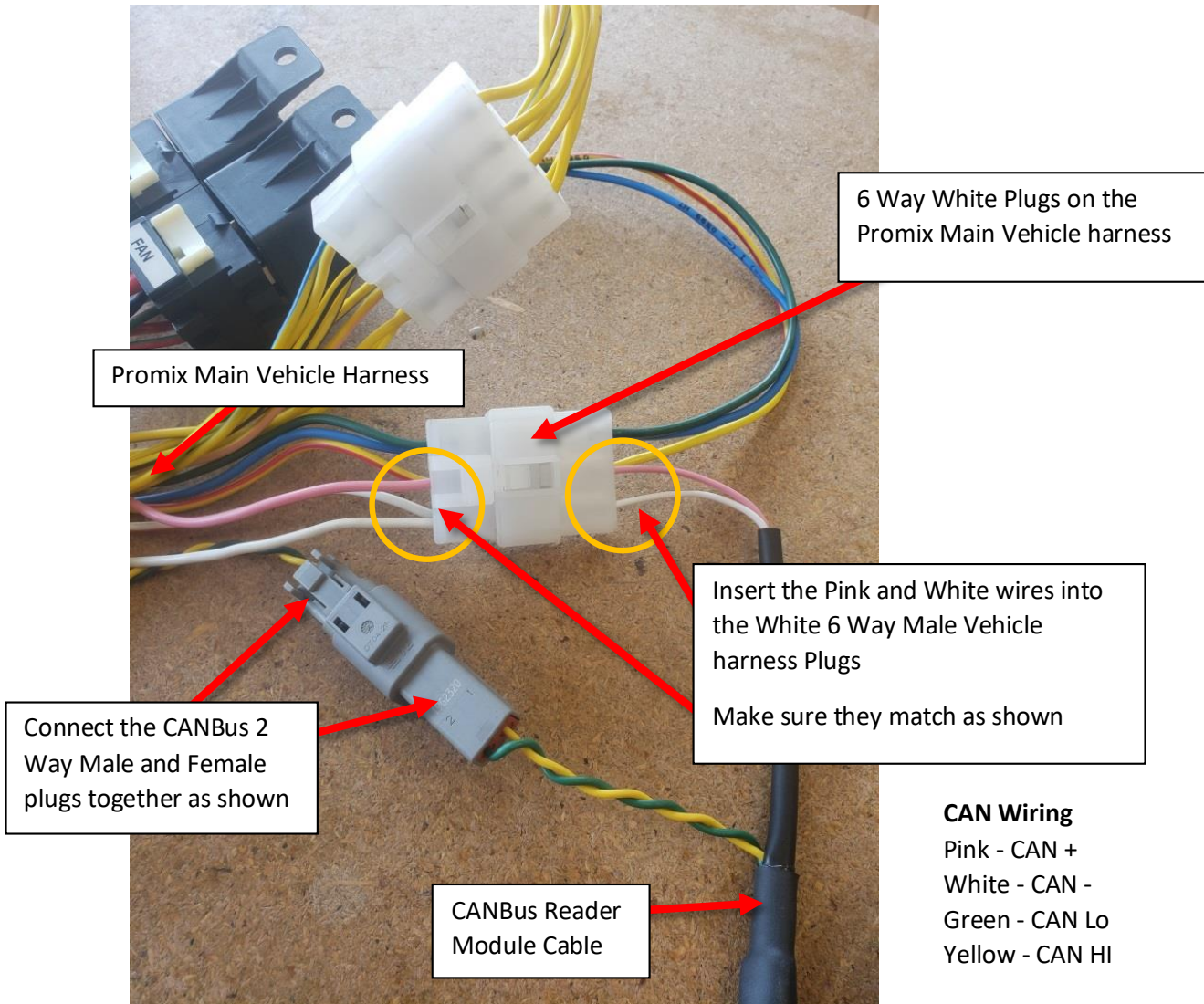

Other Important Note:

1. The Promix Isolated CANBus Reader Module cable plugs straight into the Standard Promix Vehicle harness requires no modifications to the standard harness.
2. Insure your Promix LCD Cab Box setting via the LCD are set for the required CANBus Inputs.
3. If using a Promix SD Cab Box its must have a standalone CANBus Interface Module fitted if not can be purchased separately found on our website - <https://woodtech.net.au/spare-parts>

4

WOODTECH ELECTRONICS

Phone: 07 38882998 – email: enquiries@woodtech.net.au

Address: 8 Osborne Drive, Burpengary Queensland 4505

Web: www.woodtech.net.au

Promix Isolated CANBus Sniffer & Extension Harness - 190829

Wiring Drawing for the CANBus Sniffer Extension Cable

CANBus Sniffer Extension Harness

Top View 4 Way Plug

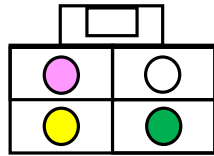
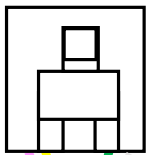

**Plug Rear View
(Sniffer Extension Cable)**

4 Way White Plug - Sniffer Extension Cable	Wire	Topic
Top Left	Pink	VBATT
Top Right	White(Gray)	GND
Bottom Left	Green	CAN Low
Bottom Right	Yellow	CAN High

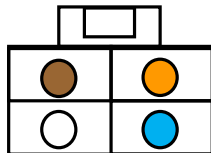

**Plug Rear View
(CANBus Sniffer Cable)**

4 Way White Plug - CANBus Sniffer Cable	Wire	Topic
Top Left	Brown	VBATT
Top Right	Orange	GND
Bottom Left	White	CAN Low
Bottom Right	Blue	CAN High



2 Way CANBus Connector

Connects to the CANBus 2 Way on the Promix Main Harness - See Photo Above



White and Pink Wires

Connect to Promix Main Harness 6 Way Male White Connector – See Photo Above