

# Manual Transmission 217 NG Diesel (GS6-17DG)

MT00026, MT00027, MT00028

OEM No: 23008610983; 23008610985; 23008610986

## Brands

Brand	Modelseries
BMW	1; 2; 3; 4; X1

## List of parts

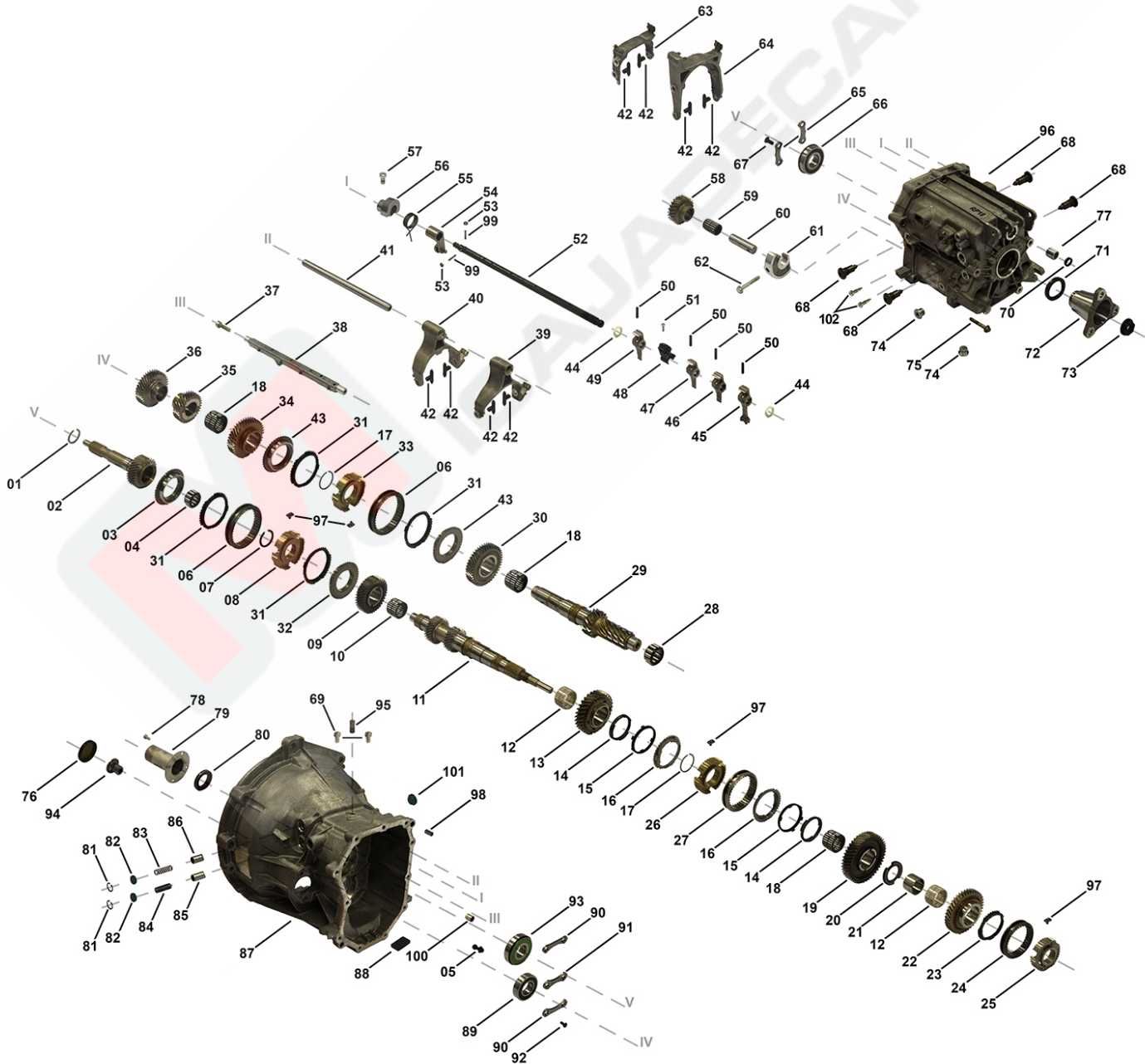

# Manual Transmission 217 NG Diesel (GS6-17DG)

MT00026, MT00027, MT00028

OEM No: 23008610983; 23008610985; 23008610986

## List of parts

Pos	Part number	OEM no	Quantity	Product name	Info
'I01	MT00026	23008610983		OE References	23007630703, 23008610983 (GS6-17DG - TBF2)
'I02	MT00027	23008610985		OE References	23007566731, 23007604373, 23007626295, 23008610985 (GS6-17DG - BGO)
'I03	MT00028	23008610986		OE References	23007566729, 23007604371, 23007626292, 23008610986 (GS6-17DG - BG8)
'K01	SP02713		1 piece	Bearing Kit	Contains position 04, 10, 12, 18, 21, 28, 59, 66, 89, 93
'K02	SP02715		1 piece	Sealing Kit	Contains position 70, 71, 74, 76, 80, 82, 101  Information for BMW 217 NG (6GS-17BG): Used in 23007633986
'K10	SP02519		1 piece	Synchroniser Body ASM (1st and 2nd Gear)	Contains position 26, 27, 97 (3pcs.)
'K11	SP02514		1 piece	Synchroniser Body ASM	Contains position 06, 08, 31 (2pcs.), 97 (3pcs.)
'K13	SP02503		1 piece	Synchroniser Body	Contains position 33, 06, 31 (2.pcs), 97 (3pcs.)
'K15	SP02525		1 piece	Synchroniser Body ASM (Reverse Gear)	Contains position 24, 25, 97 (3pcs.)
'K17	SP02520		2 pieces	Friction System	Contains position 14 (1pce), 15 (1pce), 16 (1pce)
'K18	SP02535		1 piece	Selector Shaft	Contains position 45, 46, 47, 49, 50 (4pcs.), 52, 99 (2pcs.)
'K20	SP02533		1 piece	Shift Fork 1/2 Gear	Contains position 40, 42 (2pcs.)
'K21	SP02529		1 piece	Shift Fork 3/4 Gear	Contains position 63, 42 (2pcs.)
'K23	SP02534		1 piece	Shift Fork Reserve Gear	Contains position 39, 42 (2pcs.)
'K24	SP02530		1 piece	Shift Fork 5/6 Gear	Contains position 64, 42 (2pcs.)
001	SP02498		1 piece	Snap Ring	
002	SP02495		1 piece	Shaft Input	
003	SP02496		1 piece	Synchroniser (Clutch Body)	
004	Only available in K01		1 piece	Needle Ring	
005	SP02362		1 piece	Bolt	Information for BMW 217 NG (GS6-17BG): Used in 23007626306, 23007626315, 23007626310
006	Only available in K11 & K13		1 piece	Shifting Collar	
007	SP02516		1 piece	Snap Ring	
008	Only available in K11		1 piece	Synchroniser Body 3/4 Gear	
009	SP02512		1 piece	3rd Control Gear	
010	Only available in K01		1 piece	Needle Ring	
011	SP02510		1 piece	Output Shaft	
012	Only available in K01		2 pieces	Needle Ring	
013	SP02518		1 piece	2nd Control Gear	
014	Only available in K17		2 pieces	Conical Ring	
015	Only available in K17		2 pieces	Friction Ring	
016	Only available in K17		2 pieces	Synchronizer Ring	
017	SP02505		2 pieces	Snap Ring	
018	Only available in K01		3 pieces	Needle Ring	
019	SP02521		1 piece	1st Control Gear	
020	SP02522		1 piece	Thrust Washer	
021	Only available in K01		1 piece	Inner Ring	
022	SP02524		1 piece	Reverse Control Gear	
023	SP02526		1 piece	Synchroniser Ring	

# Manual Transmission 217 NG Diesel (GS6-17DG)

MT00026, MT00027, MT00028

OEM No: 23008610983; 23008610985; 23008610986

## List of parts

Pos	Part number	OEM no	Quantity	Product name	Info
024	Only available in K15		1 piece	Shifting Collar Reverse Gear	
025	Only available in K15		1 piece	Synchroniser Body Reverse Gear	
026	Only available in K10		1 piece	Synchroniser Body 1/2 Gear	
027	Only available in K10		1 piece	Shifting Collar 1/2 Gear	
028	Only available in K01		1 piece	Roller Bushing	
029	SP02499		1 piece	Layshaft	
030	SP02501		1 piece	6th Control Gear	
031	SP02515		4 pieces	Synchroniser Ring	
032	SP02513		1 piece	Synchroniser (Clutch Body)	
033	Only available in K13		1 piece	Synchroniser Body 5/6 Gear	
034	SP02507		1 piece	5th Control Gear	
035	SP02506		1 piece	Fixed Wheel	
036	SP02508		1 piece	Sprocket	
037	SP02541		1 piece	Screw	
038	SP02540		1 piece	Locking Support	
039	Only available in K23		1 piece	Shift Fork Reverse Gear	
040	Only available in K20		1 piece	Shift Fork 1/2 Gear	
041	SP02532		1 piece	Shift Rod	
042	Only available in K20, K21, K23, K24		8 pieces	Gliding Stone	
043	SP02502		2 pieces	Synchroniser (Clutch Body)	
044	SP02538		2 pieces	Stop Plate	
045	Only available in K18		1 piece	Shift Finger Reverse Gear	
046	Only available in K18		1 piece	Shift Finger 1/2 Gear	
047	Only available in K18		1 piece	Shift Finger 5/6 Gear	
048	SP02536		1 piece	Magnet	Information for BMW 217 NG (GS6-17BG): Used in 23007633986, 23007626315
049	Only available in K18		1 piece	Shift Finger 3/4 Gear	
050	Only available in K18		4 pieces	Spiral Pin	
051	SP02537		1 piece	Screw	Information for BMW 217 NG (GS6-17BG): Used in 23007633986, 23007626315
052	Only available in K18		1 piece	Selector Shaft	
053	SP02539		4 pieces	Roller	Information for BMW 217 NG (GS6-17BG): Used in 23007626306, 23007626315, 23007626310
054	SP02289		1 piece	Selector Arm	Information for BMW 217 NG (GS6-17BG): Used in 23007626306, 23007626315, 23007626310
055	SP02366		1 piece	Torsion Spring	
056	SP02290		1 piece	Bearing Bracket	Information for BMW 217 NG (GS6-17BG): Used in 23007626306, 23007626315, 23007626310
057	SP02367		1 piece	Fillister Head Screw	Information for BMW 217 NG (GS6-17BG): Used in 23007626306, 23007626315, 23007626310
058	SP02488		1 piece	Reserve Idler Gear	
059	Only available in K01		1 piece	Needle Ring	
060	SP02487		1 piece	Reverse Spindle	
061	SP02490		1 piece	Adapter	
062	SP02491		1 piece	Screw	
063	Only available in K21		1 piece	Shift Fork 3/4 Gear	
064	Only available in K24		1 piece	Shift Fork 5/6 Gear	
065	SP02286		2 pieces	Retaining Plate	
066	Only available in K01		1 piece	Roller Bearing	

# Manual Transmission 217 NG Diesel (GS6-17DG)

MT00026, MT00027, MT00028

OEM No: 23008610983; 23008610985; 23008610986

## List of parts

Pos	Part number	OEM no	Quantity	Product name	Info
067	SP02287		4 pieces	Countersunk Screw	
068	SP02531		2 pieces	Bearing Pin	
069	SP02368		2 pieces	Screw	Information for BMW 217 NG (GS6-17DG): Used in 23008610983, 23008610985  Information for BMW 217 NG (GS6-17BG): Used in 23007633986, 23007626315
070	SP02456	23128677736	1 piece	Radial Seal Ring	
071	SP02438	23128742716	1 piece	Radial Seal Ring	
072	SP02527	23117564845	1 piece	Output Flange	Information for BMW 217 NG (GS6-17BG): Used in 23007626310
073	SP02528		1 piece	Collar Nut	
074	SP00409	23127602815; 321040790R; A0009905017	2 pieces	Plug	
075	SP02494		11 pieces	Pan Head Screw	
076	Only available in K02		1 piece	Cover Seal	
077	SP00366		1 piece	Sliding Bushing	Information for BMW 217 NG (GS6-17BG): Used in 23007633986
078	SP02267	23137545708	2 pieces	Hexagon Screw	
079	SP02266	23117589987	1 piece	Guiding Sleeve	Information for BMW 217 NG (GS6-17BG): Used in 23007633986
080	SP02298	23128677738	1 piece	Radial Seal Ring	
081	SP02363	7119934624	2 pieces	Retaining Ring	
082	SP02364	23217590034	2 pieces	Cover Seal	Information for BMW 217 NG (GS6-17BG): Used in 23007633986
083	SP02295		1 piece	Pressure Spring	Information for BMW 217 NG (GS6-17BG): Used in 23007633986
084	SP02291	23311228393	1 piece	Pressure Spring	
085	SP02294	23317607560	1 piece	Locking Pin (Reverse Gear)	Information for BMW 217 NG (GS6-17DG): Used in 23008610983  Information for BMW 217 NG (GS6-17BG): Used in 23007633986
085	SP02603	23317616461	1 piece	Locking Pin (Reverse Gear)	Information for BMW 217 NG (GS6-17DG): Used in 23008610985, 23008610986  Information for BMW 217 NG (GS6-17BG): Used in 23007626306, 23007626315, 23007626310
086	SP02369		1 piece	Locking Pin	Information for BMW 217 NG (GS6-17DG): Used in 23008610983  Information for BMW 217 NG (GS6-17BG): Used in 23007633986
086	SP02546		1 piece	Locking Pin	Information for BMW 217 NG (GS6-17DG): Used in 23008610985, 23008610986  Information for BMW 217 NG (GS6-17BG): Used in 23007626306, 23007626315, 23007626310
087	Not available		1 piece	Gear Housing	
088	SP02296		1 piece	Magnet	
089	Only available in K01		1 piece	Grooved Ball Bearing	
090	SP02359		2 pieces	Retaining Plate (single)	
091	SP02358		1 piece	Retaining Plate (double)	
092	SP02360		6 pieces	Countersunk Screw	
093	Only available in K01		1 piece	Grooved Ball Bearing	
094	SP02509		1 piece	Retaining Screw	

# Manual Transmission 217 NG Diesel (GS6-17DG)

MT00026, MT00027, MT00028

OEM No: 23008610983; 23008610985; 23008610986

## List of parts

Pos	Part number	OEM no	Quantity	Product name	Info
095	SP02365		1 piece	Vent Pipe	
096	Not available		1 piece	Transmission Cover	
097	Only available in K10, K11, K13, K15		12 pieces	Adjustment	
098	SP02080		2 pieces	Pin	
099	Only available in K18		2 pieces	Dowel Pin	
100	SP02361		2 pieces	Precision Sleeve	Information for BMW 217 NG (GS6-17BG): Used in 23007626306, 23007626315, 23007626310
101	SP02545		1 piece	Retaining Plug	
102	SP02542	23318609223	2 pieces	Link Pin	