

**PIRATES COVE**  
**SOUTH SOUND, GRAND CAYMAN**

**NAKED FOOT LTD.**  
**30 MAY 2024**

# PC MATERIAL PALETTE



**ALBIZIA LEBBECK**  
LADY TOUNGE



**BURSERA SIMARUBRA**  
RED BIRCH



**COCOS NUCIFERA**  
COCONUT TREE



**COCCOTHRINAX PROCTORII**  
SILVER THATCH



**COCCOLOBA UVIFERA**  
SEAGRape



**CONOCARPUS ERECTUS**  
BUTTONWOOD



**JACQUNIA ARBOREA**  
WASHWOOD

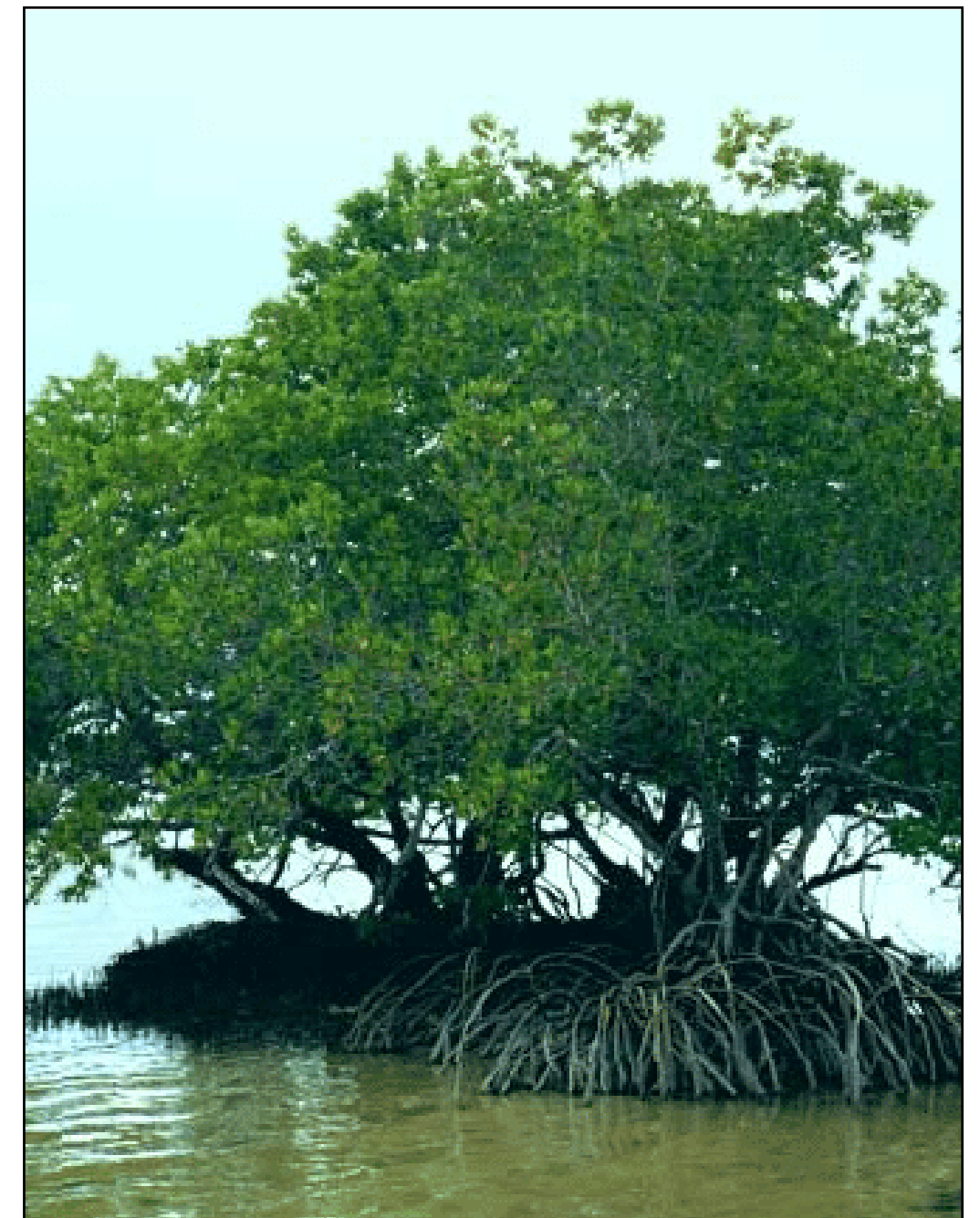

**RHIZOPHORA MANGLE**  
RED MANGROVE



**THESPESIA POPULNEA**  
SEASIDE MAHOE



**BATIS MARITIMA**  
SALTWORT



**BORRICHIA ARBORESCENS**  
SEA OXEYE DAISY

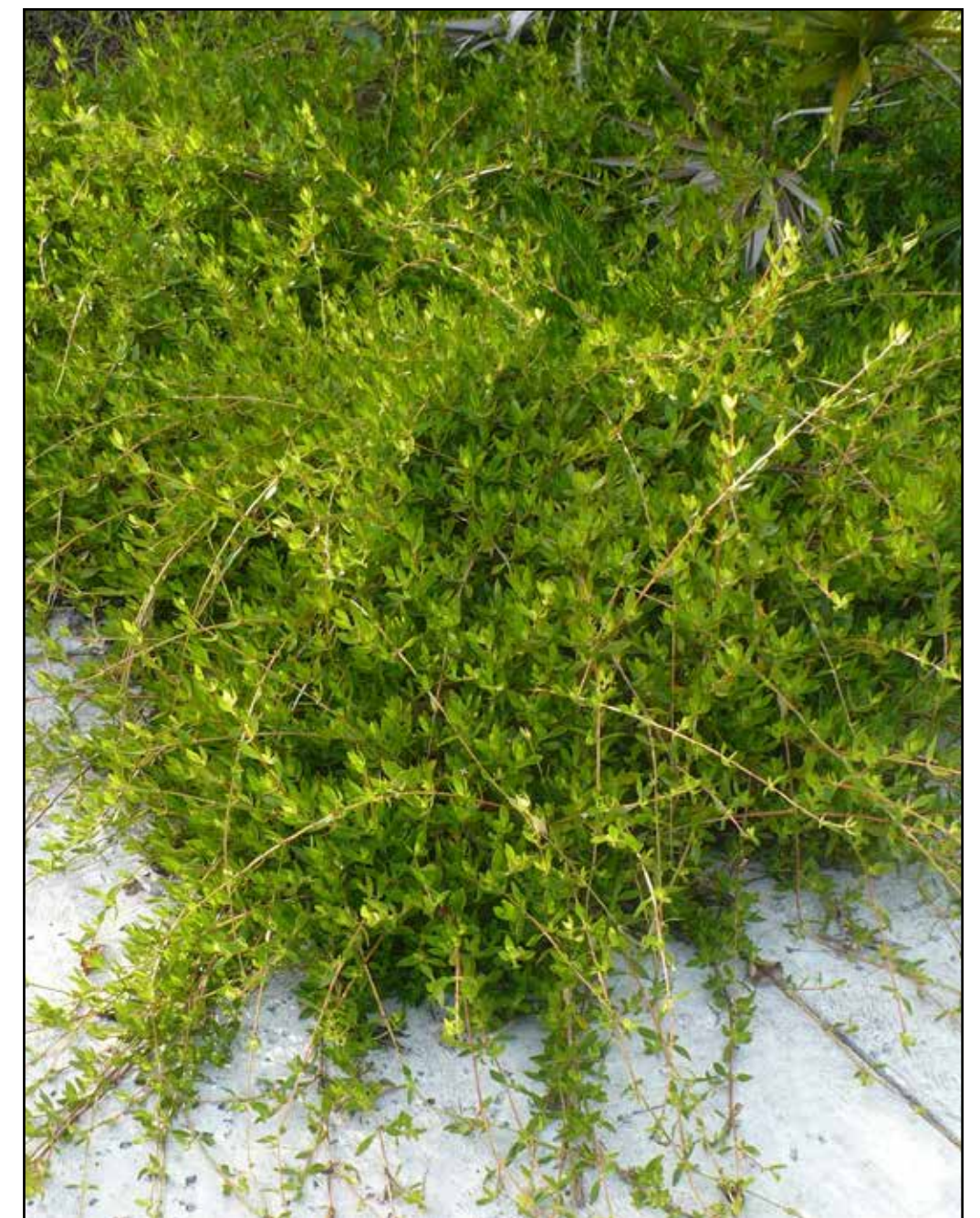

**ERNODEA LITTORALIS**  
BEACH CREEPER



**IPOMOEA PES CAPRAE**  
MORNING GLORY



**SESUVIUM PORTULACAstrum**  
SEA PUKSLANE



**MAKL**  
COMPACTED GRAVEL



**COIR LOGS**  
COCONUT HUSK + SECURING MECHANISM

# PC GROUNDWORK & COIR

## SITE CONTEXT:

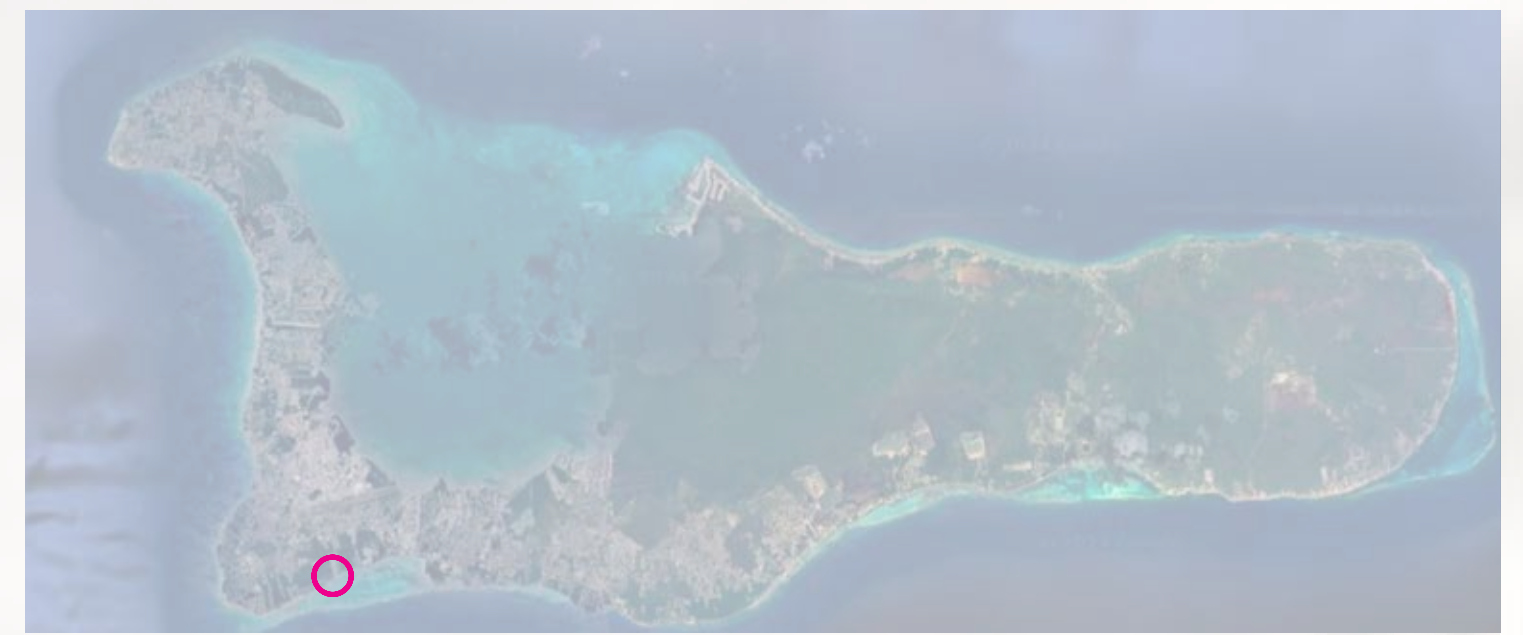

## GROUNDWORK NOTES:



### 1. IN GROUND PLANTERS

- ZONES BEHIND BEACH RIDGE BREAK UP GROUND WITH EXCAVATOR/BACO
- MAKE GROUNDZONES HERE LESS COMPACT
- ADD IN HIGH QUALITY POTTING SOIL, MIX WITH HYDROGEL
- PERTINENT TO MAKE SURE SOIL IS TOP QUALITY AND CAN RETAIN WATER

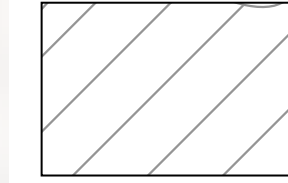

### 2. ABOVE GROUND/RIDGE BUILD PLANTER

- AT RIDGE ALLOW FOR GROUND TO BE BUILT UP VIA COCONUT COIR LOGS
- MAKE GROUNDZONES HERE LESS COMPACT BUT DO NOT DECREASE GRADE
- ADD IN HIGH QUALITY POTTING SOIL, MIX WITH HYDROGEL
- PERTINENT TO MAKE SURE SOIL IS TOP QUALITY AND CAN RETAIN WATER

## HYDROGEL DIAGRAM:

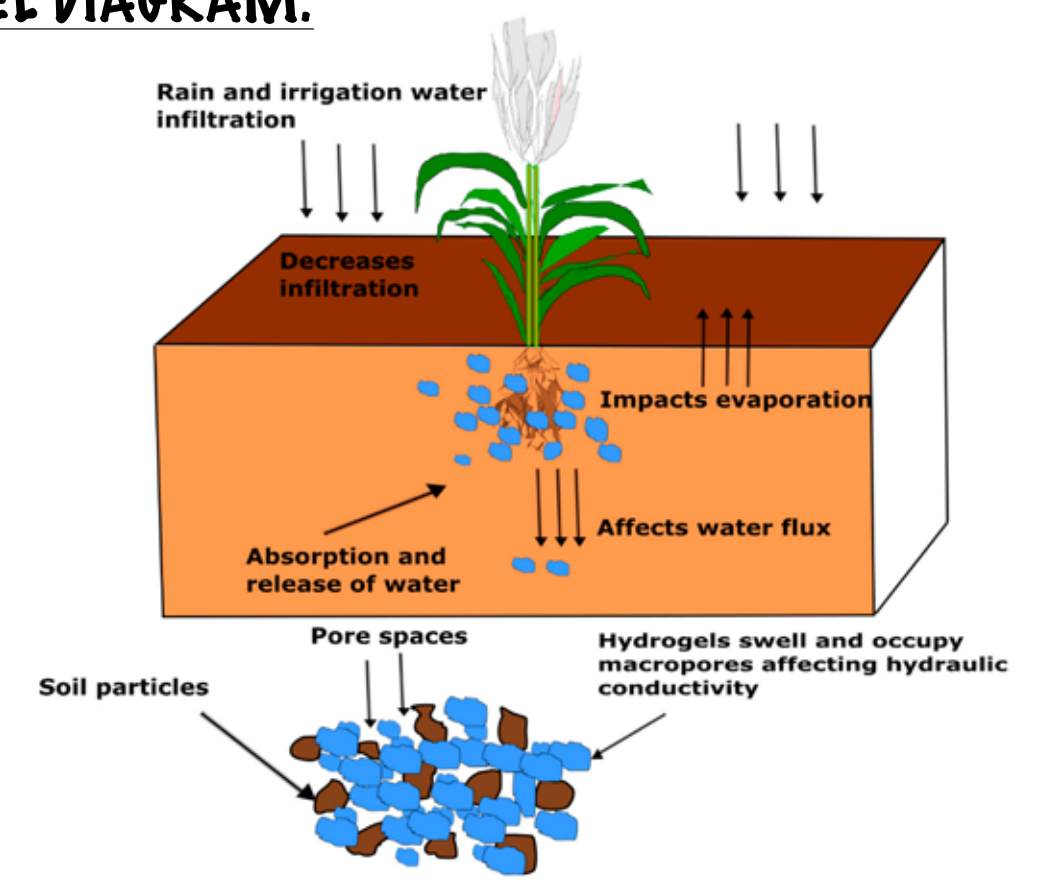

EXCAVATE 18" MAX INTO GROUND, MIX IN HYDROGEL IN TOP QUALITY POTTING SOIL MIX

COIR ON EAST BED:  
BOTTOM LAYER = 12  
MIDDLE LAYER = 6  
TOP LAYER = 2

EACH COCO COIR MEASURES  
1.5' DIAMETER, 14' LENGTH

COIR ON WEST BED:  
BOTTOM LAYER = 14  
MIDDLE LAYER = 4  
TOP LAYER = 2



0' 15' 30' 45' 60'



# PC GROUNDCOVER LAYER

## SITE CONTEXT:

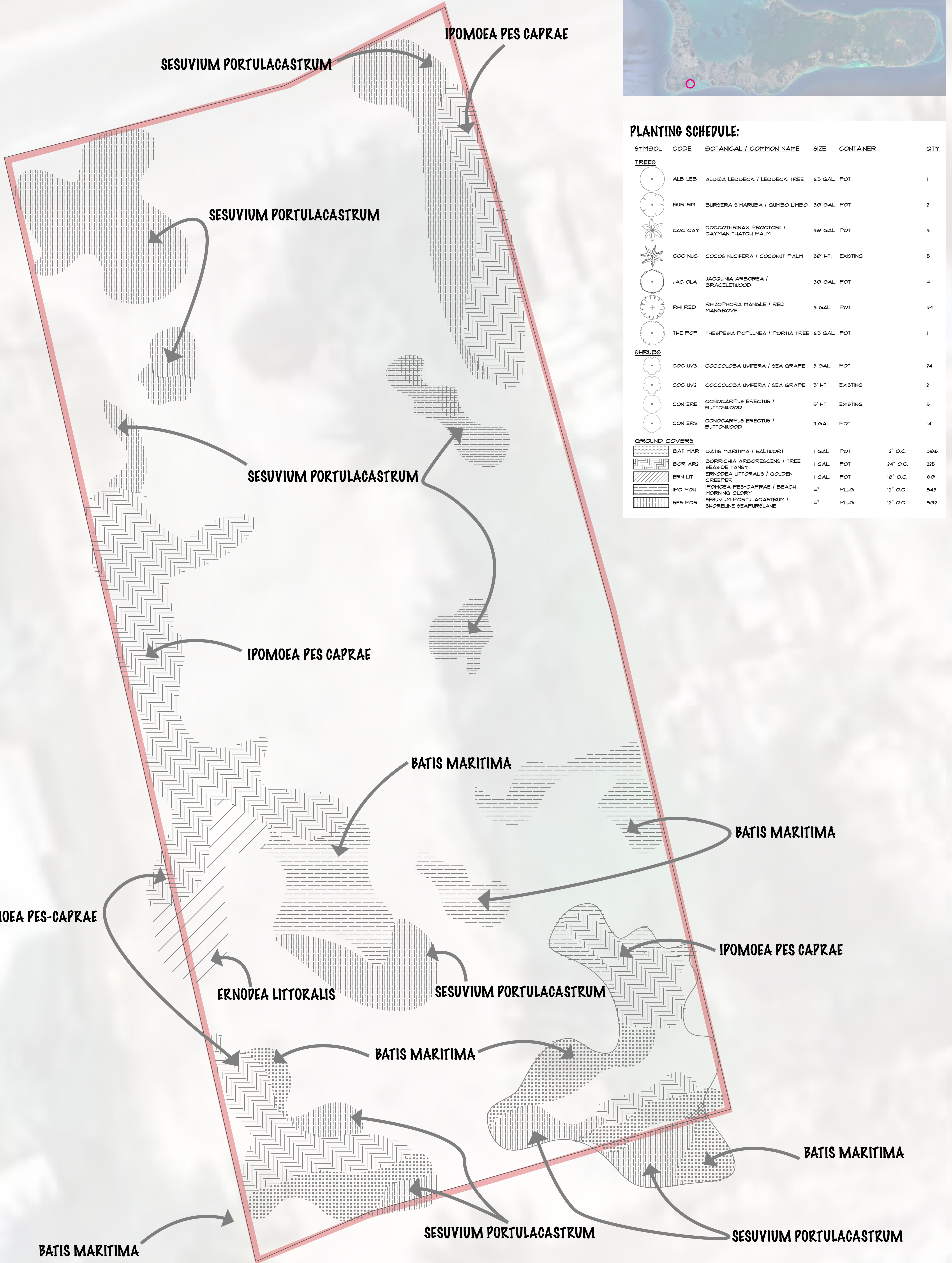
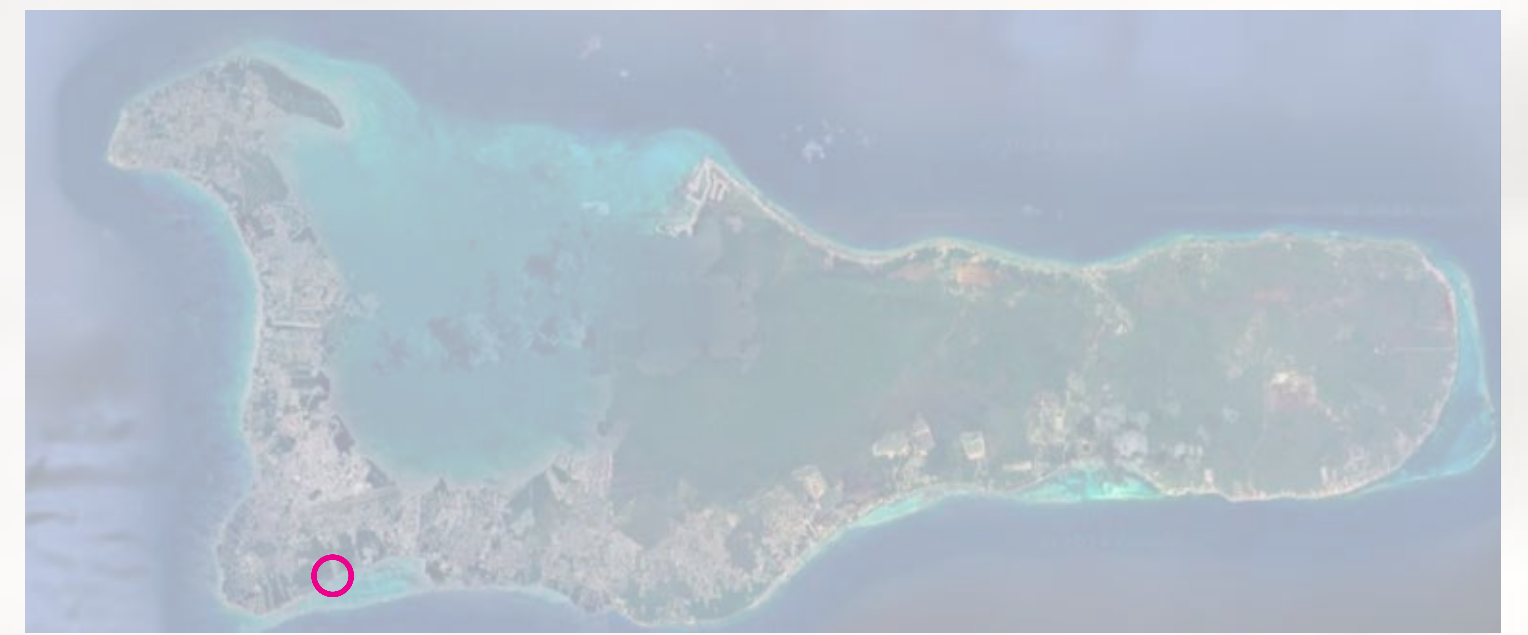

## PLANTING SCHEDULE:

SYMBOL	CODE	BOTANICAL / COMMON NAME	SIZE	CONTAINER	QTY
<b>TREES</b>					
	ALB LEB	ALBIZIA LEBBECK / LEBBECK TREE	65 GAL POT		1
	BUR SIM	BURSERIA SIMARUBA / GUMBO LIMBO	30 GAL POT		2
	COC CAT	COCCOTHRINAX PROCTORII / CATMAN THATCH PALM	30 GAL POT		3
	COC NUC	COCCO NUCIFERA / COCONUT PALM	20' HT. EXISTING		5
	JAC OLA	JACQUINA ARBOREA / BRACELETWOOD	30 GAL POT		4
	RHI RED	RHIZOPHORA MANGLE / RED MANGROVE	3 GAL POT		34
	THE POP	THEOPELIA POPULNEA / PORTIA TREE	65 GAL POT		1
<b>SHRUBS</b>					
	COC UV3	COCCOLOBA UVIFERA / SEA GRAPE	3 GAL POT		24
	COC UV2	COCCOLOBA UVIFERA / SEA GRAPE	5' HT. EXISTING		2
	CON ERE	CONOCARPUS ERECTUS / BUTTONWOOD	5' HT. EXISTING		5
	CON ER3	CONOCARPUS ERECTUS / BUTTONWOOD	1 GAL POT		14
<b>GROUND COVERS</b>					
	BAT MAR	BATIS MARITIMA / SALTWORT	1 GAL POT	12" O.C.	306
	BOR AR2	BORRICHIA ARBORESCENS / TREE SEASIDE TANSY	1 GAL POT	24" O.C.	225
	ERN LT	ERNODEA LITTORALIS / GOLDEN CREEPER	1 GAL POT	18" O.C.	60
	IPO POH	IPOMOEA PES-CAPRAE / BEACH MORNING GLORY	4" PLUG	12" O.C.	543
	SES POR	SESUVIUM PORTULACASTRUM / SHORELINE SEAPURSLANE	4" PLUG	12" O.C.	902



# PC PROPOSED PLANTING

## SITE CONTEXT:

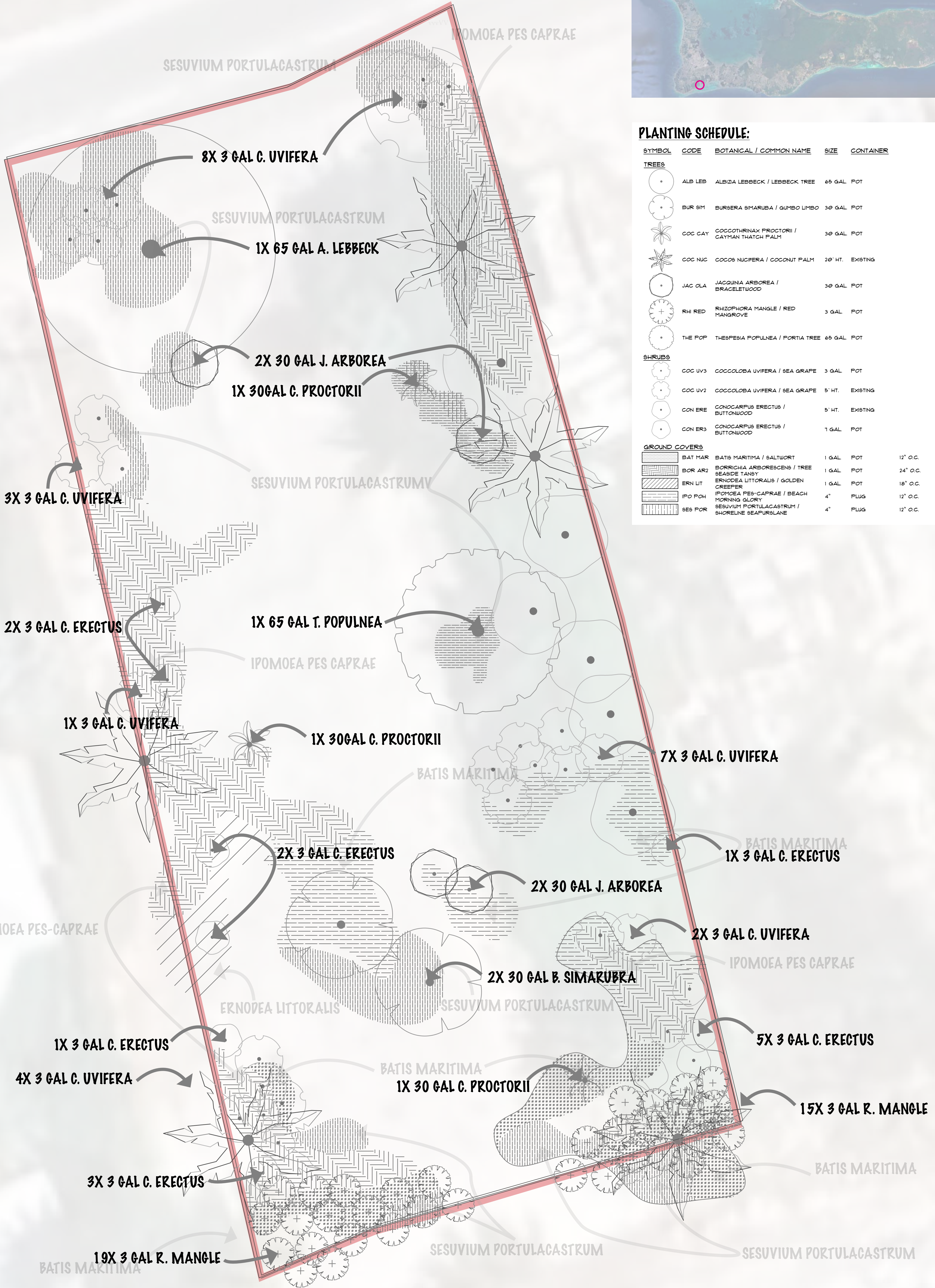
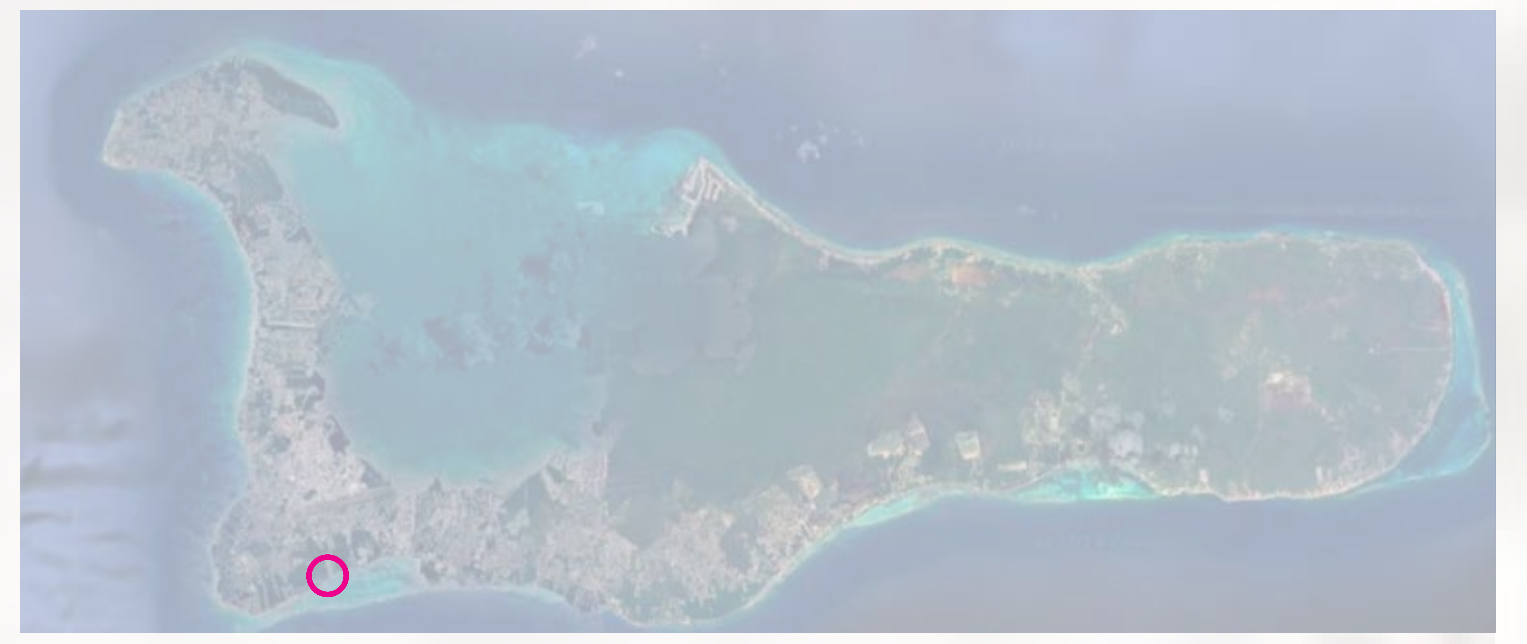

## PLANTING SCHEDULE:

SYMBOL	CODE	BOTANICAL / COMMON NAME	SIZE	CONTAINER	QTY
<b>TREES</b>					
	ALB LEB	ALBIZIA LEBBECK / LEBBECK TREE	65 GAL	POT	1
	BUR SIM	BURSERIA SIMARUBA / GUMBO LIMBO	30 GAL	POT	2
	COC CAT	COCCOTHRINAX PROCTORII / CATMAN THATCH PALM	30 GAL	POT	3
	COC NUC	COCOS NUCIFERA / COCONUT PALM	20' HT.	EXISTING	5
	JAC OLA	JACQUINIA ARBOREA / BRACELEWOOD	30 GAL	POT	4
	RHI RED	RHIZOPHORA MANGLE / RED MANGROVE	3 GAL	POT	34
	THE POP	THEOPELIA POPULNEA / PORTIA TREE	65 GAL	POT	1
<b>SHRUBS</b>					
	COC UV3	COCCOLOBA UVIFERA / SEA GRAPE	3 GAL	POT	24
	COC UV2	COCCOLOBA UVIFERA / SEA GRAPE	5' HT.	EXISTING	2
	CON ERE	CONOCARPUS ERECTUS / BUTTWOOD	5' HT.	EXISTING	5
	CON ER3	CONOCARPUS ERECTUS / BUTTWOOD	1 GAL	POT	14
<b>GROUND COVERS</b>					
	BAT MAR	BATIS MARITIMA / SALTWORT	1 GAL	POT	12" O.C. 306
	BOR AR2	BORRICHIA ARBORESCENS / TREE SEASIDE TANSY	1 GAL	POT	24" O.C. 225
	ERN LIT	ERNODEA LITTORALIS / GOLDEN CREEPER	1 GAL	POT	18" O.C. 60
	IPO POH	IPOMOEA PES-CAPRAE / BEACH MORNING GLORY	4"	PLUG	12" O.C. 543
	SES POR	SESUVIUM PORTULACASTRUM / SHORELINE SEAPURSLANE	4"	PLUG	12" O.C. 902



# PC GROUNDWORK & PLANTING

## SITE CONTEXT:

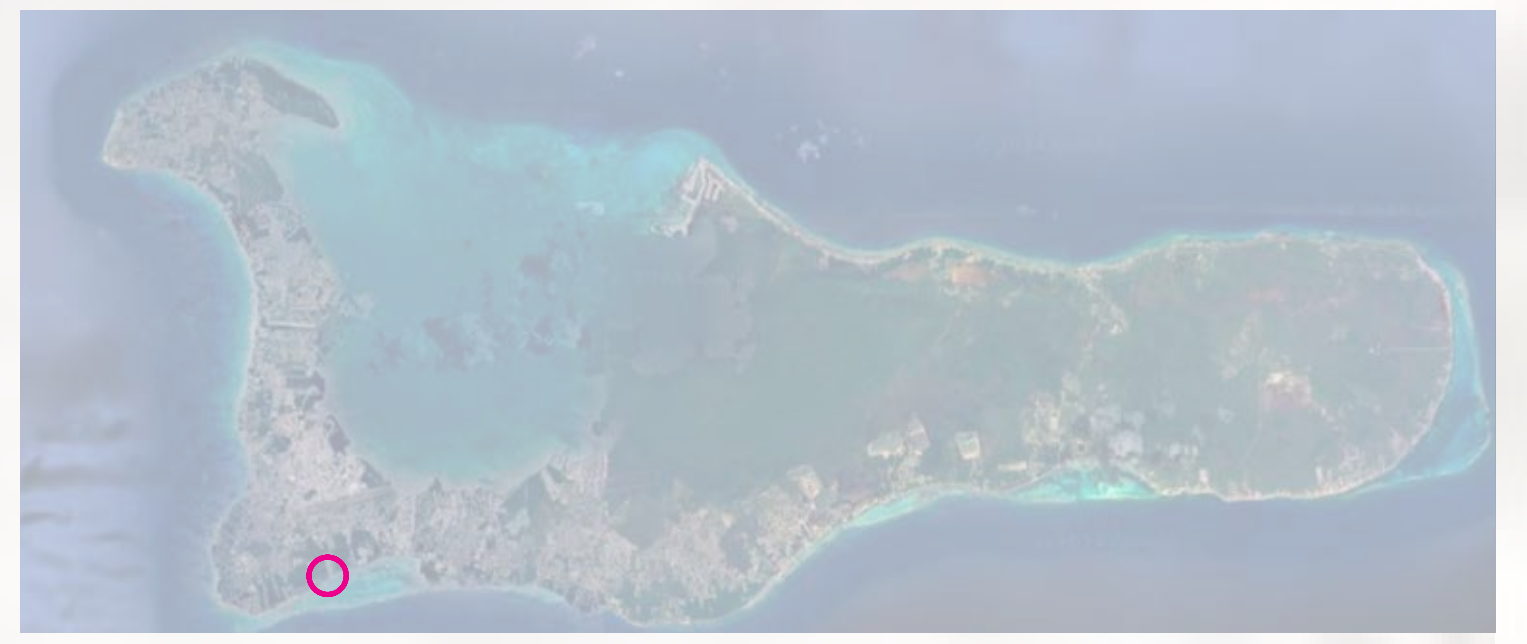

**NOTE 1:**  
-QUICK GROWING SHADE TREE NEAR FRONT TO BLOCK OFF ROAD

**NOTE 2:**  
-LEAVING PARKING AREA NEAR FRONT OF PARKETTE CLEAR FOR 2-3 FEW CARS

**NOTE 3:**  
-USE ORGANICALLY SHAPED BEDS TO CREATE STRUCTURE IN PARKETTE  
-COMPACTED MARL/GRAVEL OTHERWISE TO MAKE PLACE APPEAR CLEAN

**NOTE 4:**  
-USE ORGANICALLY SHAPED BEDS TO CREATE SEATING NOOKS

**NOTE 5:**  
-LEAVE GAP IN MIDDLE TO KEEP VIEW TOWARDS OCEAN

**NOTE 6:**  
-USE COIR AND PLANTS TO REIMBURSE WHAT HAS BEEN LOST VIA BEACH EROSION  
-STACK 3X COIR VERTICALLY ON TOP OF GROUND (NO EXCAVATION, PLEASE ON EXISTING GRADE) FOR A TOTAL MAX HEIGHT 54" ABOVE GRADE RESPECTING THE 20 FEET SET BACK

## PLANTING SCHEDULE:

SYMBOL	CODE	BOTANICAL / COMMON NAME	SIZE	CONTAINER	QTY
<b>TREES</b>					
	ALB LEB	ALBIZIA LEBBECK / LEBBECK TREE	65 GAL POT		1
	BUR SIM	BURSERIA SIMARUBA / GUMBO LIMBO	30 GAL POT		2
	COC CAT	COCCOLITHRINAX PROCTORII / CATMAN THATCH PALM	30 GAL POT		3
	COC NUC	COCCOS NUCIFERA / COCONUT PALM	20' HT. EXISTING		5
	JAC OLA	JACQUINA ARBOREA / BRACELETWOOD	30 GAL POT		4
	RHI RED	RHIZOPHORA MANGLE / RED MANGROVE	3 GAL POT		34
	THE POP	THEOPELIA POPULNEA / FORTIA TREE	65 GAL POT		1
<b>SHRUBS</b>					
	COC UV3	COCCOLOBA UVIFERA / SEA GRAPE	3 GAL POT		24
	COC UV2	COCCOLOBA UVIFERA / SEA GRAPE	5' HT. EXISTING		2
	CON ERE	CONOCARPUS ERECTUS / BUTTONWOOD	5' HT. EXISTING		5
	CON ER3	CONOCARPUS ERECTUS / BUTTONWOOD	1 GAL POT		14
<b>GROUND COVERS</b>					
	BAT MAR	BATIS MARITIMA / SALTWORT	1 GAL POT	12" O.C.	306
	BOR AR2	BORRICHIA ARBORESCENS / TREE SEASIDE TANSY	1 GAL POT	24" O.C.	225
	ERN LT	ERNODEA LITTORALIS / GOLDEN CREEPER	1 GAL POT	18" O.C.	60
	IPO POH	IPOMOEA PES-CAIPRAE / BEACH MORNING GLORY	4" PLUG	12" O.C.	543
	SES POR	SEBIVUM FORTULACASTRUM / SHORELINE SEAPURSLANE	4" PLUG	12" O.C.	902

0' 15' 30' 45' 60'



# PC PROPOSED PLAN

## SITE CONTEXT:

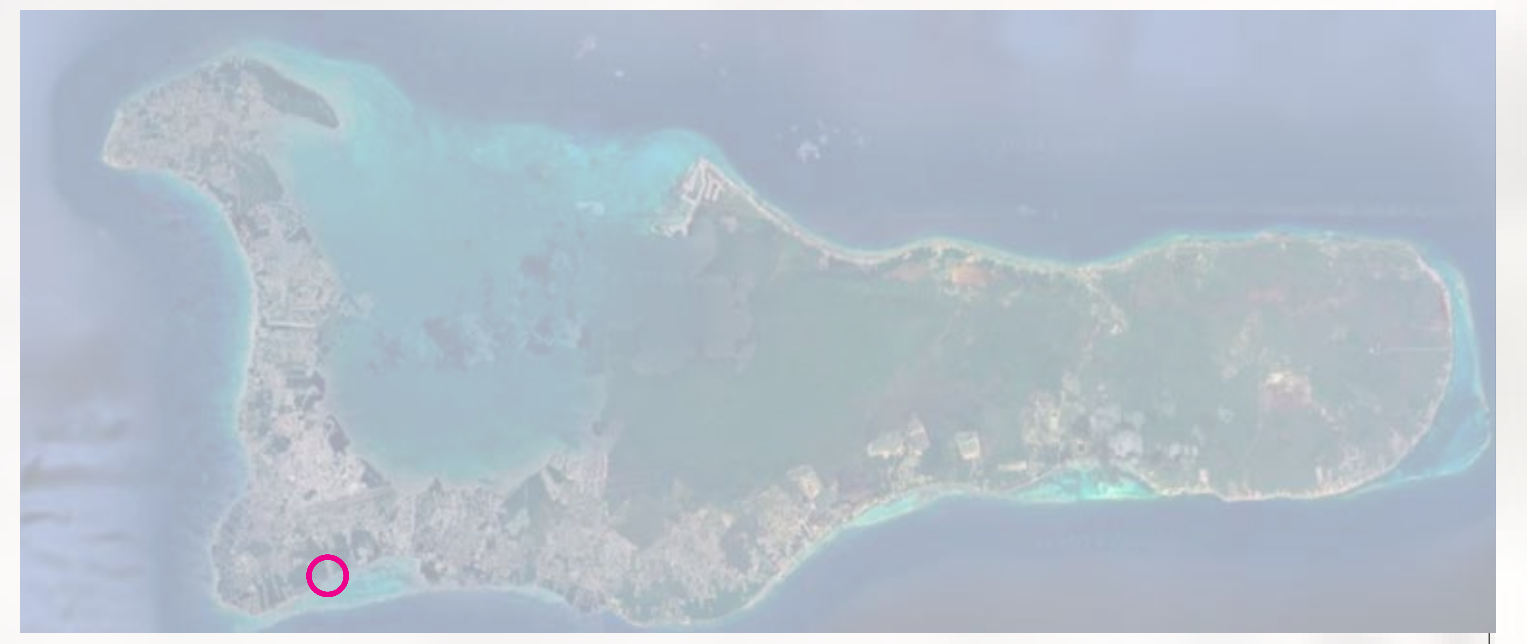

## PLANTING SCHEDULE:

SYMBOL	CODE	BOTANICAL / COMMON NAME	SIZE	CONTAINER	QTY
<b>TREES</b>					
	ALB LEB	ALBIZIA LEBBECK / LEBBECK TREE	65 GAL POT		1
	BUR SIM	BURSERIA SIMARUBA / GUMBO LIMBO	30 GAL POT		2
	COC CAT	COCCOTHRINAX PROCTORII / CATMAN THATCH PALM	30 GAL POT		3
	COC NUC	COCOS NUCIFERA / COCONUT PALM	20' HT. EXISTING		5
	JAC OLA	JACQUINIA ARBOREA / BRACELETWOOD	30 GAL POT		4
	RHI RED	RHIZOPHORA MANGLE / RED MANGROVE	3 GAL POT		34
	THE POP	THESPESIA POPULNEA / FORTIA TREE	65 GAL POT		1
<b>SHRUBS</b>					
	COC UV3	COCCOLOBA UVIFERA / SEA GRAPE	3 GAL POT		24
	COC UV2	COCCOLOBA UVIFERA / SEA GRAPE	5' HT. EXISTING		2
	CON ERE	CONOCARPUS ERECTUS / BUTTONWOOD	5' HT. EXISTING		5
	CON ER3	CONOCARPUS ERECTUS / BUTTONWOOD	1 GAL POT		14
<b>GROUND COVERS</b>					
	BAT MAR	BATIA MARITIMA / SALTWORT	1 GAL POT	12" O.C.	306
	BOR AR2	BORRICHIA ARBORESCENS / TREE SEASIDE TANSY	1 GAL POT	24" O.C.	225
	ERN LT	ERNODEA LITTORALIS / GOLDEN CREEPER	1 GAL POT	18" O.C.	60
	IPO POH	IPOMOEA PES-CAIPRAE / BEACH MORNING GLORY	4" PLUG	12" O.C.	543
	SES POR	SESVIUM FORTULACASTRUM / SHORELINE SEAPURSLANE	4" PLUG	12" O.C.	902

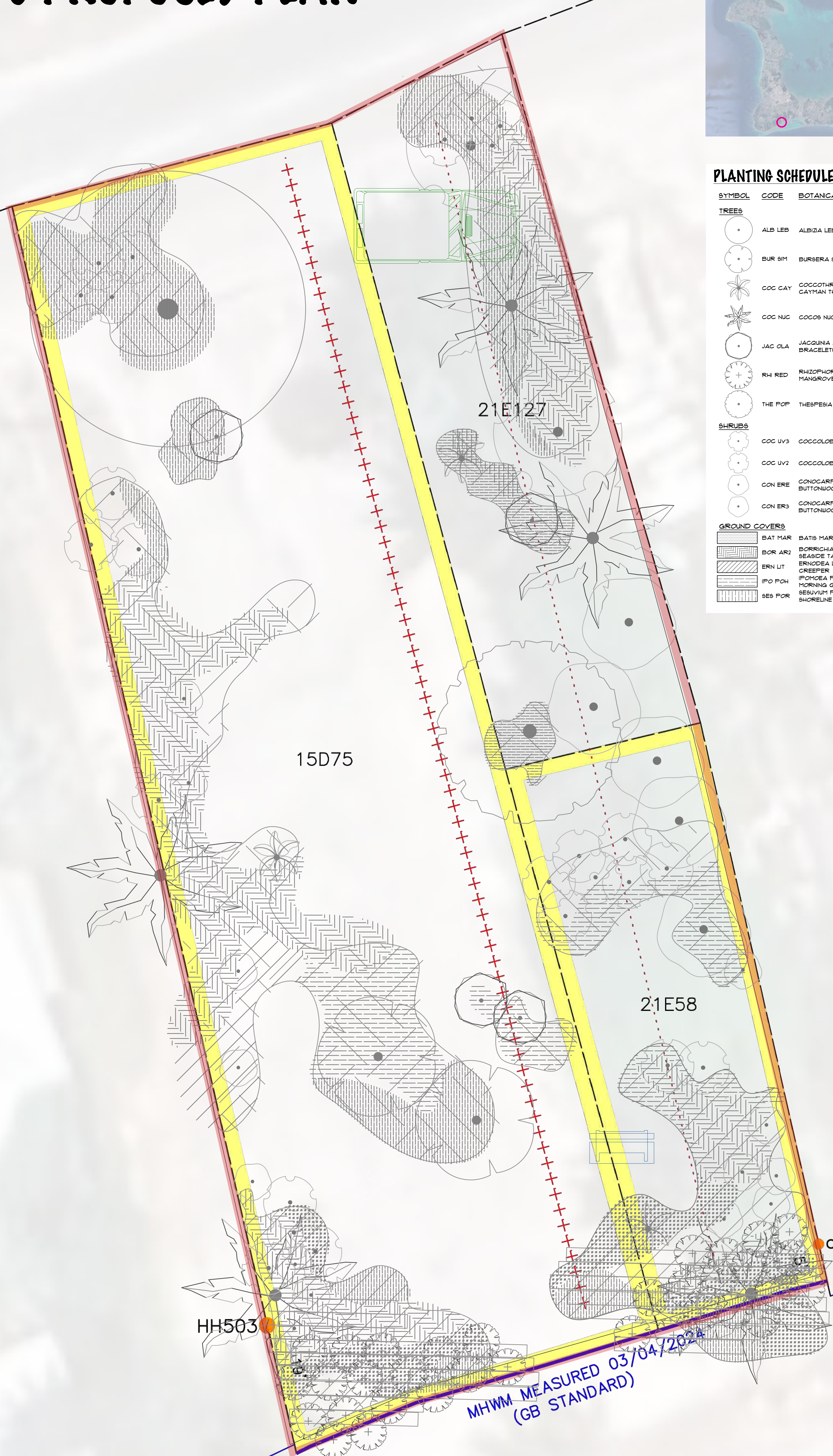

MHWM MEASURED 03/04/2024  
(GB STANDARD)



# PC PROPOSED SECTIONS

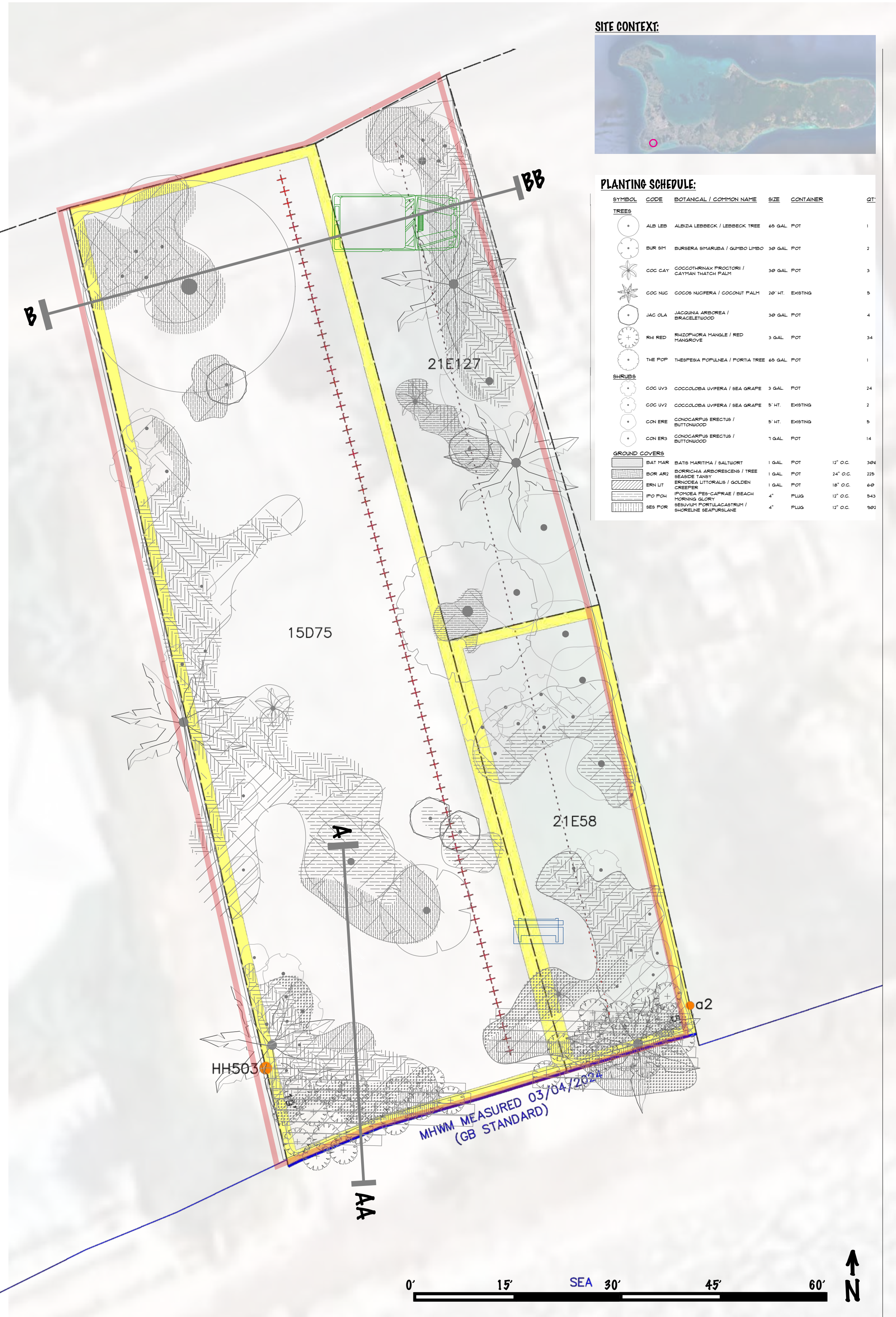

**FIGURES 1 & 2: RED LINE REPRESENTS THE CLOSEST POSSIBLE EDGE (HIGH WATER MARK ASSUMED BY SARAGASSUM DEBRIS) WHERE WE ANTICIPATE TO PLACE COIR (EXAMPLE LAYOUT IN GREEN) AND PLANTS. NO EXCAVATION OR DIGGING PAST THESE RED LINES.**

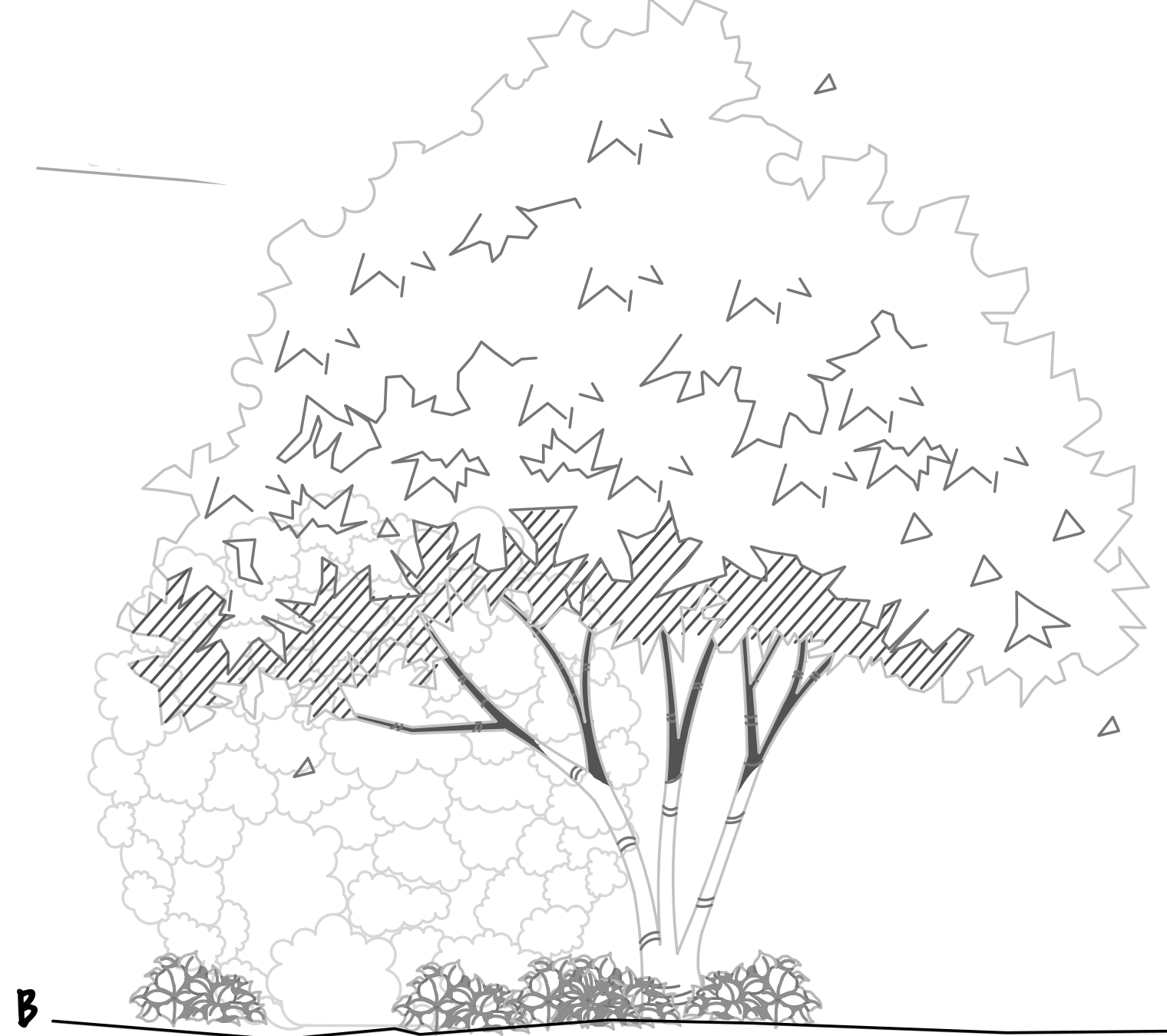

**SECTION B-BB: ENTRANCE TO SITE. SPACE FOR CARS TO PARK, SHADE TREES AND HEDGES TO BLOCK ROAD AND A WASTE COLLECTION AREA FOR SITE SERVICING REQUIREMENTS.**

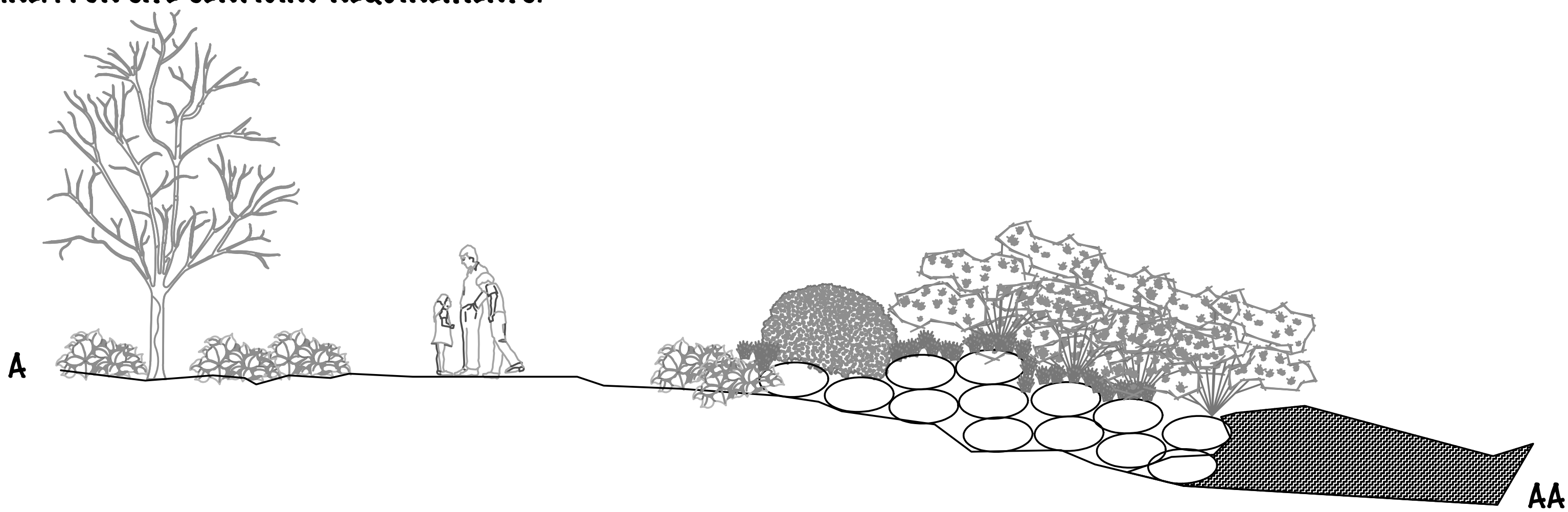
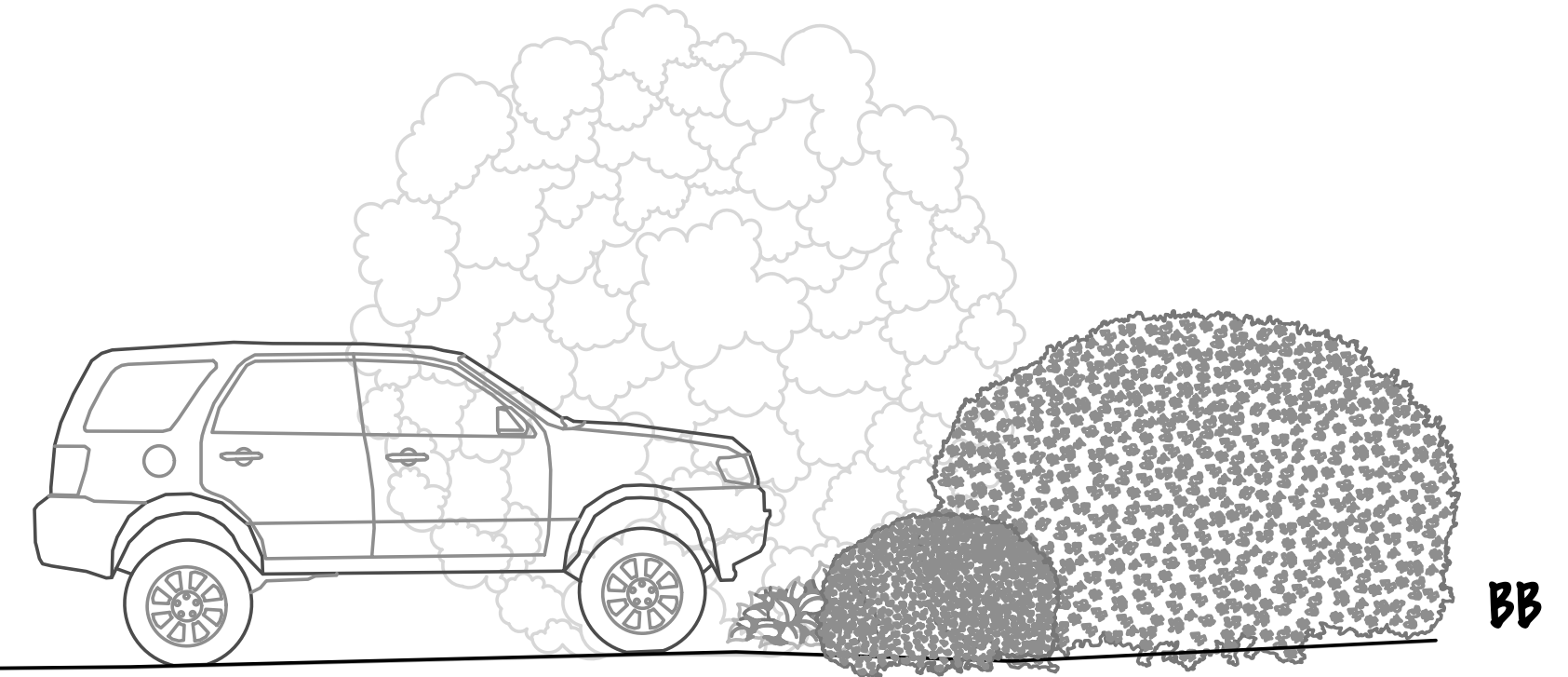

**SECTION A-AA: SITE NEAREST WATER. ELEVATION DROP SUPPLEMENTED BY COCONUT COIR ROLLS STACKED MAX IN 3. SECURING MECHANISM REQUIRED PLANT INTO THE COIR HUSK WITH SEASIDE TOLERANT PLANTS IE. RED MANGROVE, BATIS MARTIMA. PLANT ABOVE HIGH WATER MARK. DO NOT EXCAVATE GROUND. SECTION SHOWS WATER AT A HIGH TIDE.**

