

JON RENAU

WOMEN'S HAIR REPLACEMENT SYSTEMS

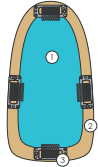

easiPart

BASE TYPE

1. Welded Monofilament
2. PU Coated Monofilament
3. Pressure Sensitive Clips

BASE DIMENSION	LENGTH
2.75" X 5"	8" + 12" + 18"
FIBER	CURL PATTERN
Remy Human Hair Heat Resistant Fiber	Straight/ No Perm
DENSITY	
Light-Medium	

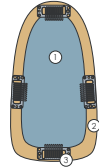

easiPart French

BASE TYPE

1. French Drawn Monofilament
2. PU Coated Monofilament
3. Pressure Sensitive Clips

BASE DIMENSION	LENGTH
2.75" x 5"	8" + 12" + 18"
FIBER	CURL PATTERN
Remy Human Hair European Hair (8" only)	Straight/ No Perm
DENSITY	
Light-Medium	

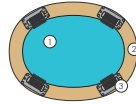

Top This

BASE TYPE

1. Welded Monofilament
2. PU Coated Monofilament
3. Pressure Sensitive Clips

BASE DIMENSION	LENGTH
5" x 4"	8" + 12" + 16"
FIBER	CURL PATTERN
Remy Human Hair	Straight/ No Perm
DENSITY	
Light-Medium	

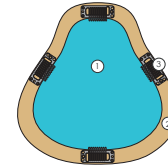

easiPart XL

BASE TYPE

1. Welded Monofilament
2. PU Coated Monofilament
3. Pressure Sensitive Clips

BASE DIMENSION	LENGTH
3"-5.75 x 6"	8" + 12" + 18"
FIBER	CURL PATTERN
Remy Human Hair Heat Resistant Fiber	Straight/ No Perm
DENSITY	
Light-Medium	

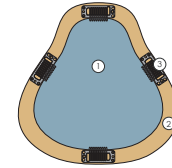

easiPart XL French

BASE TYPE

1. French Drawn Monofilament
2. PU Coated Monofilament
3. Pressure Sensitive Clips

BASE DIMENSION	LENGTH
3"-5.75 x 6"	8" + 12" + 18"
FIBER	CURL PATTERN
Remy Human Hair European Hair (8" only)	Straight/ No Perm
DENSITY	
Light-Medium	

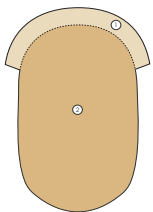

Cosette

BASE TYPE

1. 1/2" Extended PU See Thru without hair
 2. PU See Thru G2 Base
- Features Direct Inject Knotting Technique*

BASE DIMENSION	LENGTH
3.75" x 5.25"	14"
FIBER	CURL PATTERN
100% Chinese Non-Remy Human Hair	Straight/ No Perm
DENSITY	
Sections 1-6: Light-Medium 115%	

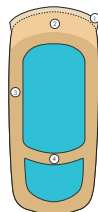

Lucille

BASE TYPE

1. 1/4" Extended PU See Thru Front without Hair
2. 3/4" PU See Thru G5
3. 1/2" - 3/4" PU Coated E2 Perimeter
4. 1/2" PU Coated Cut-away section at back

BASE DIMENSION	LENGTH
3.5" x 8"	14"
FIBER	CURL PATTERN
100% Chinese Non-Remy Human Hair	Straight/ No Perm
DENSITY	
Sections 1-6: Light-Medium 115%	

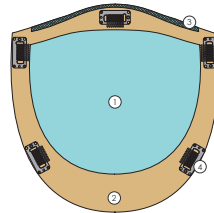

Top Form

BASE TYPE

1. Double Monofilament
2. PU Coated Monofilament
3. 1/8" Folded Monofilament
4. Pressure Sensitive Clips

BASE DIMENSION	LENGTH
6.5" x 6.5"	8" + 12" + 18"
FIBER	CURL PATTERN
Remy Human Hair	Straight/ No Perm
DENSITY	
Light-Medium	

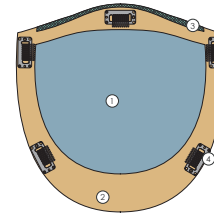

Top Form French

BASE TYPE

1. French Drawn Monofilament
2. PU Coated Double Monofilament
3. 1/8" Folded Swiss Lace
4. Pressure Sensitive Clips

BASE DIMENSION	LENGTH
6.5" x 6.5"	8" + 12" + 18"
FIBER	CURL PATTERN
Remy Human Hair	Straight/ No Perm
DENSITY	
Light-Medium	

BEGINNING

MID/PROGRESSIVE

ADVANCED

Base Dimensions
Width x Length

JON RENAU WOMEN'S HAIR REPLACEMENT SYSTEMS

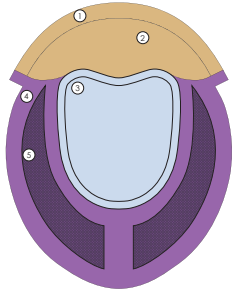

Eloise

BASE TYPE

1. Thin Skin
2. See Thru Polyurethane
3. French Knotting on Silk
4. Polyurethane Coated 360° Stretch
5. Jon Renau 360° Stretch

BASE DIMENSION	LENGTH
8" x 10"	12" + 18"

FIBER	CURL PATTERN
Chinese/Indian Remy Human Hair Blend	Straight/ No Perm

DENSITY
Sections 1-6: Light-Medium 115%

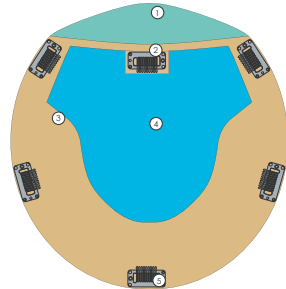

Juliette

BASE TYPE

1. Smartlace (Welded Lace Front)
2. Polyurethane Coated Tab
3. Polyurethane Coated Monofilament
4. Single Monofilament
5. Pressure Sensitive Clips

BASE DIMENSION	LENGTH
9" x 9"	12" + 18"

FIBER	CURL PATTERN
Chinese/Indian Remy Human Hair Blend	Straight/ No Perm

DENSITY
Sections 1-6: Light-Medium 115%

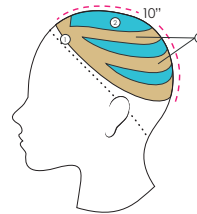

Chanel

BASE TYPE

1. 1" PU Coated Glass Silk G8 Perimeter
2. M-Mesh Center & Back Sections
3. 2- 3/4" PU Coated Cutaway Sections

BASE DIMENSION	LENGTH
8" x 10"	14"

FIBER	CURL PATTERN
Chinese/Indian Remy Human Hair Blend	Straight- 36 mm wet set

DENSITY
Section 1: Medium 130%
Sections 2, 4, 6: Light-Medium 115%
Sections 3, 5: Light-Medium 115%-130%

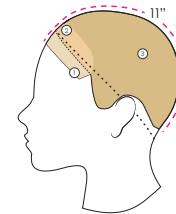

Marcella

BASE TYPE

1. 1/2" Extended PU See Thru Front without Hair
 2. 1" PU See Thru G15 Front
 3. PU Coated Glass Silk G16
- Features Direct Inject Knotting Technique*

BASE DIMENSION	LENGTH
10.5" x 11" - 21" Cir.	14"

FIBER	CURL PATTERN
100% Chinese Non-Remy Human Hair	Straight/ No Perm

DENSITY
Sections 1-3: Light-Medium to Medium 115%-130%
Sections 4-6: Light-Medium 110%



Base Dimensions
Width x Length