

CDD12

Electric pallet stacker



Characteristics:

1. High-power and high-performance lifting pump has high efficiency.
2. Side driving design gives the truck a small steering radius and broadened view.
3. The driving system with permanent magnetic motor has small volume, light mass, small loss.
4. Water-proof inching switch imported from German meets the requirements of harsh working condition such as cold, humidity and dust circumstances.
5. Four colors LED electricity meter makes it simple and direct to read.
6. External positioned charger has better cooling performance.
7. It's more comfortable and easy for operation using a super long handle that integrates lifting button, key switch, electricity meter, which is suitable for ergonomics; more accurate speed control with the turtle speed switch; more durable with the high quality air-pressure springs which allows slowly and automatically reset.
8. Iron steel guard with high density is durable, firm and has high protection effect.
9. Adjustable wide leg is suitable for different sizes of pallets and it is safer and more reliable.

Manufacturer and Technical Data

Characteristics						
1.01	Manufacturer					CHL
1.02	Model					CDD12
1.03	Operation					Walkie
1.04	Rated traction weight	lb.				2640
1.05	Mast type		Single mast		2-Stage STD	
1.06	Lift	in	63.0	78.7	98.4	118.1 137.8
1.07	Capacity at highest height	lb.	2640	2310	1980	1650 1320
1.08	Service weight with battery	lb.	1309	1399.2	1425.6	1452 1478.4
1.09	Load centre	in				24
1.10	Axle centre to fork face	in				27.5
1.11	Wheel base	in				46.1
1.12	Controller					CURTIS
Wheels / Tyres						
2.01	Wheels type					Polyurethane
2.02	Driving wheel size	in				φ8.3×2.8
2.03	Bearing wheel size	in				φ3.1×2.8
2.04	Additional wheels (dimensions)	in				φ4.5×2.2
2.05	Wheels, number front / rear (x=driven)					1×+1/4
Dimensions						
3.01	Height of mast, lowered	in				
3.02	Height of mast, extended	in				
3.03	Fork height, lowered	in				2.6
3.04	Overall length	in				69.6
3.05	Length to fork face	in				24.4
3.06	Overall width	in				45.2-60.9
3.07	Fork dimensions	in				1.4/3.9/45
3.08	Width of forks	in				8.3-33.5
3.09	Min. ground clearance	in				1.0
3.10	Aisle width with pallet 40×48 across forks	in				87.0
3.11	Aisle width with pallet 32×48 along forks	in				85.8
3.12	Min. turning radius	in				53.0
Performance						
4.01	Travel speeds, with/ without load	mph				2.5/4.2
4.02	Lifting speed, with/ without load	fpm				18/26.8
4.03	Lowering speed, with/ without load	fpm				22/19.3
4.04	Max. gradeability laden/ unladen	%				4/8
4.05	Service brake					Electromagnetic brake
Drive						
5.01	Drive motor, output S2 60 min.	hp				1
5.02	Lift motor rating at S3 15%	hp				2.95
5.03	Battery according to DIN 43531/35/36 A,B,C,no					no
5.04	Battery voltage / rated capacity	V/Ah				2x12/100
5.05	Battery weight (±5%)	lb.				2x59.4
Others						
6.01	Noise level at operator's ear	dB				≤70
6.02	Steering type					Mechanical steering

* Details of specifications and equipment are based on information available at time of printing and may change without notice.

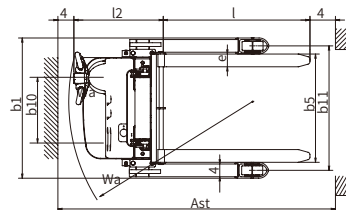
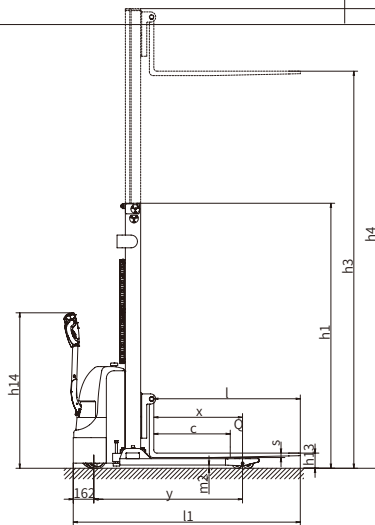

CHL COMPANY

Add / 4071 Southmeadow Pkwy W Suite 100 Atlanta, GA 30349
Tel / 404 502 4867

* Our products are subject to improvements and changes without notice.

AUTHORIZED DEALER