

**beacon** LIFTS<sup>®</sup> **beacon** ELEVATORS<sup>®</sup> **beacon** ESCALATOR<sup>®</sup>  
**beacon** INSECT KILLER<sup>®</sup> **beacon** AIR CURTAIN<sup>™</sup>  
(AN ISO 9001:2008 Certified Co.)

**BEACON ENGINEERING (INDIA) PVT. LTD.**

Ph. : 9810047436, 8800399146 / 149

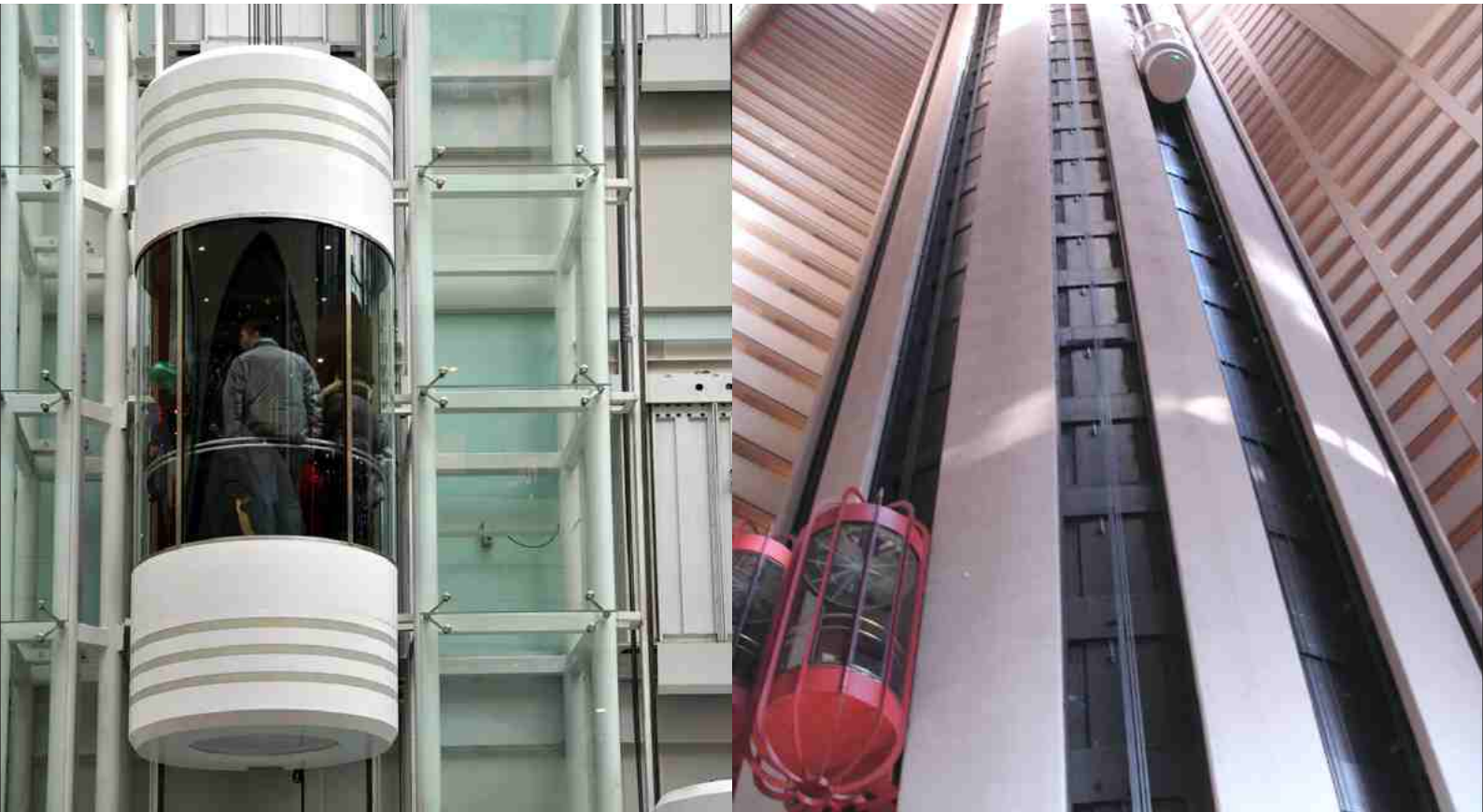

Lifting Performance and Quality to greater heights

Passenger Elevators

Hydraulic Elevators

Freight Elevators

Automobile Elevators

Hospital Elevators

Traction Elevators

Capsule Elevators (Glass Panels)



[www.beaconengg.com](http://www.beaconengg.com)



# Passenger Elevator

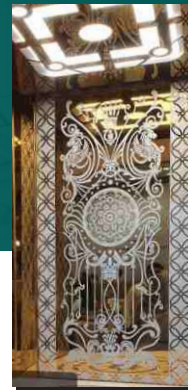

## WHAT IS PASSENGER ELEVATOR, HOW TO CHOOSE A PASSENGER ELEVATOR

A Passenger lift is designed to carry people from point A to Point B vertically. The modern passenger lift is a simple means of transport within a building. Passenger elevators capacity is related to the available floor space. Generally passenger elevators are available in typical capacities from 4 TO 26 passengers and speed varying between 0.5 Meter/sec to 2.5 Meter/sec.

SPEED IN M/S	Pit depth	Over-head	Ma-chine-room Depth L	Ma-chine-room Width K
<b>UPTO 0.70</b>	1450	4500	D+2000	D+1000
>0.70≤	1.00	1500	4500	D+2000
>1.00≤	1.50	1500	4500	C+1200

## MINIMUM CIVIL DIMENSION FOR PASSENGER ELEVATORS

LOAD		CAR INSIDE		LIFT WELL		ENTRANCES	TYPE OF DOOR
PERSONS	KGS.	A WIDE	B DEEP	C WIDE	D DEEP	E IN [mm]...	
5	340	1100	900	1800	1400	700	AUTOMATIC
6	408	1100	1000	1800	1500	700	
8	544	1300	1100	1900	1700	800	
10	680	1300	1200	1900	1800	800	
13	844	2000	1100	2500	1800	900	
16	1088	2000	1300	2500	2100	1000	
20	1360	2000	1500	2500	2200	1000	

**Note:** In case of manually operated doors, clear entrance will be reduced by the amount of projection of handle on the landing door.

**All Dimensions are in mm.**

**Note:** Dimensions Comply With Bureau Of Indian Standards IS 14665 (Part I):2000V

FEATURES	STANDARD	OPTIONAL
Adjustable Door Opening & Closing Time Alarm Button	✓	
Car Call Cancellation at Terminal Stop Attendant	✓	
Direction Arrow and Position Indicator on all Stops Home Landing	✓	
Phase Failure and Phase Reversal Protection	✓	
Repeated Door Closing in the event of Lock Failure	✓	
Door Protection by Light Beams (2 Beams)	✓	✓
Door Protection by Light Curtain	✓	
Emergency Lighting	✓	
Intercom Car to Machine Room		✓
Overload Indicator		✓
Automatic Rescue Device	✓	✓
Compulsory Stop	✓	✓
Duplex, Triplex, Quadruplex Control		✓
Direction Pre-announcing with Arrival Going		✓
Opposite Door Operation		✓

Choice of passenger elevator typically depends on type of building (Commercial, Residential, Hotel, Mall, Housing society etc.) and parameter such as passenger traffic movement. Budget involved is also a deciding factor between manual door and automatic door passenger elevators. Beacon offers all types of passenger elevator whether automatic door or manually operated doors with variety of aesthetic choices for interior, flooring & false ceiling.

## Dimensions

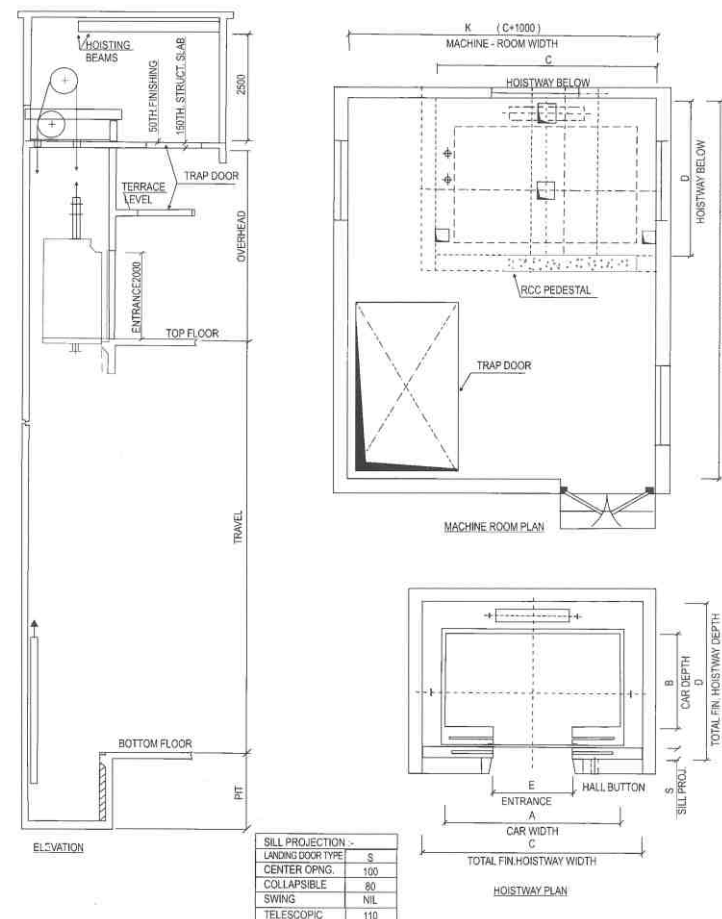

## Designer Backpanel

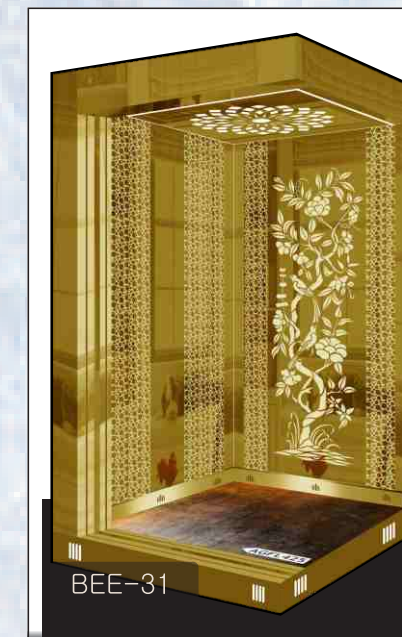
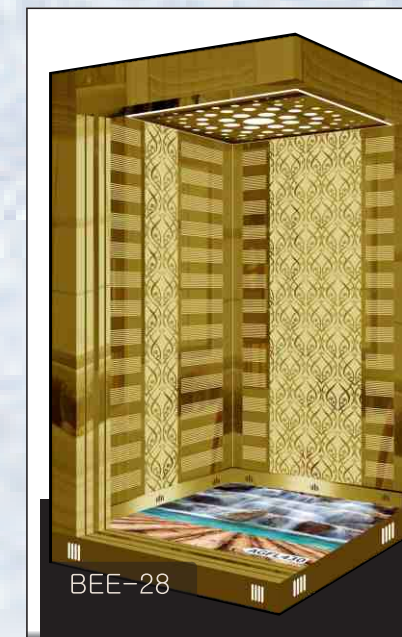
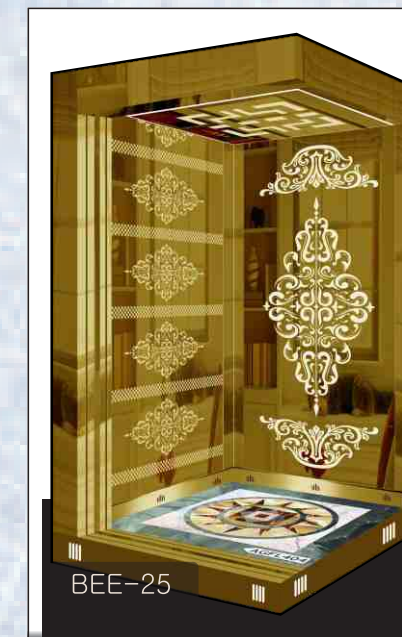



## Designer Backpanel

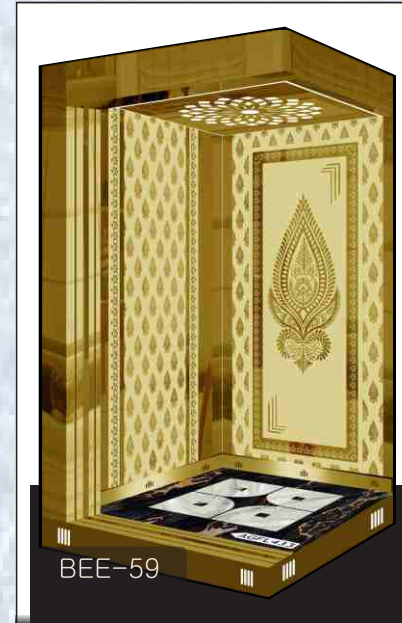
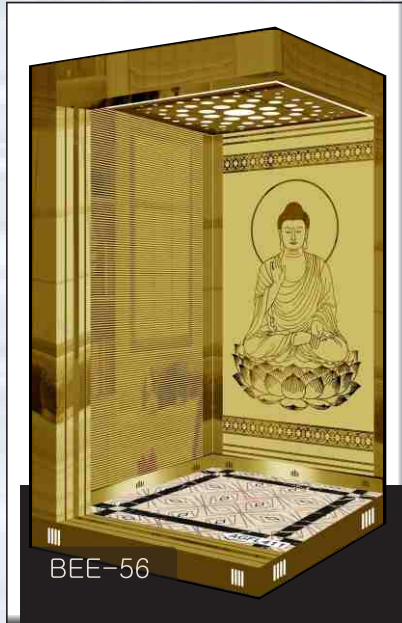
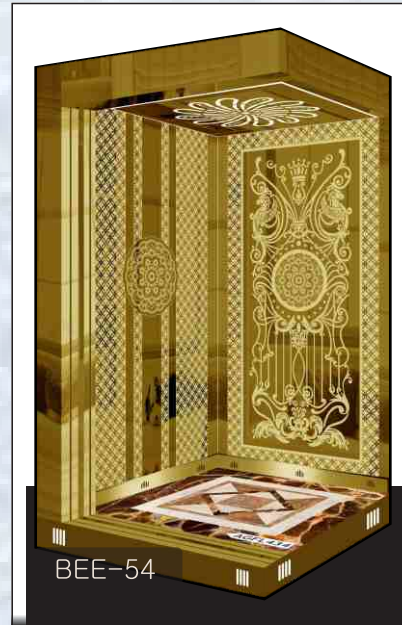
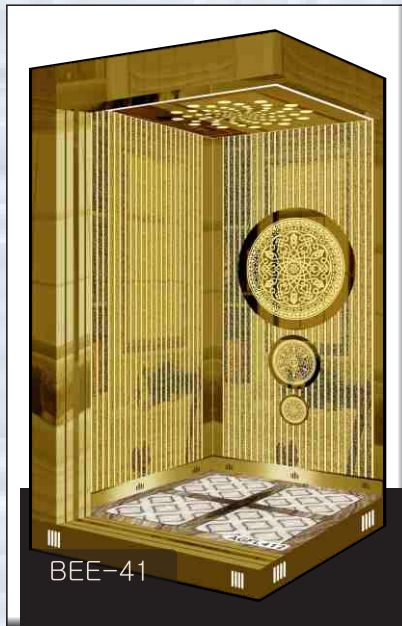

## Designer PVC Flooring

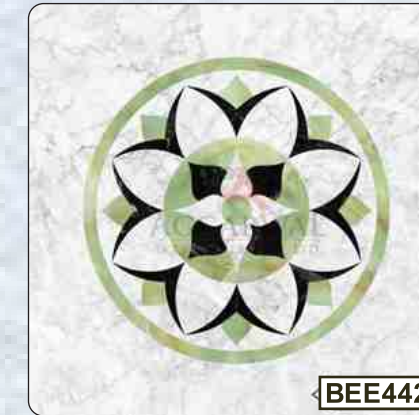

## False Ceiling

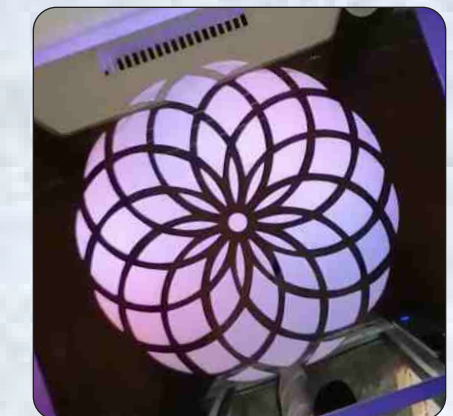
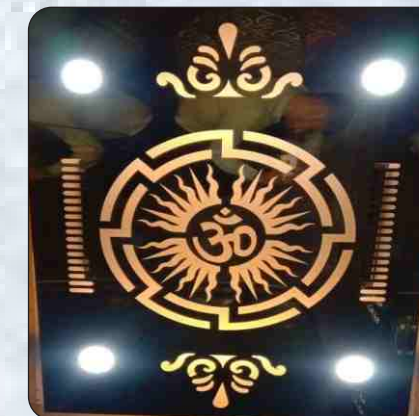
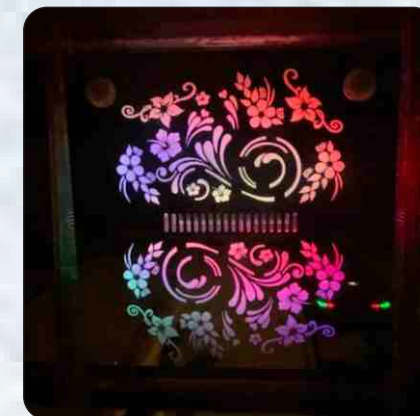
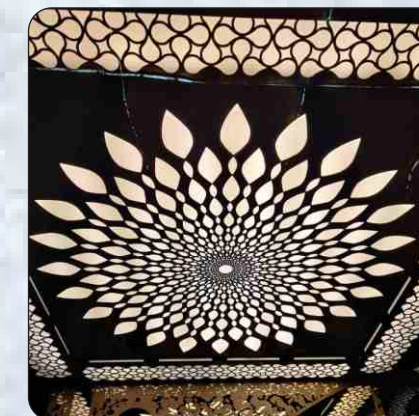
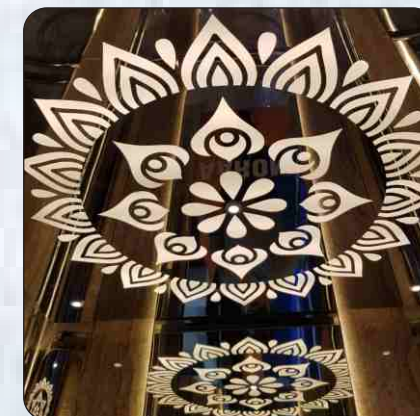



# Hospital Elevator

## WHAT IS HOSPITAL ELEVATOR AND HOW TO CHOOSE A HOSPITAL ELEVATOR

Hospital elevators are used for simple transportation of a patient on wheelchair to wheeling away a critical patient on stretcher without disturbing his life support system with doctors and nurses, smoothly, silently and swiftly, without jerks and shocks. Elevators for medical purpose are vertical transport equipment used in hospital and other relevant places to move patients and surgical instruments. Beacon offers Hospital elevator in Auto Door and Manual door operation.

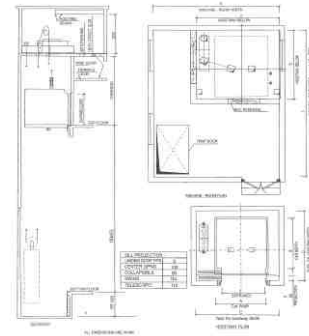

### CLIENT'S SCOPE

1. Construct the shaft (230mm brick / 150mm RCC Walls) and Machine Room Slab (with Pockets) in accordance with our GA drawings.
2. Mason with material for minor builder's work such as pocket cutting, grouting, door fixing etc.
3. Temporary power connection for erection & testing work.
4. Scaffolding till the time of erection, for about 30 days.
5. Access to Machine room, Machine beams, supporting beams, pit ladder etc.
6. Power supply (415 Volts, 3 phase, 4 wires with Neutral, 50 Hz. & 230 Volts 1 Phase) near our control panel with MCB/JUNCTION BOX.

### MINIMUM CIVIL DIMENSION FOR HOSPITAL ELEVATORS

#### HOSPITAL ELEVATORS

LOAD		CAR INSIDE		LIFT WELL		ENTRANCES		MACHINE ROOM		PIT DEPTH	OVER HEAD
PERSONS	Kg	A	B	C	D	E	K	L			
15	1020	1000	2400	1800	3000	900	3800	5500	1500	4500	
20	1300	1300	2200	2200	3000	1200	4200	5500	1500	4500	
26	1768	1600	2400	2400	3000	1200	4400	5500	1500	5000	



# Dumb-Waiter

## WHAT IS A DUMB-WAITER AND HOW TO CHOOSE A DUMB-WAITER

A small freight elevator is often called a Dumb-Waiter or a small box elevator designed for carriage of lightweight freight is called a Dumb Waiter. often used for moving of small items such as dishes in a kitchen or books in a multistorey rack assembly.

Dumb-Waiters are used extensively in the restaurant business (hence the name) and may also be used for lifting books in libraries, to transfer goods and articles in a house, to transfer equipments in a hospital or to transport mail or similar items in an office tower.

Beacon Dumb-Waiters handle 100 to 250 kg. At speeds 0.25 to 0.50 mps. The choice of the control system depends upon the number of floors served and the intensity of service required. Different types of control offered include call and send and multi-button systems.

Among other optional features available are two speed control with ACVVVF drive, signals to indicate car location and audio-visual signals to indicate car arrival and a removable shelf.

Apart from the standard sizes it can also be customised according to the client's requirement.

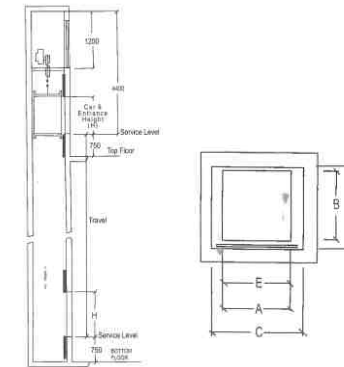

Note: Entrance width 'E' is based on assumption of provision of vertical bi-parting doors (no car door is normally provided). In case of swing door civil entrance openings to be left as E+100 and H+100. REFER BEACON DETAILED DRAWING FOR ADDITIONAL INFORMATION

### MINIMUM CIVIL DIMENSION FOR DUMB-WAITER

#### DUMB-WAITER

LOAD / SPEED		CAR INSIDE			LIFT WELL & M/C ROOM		ENTRANCE	
Kg	mps.	A	B	H	C	D	E	H
100	0.50	700	700	800	1200	900	700	800
150	0.50	800	800	900	1300	1000	800	900
200	0.25	900	900	1000	1400	1100	900	1000
250	0.25	1000	1000	1200	1500	1200	1000	1200

All Dimensions are in mm.



# Freight Elevator

## WHAT IS FREIGHT ELEVATOR, HOW TO CHOOSE A FREIGHT ELEVATOR

Freight elevator is essentially designed so as to fulfill material handling requirement of industry, building, hotel, car workshop etc.

For a properly engineered installation, the choice of freight elevator requires consideration of such factors as volume and weight of material to be transported and the method of handling like manual or trolley driven.

We at Beacon have various models of Freight elevators to choose from wide variety of capacities and sizes and always attempt to customize our product according to customer's requirement.

### MINIMUM CIVIL DIMENSION FOR FREIGHT ELEVATORS

#### FREIGHT ELEVATORS

LOAD	CAR INSIDE		LIFT WELL		ENTRANCES		MACHINE ROOM		PIT DEPTH	OVER HEAD
Kg	A	B	C	D	E	K	L			
500	1100	1200	1900	1500	1100	3900	4500	1500	4500	
1000	1400	1800	2300	2100	1400	4300	4600	1500	4500	
1500	1700	2000	2600	2300	1700	4600	4800	1500	4500	
2000	1700	2500	2600	2800	1700	4600	5300	1500	5000	
2500	2000	2500	2900	2800	2000	4900	5300	1500	5000	
3000	2000	3000	2900	3300	2000	4900	5800	1500	5000	
4000	2500	3000	3400	3300	2500	5400	5800	1500	5000	
5000	2500	3600	3400	3900	2500	5400	6400	1500	5000	

Note: In case of manually operated doors, clear entrance will be reduced by the amount of projection of handle on the landing door.

All Dimensions are in mm.

Note: Dimensions Comply With Bureau Of Indian Standards IS 14665 (Part I) : 2000

www.beaconengg.com

**beacon Lifts**  
Beacon Engineering India Pvt. Ltd.



# Car Elevator

## WHAT IS CAR ELEVATOR AND HOW TO CHOOSE A CAR ELEVATOR

A car lift is installed where ramps are considered space-inconvenient for smaller buildings (usually in apartment buildings where frequent access is not an issue, Car workshop where judicious space usage is very important). The car platforms are raised and lowered in the similar fashion as freight elevator except for the fact that size and load carrying capacity of Lift platform is in accordance with the dimensions & weight of largest vehicle to be transported between floors. Beacon offers all types of vehicle elevator from 1500 kg for smaller cars to 5000 kg for bigger cars like SUVs and tempus.

### CLIENT'S SCOPE

1. Construct the shaft (230mm brick / 150mm RCC Walls) and Machine Room Slab (with Pockets) in accordance with our GA drawings.
2. Mason with material for minor builder's work such as pocket cutting, grouting, door fixing etc.
3. Temporary power connection for erection & testing work.
4. Scaffolding till the time of erection for about 30 days.
5. Access to Machine room, Machine beams, supporting beams, pit ladder etc.
6. Power supply (415 Volts, 3 phase, 4 wires with Neutral, 50 Hz. & 230 Volts 1 Phase) near our control panel with MCB/JUNCTION BOX.

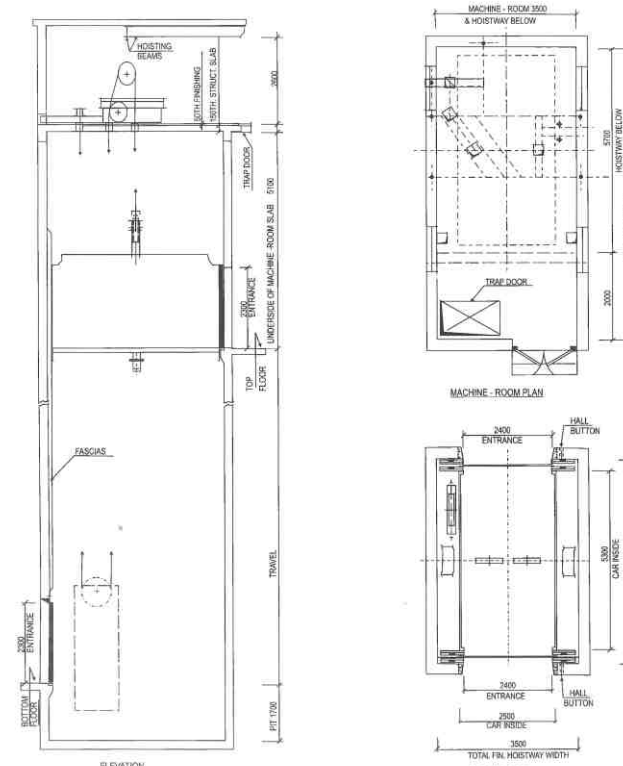

www.beaconengg.com



**beacon Lifts**  
Beacon Engineering India Pvt. Ltd.

## OUR SUPPLIERS



**beacon** LIFTS<sup>®</sup> **beacon** ELEVATORS<sup>®</sup> **beacon** ESCALATOR<sup>®</sup>

**BEACON ENGINEERING (INDIA) PVT. LTD.**

(AN ISO 9001:2008 Certified Co.)

**Ph. : 9810047436, 8800399146 / 149**

B-3/61, Janakpuri, New Delhi-110058

Email : [beaconengg@gmail.com](mailto:beaconengg@gmail.com)

Website : [www.beaconengg.com](http://www.beaconengg.com)