

Lux Indoor Sauna

Installation Manual

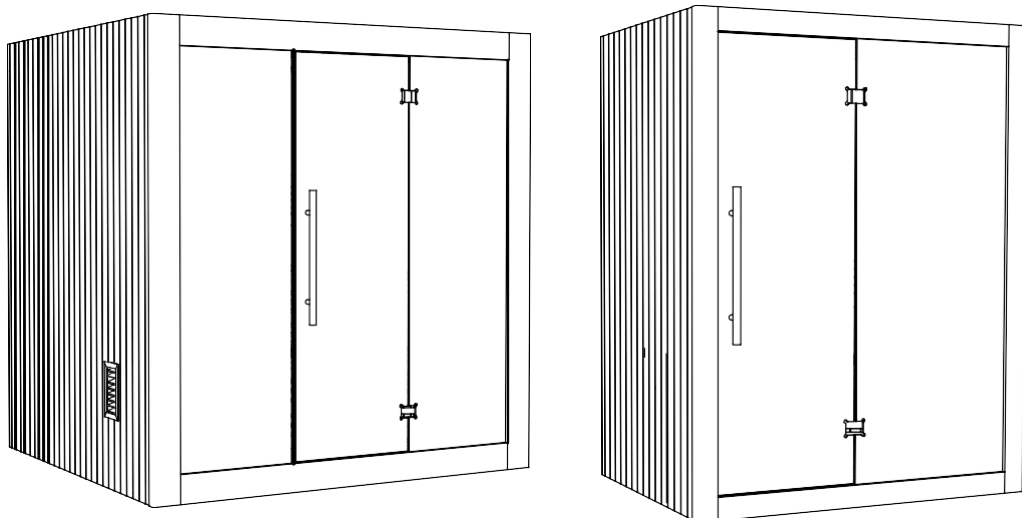

PLEASE NOTE: The circuit for this product must be installed by a certified electrician, select a circuit breaker according to the electrical codes in your area

⚠ WARNING

Please read this manual carefully and follow all instructions.
Keep this manual for future reference.



Safety Warning

Precautions

△ SAFETY INSTRUCTIONS

1. Children's Safety – Children must only use the sauna under close adult supervision. Do not allow children to play with the equipment.
2. Electrical Safety – Power cords, plugs, sockets, and switches must be kept out of children's reach and protected from moisture or rain.
3. Heating Element Safety – Never insert fingers, sticks, or other objects into the heating element (plate).
4. Flammable Materials – Do not use or store flammable gases or liquids (e.g., hairspray, paint, gasoline) near or inside the sauna.
5. Obstructions – Do not place any objects inside or on top of the sauna.
6. Damaged Power Cord – If the power cord is damaged, it must be replaced by an authorized service provider or qualified professional.
7. Thunderstorms – Do not use the sauna during thunderstorms.
8. Continuous Use Limit – If the sauna operates for more than 4 hours continuously, switch it off for at least 30 minutes before resuming use.
9. Repairs – Do not attempt unauthorized repairs. Damage resulting from unauthorized repairs is not covered by the warranty.
10. Electronic Devices – Do not bring electronic devices with lithium batteries (e.g., mobile phones, tablets, smartwatches) into the sauna.
11. Sauna Stones – Operating the sauna without sauna stones is prohibited.
12. Water Use – Do not pour chlorinated water (such as swimming pool water) on sauna stones.

Usage prohibition

13. Alcohol – Do not use sauna after consuming alcohol.
14. Sleeping – Do not sleep inside the sauna while it is operating.
15. Skin & Wounds – Do not use if you have skin erosion or unhealed surgical wounds.
16. Medical Conditions – If you have any medical condition, are unwell, or are taking medication, consult your doctor before using the sauna.
17. After Exercise – Do not use immediately after intense exercise. Wait at least 30 minutes, or until your body temperature returns to normal.
18. Pregnancy – Do not use if you are pregnant or suspect you may be pregnant, as excessive heat may harm the fetus.
19. Overheating Risk – Prolonged exposure to high temperatures may cause burns, dizziness, weakness, drowsiness, or fainting. If any symptoms occur, stop using the sauna immediately.
20. Chronic Health Conditions – Consult your doctor before use if you have obesity, heart disease, high or low blood pressure, circulatory problems, or diabetes.
21. Head Clearance – Take care not to bump your head when entering or exiting the sauna.
22. Supervision for At-Risk Users – This appliance must not be used by individuals (including children) who are physically incapacitated, lethargic, or have mental impairments unless supervised or assisted by a responsible person.

Follow these guidelines

Important safety warning

※ Please read the manual carefully before use, and strictly observe the following safety guide when using:

This safety precaution uses the following symbols to distinguish the harm and damage to the human body caused by misuse



Warning

Indicates the possibility of serious injury.



Note

Indicates the possibility of personal injury or property damage

Symbolic indication



Indicates prohibited matters



Indicates mandatory guidance



Indicates guidelines



Indicates that modification is prohibited



Indicates that the power plug is unplugged



Indicates attention to electric shock



Warning: Please follow the doctor's advice



With a pacemaker embedded in the body



Person with artificial heart



High fever



Patients with epilepsy



Acutely ill patients



Pregnant woman



Infectious patients



The perceptually impaired and the drunk



This product is not intended for use by individuals—including children—who are incapacitated, sluggish, or mentally handicapped, unless they are under the direct supervision or assistance of a responsible person ensuring their safety.



Warning



It is strictly forbidden to install any lock or hasp system on the door of this product without permission to prevent it from being trapped in the product in case of failure



Do not put flammable materials into this product at any time to prevent fire



Thunderstorm weather is strictly prohibited



Do not bring mobile phones, MP3 players and other electronic products, digital products, and watches into this product



Attention



When you feel suffocated when using this product, you should exit immediately



When repairing this product, the power supply should be cut off to prevent electric shock



If the product malfunctions or fails, please contact authorized maintenance personnel immediately.



It is still strictly prohibited to install sockets and other electrical equipment in this product.



This product is a high-power electrical device. The dedicated circuit for this product must not be shared with other electrical appliances.



If you experience symptoms such as discomfort, dizziness, or drowsiness, stop using the product immediately. Prolonged use may cause overheating and pose health risks.



When the human body produces excessive heat. Do not use this product

Product construction diagram

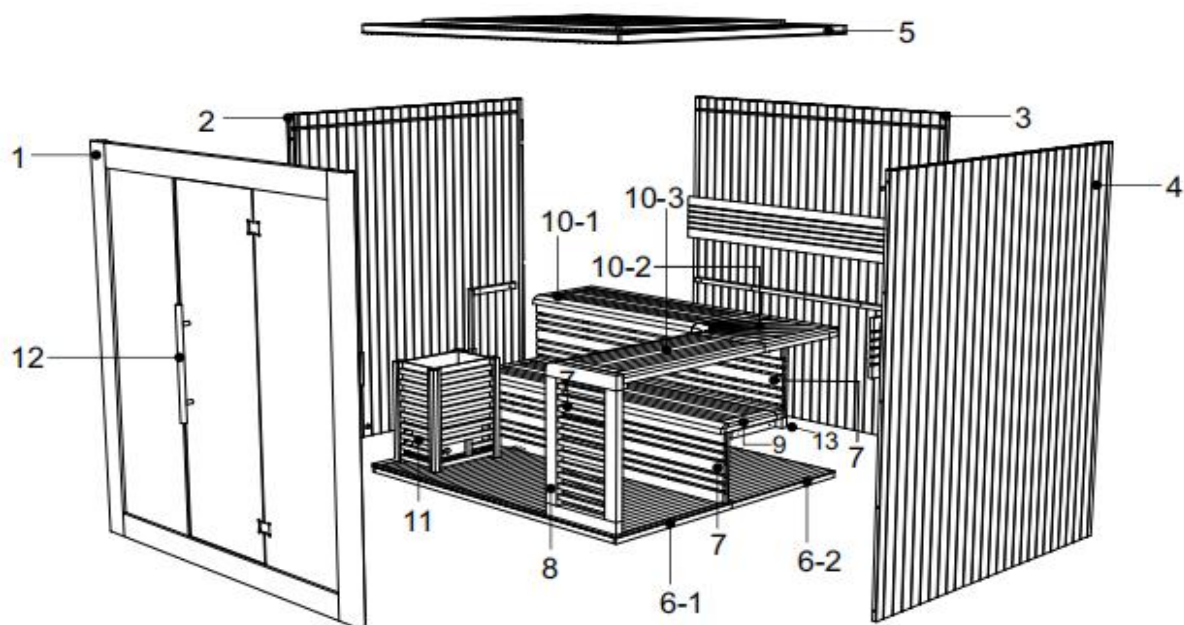

- | | | | |
|--------------------|---------------------|-----------------------|----------------------------|
| 1: Front plate | 4: Right side panel | 7: seat side plate | 10:Seat plate (second) |
| 2: Left side panel | 5: Top cover | 8: seat support plate | 11:heater guardrail |
| 3: Back panel | 6:Base Frame | 9:Seat plate (first) | 12:door handle |
| | | | 13:seat side support plate |

Technical parameter

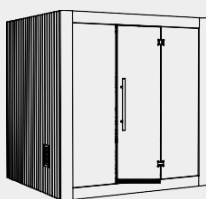

Item name

Item size/MM

Voltage/KW

Material

Lux - Large

internal :1908×1740×1980
external:2000×1830×2100

240V/8KW

Hemlock

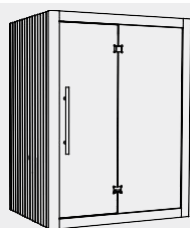

Item name

Item size/MM

Voltage/KW

Material

Lux - Small

internal :1410×1010×1875
external:1500×1100×1960

240V/ 6 KW

Hemlock

Contents



Safety Warning	1
Important safety warning	2
Product construction diagram	3
Product installation	4
Preparation before installation	4
Installation method	4
Product installation	5
Product use	9
Troubleshooting	11

■ Product installation

Preparation before installation

1. Check whether the total number of packages is correct and whether the appearance of the package is in good condition.
2. After removing the outer packaging, pls check if the product components are complete and whether they are damaged.
3. Choose the location where you want to place the product: It is recommended not to install in a narrow, humid, long distance from the power supply, and easy to shake.
4. Prepare the necessary tools for installation (pictured below).

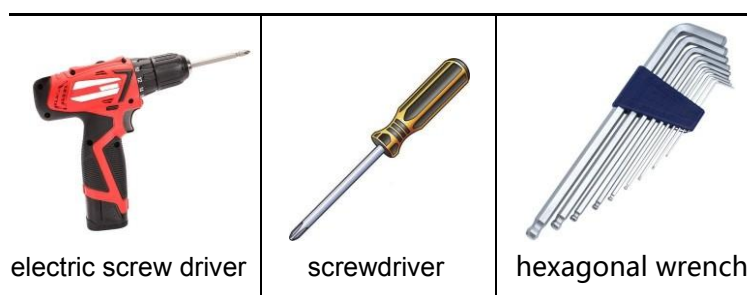

Installation method

Different products have different modes and different connection methods. There will be one or more connection methods, make sure the connection is firm during the connection process. The connection methods of the box are as follows:

• Buckle connection

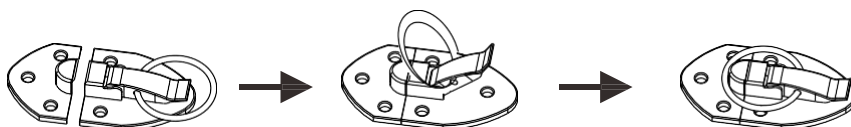

• Concealed buckle connection

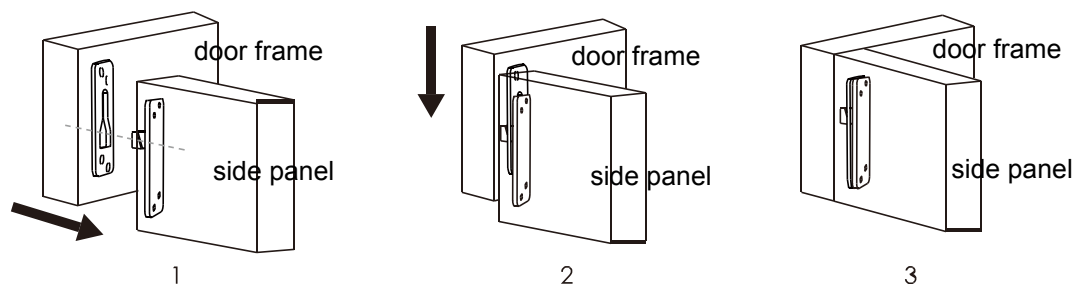

• Connection of screw

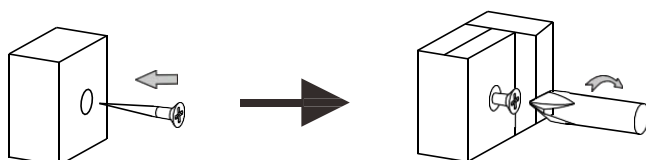

Step 1

1. Place the base part

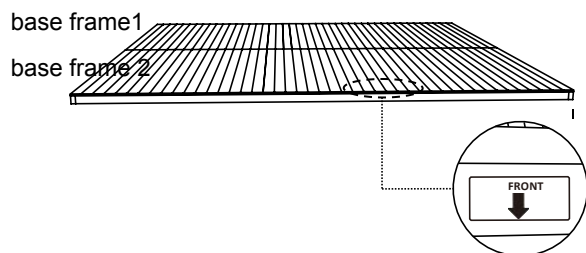

Pay attention to the front and rear direction, there are instruction stickers

Place the base frame at the installation position, and distinguish the front and rear positions of the base frame according to the stickers on the base frame. In order to avoid damage to your floor, it is recommended not to move the sauna as a whole after installation. Therefore, it is recommended:

- There is a power socket or wiring port at the selected location, and it is within the length of the power cord;
- Pay attention to the opening direction of the product to ensure that no other objects block the door when opening the door.

Step 2

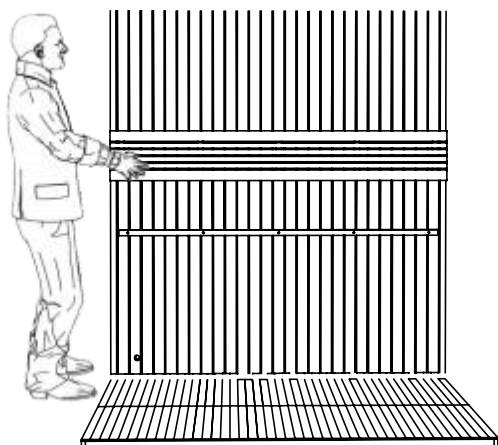

2. Place the back plate

Lift the rear panel, place the rear panel on the ground and align it with the bottom frame left and right, and arrange for personnel to support the rear panel to prevent injury from collapse.

Step 3

3. Place the left panel

Align the left side and the rear panel, align the card slots, and fasten the connection buckles.

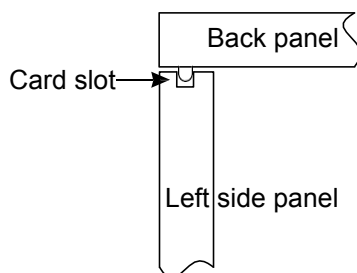
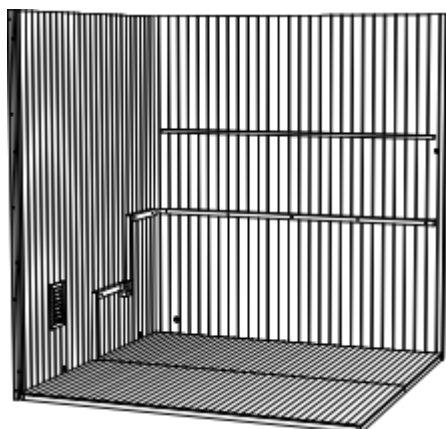

Align the card slots

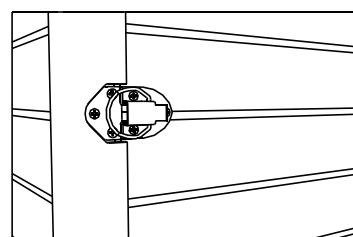

Firm the buckle

Product installation

Step 4

4. Place the right side panel

Align the right side panel and the rear panel, align the card slots, and firm the connection buckles

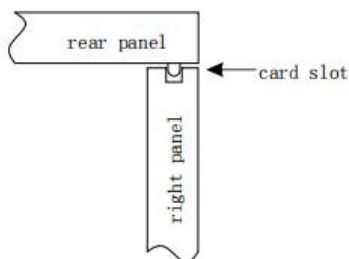
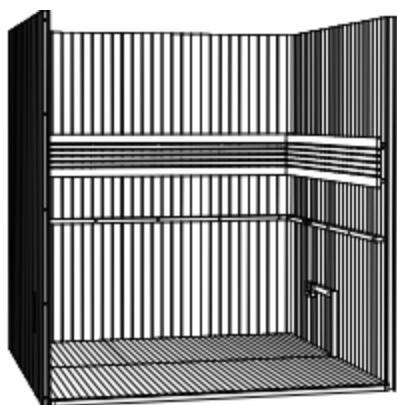

Align the card slot

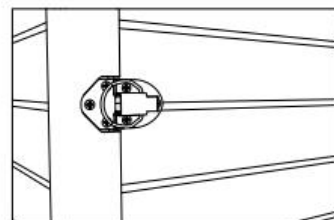

Fasten the buckle

Step 5

5. Place the front panel

Align the front panel with the left and right side panels and place them in place with the same height as the left and right side panels. Use screws to connect the front panel and the left and right side panels.

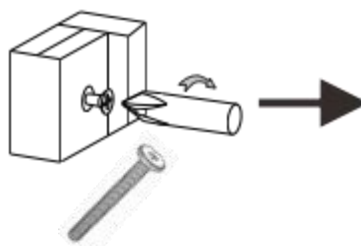
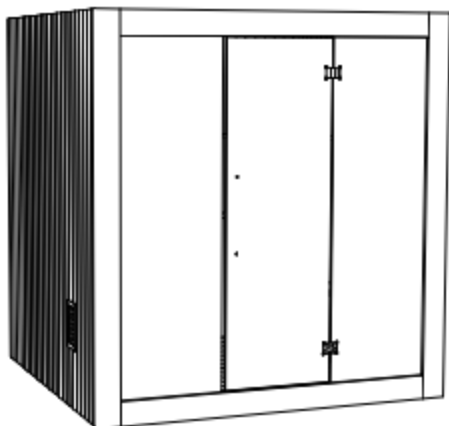

Screws M6*25=8PCS

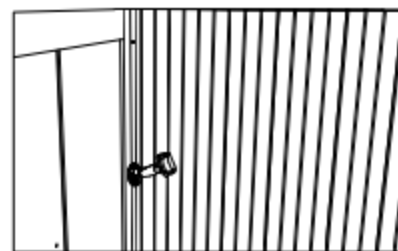

The front plate and the left and right side plates are connected with screws

Step 6

6. Place the top cover

Put the top cover in place. Because the sauna room is high, you need to use a pad when placing the top cover. couples people lift the top cover over the height of the room. When placing the top cover, special care should be taken not to crush the power cord on the side panel. Connect all power cords in place according to the power cord labels on the top cover.

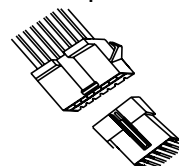

Control panel, lamp power cord connection

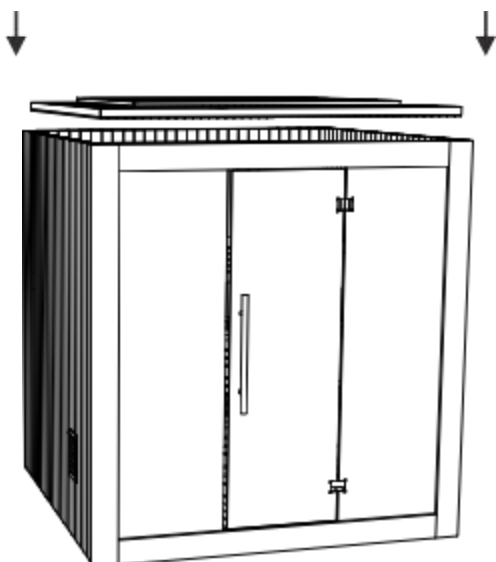

Product installation

Step 7

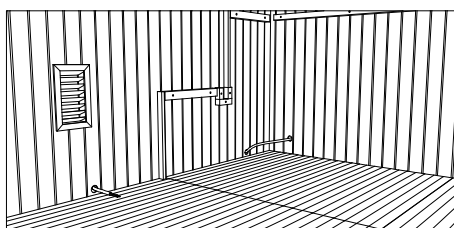

7. Power cord installation

Use the rope reserved on the left plate to pass the power cord through the left plate and fix the cable with the cable fixing head.

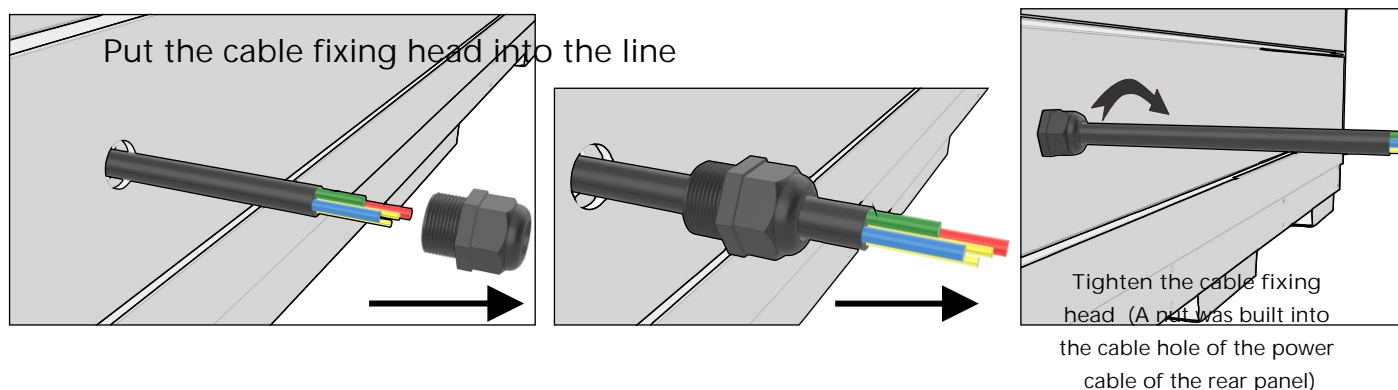

Step 8

8. Place a layer of seat panel and it's support

Place the seat panel and it's support in place according to the location shown in the picture, then align the seat panel to the location bar of right plate when placing the seat panel, and fix the seat panel with screws.

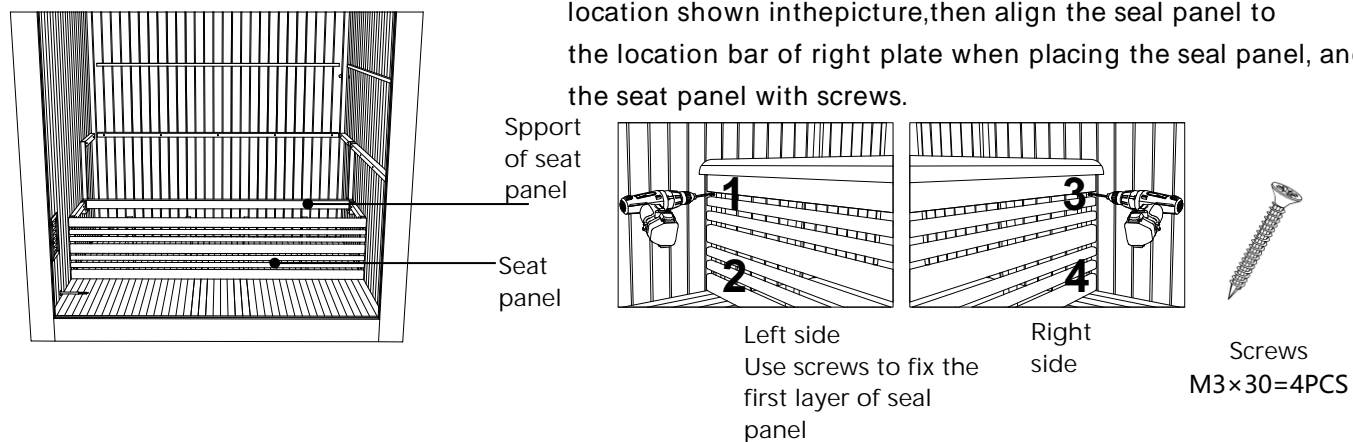

Step 9

9. Setting the first and the second seat panel

Setting the first and the second seats panel in right location according to they were shown in the picture, then use screws to fix the second seat panel at their locations, like 1, 2, 3 and 4 shown on the left and right sides.

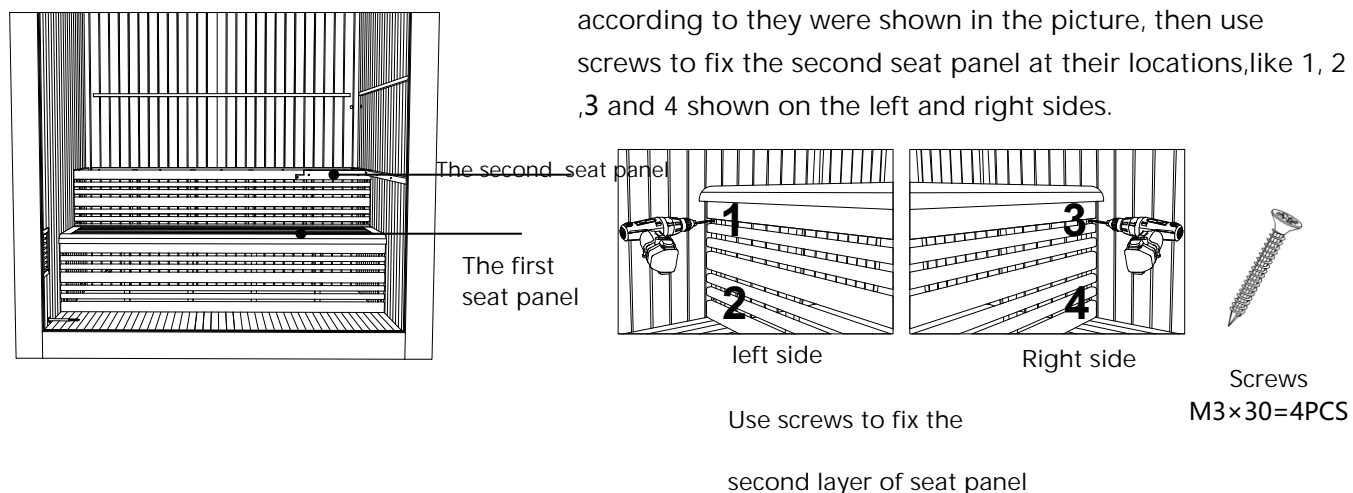

Product installation

Step 10

10. Install the support of the first and the second seat panel

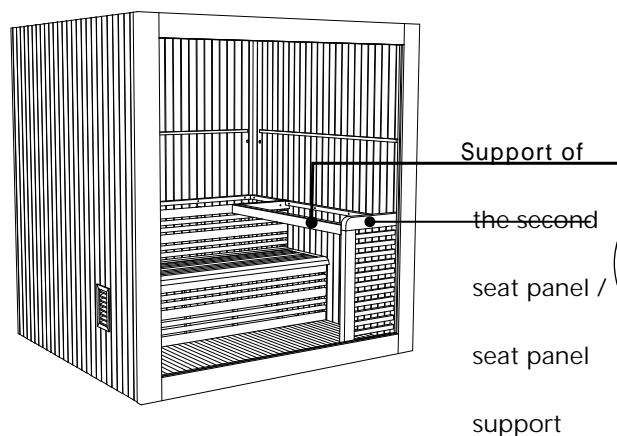

Install the support of the first and the second seat panel according to the picture shown and use the screws to fix the support of the second seat panel on location 1&2 like the picture shown as well.

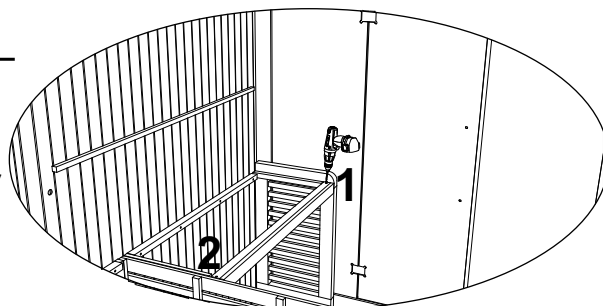

Use the screws to fix the support of the second seat panel

Screws
M3×40=2PCS

Step 11

11. Set the second seat panel and install the door handle.

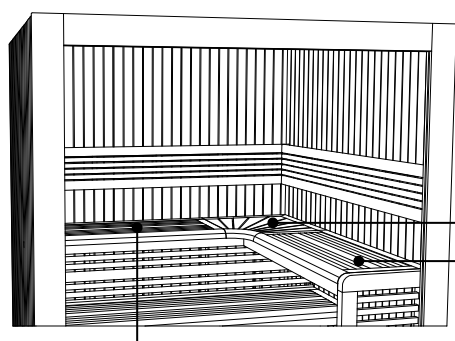

Part 1 of the second seat panel

Part 2 of the second seat panel

Set the part 1 seat panel, corner, the part 2 seat panel in right location and install the door handle according to the picture shown

External door handle

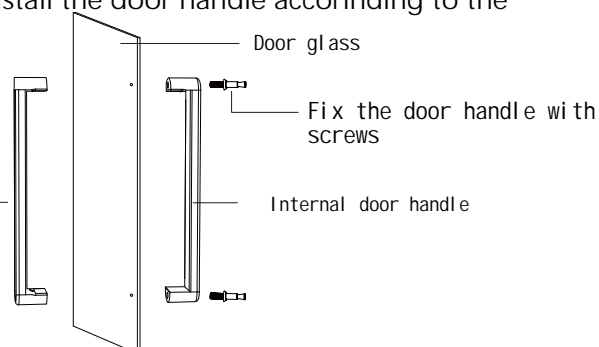

Door handle installation

Step 12

12. Install the shelf and place the heater

Assemble the shelf and fix the heater as the below picture show, then connect the heater with power cord according to the request of heater user manual.

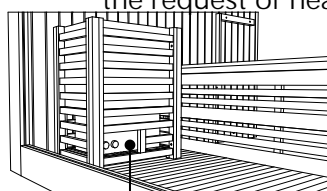
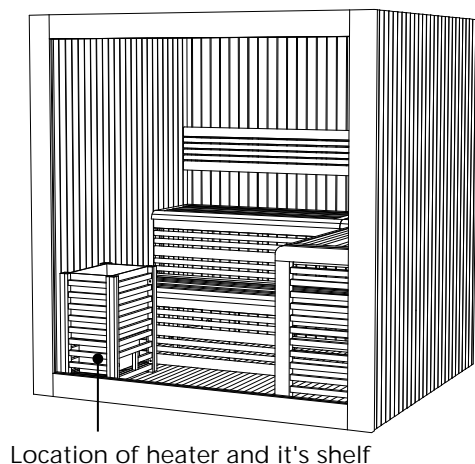

Pay attention to the shelf direction, the switch of heater should align to the entrance of the shelf as the picture shown

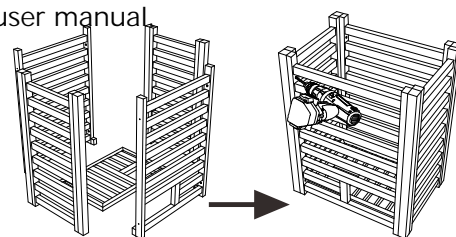

Use screws to install the shelf as shown

Screws
M3×40=8PCS

Product use

Electrical connection method

- Wiring diagram

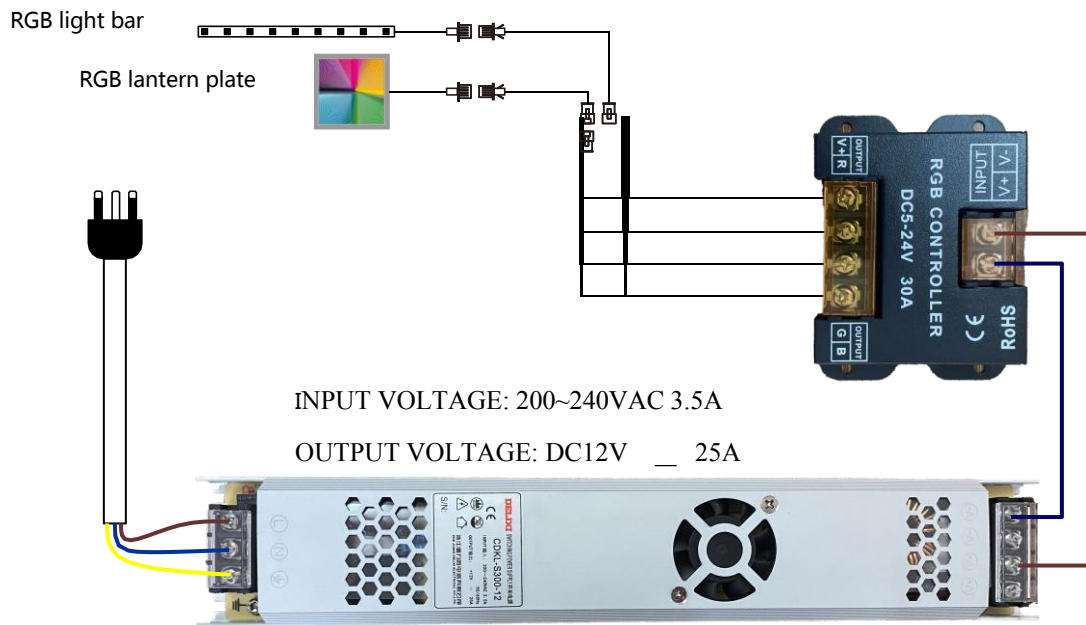

Light control panel usage

- Light control panel function introduction



- 1 switch
After the power is turned on and ready, press the power button, the light will turn on, and the last setting will be remembered by default after the power is turned on
 - 2 color switch
The color order is: red-green-blue-yellow-purple-cyan-white, cyclic switching.
 - 3 model+,model-
The buttons for switching colors are detailed in the mode list below.
- | No | Mode list | | |
|----|----------------------|-----------------------|--------------------|
| 1 | red gradient | red fast change | red strobe |
| 2 | green gradient | green fast change | green strobe |
| 3 | blue gradient | blue fast change | blue strobe |
| 4 | yellow gradient | yellow fast change | yellow strobe |
| 5 | purple gradient | purple fast change | purple strobe |
| 6 | cyan gradient | cyan fast change | cyan strobe |
| 7 | white gradient | white fast change | white strobe |
| 8 | tri-color gradient | tri-color fast change | tri-color strobe |
| 9 | seven-color gradient | seven-color change | seven-color strobe |
- 4 brightness+,brightness-
Brighten and dim the color of the lights.
 - 5 color change speed fast keycolor change speed slow down key
Adjust the speed of light color switch

Note: The light control panel is RF wireless control, the battery is a button battery, the battery model: CR20253V, when replacing the battery, it must be placed according to the positive and negative levels marked on the control panel.

Warm tips

1. Do not wear gold and silver jewelry such as bracelets in to the sauna room.
2. Do not place volatile substances such as drugs and alcohol in the sauna room.
3. Do not use the sauna room without the sauna stone.

Important hint

- ✖ When using the sauna room, it is forbidden to bring electronic equipment powered by lithium batteries into the sauna room to avoid potential safety hazards

NO	Failure	Cause Analysis	Solution
When troubleshooting, disconnect the power			
1	The power indicator is off	No power input	Check whether the power cord is plugged in and connected properly
		The cable is not connected	Check whether the control panel cable is connected well, and whether the terminal of the cable is disconnected
		The power light is broken	Replace the relevant control panel
2	Sauna stove not working	Sauna stove power cord loose	Check if the power cord is loose, plugged in tightly, and plugged in properly
		Sauna stove is damaged	Replace the sauna stove of the same specification
		Temperature sensor failure	Check whether the wire of the temperature sensor is plugged in, the inter face is loose, or need to be replaced with a new one
3	The light is off	The cable is not connected	Check whether the connecting wire is connected and reconnected, and whether the terminal of the wire is disconnected
		The lights is broken	Replace the lights with the same specification
4	Sauna not working	The power plug is not plugged in properly	Check and plug it back in
		Outlet without power	Check the outlet or wiring

- ✖ If the problem is still not resolved, please contact the dealer or manufacturer