

NC HIGHWAY 306
100 FT. IMPROVED PUBLIC R/W

TO NC101

CERTIFICATE OF OWNERSHIP AND DEDICATION
I HEREBY CERTIFY THAT WE ARE THE OWNERS OF THE PROPERTY SHOWN HEREON, WHICH IS LOCATED IN THE SUBDIVISION JURISDICTION OF THE COUNTY OF CRAVEN AND THAT WE HEREBY ADOPT THIS PLAN OF SUBDIVISION PURSUANT TO ARTICLE III, SECTION 304, OF THE CRAVEN COUNTY SUBDIVISION ORDINANCE WITH OUR FREE CONSENT AND ESTABLISH MINIMUM BUILDING SETBACK LINES AS NOTED.
OWNER: CHERRY BRANCH, LTD.
BY: *Donald J. Thomas, Jr.*
DATE: 5/22/03

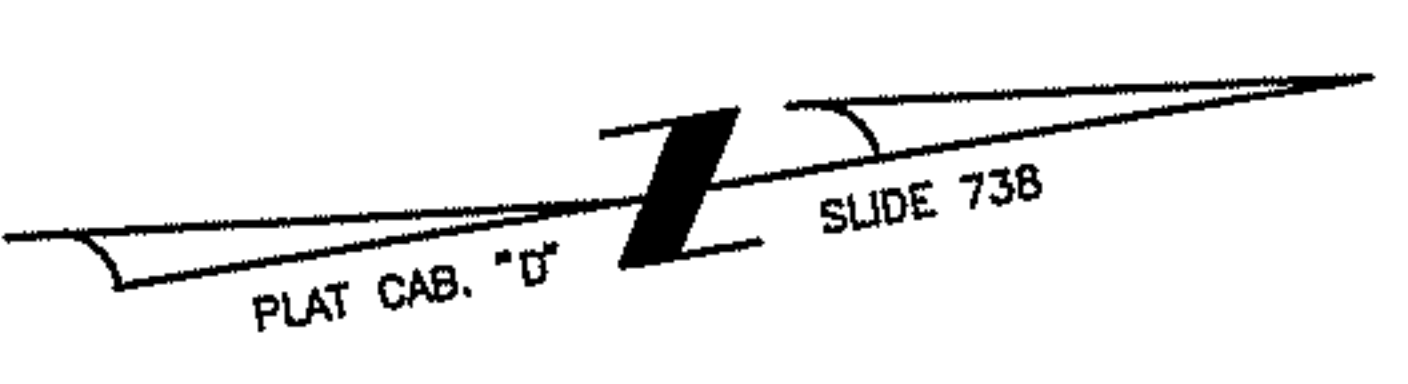

Work Flow No: 9999-00145110

Craven NC - Document Stamp
Becky Thompson, Registrar of Deeds
Date 06/04/2003 Time 13:24:16 1 of 1 Pgs
No: 2003-00069214
Book 2046 Page 526
Fee Amt: 21.00
Excise Tax: .00

CURVE DATA TABLE

CURVE	RADIUS	LENGTH	DELTA	CHORD	CH. BEARING
C1	1180.00'	189.64'	9°12'29"	189.43'	S75°23'30"E
C2	20.00'	31.08'	89°02'42"	28.05'	S35°28'23"E
C3	920.00'	115.00'	7°09'43"	114.93'	N77°22'10"W

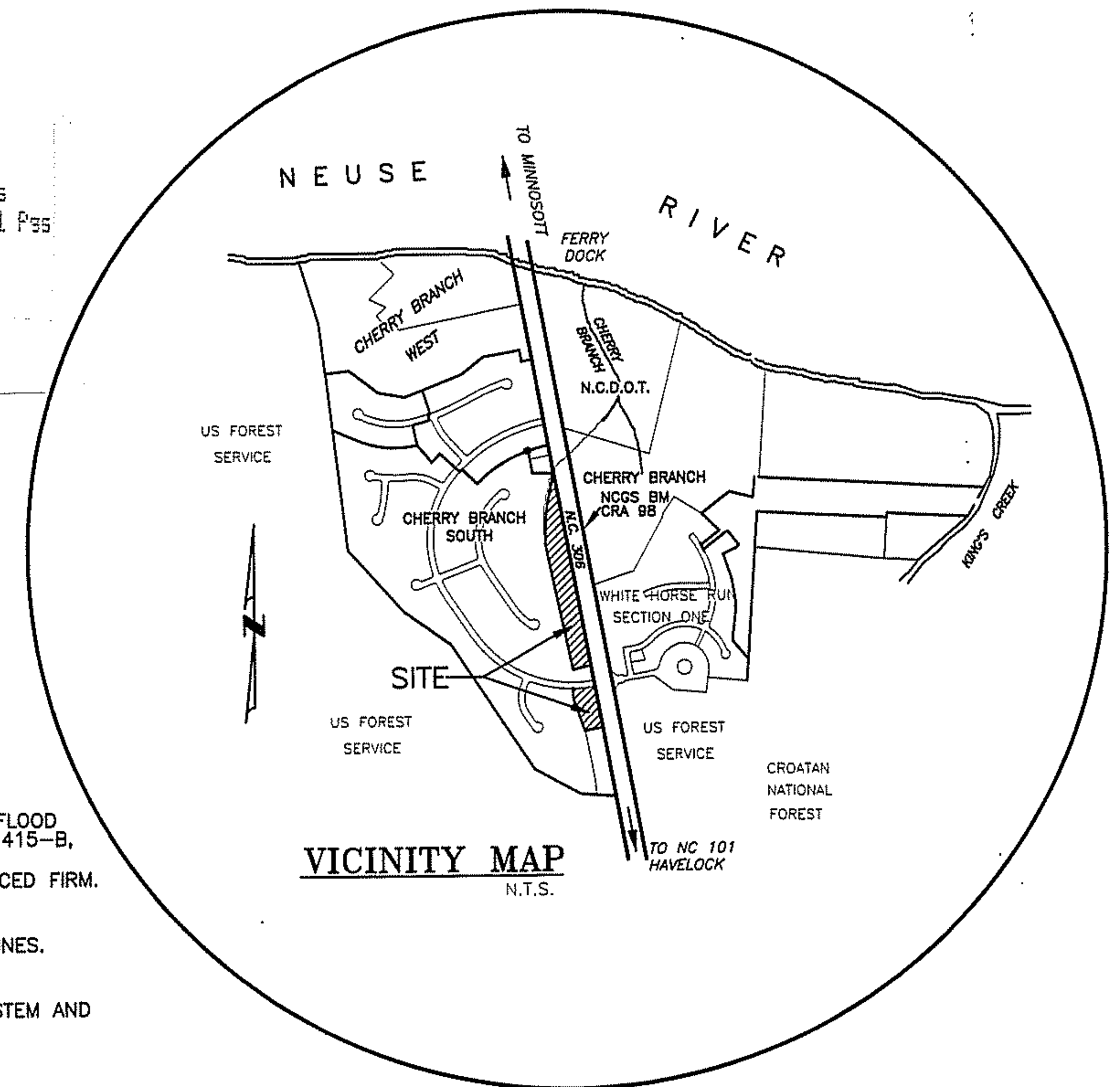

CERTIFICATE OF SURVEY AND ACCURACY
I, HERBERT J. NOBLES, JR. CERTIFY THAT THIS MAP WAS DRAWN UNDER MY SUPERVISION FROM AN ACTUAL SURVEY MADE UNDER MY SUPERVISION AND BOUNDARIES NOT SURVEYED ARE SHOWN AS DASHED LINES; THAT THE RATIO OF PRECISION AS CALCULATED IS 1:15000; THAT THIS MAP WAS PREPARED IN ACCORDANCE WITH G.S. 47-30 AS AMENDED. WITNESS MY ORIGINAL SIGNATURE, REGISTRATION NUMBER AND SEAL THIS 22nd DAY OF MAY 2003, A.D.
Herbert J. Nobles, Jr.
HERBERT J. NOBLES, JR. PLS #2703

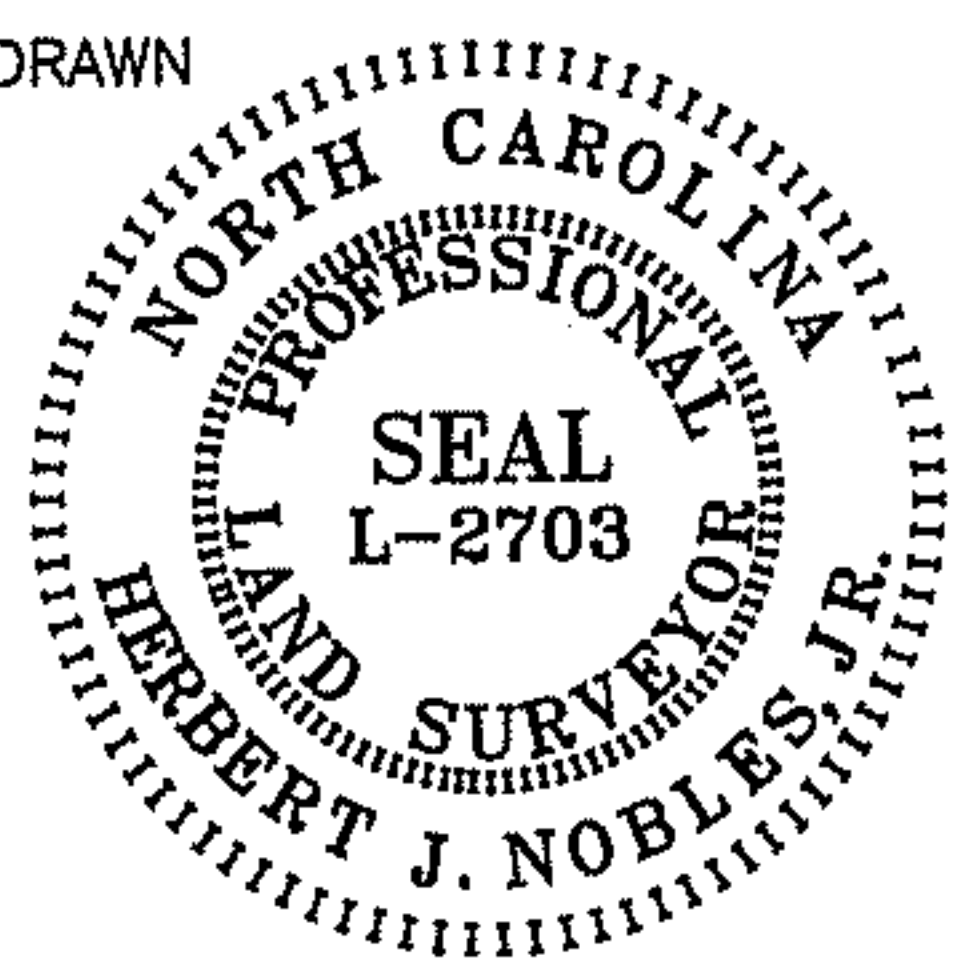

CERTIFICATE OF APPROVAL BY THE PLANNING BOARD
THE CRAVEN COUNTY PLANNING BOARD HEREBY APPROVES THE FINAL PLAT FOR CHERRY BRANCH SOUTH SECTION SIX.
Charles Dickinson
CHAIRMAN, PLANNING BOARD
DATE: 5/22/03

CERTIFICATE OF APPROVAL BY THE BOARD OF COUNTY COMMISSIONERS
THE CRAVEN COUNTY BOARD OF COMMISSIONERS HEREBY APPROVES THE FINAL PLAT FOR CHERRY BRANCH SOUTH SECTION SIX.
Johnnie Lammert
CHAIRMAN, CRAVEN COUNTY BOARD OF COMMISSIONERS
DATE: 6/02/03

CERTIFICATE OF LOCAL COASTAL AREA MANAGEMENT OFFICER
THIS SUBDIVISION CONFORMS TO THE STANDARDS OF THE NORTH CAROLINA COASTAL AREA MANAGEMENT ACT OF 1974 AND PORTIONS THEREOF ARE NOT LOCATED IN AN AREA OF ENVIRONMENTAL CONCERN.
Orley K. Wilt
LOCAL PERMIT OFFICER
DATE: 5/23/03

CERTIFICATE OF APPROVAL BY ENVIRONMENTAL HEALTH
UNLESS SPECIFICALLY REMARKED IN THE GENERAL NOTES OF THIS PLAT THE CRAVEN COUNTY HEALTH DEPARTMENT, BASED ON THE INFORMATION SUBMITTED WITH THE APPLICATION, HAS PERFORMED A SITE EVALUATION ON EACH LOT LOCATED WITHIN CHERRY BRANCH SOUTH SECTION SIX. COPIES OF THE SITE EVALUATION AND IMPROVEMENT PERMITS FOR THE SEWAGE COLLECTION TREATMENT AND DISPOSAL SYSTEMS PLANNED TO SERVE EACH LOT ARE AVAILABLE FOR REVIEW IN THE OFFICE OF THE DIVISION OF ENVIRONMENTAL HEALTH.
R. D. Sibley
DIRECTOR
DIVISION OF ENVIRONMENTAL HEALTH
CRAVEN COUNTY HEALTH DEPARTMENT
DATE: 6/02/03

STATE OF NORTH CAROLINA
CRAVEN COUNTY
Theresa Looney
REVIEW OFFICER OF CRAVEN COUNTY,
CERTIFY THAT THE MAP OR PLAT TO WHICH THIS CERTIFICATION IS AFFIXED MEETS ALL STATUTORY REQUIREMENTS FOR RECORDING.
DATE: 6/4/03

CERTIFICATE OF APPROVAL OF WATER SUPPLY SYSTEM
I CERTIFY THAT THE WATER SYSTEM INSTALLED OR PROPOSED FOR INSTALLATION IN CHERRY BRANCH SOUTH SECTION SIX FULLY MEETS THE REQUIREMENTS OF THE NORTH CAROLINA DEPARTMENT OF ENVIRONMENTAL AND NATURAL RESOURCES, DIVISION OF ENVIRONMENTAL HEALTH PUBLIC WATER SUPPLY SECTION AND IS HEREBY APPROVED AS SHOWN.
Ray Hays
SUPERINTENDENT
CRAVEN COUNTY WATER DEPARTMENT
DATE: 5/30/03

CERTIFICATION OF REGISTRATION BY REGISTER OF DEEDS
CRAVEN COUNTY NORTH CAROLINA
FILED FOR REGISTRATION THIS 4 DAY OF June
2003 A.D. AT 1324 (AM/PM) AND DULY RECORDED IN PLAT
CABINET 6, SLIDE(S) 1673
Becky Thompson
REGISTER OF DEEDS

- GENERAL NOTES:**
CHERRY BRANCH SOUTH - SECTION SIX
- THIS PROPERTY SCALED IN ZONE "A6" & "C" AS PER FLOOD INSURANCE RATE MAP COMMUNITY 370072, PANEL NUMBER 415-B, EFFECTIVE DATE OF MAY 04, 1987.
 - THIS REPORT IN NO WAY SUPERSEDES THE ABOVE REFERENCED FIRM.
 - DRAINAGE AND UTILITY EASEMENTS ARE AS FOLLOWS:
A. 10 FOOT EASEMENTS ALONG RIGHTS-OF-WAY.
B. 15 FOOT EASEMENTS CENTERED ALONG ALL SIDE LOT LINES.
C. 20 FOOT EASEMENTS ALONG ALL REAR LOT LINES.
D. OTHER EASEMENTS AS SHOWN ON PLAT.
 - THIS SUBDIVISION TO BE SERVED BY PUBLIC WATER SYSTEM AND INDIVIDUAL SEPTIC SYSTEMS.
 - MINIMUM BUILDING SETBACKS ARE AS FOLLOWS:
A. 10 FOOT SIDE SETBACKS.
B. 25 FOOT REAR SETBACKS.
C. 50 FOOT FRONT SETBACKS.
D. 75 FOOT MINIMUM LOT WIDTH AT SETBACK LINE.
 - TOTAL ACREAGE IN CHERRY BRANCH SOUTH - SECTION SIX IS 7.8465 ACRES.
 - FIGURES IN PARENTHESES () DENOTE LOT SIZE IN SQUARE FOOTAGE.
 - DENOTES CONTROL CORNERS.
 - THE TOTAL NUMBER OF LOTS IN CHERRY BRANCH SOUTH SECTION SIX IS 5 LOTS.
 - THIS SUBDIVISION IS NOT IN A ZONE CONTROLLED BY ZONING REGULATIONS.
 - ALL CORNERS ARE MARKED WITH IRON PIPES.
 - APPROVAL OF THIS SUBDIVISION PLAT BY THE CRAVEN COUNTY BOARD OF COMMISSIONERS DOES NOT ADDRESS THE ISSUE OF THE EXISTENCE OR NONEXISTENCE OF WETLANDS WITHIN THE SUBDIVISION. THE ENFORCEMENT OF WETLAND REGULATIONS UNDER THE SECTION 404 OF THE CLEAN WATER ACT OF 1989 IS WITHIN THE JURISDICTION OF THE U.S. ARMY CORPS OF ENGINEERS. INQUIRIES CONCERNING THAT MATTER SHOULD BE ADDRESSED TO THAT AGENCY.
 - ANY PRIVATE WATER SUPPLY SOURCE SHALL BE LOCATED A MINIMUM HORIZONTAL DISTANCE OF 100 FEET FROM ANY OBVIOUS SOURCES OF CONTAMINATION.
 - PLOT PLANS FOR ANY GIVEN LOT MAY BE REQUIRED BY A THE CRAVEN COUNTY HEALTH DEPARTMENT.
 - THIS SURVEY CREATES A SUBDIVISION OF LAND WITHIN THE AREA OF CRAVEN COUNTY THAT HAS AN ORDINANCE THAT REGULATES PARCELS OF LAND.
 - ELEVATION BENCH MARK REFERENCE: NCGS "CRA 98", BRASS DISK SET FLUSH IN A CONCRETE CURB AT ENTRANCE TO CHERRY BRANCH SUBDIVISION. PUBLISHED ELEVATION = 14.80 FT. (4.511 METERS).
 - A PORTION OR ALL OF THIS SUBDIVISION FALLS WITHIN THE 100E WIND ZONE AS ESTABLISHED BY STATE BUILDING CODES OFFICIALS. RESIDENTS AND BUYERS SHOULD CONSULT WITH THE BUILDING INSPECTIONS DEPARTMENT FOR ANY SPECIFIC FOUNDATION REQUIREMENTS FOR STRUCTURES THAT FALL WITHIN THIS ZONE.
 - ALL LOTS ARE SUBJECT TO A 50 FOOT BUFFER FROM CHERRY BRANCH IN ACCORDANCE TO THE NUSE RIVER BUFFER RULES.
 - DRIVEWAY FOR LOT 150 SHALL BE INSTALLED FROM JACQUELINE DRIVE. NO DRIVEWAY SHALL BE ALLOWED FROM LOT 150 ONTO NC 306.

OWNER/DEVELOPER: CHERRY BRANCH, LTD.
803-A EAST MAIN STREET
HAVELOCK, NC 28532
252-447-1529

CONSULTING ENGINEER: JOHN G. THOMAS, P.E. #10147
THOMAS ENGINEERING, P.A. #C-148
P.O. BOX 1309 403-C AIRPORT ROAD
NEW BERN, NORTH CAROLINA 28563
(252) 637-2727 FAX: (252) 636-2448

LAND SURVEYOR: HERBERT J. NOBLES, JR.
186 CAMPEN ROAD
BAYBORO, NORTH CAROLINA 28515
252-745-5951

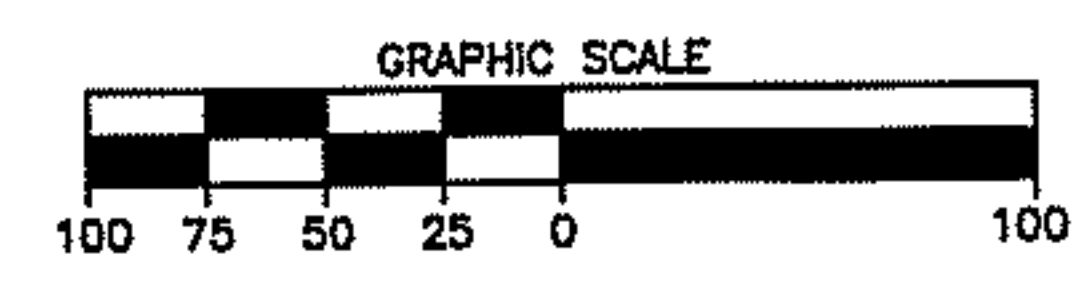

SITE PLAN		
FINAL PLAT		
CHERRY BRANCH SOUTH		
SECTION SIX		
TOWNSHIP No. 5	CRAVEN COUNTY	NORTH CAROLINA
SCALE: 1"=100'	PROJ: 2002006	DATE: JULY 10, 2002
PLOT: 1:100	FILE: FINAL_PLAT	SHEET: 1 OF 1

02/10/03