

Acoustic Dry Screed Flooring Panels

Knauf acoustic dry screed panels create a robust and monolithic floor treatment

Profile jointing options are:

- Brio lap joints being glued & screwed together or
- T&G joint being just glued together

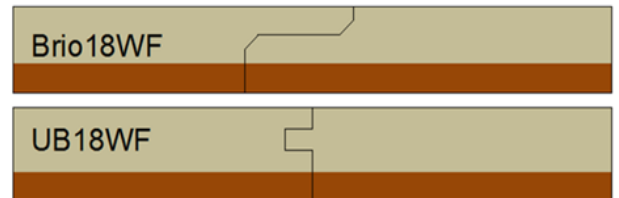

28mm Brio18WF & 28mm UB18WF are interchangeable

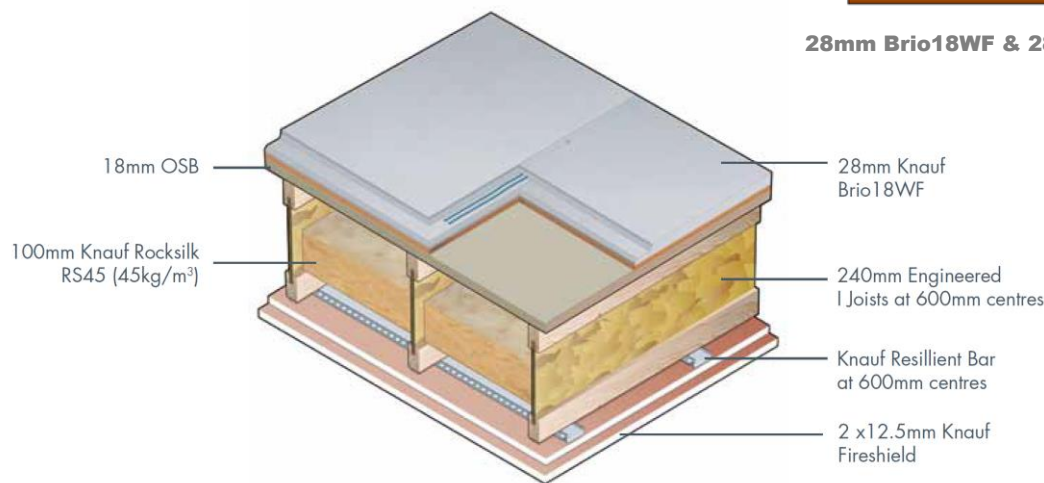

Technical Data

Density	1100-1200kg/m ³ (gypsum fiber board)
Dimensions	18mm thick (28mm with WF), 600x1200mm

System Acoustic Information

Airborne	60dB R _w
Impact	58dB L _{n, w}

Brio 18WF & UB 18WF Fire Performance

From above	90mins
From below	60mins

Brio 18WF & UB 18WF Thermal Performance

Thermal resistance	0.23m ² K/W
--------------------	------------------------

Loading

Point Loading	2kN*
Area Loading	3kN/m ² *

*Safety Factor of x2

Customer Service

Tel: 0800 521 050
 cservice@knauf.co.uk

Technical Service

Tel: 01795 416 259
 technical@knauf.co.uk

Knauf Factory Locations

Knauf
 Kemsley Fields Business Park
 Sittingbourne
 Kent ME9 8SR
 Tel: 01795 424 499
 Fax: 01795 428 651

Website

www.knauf.co.uk

© Copyright Knauf 2012

The information given in this publication is believed to be current and accurate as at the date of publication, but no warranty, express or implied is given. Updates will not be automatically issued.

The above acoustic performance data is taken from test reports carried out at the Sound Research Laboratories, Sudbury. The tests were in accordance with BSEN ISO – 717-1:1997 and BSEN ISO 717-2:1997. The laboratory performances stated are specific to the above system only, inclusive of all elements shown and correct installation. They should be used for guidance only.

All loading data is tested in accordance with DIN 1055-3.

All fire performance data & building material classes are to EN 13501-1