

SEWARD HIGHWAY (1-SOUTH)

HOMER DRIVE (45 MPH)

HOMER DRIVE (45 MPH)

LEGEND:

-  LOADED SWS TRANSFER TRAILER
-  EMPTY SWS TRANSFER TRAILER
-  LOADED SWS COLLECTION VEHICLE
-  EMPTY SWS COLLECTION VEHICLE
-  LOADED COMMERCIAL VEHICLE
-  EMPTY COMMERCIAL VEHICLE
-  LOADED RESIDENTIAL VEHICLE
-  EMPTY RESIDENTIAL VEHICLE
-  EMPLOYEE / VISITOR VEHICLE
-  PROPOSED PERIMETER SECURITY FENCE
-  EXISTING CONSERVATION EASEMENT (APPROX.)
-  EXISTING SITE PROPERTY BOUNDARY
-  EXISTING OFF-SITE PROPERTY LINE
-  EXISTING RIGHT OF WAY LIMIT/PROPERTY BOUNDARY
-  EXISTING UTILITY EASEMENT
-  EXISTING FENCE

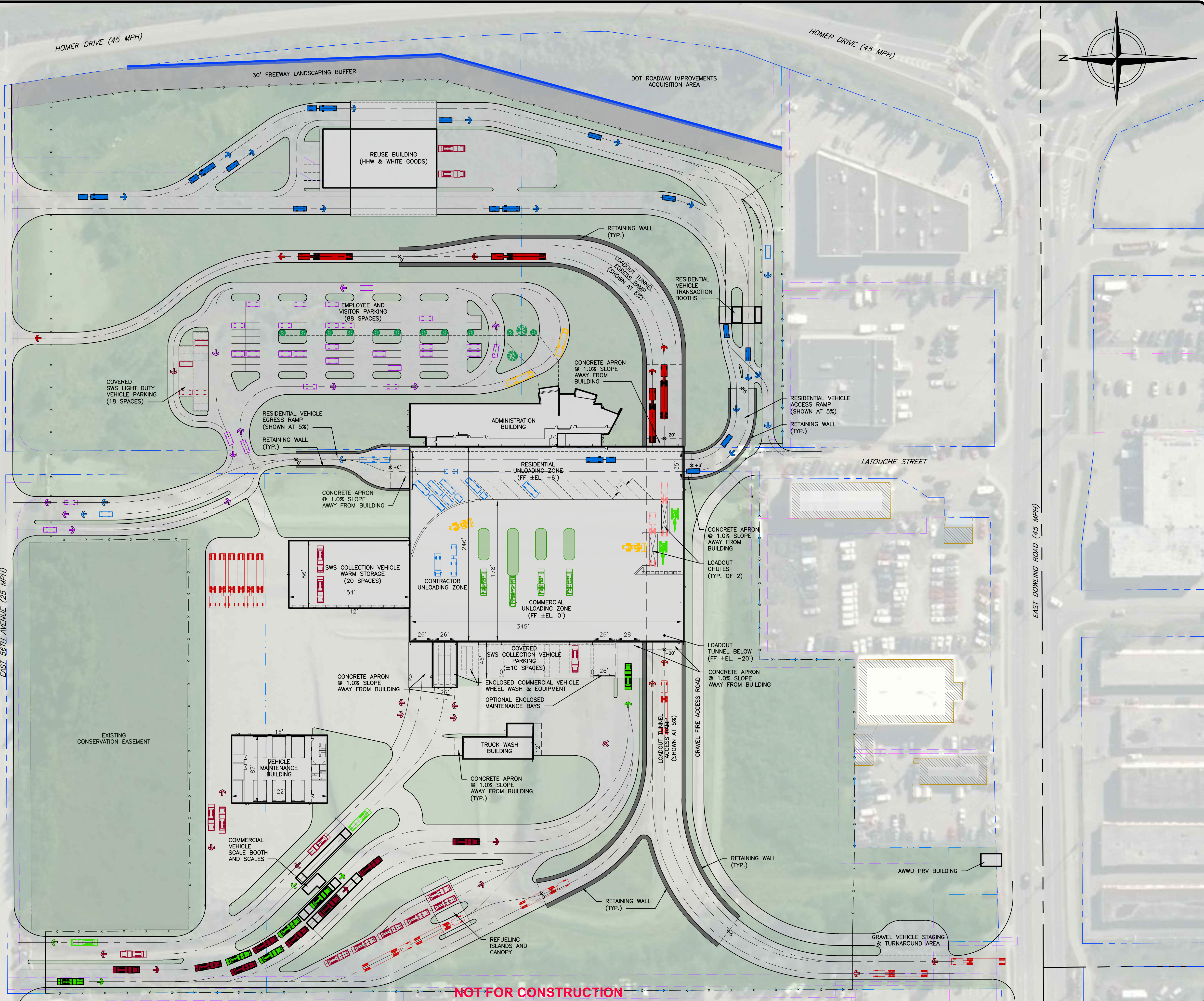

File: X:\PROJECTS\MUNICIPALITY OF ANCHORAGE\190461 - SW\_CTS\_Plan\_Drawings\190461-5-01-CONCEPT PLAN-11-14-19.DWG Layout: SITE PLAN User: b.pedmon@tetra.com Nov 14, 2019 - 2:20pm  
 1" = 1/2" = 0"  
 0 60 120  
 SCALE IN FEET

NOT FOR CONSTRUCTION

| REV | DATE       | DESCRIPTION   | OWN BY | DES BY | CHK BY | APP BY |
|-----|------------|---------------|--------|--------|--------|--------|
| 1   | 11/14/2019 | DATE OF ISSUE |        |        |        |        |
|     |            | DRAWN BY      |        |        |        |        |
|     |            | DESIGNED BY   |        |        |        |        |
|     |            | CHECKED BY    |        |        |        |        |
|     |            | APPROVED BY   |        |        |        |        |



MUNICIPALITY OF ANCHORAGE SOLID WASTE SERVICES  
 CENTRAL TRANSFER STATION  
 MUNICIPALITY OF ANCHORAGE, ALASKA

CONCEPTUAL SITE PLAN

SHEET NO.  
**CS101**  
 PROJECT NO.  
 190461

This drawing represents intellectual property of Tetra Tech. Any modification to the original by other than Tetra Tech personnel violates the original purpose and as such is considered void. Tetra Tech will not be held liable for any changes made to this document without express written consent of the originator.

1 2 3 4 5 6 7

F  
E  
D  
C  
B  
A

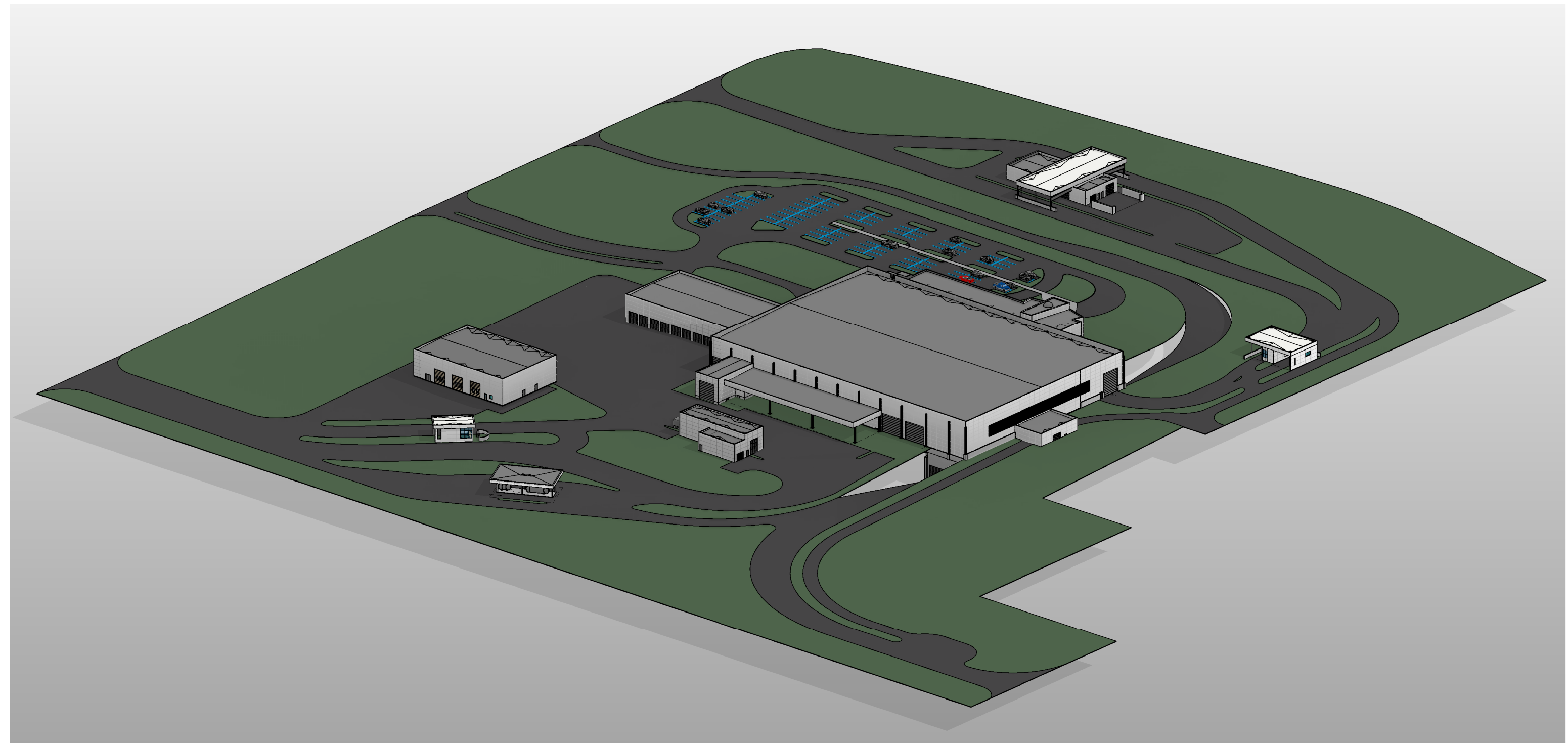
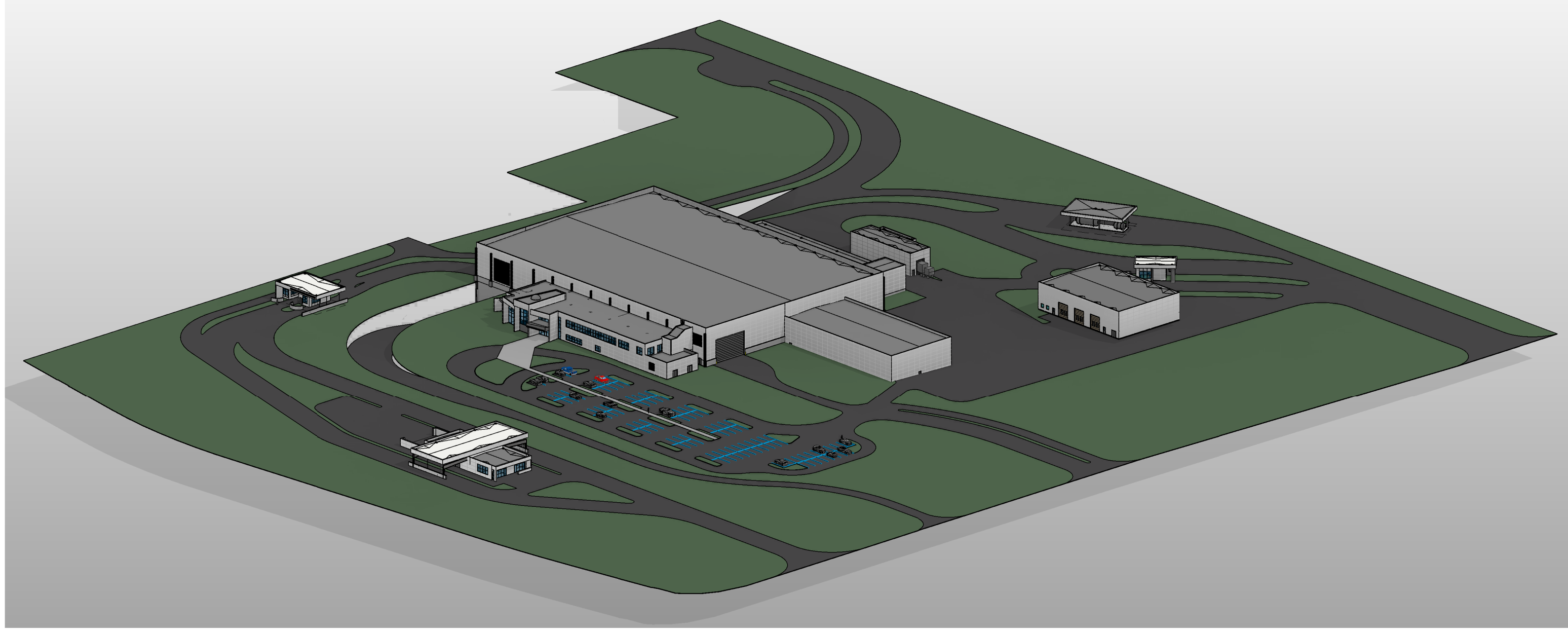

11/13/2019 3:02:57 PM BIM 360://200-93602-19002 Anchorage SVTS/93602-SITE-A-2019.rvt



**TETRA TECH**  
www.tetratech.com  
1420 Fifth Avenue, Suite 600  
Seattle, Washington 98101  
TEL: 206.883.9900

10% SUBMITTAL

NOT FOR  
CONSTRUCTION

BY

MARK DATE DESCRIPTION

MUNICIPALITY OF ANCHORAGE  
SOLID WASTE SERVICES

SITE LAYOUT

PROJ: 200-93602-19002  
DESN: Designer  
DRWN: Author  
CHKD: Checker

**G-003**

Copyright: Tetra Tech

Bar measures 1 inch, otherwise drawing is not to scale