

CVCB



CENTRAL
VALLEY
COMMERCIAL
BROKERS, INC

FOR SALE

905 Main Street

APN: 038-190-07



Property Details

- Listing Price: \$875,000
- 6,707 SF.
- Office/Retail
- Enclosed loading dock
- Large retail area
- Ample on-site parking
- High foot traffic
- Utilities:
- Water: City of Delano
- Electricity: SoCal Edison
- Gas: SoCal Gas
- Located at center of Downtown Delano
- Corner location across from Vallarta Grocery Store



HENRY E. MENDEZ, JR.

CA RE #01127054 CA DRE #02084340 • Broker/ Principal
hmendez@cvcbrokers.com • 661.404.4090 Office
930 Truxtun Ave., Suite 101, Bakersfield, CA 93301

The information contained herein may have been obtained from sources other than CVCB. We have not verified such information and make no guarantees, warranties, or representations about such information. It is your responsibility to independently confirm its accuracy and completeness prior to purchasing/leasing the property.

Property Photos



FOR SALE

905 Main Street

Floor Plan

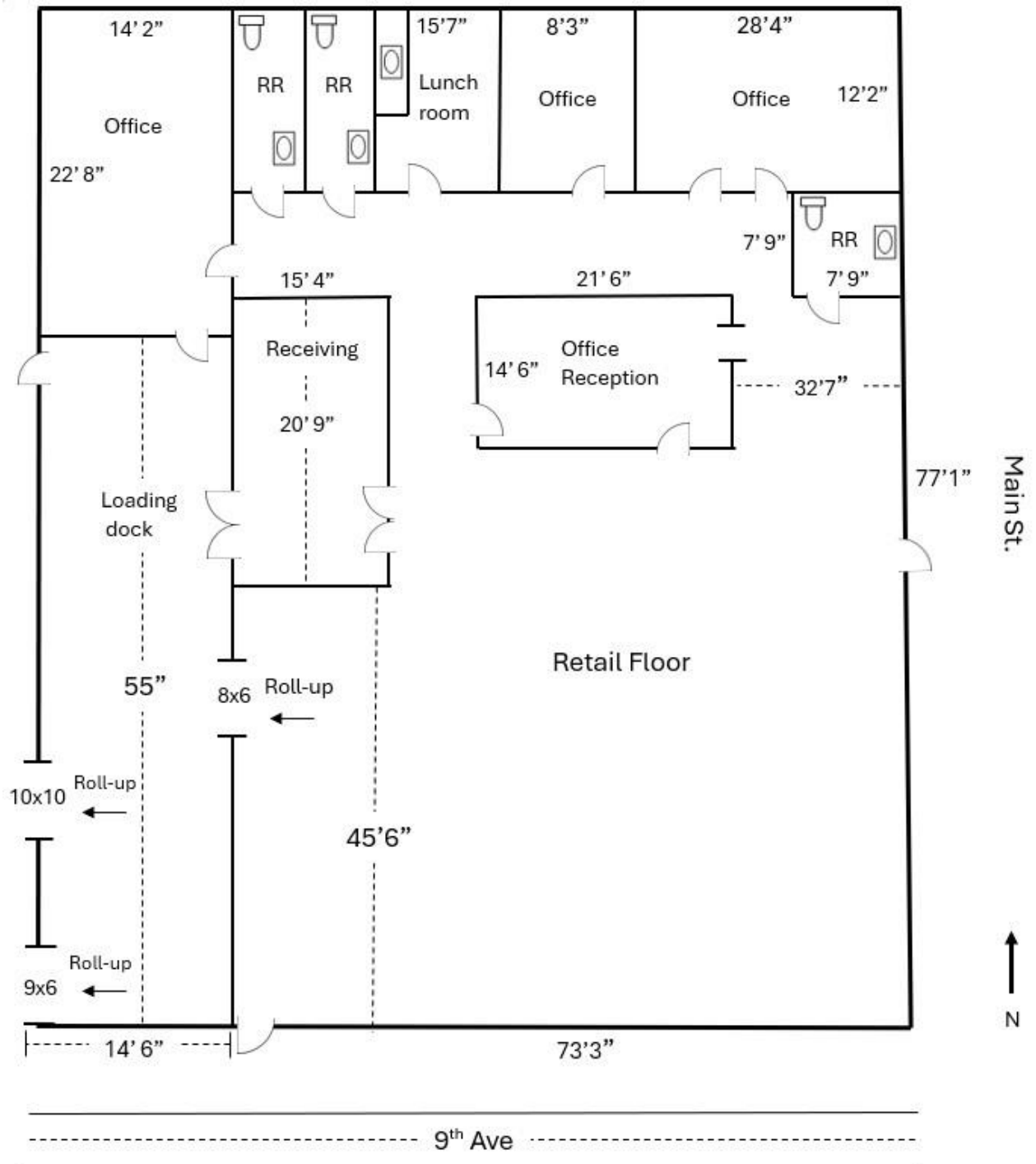

HENRY E. MENDEZ, JR.

CA RE #01127054 CA DRE #02084340 •Broker/ Principal

hmendez@cvcbrokers.com •661.404.4090 Office

930 Truxtun Ave., Suite 101, Bakersfield, CA 93301

The information contained herein may have been obtained from sources other than CVCB. We have not verified such information and make no guarantees, warranties, or representations about such information. It is your responsibility to independently confirm its accuracy and completeness prior to purchasing/leasing the property.



FOR SALE

905 Main Street

Aerial Map

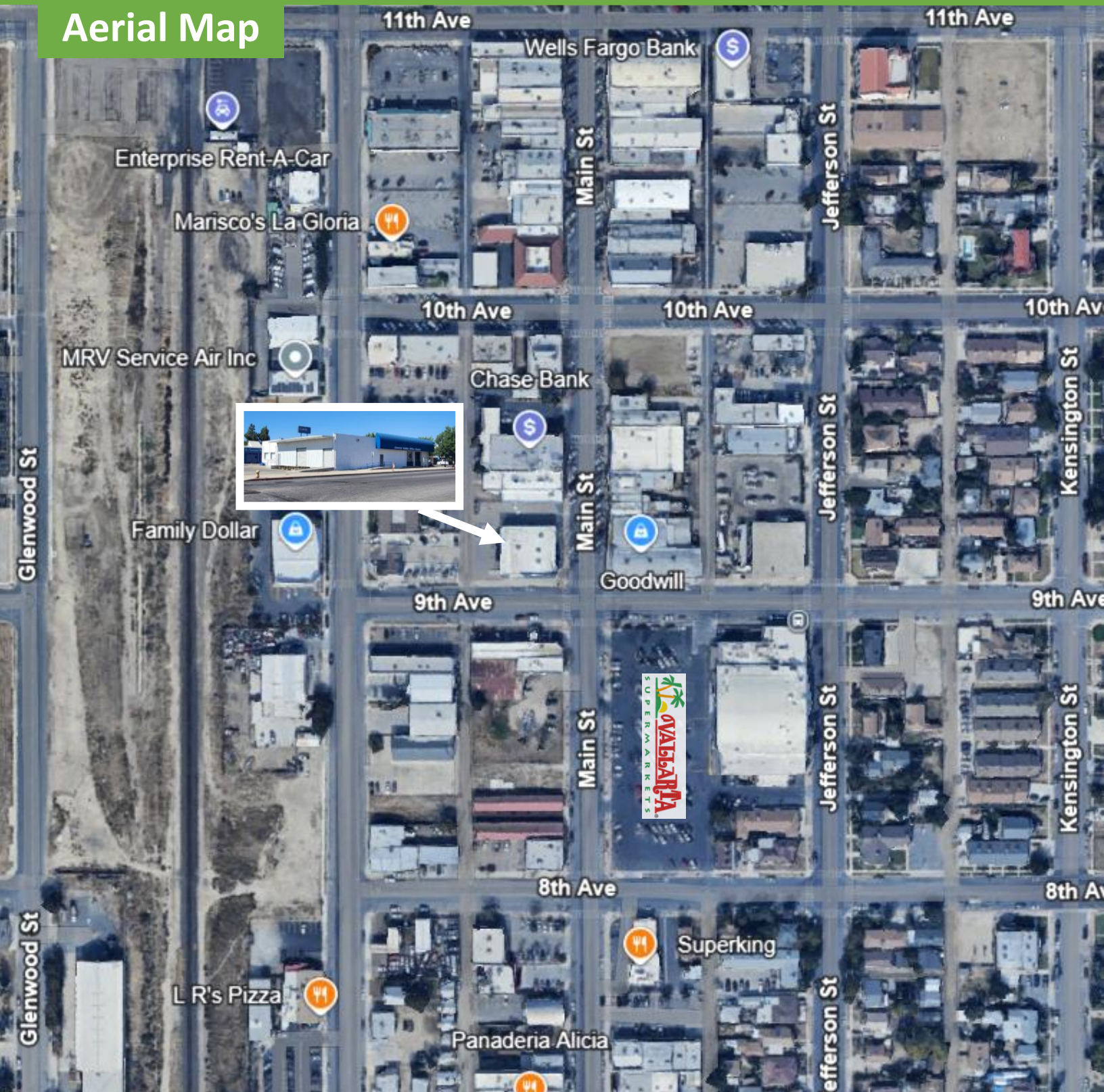

HENRY E. MENDEZ, JR.

CA RE #01127054 CA DRE #02084340 • Broker/ Principal

hmendez@cvcbrokers.com • 661.404.4090 Office

930 Truxtun Ave., Suite 101, Bakersfield, CA 93301

The information contained herein may have been obtained from sources other than CVCB. We have not verified such information and make no guarantees, warranties, or representations about such information. It is your responsibility to independently confirm its accuracy and completeness prior to purchasing/leasing the property.

