

Nims Center Studio

*Information
and Floor Plans*



Features:

- Offices and Stages are located in the same working space.
- Includes all offices and production spaces not utilized by Nims as shown on the site map.
- All offices include furniture.
- All HVAC systems for the offices and stages have the highest grade MERV filters available.
- All filters are changed according to CDC and manufacturers guidelines.
- HVAC systems continuously refresh and cleanse air via the latest commercial UV Sanitization Technology
- Sanitizing stations are present throughout the facility.
- All production spaces are wired for phone and Internet.
- 1GB internet service is provided. Additional bandwidth can be added for an additional fee.
- Auditel has been the phone service provider for Nims Center productions for the last 20 years. The tenant may make arrangements with Auditel for their phone services directly.
- Certain areas have monitors with DirectTV full access programming (included). Additional DirectTV drops can be added for an added cost.
- Security stations in the lobby for check-in and a guard booth near the automatic gate
- All major areas are covered with security cameras and have Sonitrol card reader access points.
- Reserved parking available in front of the facility. Dedicated crew parking on the back lot which is secured.

Additional Services and Support Spaces:

- On-site full recording and ADR facility
- Screening Room
- Day Stage E
- Dailies room with a dedicated 1GB fiber internet connection
- 7 pre-wired editorial suites
- Cast dressing rooms and green room space

Nims Center Studio Information

Buildings 800, 820 and 824 Distributors Row

Nims Center Studio Layout 1st Floor

Buildings 800, 820 and 824 Distributors Row



Nims Center Studio Layout 2nd Floor
Buildings 800 and 824 Distributors Row

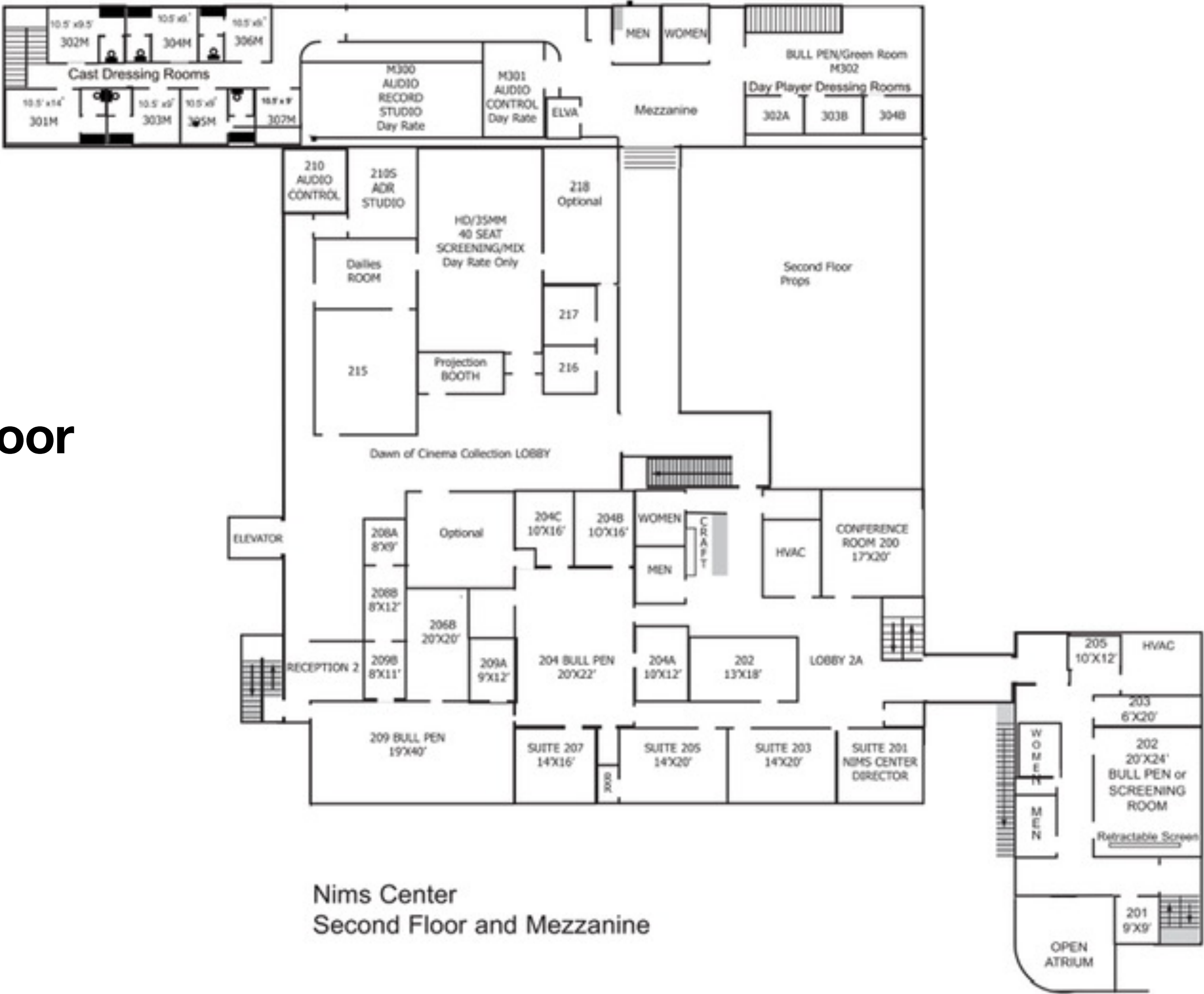

Nims Center
Second Floor and Mezzanine

Nims Center Studio

*Stage Dimensions
and Grid Height*



Nims Center Studio Stage D

10,000 sqft.



Nims Center Studio Stage D

10,000 sqft.



Working Dimensions:

Length - 125'

Width - 80'

Grid:

Height - 35'

(Ceiling Height - 40')



Nims Center Studio Stage A

20,000 sqft.

Working Dimensions:

Length - 178'

Width - 111'8"

Grid:

Maximum Height - 29'6"

Minimum Height - 25'7"

(South Wall)



Space Between Support Beams:

Column A and East Wall - 29'6"

Column A and Column B - 29'6"

Column B and Column C - 69'

Column C and Column D - 29'6"

Nims Center Studio Stage B

10,000 sqft.

Working Dimensions:

Length - 178'

Width - 56'

Grid:

Maximum Height - 29'6"

Minimum Height - 25'7"

(North Wall)



Nims Center Studio Stage C

6,500 sqft.

Working Dimensions:

Length - 90'

Width - 70'

Pipe Grid:

Height - 16'4"



Uses:

Stage C has been used as a stage, swing stage, indoor catering with proper COVID spacing, setdec storage