

*Discover Manchester's North End
A Neighborhood with History, Charm, and Endless
Possibilities*



real

Prepared by Elizabeth Moreau
Granite Key Properties
elizabeth@granitekeyproperties.com
603-782-6776

Brokered by Real Broker NH LLC 855-450-0442

WELCOME TO THE NORTH END

Manchester's North End is one of the city's most well-known and historic neighborhoods. It offers a unique blend of old-world character, modern amenities, and community conveniences that make it a highly desirable place to call home.

Whether you're selling your property or considering a move here, understanding what makes the North End special is key to appreciating its value.

Tastefully decorated and furnished, feel at home in our vacation rental. Big living room with a sofa bed and a french door that leads out into the garden. Big separated fully equipped kitchen, double bedroom and bathroom with a large shower. Perfect for relaxing after a busy day sight-seeing in Amsterdam. Please let us know if you need anything else!

GRANITE KEY PROPERTIES
LISTING/BUYING/TRANSITIONS



MANCHESTER

A STORIED PAST

The North End is rich with history. Walking through its tree-lined streets, you'll find a blend of historic homes—some dating back over a century—alongside more modern residences. Architectural styles vary widely, from stately Colonials and Tudors to elegant Victorians and mid-century designs, each telling a story of Manchester's growth over time.

TOUFIC H. KALIL HOUSE



Just a few lots from the Zimmerman House, the Kalil House shares some of its architectural DNA but showcases Wright's Usonian Automatic approach. That means simpler forms, concrete blocks, clean geometry, strong horizontal lines, and design that emphasizes functional beauty over ornament. The house includes two bedrooms, two baths, kitchen, living spaces, all design details very intentional. The original furniture largely remains intact.

Why It's Special:

- Because it's one of the very few Frank Lloyd Wright designs in NH, and it's still in excellent condition.
- Its proximity to the Zimmerman House creates a small architectural landmark cluster in the North End.
- Appeals to buyers/owners who appreciate mid-century modern or architect-designed homes.

LOCATION: 117 HEATHER STREET, MANCHESTER, NH

Architect / Style: Frank Lloyd Wright, Usonian Automatic style (modular concrete block construction).

Built: 1955

WEBSITE

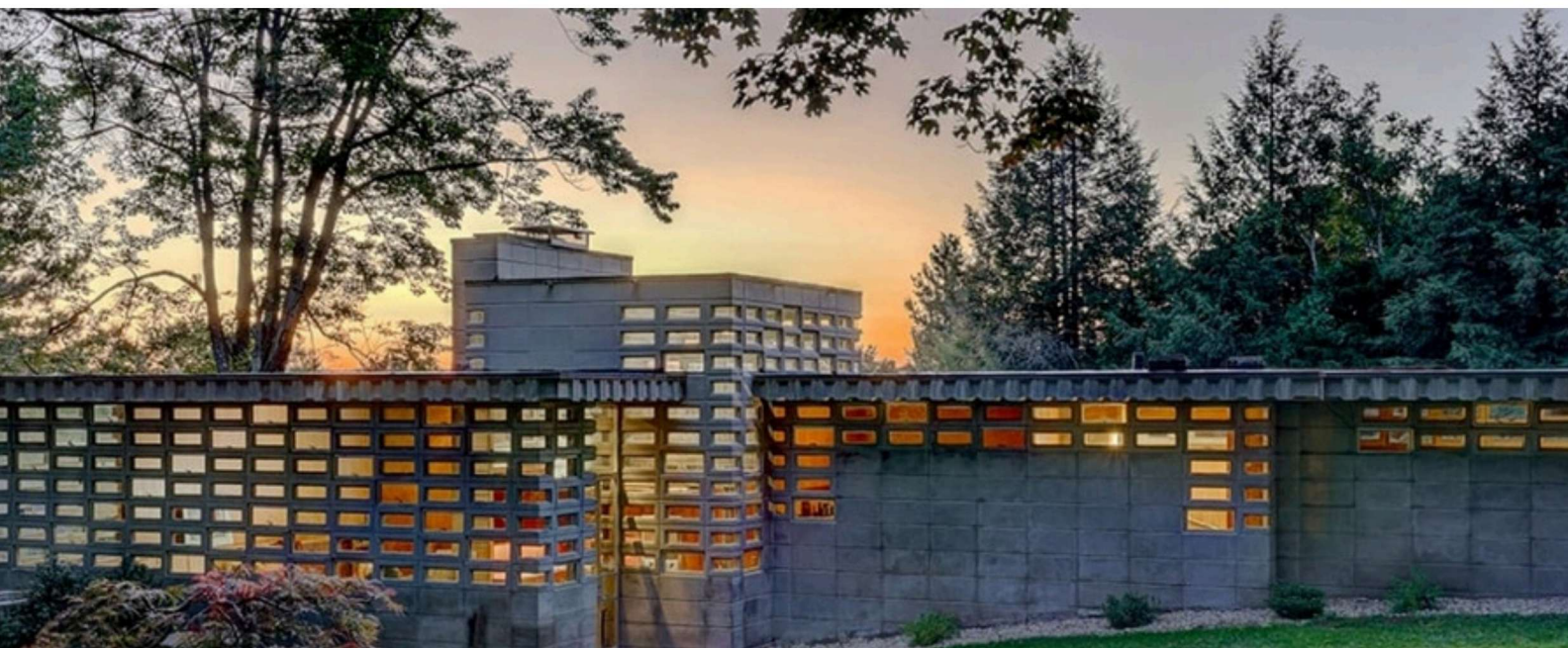



THE ZIMMERMAN HOUSE

ADDRESS

223 Heather Street, Manchester, NH

[Website](#)

BUILT: 1951

Architect / Style: Designed by Frank Lloyd Wright in his Usonian style

WHY ITS SPECIAL

- The only Frank Lloyd Wright home open to the public in New England. [New Hampshire Home Magazine+1](#)
- Adds modern architectural significance to the mostly Victorian/Queen Anne / Italianate neighborhood.

This is a single-story home set in a wooded, residential part of the North End. It features a deeply overhanging roof, a large central chimney arranged in an L-shape, and walls of red glazed brick with Georgia cypress trim. Wright also designed the interior furniture, garden plantings, even the mailbox, so it's a very cohesive example of his work. The layout blends indoor and outdoor spaces with large windows, natural materials, and an emphasis on simplicity and harmony with its surroundings

OTHER INFORMATION

Tours offered through Currier

Museum of Art



FRANK PIERCE CARPENTER HOUSE

ADDRESS

1800 Elm Street Manchester

BUILT: 1891

Architect / Style: Queen Anne style;
likely designed by Edgar A. P. Newcomb.

Why It's Special:

- Represents the late 19th-century architectural legacy of Manchester's affluent industrial era.
- A contrast in style to the Wright houses (Victorian era vs mid-20th century).
- It's visible to the public in that its exterior can be admired, and it is part of guided historic tours in Manchester.

A grand Queen Anne-style home located at Elm & West North Streets. The house sits on a large lot, has a turret (a three-story tower), projecting bay windows, multiple porches, ornate stained glass, detailed woodwork, and a stone foundation. The roof is slate; there is a carriage house behind. Interiors are richly decorated. The property retains a lot of its original design, materials, and craftsmanship. It's no longer a private home; converted to office use but with preservation protections.

EDUCATION AT YOUR DOORSTEP

The North End isn't just known for its beautiful architecture and historic charm –it also offers access to some of Manchester's most respected private schools. Families will find the Montessori approach at North End Montessori (Toddler through Grade 4, expanding toward Grade 6), where multi-age classrooms encourage independence and individualized learning. Mount St. Mary Academy provides faith-based elementary and middle school education in a supportive setting, while St. Catherine of Siena School serves Pre-K through Grade 6 with a tradition of academic excellence and Catholic values. For older students, The Derryfield School (Grades 6–12) offers rigorous academics, arts, and athletics, while Holy Family Academy (Grades 7–12) provides a classical, faith-centered education.

For families considering top boarding and college-preparatory options, St. Paul's School in Concord is just a ~25-minute drive (~18–20 miles) from the North End, offering nationally renowned academics in a close setting. Phillips Exeter Academy, about 60–80 miles away, is still within reach for boarding students seeking one of the most prestigious prep school experiences in the country. Together, these local and regional options give North End families strong educational access—from neighborhood schools to nationally recognized institutions.

PRIVATE / INDEPENDENT SCHOOLS & MUSIC INSTITUTION IN THE NORTH END AREA

School	Grades / Location	History & What They Offer	Why Families Might Choose It
Mount St. Mary Academy	Pre-K through Grade 8 (elementary & middle school, faith-based) • Manchester, NH	In 1858, the Sisters of Mercy came to Manchester, providing education to immigrant and working-class families and to more affluent ones alike.	Deep roots in Manchester; strong tradition; faith-based values; smaller community feel; close for families
North End Montessori School	Toddlers (~15 months) through ~Grade 4 (with plans for Grades 5 & 6) Beech Street, Manchester, NH	Montessori education: multi-age classrooms, emphasis on hands-on learning, independence, exploration, and individualized development.	Excellent for families wanting early childhood or foundational years in a learning environment that supports creativity and child initiative.
The Derryfield School	Grades 6-12 2108 River Road, Manchester	Founded in 1964 by a group of Manchester families, the school opened in 1965 to serve grades 7-10, then added 11 & 12. Grade 6 added in 1999.	Strong option for middle & high school, especially for families seeking rigorous academics + great arts, athletics & reputation.
St. Catherine of Siena School	Pre-K3 through Grade 6 206 North Street, Manchester	Established in 1959, this is a Catholic parish school accredited by the New England Association of Schools and Colleges.	For families wanting faith-based education close by, smaller class sizes, strong community feel; excellent for early learning.
Manchester Community Music School (MCMS)	Music education / specialty school Manchester, NH	Serves over 1,500 students across New England; has ~40 music educators and board-certified music therapists. Offers	Great supplement for families who want to develop musical skills, performance experience

PARKS AND OUTDOOR RECREATION

The North End features easy access to some of Manchester's most beloved parks and green spaces. From strolling paths and gardens to playgrounds and athletic fields, these spaces create opportunities to relax, exercise, and connect with nature—without ever leaving the city.

LIVINGSTON PARK & DOORS POND

Located in the North End, Livingston Park spans a large acreage and includes sports fields, playgrounds, walking/running tracks, and open lawns. Doors Pond, part of the system, is especially scenic.

- Summer: Swimming, picnics, playgrounds, sports fields, walking or jogging paths. Pools are open nearby for cooling off.
- Winter: Ice skating (pond-skating when conditions allow), snow play, winter walks.

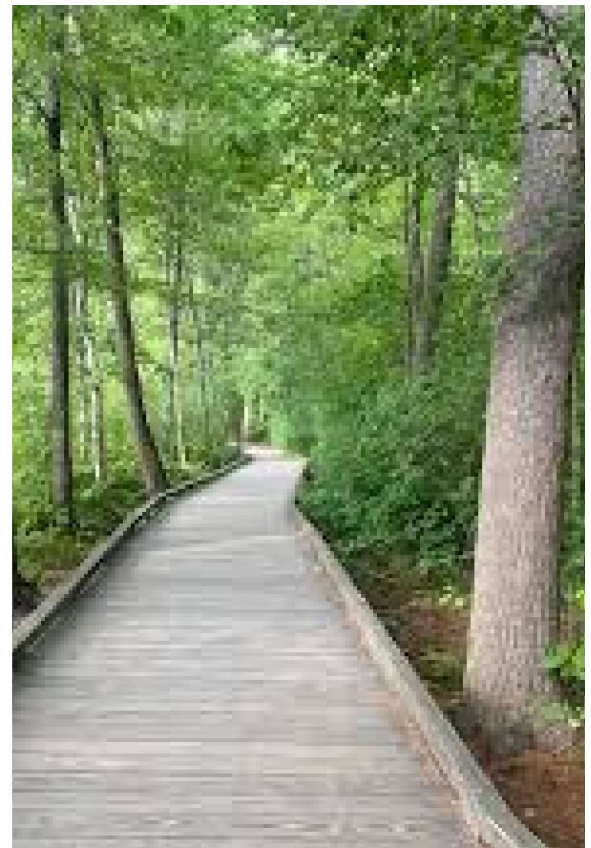

MCYNTYRE SKI AREA

Location: 50 Chalet Way Manchester, NH 03104

Winter Offerings: Fully snow-making capability with 11 trails, 2 lifts and 2 magic carpets for beginners, terrain park, snow tubing, ski and snowboard lessons. Family-friendly, affordable rates.

Summer / Off Season Uses: Trails, events, possibly outdoor gathering space. The area often hosts special events, group activities and sometimes outdoor summer events and rentals.

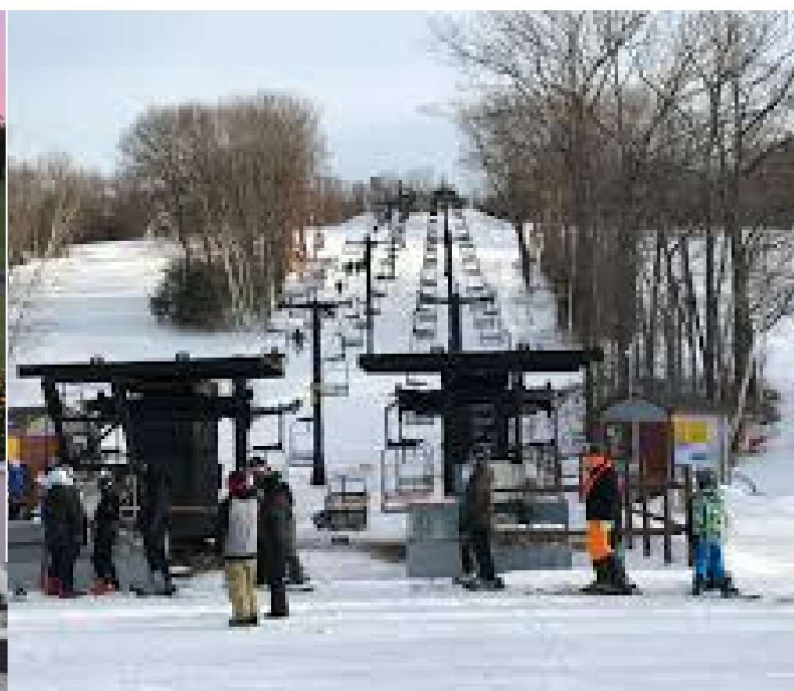
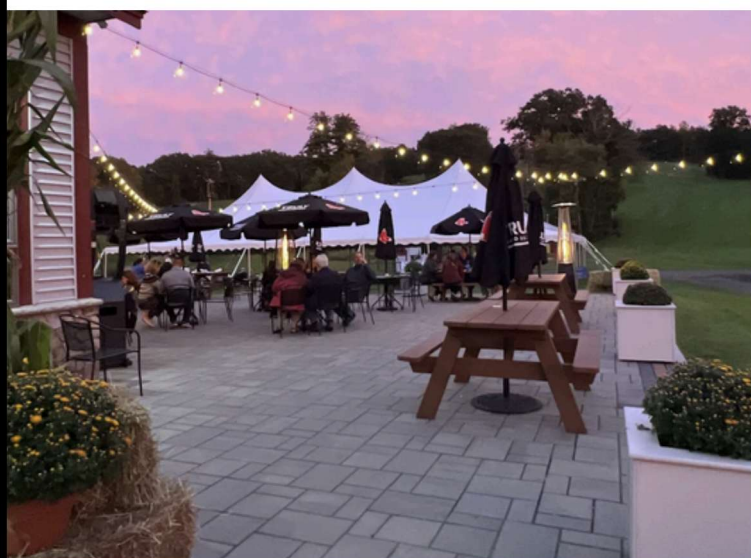

STARK PARK

- ADDRESS: 550 RIVER ROAD, MANCHESTER, NH 03104
- ACREAGE & HISTORY: 30 ACRES. THIS LAND WAS ONCE STARK FAMILY FARMLAND AND WAS DEDICATED AS A PUBLIC PARK IN 1893.
- WHAT TO DO: WALKING PATHS, SHADY LAWNS, QUIET SITTING AREAS, SCENIC NATURAL VIEWS. IT'S A PEACEFUL ESCAPE IN THE NORTH END.



DERRYFIELD PARK

- LOCATION: BRIDGE STREET / HIGHLAND STREET, MANCHESTER, NH 03104
RECDESK+2YELP+2
- SIZE & AMENITIES: 76 ACRES. INCLUDES BASEBALL FIELD, PLAYGROUND, 4 TENNIS COURTS, FITLOT OUTDOOR GYM EQUIPMENT, A GAZEBO, FOOTBALL FIELD, OPEN GREEN SPACE, AND A CROSS-COUNTRY COURSE.
- GREAT FOR SUMMER SPORTS: BASEBALL, TENNIS, OPEN FIELD GAMES, PLAYGROUNDS.



DINING AND SHOPPING

Within the North End and its nearby streets, residents enjoy an array of eateries and local shops. From coffee spots and bakeries to fine dining and casual restaurants, the area offers something for every taste. Specialty boutiques and convenient local stores add to the walkable, welcoming feel of the neighborhood.

Dining & Cuisine in and Around the North End

Manchester's North End offers more than just beautiful homes and parks—it's also a gateway to some of the city's best dining experiences. Residents enjoy the convenience of neighborhood favorites right in 03104 while being only minutes away from the vibrant downtown Elm Street corridor and additional culinary treasures nearby.

LOCAL GEMS IN THE NORTH END



- Angela's Pasta, Cheese & Wine – Specialty Italian shop and deli offering fresh pasta, imported cheeses, charcuterie, prepared meals, desserts, and wines. A neighborhood treasure with weekly tastings and gourmet finds.
- The Kitchen on River Road – Beloved café and market serving all-day breakfast, lunch, and take-home dinners. Casual and welcoming, ideal for both a quick bite and regular weekly stops.
- Puritan Backroom – A Manchester institution, famous for its chicken tenders, ice cream, and family-style meals. Just minutes from the North End, it's a go-to spot for locals and visitors alike.

Just Minutes Away: Elm Street Dining Corridor

Downtown Manchester's Elm Street—less than a 10-minute drive from most North End addresses—offers a rich selection of dining options:

Upscale steakhouses and American bistros

Farm-to-table restaurants

Breweries, pubs, and cocktail bars

International flavors ranging from Asian to Mediterranean

Living in the North End means you can enjoy quiet, tree-lined streets at home while still having immediate access to the city's most dynamic dining

CULTURE AND COMMUNITY

The neighborhood's historical sites and architectural landmarks provide cultural richness that sets the North End apart. Local organizations often host events, adding to the sense of connection and pride that residents feel for the area.

MUSEUM AND THEATER

Palace Theatre

- The Palace Theatre on Hanover Street is one of Manchester's most treasured landmarks. Built in 1914 and beautifully restored, it seats 834 guests and hosts a dynamic calendar of performances year-round. Some highlights include:
- Broadway-Style Productions: Popular titles like *Mamma Mia!*, *Les Misérables*, and *Beauty and the Beast* have graced the Palace stage.
- National Touring Acts: Comedy shows, musicians, and special events bring big-city entertainment to a local setting.
- Palace Youth Theatre: More than 700 children participate annually in programs, offering families an accessible way to engage in the arts.

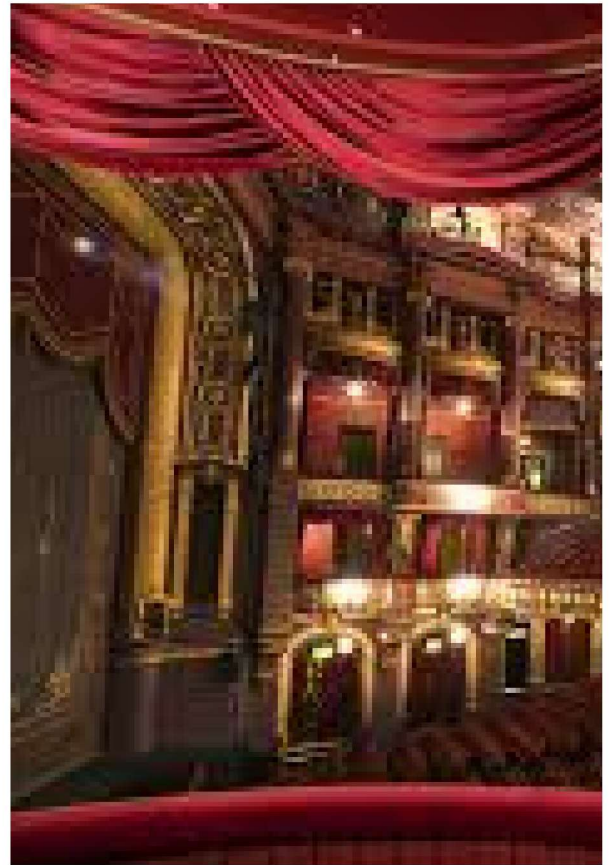

Currier Museum of Art

Located right in the 03104 zip code, the Currier Museum of Art is a world-class cultural institution within walking or a short drive from many North End homes. Founded in 1929, the Currier showcases works by masters such as Picasso, Monet, O'Keeffe, Matisse, and Wyeth. Beyond its galleries, the museum offers:

Special Exhibitions: Rotating shows bring in national and international artists.

Frank Lloyd Wright Homes: The museum operates tours of the Zimmerman House and Kalil House, both iconic architectural landmarks right in the North End.

Community Engagement: Family days, art classes, lectures, and live music make the Currier more than a museum—it's a hub for learning and

THANK YOU!

Marketing a home in the North End requires more than just putting a sign in the yard – it requires understanding the neighborhood’s history, architecture, and community appeal. With my local knowledge and professional experience, I help sellers maximize their home’s value and buyers find the perfect fit in one of Manchester’s most desirable neighborhoods.

👉 Ready to buy or sell in the North End? Let’s talk. I’d love to walk you through the process and share the insights that only a neighborhood specialist can offer.