

# TEKAMAH MUNICIPAL AIRPORT TEKAMAH, NEBRASKA

AIRPORT LAYOUT PLAN  
MARCH 2008  
(REVISED AUGUST 2017)

SHEET INDEX	
	SHEET NAME
1	AIRPORT LAYOUT PLAN
2	AIRPORT DATA
3	AIRPORT AIRSPACE PLAN, APPROACH PROFILES
4	EXISTING RUNWAY 15 INNER APPROACH PLAN AND PROFILE
5	ULTIMATE RUNWAY 15 INNER APPROACH PLAN AND PROFILE
6	EXISTING AND ULTIMATE RUNWAY 33 INNER APPROACH PLAN AND PROFILE
7	RUNWAY 15/33 DEPARTURE PLAN AND PROFILE
8	EXISTING AND ULTIMATE RUNWAY 15/33 PLAN AND PROFILE
9	TERMINAL AREA PLAN
10	LAND USE PLAN
11	AIRPORT PROPERTY MAP

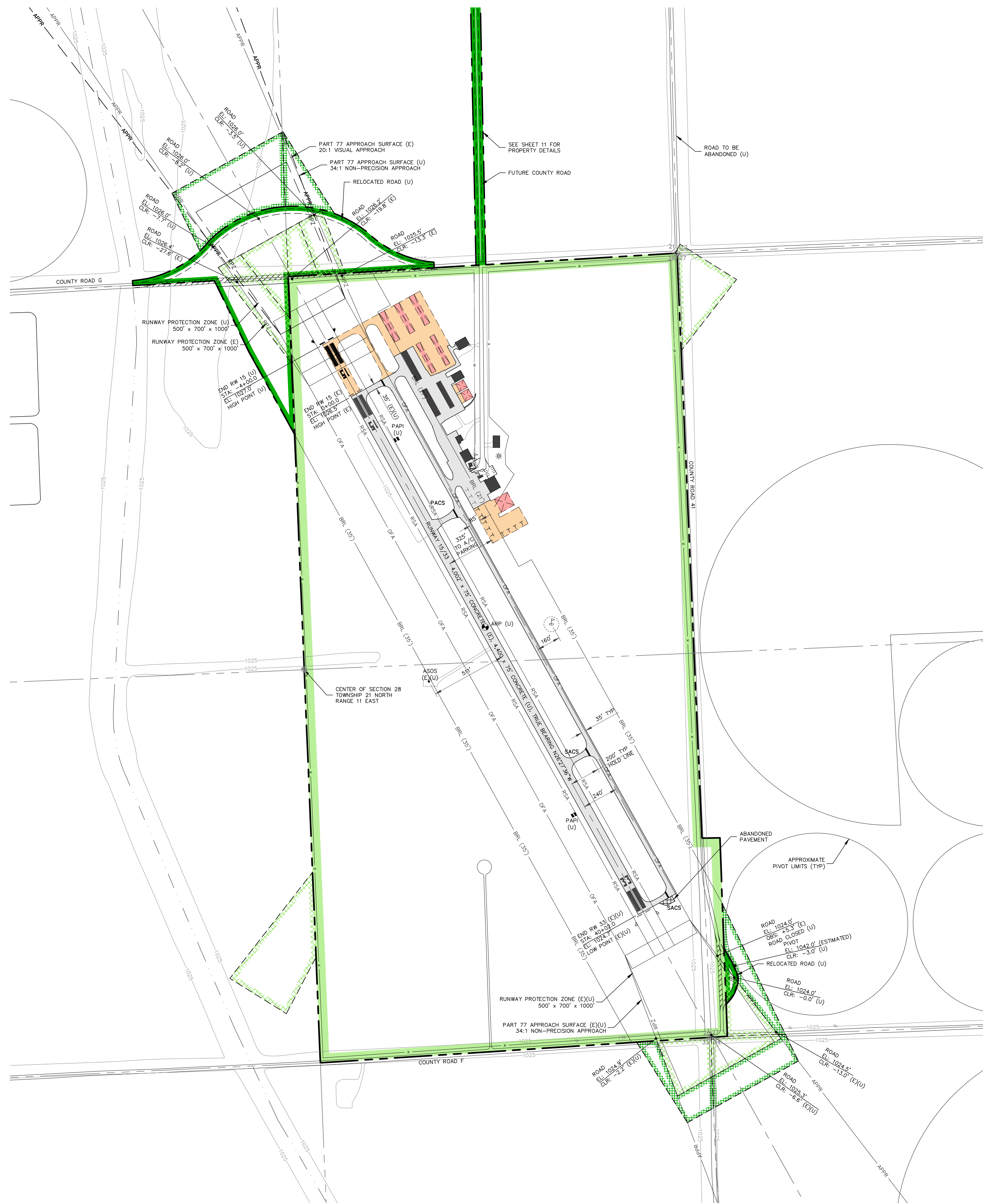



LEGEND	EXISTING (E)	ULTIMATE (U)
BUILDINGS	[Symbol]	[Symbol]
AIRFIELD PAVEMENT	[Symbol]	[Symbol]
TO BE REMOVED	[Symbol]	[Symbol]
PROPERTY LINE	[Symbol]	[Symbol]
EASEMENT	[Symbol]	[Symbol]
ELEVATION CONTOURS	[Symbol]	[Symbol]
SECTION LINE	[Symbol]	[Symbol]
RUNWAY SAFETY AREA (RSA)	[Symbol]	[Symbol]
RUNWAY PROTECTION ZONE (RPZ)	[Symbol]	[Symbol]
APPROACH SURFACE (APPR)	[Symbol]	[Symbol]
BUILDING RESTRICTION LINE WITH HEIGHT (BRL)	[Symbol]	[Symbol]
FENCE	[Symbol]	[Symbol]
PAVED ROADS	[Symbol]	[Symbol]
GRAVEL ROADS	[Symbol]	[Symbol]
TREES/TREE MASS	[Symbol]	[Symbol]
AIRPORT REFERENCE POINT	[Symbol]	[Symbol]
REIL	[Symbol]	[Symbol]
PAPI	[Symbol]	[Symbol]
RUNWAY THRESHOLD LIGHTS	[Symbol]	[Symbol]
AIRPORT BEACON	[Symbol]	[Symbol]
SECTION CORNER	[Symbol]	[Symbol]
SEGMENTED CIRCLE AND WIND CONE	[Symbol]	[Symbol]

**APPROVAL - TEKAMAH AIRPORT AUTHORITY**

APPROVED BY: \_\_\_\_\_ DATE: \_\_\_\_\_

CHAIRMAN

- GENERAL NOTES:**
- HEIGHT RESTRICTION ZONING WITHIN 3 MILES OF THE AIRPORT PROPERTY LINE HAS BEEN IN EFFECT SINCE 1966.
  - LATITUDE AND LONGITUDE ARE BASED ON NAD 1983. MSL ELEVATIONS ARE BASED ON NAVD 88.
  - CONTOUR DATA BASED ON USGS QUADRANGLE MAPS LISTED ON SHEET 3.

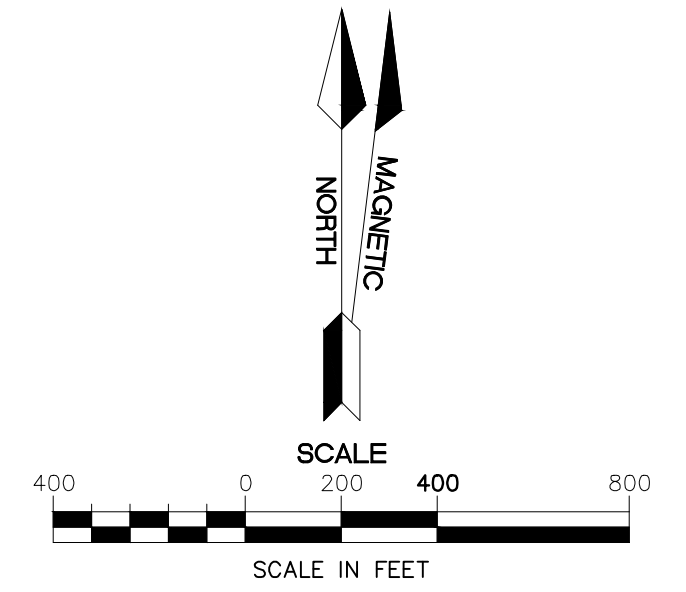

MAGNETIC DECLINATION: 3° 46' EAST, JUNE 2007  
ANNUAL RATE OF CHANGE: 7' WEST

REV	DATE	DESCRIPTION
1	15/24/70	IMP-04/70S - APPROX EXPANSION
2	10/14/73	IMP-06 - NORTH PARALLEL TAXIWAY
3	15/10/77	IMP-008 - TAXIWAY AS-BUILTS
4	8/31/77	ROAD RELOCATION REVISION

**AIRPORT LAYOUT PLAN**

**AIRPORT LAYOUT PLAN**

**SA-7 TQE/AIP 3-31-0082-04**

**TEKAMAH MUNICIPAL AIRPORT**

**TEKAMAH, NEBRASKA**

drawn by: JDB  
checked by: DJH  
approved by: DJH  
project no.: 2006-2163  
dwg name: 62163\_ALP  
date: 3/08

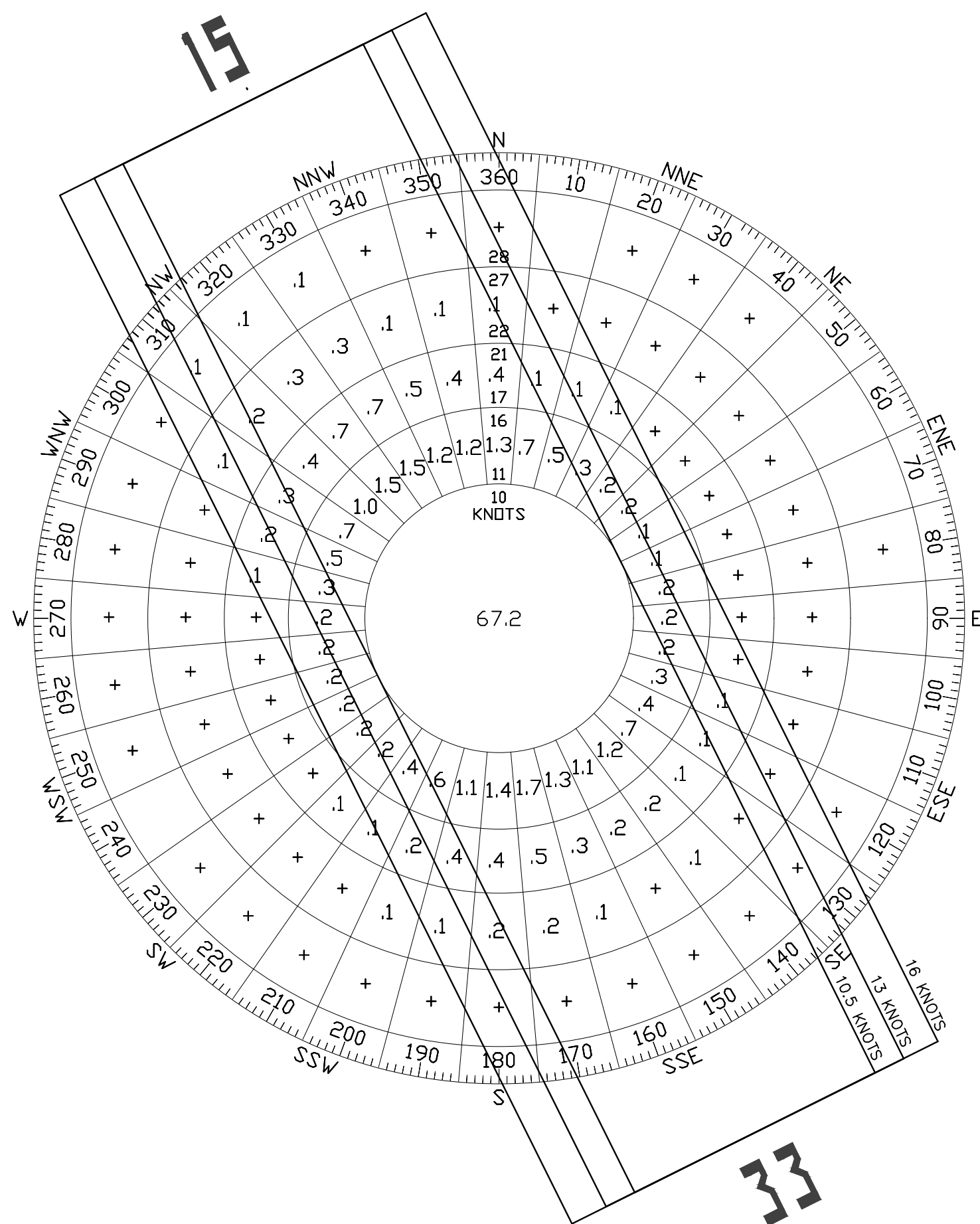

WIND ROSE



MAGNETIC DECLINATION: 3° 46' EAST, JUNE 2007  
ANNUAL RATE OF CHANGE: 7" WEST

RUNWAY DATA	RUNWAY 15/33			
	EXISTING		ULTIMATE	
APPROACH CATEGORY - DESIGN GROUP	B-II		SAME	
RUNWAY				
LENGTH/WIDTH	4,002'/75'		4,400'/75'	
LIGHTING	MIRL		SAME	
MARKING	NON-PRECISION		SAME	
PAVEMENT MATERIAL	CONCRETE		SAME	
PAVEMENT DESIGN STRENGTH	30,000 (S)		SAME	
RUNWAY SAFETY AREA				
LENGTH/WIDTH	4,602'/150'		5,000'/150'	
RUNWAY OBJECT FREE AREA				
LENGTH/WIDTH	4,602'/500'		5,000'/500'	
RUNWAY OBSTACLE FREE ZONE				
LENGTH/WIDTH	4,402'/400'		4,800'/400'	
TAXIWAY				
WIDTH	35'		SAME	
LIGHTING	MITL		SAME	
	RW 15	RW 33	RW 15	RW 33
APPROACH SURFACE SLOPE	20:1	34:1	34:1	34:1
ELECTRONIC AIDS	NONE		SAME	
VISUAL AIDS	NONE	REIL	PAPI, REIL	PAPI, REIL
APPROACH VISIBILITY MINIMUMS	VISUAL	1 MILE	1 MILE	1 MILE
TOUCHDOWN ZONE ELEVATION	1026.7'	1026.0'	1027.0'	1026.0'
TAKEOFF RUN AVAILABLE (TORA)	4,002'	4,002'	4,400'	4,400'
TAKEOFF DISTANCE AVAILABLE (TODA)	4,002'	4,002'	4,400'	4,400'
ACCELERATE/STOP DISTANCE AVAILABLE	4,002'	4,002'	4,400'	4,400'
LANDING DISTANCE AVAILABLE	4,002'	4,002'	4,400'	4,400'
(S) - SINGLE WHEEL				
(D) - DUAL WHEEL				

MODIFICATION TO STANDARDS	DESCRIPTION	FAA APPROVAL DATE	AIRSPACE CASE NO.
NONE REQUIRED			

OBJECT FREE ZONE PENETRATIONS	DESCRIPTION	FAA APPROVAL DATE	AIRSPACE CASE NO.
NONE			

THRESHOLD SITING PENETRATIONS	DESCRIPTION	FAA APPROVAL DATE	AIRSPACE CASE NO.
NONE			

AIRPORT DATA	EXISTING	ULTIMATE
AIRPORT ELEVATION (MSL)	1026.5'	1027.0'
AIRPORT REFERENCE POINT (NAD 83)	LATITUDE: NA LONGITUDE: NA	41° 45' 50.51" 96° 10' 41.77"
AIRPORT ELECTRONIC AIDS	ASOS, BEACON	SAME
MEAN MAX. TEMP. OF HOTTEST MONTH	87.3° F	SAME
AIRPORT REFERENCE CODE	B-II	SAME
MAGNETIC VARIATION	3° 46' E / JUNE 2007	7° W / YEAR

COORDINATE TABLE	EXISTING	ULTIMATE
RUNWAY 15	LATITUDE: 41° 46' 06.43" LONGITUDE: 96° 10' 52.35"	41° 46' 09.97" 96° 10' 54.70"
RUNWAY 33	LATITUDE: 41° 45' 31.06" LONGITUDE: 96° 10' 28.83"	SAME SAME

WIND COVERAGE	WIND SPEED	
	10.5 KNOTS	RUNWAY 15/33
	13 KNOTS	93.92%
16 KNOTS	97.02%	
	99.05%	

DATA SOURCE: NATIONAL CLIMATIC DATA CENTER, ASHEVILLE, NORTH CAROLINA  
STATION LOCATION: TEKAMAH, NE  
PERIOD: 1996-2006

REV	DATE	DESCRIPTION	REVISIONS
4	8/31/17	ROAD RELOCATION REVISION	
3	5/10/17	AP-008 - TAXI LANE AS-BUILT	
2	10/14/13	AP-06 - NORTH PARALLEL TAXIWAY	
1	5/24/10	AP-04/05 - APRON EXPANSION	

AIRPORT DATA  
AIRPORT LAYOUT PLAN  
SA-7 TQE/AIP 3-31-0082-04  
TEKAMAH MUNICIPAL AIRPORT  
TEKAMAH, NEBRASKA

drawn by: JDB  
checked by: DJH  
approved by: DJH  
project no.: 2006-2163  
dwg name: 62163\_ALP  
date: 3/08



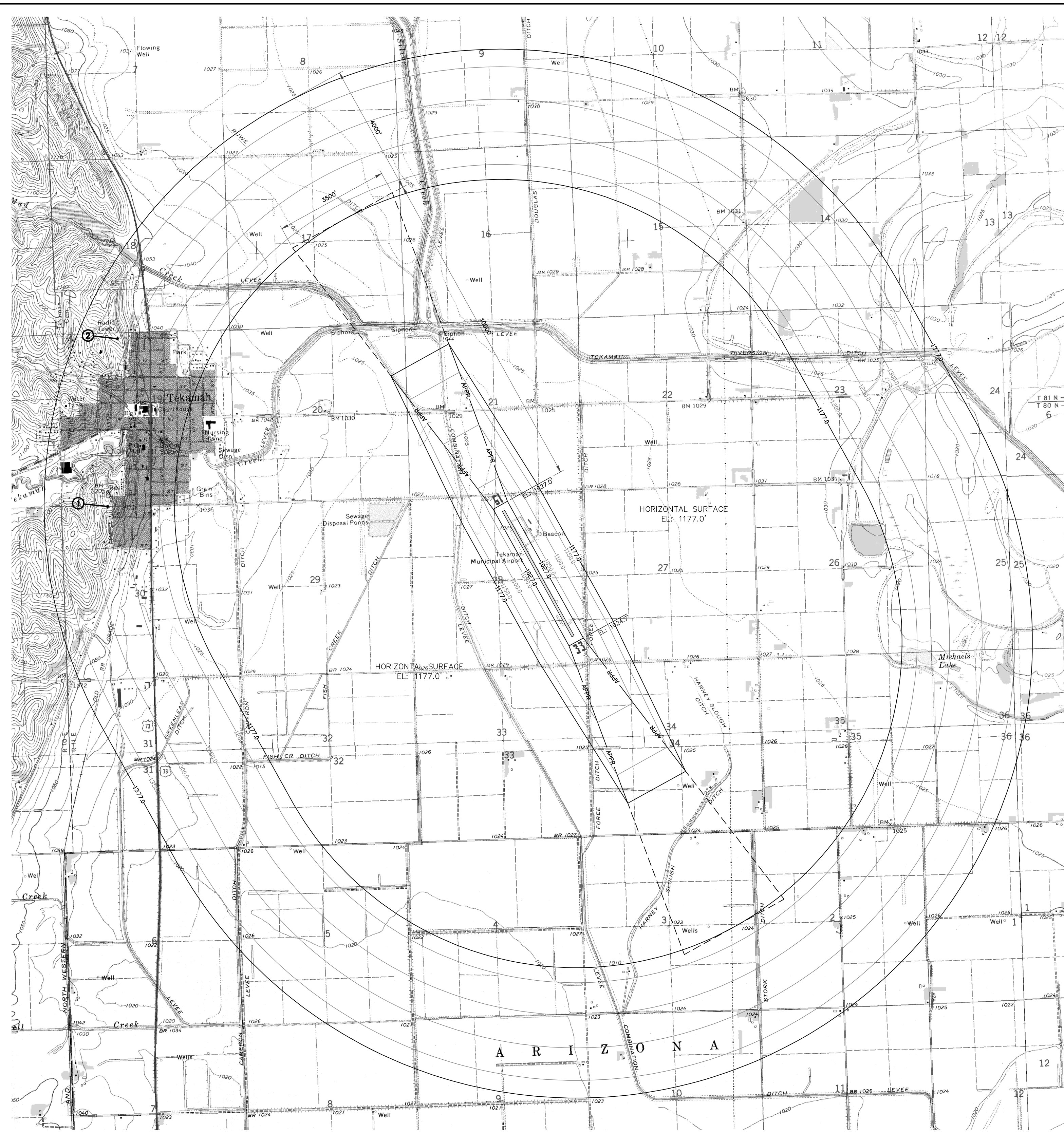

OBSTRUCTION TABLE		AIRPORT AIRSPACE			
	DESCRIPTION	ELEVATION	PENETRATION AMOUNT	PLANNED DISPOSITION	AIRSPACE STUDY NO.
1	WATER TOWER	1337.1'	+57.4'	NONE*	2002-ACE-2433-OE
2	TOWER	1483.4'	+165.5'	NONE*	1997-ACE-0923-OE

NOTE: OBSTRUCTIONS ARE POSITIVE (+), CLEARANCES ARE NEGATIVE (-)  
 \* NOT A HAZARD, PER FAA AERONAUTICAL STUDY

- U.S.G.S. QUADRANGLE TOPOGRAPHIC MAPS:
1. BERTHA, NEBRASKA, DATED 1970.
  2. BLENCOE, IOWA, DATED 1970.
  3. CRAIG, NEBRASKA, DATED 1970.
  4. HERMAN, NEBRASKA, DATED 1970.
  5. LITTLE SIOUX, IOWA-NEBRASKA, DATED 1970.
  6. MONDAMIN, IOWA-NEBRASKA, DATED 1970.
  7. NICKERSON NE, NEBRASKA, DATED 1970.
  8. TEKAMAH, NEBRASKA-IOWA, DATED 1970.
  9. TEKAMAH NW, NEBRASKA-IOWA, DATED 1970.

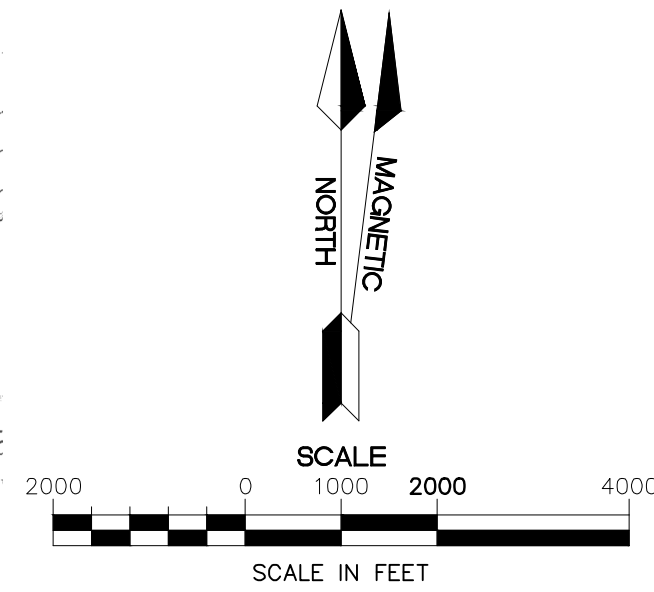

MAGNETIC DECLINATION: 3° 46' EAST, JUNE 2007  
 ANNUAL RATE OF CHANGE: 7' WEST

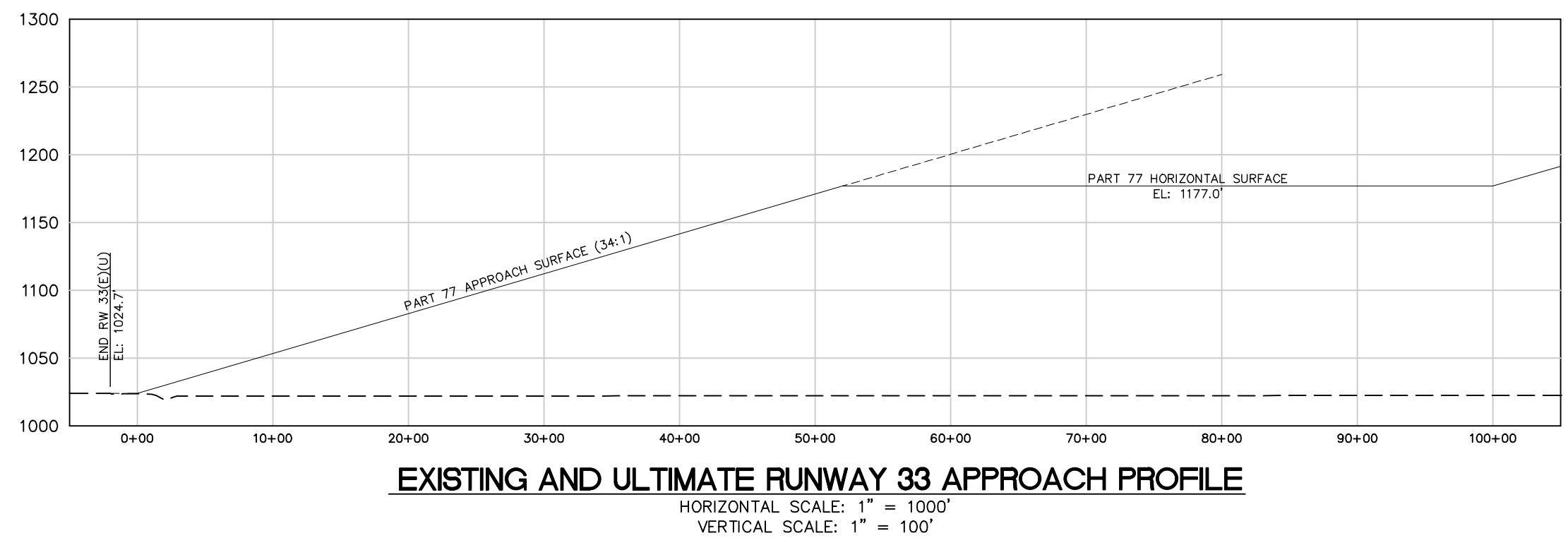
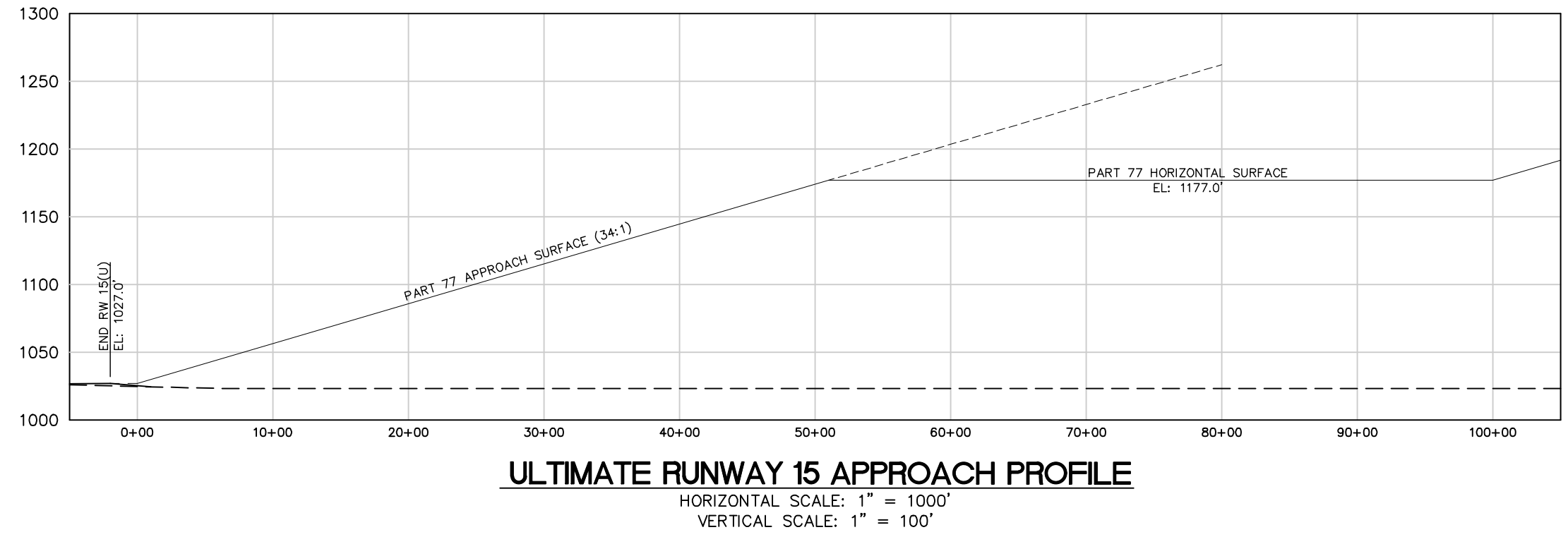
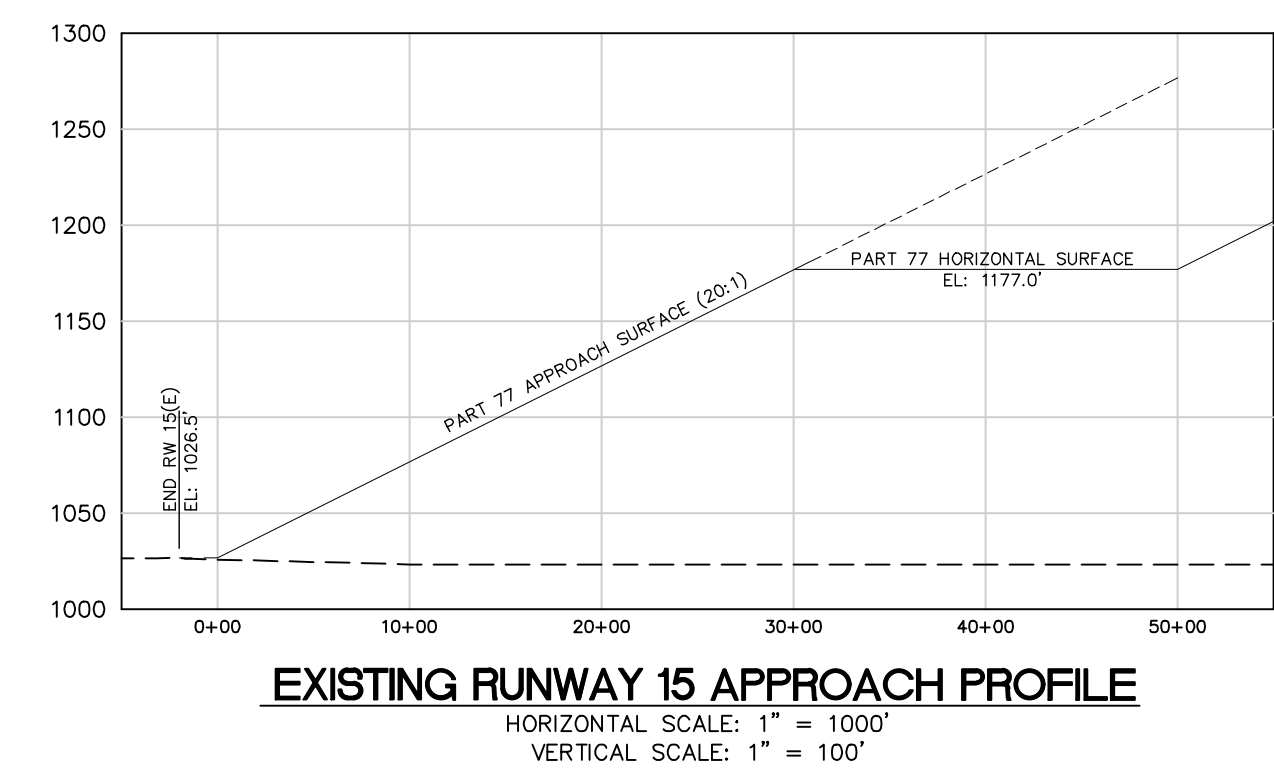

REV	DATE	DESCRIPTION
1	15/24/10	AP-04/05 - APPROX EXPANSION
2	10/14/13	AP-06 - NORTH PARALLEL TAXIWAY
3	15/10/17	AP-08 - TAXIWAY AS-BUILTS
4	8/31/17	ROAD RELOCATION REVISION

**REVISIONS**

AIRPORT AIRSPACE PLAN  
 APPROACH PROFILES

AIRPORT LAYOUT PLAN  
 SA-7 TQE/AIP 3-31-0082-04

TEKAMAH MUNICIPAL AIRPORT  
 TEKAMAH, NEBRASKA

drawn by: JDB  
 checked by: DJH  
 approved by: DJH  
 project no.: 2006-2163  
 dwg name: 62163\_ALP  
 date: 3/08



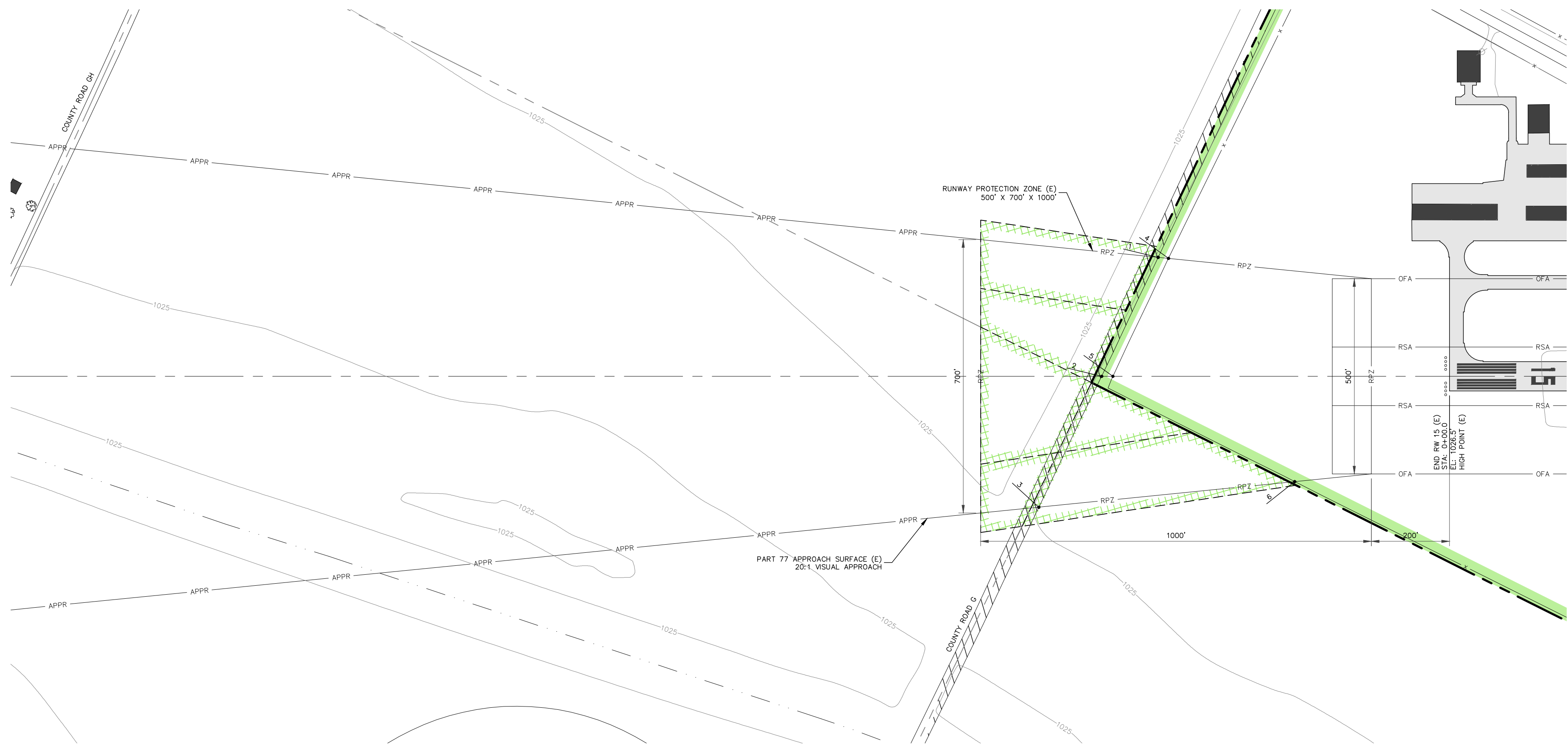

**EXISTING RUNWAY 15 INNER APPROACH PLAN**  
SCALE: 1"=200'

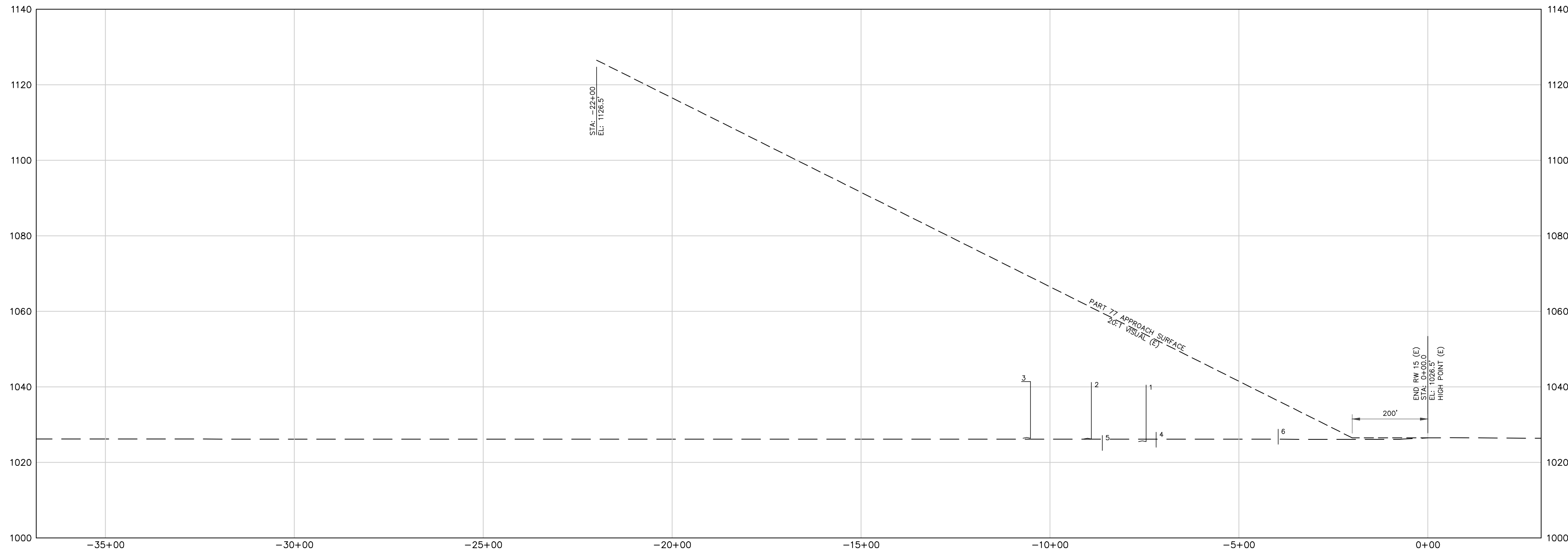

**EXISTING RUNWAY 15 INNER APPROACH PROFILE**  
HORIZONTAL SCALE: 1"=200'  
VERTICAL SCALE: 1"=20'

OBSTRUCTION TABLE		EXISTING RUNWAY 15		
	DESCRIPTION	ELEVATION	PENETRATION AMOUNT	PLANNED DISPOSITION
1	ROAD AT APPROACH	1025.5'	-13.3'	NONE
2	ROAD AT CENTERLINE	1026.2'	-19.8'	NONE
3	ROAD AT APPROACH	1026.4'	-27.6'	NONE
4	FENCE AT APPROACH	1028.0'	-24.4'	NONE
5	FENCE AT CENTERLINE	1027.3'	-32.2'	NONE
6	FENCE AT APPROACH	1028.8'	-7.5'	NONE

NOTE: OBSTRUCTIONS ARE POSITIVE (+), CLEARANCES ARE NEGATIVE (-)

LEGEND	EXISTING (E)	ULTIMATE (U)
	BUILDINGS	[Symbol]
AIRFIELD PAVEMENT TO BE REMOVED	[Symbol]	[Symbol]
PROPERTY LINE	[Symbol]	[Symbol]
EASEMENT	[Symbol]	[Symbol]
ELEVATION CONTOURS	[Symbol]	[Symbol]
SECTION LINE	[Symbol]	[Symbol]
RUNWAY SAFETY AREA (RSA)	[Symbol]	[Symbol]
RUNWAY PROTECTION ZONE (RPZ)	[Symbol]	[Symbol]
APPROACH SURFACE (APPR)	[Symbol]	[Symbol]
BUILDING RESTRICTION LINE WITH HEIGHT (BRL)	[Symbol]	[Symbol]
FENCE	[Symbol]	[Symbol]
PAVED ROADS	[Symbol]	[Symbol]
GRAVEL ROADS	[Symbol]	[Symbol]
TREES/TREE MASS	[Symbol]	[Symbol]
AIRPORT REFERENCE POINT	[Symbol]	[Symbol]
REIL	[Symbol]	[Symbol]
PAPI	[Symbol]	[Symbol]
RUNWAY THRESHOLD LIGHTS	[Symbol]	[Symbol]
AIRPORT BEACON	[Symbol]	[Symbol]
SECTIONED CORNER	[Symbol]	[Symbol]
SEGMENTED CIRCLE AND WIND CONE	[Symbol]	[Symbol]
OBSTRUCTION LABEL	[Symbol]	[Symbol]

**MOLSSON ASSOCIATES**  
801 P Street, Suite 200  
P.O. Box 64989  
Lincoln, NE 68508-4608  
TEL 402.474.6311  
FAX 402.474.5160  
www.molsson.com

REV	DATE	DESCRIPTION
1	15/24/70	MP-04/05 - APPROX EXPANSION
2	10/14/73	MP-06 - NORTH PARALLEL TAXIWAY
3	15/10/77	MP-008 - TAXIWAY AS-BUILT
4	8/31/77	ROAD RELOCATION REVISION

**EXISTING RUNWAY 15  
INNER APPROACH PLAN AND PROFILE**  
AIRPORT LAYOUT PLAN  
SA-7 TQE/AIP 3-31-0082-04  
TEKAMAH MUNICIPAL AIRPORT  
TEKAMAH, NEBRASKA

drawn by: JDB  
checked by: DJH  
approved by: DJH  
project no.: 2006-2163  
dwg name: 62163\_ALP  
date: 3/08

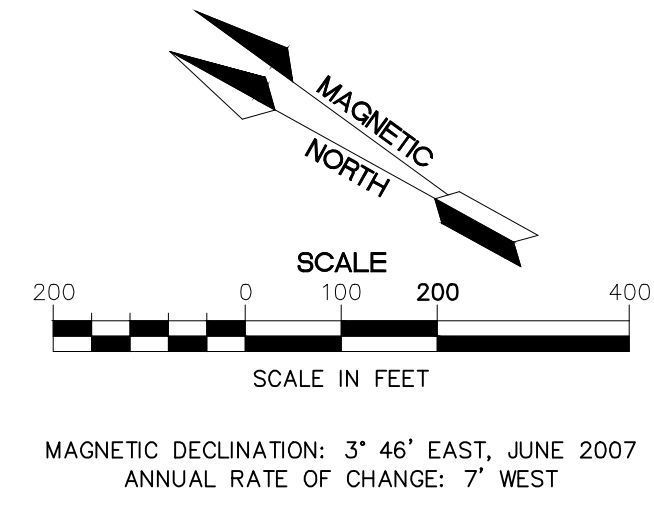



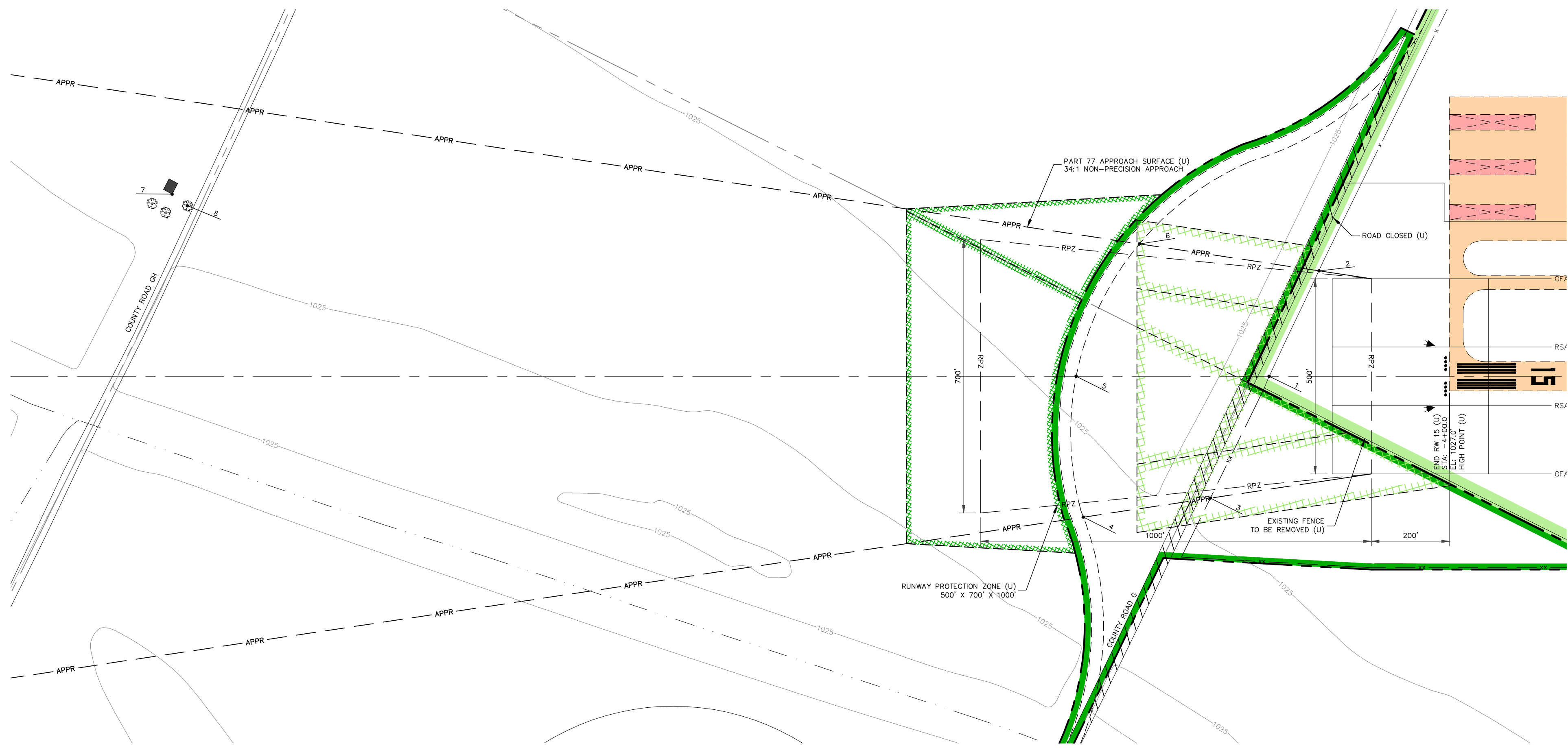

**ULTIMATE RUNWAY 15 INNER APPROACH PLAN**  
SCALE: 1"=200'

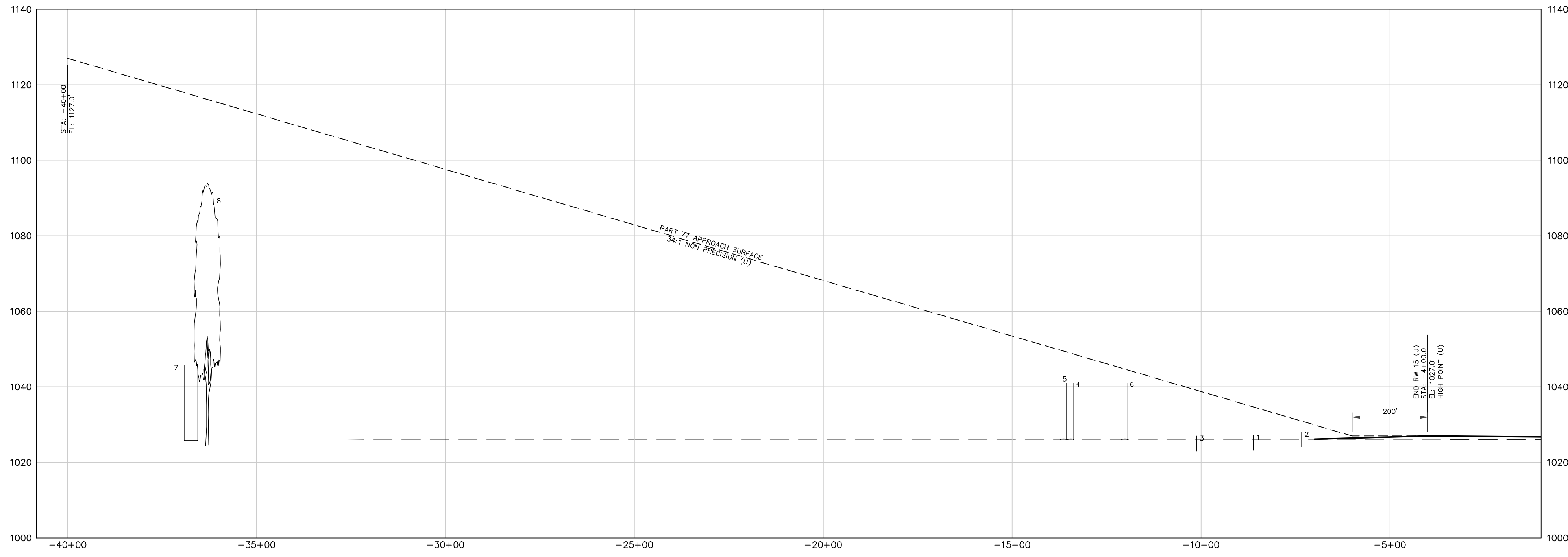

**ULTIMATE RUNWAY 15 INNER APPROACH PROFILE**  
HORIZONTAL SCALE: 1"=200'  
VERTICAL SCALE: 1"=20'

OBSTRUCTION TABLE				
ULTIMATE RUNWAY 14				
	DESCRIPTION	ELEVATION	PENETRATION AMOUNT	PLANNED DISPOSITION
1	FENCE AT CENTERLINE	1027.3'	-7.5'	NONE
2	FENCE AT APPROACH	1028.1'	-2.9'	NONE
3	FENCE AT APPROACH	1027.0'	-12.1'	NONE
4	ROAD AT APPROACH	1026.0'	-7.7'	NONE
5	ROAD AT CENTERLINE	1026.0'	-8.2'	NONE
6	ROAD AT APPROACH	1026.0'	-3.5'	NONE
7	HOUSE	1045.8'	-71.25'	NONE
8	TREE	1093.6'	-22.6'	NONE

NOTE: OBSTRUCTIONS ARE POSITIVE (+), CLEARANCES ARE NEGATIVE (-)

LEGEND	EXISTING (E)	ULTIMATE (U)
	BUILDINGS	[Symbol]
AIRFIELD PAVEMENT	[Symbol]	[Symbol]
TO BE REMOVED	[Symbol]	[Symbol]
PROPERTY LINE	[Symbol]	[Symbol]
EASEMENT	[Symbol]	[Symbol]
ELEVATION CONTOURS	[Symbol]	[Symbol]
SECTION LINE	[Symbol]	[Symbol]
RUNWAY SAFETY AREA (RSA)	[Symbol]	[Symbol]
RUNWAY PROTECTION ZONE (RPZ)	[Symbol]	[Symbol]
APPROACH SURFACE (APPR)	[Symbol]	[Symbol]
BUILDING RESTRICTION LINE WITH HEIGHT (BRL)	[Symbol]	[Symbol]
FENCE	[Symbol]	[Symbol]
PAVED ROADS	[Symbol]	[Symbol]
GRAVEL ROADS	[Symbol]	[Symbol]
TREES/TREE MASS	[Symbol]	[Symbol]
AIRPORT REFERENCE POINT	[Symbol]	[Symbol]
REIL	[Symbol]	[Symbol]
PAPI	[Symbol]	[Symbol]
RUNWAY THRESHOLD LIGHTS	[Symbol]	[Symbol]
AIRPORT BEACON	[Symbol]	[Symbol]
SECTION CORNER	[Symbol]	[Symbol]
SEGMENTED CIRCLE AND WIND CONE	[Symbol]	[Symbol]
OBSTRUCTION LABEL	[Symbol]	[Symbol]

**MOLSSON ASSOCIATES**  
801 P Street, Suite 200  
P. O. Box 84989  
Lincoln, NE 68508-4608  
TEL 402.474.6311  
FAX 402.474.5160  
www.molsson.com

REV	DATE	DESCRIPTION
4	8/31/17	ROAD RELOCATION REVISION
3	15/10/17	AP-008 - TAXI LANE AS-BUILTS
2	10/14/13	AP-06 - NORTH PARALLEL TAXIWAY
1	15/24/10	AP-04/05 - APRON EXPANSION

**ULTIMATE RUNWAY 15  
INNER APPROACH PLAN AND PROFILE**  
AIRPORT LAYOUT PLAN  
SA-7 TQE/AIP 3-31-0082-04  
TEKAMAH MUNICIPAL AIRPORT  
TEKAMAH, NEBRASKA

drawn by: JDB  
checked by: DJH  
approved by: DJH  
project no.: 2006-2163  
dwg name: 62163\_ALP  
date: 3/08

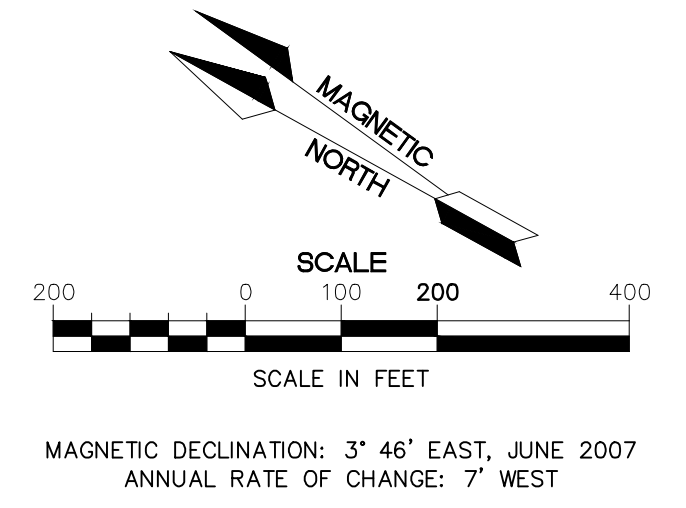



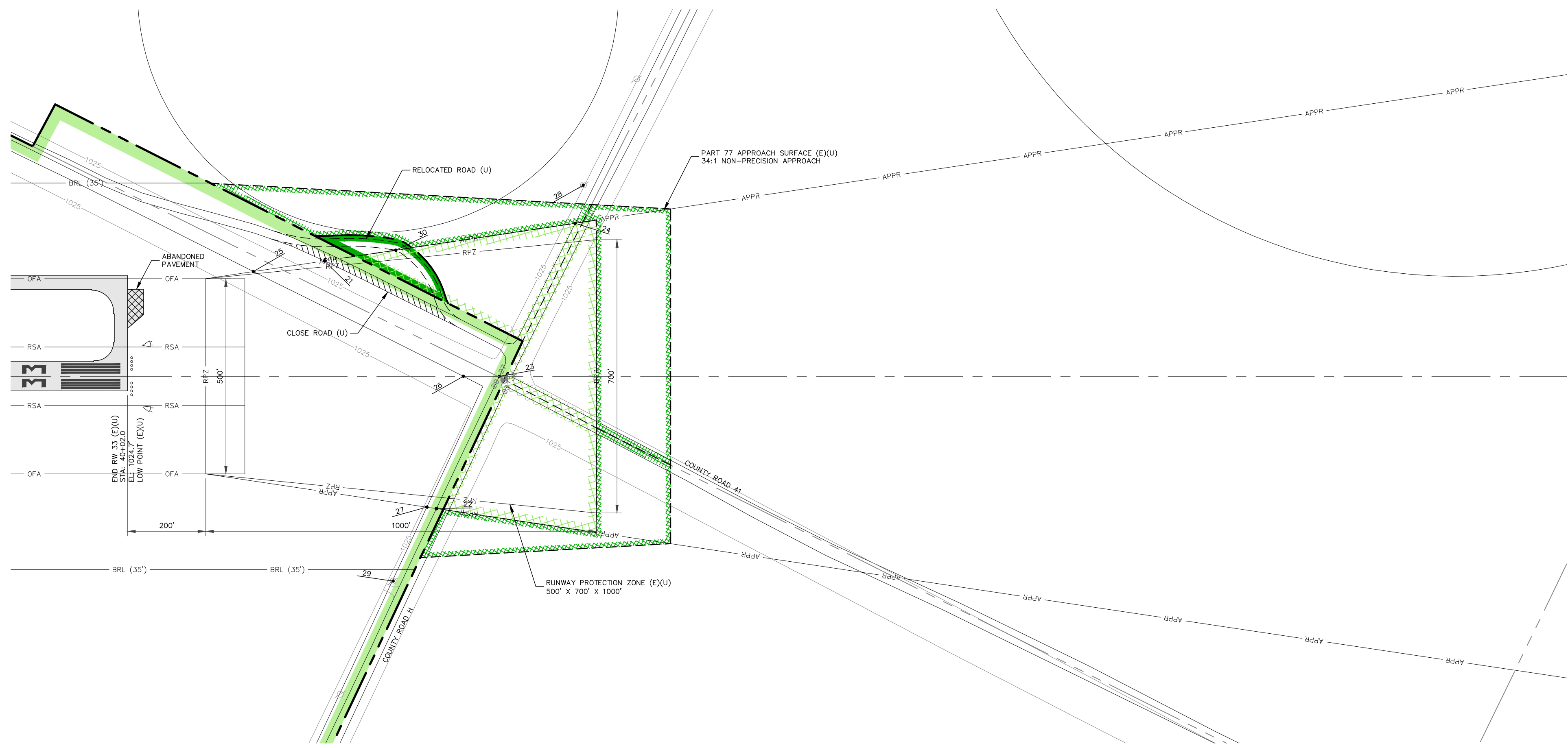

**EXISTING AND ULTIMATE RUNWAY 33 INNER APPROACH PLAN**  
SCALE: 1"=200'

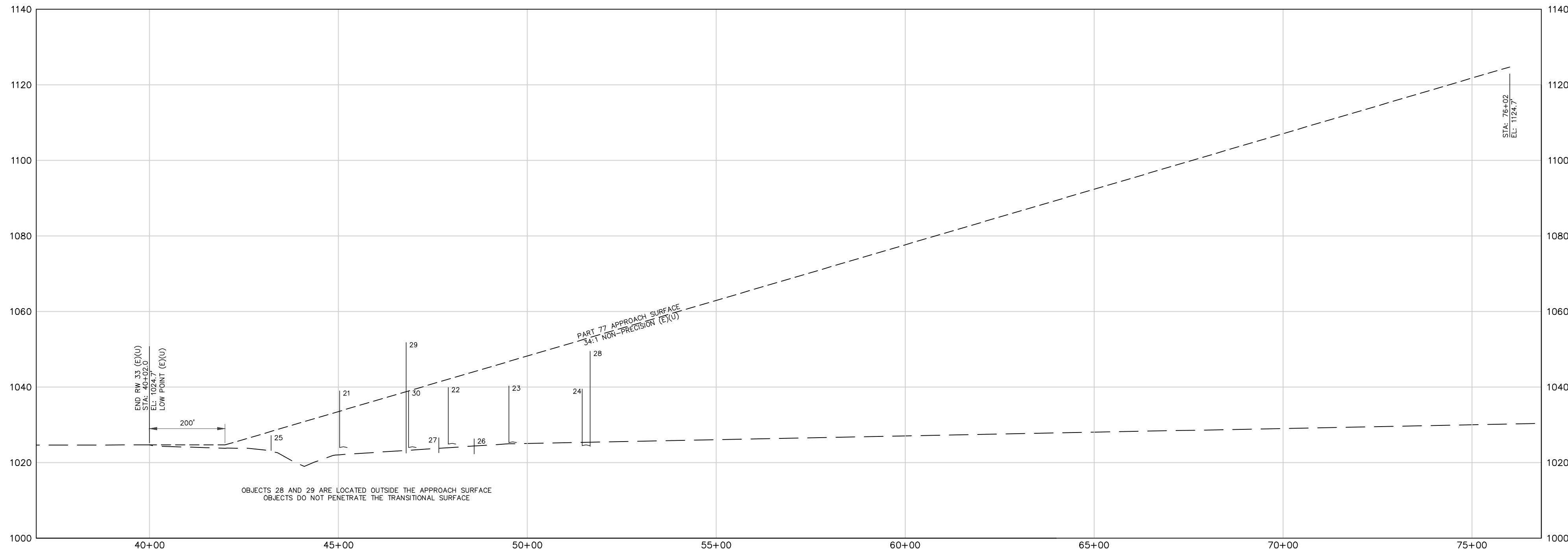

**EXISTING AND ULTIMATE RUNWAY 33 INNER APPROACH PROFILE**  
HORIZONTAL SCALE: 1"=200'  
VERTICAL SCALE: 1"=20'

OBSTRUCTION TABLE		EXISTING AND ULTIMATE RUNWAY 33		
	DESCRIPTION	ELEVATION	PENETRATION AMOUNT	PLANNED DISPOSITION
21	ROAD AT APPROACH (E)	1024.0'	+5.3'	RELOCATE
22	ROAD AT APPROACH (E)	1024.9'	-2.2'	NONE
23	ROAD AT CENTERLINE (E)	1025.3'	-6.6'	NONE
24	ROAD AT APPROACH (E)	1024.5'	-13.0'	NONE
25	FENCE AT APPROACH (E)	1027.2'	-1.4'	NONE
26	FENCE AT CENTERLINE (E)	1026.3'	-17.9'	NONE
27	FENCE AT APPROACH (E)	1026.6'	-14.8'	NONE
28	UTILITY POLE (E)	1049.5'	-17.1'	NONE
29	UTILITY POLE (E)	1051.8'	-15.8'	NONE
30	PROPOSED ROAD AT APPROACH (U)	1024.0'	-0.0'	NONE

NOTE: OBSTRUCTIONS ARE POSITIVE (+), CLEARANCES ARE NEGATIVE (-)

LEGEND	EXISTING (E)	ULTIMATE (U)
BUILDINGS	[Symbol]	[Symbol]
AIRFIELD PAVEMENT	[Symbol]	[Symbol]
TO BE REMOVED	[Symbol]	[Symbol]
PROPERTY LINE	[Symbol]	[Symbol]
EASEMENT	[Symbol]	[Symbol]
ELEVATION CONTOURS	[Symbol]	[Symbol]
SECTION LINE	[Symbol]	[Symbol]
RUNWAY SAFETY AREA (RSA)	[Symbol]	[Symbol]
RUNWAY PROTECTION ZONE (RPZ)	[Symbol]	[Symbol]
APPROACH SURFACE (APPR)	[Symbol]	[Symbol]
BUILDING RESTRICTION LINE WITH HEIGHT (BRL)	[Symbol]	[Symbol]
FENCE	[Symbol]	[Symbol]
PAVED ROADS	[Symbol]	[Symbol]
GRAVEL ROADS	[Symbol]	[Symbol]
TREES/TREE MASS	[Symbol]	[Symbol]
AIRPORT REFERENCE POINT	[Symbol]	[Symbol]
REIL	[Symbol]	[Symbol]
PAPI	[Symbol]	[Symbol]
RUNWAY THRESHOLD LIGHTS	[Symbol]	[Symbol]
AIRPORT BEACON	[Symbol]	[Symbol]
SECTION CORNER	[Symbol]	[Symbol]
SEGMENTED CIRCLE AND WIND CONE	[Symbol]	[Symbol]
OBSTRUCTION LABEL	[Symbol]	[Symbol]

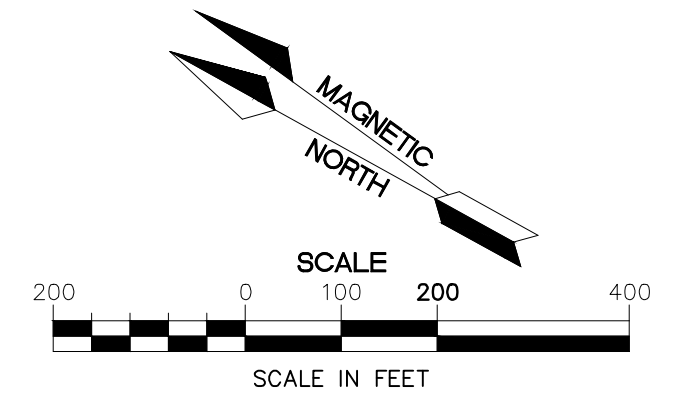

MAGNETIC DECLINATION: 3° 46' EAST, JUNE 2007  
ANNUAL RATE OF CHANGE: 7" WEST

REV	DATE	DESCRIPTION
4	8/31/17	ROAD RELOCATION REVISION
3	15/10/17	AP-008 - TAXI LANE AS-BUILTS
2	10/14/13	AP-06 - NORTH PARALLEL TAXIWAY
1	15/24/10	AP-04/05 - APRON EXPANSION

**EXISTING AND ULTIMATE RUNWAY 33  
INNER APPROACH PLAN AND PROFILE**  
AIRPORT LAYOUT PLAN  
SA-7 TQE/AIP 3-31-0082-04  
TEKAMAH MUNICIPAL AIRPORT  
TEKAMAH, NEBRASKA

drawn by: JDB  
checked by: DJH  
approved by: DJH  
project no.: 2006-2163  
dwg name: 62163\_ALP  
date: 3/08



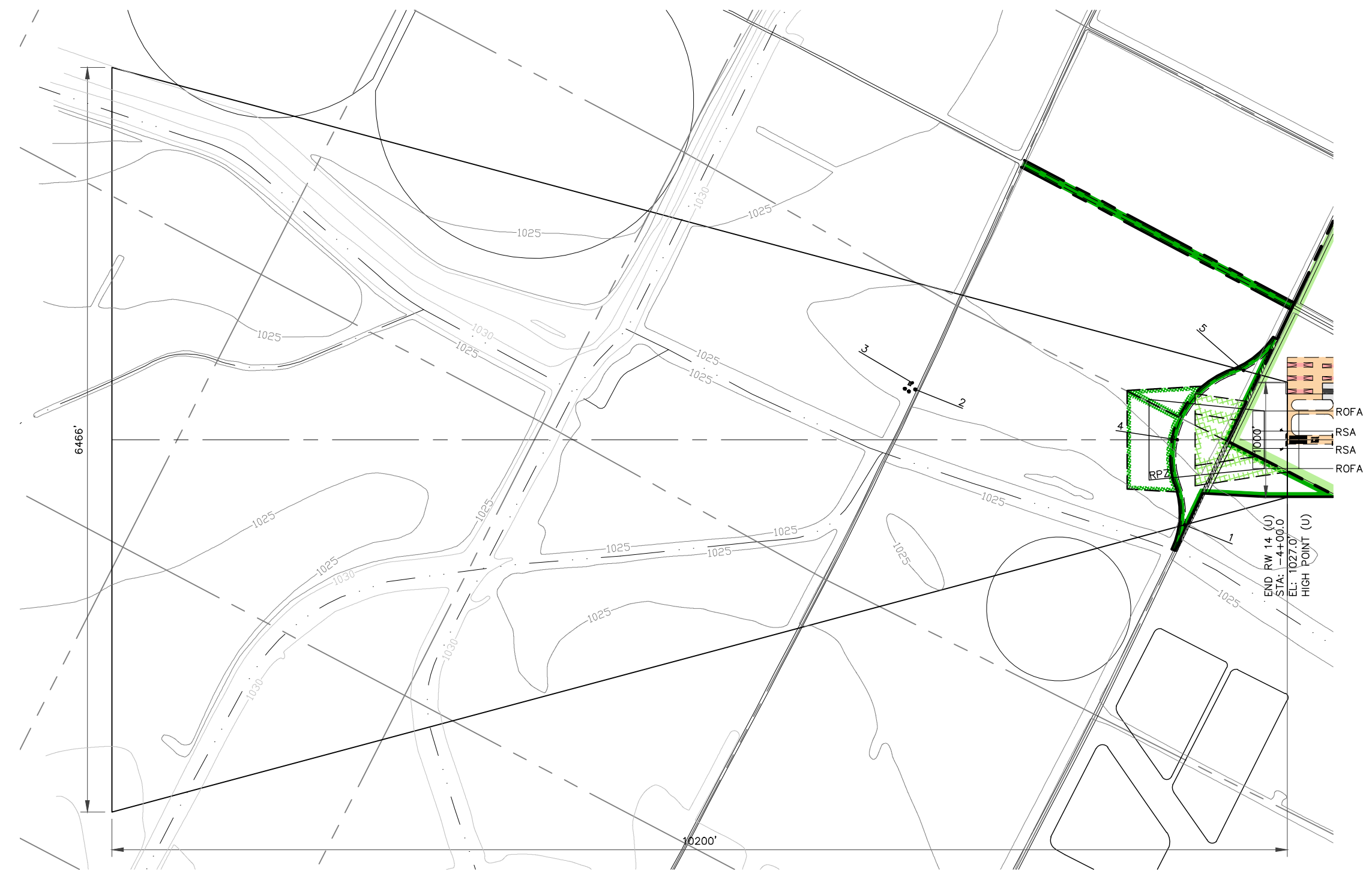

**ULTIMATE RUNWAY 15 DEPARTURE SURFACE PLAN**  
SCALE: 1"=1000'

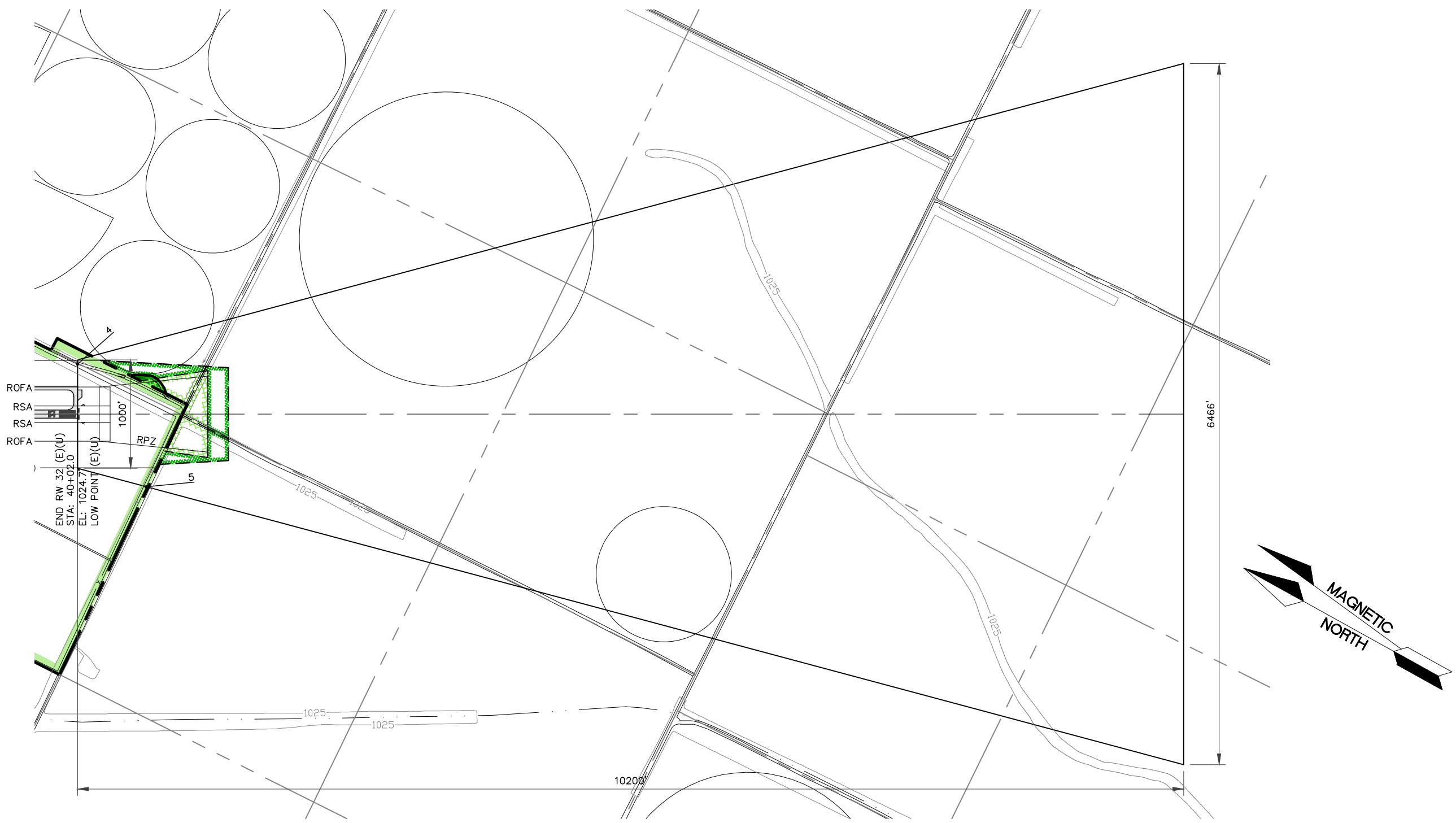

**EXISTING AND ULTIMATE RUNWAY 33 DEPARTURE SURFACE PLAN**  
SCALE: 1"=1000'

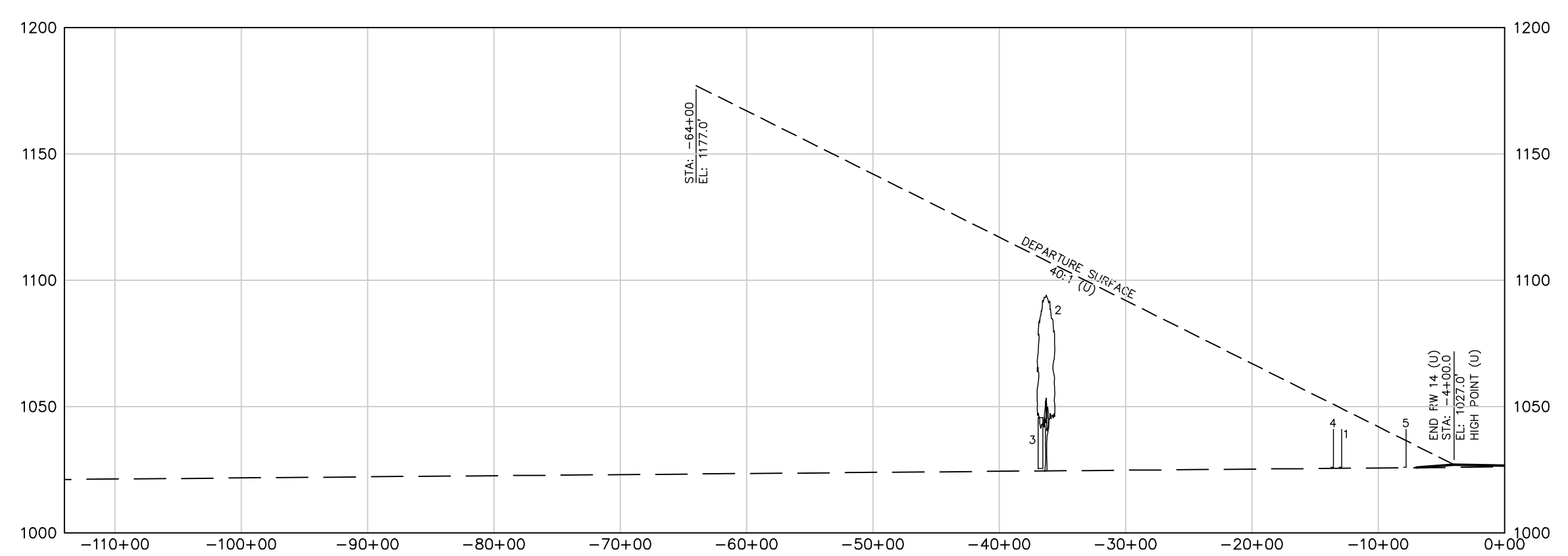
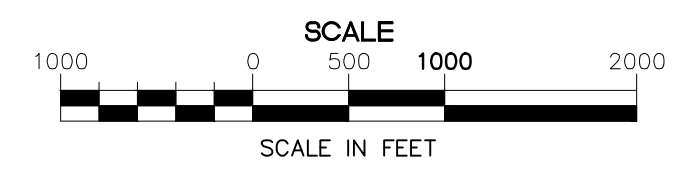

**ULTIMATE RUNWAY 15 DEPARTURE SURFACE PROFILE**  
HORIZONTAL SCALE: 1"=1000'  
VERTICAL SCALE: 1"=50'

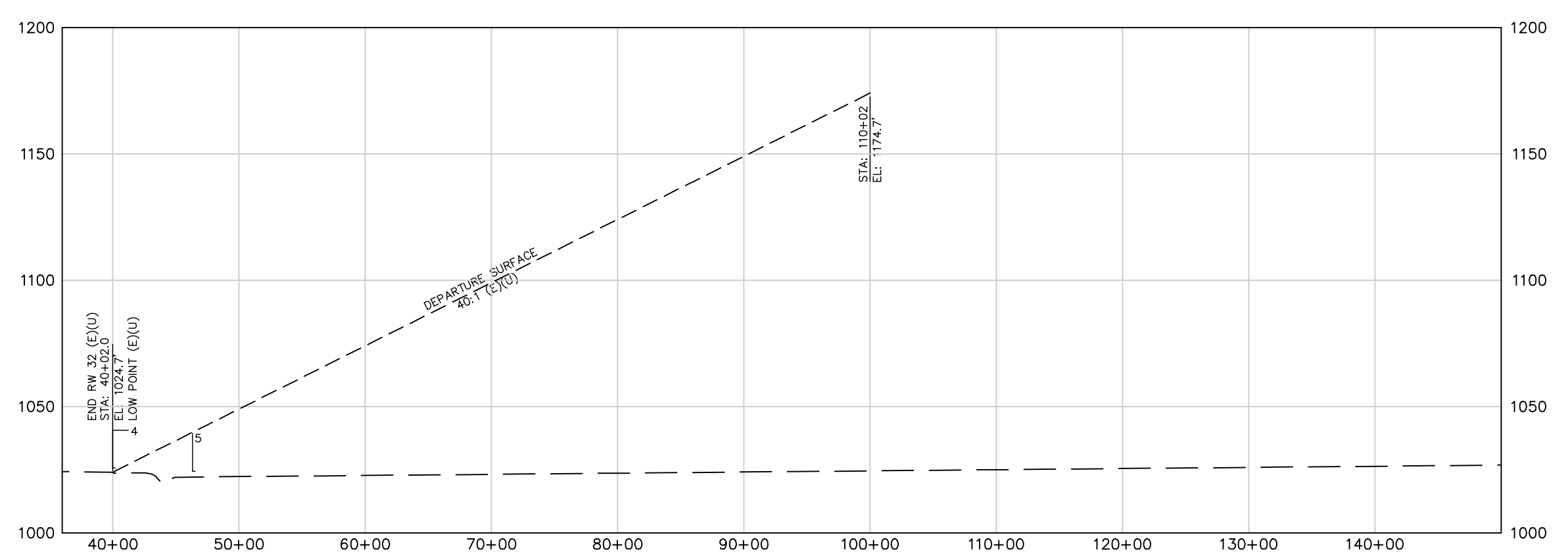

**EXISTING AND ULTIMATE RUNWAY 33 DEPARTURE SURFACE PROFILE**  
HORIZONTAL SCALE: 1"=1000'  
VERTICAL SCALE: 1"=50'

OBSTRUCTION TABLE		ULTIMATE RUNWAY 14		
	DESCRIPTION	ELEVATION	PENETRATION AMOUNT	PLANNED DISPOSITION
1	ROAD AT DEPARTURE	1026.0'	-8.3'	NONE
2	TREE	1093.6'	-14.2'	NONE
3	BUILDING	1045.6'	-62.8'	NONE
4	ROAD AT CENTERLINE	1026.0'	-9.9'	NONE
5	ROAD AT DEPARTURE	1026.0'	+4.5'	NONE*

NOTE: OBSTRUCTIONS ARE POSITIVE (+), CLEARANCES ARE NEGATIVE (-)  
\*PENETRATIONS OF LESS THAN 35' DO NOT REQUIRE MITIGATION, PER AC 150/5300-13, APPENDIX 2, PARAGRAPH 5d(1)

LEGEND	EXISTING (E)	ULTIMATE (U)
	BUILDINGS	[Symbol]
AIRFIELD PAVEMENT	[Symbol]	[Symbol]
PROPERTY LINE	[Symbol]	[Symbol]
EASEMENT	[Symbol]	[Symbol]
ELEVATION CONTOURS	910	
RUNWAY SAFETY AREA (RSA)	RSA	RSA
RUNWAY PROTECTION ZONE (RPZ)	RPZ	RPZ
OBJECT FREE AREA (OFA)	OFA	OFA
BUILDING RESTRICTION LINE WITH HEIGHT (BRL)	BRL (35')	
APPROACH SURFACE (APPR)	APPR	APPR
FENCE	x	xx
PAVED ROADS	[Symbol]	
GRAVEL ROADS	[Symbol]	
TREES/TREE MASS	[Symbol]	
RUNWAY THRESHOLD LIGHTS	oooo	****
OBSTRUCTION LABEL	[Symbol]	[Symbol]

OBSTRUCTION TABLE		EXISTING AND ULTIMATE RUNWAY 33		
	DESCRIPTION	ELEVATION	PENETRATION AMOUNT	PLANNED DISPOSITION
4	ROAD AT DEPARTURE	1025.7'	+16.0'	NONE*
5	ROAD AT DEPARTURE	1025.0'	-0.5'	NONE

NOTE: OBSTRUCTIONS ARE POSITIVE (+), CLEARANCES ARE NEGATIVE (-)  
\* PENETRATIONS OF LESS THAN 35' DO NOT REQUIRE MITIGATION, PER AC 150/5300-13, APPENDIX 2, PARAGRAPH 5d(1)

REV	DATE	DESCRIPTION
4	8/31/17	ROAD RELOCATION REVISION
3	15/10/17	AP-008 - TAXI LANE AS-BUILTS
2	10/14/13	AP-06 - NORTH PARALLEL TAXIWAY
1	15/24/10	AP-04/05 - APRON EXPANSION

**EXISTING AND ULTIMATE RUNWAY 15/33 DEPARTURE SURFACE PLAN AND PROFILE**  
AIRPORT LAYOUT PLAN  
SA-7 TQE/AIP 3-31-0082-04  
TEKAMAH MUNICIPAL AIRPORT  
TEKAMAH, NEBRASKA

drawn by: JDB  
checked by: DJH  
approved by: DJH  
project no.: 2006-2163  
dwg name: 62163\_ALP  
date: 3/08



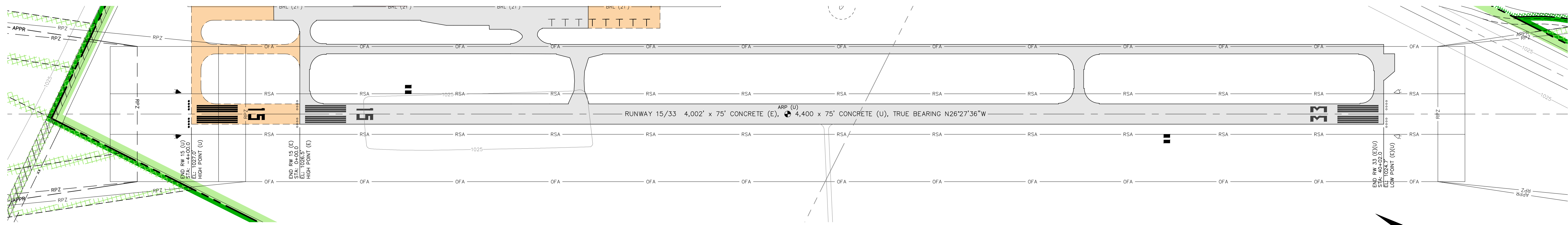

**EXISTING AND ULTIMATE RUNWAY 15/33 PLAN**  
SCALE: 1"=200'

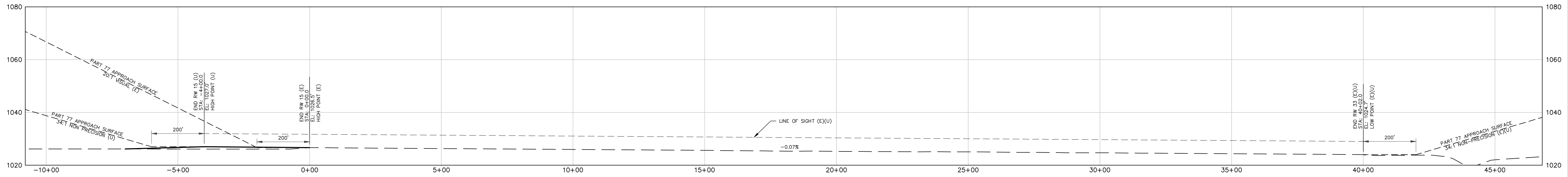

**EXISTING AND ULTIMATE RUNWAY 15/33 PROFILE**  
HORIZONTAL SCALE: 1"=200'  
VERTICAL SCALE: 1"=20'

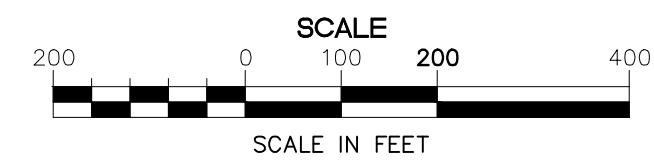

REV	DATE	DESCRIPTION
1	15/24/10	MP-04/05 - APRON EXPANSION
2	10/14/13	MP-06 - NORTH PARALLEL TAXIWAY
3	15/10/17	MP-08 - TAXIWAY AS-BUILDS
4	8/31/17	ROAD RELOCATION REVISION

**EXISTING AND ULTIMATE RW 15/33  
PLAN AND PROFILE**  
AIRPORT LAYOUT PLAN  
SA-7 TQE/AIP 3-31-0082-04  
TEKAMAH MUNICIPAL AIRPORT  
TEKAMAH, NEBRASKA

drawn by: JDB  
checked by: DJH  
approved by: DJH  
project no.: 2006-2163  
dwg name: 62163\_ALP  
date: 3/08



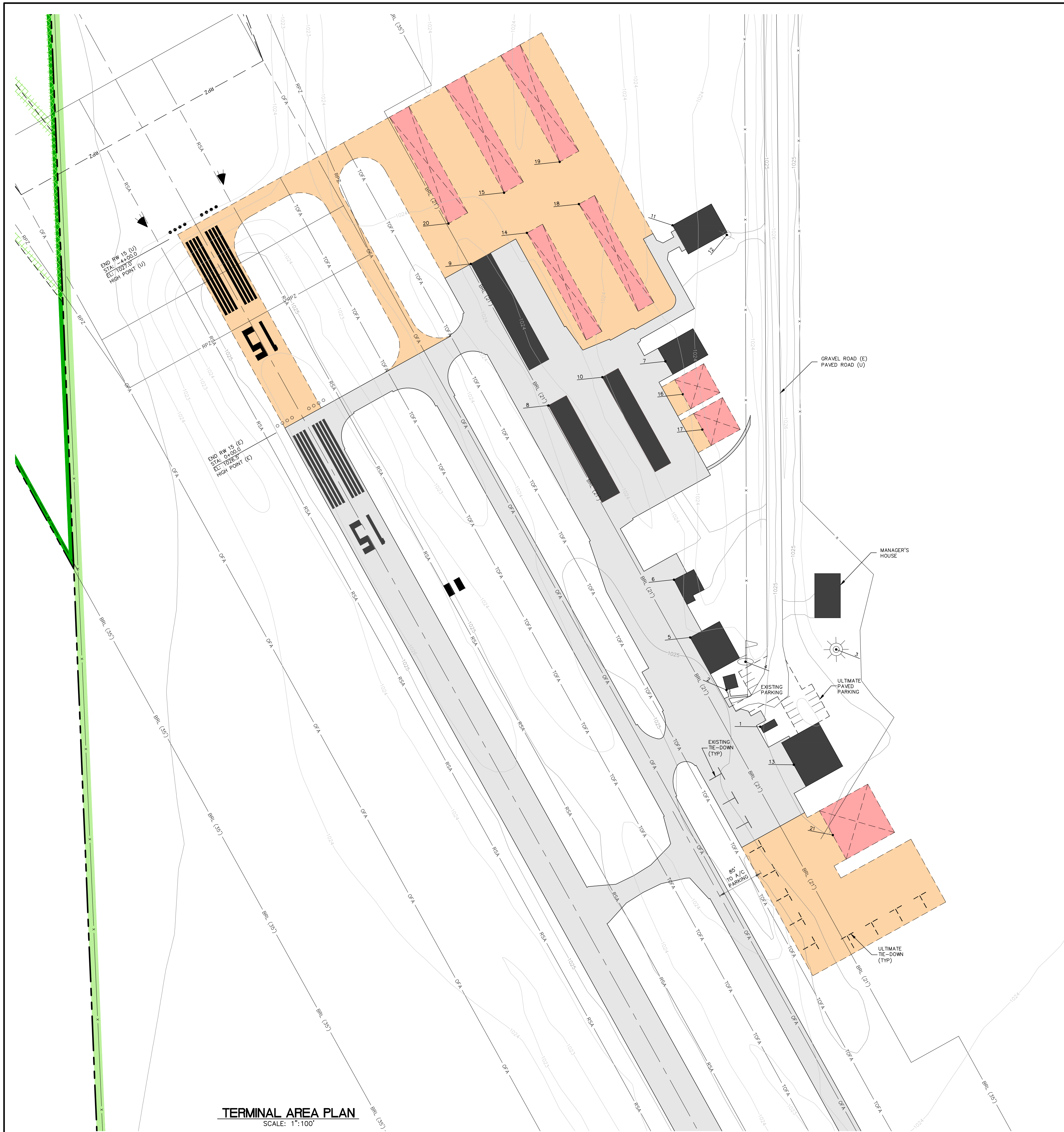

**TERMINAL AREA PLAN**  
SCALE: 1"=100'

BUILDING TABLE				
	DESCRIPTION	ELEVATION	PENETRATION AMOUNT	PLANNED DISPOSITION
1	FUEL TANK (E)	1035.50	-44.5'	NONE
2	PILOT'S LOUNGE (E)	1037.2'	-15.2'	NONE
3	BEACON (E)	1081.8'	-0.4'	NONE
4	WIND CONE (E)	1052.2'	-8.0'	NONE
5	HANGAR BUILDING (E)	1036.3'	-14.5'	NONE
6	STORAGE BUILDING (E)	1042.6'	-11.8'	NONE
7	HANGAR BUILDING (E)	1047.2'	-29.7'	NONE
8	T-HANGAR (E)	1041.3'	-6.5'	NONE
9	T-HANGAR (E)	1043.3'	-4.7'	NONE
10	T-HANGAR (E)	1041.8'	-21.7'	NONE
11	HANGAR BUILDING (E)	1049.6'	-48.8'	NONE
12	UTILITY POLE (E)	1075.1'	-34.4'	NONE
13	HANGAR (E)	1053.2'	-4.6'	NONE
14	T-HANGAR (U)	1064.5'		
15	T-HANGAR (U)	1064.4'		
16	SHOP/STORAGE HANGAR (U)	1079.0'		
17	SHOP/STORAGE HANGAR (U)	1079.0'		
18	T-HANGAR (U)	1079.9'		
19	T-HANGAR (U)	1080.8'		
20	T-HANGAR (U)	1048.0'		
21	SHOP/STORAGE HANGAR (U)	1057.4'		

NOTE: OBSTRUCTIONS ARE POSITIVE (+), CLEARANCES ARE NEGATIVE (-)  
 (E) - EXISTING  
 (U) - ULTIMATE  
 (R) - TO BE REMOVED  
 (RL) - TO BE RELOCATED  
 ELEVATION SHOWN FOR ULTIMATE BUILDINGS IS MAXIMUM HEIGHT TO CLEAR TRANSITIONAL SURFACE

LEGEND	EXISTING (E)	ULTIMATE (U)
BUILDINGS	[Symbol]	[Symbol]
AIRFIELD PAVEMENT	[Symbol]	[Symbol]
TO BE REMOVED	[Symbol]	[Symbol]
PROPERTY LINE	[Symbol]	[Symbol]
EASEMENT	[Symbol]	[Symbol]
ELEVATION CONTOURS	[Symbol]	[Symbol]
SECTION LINE	[Symbol]	[Symbol]
RUNWAY SAFETY AREA (RSA)	[Symbol]	[Symbol]
RUNWAY PROTECTION ZONE (RPZ)	[Symbol]	[Symbol]
APPROACH SURFACE (APPR)	[Symbol]	[Symbol]
BUILDING RESTRICTION LINE WITH HEIGHT (BRL)	[Symbol]	[Symbol]
FENCE	[Symbol]	[Symbol]
PAVED ROADS	[Symbol]	[Symbol]
GRAVEL ROADS	[Symbol]	[Symbol]
TREES/TREE MASS	[Symbol]	[Symbol]
AIRPORT REFERENCE POINT	[Symbol]	[Symbol]
REIL	[Symbol]	[Symbol]
PAPI	[Symbol]	[Symbol]
RUNWAY THRESHOLD LIGHTS	[Symbol]	[Symbol]
AIRPORT BEACON	[Symbol]	[Symbol]
TIE DOWNS	[Symbol]	[Symbol]
SECTION CORNER	[Symbol]	[Symbol]
SEGMENTED CIRCLE AND WIND CONE	[Symbol]	[Symbol]

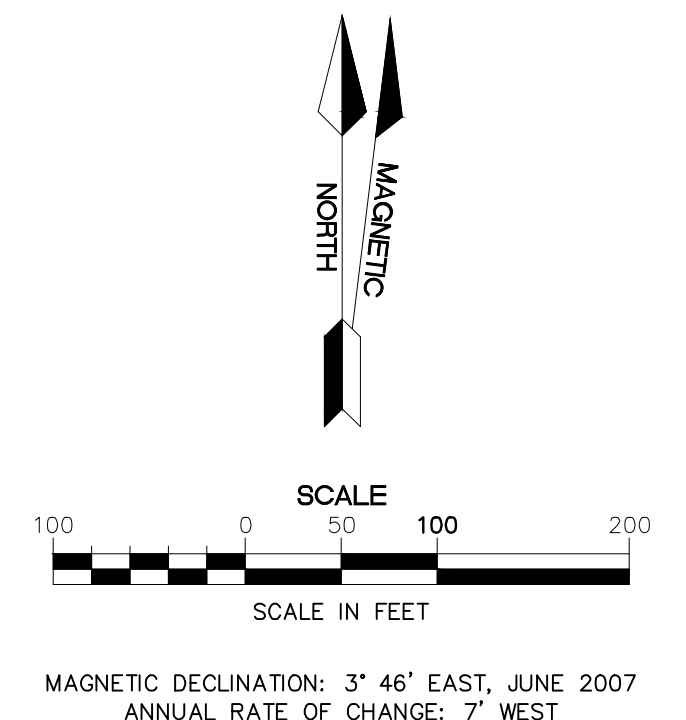

REV	DATE	DESCRIPTION
1	15/24/70	APP-04/05 - APRON EXPANSION
2	10/14/73	APP-06 - NORTH PARALLEL TAXIWAY
3	15/10/77	APP-008 - TAXIWAY AS-BUILT
4	8/31/77	ROAD RELOCATION REVISION

TERMINAL AREA PLAN  
 AIRPORT LAYOUT PLAN  
 SA-7 TQE/AIP 3-31-0082-04  
 TEKAMAH MUNICIPAL AIRPORT  
 TEKAMAH, NEBRASKA

drawn by: JDB  
 checked by: DJH  
 approved by: DJH  
 project no.: 2006-2163  
 dwg name: 62163\_ALP  
 date: 3/08





LEGEND		EXISTING (E) AND ULTIMATE (U)	
AGRICULTURAL		(AG)	

LEGEND	EXISTING (E)	ULTIMATE (U)
BUILDINGS	[Solid Black]	[Hatched]
AIRFIELD PAVEMENT	[Light Gray]	[Orange]
TO BE REMOVED	[Dotted]	[Cross-hatched]
PROPERTY LINE	[Dashed Green]	[Dashed Green]
EASEMENT	[Dotted Green]	[Dotted Green]
ELEVATION CONTOURS	[Dashed Gray]	[Dashed Gray]
SECTION LINE	[Dashed Gray]	[Dashed Gray]
RUNWAY SAFETY AREA (RSA)	[Dashed Gray]	[Dashed Gray]
RUNWAY PROTECTION ZONE (RPZ)	[Dashed Gray]	[Dashed Gray]
CROP RESTRICTION LINE (CRL)	[Dashed Gray]	[Dashed Gray]
APPROACH SURFACE (APPR)	[Dashed Gray]	[Dashed Gray]
BUILDING RESTRICTION LINE WITH HEIGHT (BRL)	[Dashed Gray]	[Dashed Gray]
FENCE	[Dashed Gray]	[Dashed Gray]
PAVED ROADS	[Solid Gray]	[Solid Gray]
GRAVEL ROADS	[Dashed Gray]	[Dashed Gray]
TREES/TREE MASS	[Cloud Symbols]	[Cloud Symbols]
PAPI	[Dotted Gray]	[Dotted Gray]
RUNWAY THRESHOLD LIGHTS	[Dotted Gray]	[Dotted Gray]
AIRPORT BEACON	[Star Symbol]	[Star Symbol]
SECTION CORNER	[Crosshair]	[Crosshair]
SEGMENTED CIRCLE AND WIND CONE	[Circle with Arrow]	[Circle with Arrow]

**GENERAL NOTE:**  
 1. LOCAL ZONING RESTRICTS THE HEIGHT OF OBJECTS WITHIN 3 MILES OF THE AIRPORT.

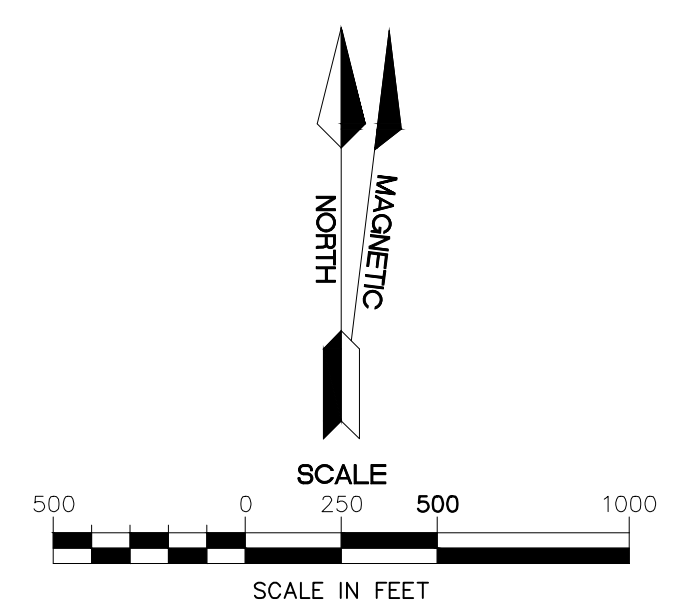

MAGNETIC DECLINATION: 3° 46' EAST, JUNE 2007  
 ANNUAL RATE OF CHANGE: 7" WEST

REV	DATE	DESCRIPTION
1	15/24/70	AP-04/70 - APRON EXPANSION
2	10/14/73	AP-06 - NORTH PARALLEL TAXIWAY
3	15/10/77	AP-08 - TAXIWAY AS-BUILT
4	8/31/77	ROAD RELOCATION REVISION

LAND USE PLAN  
 AIRPORT LAYOUT PLAN  
 SA-7 TQE/AIP 3-31-0082-04  
 TEKAMAH MUNICIPAL AIRPORT  
 TEKAMAH, NEBRASKA

drawn by: JDB  
 checked by: DJH  
 approved by: DJH  
 project no.: 2006-2163  
 dwg name: 62163\_ALP  
 date: 3/08

**MOLSSON ASSOCIATES**

801 P Street, Suite 200  
 P. O. Box 64909  
 Lincoln, NE 68508-4608

TEL 402.474.6311  
 FAX 402.474.5160  
 www.molssonllc.com



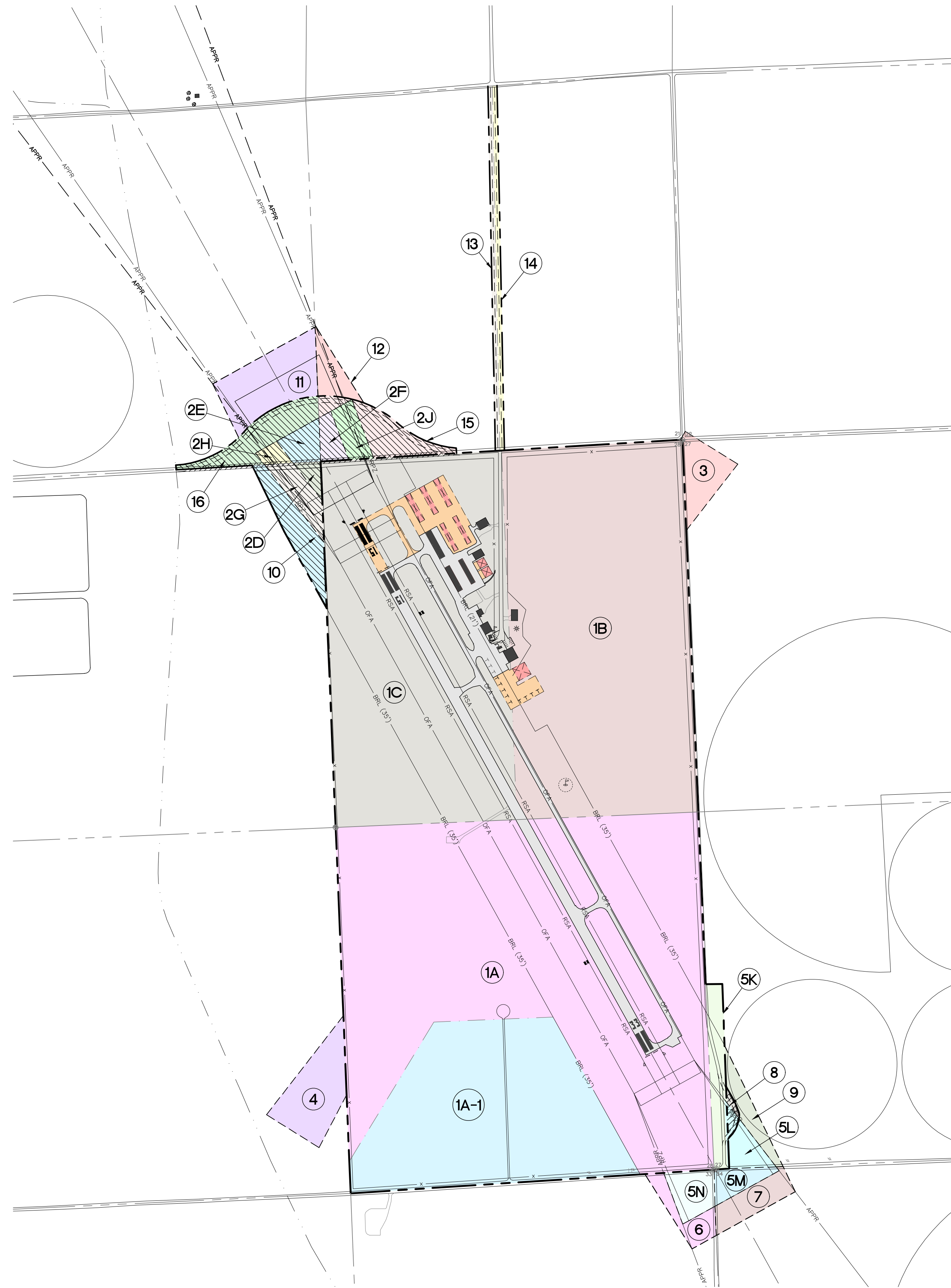

PROPERTY TABLE	AREA	DATE ACQUIRED/GRANTED	TYPE OF ACQUISITION	PROJECT NUMBER	BOOK DATA*	
					BOOK NO.	PAGE
AREA 1, TRACT A	116.95 ac	1966	FEE	9-25-090-C601	(D) 48	625
AREA 1, TRACT A-1	43.02 ac	1966	FEE	NA	(D) 48	625
AREA 1, TRACT B	80 ac	1966	FEE	9-25-090-C601	(D) 48	588
AREA 1, TRACT C	80 ac	1966	FEE	9-25-090-C601	(D) 48	624
AREA 2, TRACT D	0.76 ac	1966	EASEMENT	9-25-090-C601	(M) 22	355
AREA 2, TRACT E	1.57 ac	1966	EASEMENT	9-25-090-C601	(M) 22	694
AREA 2, TRACT F	1.33 ac	1966	EASEMENT	9-25-090-C601	(M) 23	3
AREA 3	3.15 ac	1967	EASEMENT	9-25-090-C601	(M) 22	644
AREA 4	6.07 ac	1966	EASEMENT	9-25-090-C601	(M) 23	4
AREA 2, TRACT G	1.93 ac	1987	EASEMENT	3-31-0082-01	(M) 35	447
AREA 2, TRACT H	0.63 ac	1987	EASEMENT	3-31-0082-01	(M) 35	327
AREA 2, TRACT J	1.60 ac	1987	EASEMENT	3-31-0082-01	(M) 35	444
AREA 5, TRACT K	3.02 ac	1987	FEE	3-31-0082-01	(D) 62	538
AREA 5, TRACT L	1.84 ac	1987	EASEMENT	3-31-0082-01	(M) 35	358
AREA 5, TRACT M	1.60 ac	1987	EASEMENT	3-31-0082-01	(M) 35	324
AREA 5, TRACT N	2.49 ac	1987	EASEMENT	3-31-0082-01	(M) 35	529
TRACT 6	1.90 ac	2008-2012	EASEMENT			
TRACT 7	2.70 ac	2008-2012	EASEMENT			
TRACT 8	0.48 ac	2008-2012	FEE			
TRACT 9	1.96 ac	2008-2012	EASEMENT			
TRACT 10	6.03 ac	2008-2012	FEE			
TRACT 11	6.93 ac	2008-2012	EASEMENT			
TRACT 12	1.86 ac	2008-2012	EASEMENT			
TRACT 13	2.01 ac	2008-2012	FEE			
TRACT 14	2.00 ac	2008-2012	FEE			
TRACT 15	6.37 ac	2008-2012	FEE			
TRACT 16	6.24 ac	2008-2012	FEE			

\* (D) = DEED BOOK  
(M) = MISC. BOOK

- NOTES:**
- TRACT 10 (FEE) INCLUDES THE FOLLOWING EASEMENTS: ALL OF AREA 2, TRACT D AND MOST OF AREA 2, TRACT G.
  - TRACT 8 (FEE) INCLUDES A PORTION OF AREA 5, TRACT N (EASEMENT).
  - TRACT 15 (FEE) INCLUDES THE FOLLOWING EASEMENTS: ALL OF AREA 2, TRACT F AND ALL OF AREA 2, TRACT J.
  - TRACT 16 (FEE) INCLUDES THE FOLLOWING EASEMENTS: ALL OF AREA 2, TRACT E AND ALL OF AREA 2, TRACT H.
  - DATA BASED ON ALP BY JEO DATED 1993 AND PROPERTY SURVEY MAP BY NDA REVISED 3/13/1988.
  - AREA 5, TRACT K HAS A 1990 EASEMENT RECORDED IN BOOK NO. (M) 37, PAGE 607.

LEGEND	EXISTING (E)	ULTIMATE (U)
	BUILDINGS	[Symbol]
AIRFIELD PAVEMENT	[Symbol]	[Symbol]
TO BE REMOVED	[Symbol]	[Symbol]
PROPERTY LINE	[Symbol]	[Symbol]
EASEMENT	[Symbol]	[Symbol]
ELEVATION CONTOURS	[Symbol]	[Symbol]
SECTION LINE	[Symbol]	[Symbol]
RUNWAY SAFETY AREA (RSA)	[Symbol]	[Symbol]
RUNWAY PROTECTION ZONE (RPZ)	[Symbol]	[Symbol]
APPROACH SURFACE (APPR)	[Symbol]	[Symbol]
BUILDING RESTRICTION LINE WITH HEIGHT (BRL)	[Symbol]	[Symbol]
FENCE	[Symbol]	[Symbol]
PAVED ROADS	[Symbol]	[Symbol]
GRAVEL ROADS	[Symbol]	[Symbol]
TREES/TREE MASS	[Symbol]	[Symbol]
REIL	[Symbol]	[Symbol]
PAPI	[Symbol]	[Symbol]
RUNWAY THRESHOLD LIGHTS	[Symbol]	[Symbol]
AIRPORT BEACON	[Symbol]	[Symbol]
SECTION CORNER	[Symbol]	[Symbol]
SEGMENTED CIRCLE AND WIND CONE	[Symbol]	[Symbol]

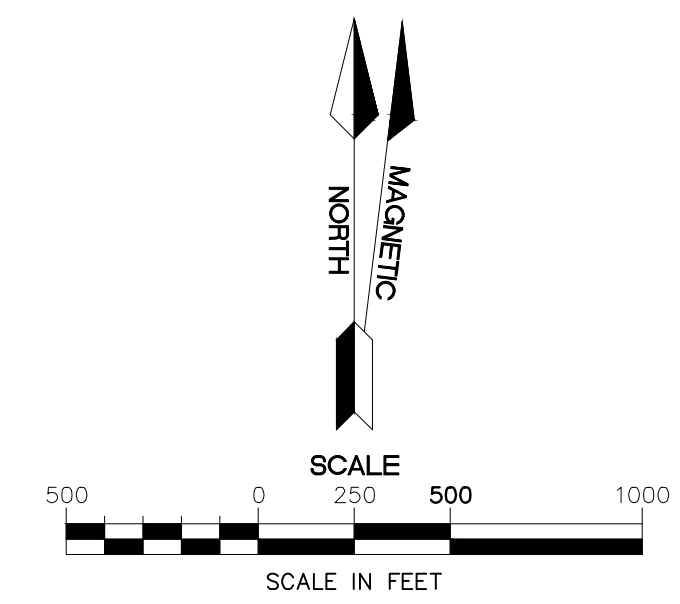

MAGNETIC DECLINATION: 3° 46' EAST, JUNE 2007  
ANNUAL RATE OF CHANGE: 7" WEST

**MOLSSON ASSOCIATES**  
801 P Street, Suite 200  
P.O. Box 64909  
Lincoln, NE 68508-4608  
TEL 402.474.6311  
FAX 402.474.5160  
www.molsson.com

REV	DATE	DESCRIPTION
4	8/31/17	ROAD RELOCATION REVISION
3	15/10/17	AP-008 - TAXI LANE AS-BUILTS
2	10/14/13	AP-06 - NORTH PARALLEL TAXIWAY
1	15/24/10	AP-04/05 - APRON EXPANSION

AIRPORT PROPERTY MAP  
AIRPORT LAYOUT PLAN  
SA-7 TQE/AIP 3-31-0082-04  
TEKAMAH MUNICIPAL AIRPORT  
TEKAMAH, NEBRASKA

drawn by: JDB  
checked by: DJH  
approved by: DJH  
project no.: 2006-2163  
dwg name: 62163\_ALP  
date: 3/08