

SEPTIC SYSTEM PROFILE

- ELEVATIONS REFER TO NAVD 88
- BENCH MARK CATCH BASIN RIM
EL. 87.70
- ESTIMATED DAILY FLOW
12 BEDROOMS X 110 GALLONS PER
BEDROOM PER DAY = 1320 GALLONS
PER DAY.
- SEPTIC TANK REQ'D CAPACITY
1st COMPARTMENT
200% OF DAILY FLOW = 2640 GALLONS
USE 3000 GALLON TANK
2nd COMPARTMENT
100% OF DAILY FLOW = 1320 GALLONS
USE 1500 GALLON TANK
- LEACHING AREA REQUIREMENTS; CLASS I SOIL
PERC RATE < 5 MIN/IN
APPLICATION RATE = 0.74 G/SF
AREA REQ. = 1320 ÷ 0.74 GAL/S.F. = 1783.8 S.F.
USE TRENCHES 24" X 24"
AREA = 6 S.F./L.F.
LNTH REQ. = 1783.8 ÷ 6 = 297.3 L.F.
- LEACHING AREA PROVIDED
USE TRENCHES 5-24" X 24" X 60"
AREA PROV. = 5 X 60 X 6 = 1,800 S.F.
CAP. PROV. = 1,800 X 0.74 G/S.F. = 1,332 G.P.D.

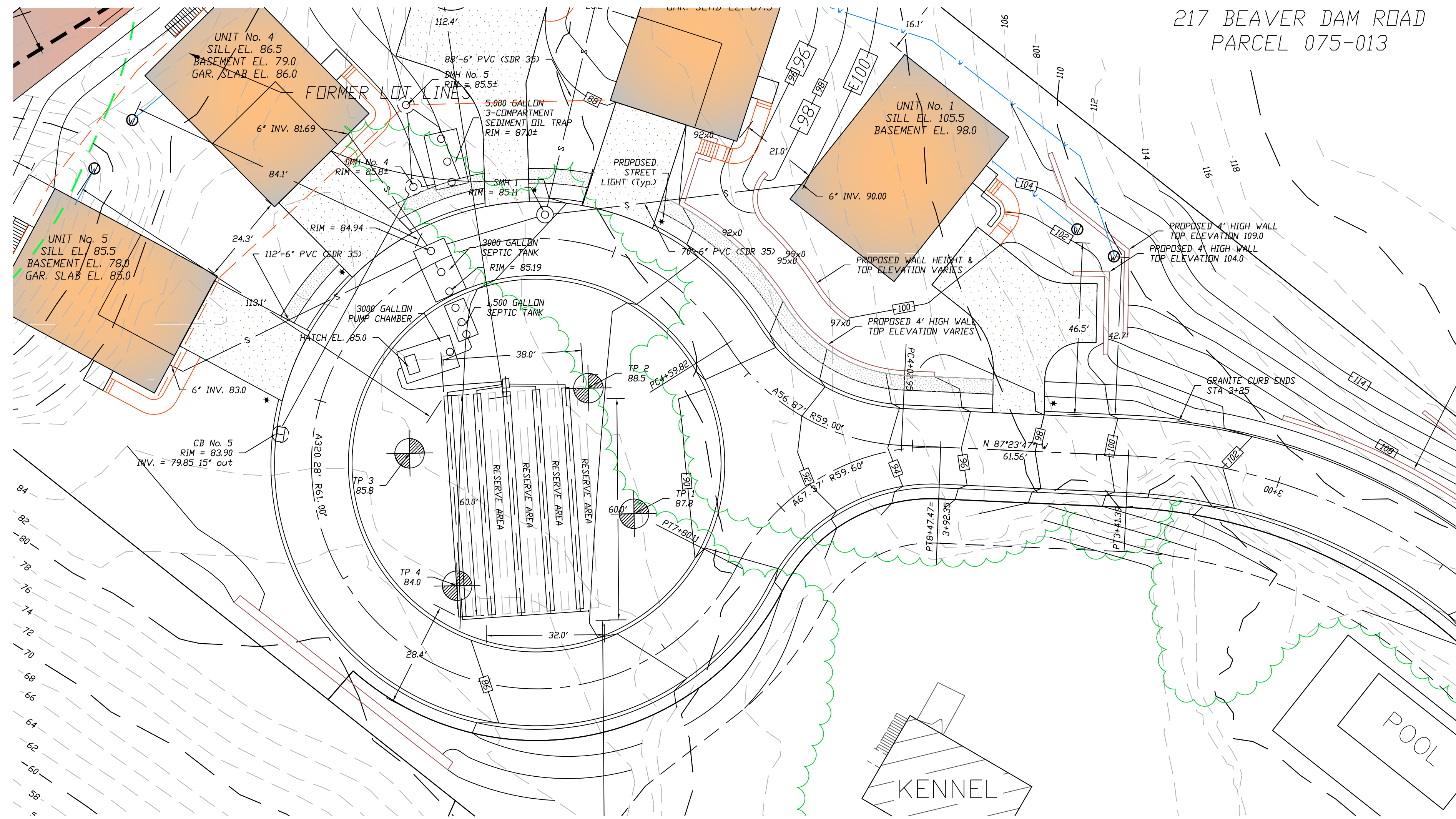

- HEAVY GRADING MACHINERY SHALL NOT BE PERMITTED TO PASS OVER LEACHING AREAS.
- ALL CONSTRUCTION TO CONFORM TO THE REQUIREMENTS OF THE MASSACHUSETTS DEPARTMENT OF ENV. PROTECTION SANITARY CODE, TITLE 5, AND THE TOWN OF PLYMOUTH BOARD OF HEALTH.
- PERCOLATION DATA

PERC RATE	DEPTH OF TEST	DATE
1		
2 < 2 MIN/IN	36"	06/11/15
3		
4		
5		

OWNER & APPLICANT
 BRENNAN, CONSTANCE J.
 REVOCABLE LIVING TRUST
 225 BEAVER DAM ROAD
 PLYMOUTH, MA 02370
 LOCUS: PARCEL Nos. 075-013-004 & 005

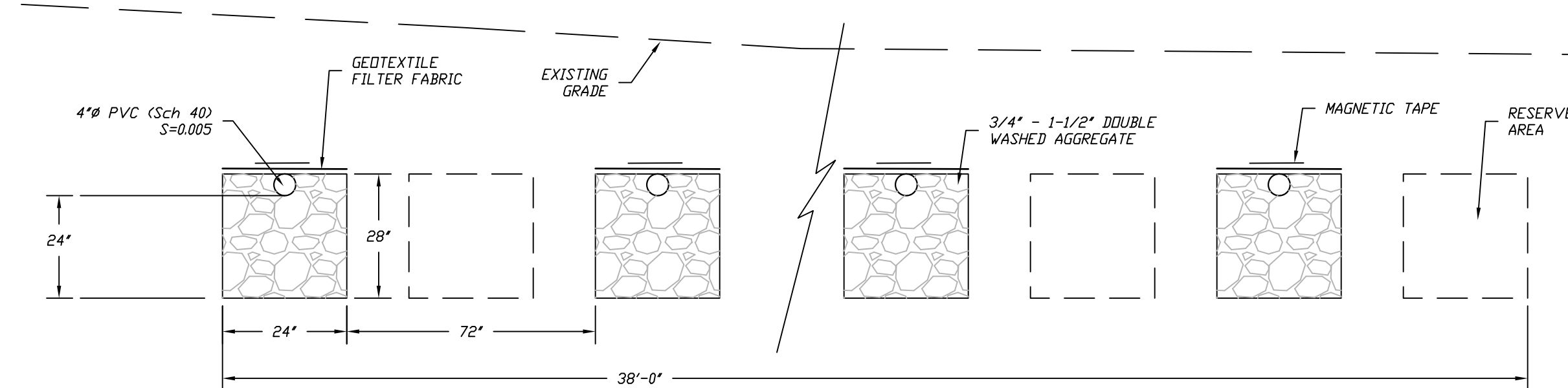

SECTION THRU LEACHING

NO.	DATE	DESCRIPTION	BY
1	12/15/20	response to engineering	GDJ
2	12/23/20	ADDED LDT NUMBERS	GDJ
3	02/15/21	RESPONSE TO ENGINEERING	GDJ
4	03/15/21	RESPONSE TO ENGINEERING	GDJ
5	04/08/21	MINDR REVS	GDJ

SUBSURFACE SEWAGE DISPOSAL SYSTEM
 CONVENTIONAL SYSTEM DESIGN
 THE RESIDENCES AT SERENITY HILL
 221 BEAVER DAM ROAD
 PLYMOUTH, MA 02370

SCALE: 1"=20' DATE: JULY 27, 2020

JAMES ENGINEERING, INC.
 125 GREAT ROCK ROAD
 HANOVER, MASS. 02339
 TEL: 1- (781)-878-1795

