



<b>Job Name</b>	
<b>Job Location</b>	
<b>P.O.#</b>	
<b>Engineer</b>	
<b>Contractor</b>	
<b>Wholesaler</b>	
<b>CopperPress® Rep</b>	

**Description:** CopperPress® Small Diameter Press Male Adapter is available in sizes ½” – 2” and is made of lead-free dezincification resistant bronze with an EPDM or HNBR o-ring. CopperPress® fittings are designed to be used with ASTM B88 Type K, L and M ½” – 2” copper tubing in the hard-drawn condition and soft copper tubing in sizes ½” to 1¼”.

**Features:**

- **Visual Indicator Press Ring (VIPR)** – facilitates immediate identification of un-pressed connections
- **Leak Before Press** – in addition to the VIPR, valve incorporates four path LBP technology, guaranteeing a visual indication if not pressed
- **Permanent Application Marking** – imprinted on fitting body for quick H<sub>2</sub>O or gas application identification
- **Lead Free Construction** – fully compliant with current lead-free laws
- **Copper Ends** - protect against dezincification and stress corrosion cracking

**Operational Parameters:** Operating / Test Pressure = 300 psi / 600 psi, Temperature Range 0°F - 250°F

**Approvals:** NSF ANSI/CAN 61, UPC, cUPC, IPC, IAPMO PS-117, ICC-ES-PMG, ASME B16.51

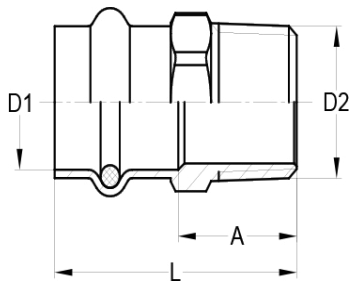

Item Number	D1 (in)	D2 (in)	L (in)	A (in)
23250	½”	¾” MPT	1.65	0.85
23260	½”	½” MPT	1.69	0.89
23270	½”	¾” MPT	1.77	0.96
23280	¾”	½” MPT	2.05	1.10
23290	¾”	¾” MPT	1.89	0.94
23300	¾”	1” MPT	2.05	1.10

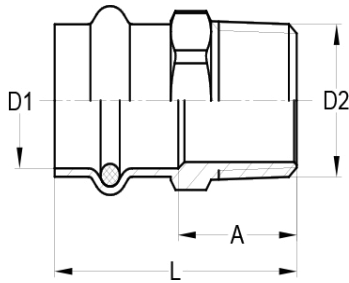

Item Number	D1 (in)	D2 (in)	L (in)	A (in)
23310	1"	1/2" MPT	2.13	1.18
23320	1"	3/4" MPT	1.93	0.98
23330	1"	1" MPT	1.97	1.02
23340	1"	1 1/4" MPT	2.09	1.14
23350	1 1/4"	1" MPT	2.20	1.06
23360	1 1/4"	1 1/4" MPT	2.20	1.06
23370	1 1/4"	1 1/2" MPT	2.28	1.14
23380	1 1/2"	1 1/4" MPT	2.70	1.24
23390	1 1/2"	1 1/2" MPT	2.64	1.18
23400	1 1/2"	2" MPT	2.64	1.18
23410	2"	1 1/2" MPT	2.83	1.22
23420	2"	2" MPT	2.80	1.18