



<b>Job Name</b>	
<b>Job Location</b>	
<b>P.O.#</b>	
<b>Engineer</b>	
<b>Contractor</b>	
<b>Wholesaler</b>	
<b>CopperPress® Rep</b>	

**Description:** CopperPress® Small Diameter Press Unequal Tee is available in sizes ½” – 2” and is made of lead-free dezincification resistant copper with an EPDM or HNBR o-ring. CopperPress® fittings are designed to be used with ASTM B88 Type K, L and M ½” – 2” copper tubing in the hard-drawn condition and soft copper tubing in sizes ½” to 1¼”.

**Features:**

- **Visual Indicator Press Ring (VIPR)** – facilitates immediate identification of un-pressed connections
- **Leak Before Press** – in addition to the VIPR, valve incorporates four path LBP technology, guaranteeing a visual indication if not pressed
- **Permanent Application Marking** – imprinted on fitting body for quick H<sub>2</sub>O or gas application identification
- **Lead Free Construction** – fully compliant with current lead-free laws
- **Copper Ends** - protect against dezincification and stress corrosion cracking

**Operational Parameters:** Operating / Test Pressure = 300 psi / 600 psi, Temperature Range 0°F - 250°F

**Approvals:** NSF ANSI/CAN 61, UPC, cUPC, IPC, IAPMO PS-117, ICC-ES-PMG, ASME B16.51

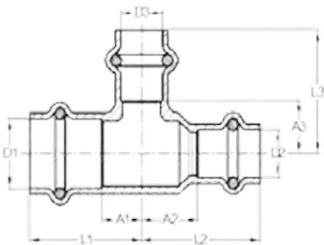

Item Number	D1 (in)	D2 (in)	D3 (in)	L1 (in)	L2 (in)	L3 (in)	A1 (in)	A2 (in)	A3 (in)
14120	½”	½”	¾”	1.71	0.91	1.71	0.91	1.54	0.59
14130	½”	½”	1”	1.73	0.79	1.71	0.91	1.71	0.91
14150	¾”	½”	½”	1.63	0.69	1.75	0.94	1.40	0.59
14160	¾”	½”	¾”	1.79	0.85	1.87	1.06	1.57	0.63
14170	¾”	¾”	½”	1.63	0.69	1.63	0.69	1.38	0.57
14180	¾”	¾”	1”	1.91	0.96	1.91	0.96	1.97	1.02

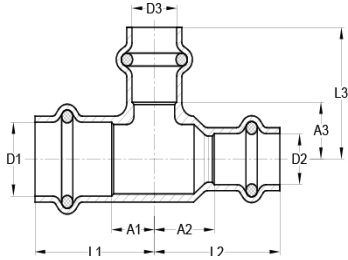

Item Number	D1 (in)	D2 (in)	D3 (in)	L1 (in)	L2 (in)	L3 (in)	A1 (in)	A2 (in)	A3 (in)
14195	1"	1"	3/4"	1.63	0.69	2.01	1.20	1.59	0.79
14200	1"	1/2"	3/4"	1.79	0.85	2.13	1.32	1.73	0.79
14210	1"	1/2"	1"	1.91	0.96	2.22	1.42	1.73	0.79
14220	1"	3/4"	1/2"	1.63	0.69	1.91	0.96	1.59	0.79
14230	1"	3/4"	3/4"	1.79	0.85	2.01	1.06	1.73	0.79
14240	1"	3/4"	1"	1.91	0.96	2.17	1.22	1.73	0.79
14250	1"	1"	1/2"	1.63	0.69	1.63	0.69	1.59	0.79
14260	1"	1"	3/4"	1.79	0.85	1.79	0.85	1.73	0.79
14270	1"	1"	1/4"	1.93	0.98	2.24	1.30	2.32	1.18
14290	1/4"	1/2"	1/4"	2.13	0.98	2.62	1.81	2.19	1.04
14300	1/4"	3/4"	1/2"	1.77	0.63	2.19	1.24	1.91	1.10
14310	1/4"	3/4"	3/4"	1.87	0.73	2.01	1.20	2.11	1.16
14320	1/4"	3/4"	1"	1.99	0.85	2.38	1.44	2.03	1.08
14330	1/4"	3/4"	1/4"	2.13	0.98	2.44	1.50	2.19	1.04
14340	1/4"	1"	1/2"	1.77	0.63	2.09	1.14	1.91	1.10
14350	1/4"	1"	3/4"	1.87	0.73	2.11	1.16	2.11	1.16
14360	1/4"	1"	1"	1.99	0.85	2.22	1.28	2.03	1.08
14365	1/4"	1"	1/4"	2.13	0.98	2.24	1.30	2.19	1.04
14370	1/4"	1/4"	1/2"	1.77	0.63	1.77	0.63	1.91	1.10
14380	1/4"	1/4"	3/4"	1.87	0.73	1.87	0.73	2.11	1.16
14390	1/4"	1/4"	1"	1.99	0.85	1.99	0.85	2.03	1.08
14395	1/2"	1/2"	1/2"	2.61	1.16	2.91	2.11	2.76	1.30
14410	1/2"	1"	3/4"	2.13	0.67	2.36	1.42	2.09	1.14
14420	1/2"	1"	1"	2.26	0.81	2.38	1.44	2.09	1.14
14430	1/2"	1"	1/2"	2.62	1.16	2.70	1.75	2.76	1.30
14435	1/2"	1/4"	1/2"	1.93	0.47	2.15	1.00	1.91	1.10
14440	1/2"	1/4"	3/4"	2.13	0.67	2.28	1.14	2.09	1.14
14450	1/2"	1/4"	1"	2.26	0.81	2.34	1.20	2.09	1.14
14460	1/2"	1/4"	1/4"	2.38	0.93	2.54	1.40	2.24	1.10
14465	1/2"	1/4"	1/2"	2.62	1.16	2.78	1.63	2.76	1.30

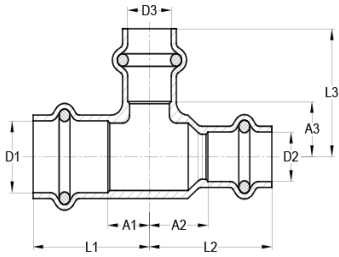

Item Number	D1 (in)	D2 (in)	D3 (in)	L1 (in)	L2 (in)	L3 (in)	A1 (in)	A2 (in)	A3 (in)
14500	1½"	1½"	¼"	2.38	0.93	2.38	0.93	2.24	1.10
14515	2"	1"	1"	2.66	1.04	2.62	1.67	2.44	1.50
14520	2"	1½"	1½"	2.66	1.04	2.89	1.75	2.60	1.46
14530	2"	1½"	¾"	2.42	0.81	2.85	1.40	2.40	1.46
14540	2"	1½"	1"	2.54	0.93	2.93	1.48	2.44	1.50
14550	2"	1½"	¼"	2.66	1.04	3.09	1.63	2.60	1.46
14560	2"	1½"	1½"	2.78	1.16	3.25	1.79	2.99	1.54
14570	2"	1½"	2"	2.99	1.38	3.43	1.97	3.15	1.54
14580	2"	2"	½"	2.42	0.81	2.42	0.81	2.52	1.71
14590	2"	2"	¾"	2.42	0.81	2.42	0.81	2.40	1.46
14600	2"	2"	1"	2.54	0.93	2.54	0.93	2.44	1.50
14610	2"	2"	¼"	2.66	1.04	2.66	1.04	2.60	1.46
14620	2"	2"	1½"	2.78	1.16	2.78	1.16	2.99	1.54