

FairyTek

LED Emergency Lighting Solution Expert

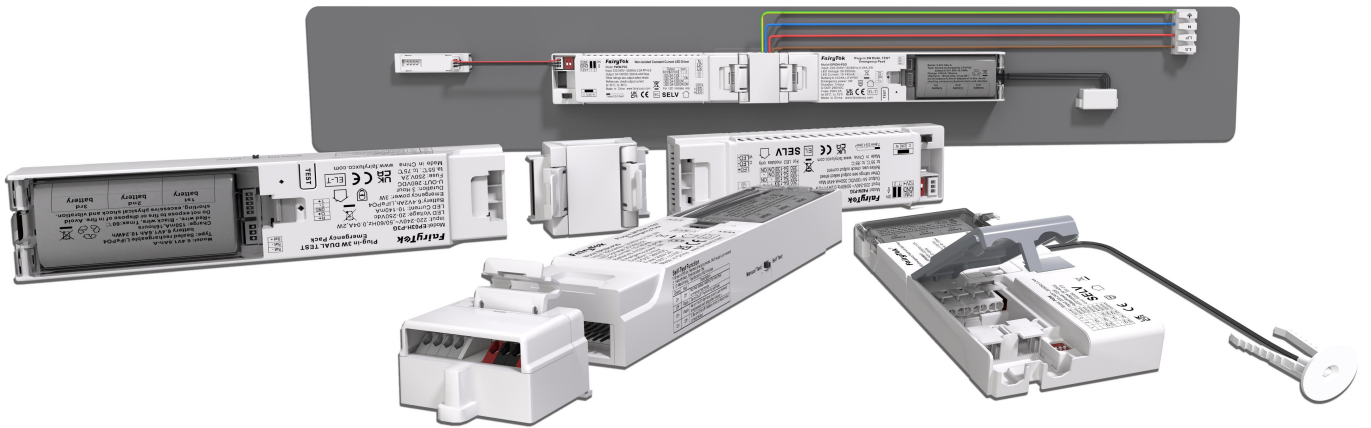

CABLE-FREE AND PLUG-IN DESIGN

LED EMERGENCY PACK AND DRIVER SERIES

Designed for Tri-proof, Batten, Linear and Panel Lights

**Modular Solution
For UK, EU and AU Markets**



Cable-free & Plug-in Quick-Connect LED Emergency Pack Series

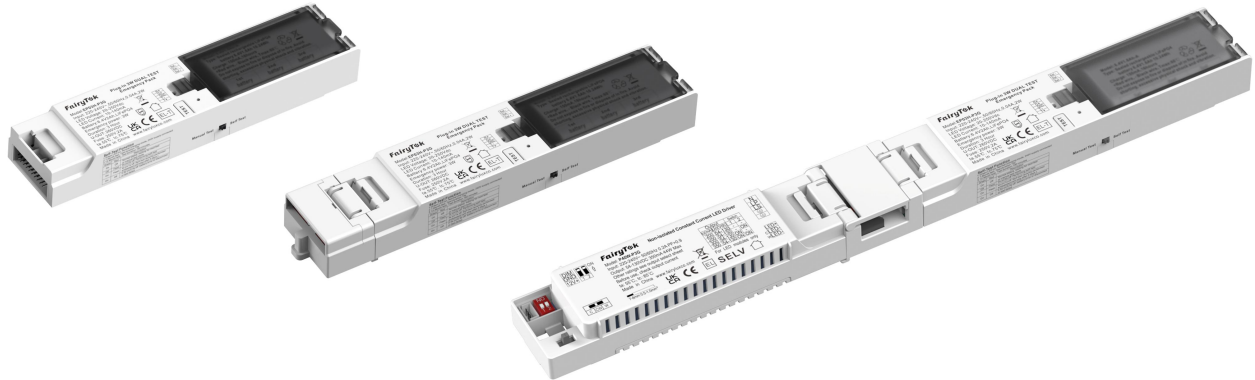

FairyTek manufactures LED emergency lights, emergency packs. We can provide OEM/ODM service and emergency lighting solutions for our customers. Our markets are Europe, the UK and Australia, since 2010.

Launched in 2022, our Cable-free & Plug-in Quick-Connect LED Emergency Pack--tool-free and easy to maintenance has seen strong adoption in Europe, strengthening our clients' competitiveness and market share.

The series includes three production-ready products, suitable for LED panel, tri-proof batten and linear, offered two solutions: one is for all ordinary LED drivers, like OSRAM, TRIDONIC and LIFUD drivers. Another solution is for customized plug-in drivers.

All products in this series share a unified interface and the same emergency module series, enabling greater product stability, easier product expansion and SKU simplification for clients.

Solution For All LED Ordinary Drivers

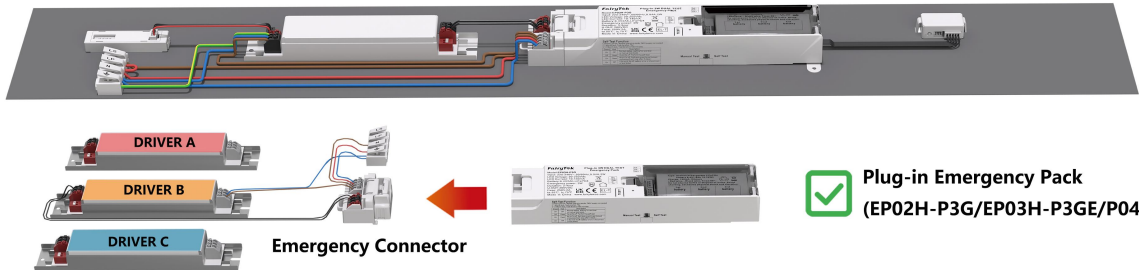

Solution For Plug-in Drivers

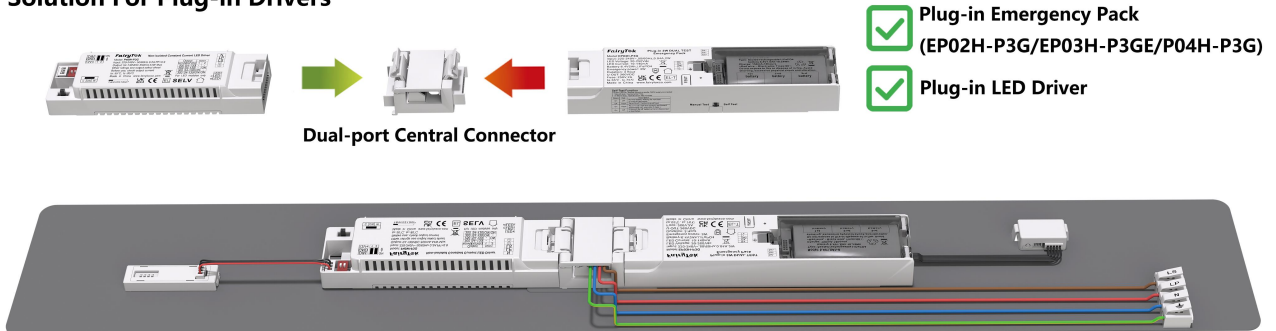

Save 50% Installation Time



Save 30% Costs



Save 80% Maintenance Time

SOLUTION FOR ALL LED DRIVERS



Technical data (EMERGENCY PACK)

Model	Input	EM. output	Duration	Battery
EP02H-P3G	220-240Vac	2W CP. 20-250V	180mins	LiFePO4 6.4v1.6Ah
EP03H-P3G	220-240Vac	3W CP. 20-250V	180mins	LiFePO4 6.4v2.0Ah
EP04H-P3G	220-240Vac	4W CP. 20-250V	120mins	LiFePO4 6.4v2.0Ah

For Tri-proof Lights

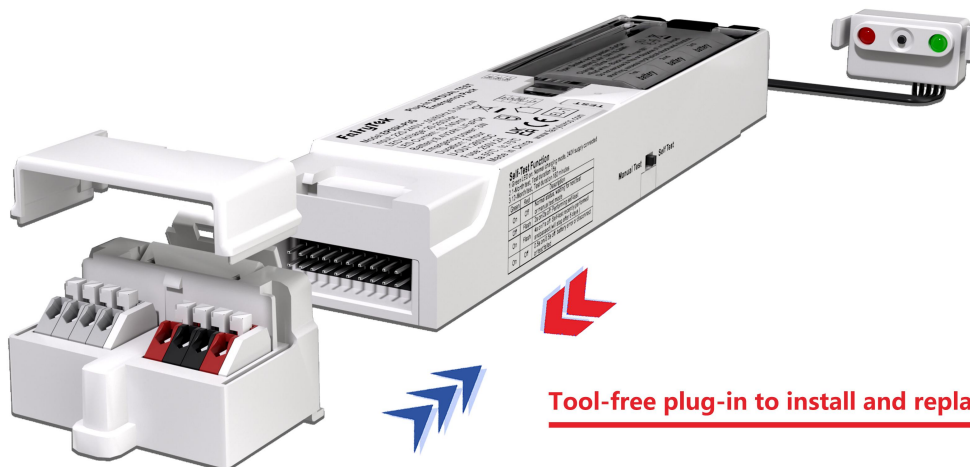

Tool-free plug-in to install and replace emergency pack

Suitable for all kinds of LED drivers

SOLUTION FOR PLUG-IN DRIVERS



Technical data (EMERGENCY PACK)

Model	Input	EM. output	Duration	Battery
EP02H-P3G	220-240Vac	2W CP. 20-250V	180mins	LiFePO4 6.4v1.6Ah
EP03H-P3G	220-240Vac	3W CP. 20-250V	180mins	LiFePO4 6.4v2.0Ah
EP04H-P3G	220-240Vac	4W CP. 20-250V	120mins	LiFePO4 6.4v2.0Ah

Technical data (LED DRIVER)

Model	Input	Rated Power	Output Voltage	Output Current	3CCT Switch
P40W-P3G	220-240Vac	40W	50-114Vdc	200/250/300/350mA	Yes

For Batten Lights

Tool-free Installation Solution on Gear Tray

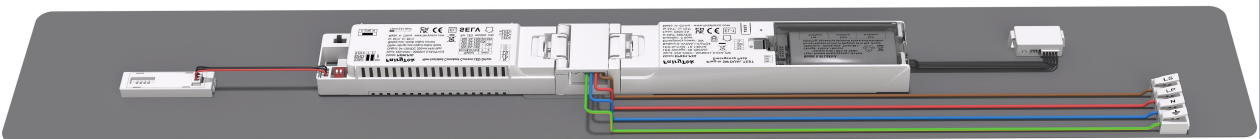
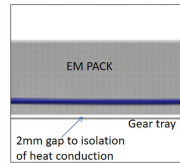
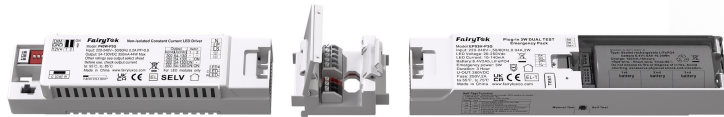
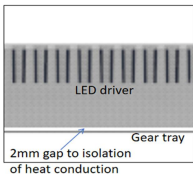

12V Auxiliary Power Supply

40W/20W, 3CCT
Adjustable Output Current

Support PWM Dimming (5-10V)



PLUG-IN EMERGENCY PACK FOR PANEL



Technical data (EMERGENCY PACK)

Model	Input	EM. output	Duration	Battery
EP02WI-P	220-240Vac	2W CP. 20-56V	180mins	LiFePO4 6.4v1.6Ah
EP03WI-P	220-240Vac	3W CP. 20-56V	180mins	LiFePO4 6.4v2.0Ah
EP04WI-P	220-240Vac	4W CP. 20-56V	120mins	LiFePO4 6.4v2.0Ah
EP05WI-P	220-240Vac	5W CP. 20-56V	90mins	LiFePO4 6.4v2.0Ah

Technical data (LED DRIVER)

Model	Input	Rated Power	Output Voltage	Output Current	3CCT Switch
P30W	220-240Vac	26W	30-40Vdc	300/360/420/460/500/530/580/650mA	Yes
P40W	220-240Vac	40w	30-40Vdc	600/700/750/800/830/900/950/1000mA	Yes

For Panel Lights

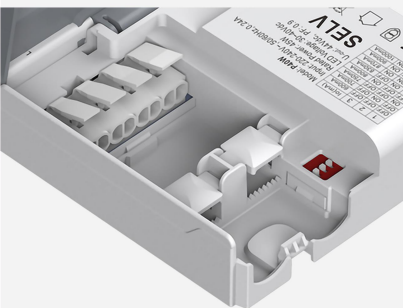

Big Size Loop-in & Loop-out Push Terminals

3CCT Switch

Output Current Select Switch



FairyTek

Dongguan Engine Electronics Co., Ltd

E-mail: Sky@fairyluxco.com

Wechat: 0086 18202881017

Tel: 0086 769 82255286

Fax: 0086 769 82255287

Factory base: Room 403, Building 1, Xiecao Road 792, Xiegang Town, Dongguan, Guangdong Province, China



Download Product List

www.fairyluxco.com