



2018 CATALOG



Adornus™
redefining expectations

redefining expectations



TABLE OF CONTENT

SAHARA	4
PRESTIGE	6
CAMDEN	8
LEXINGTON	10
ROCKPORT	12
TOSCANA	14
MADISON	16
BOARDWALK	18
HAMPTON	20
ASPEN	22
VENICE	24
NEWPORT	26
FAIRFIELD	28
GABLES	30

Over the past decade, we have pioneered the idea that beautiful living spaces and higher prices does not need to go hand in hand. And it is this idea that continues to make **Adornus** a leading manufacturer and distributor of elegant, yet affordable frameless kitchen cabinets and bathroom furniture. Over the past decade, we have been trusted by our clients for our ability to provide cost effective home solutions without compromising the quality of our products.

We are married to quality.

“Quality is not an act, it is a habit” – Aristotle

This unwavering commitment reaches across everything we do, from the materials we use to the products we sell and the service we provide. At **Adornus**, we believe attention to detail is vital, and it is the reason we utilize nothing less than the highest quality, all wood construction and materials in all of our world class kitchen and bathroom cabinetry. We challenge our customers to redefine their expectations of quality craftsmanship and service- that is the **Adornus challenge**.

Renderings in this catalog are for illustration purposes only

ASPEN

TOSCANA



CABINET CONSTRUCTION SPECIFICATIONS

Doors:

We use select grade **North American grown Alder** in our Camden, Lexington, Rockport, Toscana and Madison doors. Alder is attractive and durable, and shows a very uniform and beautiful pattern of grain. All the batches of raw materials carry the forest stewardship council mark. Alder is widely used and popular in the cabinet industry for making doors and it is an environmentally friendly cabinet wood because it is renewable and fast-growing. Sahara, Prestige, Hampton, Aspen, Boardwalk, Venice, Fairfield, Newport and Gables are made of **Solid Maple Wood**. Not only is it a handsome wood, but it offers durability and versatility as well. Maple is a timeless classic that has been used in a majority of kitchen remodels for years. It is versatile, durable and beautiful.

Carcasses:

Carcasses are made of **CARB Phase II** certified plywood with wood veneer. **There is no formaldehyde added in the process of making our plywood.** The carcasses are ¾” plywood on sides, bottom and top (wall cabinets), and reinforced with framed backing. Our cabinet boxes are the steadiest boxes you will find in the market.

Finish:

The Adornus Series doors are multi-step finished with two-part post-catalyzed conversion varnish. We use formaldehyde free, high performance finish conversion varnish that is hard, heat resistant, chemical resistant, and has exceptional non-yellowing characteristics. Conversion varnish is more durable and has a higher elasticity, which allows it to hold up better through wood joint expansion as compared to traditional lacquer. The carcasses are finished UV lacquer, which is durable, environmentally-friendly and free from formaldehyde and hazardous substances. This lacquer is not only safe but also kind to the environment at our production facilities. UV lacquer hardens when exposed to ultraviolet light. This makes the lacquer completely harmless and gives an attractive and robust finish that can tolerate even the roughest treatment.

Drawer box:

The drawer box for the Adornus Series is constructed of solid wood with a clear finish and are connected with tight dovetail joints. All drawers come with a 1/4” plywood bottom.

Shelving:

One full length Adjustable shelf comes with every 30” tall wall cabinets. Two shelves come with 36” tall wall cabinets and three come with 42” tall cabinets. Half length adjustable shelving comes with every base cabinet. Shelves are made of ¾” plywood and finished front and back.

Toe kick:

Every base cabinet comes with ¾” toe kick that is finished both ends. 96” x 4 ½” x 5mm toe kicks are available as well.

Slides:

Under mounted, full extension, soft closing slides are used in Lexington, Toscana, Madison, Hampton, Camden, Rockport, Aspen and Boardwalk. Side mounted full extension slides are used in Prestige and Sahara. Venice, Fairfield, Newport and Gables com with Blum® hardware.

Hinges:

6-way adjustable, concealed, 110 degree soft closing hinges are used in Lexington, Toscana, Madison, Hampton, Camden, Rockport, Aspen & Boardwalk. Venice, Fairfield, Newport and Gables come with Blum® hinges. Soft closing hinges are not available for special cabinets such as lazy susans and diagonal corner cabinets. Regular 6-way adjustable, concealed, 110 degree are used in Prestige and Sahara.



SPECIFICATIONS

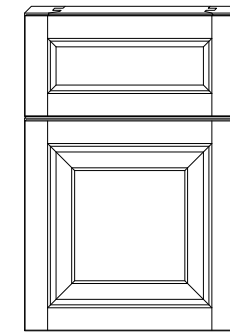

SAHARA

- Full Overlay Door Design
- 5 Piece Raised Panel Door and Drawer
- Front with Tongue and Groove Joint Stiles and Rails
- Door and Drawer Front Have 2 1/2" wide Stiles and Rails

PRICE LEVEL A



redefining expectations

SAHARA

PRODUCT OVERVIEW

- Refined & Classic
- Solid Maple
- Nutmeg Finish
- Soft Chocolate Glazed Finish accents on the exterior inner edges of the doors & drawer fronts
- 5 Piece Raised Panel Door/Drawers Tongue & Groove Construction
- Full Extension Drawers

"Sahara door will stand out in your kitchen with its exotic and delicate appeal that will bring life and joy to your kitchen."



SPECIFICATIONS

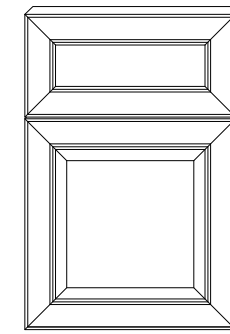

PRESTIGE

- Full Overlay Door Design
- 5 Piece Raised Panel Door with Finger Miter Joint Stile and Rail
- Door and Drawer Front Have 2 1/2" wide Stiles and Rails

PRICE LEVEL A



redefining expectations



PRESTIGE

PRODUCT OVERVIEW

- Simplicity Redefined
- Solid Maple
- Harvest Bronze Finish
- Soft glaze - finished Interior & Exterior
- 5 piece mitered solid wood raised panel door
- Full extension Drawers

"Prestige's harvest bronze finish gives the wood a versatile and expressive appearance. It's elegant simple lines add warmth to the kitchen of your dreams."



SPECIFICATIONS

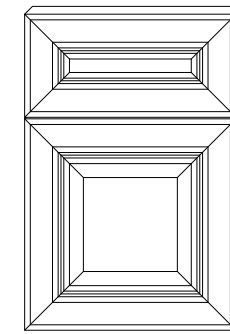

CAMDEN

- Full Overlay Door Design
- 5 Piece Raised Panel Door and Drawer Front with Finger Miter Joint Stile and Rail
Door and Drawer Fronts Have 3" wide Stiles and Rails

PRICE LEVEL B



redefining expectations



CAMDEN

PRODUCT OVERVIEW

- Traditional Elegance
- Solid **North American Alder Wood**
- Rich Walnut Finish Offering a Subtle Glaze/Finished Interior & Exterior
- Soft close Doors & Drawers with Full Extension Glides
- 5 Piece Mitered Solid Raised Panel Door/Drawers Construction

"The Beauty of Camden is within the soft, rich and smooth Alder wood with a traditional glazed finish."



SPECIFICATIONS

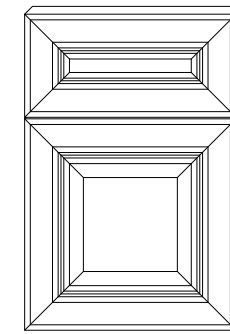

ROCKPORT

- Full Overlay Door Design
- 5 Piece Raised Panel Door and Drawer Front with Finger Miter Joint Stile and Rail
Door and Drawer Fronts Have 3" wide Stiles and Rails

PRICE LEVEL B



redefining expectations



ROCKPORT

PRODUCT OVERVIEW

- Simply Timeless
- Solid **North American Alder Wood**
- Cream Painted/Finished Interior & Exterior
- Soft close Doors & Drawers with Full Extension Glides
- 5 Piece Mitered Solid Raised Panel Door/Drawers Construction

"Our Rockport door is a timeless traditional cream raised panel. The finish is elegant with a bright warm classic feeling."



SPECIFICATIONS

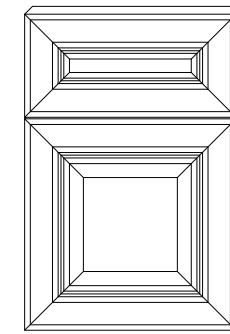

LEXINGTON

- Full Overlay Door Design
- 5 Piece Raised Panel Door and Drawer Front with Finger Miter Joint Stile and Rail
Door and Drawer Fronts Have 3" wide Stiles and Rails

PRICE LEVEL B



redefining expectations



LEXINGTON

PRODUCT OVERVIEW

- Timeless Classic
- Solid **North American Alder Wood**
- Rich Cherry Stain/Finished Interior & Exterior
- Soft close Doors & Drawers with Full Extension Glides
- 5 Piece Mitered Solid Raised Panel Door/Drawers Construction

"The Lexington is a casual but sophisticated style that will add a warm kitchen environment."



SPECIFICATIONS

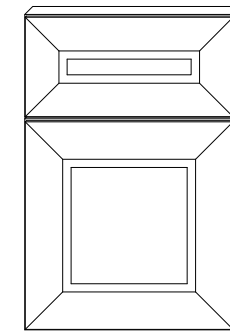

BOARDWALK

- Full Overlay Door Design
- 5 Piece Raised Panel with pillowed Door and Drawer Front with Finger Miter Joint Stile and Rail Door and Drawer Fronts Have 3" wide Stiles and Rails

PRICE LEVEL B



redefining expectations



BOARDWALK

PRODUCT OVERVIEW

- Contemporary Casual Elegance
- Solid **Maple Wood**
- Glazed Dark Walnut/Finished Interior & Exterior
- Soft Close Doors & Drawers with Full Extension Glides
- 5 Piece Mitered Soft Raised Panel with a Pillowed Edge Detail

"The Boardwalk offers a contemporary sleek kitchen with a unique pillowed door design that feels slightly traditional."



SPECIFICATIONS

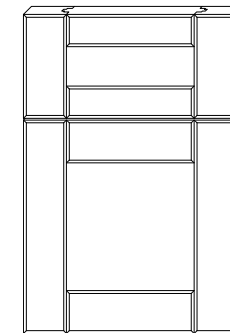

TOSCANA

- Full Overlay Door Design
- 5 Piece Shaker Door and Drawer Front with Tongue and Groove Joint Stiles and Rail
Door and Drawer Fronts Have 3" wide Stiles and Rails

PRICE LEVEL B



redefining expectations



TOSCANA

PRODUCT OVERVIEW

- Tuscan Shaker Treasure
- Solid **North American Alder Wood**
- Soft Cherry/Walnut Finished Interior & Exterior
- Contemporary & Traditional
- Soft Close Doors & Drawers with Full Extension Glides
- 5 piece Door/Drawers
Tongue & Groove Construction

"With simple elegance, too beautiful to resist, and color hues that will go with any decor, Toscana captures the true Tuscan feel."



SPECIFICATIONS

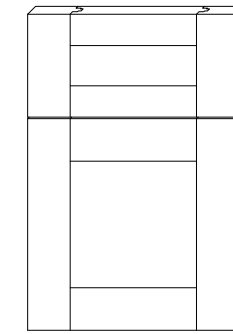

MADISON

- Full Overlay Door Design
- 5 Piece Shaker Door and Drawer Front with Tongue and Groove Joint Stiles and Rail
Door and Drawer Fronts Have 3" wide Stiles and Rails

PRICE LEVEL B



redefining expectations



MADISON

PRODUCT OVERVIEW

- Rich Contemporary Inspiration
- Solid **North American Alder Wood**
- Espresso Finish Exterior Natural Finish Interior
- Elegant & Timeless
- Soft Close Doors & Drawers with Full Extension Glides
- 5 piece Door/Drawers
Tongue & Groove Construction

"Madison's shaker style cabinet promises to capture the traditional to transitional designs within your home."



SPECIFICATIONS

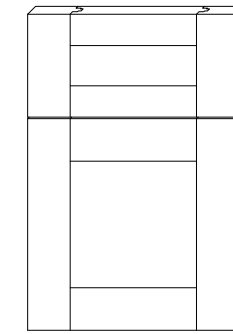

HAMPTON

- Full Overlay Door Design
- 5 Piece Shaker Door and Drawer Front with Tongue and Groove Joint Stiles and Rail
Door and Drawer Fronts Have 3" wide Stiles and Rails

PRICE LEVEL C



redefining expectations



HAMPTON

PRODUCT OVERVIEW

- Classic Beach House
- Solid **Maple Wood**
- White Painted Finished Interior & Exterior
- Elegant & Timeless
- Soft Close Doors & Drawers with Full Extension Glides
- 5 piece Door/Drawers
Tongue & Groove Construction

"Hampton's design is inspired by the contemporary beach house appeal. The white finish is truly timeless."



SPECIFICATIONS

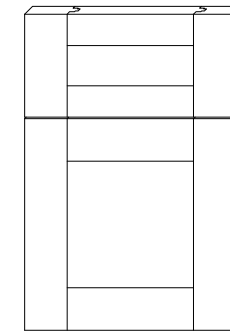

VENICE

- Full Overlay Door Design
- 5 Piece Shaker Door and Drawer Front with Tongue and Groove Joint Stiles and Rail
Door and Drawer Fronts Have 3" wide Stiles and Rails

PRICE LEVEL C



redefining expectations



VENICE

PRODUCT OVERVIEW

- Modern and Casual Style
- Solid **Maple Wood**
- Soft Painted Grey Finish
- Natural Interior and Matching Exterior Finishes
- Soft Close Doors & Drawers with Full Extension Glides
- 5 piece Door/Drawers
Tongue & Groove Construction

"The Venice is where modern meets classic. Traditional cabinets with a modern and sleek finish gives a sophisticated feel to any kitchen"



SPECIFICATIONS

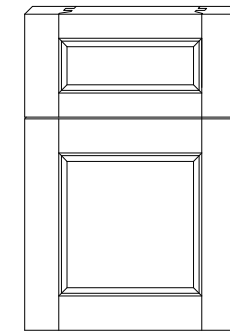

GABLES

- Full Overlay Door Design
- Overlay Door and Drawer Front with Tongue and Groove Joint Stiles and Rail
Door and Drawer Fronts Have 3" wide Stiles and Rails

PRICE LEVEL C



redefining expectations



GABLES

PRODUCT OVERVIEW

- Contemporary Casual Elegance
- Solid **Maple Wood**
- Soft Painted Smokey Grey Finished
- Natural Interior and Matching Exterior Finishes
- Soft Close Doors & Drawers with Full Extension Glides

"The Gables offers a smokey grey contemporary style with a touch of elegance."



SPECIFICATIONS

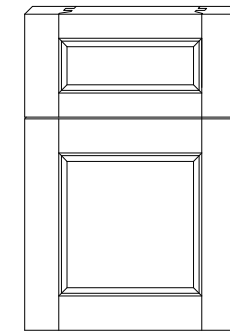

NEWPORT

- Full Overlay Door Design
- 5 Piece Shaker Door and Drawer Front with Tongue and Groove Joint Stiles and Rail
Door and Drawer Fronts Have 3" wide Stiles and Rails

PRICE LEVEL C



redefining expectations



NEWPORT

PRODUCT OVERVIEW

- Elegant Farmhouse Style
- Solid **Maple Wood**
- Soft Painted Grey Finished
- Natural Interior and Matching Exterior Finishes
- Soft Close Doors & Drawers with Full Extension Glides
- 5 Piece Mitered Soft Raised Panel with a Pillowed Edge Detail

"The Newport feature a flat panel door great for those looking for a contemporary feel, farmhouse style, or traditional look."



SPECIFICATIONS

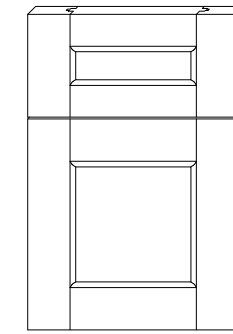

FAIRFIELD

- Full Overlay Door Design
- 5 Piece Raised Panel with pillowed Door and Drawer Front with Finger Miter Joint Stile and Rail Door and Drawer Fronts Have 3" wide Stiles and Rails

PRICE LEVEL C



redefining expectations



FAIRFIELD

PRODUCT OVERVIEW

- Elegant and Versatile
- Solid **Maple Wood**
- Soft Painted White Finished
- Natural Interior and Matching Exterior Finishes
- Soft Close Doors & Drawers with Full Extension Glides
- 5 Piece Mitered Soft Raised Panel with a Pillowed Edge Detail

"Casual shoreline house looks with modern lines makes The Fairfield one of our most versatile models"



SPECIFICATIONS

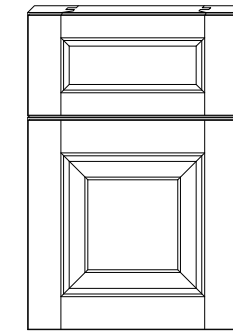

ASPEN

- Full Overlay Door Design
- 5 Piece Raised Panel Door and Drawer Front with Finger Miter Joint Stile and Rail
Door and Drawer Fronts Have 3" wide Stiles and Rails

PRICE LEVEL C



redefining expectations



ASPEN

PRODUCT OVERVIEW

- Perfection & Classic Elegance
- Solid **Maple Wood**
- Soft Painted Warm White/Finished Interior & Exterior
- Soft Close Doors & Drawers with Full Extension Glides
- 5 piece Door/Drawers
Tongue & Groove Construction

"Aspen is the most elegant traditional kitchen. This amazing solid maple raised panel door is a timeless classic that will add sophistication to anyones home."

Adornus™

redefining expectations



Northeast Region

2559 Route 130
Cranbury, NJ 08512
Tel: 201.577.5421
Fax: 732.453.1628

Southeast Region

3200 NW 112th Ave
Doral, Florida 33172
Tel: 305.629.4800
Fax: 305-503-8206

adornus.com