



## INTRODUCTION

Spring Ford Country Club enjoys a rich architectural history. When the course opened in 1924, it was a 9 hole layout designed by J. Franklin Meehan (North Hill, Sandy Run & Brookside in Allentown). What many might not know is that Meehan designed Pine Valley's first golf hole. And so, our roots grow deep.

In the mid-1950's the leadership of the club were well aware that all thriving golf courses were 18 hole layouts and in uncertain times they had the courage and wisdom to bring in William Gordon (Saucon Valley's Grace & Weyhill, Medford Village & Old York Road) to design our present 18 hole course. Prior to joining the Toomey & Flynn organization in 1923, Gordon had built courses for architects such as Donald Ross and Devereux Emmet. Spring Ford's leaders may have been more impressed by the fact that Gordon had been a central figure in the revisions at both Shinnecock Hills and The Country Club (Boston) carried out by the Toomey & Flynn company, both masterful updates of a prior architect's original vision.

The foresight of our Club's past leadership was demonstrated again in the late 1990's when Spring Ford engaged a virtually unknown individual that turned out to be one of our generation's greatest architects, Gil Hanse (Golf Magazine's 2009 Architect of the Year, Rio 2016 Olympics, and recent local restoration work at Merion East and Aronimink) to prepare our course's most recent Master Plan. Many of Hanse's recommendations were carried out, but unfortunately few of them were made under Hanse's direction and, as they lay upon our land today, few are true to his masterful vision.

Three decades have passed since the adoption of our last Master Plan and now the Club's stewards, still with a brilliant gem in hand, are faced with the reality of aging infrastructure and changing site conditions that threaten our gem's long term luster. Earlier this year the Board of Governor's authorized the formation of a committee, comprised of the Board, the Green's Committee, Golf and Tournaments' Committee, the Women's Golf Chair, Women's Tournament Chair, our Greens Superintendent, Head Pro and a few select members to assist in the development of a new Master Plan to provide a template of course improvements for at least the next fifteen years. The goal of that committee is to present a plan for ongoing restoration and enhancement work that is consistent with the rich and classic character of our golf course, to be implemented in accordance with a comprehensive and unified plan unaffected by hastened whims and variable means.

On the pages that follow you will see the vision of Tyler Rae, the golf course architect Spring Ford has engaged to assist in the development of our next Master Plan. Most of the modifications recommended in the Master Plan will improve playability for members of all ages and skill levels, enhance the natural beauty of our property and seize upon opportunities to present features in the style of Flynn's and Gordon's best work in a manner appropriate for our course.

Tyler is well trained in historic restoration. He began his career under the tutelage of Ron Prichard, a world renowned expert in Donald Ross restoration known for his passion for the purity of classic architecture and golf. While Tyler has deeply studied Ross' work, he has an excellent command of Meehan's, Flynn's and Gordon's work and style as well. While chronologically Tyler's ideas follow those of Meehan, Gordon and Hanse, in recent months Tyler literally is walking into the boardrooms of some of America's greatest golf courses as Gil walks out, each interviewing for the opportunity to prepare and present a Master Plan critical to the future of some of our nation's greatest courses. Given our Club's strong track record in architect selection, we are confident that you will agree that Tyler has laid out a masterful update for our gem.

Joe Sterchak  
*President, Spring Ford Country Club*

Mike Roynan  
*Greens Chairman, Spring Ford Country Club*

## ARCHITECTURAL HISTORY AND EVOLUTION

Spring Ford Country Club is blessed to have a wonderful mixture of two local Golf Architects work from different eras in golf. The result is nine J. Franklin Meehan golf holes dating back to 1925 and nine William F. Gordon holes that were seamlessly incorporated within the original routing between 1956 and 1957. The first nine holes ironically coincided directly within the middle of the Golden Age era of Golf Architecture in America, which began at the end of WWI and lasted until the onset of the Great Depression [1918 - 1930]. It was also a time in Meehan's personal career when he was beginning to make a transition into designing and building golf courses to attract more and more people to the popular game.

An early member of Pine Valley, Meehan was deeply connected in the Philadelphia golf scene and was a lifelong proponent of the Golf Association of Philadelphia's junior mentorship program. While golf encompassed most of his daily affairs, he somehow carved out enough time to become a regionally recognized Landscape Architect (designing estates, parks, highways and memorial sites) and also operate two of the nations leading tree and plant nurseries. Within this busy period in Meehan's life, he designed and built over 30 golf courses including Hillendale Golf Club in Maryland, a handful of courses in Florida and New York and other local courses such as Paxon Hollow Golf Club, Brookside Country Club (Allentown), North Hills Country Club, Sandy Run Country Club and Plymouth Country Club.



*November 24, 1924: The Morning Call Newspaper details the Clubs formation*



In the years between Spring Ford Country Clubs expansion to 18 holes, the Club weathered two Clubhouse fires, the Great Depression, WWII and a membership total that dwindled down to unsustainable numbers.



November 15, 1927: Original Clubhouse located next to current Hole #3 Tee burns down



1930's Historic Spring Ford CC Scorecard (Note: Par was 74!)



December 17, 1938: Original Course Architect J. Franklin Meehan Dies

While golf seemed to take a back seat in the 1930's and a mass planting effort was becoming en vogue at all Club's in America in the 40's and early 50's (as seen in the aerials below), it soon became apparent that life was returning to normal and nine more holes were thus needed. By 1955 nearly every local nine-hole golf course was making the leap; acquiring more land in order to fully stretch their links to regulation length.

Spring Ford's previous Golf Architect had passed away at the age of 69 in 1938 and thus they turned to another local Golf Architect, William F. Gordon of nearby Bethlehem, PA. William Gordon, who had his son David working by his side from 1952 - 1974 was a Golden Age relic and someone who's career spanned parts of seven decades. His resume includes building courses for Golf Architect's Willie Park Jr. and Devereux Emmet between 1916 - 1923, then crafting local gems such as Huntingdon Valley Country Club, Manufacturers Golf & Country Club and Philadelphia Cricket Club's Wissahickon Course while working for William S. Flynn from 1923 - 1941.

During that timeframe he was highly lauded by Flynn for having a heavy hand in the creation of Shinnecock Hills (NY), Indian Creek (FL), The Country Club at Brookline (MA), and Cherry Hills (CO). After his time in Flynn's firm, he went on to become one of the co-founders of the American Society of Golf Course Architects in 1946 and also helped build courses for Donald J. Ross and J.B. McGovern from 1941 - 1952. His trademarks were saucer shaped greens that look like potato chips that sloped back to front with sand flashed bunkers emulating the look that we see at other local Flynn courses.



1942 Historic Aerial (Note: the open vistas and country feel)





*1950 Historic Aerial (Note: the amount of new tree plantings)*



*1951 Historic Aerial (Note: original routing)*



*Spring 1958 Historic Aerial (Note: the new holes under construction)*

When William and David Gordon visited and laid out the new nine holes at Spring Ford Country Club in 1956, it's evident to see that they tried to honor and salvage as much of the J. Franklin Meehan layout as possible. This helped offset construction costs and also leave 8 or 9 holes open during the two-year course addition. The cost of the work was \$125,000.00 and this included new greens at holes #3, 7, 8, 10, 12, 13, 14, 15, 16, 17 and 18 and also some Clubhouse expansion work. The Meehan greens that survive to this day can be found at holes #1, 2, 4, 5, 6, 9 and 11 and their typical characteristic is steeper back to front with more basic, square shapes versus the rounded potato-shape or half-pipe feel to the Gordon greens.



POTTSTOWN MERCURY, POTTSTOWN, PA.

# Royersford-Spring City

HARLEY B. BRANDRETH, Rep.

Third Avenue and Main Street, Royersford Phone 158

## SPRING-FORD COUNTRY CLUB TO CELEBRATE RENOVATIONS

Spring-Ford Country club will celebrate the grand opening of its completely renovated golf and clubhouse facilities over the coming weekend.

Over a period of two years, \$125,000 has been expended to build a new 18-hole golf course, swimming pool, dining room and cocktail lounge.

The air-conditioned cocktail lounge and dining room can accommodate over 300 people at one time and afford a broad view through ten picture windows overlooking the golf course.

Friday night will be get-acquainted night for members and their guests. Saturday at 11 a. m., will be a women's golf tournament, featuring seven outstanding amateur women golfers from the Philadelphia area, who will play in foursomes with women from Spring-Ford.

golfers. The pros will compete in a best ball of the foursome tournament with three members of Spring-Ford. Matches will begin at 9:40 a. m., with Jack Robinson, pro at Spring-Ford, first off the tee.

The public was invited to watch the matches, also to inspect the improvements at the club throughout the weekend.

## Girl Scouts Plan Camping Session With Mothers

Final arrangements for a mother-daughter camp outing at Camp Kiwanis, Obelisk, this weekend will be made at a Royersford Girl Scout Neighborhood meeting tonight at 8 o'clock in First United Church of Christ.

LEARN TO DANCE  
AT  
SPRING-FORD  
COUNTRY CLUB

- Fox Trot
- Jitterbug
- Mamba
- Waltz
- Cha Cha
- Tango



You can get in on this fun and become a popular partner even if you have never danced before. Jeanne Maguire, formerly with Arthur Murray Studios, has turned out many hundreds of expert, polished dancers.

BEGINNERS' CLASS  
Starting January 3  
8:30 — 9:30

For Further Information  
Call Royersford 895

*December 20, 1960 Pottstown Mercury Newspaper*

With all of the positive changes going on at the Club during the late 1950's and early 1960's it was easy to see that the Club was set up for success for the long-term future. Fast forward sixty years and we still are enjoying the hybrid layout and original greens that were slowly crafted and altered during the Club's initial forty years. In the coming years leading up to the Club's Centennial Celebration in 2024, a goal of ours should be to honor the heritage of Spring Ford Country Club and work diligently to enhance your greatest asset, the golf course.

The historic aerials, photos and newspaper articles from our research have been a driving factor in our overall thinking and accompanying Restoration Master Plan. We will be referring to them often and hope you enjoy reading through the following pages of the 2020 Restoration Master Plan Hole-by-Hole Booklet.

*Respectfully submitted,*



*Tyler J. Rae  
Golf Architect*

*September 23, 1958 Pottstown Mercury Newspaper Article detailing the new addition of 9 holes by  
William F. Gordon*



1924



SFCC

# SPRING FORD COUNTRY CLUB

LONG RANGE MASTER PLAN

Tyler J. Rae ~ Golf Architect c. 2020  
William Gordon c. 1957  
J. Franklin Meehan c. 1924

NOVEMBER 18th, 2020

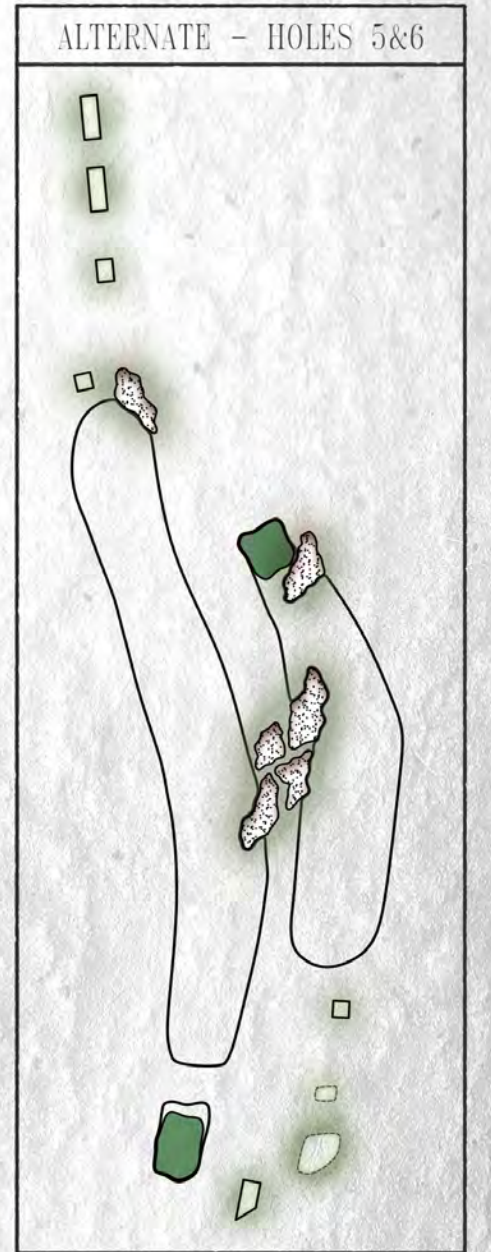

CARD

HOLE	PAR	GORDON	BLUE	WHITE	GOLD	RED	GREEN
1	4	449	454	436	394	373	266
2	4	449	432	392	359	319	317
3	4	388	276	334	312	310	248
4	3	162	148	133	118	95	91
5	5	523	507	480	437	391	386
6	4	336	326	305	276	275	234
7	3	230	204	185	155	150	116
8	4	428	381	319	287	270	266
9	5	534	515	500	439	436	433
OUT	26	3519	3334	3083	2777	2618	2457
10	4	428	372	333	324	273	271
11	4	350	325	316	302	279	275
12	4	389	376	356	297	293	255
13	4	387	345	332	295	279	243
14	3	202	163	154	145	137	102
15	5	558	500	489	434	409	405
16	3	241	214	194	175	114	108
17	4	433	399	383	324	285	278
18	5	527	496	430	395	362	358
IN	36	3514	3188	2988	2690	2431	2296
TOTAL	72	7033	6522	6071	5467	5030	4753

JR



## Hole #1

Par 4

### Centerlines Key:

Gordon:	469	Gordon:	N/A
Blue:	454	Blue Line:	250
White:	436	White Line:	225
Gold:	394	Gold Line:	200
Red:	373	Red Line:	175
Green:	366	Green Line:	150

- Rebuild, level, and align tees to achieve crisp, clean look. Construct new forward tees for Gold, Green and Red tees. The Gordon tee shown with a black dot (Championship tee) can be played off the edge of the existing upper putting green during future tournament venues.
- Remove pine trees between Holes #1 and #9 to improve the view from the clubhouse out onto the golf course.
- Widen fairway to provide larger landing area for not only a long Par 4, but also the first hole.
- Remove overly penal existing sand bunker and replace with a series of mounds to better separate Holes #1 and #9 and slow down balls before running into the creek.
- Combine and reshape existing fairway bunkers into one large Flynn/Gordon style bunker that creates a dramatic view from the tee and sets the tone for the round.
- Construct new greenside bunker that plays off of the new fairway bunker at "E". While the hole is straight, the diagonal bunkering will give the hole a serpentine movement and feel.
- Extend fairway out and to the right of the green to allow for ground approaches and more variety in recovery shots from around the putting surface.
- Recapture lost green square footage in back corners providing several new hole locations.

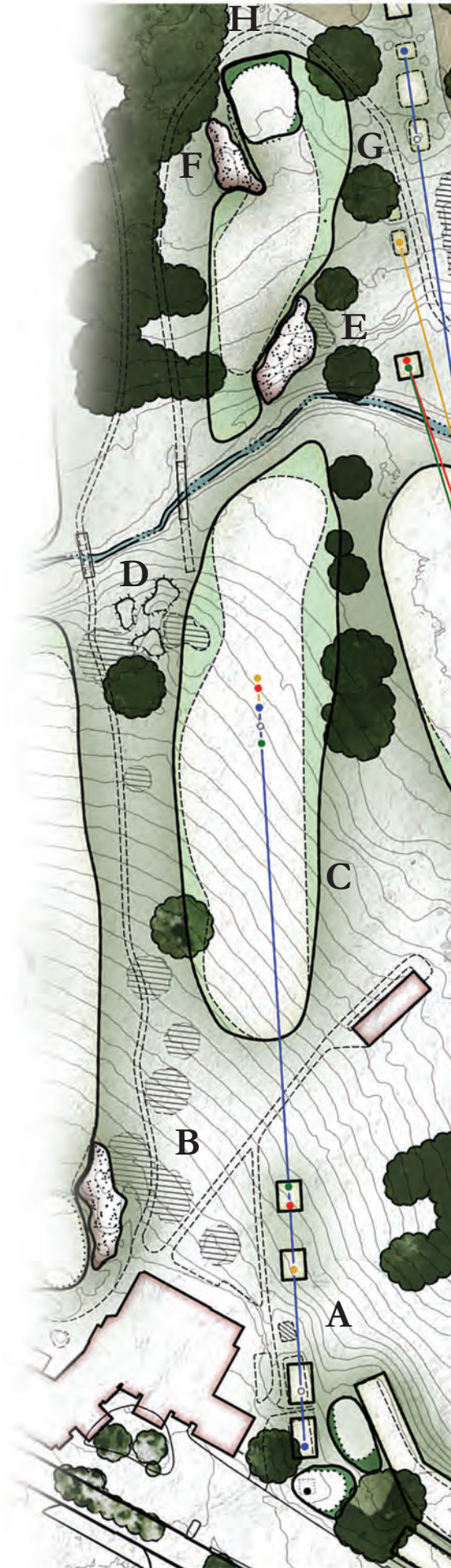

## Hole #2

Par 4

Gordon:	449
Blue:	422
White:	392
Gold:	359
Red:	319
Green:	317

- Construct new championship tee that can also be used to spread out wear and tear for the Blue tees on dryer days. Trim back trees down the left side of the teeing grounds to allow for aggressive tee shots over the new fairway bunkers.
- Construct new forward tee adjacent to the creek.
- Delete existing mounding and bunkering, shift cart path closer to the pond, and replace with two bunkers cut into the natural hillside. Regrade this area so surface water drains to the pond.
- Widen fairway for risk averse players trying to avoid the bunkers.
- Cut bunker short and right of the green to encourage players to try riskier lines off the tee to gain an advantage. Playing right off the tee will lead to a long, difficult shot over this new greenside bunker.
- Expand existing run off area to the left of the green.
- Expand green back to the edges of the fill pad creating dramatic hole locations that place a premium on strategy and shot making.

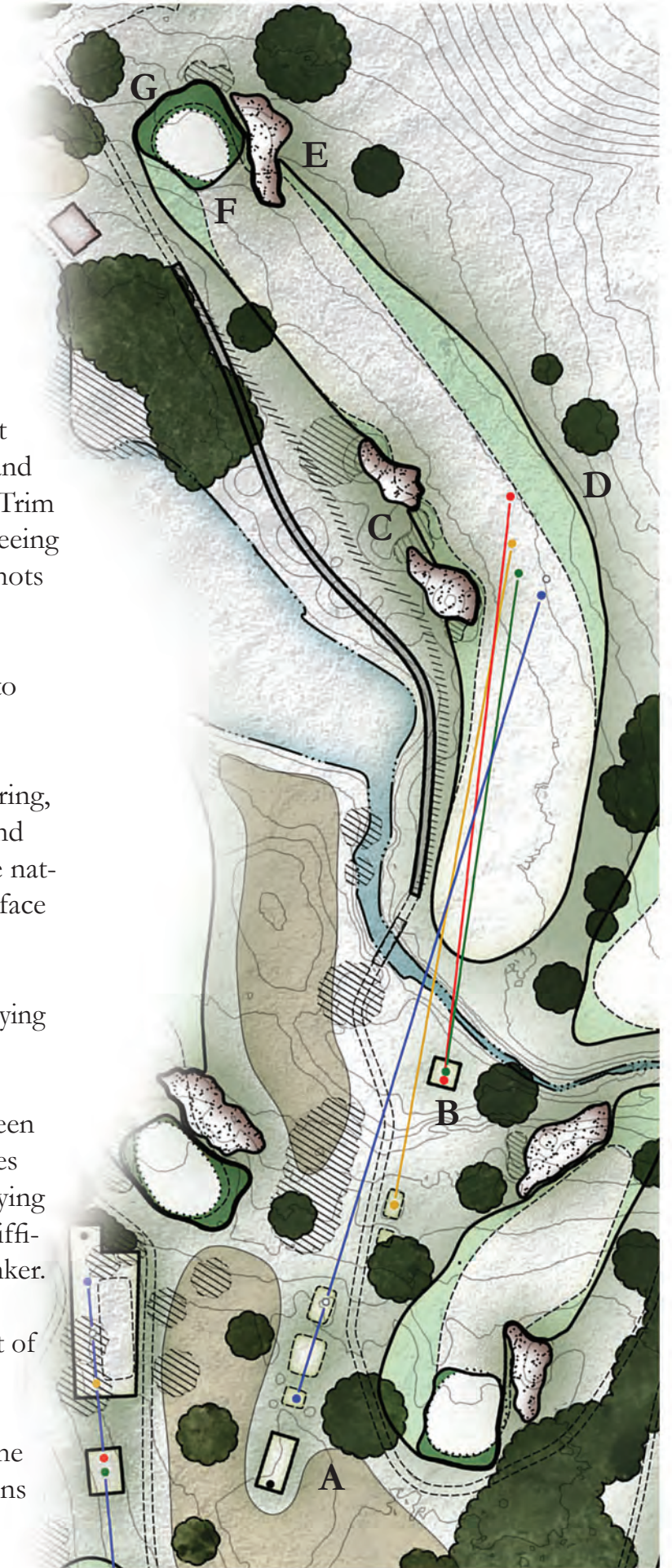



## Hole #3

Par 4

<b>Gordon:</b>	<b>388</b>
<b>Blue:</b>	<b>376</b>
<b>White:</b>	<b>334</b>
<b>Gold:</b>	<b>312</b>
<b>Red:</b>	<b>310</b>
<b>Green:</b>	<b>248</b>

- Expand and relevel back tee.
- Plant new native area in a largely out of play area to take burden off of maintenance staff.
- Construct new forward tee across the pond for players who prefer to avoid a forced carry.
- Trim back grove of trees to open up complete view of the widened fairway.
- Shift entire landing area left creating a dramatic tee shot that wraps around the pond to the left and is further challenged by new diagonal fairway bunkering in the Flynn/Gordon style. Remove necessary trees to expand fairway. Delete existing fairway bunker about 80 yards from the green. This fairway shift left will also help widen the corridor between Holes #3 and #5 and lessen the risk of errant tee shots from either hole ending up in opposing fairways.
- Delete existing right greenside bunker as it offers no strategic value. Construct new left greenside bunker on the same angle as the fairway bunkers creating an interesting visual from the tee as all of the bunkers will appear to be adjacent.
- Expand saddle-like green back and to the left offering new hole locations and providing strategic advantages for players who choose to challenge the fairway bunkers off the tee.



## Hole #4

Par 3

<b>Gordon:</b>	<b>162</b>
<b>Blue:</b>	<b>148</b>
<b>White:</b>	<b>133</b>
<b>Gold:</b>	<b>118</b>
<b>Red:</b>	<b>95</b>
<b>Green:</b>	<b>91</b>

- Remove several pine trees to help improve growing conditions for the tees. Plant new bushes/hedges to protect the back of #4 tee from errant shots from Hole #3.
- Largely expand back tee and construct new forward tee for shorter players. Shifting the centerline slightly right will reclaim the intended line of play for this green.
- Largely expand fairway and widen approach to allow for run-up shots. Clear all trees right of the hole for better visibility from Hole #5 tee.
- Construct new greenside bunkering scheme that will make the green feel much more elevated from the tee. Reconstruct back right bunker to match the new bunkering style.
- Recapture corners of the green that have shrunk over time. Flags in the back corners, while fair, will appear diabolical in nature.

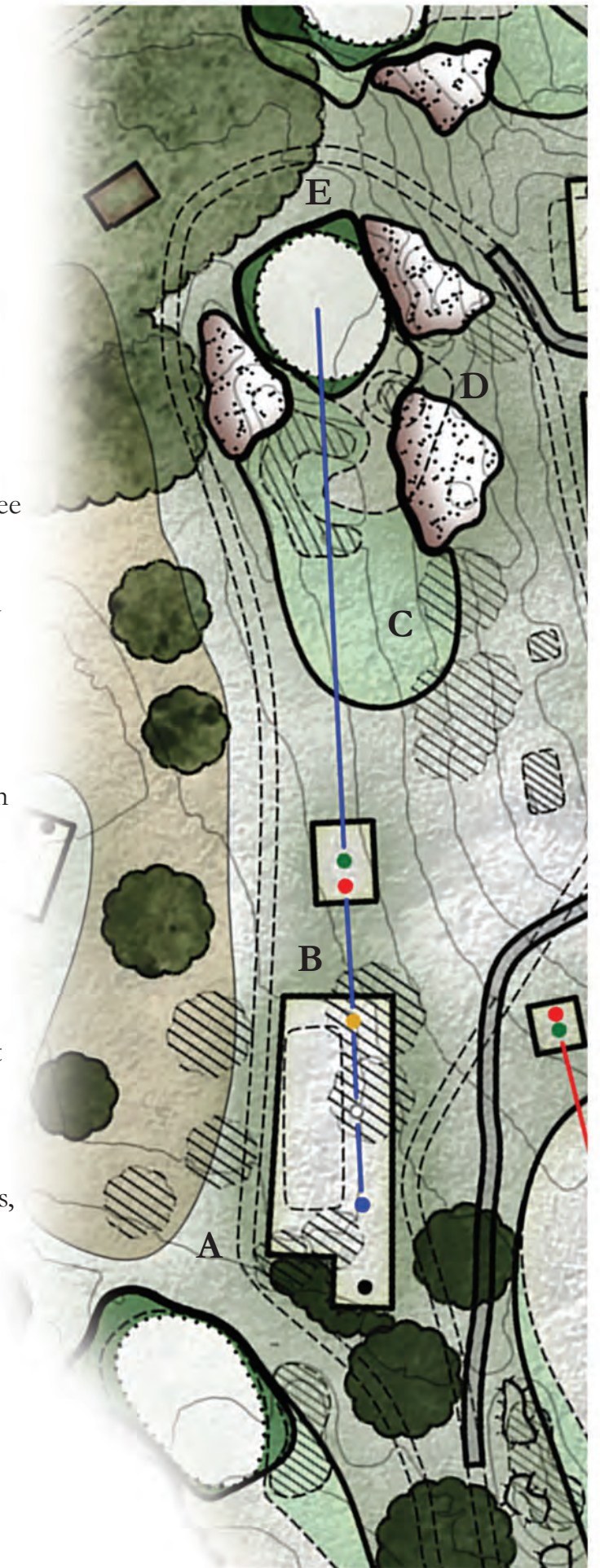



## Hole #5

Par 5

<b>Gordon:</b>	<b>523</b>
<b>Blue:</b>	<b>507</b>
<b>White:</b>	<b>480</b>
<b>Gold:</b>	<b>437</b>
<b>Red:</b>	<b>391</b>
<b>Green:</b>	<b>386</b>

- Construct new tee complex with aligned tee boxes for the Gordon through Gold tees. Construct new forward tee so shorter hitters do not have a forced carry.
- Swing cart path left of the teeing area to eliminate a dangerous situation between Holes #4 and #5.
- Create new native area in an out of play area for ease of maintenance.
- Construct a "Fore Bunker" creating an exciting tee shot for golfers showcasing the intended line of play (playing over the Fore Bunker will give the player the preferred angle down the fairway, playing to the right of the Fore Bunker means potentially bringing the right rough into play).
- Eliminate bunkering on the right side of the hole as it is largely blind from the tee. Replace with a low profile series of mounds to contain errant shots.
- Construct new fairway bunker in the second landing area to challenge layup shots. Widen fairway to the right and trim back treeline so golfers can go for the green in two from the right side of the fairway.
- Cut down struggling oak tree on the right just short of the creek.
- Delete greenside bunker short left of the green and regrade this area to drain naturally to the creek.
- Recapture lost green square footage bringing back the punchbowl effect of this back tier.



## Hole #6

Par 4

<b>Gordon:</b>	<b>336</b>
<b>Blue:</b>	<b>326</b>
<b>White:</b>	<b>305</b>
<b>Gold:</b>	<b>276</b>
<b>Red:</b>	<b>275</b>
<b>Green:</b>	<b>234</b>

- Construct new back tee for Gordon and Blue tees. Cut down the struggling tree at the tee to allow for the new angle.
- Consider moving walk bridge from left of tees to in line with teeing grounds to provide a nicer visual from the back tee and an easier walk from all tees.
- Construct new forward tee so golf hole plays the same for longer and shorter hitters alike.
- Remove dilapidated cart path in between Holes #5 and #6.
- Cut down competing pine trees to open up a beautiful vista looking out onto Hole #7. Plant native grasses in between the cart path on Holes #6 and #7 in an out of play area.
- Build new fairway bunker to prevent players from bailing right away from the trees on the inside of the dogleg. Eliminate existing fairway bunkers and expand fairway so it better reflects the landforms.
- Construct new greenside bunker creating strategy from the tee. Players who choose to go for the green from the tee will face challenging pitch shots if they lack accuracy.
- Recapture lost corners of the putting surface to bring back exciting pins.

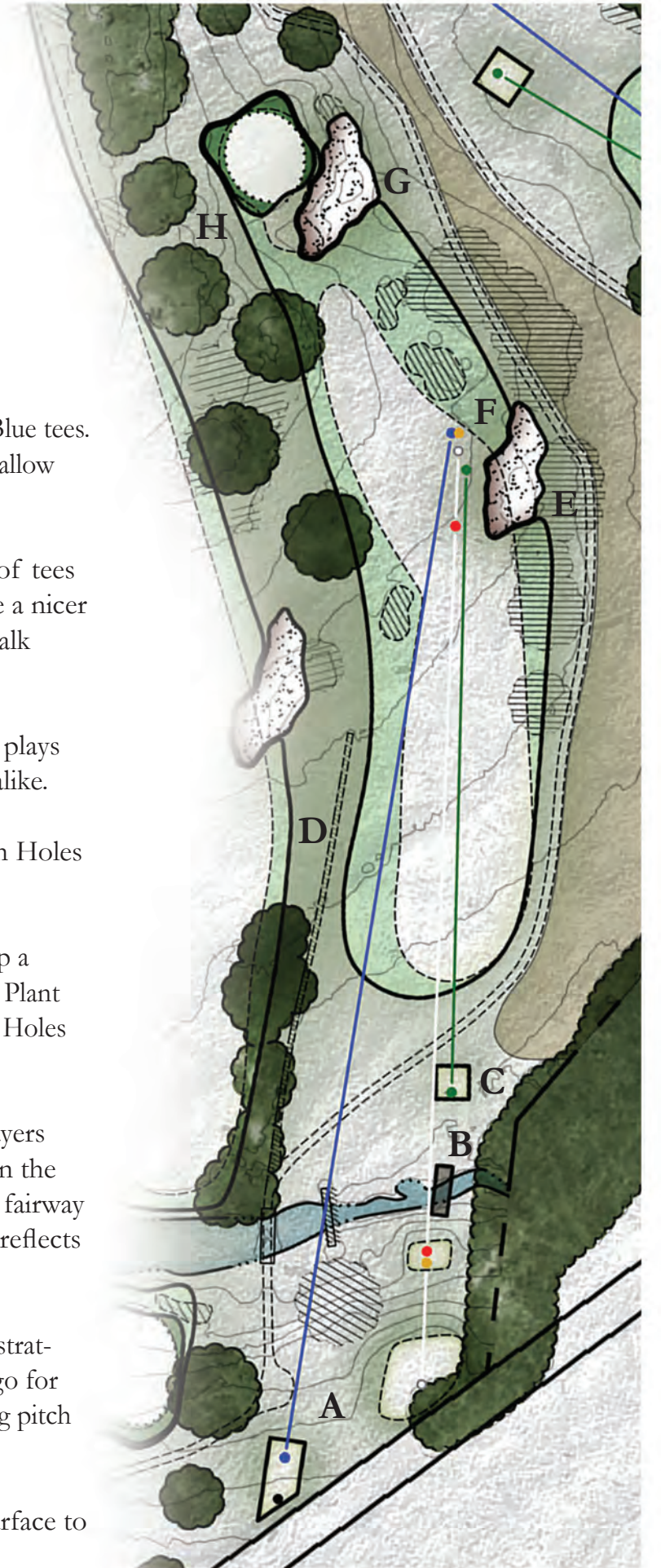



## Holes #5 & #6 Alternate

Par 4

Par 4

Gordon:	523	Gordon:	336
Blue:	507	Blue:	326
White:	480	White:	305
Gold:	437	Gold:	276
Red:	391	Red:	275
Green:	386	Green:	234

- A. Consider creating a dual bunker complex between Holes #5 and #6 paying homage to the original design that included a dual bunker on what were Holes #4 and #5 of the Meehan routing. While it honors the past, these bunkers would have the Flynn/Gordon feel that would add significant character to these holes and Spring Ford as a whole.



1950 Photo showing dual bunkers between what are now Holes #3 and #5.

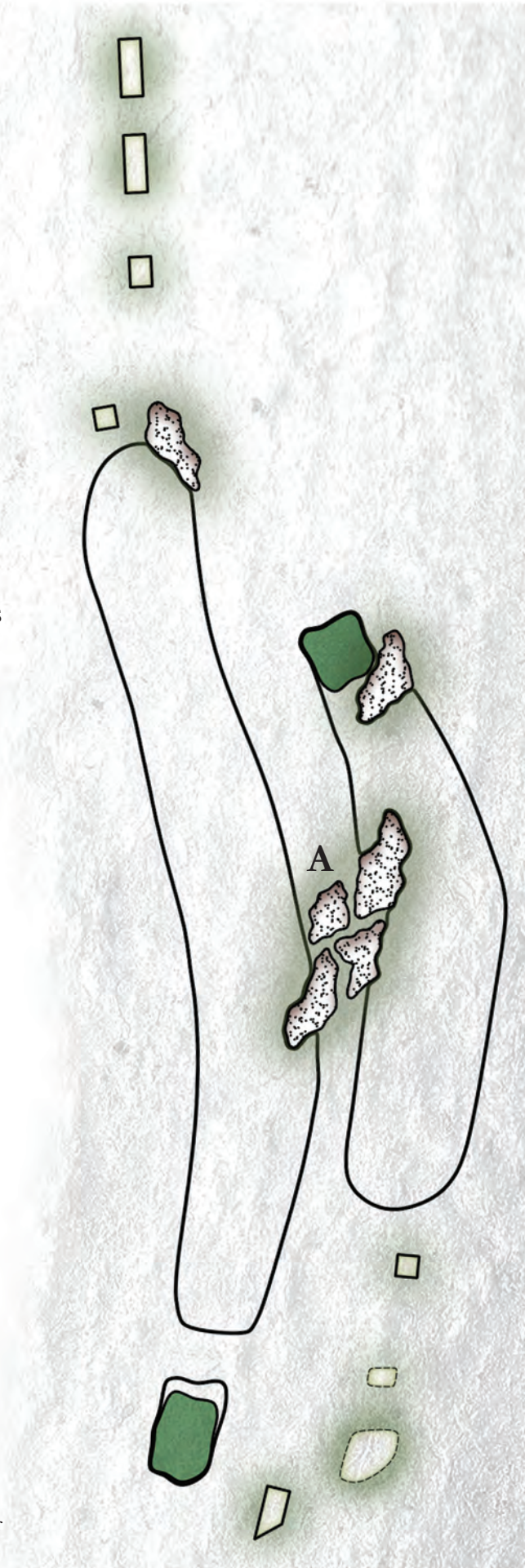

*NOTE: all trees, creeks, native grasses, etc. remain the same as are shown on Holes #5 and #6. They are just not shown here.*

## Hole #7

Par 3

Gordon:	230
Blue:	204
White:	185
Gold:	155
Red:	150
Green:	116

- A. Construct new Gordon and Forward tees. Cut down necessary trees to build new back tee. Rebuild, level, expand, and align all middle tees for classic look.
- B. Trim back treeline down the entire left side to help improve turf quality and allow for left to right shots off the tee.
- C. Extend fairway back towards the tees to allow shorter hitters to run the ball into the green.
- D. Construct new greenside bunkers to match the look, style and feel of the Flynn/Gordon bunkers throughout the course.
- E. Trim back treeline behind the green to improve turf quality so shots that sail long will settle in rough grass as opposed to the hardpan that exists now.

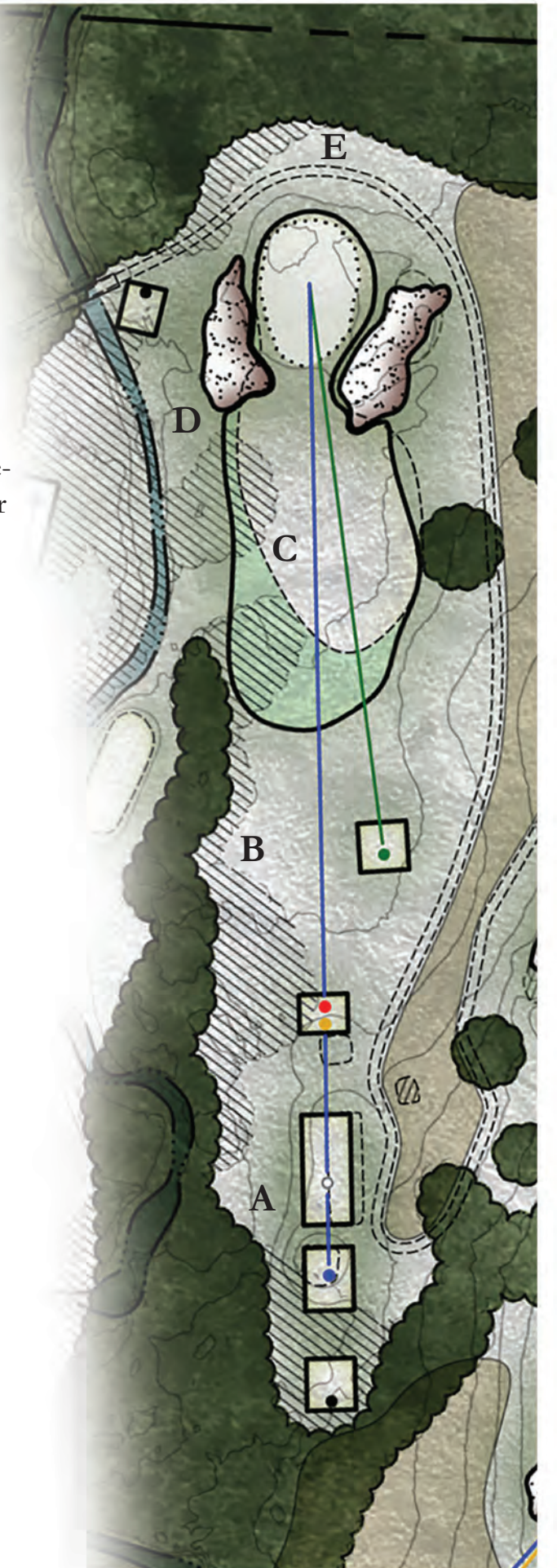



## Hole #8

Par 4

<b>Gordon:</b>	<b>428</b>
<b>Blue:</b>	<b>381</b>
<b>White:</b>	<b>319</b>
<b>Gold:</b>	<b>287</b>
<b>Red:</b>	<b>270</b>
<b>Green:</b>	<b>266</b>

- Clear the entire area between what is now Hole #8 tee and Hole #7 Green to expose the meandering creek and create a quaint setting at the low end of the property. Construct new back tees that highlight the creek and provide additional length.
- Construct new forward tees that are aligned away from the property line towards the new centerline of the widened fairway.
- Trim back the left treeline to expose the creek. Shift and widen fairway left to not only bring the creek on the left more into play but get play away from the property line on the right.
- Cut down two to three encroaching trees on the right that often block approach shots that reside in the fairway.
- Cut a new greenside bunker into the hillside.
- Expand green back and to the left into an already existing level area behind the new bunker. Create a kicker slope/bowl feature off the back of the new bunker to funnel balls into this new back left pin.

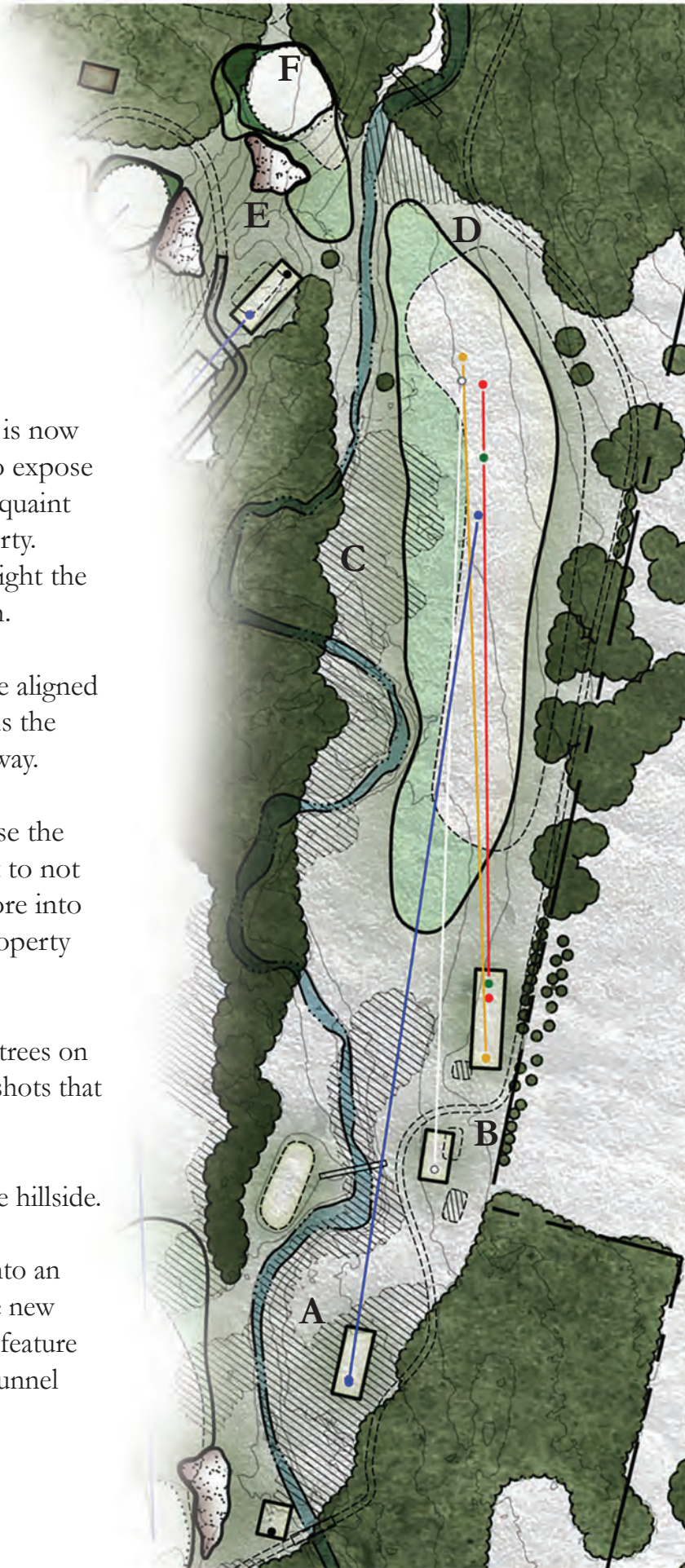

## Hole #9

Par 5

<b>Gordon:</b>	<b>534</b>
<b>Blue:</b>	<b>515</b>
<b>White:</b>	<b>500</b>
<b>Gold:</b>	<b>439</b>
<b>Red:</b>	<b>436</b>
<b>Green:</b>	<b>433</b>

- Create new combo tee for Holes #9 and #14 to maximize potential tee space and spread out wear and tear.
- Remove large spruce trees between Holes #9 and #18 and expand the native grasses in an out of play area to create a more natural, aesthetically pleasing separation between the two teeing grounds.
- Construct new forward tees providing various distance options for White, Gold, Red and Green tee players.
- Remove awkward pines to the right of the fairway and significantly expand the fairway.
- Remove unhealthy trees in this large grove between Holes #9 and #18 to highlight and improve the health of remaining specimen trees.
- Cut a new fairway bunker into the hillside challenging golfers' layups.
- Remove pine trees between Holes #1 and #9 to improve the view from the clubhouse out onto the golf course and increase turf quality of the approach on Hole #9.
- Reshape and expand existing greenside bunkers into one large Flynn/Gordon style sand bunker.
- Expand the existing run off area to the right of the green so errant shots remain in the chipping area instead of automatically running into the rough.

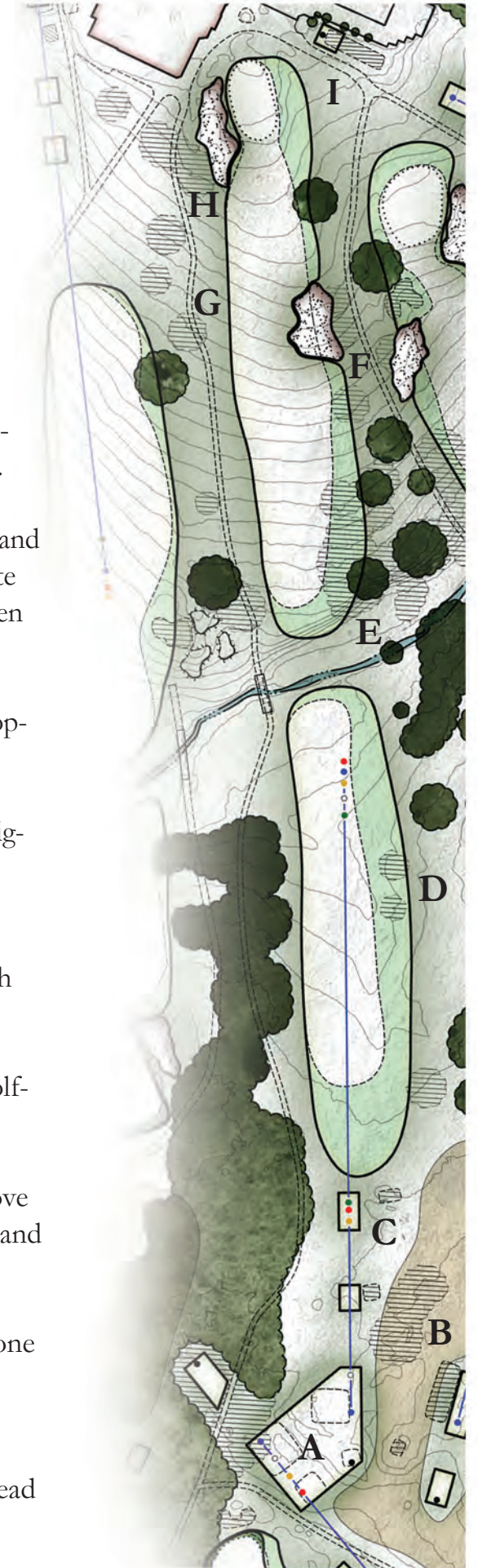



## Hole #10

Par 4

<b>Gordon:</b>	<b>428</b>
<b>Blue:</b>	<b>372</b>
<b>White:</b>	<b>333</b>
<b>Gold:</b>	<b>324</b>
<b>Red:</b>	<b>273</b>
<b>Green:</b>	<b>271</b>

- Shrink current men's tee to a smaller Gordon tee and create two large new teeing grounds for Blue, White and Gold tees so golfers are able to reach the green with two solid shots.
- Construct new forward tee so Green and Red tee golfers no longer have a long forced carry over the creek.
- Cut down unhealthy tree encroaching into the fairway blocking shots from the new forward tee from finding the right side of the fairway.
- Expand existing fairway bunker back towards the tee and reshape to match the Flynn/Gordon style and shape throughout.
- Remove encroaching tree that blocks shots from the new, widened fairway.
- Convert the front portion of the existing green into a false front at approach height as it is unpinable. Expand green back and to the right to create several more hole locations and add strategy to the hole in that tee shots want to favor the more risky left side of the fairway and challenge the Out of Bounds to gain a better angle to right flags. Build a new, Golden Age style wing bunker to contain errant shots and create a perched feel for the green.
- Introduce native area between Holes #10, #11 and #16. See Hole #11 for more.

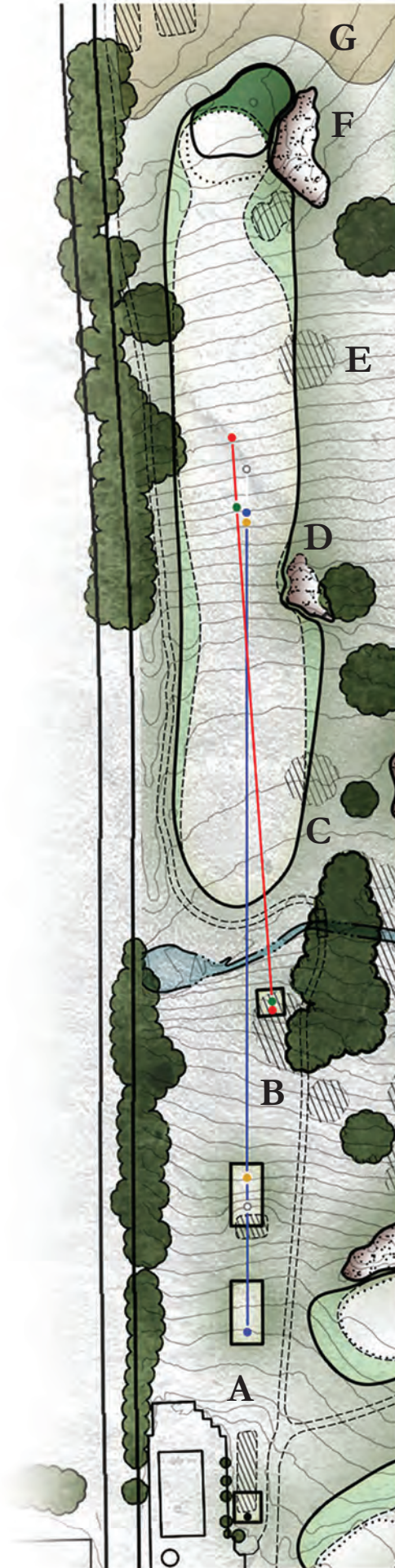

## Hole #11

Par 4

<b>Gordon:</b>	<b>350</b>
<b>Blue:</b>	<b>325</b>
<b>White:</b>	<b>316</b>
<b>Gold:</b>	<b>302</b>
<b>Red:</b>	<b>279</b>
<b>Green:</b>	<b>275</b>

- Rebuild, level, and align tees to achieve crisp, clean look. Construct new forward tees for Gold, Green and Red tees.
- Eliminate right teeing grounds as they align golfers towards Out of Bounds. Replace with native area separating Holes #10, #11, and #16, easing maintenance in this area, and creating a more natural look. Slightly shift cart path to the right and next to the native area to accommodate the new forward tees.
- Eliminate the trio of bunkers on the left and replace with one large bunker that is cut naturally into the hillside. This bunker will not only deter golfers from hitting towards the property line, but also provide a strategic decision from the tee.
- Remove grove of pines to expose healthier oak trees. Expand fairway out to the right to accommodate the new angle from the tee.
- Cut two bunkers below the surface of the green to perch the green high above the landing area and force golfers to challenge the fairway bunker off the tee to achieve a better angle to the flag.
- Expand green back and left to recapture interesting corners.
- Remove unnecessary cart path behind the green and replace with native grasses.

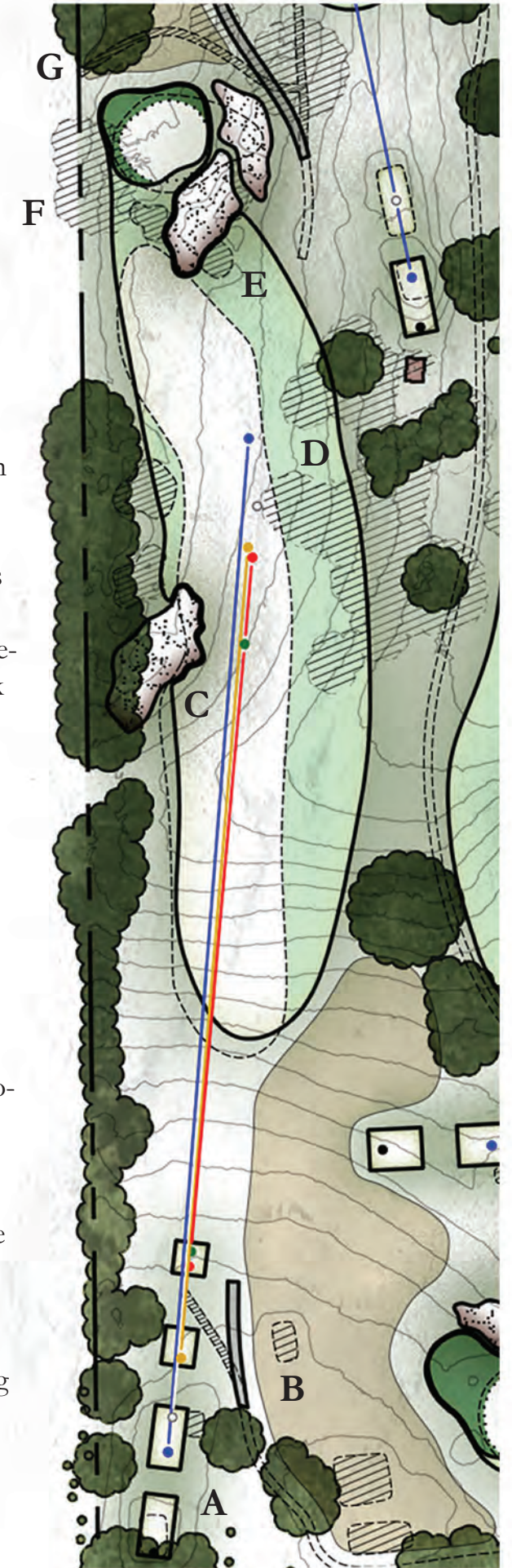



## Hole #12

Par 4

<b>Gordon:</b>	<b>389</b>
<b>Blue:</b>	<b>376</b>
<b>White:</b>	<b>356</b>
<b>Gold:</b>	<b>297</b>
<b>Red:</b>	<b>293</b>
<b>Green:</b>	<b>255</b>

- A. Rebuild, level, and expand back tee to spread out wear and tear.
- B. Remove encroaching unhealthy tree and swing cart path left and out of sight of the back tees.
- C. Extend fairway back and over the crest of the hill so the leading edge is visible from the White, Blue and Gordon tees, which serves to frame lines of play on a blind hole.
- D. Construct a new forward tee for Green tee players allowing them to see over the crest of the hill.
- E. Remove grove of pine trees right of the fairway and widen fairway in their absence to create a fairer blind landing area.
- F. Replace front bunker with short grass to create a "Valley of Sin" swale feature allowing for run up shots to an existing shallow green that cant away from the player.
- G. Recapture back corners of the green and add a tounge of putting surface to the front left of the green for new hole locations that play off the Valley of Sin.
- H. Add a "Saving Bunker" to the left side and back portions of the green to stop errant shots from ricocheting Out of Bounds.



## Hole #13

Par 4

<b>Gordon:</b>	<b>387</b>
<b>Blue:</b>	<b>345</b>
<b>White:</b>	<b>332</b>
<b>Gold:</b>	<b>295</b>
<b>Red:</b>	<b>279</b>
<b>Green:</b>	<b>243</b>

- A. There is the potential for an easement from the adjacent property to build a new Gordon tee. If possible, construct tee to add 40+ yards.
- B. Add screening to the property line to hide homes from view when on the tee.
- C. Consider moving the cart path right of the new tees to keep golfers away from the unsightly and congested current cart path turnaround area and improve the overall aesthetic.
- D. Construct all new tees to align them for a clean presentation. Also construct new Green tee for shorter players.
- E. Shift fairway right and away from the property line.
- F. Remove grove of unhealthy trees that block play to the right side of the green. Expand fairway right to the crest of the hill on the right to make a dramatic fairway edge.
- G. Remove encroaching trees that block the left side of the green from the left side of the landing area.
- H. Cut new greenside bunker into the left side of the green surrounds to place a premium on tee shot placement. Recapture all corners on the putting surface.
- I. Remove back greenside bunker as it is out of place at Spring Ford.

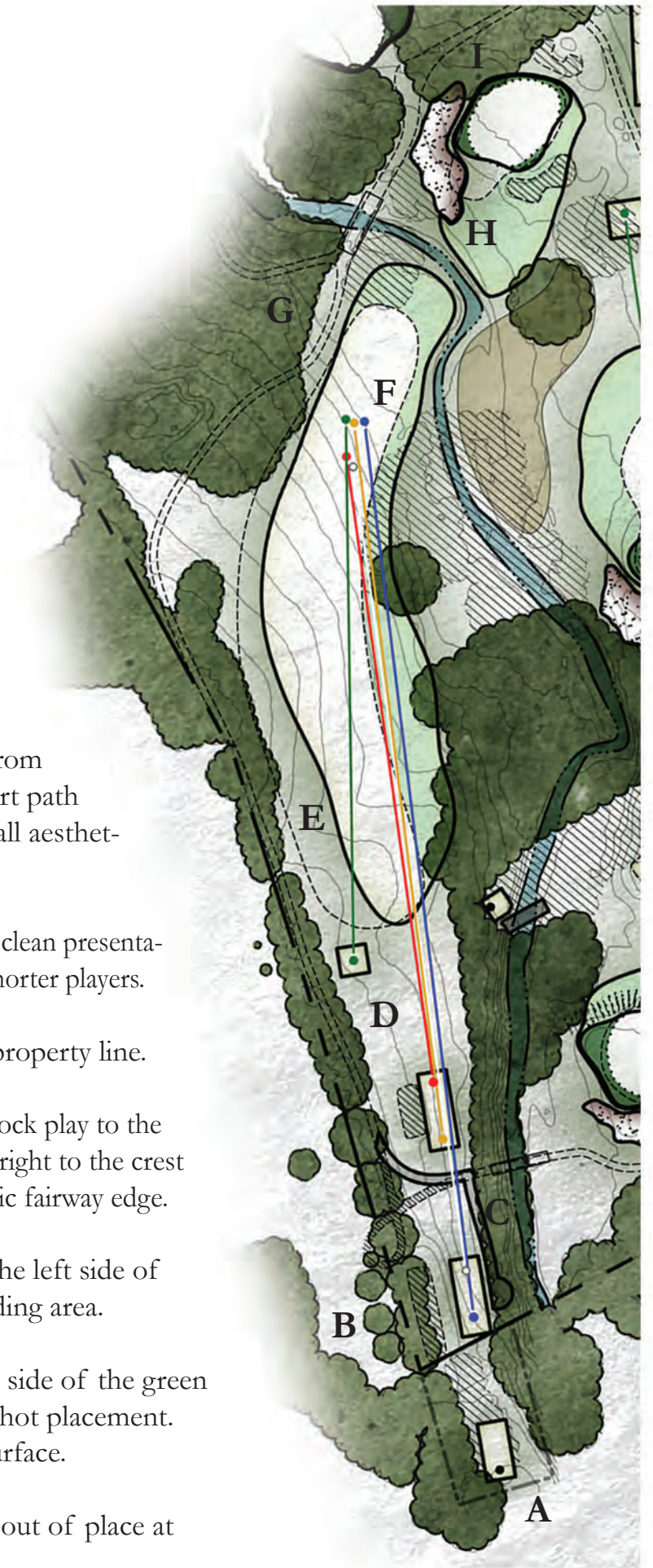



## Hole #14

Par 3

<b>Gordon:</b>	<b>202</b>
<b>Blue:</b>	<b>163</b>
<b>White:</b>	<b>154</b>
<b>Gold:</b>	<b>145</b>
<b>Red:</b>	<b>137</b>
<b>Green:</b>	<b>102</b>

- A. Construct new Gordon tee that can also be used by Blue tees in events. Clear trees necessary for construction.
- B. Create new combo tee for Holes #9 and #14 to maximize potential tee space and spread out wear and tear.
- C. Construct new forward tee for shorter hitters. Remove Maple tree necessary to construct tee.
- D. Reimagine greenside bunkering with two large Flynn/Gordon style bunkers that flank the green. Widen approach to allow for run up shots.
- E. Remove unhealthy trees left of the green as the cart path is impacting their health and they are affecting the green's overall turf quality.
- F. Expand green in front corners and back to the left to capture the level area that already exists and create interesting new flagstick locations for events.



## Hole #15

Par 5

<b>Gordon:</b>	<b>558</b>
<b>Blue:</b>	<b>500</b>
<b>White:</b>	<b>489</b>
<b>Gold:</b>	<b>434</b>
<b>Red:</b>	<b>409</b>
<b>Green:</b>	<b>405</b>

- A. There is an option to potentially construct a new Gordon tee just across the creek in an existing flat to not only add length, but also create an intimate setting for a tee shot. Add a walk bridge to access the tee. Clear trees necessary for this tee.
- B. Utilize existing tees for Blue, White and Gold tees. Construct new forward tee for Red and Green tee players.
- C. Remove pines left of the landing area and expand fairway in their absence. Expand fairway back towards the tee as well to make the leading edge visible from the tees (similar to Hole #12).
- D. Delete existing fairway bunkers and construct a new layup bunker on a diagonal that fits the Flynn/Gordon theme and turns the hole visually.
- E. Eliminate grove of pines left of the approach and expand existing native area to ease maintenance.
- F. Cut two diagonal bunkers into the hillside and swing the fairway to the right around them to create movement in an otherwise tight playing corridor. Players can choose to play over or around these bunkers for a fun strategic juxtaposition. Consider regrading this new approach to better accept shots with long irons and woods.
- G. Soften step grades and expand green in the back to create a green on a diagonal axis matching that of the new cross bunkers with exciting hole locations.

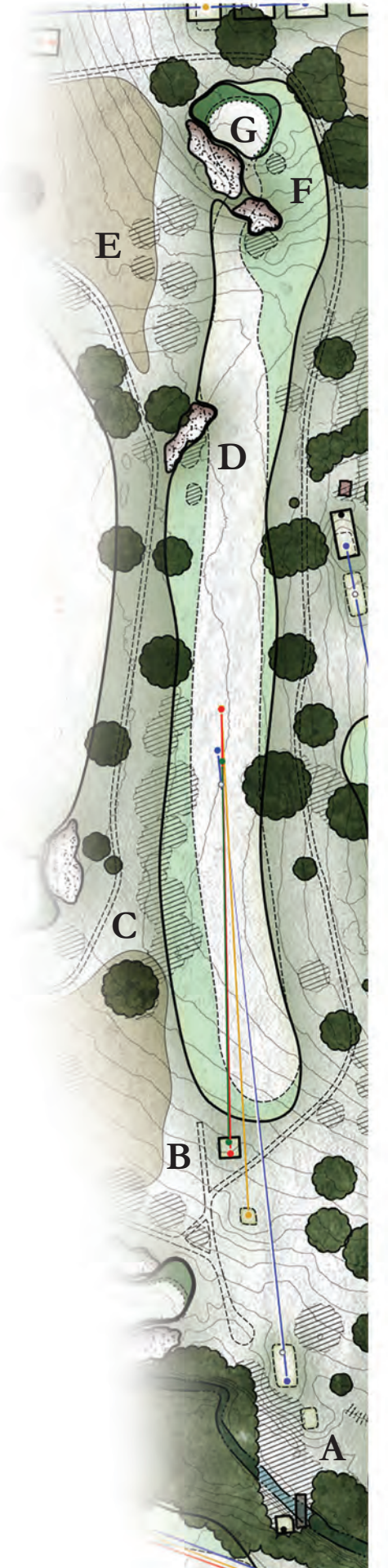



## Hole #16

Par 3

<b>Gordon:</b>	241
<b>Blue:</b>	214
<b>White:</b>	194
<b>Gold:</b>	175
<b>Red:</b>	114
<b>Green:</b>	108

- A. Construct a new Gordon tee and create native to separate Holes #10, #11 and #16 in an out of play area. Rebuild, level, align and expand existing tees to achieve crisp, clean look.
- B. Construct new forward tees for Green and Red tees as the hole currently plays too long for shorter hitters.
- C. Significantly widen approach to allow for run up shots and so that lower shots have a chance to hold the putting surface. Construct two new bunkers well below the green height to perch the green above the surrounding landscape and help save balls from bounding too far away from the putting surface.
- D. Recapture dramatic back left corner of the green and slightly expand the green on both sides to reflect the new greenside bunkering.

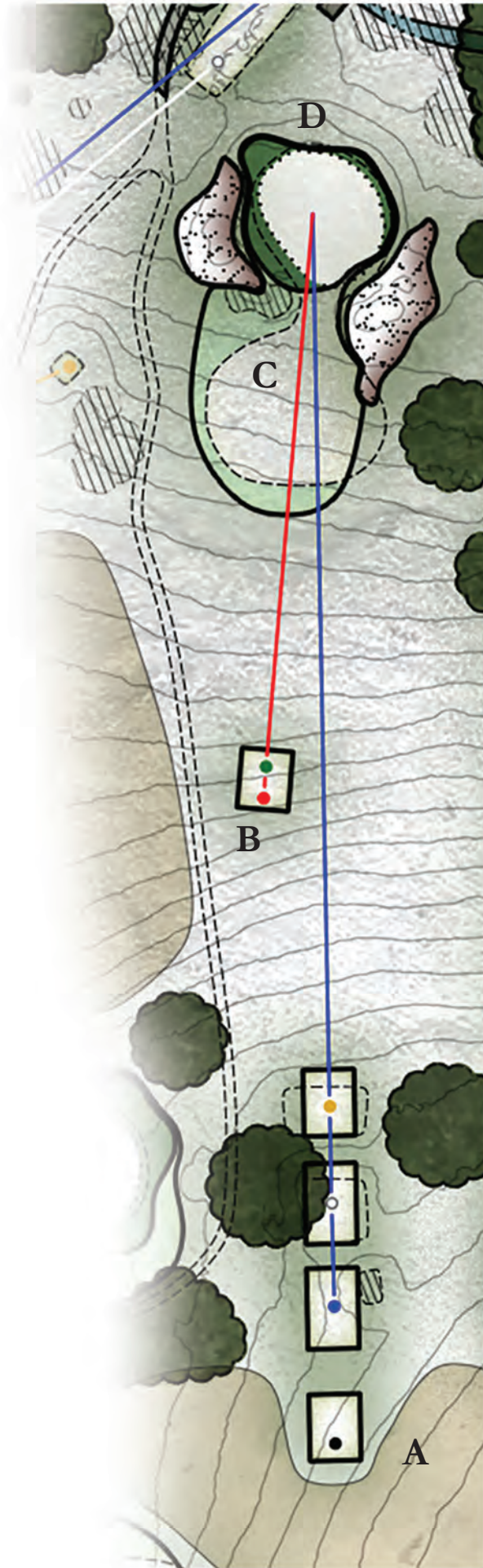

## Hole #17

Par 4

<b>Gordon:</b>	433
<b>Blue:</b>	399
<b>White:</b>	383
<b>Gold:</b>	324
<b>Red:</b>	285
<b>Green:</b>	278

- A. Bench a new Gordon tee into hillside on the other side of the creek. Add a walk bridge for access and remove trees necessary for turf health.
- B. Clear trees whose root systems have uprooted the cart path. Create new cart turnaround.
- C. Remove tree impairing Gold tee turf health.
- D. Construct a new forward tee so shorter hitters can more easily reach the green with two solid shots.
- E. Remove all pines in this grove of trees as they only serve to impair turf quality. Expand fairway in their absence to reward aggressive tee shots.
- F. Construct new greenside bunkers to match the Flynn/Gordon style throughout.
- G. Recapture beautiful back corners on the putting surface.
- H. Remove trees from behind green to confuse the depth perception of players in the fairway. The green will appear as an "Infinity Green" with these trees removed.

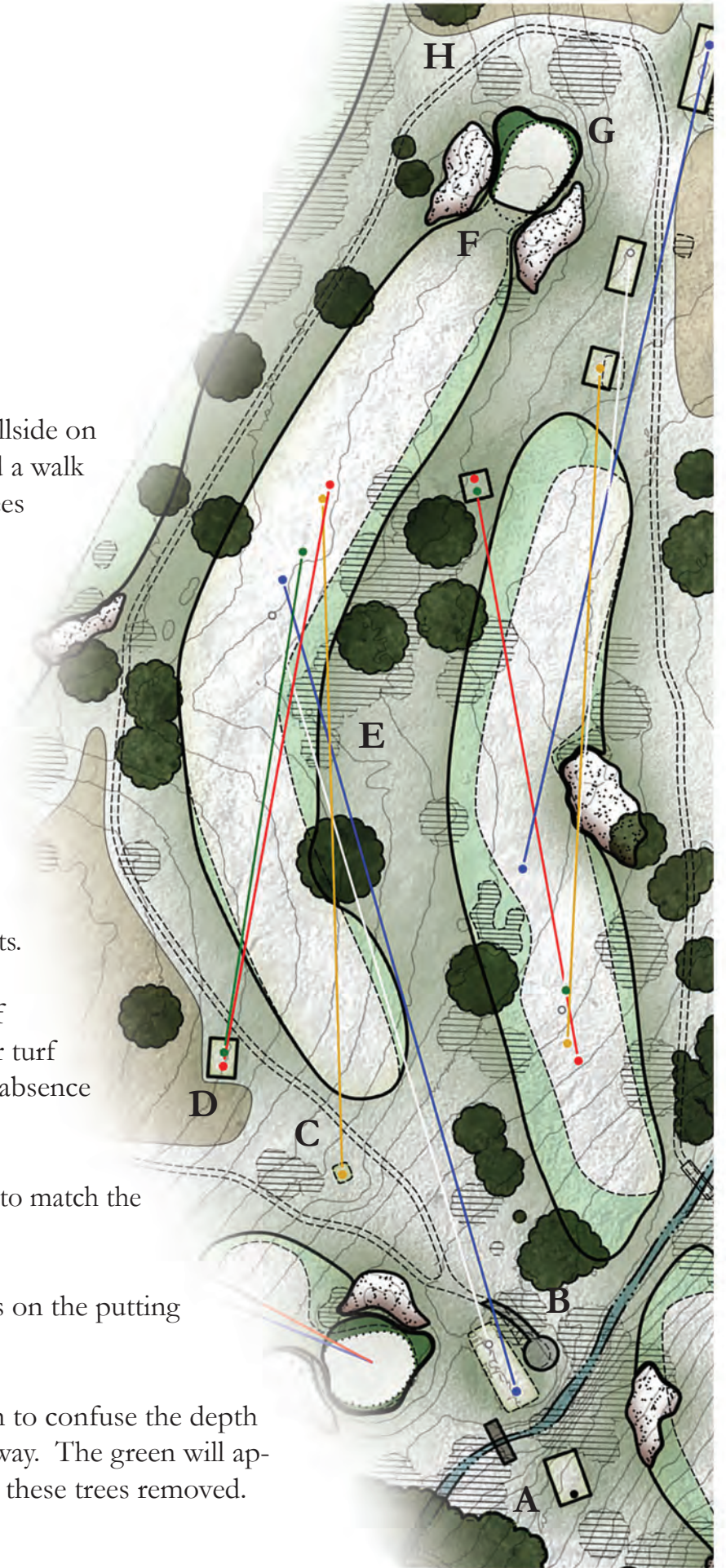



## Hole #18

Par 5

<b>Gordon:</b>	<b>527</b>
<b>Blue:</b>	<b>496</b>
<b>White:</b>	<b>430</b>
<b>Gold:</b>	<b>395</b>
<b>Red:</b>	<b>362</b>
<b>Green:</b>	<b>358</b>

- Construct new back tees for additional yardage and clean, classic feel. Eliminate all trees between Holes #9 and 18 teeing grounds and replace with native grasses for a more natural separation.
- Construct new forward tees to allow forward tee players to reach the green with three solid shots.
- Replace the two existing fairway bunkers with one bunker cut naturally into the hillside for players to challenge off the tee to gain a strategic advantage.
- Clear pines and unhealthy trees that encroach on the playing corridor and impair turf health. Expand fairway in their absence providing a wider landing area.
- Remove leaning trees on both sides of the second landing area that are becoming unsafe.
- In absence of the trees, cut two new bunkers into the hillside to challenge layup shots.
- Construct a new greenside bunker that fits the Flynn/Gordon scale and feel.
- Wrap fairway around the green to create a punch-bowl style backstop that will funnel balls back onto the putting surface. Any match that comes down to the closing hole will be much more exciting.

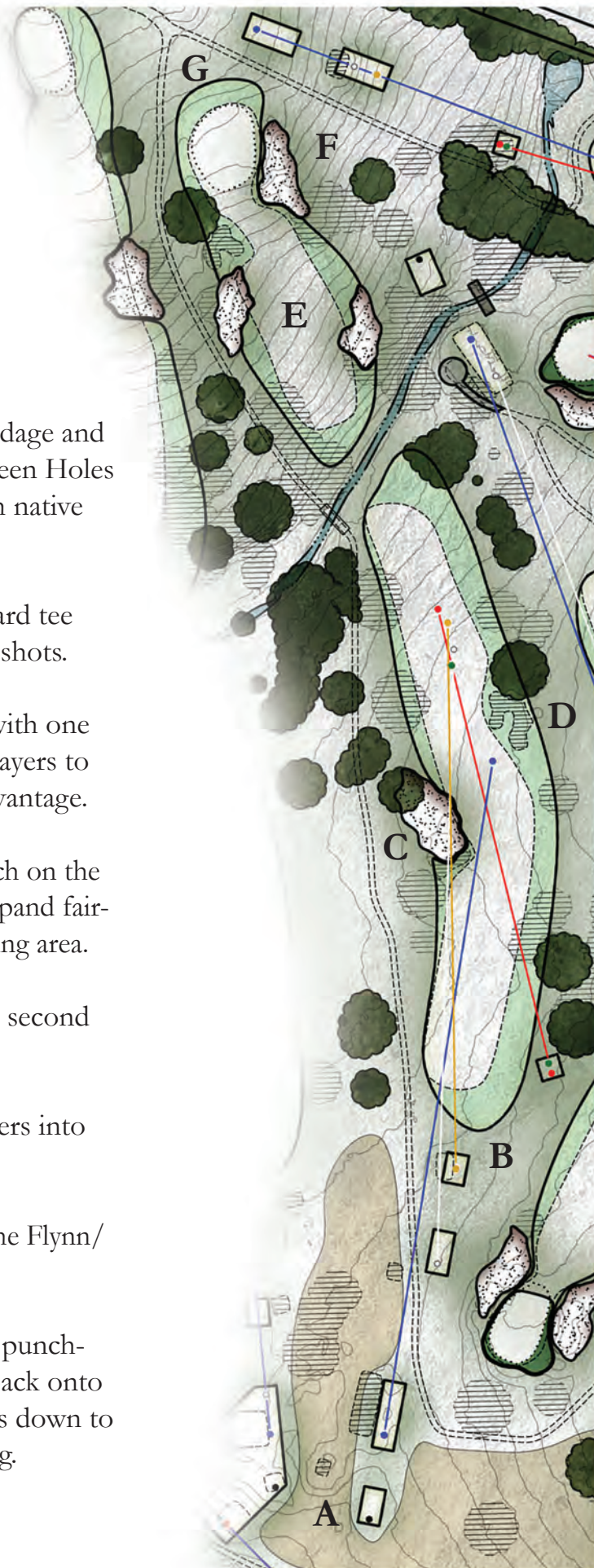

## DRIVING RANGE AND PUTTING GREENS

- Recapitulate lost practice green square footage on both putting greens.
- Rebuild, level, and expand range tees within their current footprint.
- Expand lower range tee to spread out wear and tear. Fill in largely unused practice sand bunker and expand range tee in its absence.





*Tyler J. Rae*  
*Golf Architect*  
*December 4th, 2020*