

2004 Penn St, Harrisburg, PA 17102

871 Square Feet

2004 Penn St, Harrisburg, PA 17102

Sold

: \$3,000 Sold on 08/29/23 Zestimate®: None **Help**

173-175 Lakeside Lane, Albrightsville PA 18210

Parcel# 1 : 21A-21-C418 (LOT#418)

Parcel # 2: 21A-21-C419 (LOT#419)

TAX ID #'s: 21A-21-C418 & 21A-21-C419

ANNUAL TAXES: \$200/LOT

ANNUAL HOA FEES: \$350 per Lot (Unimproved Land)

450 Feet to Placid Lake, Situated at the corner of Sunrise Lane and Lakeside Lane (Birch Road) inside of Holiday Poconos.

Lot Dimensions : 204 Ft Wide X 202 Ft Deep

Total Land Area: 41,208 Sq Ft

THIS IS RAW LAND - 1 ACRE between both parcels....NO PERC TESTING DONE, NO WELL, NO SEPTIC, NO ELECTRIC.....DOES NOT GET ANY CHEAPER THAN THIS. ALL DETAILS ON THIS LISTING. For a more interactive illustration of the parcel you can visit Carbon County Website & utilize the county GIS Parcel Viewer Tool to see exactly what the lot entails, reference the parcel number listed above. Selling the land without plans or permits, it will be up to the buyer to obtain the proper plans and permits for building. Holiday Pocono has a fabulous HOA, ton's of amenities, Lake access, playgrounds, basketball courts, all year round recreation. An excellent getaway. Ton's of beautiful homes in this development. Close to Towamensing Trails, Jim Thorpe, & a number of other POCONO area attractions. I will not be there to show the lot to you.

Settlement will be held in Jim Thorpe at the Carbon County Recorder of Deeds Office. I will prepare all paperwork for closing at no additional cost. Transfer and closing costs will be roughly \$6-700.

Asking Price: \$16,000





Arbus, Maxar Technologies, PA Department of Conservation and Natural Resources-PAMAP/USGS, USDA/FPAC/GEO

19-21 Foxhaven Rd, Albrightsville PA 18210

(2 Lots - 1 Acre in Total Area)

Parcel# 1 : 21A-21-C513 (LOT#513)

Parcel # 2: 21A-21-C514 (LOT#514)

Lot Dimensions : 244 Ft Wide X 183 Ft

Total Land Area: 44,652 Sq Ft



800 Feet to Placid Lake, Situated right next to 17 Foxhaven Rd inside of Holiday Poconos. LAND - 1 ACRE between both parcels....NO PERC TESTING DONE, NO WELL, NO SEPTIC, NO ELECTRIC.....DOES NOT GET ANY CHEAPER THAN THIS. ALL DETAILS ON THIS LISTING. For a more interactive illustration of the parcel you can visit Carbon County Website & utilize the county GIS Parcel Viewer Tool to see exactly what the lot entails, reference the parcel number listed above. Selling the

land without plans or permits, it will be up to the buyer to obtain the proper plans and permits for building. Holiday Pocono has a fabulous HOA, ton's of amenities, Lake access, playgrounds, basketball courts, rifle range, all year-round recreation. An excellent getaway. Ton's of beautiful homes in this development. Close to Towamensing Trails, Jim Thorpe, & a number of other POCONO area attractions. I will not be there to show the lot to you. Settlement will be held in Jim Thorpe at the Carbon County Recorder of Deeds Office. I will prepare all paperwork for closing at no additional cost. Transfer and closing costs will be roughly \$2-300. Asking Price: \$8,000 for BOTH LOTS.

308 Foothill Rd, Albrightsville, PA 18210



irbus, Maxar Technologies, PA Department of Conservation and Natural Resources-PAMAP/USGS, USDA/FPAC/GEO

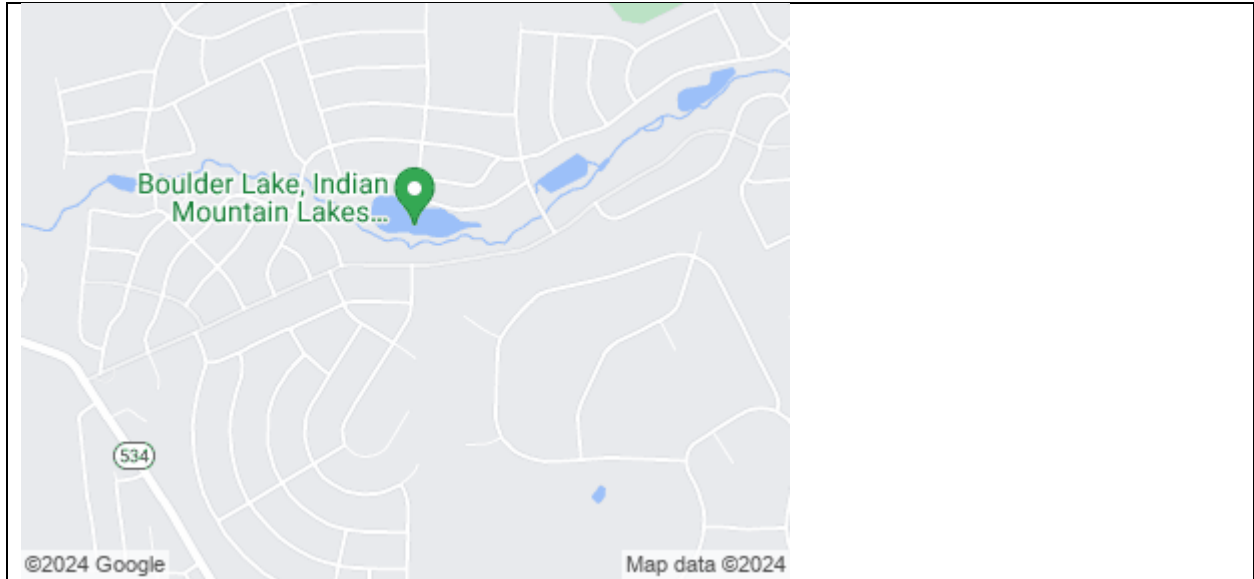

Details

Facts and Features

Lot

19,404 sq feet

Type

Vacant Land

Total Acres

0.4455

37 N Shore Dr, Albrightsville, PA 18210

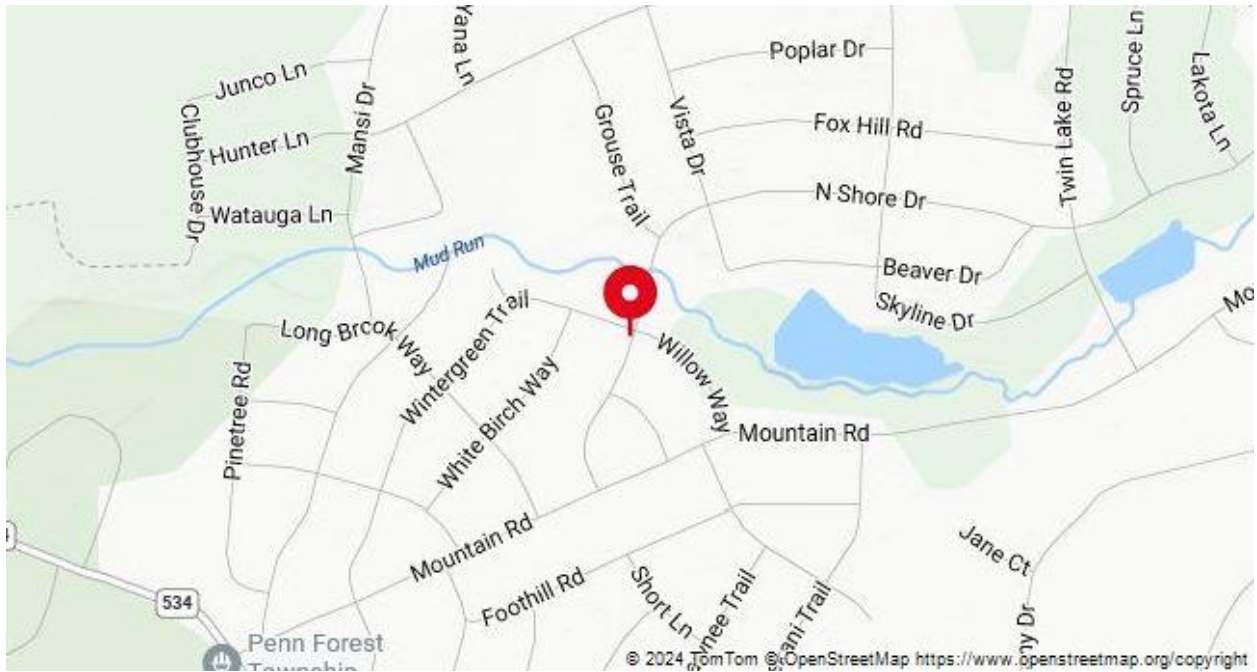

- United States
- PA
- Carbon Co.
- Penn Forest

40.999408, -75.530215

60 Fox Hill Rd, Albrightsville PA 18210 (Indian Mountain Lakes)

- Parcel# 2A-51-B1004
- Lot Dimensions : 90 Ft Wide X 190 Ft Deep
- Total Land Area: 17,100 Sq Ft
-



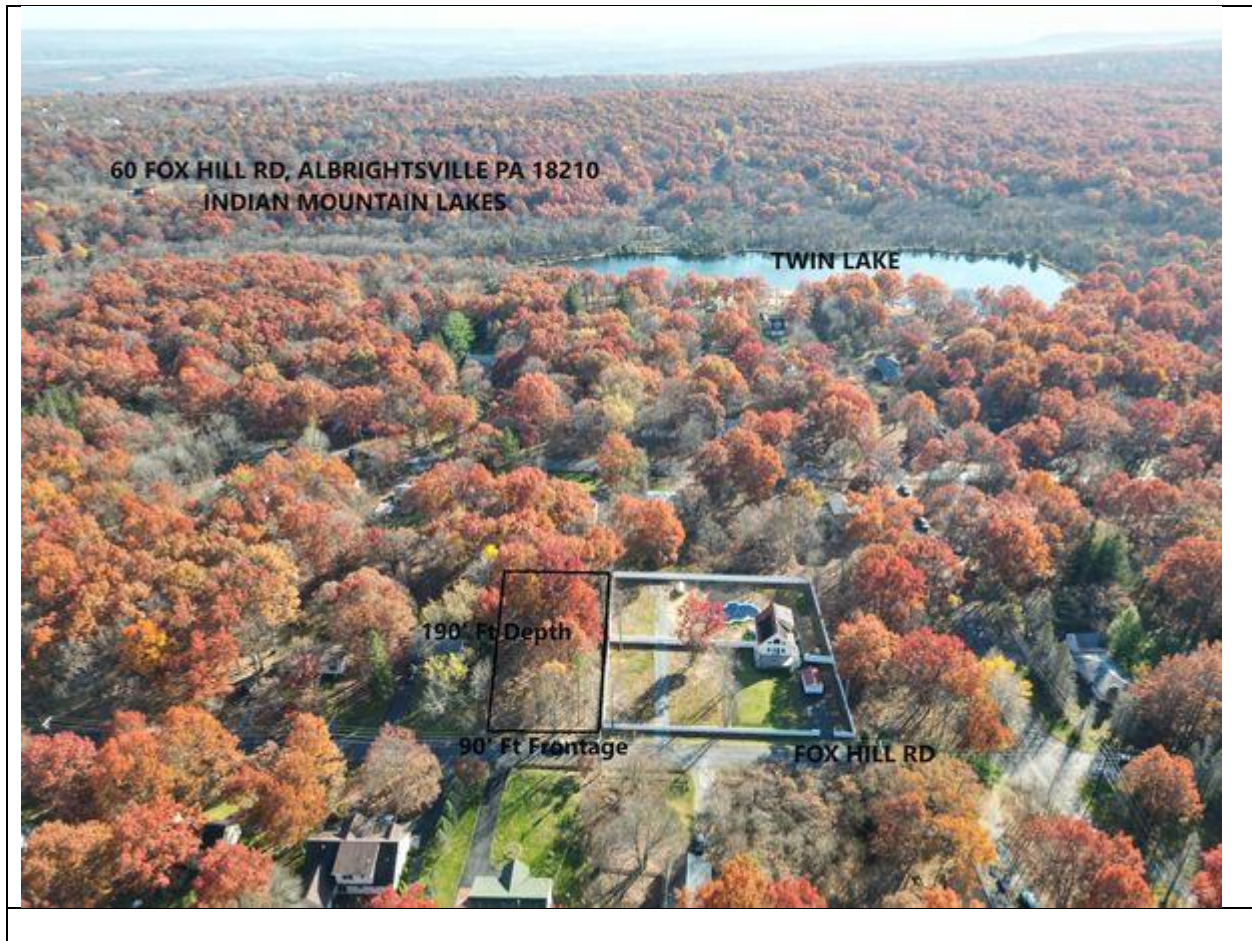

- Sitting roughly 900 feet away from the Twin Lake Beach at Indian Mountain Lake Community. Ton's of new construction within a stone's throw of this site. THIS IS RAW LAND - 1/2 ACRENO PERC TESTING DONE, NO WELL, NO SEPTIC, NO ELECTRIC - you need to go thru the proper approval and building process, NO PLANS OR PERMITS HAVE BEEN COMPLETED.....DOES NOT GET ANY CHEAPER THAN THIS. ALL DETAILS ON THIS LISTING. For a more interactive illustration of the parcel you can visit Carbon County Website & utilize the county GIS Parcel Viewer Tool to see exactly what the lot entails, reference the parcel number listed above. Selling the land without plans or permits, it will be up to the buyer to obtain the proper plans and permits for building. Indian Mountain Lakes Community has a fabulous HOA, ton's of amenities, all year round recreation including lake, beach, pool, and clubhouse. An excellent getaway. Ton's of beautiful homes in this development. Close to Jim Thorpe, Lake Harmony, Jack Frost/Big Boulder & a number of other POCONO area attractions.
- ASKING PRICE \$6,000 CLEAR TITLE, READY FOR TRANSFER !

**69 Placid Lane (1/2 Acre Lot in Holiday Pocono
(Albrightsville) - 200 Feet to Lake Placid)**





HOLIDAY POCONO

PLACID LAKE

PLACID ROAD

200 Ft to Lake

93 FT ROAD FRONTAGE

**LOT
#248**

217 FT DEPTH





Details

- Condition

Used - Good

69 Placid Lane, Albrightsville PA 18210 Parcel# 21A-21-C248 (Lot#248) Lot Dimensions : 93 Ft Wide X 217 Ft Deep Total Land Area: 20,181 Sq Ft 190 Feet to Placid Lake Situated across from 66 Placid Lane, 18210. THIS IS RAW LAND - 1/2 ACRENO PERC TESTING DONE, NO WELL, NO SEPTIC, NO ELECTRIC.....DOES NOT GET ANY CHEAPER THAN THIS. ALL DETAILS ON THIS LISTING. For a more interactive illustration of the parcel you can visit Carbon County Website & utilize the county GIS Parcel Viewer Tool to see exactly what the lot entails, reference the parcel number listed above. Selling the land without plans or permits, it will be up

to the buyer to obtain the proper plans and permits for building. Holiday Pocono has a fabulous HOA, ton's of amenities, Lake access, playgrounds, basketball courts, all year round recreation. An excellent getaway. Ton's of beautiful homes in this development. Close to Towamensing Trails, Jim Thorpe, & a number of other POCONO area attractions. I will not be there to show the lot to you. Settlement will be held in Jim Thorpe at the Carbon County Recorder of Deeds Office. I will prepare all paperwork for closing at no additional cost. Transfer and closing costs will be roughly \$2-300. Asking Price: \$5,000 (CASH DEAL) Can finance with \$2,500 Down, & \$150 month for 2 years.

27 N Shore Dr

Albrightsville, PA 18210

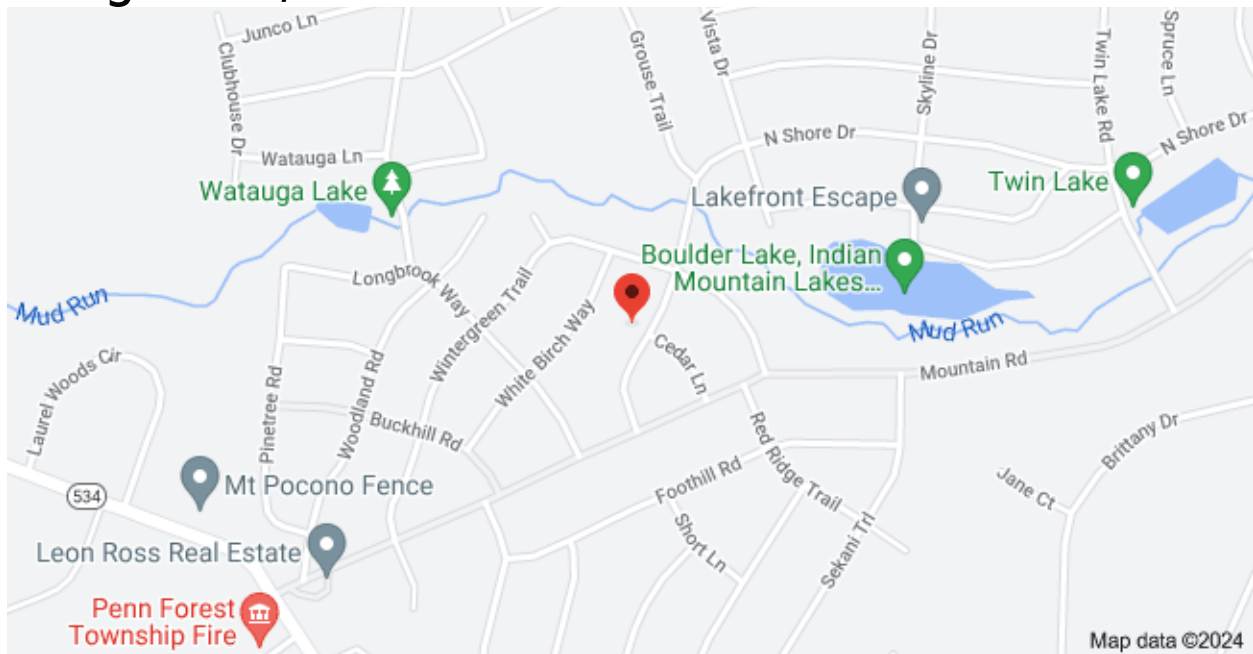

4660 Route 447, Canadensis, PA 18325

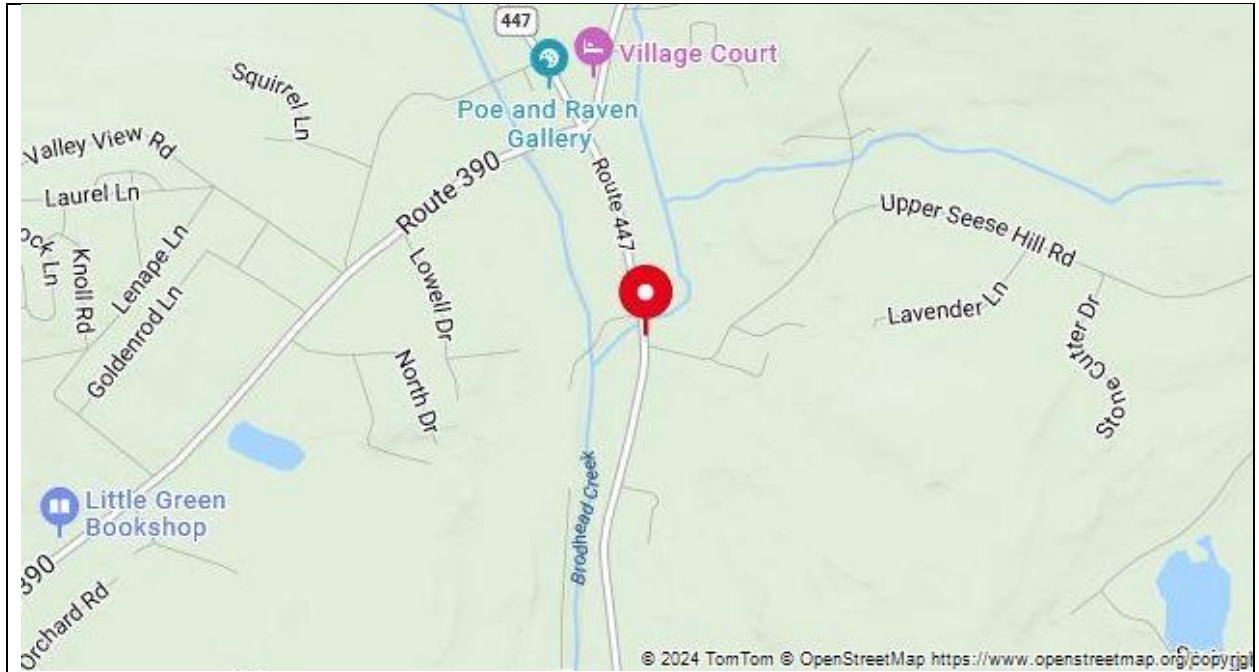

136 Private Dr

Dingmans Ferry, PA 18328

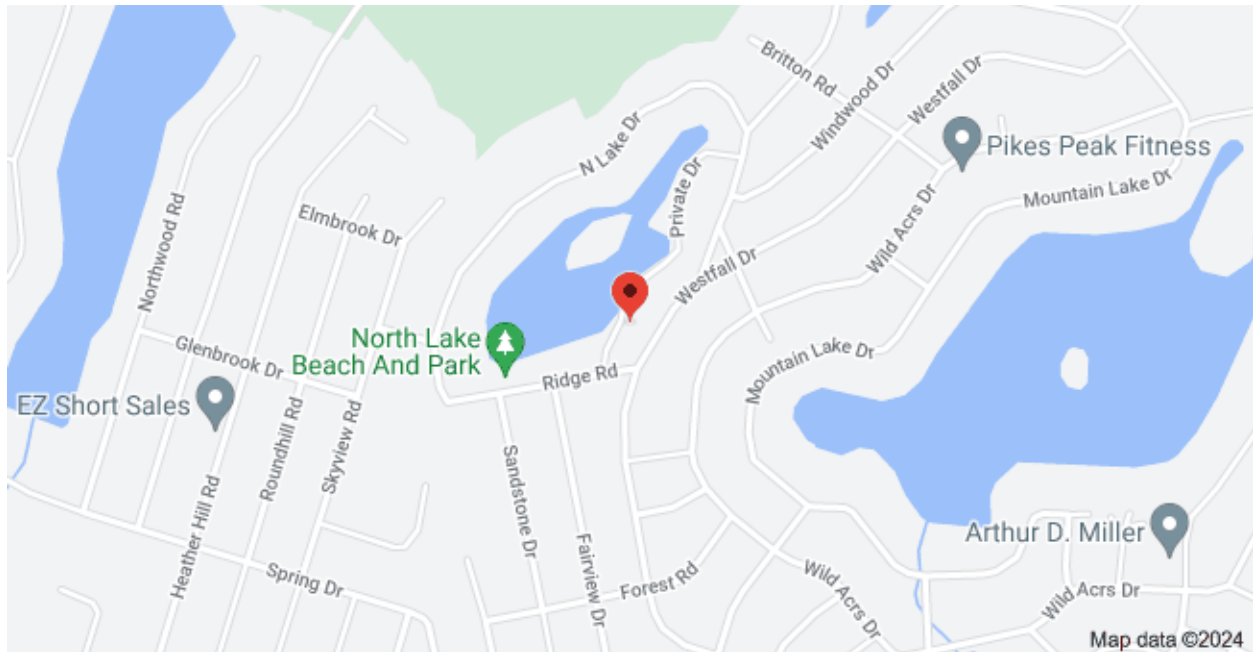

158 Oak Ridge Dr

Dingmans Ferry, PA 18328



Property Type / Style
Property Type: Lot Land

Lot Information

Lot Area: 0.83 acres

HOA: None

105 Iowa Trail

Pocono Lake, PA 18347



Arrowhead Lake Community Association has various community amenities that are available for use during every season to homeowners, members, and guests. Arrowhead Lake is 235 acres while North Arrowhead Lake is 86 acres. Lake Arrowhead is a private lake governed by the Arrowhead Lake Association and is for restricted use by Lake Arrowhead property owners.

117 Kona Ln

Scotrun, PA

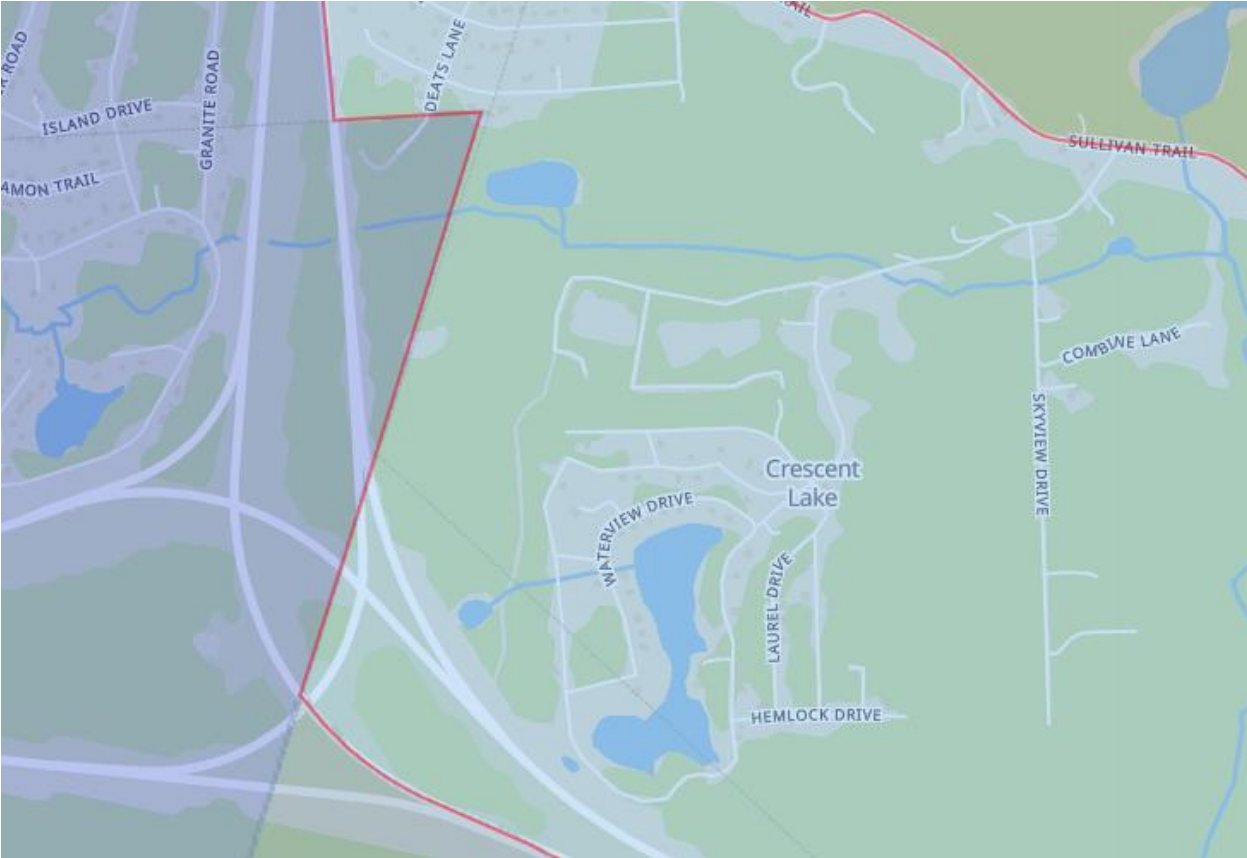

123 Westcolang Rd, Lackawaxen, PA 18435



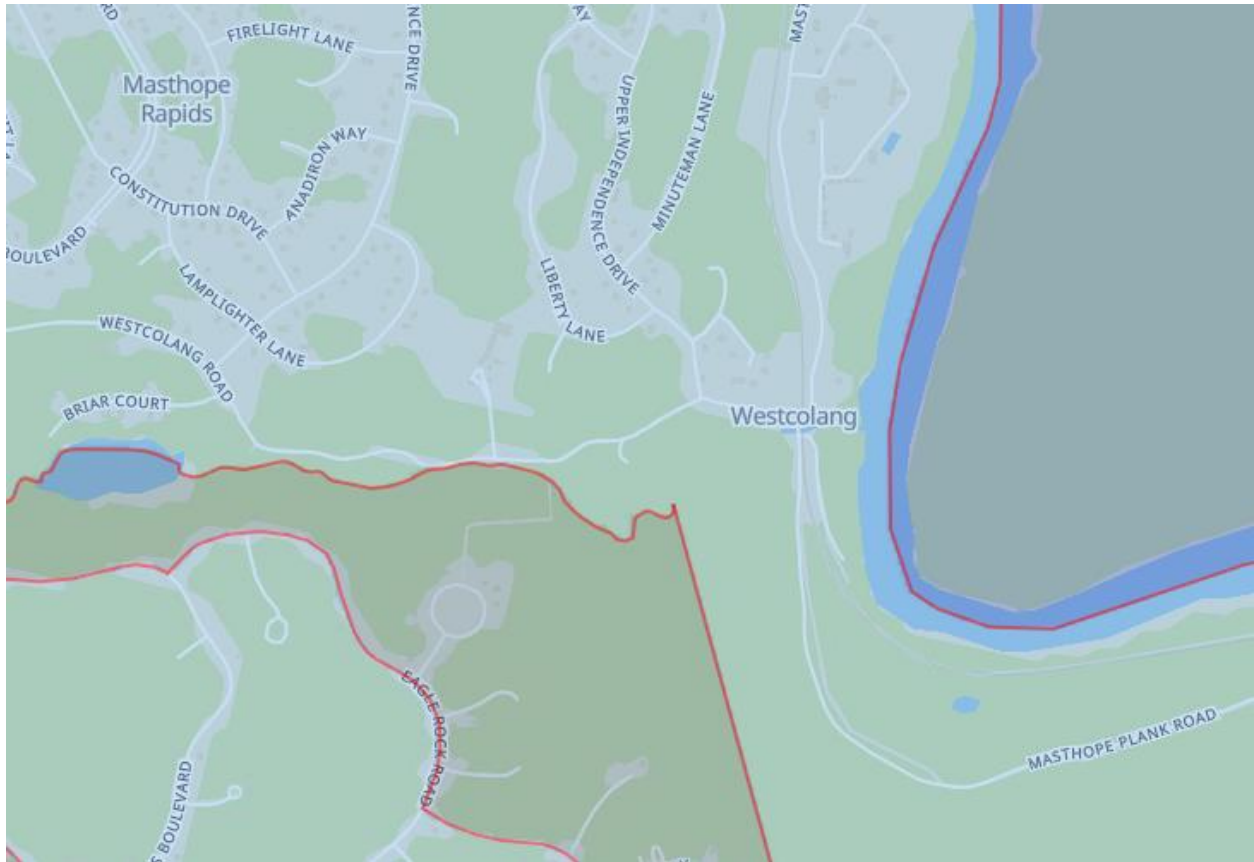

County:	Pike County
Coordinates:	41.511, -75.010
Address (~400 yard radius)	

403 Westcolang Rd, Lackawaxen, PA 18428

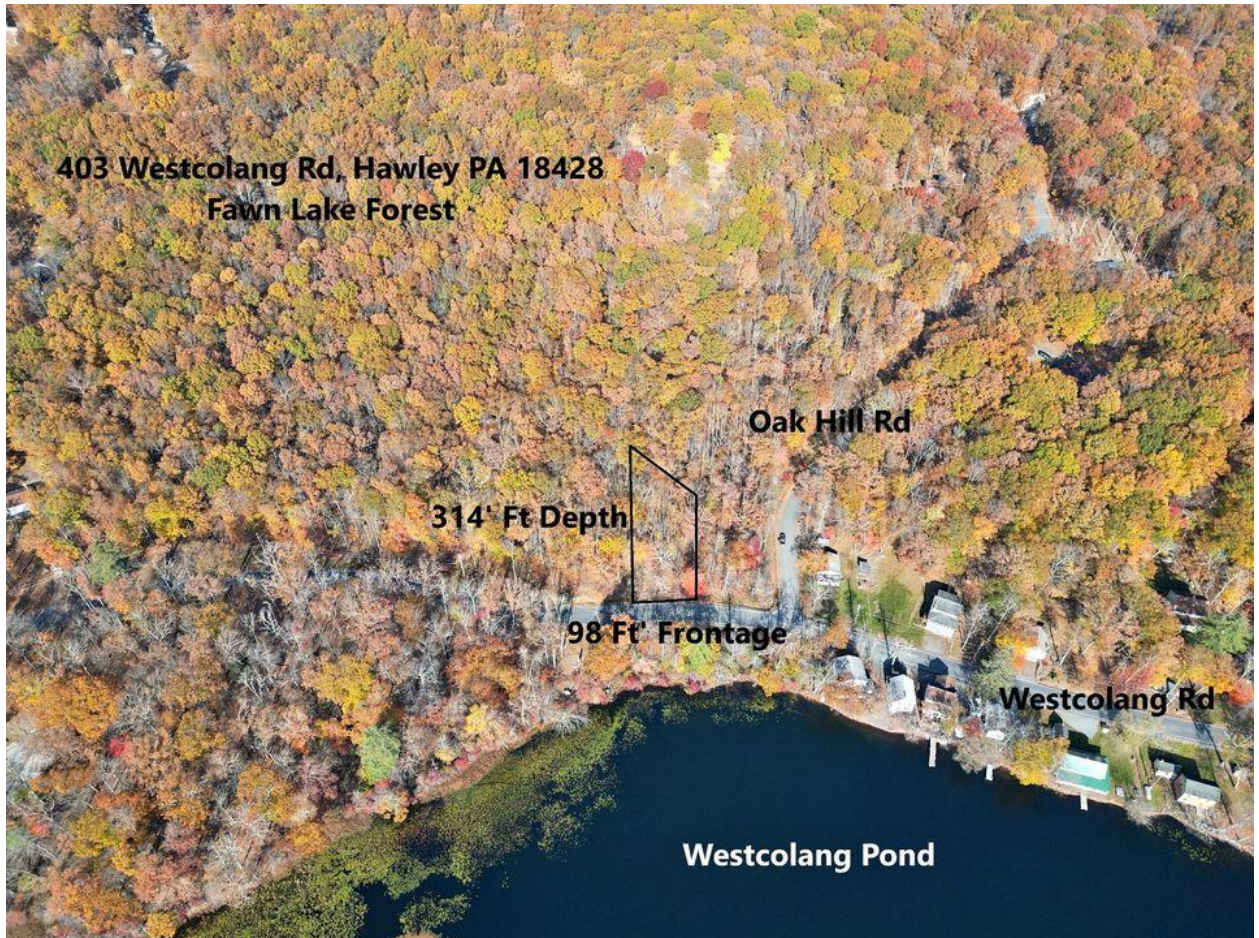

**403 WESTCOLANG RD, HAWLEY PA 18428
FAWN LAKE FOREST**

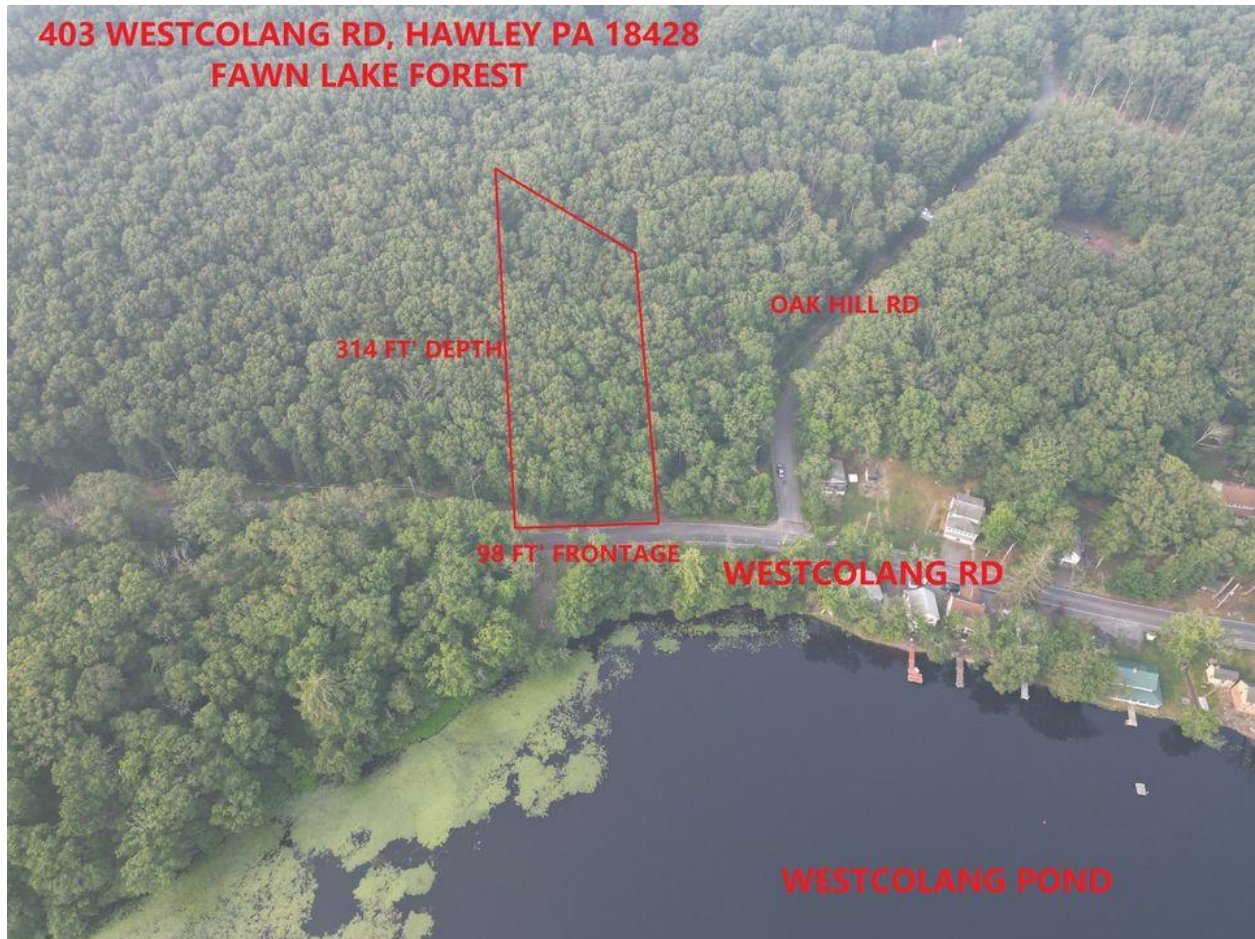

314 FT' DEPTH

OAK HILL RD

98 FT' FRONTAGE

WESTCOLANG RD

WESTCOLANG POND



3/4 ACRE LOT-LAKE VIEWS- FAWN LAKE FOREST, PIKE COUNTY POCONOS

Details

3/4 ACRE LOT-LAKE VIEWS- FAWN LAKE FOREST, PIKE COUNTY- POCONOS 403 Westcolang Rd, Hawley PA 18428 (closest and most accurate address) LOT SIZE: 98 FEET WIDE X 314 FEET DEEP PARCEL# [hidden information] CONTROL # 022955 ANNUAL TAXES: \$229.58 HOA: FAWN LAKE FORREST COUNTY: PIKE This beautiful lot has an unobstructed view of Westcolang Pond, it is situated in the Dingmans Ferry area of the Pocono Mountains. It has 98 Feet of Road Frontage and is 314 Feet Deep, it is sitting right next to the corner of Oak Hill Rd & Westcolang Rd in the Fawn Lake Forest Development. Right off Milford Rd, Route 209, in between Dingmans Ferry and East Stroudsburg. This site is close to many Pocono Attractions, ski resorts, stategame lands, the Delaware River. The site has electric but will need a well water system and septic system when you build here. Selling the lot AS-IS. The title is free and clear, ready for transfer. The community has

plenty of amenities; pool, beaches, playgrounds, basketball courts, boat slips, and much more. Priced to sell. Looking for a cash buyer. Message if interested or if you have any questions.

101 Blackfoot Rd, Shohola, PA 18458



From Wikipedia, the free encyclopedia: Shohola is an unincorporated community in Pike County, Pennsylvania, United States.[1] The community is located along Pennsylvania Route 434 at the Delaware River, which forms the state line with New York; Barryville is across the river. Shohola has a post office with ZIP code 18458.[2][3]

Pike St, Scranton, PA 18508

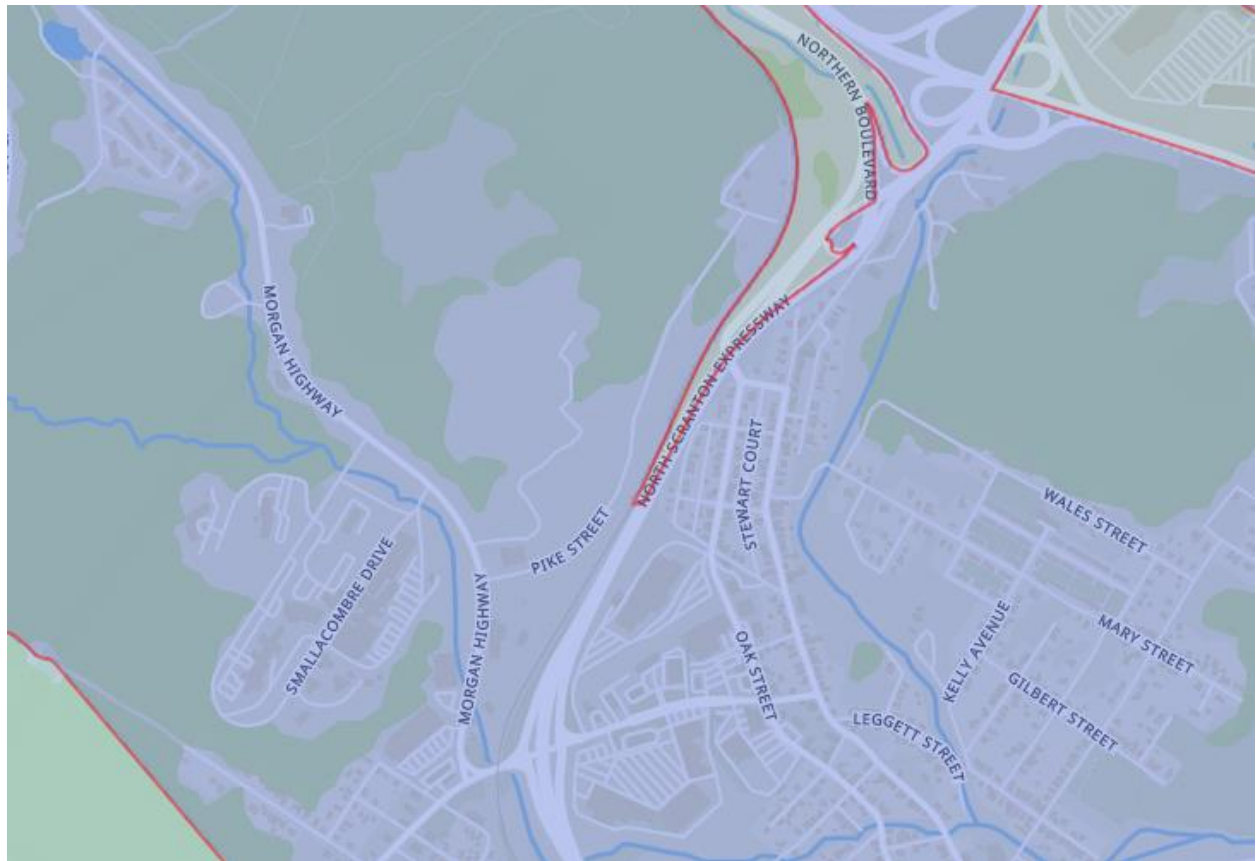
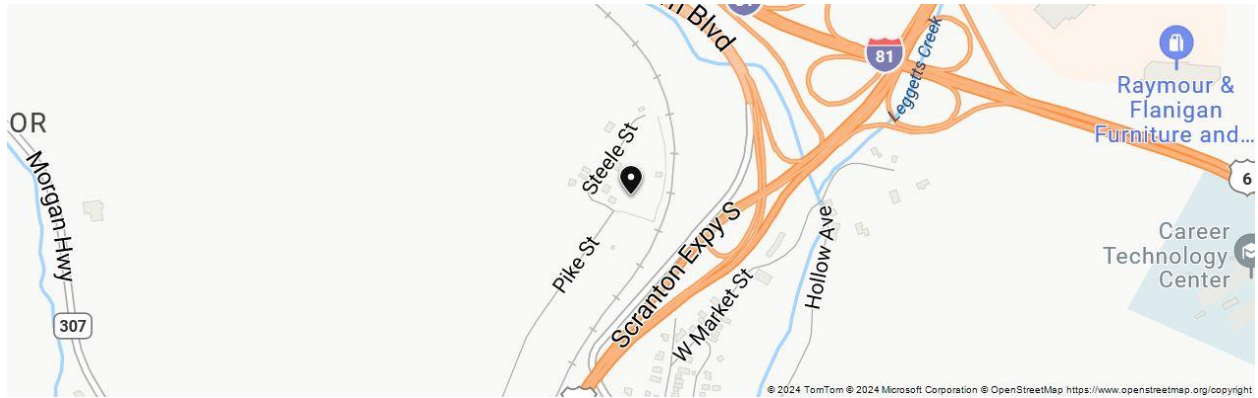

3824 Poplar St, Philadelphia, PA 19104

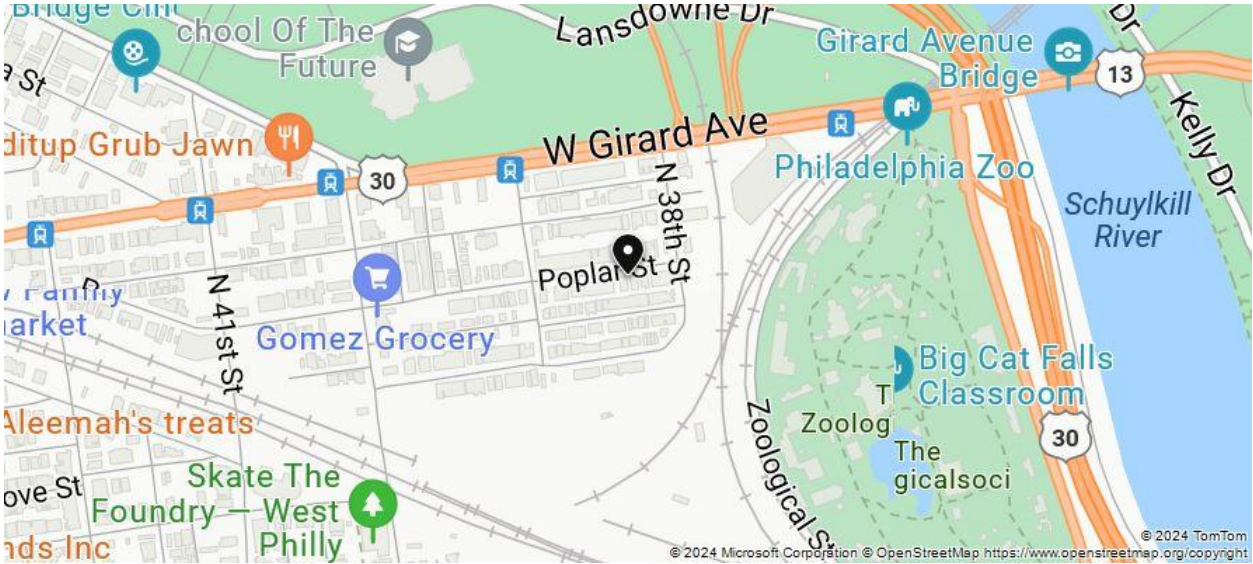

Details

Facts and Features

Bedroom: 3 bed
Bathroom: 1 bath

Area: 1,356 sqft

Year Built: 1930

Lot: 1,200 sq feet

Nearby Schools: Blankenburg Rudolph School, Overbrook High School

1144 Union St Philadelphia, PA 19104



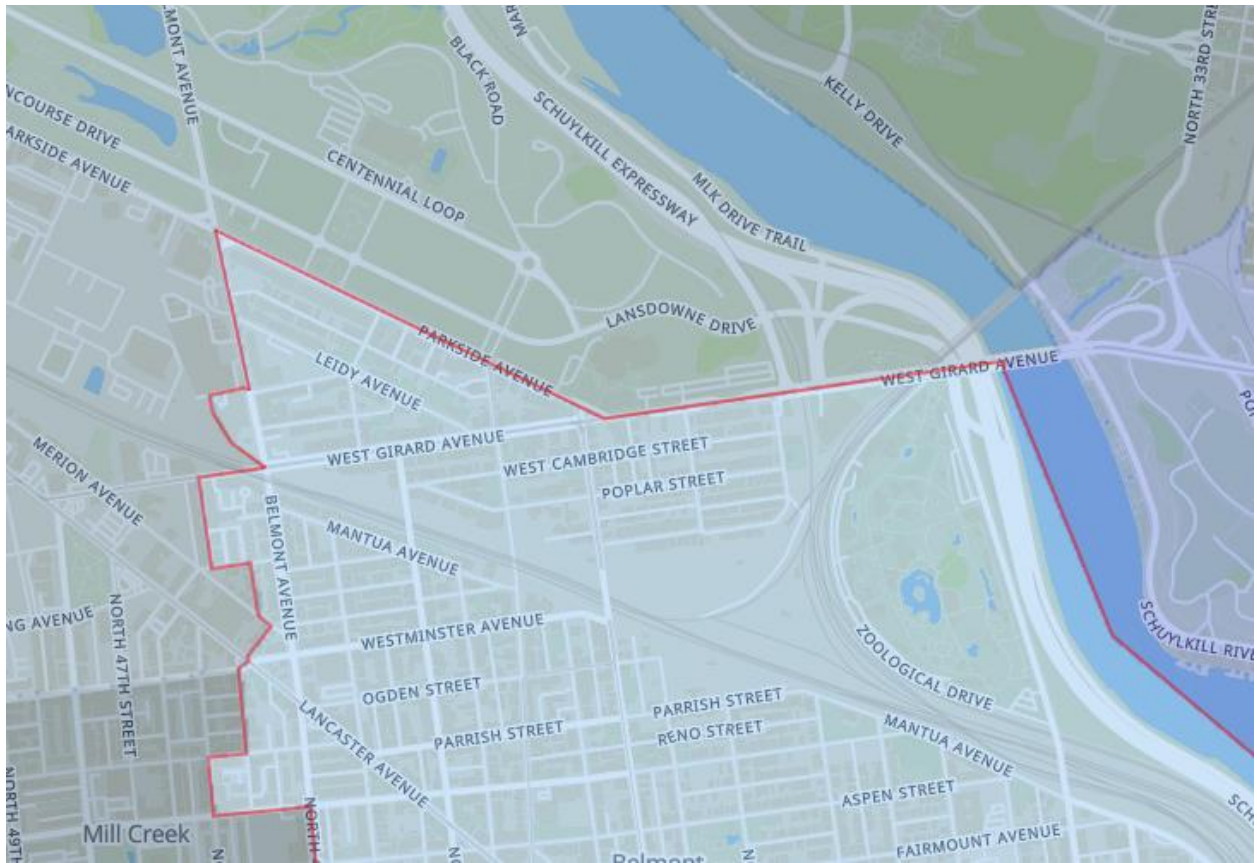
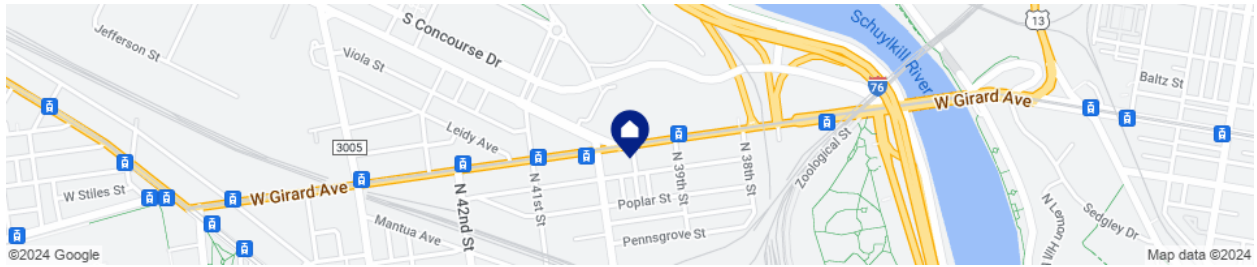

Details

3 bd1 ba1,002 sqft

Acres: 0.0163

Exterior Finish: Brick

Property Type: Single Family Residence / Townhouse

Public tax history

Year	Property taxes	Tax assessment
2023	\$267 +119.5%	\$19,100

Neighborhood:	East Parkside
County:	Philadelphia County

1145 N Union St, Philadelphia, PA 19104

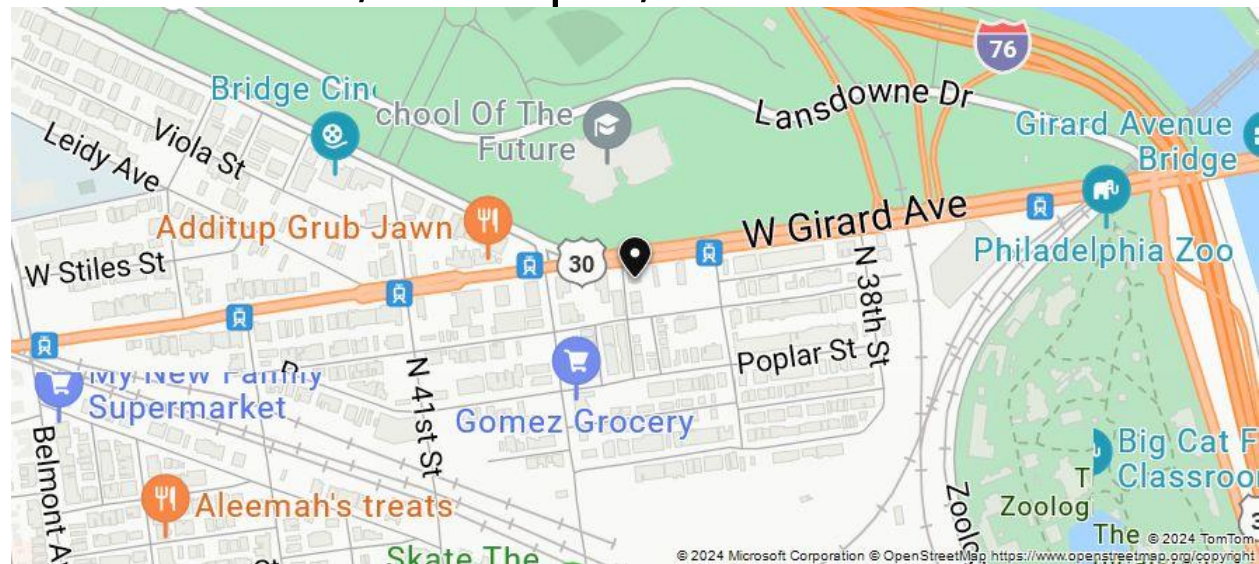

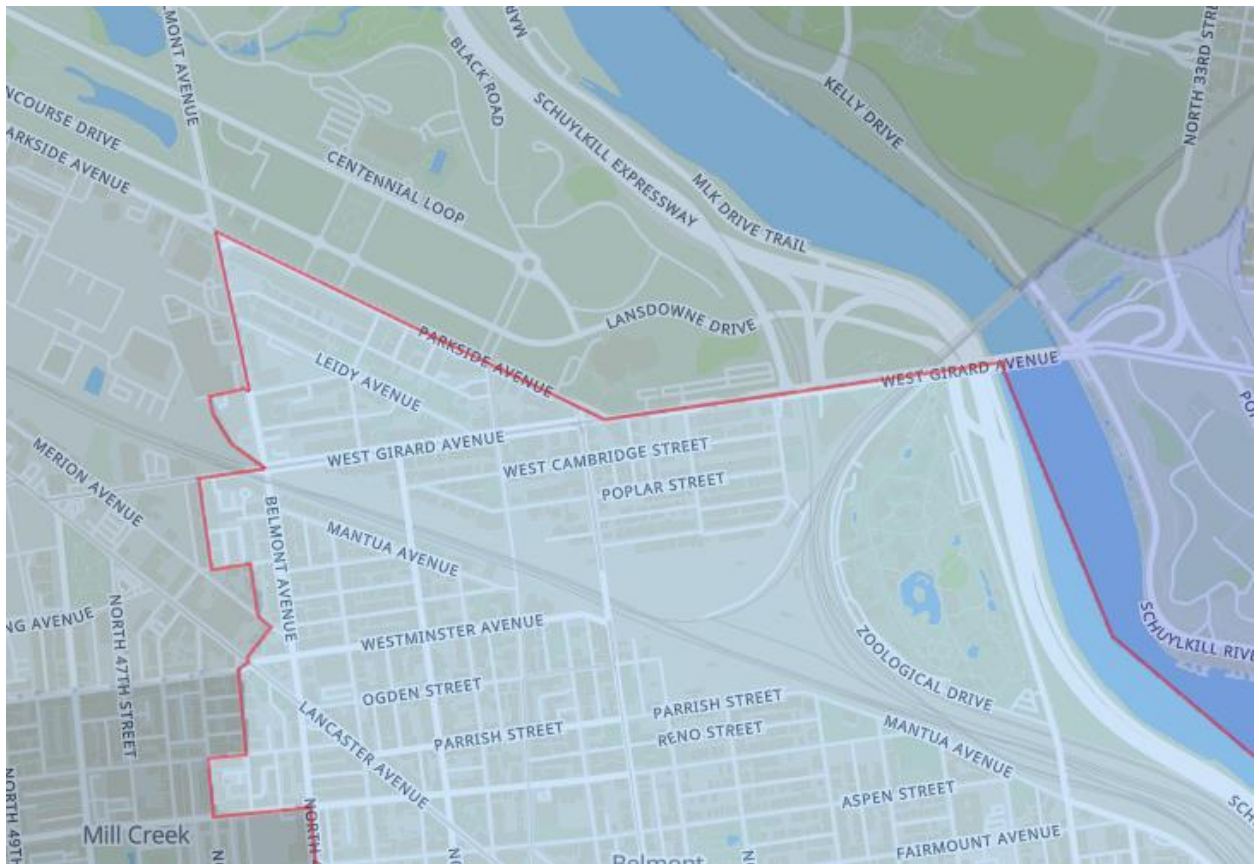

Property Type / Style

Property Type: Lot Land

Lot Information

Lot area: 871 sqft

Neighborhood:	East Parkside
---------------	---------------

County:	Philadelphia County
---------	---------------------

1125 Union St, Philadelphia, PA 19104



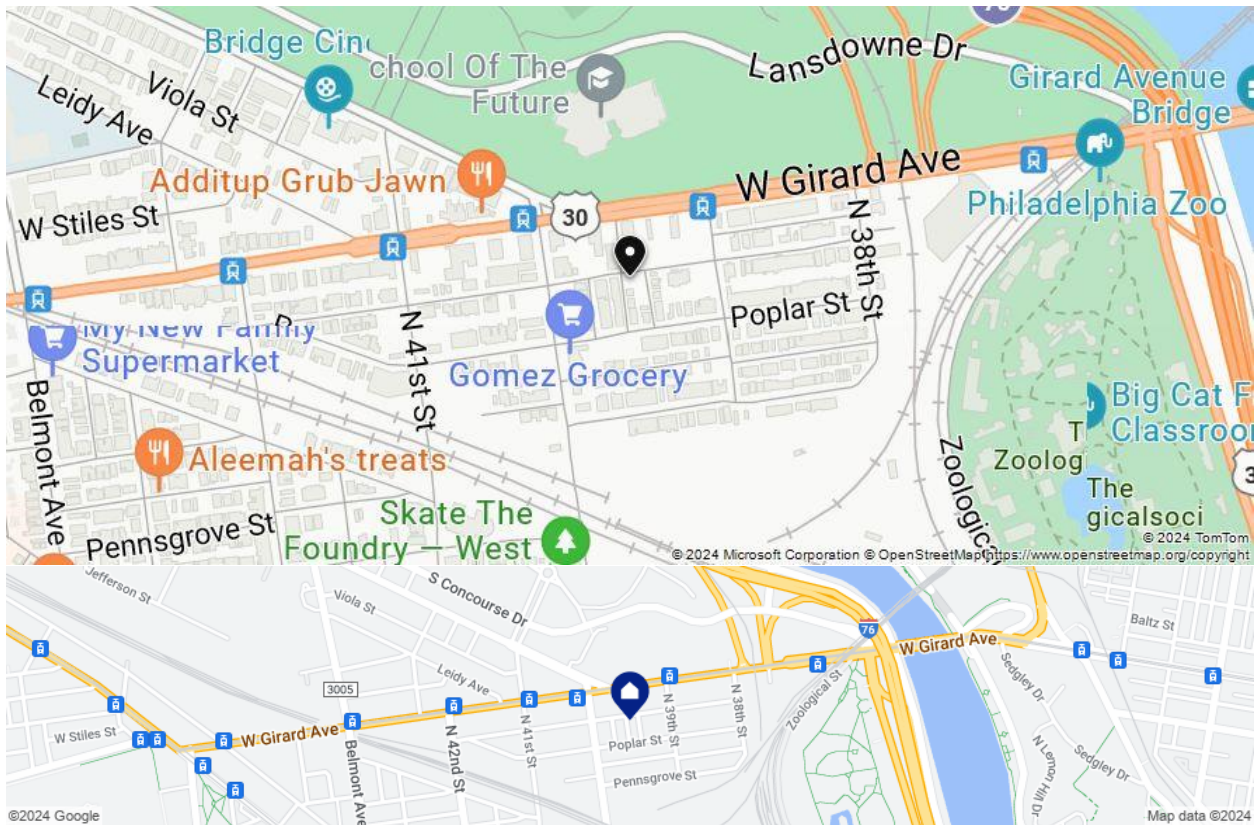

Bedroom: 3 bed
Bathroom: 1 bath
Approximate Area: 756 sqft
Lot size: 535 sqft
Year Built: 1935

Levels, Entrance, & Accessibility
Stories: 2

1116 State St, Philadelphia, PA 19104

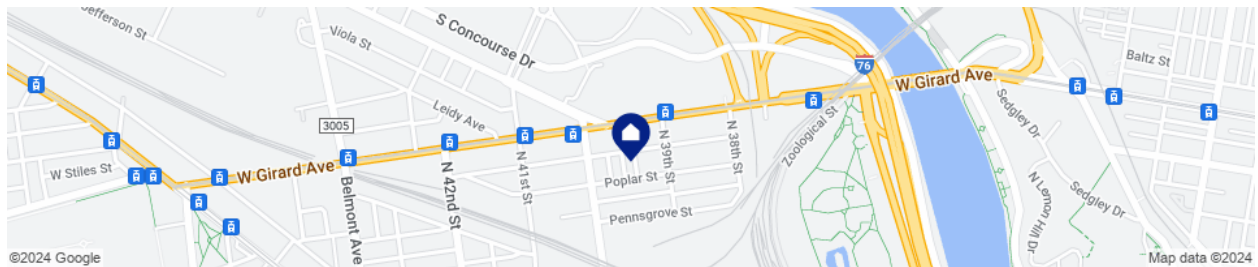
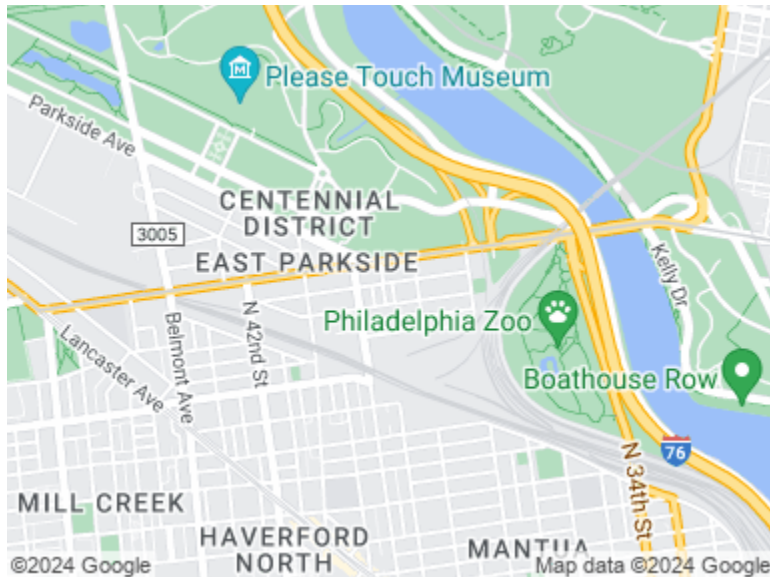

Lot Information

Land Sq. Ft: 535
Legal Lot Number: 248
Legal Block Number: 58N15
Municipality Name: PHILADELPHIA
Acres: 0.0123
Depth Footage: 40
Front Footage: 14
Zoning Code: RM1
County Use Description: VACANT LAND, RESIDENTIAL,

Location Information

Parcel Location Influence: Interior

Property Information

Legal Description: 109'3" N POPLAR ST; 13'6"X39'7 1/2"

Financial Assessor Information

Assessment Year: 2024

2151 N 22nd St, Philadelphia, PA 19121

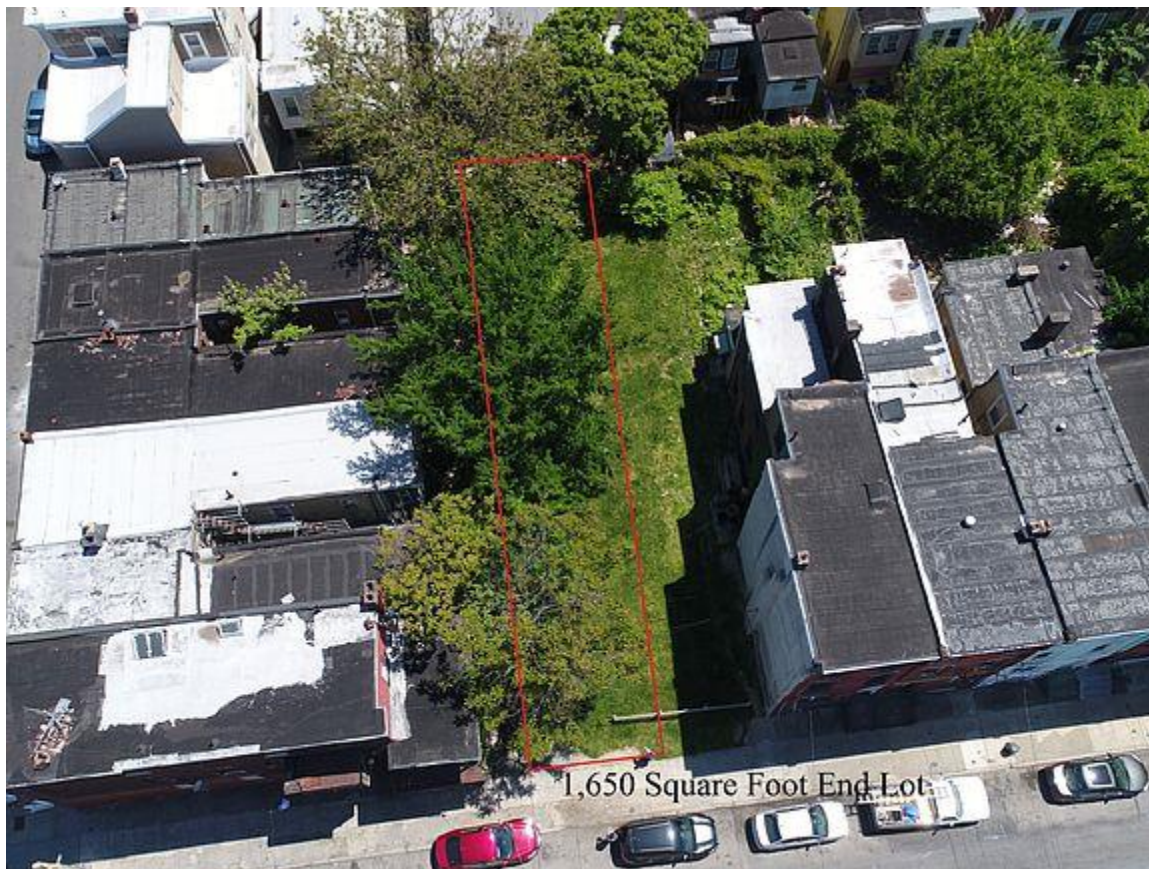

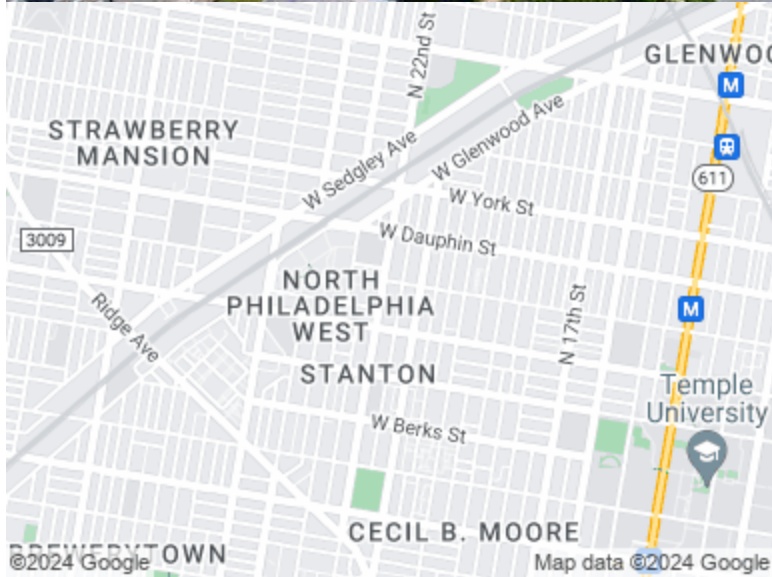

Details

Facts and Features

Lot: 1,650 sq feet

Type: Vacant land on a 1,650 square foot lot

Zoning: RSA5

Nearby Schools:

Dick William School

Strawberry Mansion High School

1913 N Napa St, Philadelphia, PA 19121

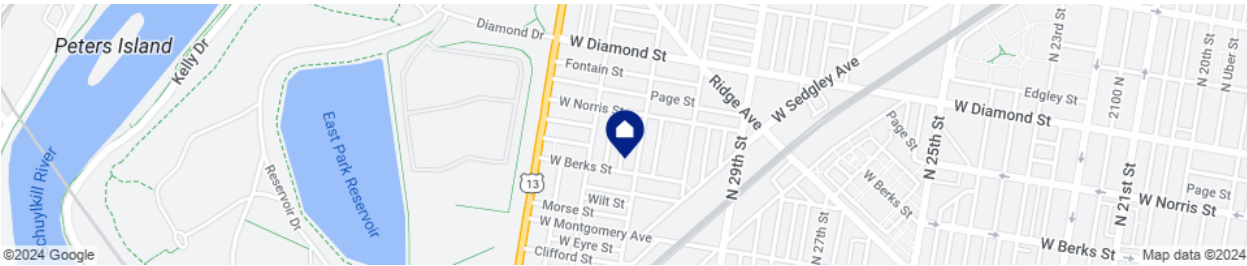

Vacant land
672 sq ft lot

Neighborhood: North Philadelphia West

County: Philadelphia County

1830 N Bailey St, Philadelphia, PA 19121

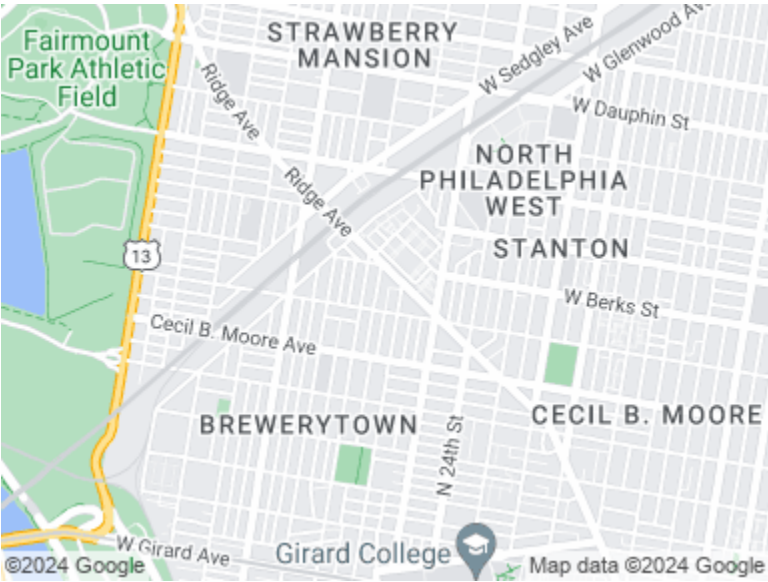

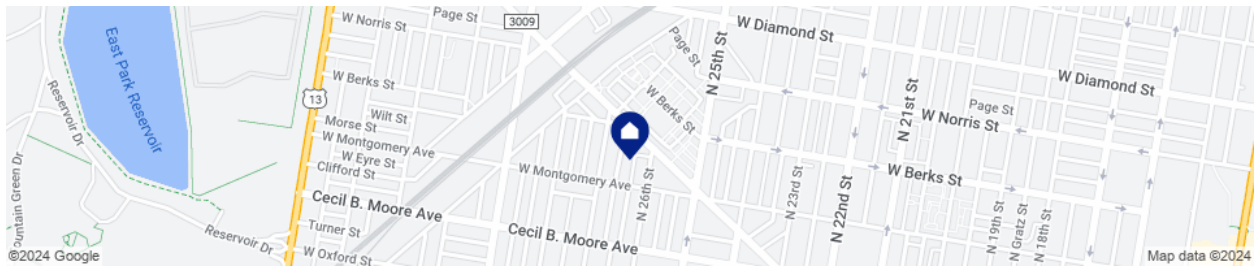

Neighborhood: North Philadelphia West

County: Philadelphia County