

# Coretech

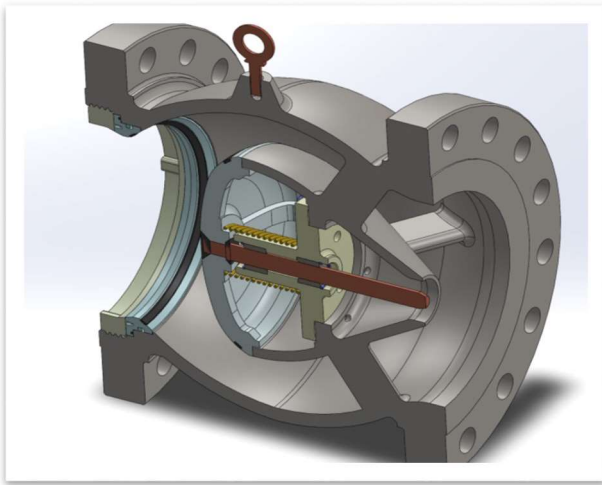

## Master Valve API 6D Axial Flow Check Valve



**Coretech Flow America Inc**

# High Performance Check Valve

## High Performance/High Cycle Check Valve

**Axial Check Valve is a versatile all-purpose, non-slam valve that provides reliable, low-maintenance service for a wide range of liquids, steam and gases at various pressure/temperature combinations. The valve consists of a guard cage, spring, valve disc, retaining ring and seat. It can be combined with pipe fittings such as reducing couplings, drain elbows, etc. to form a complete check valve unit ideally suited for a broad range of pipeline applications or incorporated into machinery for OEM applications. The metal-to-metal sealing area of the Check valve's disc and seat is precision-lapped, providing very tight shutoff of gas, steam and liquid. If bubble-tight shutoff is required, optional resilient soft seats are available.**

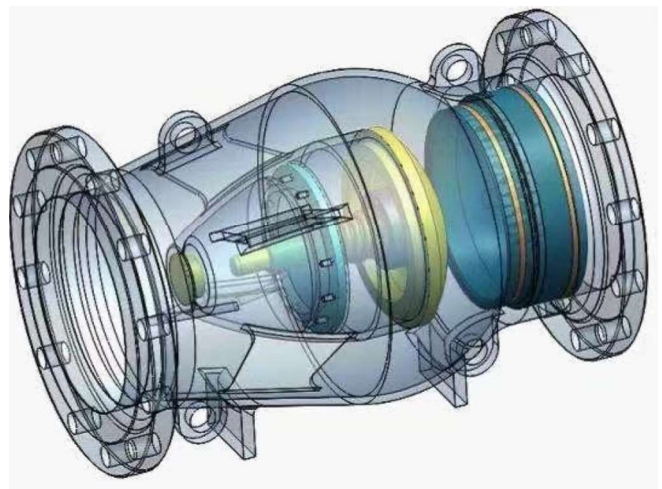
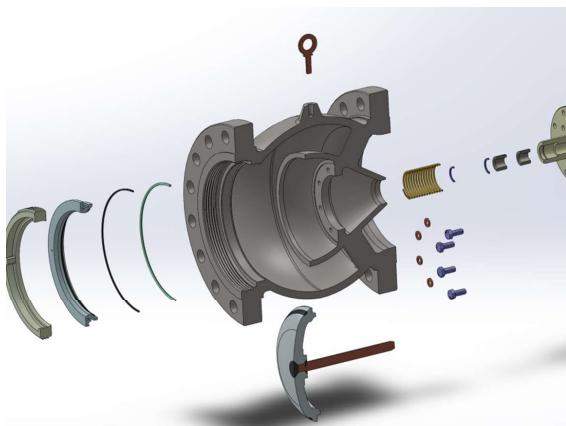

# High Quality Valve for Tough Applications



## Features

- ASME B16.10 Face to Face dimensions
- 2" to 48" line size
- ASME class 150 to 2500 a
- Standard body materials A216 WCB and A351 CF8M
- Tight shutoff
- Stellite metal to metal seat on disc and body sealing for high cycles
- Optional: soft seat

## Axial Flow Check Valve

- Streamlined Venturi port design to ensure flow efficiency and minimize pressure loss
- Flow side outlet design to minimize fluid turbulence ( water hamper)
- High quality casting body
- In low pressure conditions, internal preloaded spring to ensure tight sealing
- Water hammer effect are minimized
- Installed in any position
- Long pattern and short pattern
- 





## Coretech Flow America Inc

**Master Valve USA  
23555 Clay Road  
Katy, Texas 77493  
United States of America  
[www.MasterValveUSA.com](http://www.MasterValveUSA.com)**