

⚠ WARNING! DEATH or SERIOUS INJURY can occur:

- Follow all instructions on the child restraint and in this manual. Failure to follow the manufacturer's warnings for proper use of this child restraint system can result in serious injury or death.
- Use only with children who weigh between 22 and 85 pounds (10 and 39 kg) and whose height is 49 inches (124 cm) or less and who are over 1 year of age.
- Top portion of the seat cushion must be folded under lower portion of seat cushion to form seating surface for child.
- Adjust the belts provided with this child restraint snugly around your child.

1. Activate the restraint system by lowering the two-piece seat cushion. **Fold the top portion of the cushion under the bottom portion to form a seating surface for the child.** **A**
Be sure seat belt buckles (if equipped) are NOT beneath the two-piece cushion. Failure to fold the seat cushion under can result in damage to the restraint and thus improper restraint of the child.

Open chest clip by squeezing middle tabs and pulling chest clip apart.

Unbuckle harness buckle by pressing down on red release button.

To loosen harness, lift metal tab at top of seat **1** and pull down on shoulder strap **2** to loosen strap.

Repeat with second shoulder strap.

2. Place the child in the restraint with the child's back flat against the back of the bus seat cushion. Position shoulder straps over the child's shoulders.

Buckle harness **B** by inserting buckle tongues into harness buckle **3**.

Listen for an audible click when each buckle tongue is fastened.

Check the buckle connection is secure by pulling on the shoulder straps.

3. To tighten harness, pull down equally on top straps **4** on both sides until the harness is snug around the child. **C**
A snug strap should not allow any slack. It lies in a relatively straight line without sagging. It does not press on the child's flesh or push the child's body into an unnatural position.

4. Fasten chest clip **5** by pushing both sides together.
Position chest clip at middle of the child's chest, at armpit level. **D**
Position each shoulder height adjuster **6** at or just above the child's shoulder.
Be sure harness is snug and tight on child's thighs and chest.

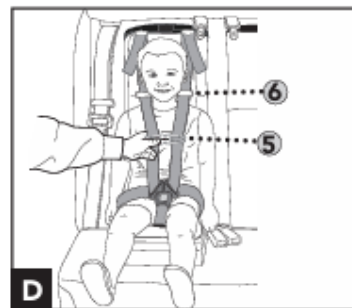
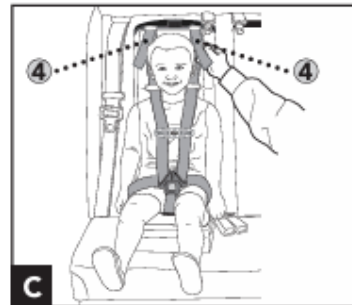
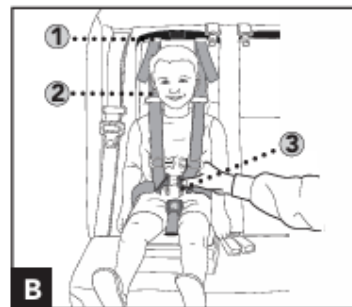
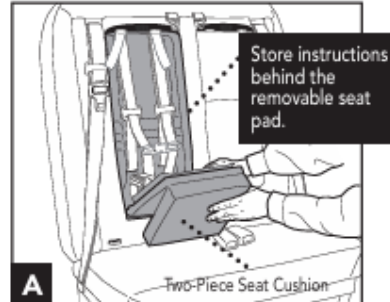

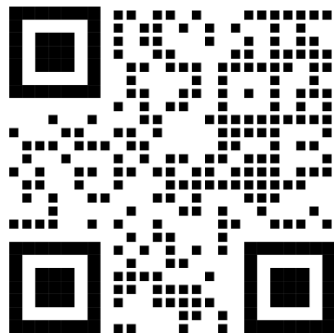

For more information scan QR code for video. See instruction on back, or contact Jodi Polchies

Gorham Fire Rescue

Gorhamcarseat@gmail.com

- **Remove child's Jacket.**
- **Loosen Harness and pull crotch buckle to front before child is seated.**
- **Once child is seated adjust shoulder belt guide to top of shoulder**
- **Clip buckle and Chest Clip, make sure not to twist straps**
- **Pull adjuster straps at shoulders to tighten webbing, should lie flat not be able to pinch and inch at child's collarbone.**