

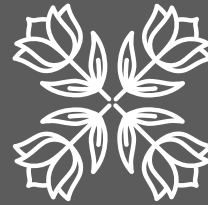

# BLUME

BOUTIQUE CONDOS





BLUME  
BOUTIQUE CONDOS

EXPLORE  
*your senses*



# CANCÚN

This incredible city brings you closer to magical destinations full of history, sacred places like Tulum and Chichen Itza, one of the wonders of the world, not to mention the idyllic destinations of Playa del Carmen, Bacalar and Mahaua. It is an ancestral, multicultural, and cosmopolitan experience. Because living here means doing it safely with all the comforts of the present (yachting around Isla Mujeres, windsurfing, paddleboarding or simply enjoying the beach), without forgetting the majestic Mayan past, always looking towards a warm and peaceful future that only Cancun can provide.





Located in a wonderful natural setting, this exclusive residential complex offers a unique lifestyle as it is surrounded by a beach, marina, golf course, boutiques, restaurants, movie theaters, and much more, with the advantage of being just a few minutes away from the city.

This is why it represents the finest lifestyle, since its private beach club, not to mention the strategic location where it is located, makes it one of the best places to live as a family.

*“Live at the beach and in the city”*

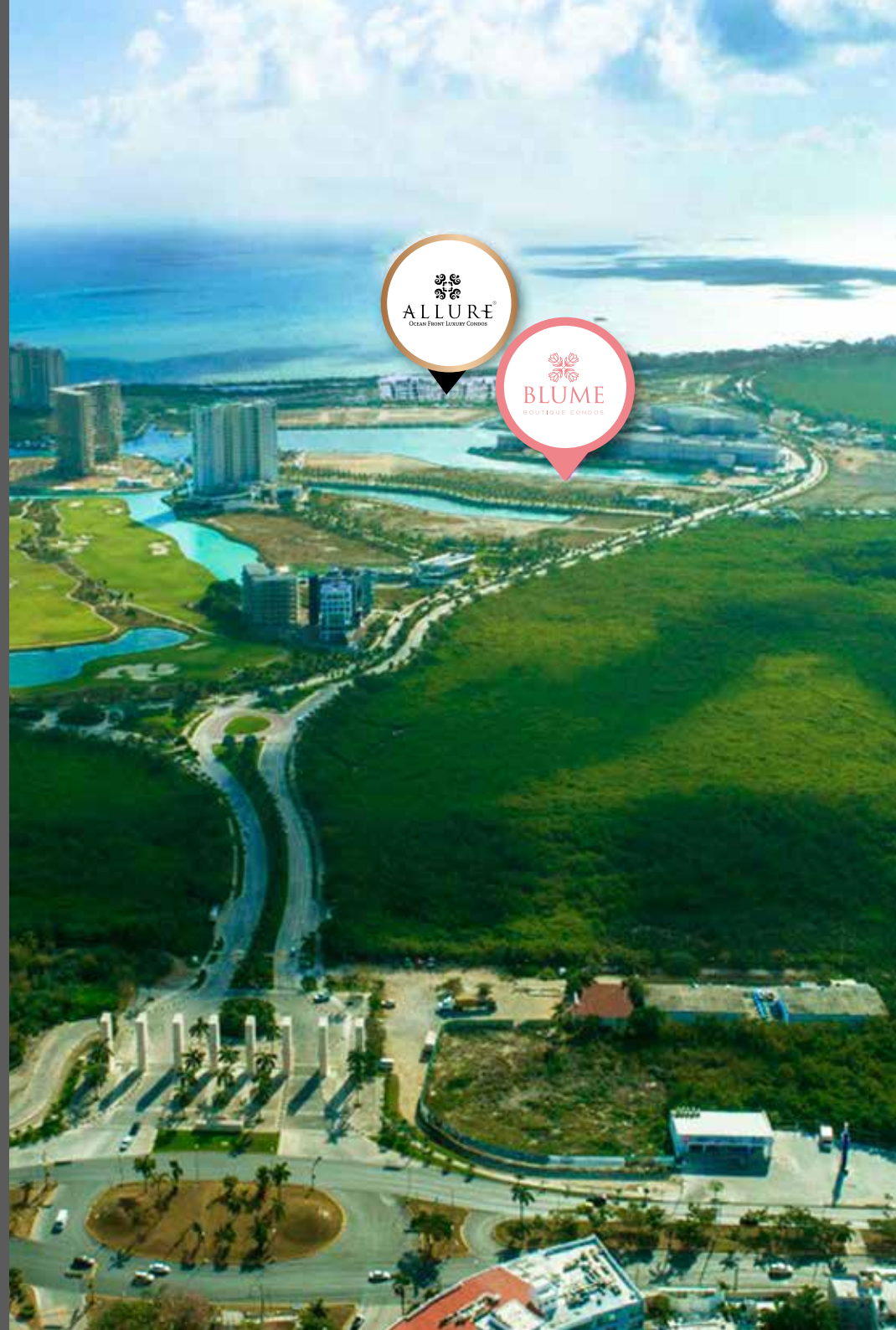





SHOPPING  
CENTER



SHOPPING



DINNING



ENTERTAINMENT



THE MARINE



CLUB HOUSE



BEACH CLUB



CLUB KAYAK



CLUB DE SKI

*Amenities*



BLUME  
BOUTIQUE CONDOS



ALLURE  
Ocean Front Luxury Condos

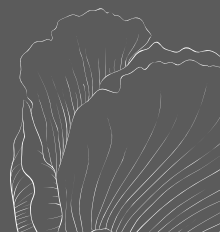





## THE MARINA

The largest marina in Cancun; specifically designed to accommodate yachts up to 125 feet in length, it will be the home of Cancun's nautical community, with over 175 berths and direct access to the Caribbean Sea. It will also have a dry marina that will be able to store and protect boats up to 35 feet.



## SHOPPING CENTER

Enjoy the experience of a day of shopping, gourmet restaurants with spectacular views of the marina. It's the place to meet friends after work, go to the movies or celebrate a special occasion. The mall will be the center of this great community and its new lifestyle.





## GOLF COURSE & CLUB HOUSE

Designed by British Open champion Tom Weiskopf, this course challenges all types of players by offering one of the most incredible views of the Caribbean Sea, the canals and the mangrove. Perfect your golf practice technique.

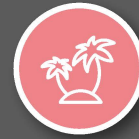

## BEACH CLUB

The perfect setting to enjoy a restaurant, barbeques, lounge chairs, overlooking the beautiful beaches of the Caribbean Sea. You can enjoy a moment of relaxation or do an activity such as sailing, windsurfing, paddleboard, or skiing.







# BLUME

BOUTIQUE CONDOS

Blume is the perfect combination of luxury, ecological reserve, and the sea.

This development is based on the sensory experience, where exclusivity lives. Made up of a splendid tower with 20 levels, it has 113 units divided between spectacular Penthouses, Condos, and Garden Houses.







## **Lot**

145,226.68 sq. ft.

## **Tower**

20 LEVELS

## **113 Units**

2271.19 - 4445.5  
sq. ft.

## **4 Penthouses**

3982.65 - 4445.5  
sq. ft.

## **109 Condos**

2271.19 - 2873.96  
sq. ft.

## **Waterfront**

328.084 feet



FUTBOL - PADLE



PET PARK



NAVIGATION CHANNEL



# MASTER PLAN



DECK



POOL



TERRAZA BAR



SOCCER -PADDLE



PLAYGROUND



MARINA POOL



DOCK



POOL BAR



LOUNGE BAR



INFINITY POOL



AMENITIES



SPA



GYM



KIDS CLUB



BUSSINES CENTER





# *Amenities*





## KIDS CLUB

In this playful space, the children of the home will have a great time with each of the games offered by our kids' club.



## GYM

If you are one of those people who like to lead a healthy life, in our gym you will be able to exercise with other residents of Blume, promoting a healthy and beneficial interaction for each inhabitant.







## SPA

In the Blume SPA, you will find a refuge to disconnect from the outside world, with all the comforts ready to receive you and help you rest as you deserve.

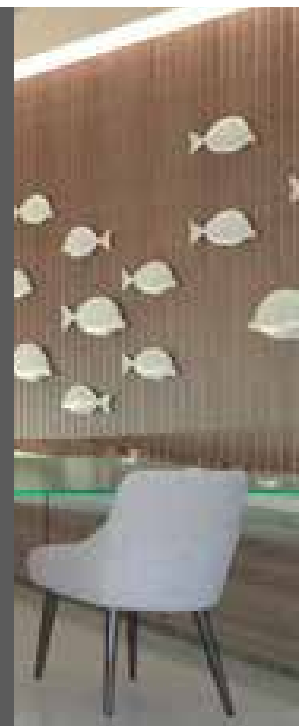

## BUSSINES CENTER

Ideal for closing that deal you have fought tirelessly for, this workspace will have all the tools and advantages at your disposal for you and your partners to make your job a unique experience.

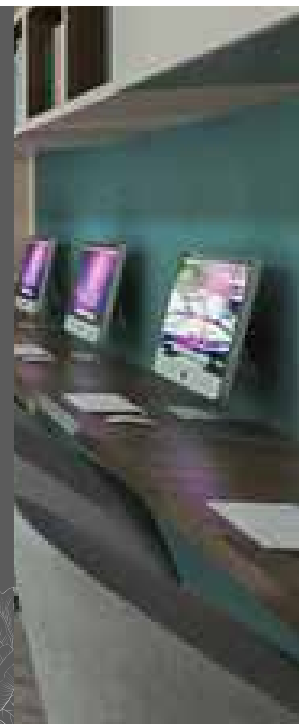

# *Deck*

## AMENITIES







## POOL

In our family pool, you can enjoy a pleasant day together with your loved ones, refreshing yourself with fun and endless water games in a safe pool.



## TERRACE BAR

Ideal to live with your closest friends, our terrace bar has a warm and pleasant environment to have a glass of your favorite drink. Here the atmosphere is set by you and your guests, to share the best possible moment.







## SOCCER PADDLE

Without going out to a club, learn and play soccer on a state-of-the-art synthetic grass field or enjoy the spectacle from the stands in the company of your family and friends



## PLAY GROUND

The outdoor areas are distributed into practical spaces for enjoying with family and friends, either in the playground or simply sitting to read a book on one of the benches in the large open parks.

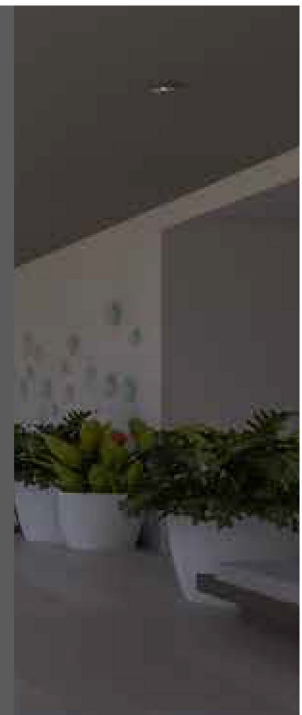





## LOUNGE BAR

Do you have an urge to get home after a hard day's work? Relax in our lounge and forget about the stress of everyday life looking at the Caribbean Sea while your thoughts flow as calmly as each wave does.



## INFINITY POOL

Our beautiful infinity edge pool will make you feel like you're floating between the marina and the sky.







## DOCK

Enjoy a walk along the lagoon  
boarding at Blume's dock.



## POOL BAR

Exclusive for residents to  
relax and enjoy snacks and  
refreshing drinks in an oasis  
of tranquility, sun and water.





# APARTMENTS



BLUME  
BOUTIQUE CONDOS



# A

**2396.58 sq ft**  
**3 BEDROOMS**  
**+ UTILITY**  
**ROOMS**

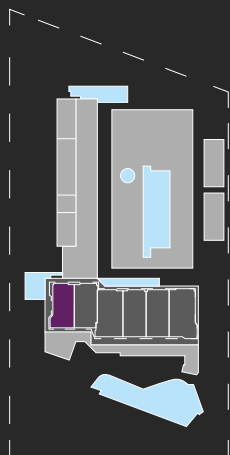

## COMMON AREAS

Living room  
Terrace  
Kitchen  
Dining Room  
TV Room  
Half Bath

## BEDROOMS

Main bedroom with walk-in closet and full bath  
Bedroom 2 with walk-in closet and full bath  
Bedroom 3 with walk-in closet and full bath

## EXTRAS

Maid's room with bathroom  
Utility room

## AREAS

Interior: 2127.49 sq ft  
Terrace: 269.10 sq ft  
Total: 2396.58 sq ft

## PARKING

2 Covered spots

## LOCATION

Levels 3 to 19



\*The floor plans represented correspond to the units of level 19.  
The apartments may have variations in the terraces and changes in the surfaces.



# B

**2406.38 sq ft**  
**3 BEDROOMS**  
**+ UTILITY**  
**ROOMS**

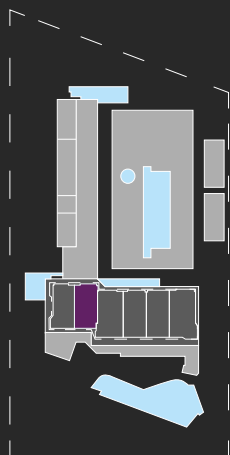

## COMMON AREAS

Living room  
Dining Room  
Terrace  
Kitchen  
Guest Half Bath  
TV Room

## BEDROOMS

Main bedroom with walk-in closet and full bath  
Bedroom 2 with walk-in closet and full bath  
Bedroom 3 with walk-in closet and full bath

## EXTRAS

Maid's room with bathroom  
Utility room

## AREAS

Interior: 2138.36 sq ft  
Terrace: 268.02 sq ft  
Total: 2406.38 sq ft

## PARKING

2 Covered spots

## LOCATION

Levels 3 to 19



\*The floor plans represented correspond to the units of level 19.  
The apartments may have variations in the terraces and changes in the surfaces.

# C

**2762.13 sq ft**  
**3 BEDROOMS**  
**+ UTILITY**  
**ROOMS**



## COMMON AREAS

Living room  
 Dining Room  
 Terrace  
 Kitchen  
 Guest Half Bath  
 TV Room

## BEDROOMS

Main bedroom with walk-in closet and full bath  
 Bedroom 2 with walk-in closet and full bath  
 Bedroom 3 with walk-in closet and full bath

## EXTRAS

Maid's room with bathroom  
 Utility room

## AREAS

Interior: 2512.83 sq ft  
 Terrace: 249.29 sq ft  
 Total: 2762.13 sq ft

## PARKING

2 Covered spots

## LOCATION

Levels 3 to 19



\*The floor plans represented correspond to the units of level 19.  
 The apartments may have variations in the terraces and changes in the surfaces.



# D

**2616.60 sq ft**

**3 BEDROOMS  
+ UTILITY  
ROOMS**

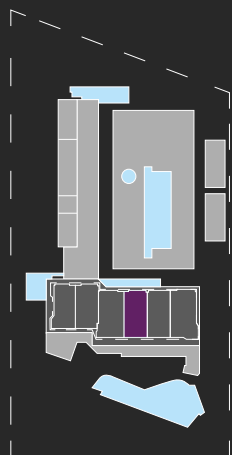

## COMMON AREAS

Living room  
Dining Room  
Terrace  
Kitchen  
Guest Half Bath  
TV Room

## BEDROOMS

Main bedroom with walk-in closet and full bath  
Bedroom 2 with walk-in closet and full bath  
Bedroom 3 with walk-in closet and full bath

## EXTRAS

Maid's room with bathroom  
Utility room

## AREAS

Interior: 2363.32 sq ft  
Terrace: 253.27 sq ft  
Total: 2616.60 sq ft

## PARKING

2 Covered spots

## LOCATION

Levels 3 to 19



\*The floor plans represented correspond to the units of level 19.  
The apartments may have variations in the terraces and changes in the surfaces.

# E

**2616.60 sq ft**  
**3 BEDROOMS**  
**+ UTILITY**  
**ROOMS**



## COMMON AREAS

Living room  
Dining Room  
Terrace  
Kitchen  
Guest Half Bath  
TV Room

## BEDROOMS

Main bedroom with walk-in closet and full bath  
Bedroom 2 with walk-in closet and full bath  
Bedroom 3 with walk-in closet and full bath

## EXTRAS

Maid's room with bathroom  
Utility room

## AREAS

Interior: 2363.32 sq ft  
Terrace: 253.27 sq ft  
Total: 2616.60 sq ft

## PARKING

2 Covered spots

## LOCATION

Levels 3 to 19



\*The floor plans represented correspond to the units of level 19.  
The apartments may have variations in the terraces and changes in the surfaces.



# PENTHOUSES



BLUME  
BOUTIQUE CONDOS



# PH1

**3979.20 sq ft**  
**3 BEDROOMS**  
**+ UTILITY**  
**ROOMS**

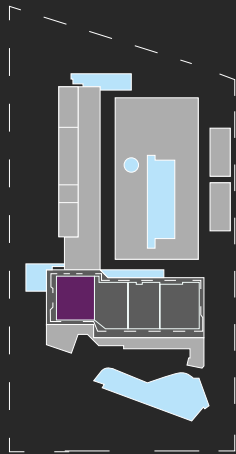

## COMMON AREAS

Living room  
Dining Room  
Terrace  
Kitchen  
Guest Half Bath  
TV Room

## BEDROOMS

Main bedroom with walk-in closet and full bath  
Bedroom 2 with walk-in closet and full bath  
Bedroom 3 with walk-in closet and full bath

## EXTRAS

Maid's room with bathroom  
Utility room

## AREAS

Interior: 3356.08 sq ft  
Terrace: 623.12 sq ft  
Total: 3979.20 sq ft

## PARKING

3 Covered spots

## LOCATION

Level 20





# PH2

**4043.68 sq ft**  
**3 BEDROOMS**  
**+ UTILITY**  
**ROOMS**

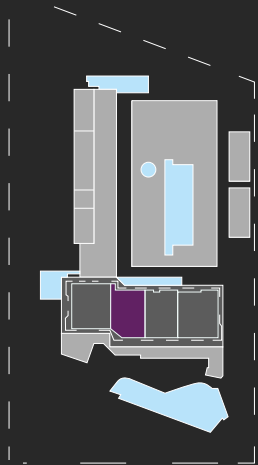

## COMMON AREAS

Living room  
Dining Room  
Terrace  
Kitchen  
Guest Half Bath  
TV Room

## BEDROOMS

Main bedroom with walk-in closet and full bath  
Bedroom 2 with walk-in closet and full bath  
Bedroom 3 with walk-in closet and full bath

## EXTRAS

Maid's room with bathroom  
Utility room

## AREAS

Interior: 3439.28 sq ft  
Terrace: 604.07 sq ft  
Total: 4043.68 sq ft

## PARKING

3 Covered spots

## LOCATION

Level 20



# PH3

**3864.90 sq ft**  
**3 BEDROOMS**  
**+ UTILITY**  
**ROOMS**

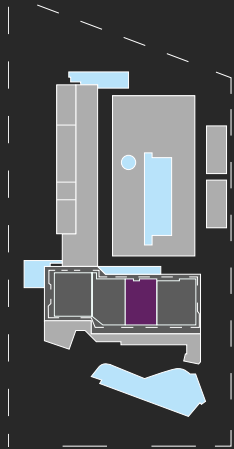

## COMMON AREAS

Living room  
Dining Room  
Terrace  
Kitchen  
Guest Half Bath  
TV Room

## BEDROOMS

Main bedroom with walk-in closet and full bath  
Bedroom 2 with walk-in closet and full bath  
Bedroom 3 with walk-in closet and full bath

## EXTRAS

Maid's room with bathroom  
Utility room

## AREAS

Interior: 3314.96 sq ft  
Terrace: 549.92 sq ft  
Total: 3864.90 sq ft

## PARKING

3 Covered spots

## LOCATION

Level 20





# PH4

**4440.54 sq ft**  
**3 BEDROOMS**  
**+ UTILITY**  
**ROOMS**

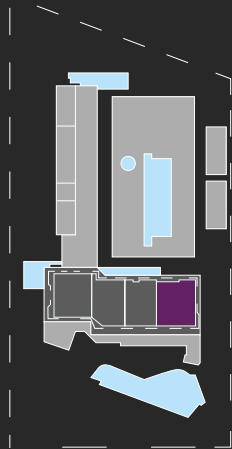

## COMMON AREAS

Living room  
Dining Room  
Terrace  
Kitchen  
Guest Half Bath  
TV Room

## BEDROOMS

Main bedroom with walk-in closet and full bath  
Bedroom 2 with walk-in closet and full bath  
Bedroom 3 with walk-in closet and full bath

## EXTRAS

Maid's room with bathroom  
Utility room

## AREAS

Interior: 3737.77 sq ft  
Terrace: 702.78 sq ft  
Total: 4440.54 sq ft

## PARKING

3 Covered spots

## LOCATION

Level 20





BLUME  
BOUTIQUE CONDOS

