

HAZARDOUS LOCATIONS LIGHT SPECIFICATION

N Series

Applications

This luminaire can be used as flood light, wall pack and area light which can provide general illumination in hazardous locations, such as:

- 1.Oil refineries and Gas station
- 2.Oil and gasoline loading dock
- 3.Distillerie
- 4.Painting manufacturing plant
- 5.Pumping station
- 6.Mine
- 7.Vessel
- 8.Other high humidity, high temperature, dusty location



Features

- High efficacy: up to 140lm/W
- CRI>70
- Surface mounting and pendant installation
- Wide and narrow optics for uniform illumination
- Copper free aluminum
- High vibration resistance

Professional Light Distribution

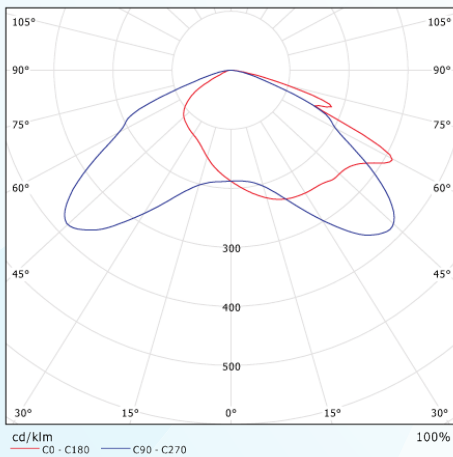

Type III

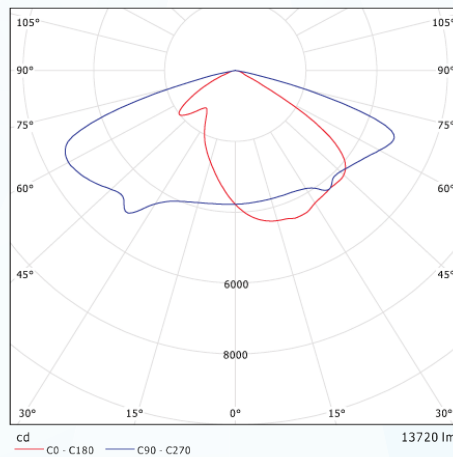

Type IV

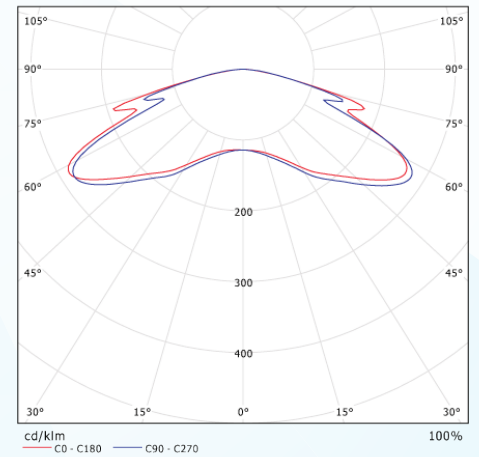

Type V

Typical model specification

Product Number	Wattage	Color	Voltage	Lumens	Working Hours	CRI
N80020	20	4000K-5700K	AC100-277V	2800	5 years	70
N80040	40	4000K-5700K	AC100-277V	5600	5 years	70

"N"=Product series "Y"=D or N:Dimmable or non-dimmable "Z"= CCT, from 4000~5700K "D"=Beam angle: 150×70°

Mechanical information

	Size(in)
AC100-277V	19.2×6.9×2.2

Structure diagram

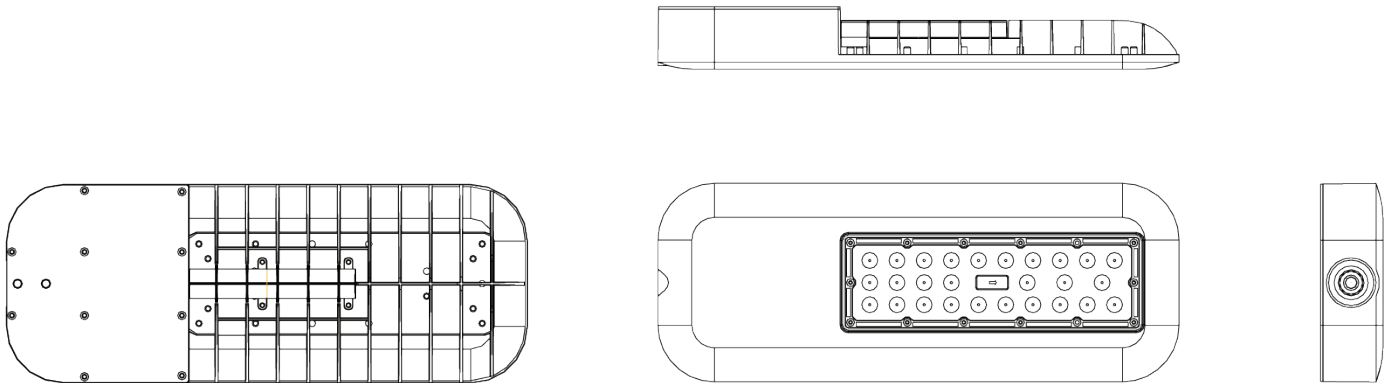

Mounting method

Arm Mount

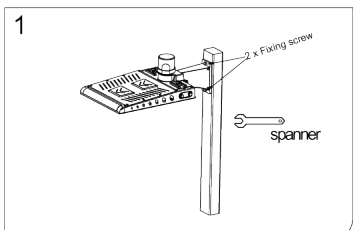

1. Tighten 2 x Fixing screw by spanner, ensure to add star washer avoid the screw will loose.

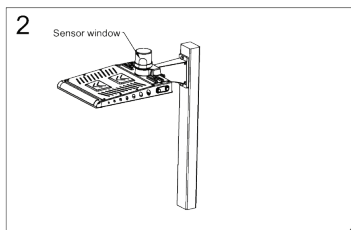

2. Turn on the power to test shoe box light, however you need to cover the sensor window if there is sunshine.

Slip Mount

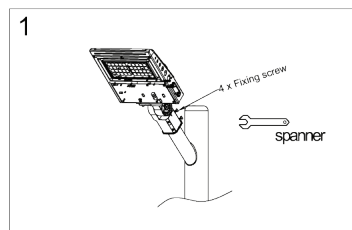

1. Tighten 2 x Fixing screw by spanner, ensure to add star washer avoid the screw will loose.

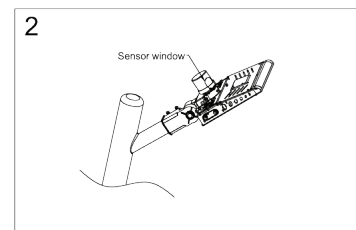

2. Turn on the power to test shoe box light, however you need to cover the sensor window if there is sunshine.

Trunnion Mount

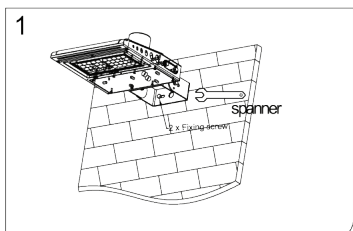

1. Tighten 2 x Fixing screw by spanner, ensure to add star washer avoid the screw will loose.

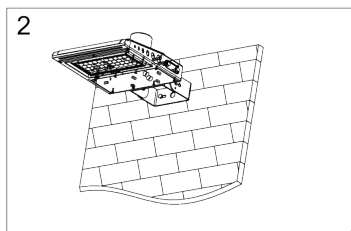

2. Turn on the power to test shoe box light, however you need to cover the sensor window if there is sunshine.

Warranty

Only offer 5 year's warranty or any other warranty period specified in the contract for the product from the date of purchase:

- Invoice or shipment bill is required to claim the warranty.
- The warranty policy only requires manufacturer to repair the defective product or send substitute for replacement.
- Installation labor, electricity cost and other related cost will not be covered by the manufacturer warranty policy.
- Warranty doesn't cover the defect caused by inappropriate use, especially if directions of the instructions for use are not observed, normal abrasion as well as failures which affect the value or use of the product insignificantly.