

Location

Falcon Falls East



Falcon Falls East is just north of HWY 254 on Hillside in north Wichita. 3 Bedroom single family homes available at \$235,000-\$239,000 or 4 bedrooms at \$245,000.



Charley

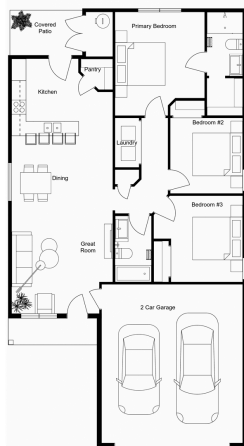

1181 SQ FT
3 Bed | 2 Bath

Baxter



1200 SQ FT
3 Bed | 2 Bath

Maxine



1314 SQ FT
4 Bed | 2 Bath

PROPERTY DETAILS

Each separate home is rent ready offering 3-4 bedrooms, 2 full bathrooms and an attached two car garage. 36" hallways and doors. Luxury features include quartz counters throughout, vaulted ceilings, walk in pantry and closets, and luxury vinyl flooring. All units include garage door openers.

FALCON FALLS EAST NEIGHBORHOOD

- Easy highway access to Hwy 254 & K96
- HOA handles the yard mowing, sprinkler systems, and wells and ponds. Actual costs are billed back to owners around \$900 year.
- Several proven floor plans offered
- Special Assessments estimate: \$253 per month Engineer's Estimate Available
- Taxes estimated \$2,300 yr
- 3 Bedroom \$235,000-\$239,000 on water view
- 4 Bedroom \$245,000
- Estimated completion Dec of 2025
- Wichita School District, nearby Heights High excels in athletics, new Easley Elementary just a couple miles away

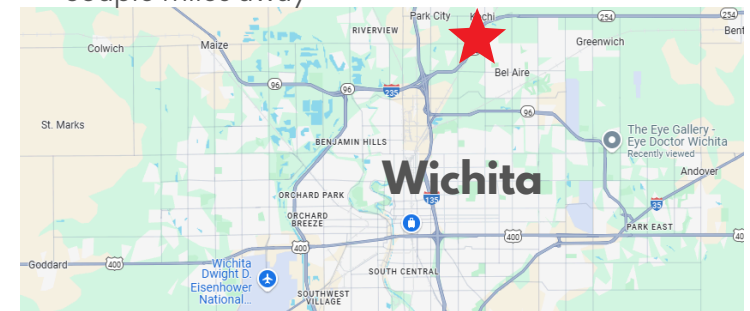

Bree Russell, CCIM 316-516-7417
Bree@RussellRealResources.com