

# FIRE DISTRICT AREA EXHIBITS

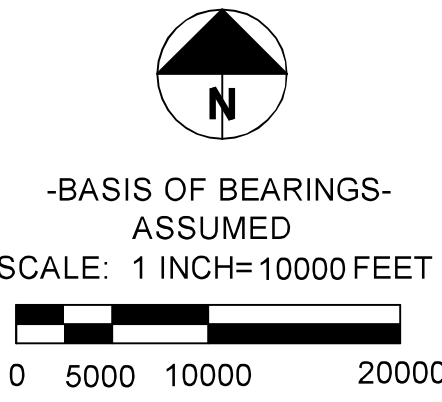
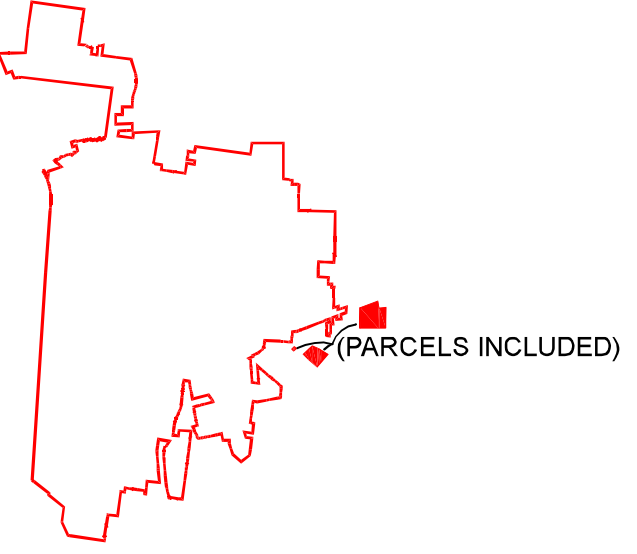
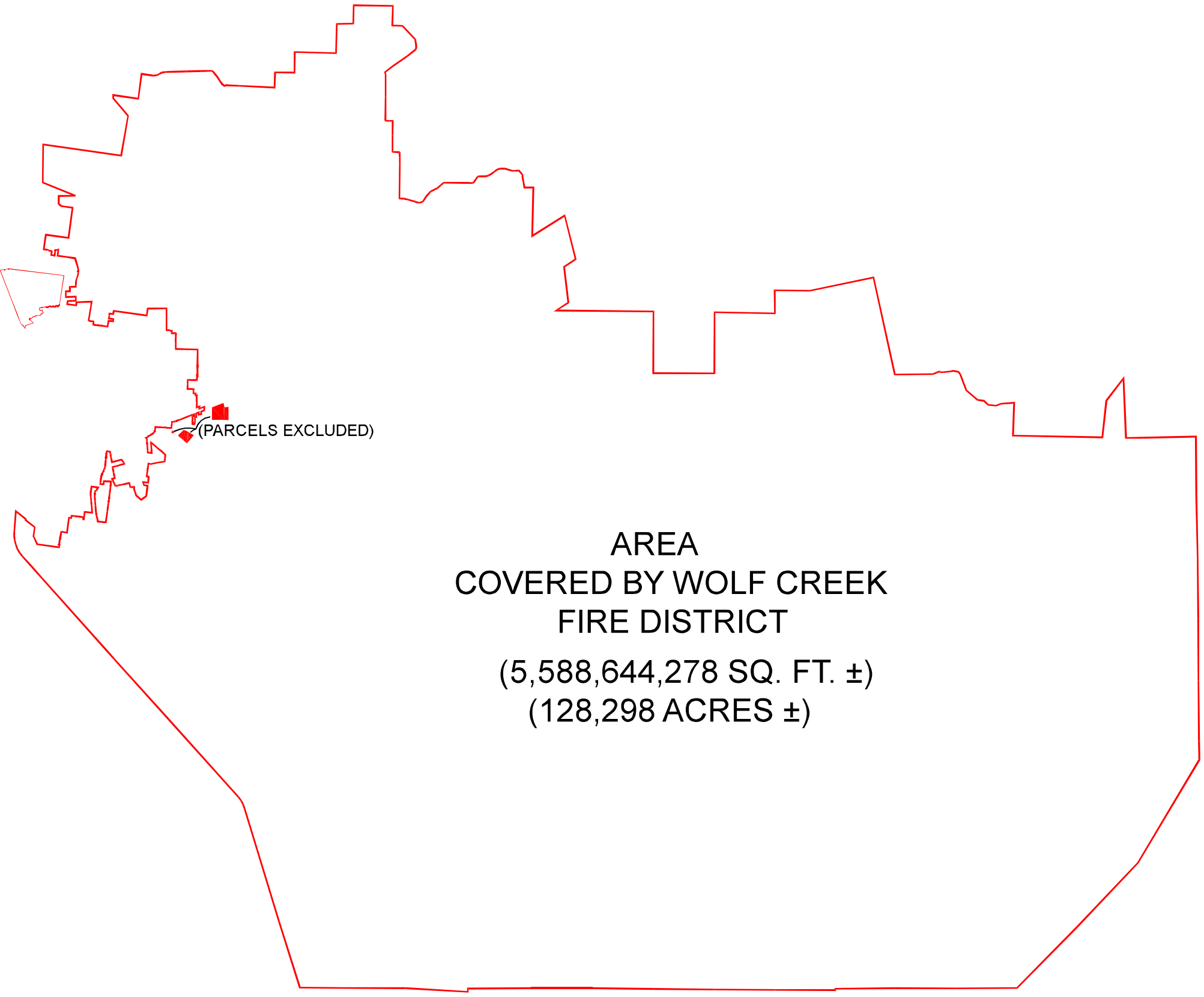
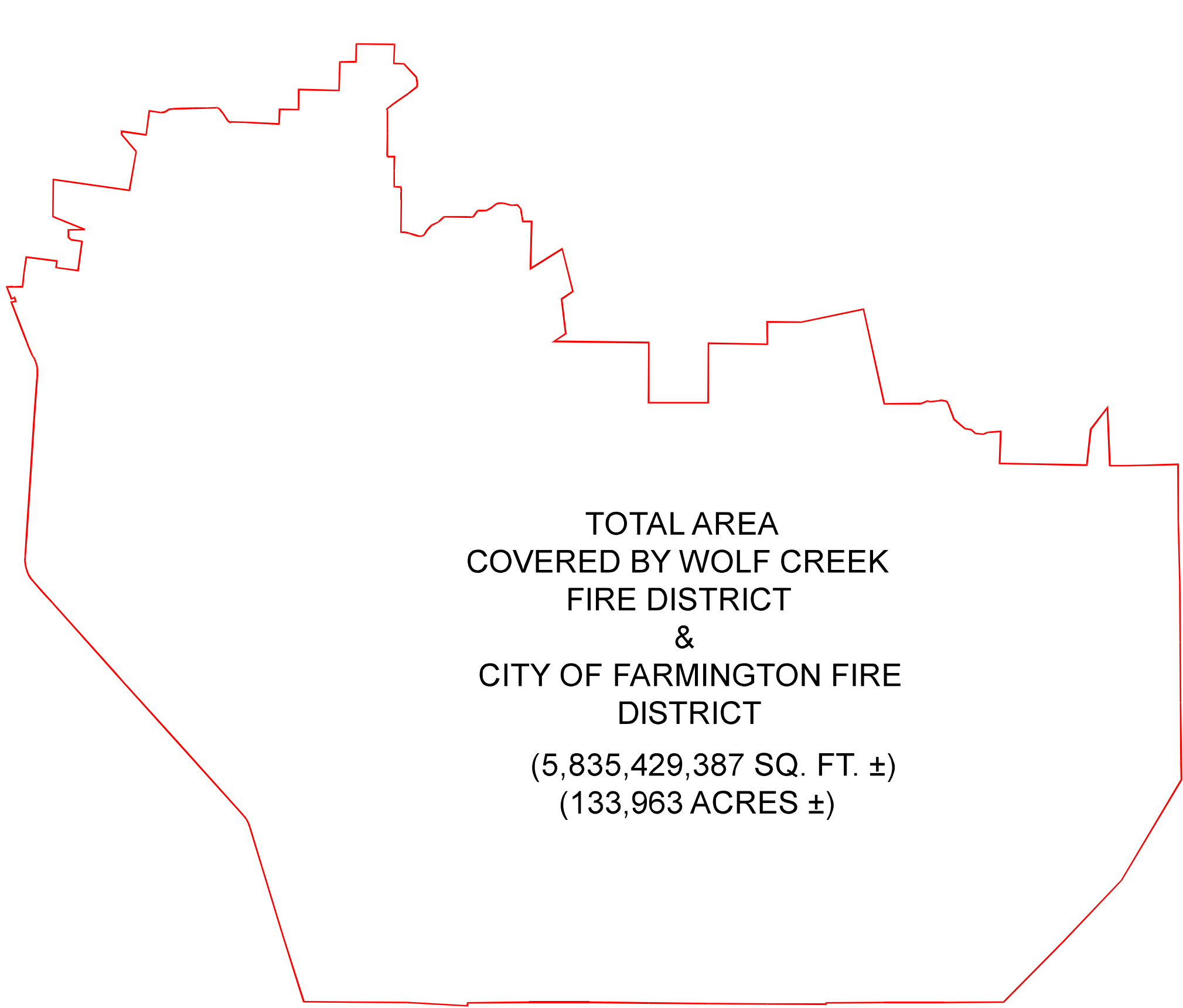

**SURVEYOR'S CERTIFICATE:**  
 THIS IS TO CERTIFY THAT TAYLOR ENGINEERING, L.L.C., AT THE REQUEST OF BART MABRY, FIRE CHIEF FOR THE WOLF CREEK FIRE DEPARTMENT, HAS DURING THE MONTHS OF MAY AND JUNE 2020, CREATED A BOUNDARY DESCRIPTION OF THE TRACT OF LAND SHOWN HEREUPON FOR THE PURPOSE OF ASCERTAINING THE CURRENT WOLF CREEK FIRE DEPARTMENT DISTRICT BOUNDARY.

\_\_\_\_\_  
 BRIAN HENRY WELLS, MO PLS 2005000072 \_\_\_\_\_  
 DATE

BART MABRY-FIRE CHIEF WOLF CREEK FIRE DEPARTMENT 1151 OLD JACKSON ROAD P.O. BOX 746 FARMINGTON, MO 63640	FIELD CREW: CC/JW CALCULATED BY: BHW DRAWN BY: BHW	PLOT SCALE: 1" = 10000' PROJ. NO.: 20040 ISSUE DATE: 09/29/2020	<b>WOLF CREEK FIRE DEPARTMENT                  DISTRICT BOUNDARY</b> PART OF ST. FRANCOIS COUNTY, MISSOURI AND PART OF STE. GENEVIEVE COUNTY, MISSOURI	<b>TAYLOR ENGINEERING L.L.C.</b>  <small>ENGINEERING · SURVEYING · CONSTRUCTION TESTING                  P.O. BOX 674 · 109 E. COLUMBIA FARMINGTON, MO 63640                  OFFICE 573.756.9226                  FAX 573.756.7310                  DISCIPLINE: PROFESSIONAL LAND SURVEYING                  WWW.TAYLORENGINEERINGLLC.COM                  CERTIFICATE OF AUTHORITY: 2000148114                  EXPIRATION DATE: DECEMBER 31, 2020</small>	DRAWING NO: <b>4 OF 4</b>
--	--	---	---	--	------------------------------