

# Parts Included

## Tools and Components included in your package:

- |  |   |
|--|---|
| A- 1 1/2" Threaded Pipe (Not Provided) | I- Cam Lock & Key   |
| B- Pipe Adhesive                       | J- Spacer Pack  |
| C- 1 1/2" Pipe Coupler                 | K- Flex Foot (Qty 4) NOTE: Is only included in the Universal Loc IV |
| D- Adjuster Dome                       | L- Media Shelf  |
| E- Receiver Tray                       | P- Projector (Not Included)   |
| F- Grid Plate                          | V- Velcro   |
| G- Pan Head Metric Screw Pack          |   |
| H- Flat Washer Pack                    |   |

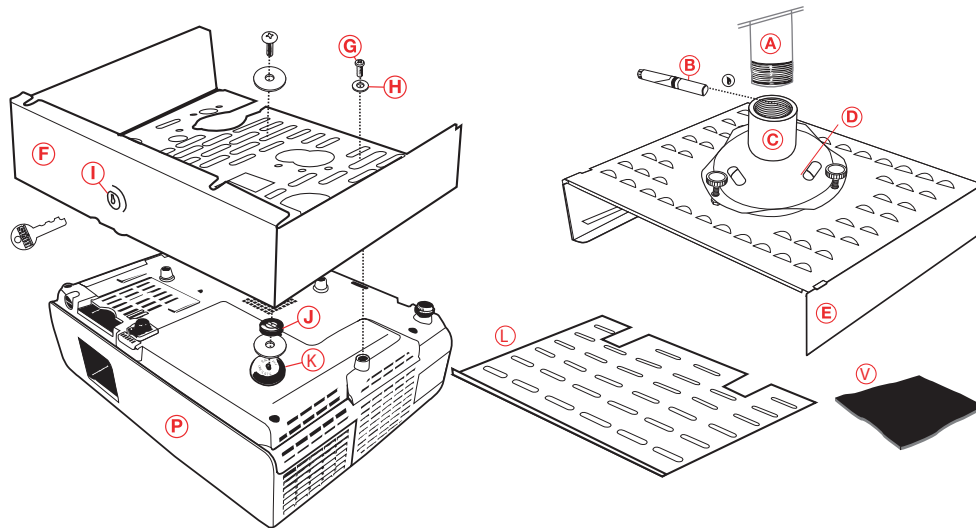

## Important Warnings and Cautions

- Warning** - Failure to read, understand and follow instructions can result in serious injury, damage to equipment or voiding equipment warranty.
- Warning** - Improper installation can result in serious personal injury or death. Ensure that the mounting surface can support a weight factor of four times the combined total weight of the equipment and the mount. If not, reinforcement of the mounting surface will be necessary before installing the mount.
- Warning** - It is the installer's responsibility to make sure that the mounting surface and the subsurface is free and clear of all electrical wires, plumbing and gas pipes. Failure to provide adequate clearance of all electrical wires and pipes can result in serious personal injury or death.
- Warning** - Mount and equipment exceeding a combined weight of 50 lbs can result in damage to the support structure, the mount, the equipment and may cause personal injury.
- Warning** - Business Machine Security, Inc. does not warrant its mounts against damage caused by the end use of its mounts for any purpose other than for the purpose for which it has been designed.
- Warning** - Business Machine Security, Inc. is not responsible for damage, or injury that may result in the use of any unauthorized modifications or attachment.
- Warning** - Proper safety gear (Goggles, Glasses & Gloves) and practices should be adhered to at all times throughout the installation process.
- Warning** - Do not install the mount near any heat source or air conditioning vent which may be prone to vibration.
- Warning** - Maximum load capacity 50 lbs.
- Warning** - Do not expose to extreme temperatures.



## Installation Guide

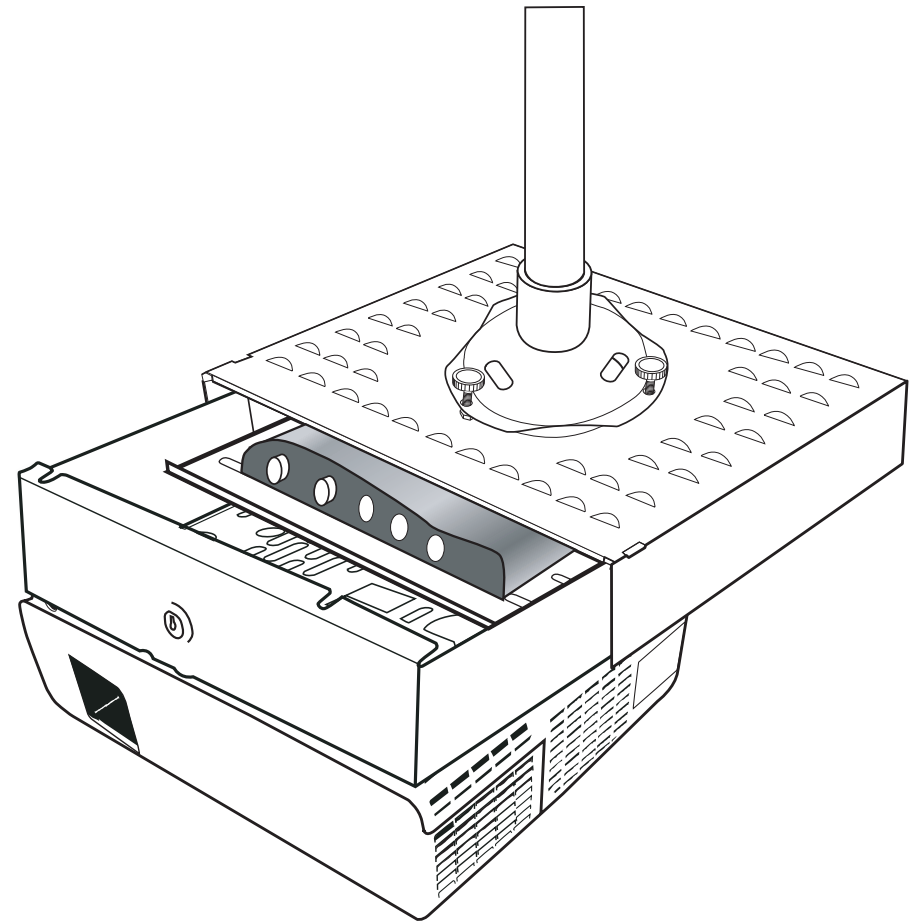

Made in USA

[www.LocDown.com](http://www.LocDown.com)  
[www.Anchorpad.com](http://www.Anchorpad.com)

800.872.9562

## 1 Securing Receiver Tray to Pipe

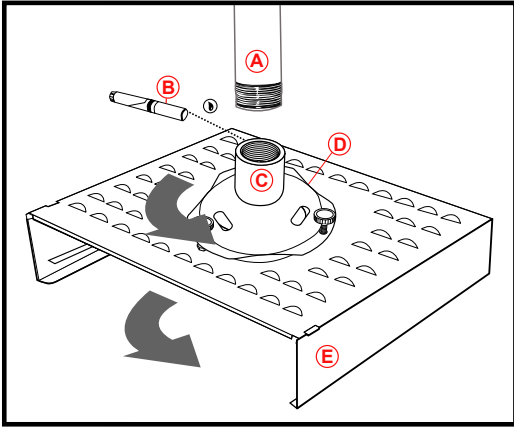

1. Apply the Pipe Adhesive (B) to the inside of the Coupler (C) at the top for approximately 3 threads down.
2. Screw the Coupler (C) clockwise with the Receiver Tray (E) onto the preinstalled 1 1/2" Standard Pipe threads (A).
3. We recommend running the cords through the pipe for a clean and safe installation.

## 2 Mounting Projector to Grid Plate

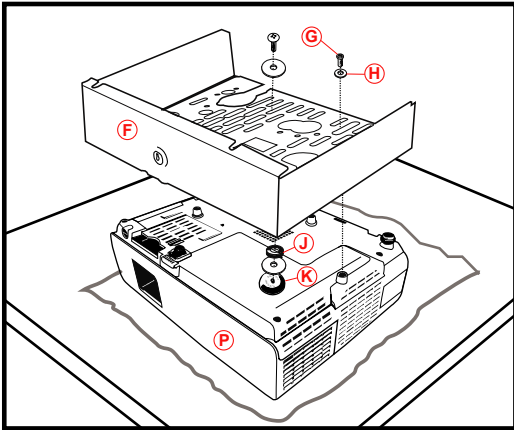

1. Place the Projector (P) upside down on a soft cloth and remove or lower the feet as much as possible.
2. Place the Grid Plate (F) on the Projector and line up the holes to match the projector mounting inserts. (Attach Flex Feet (K) if using a universal kit.)
3. Attach the Grid Plate (F) to the projector with the supplied Screws (G) and Washers (H), if necessary use the Spacers (J) for a level fit.

## 3 Attaching Equipment to Media Shelf

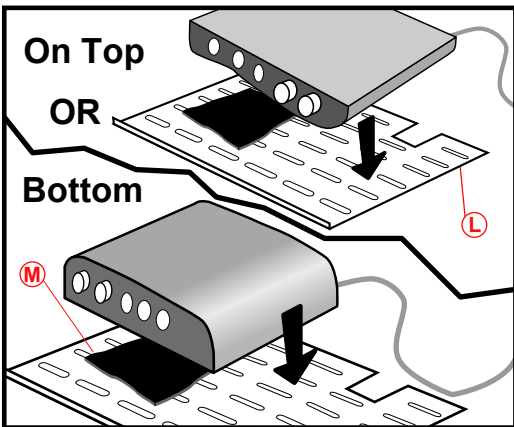

1. Place the Media Shelf (L) down and position your equipment on top of the shelf.
2. Measure, cut and attach the provided Velcro (M) onto the Media Shelf (L) and the top or bottom of the equipment.
3. Slide the shelf into the receiver tray with the cords towards the back and organize the cords (see Step 5).

## 4 Locking Grid Plate to Receiver Tray

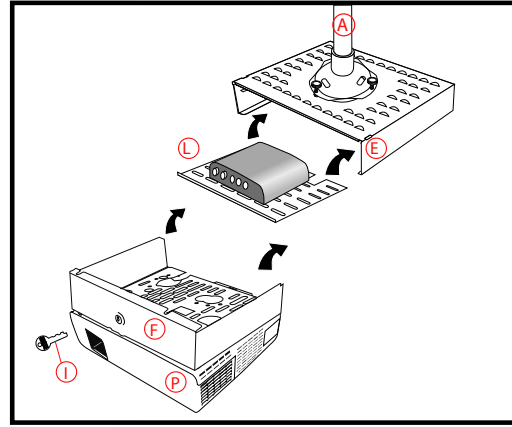

1. After the Receiver Tray (E) has been attached to the Pipe (A), the Media Tray (L) is in place and the Projector (P) has been attached to the Grid Plate (F), slide the Grid Plate 3 inches into the Receiver Tray.
2. Organize the cords (see Step 5) then slide the Grid Plate completely into the Tray.
3. Insert the key (I) into the Grid Plate (F) and lock into place.

## 5 Consolidating Cords When Closing

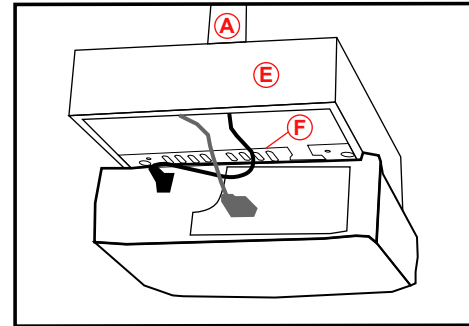

1. Before completely closing the mount, route the cables from the Pipe (A) out along the back of the Receiver Tray (E).

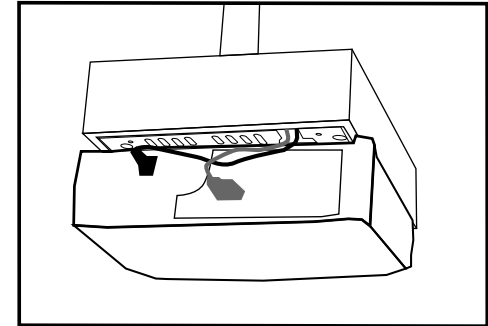

2. Slide the Grid Plate (F) (or Media Shelf) in while guiding the cables into a slot located in the back of the Grid Plate (F) (or Media Shelf).

## 6 Adjusting the Mount to Align Projector

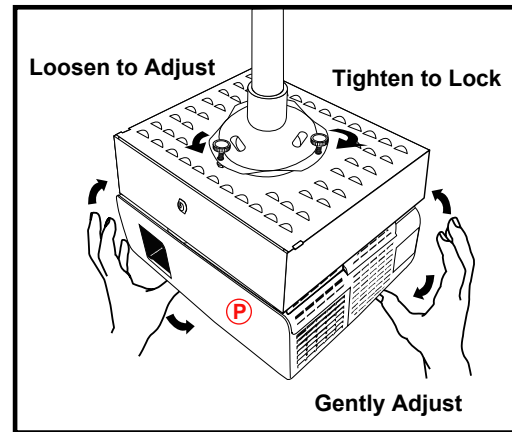

1. Turn knobs counter clockwise to loosen mount.
2. To align the Projector (P), simply grab a hold of either side of the mount and adjust it up or down until you have the proper registration.
3. Tighten the knobs by rotating clockwise until the mount is snug.

\* **Parts Description on Back Page**