

PAIN SHIELD® MD QUICK GUIDE

Please read the complete PainShield manual before using the device and pay attention to important warnings.

For maximal effectiveness ensure that the active element is in full contact with clean, hairless and oil-free skin



Connect the actuator cable to the device socket (1)

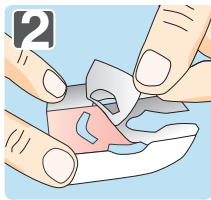

Note: Thoroughly clean the skin before patch application. Remove the protective liner from the center portion of the patch only (2).

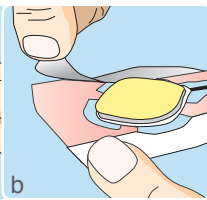
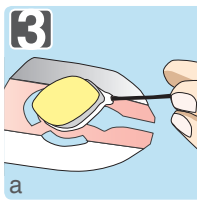

Attach the treatment actuator to the exposed adhesive at the center of the patch, with the wire aligned with the open notch in the patch (3a). Remove the rest of the protective liner from the patch (3b).

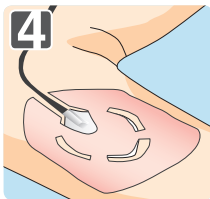

Attach the actuator patch to the skin, with the adhesive side down over the area where the pain is most intense (4).



Attention: when replacing the actuator, hold the connector plug to disconnect the actuator from the device (5).

6 Press the ON/OFF button on the device for about 2 seconds until beeping sound is heard. The device requires a few seconds to initialize and then displays the information screen.

- When the device is in working or charging modes, it enters the screen saving mode.
- To check the status, press shortly on the ON/OFF button.
- The device can be turned off at any time by pressing and holding the **ON/OFF** button for 2 seconds.



DELTA MEDICAL GROUP

PAIN SHIELD[®] MD QUICK GUIDE

Working mode
(Active period)

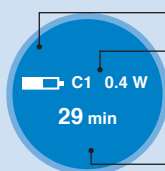

Battery level

Treatment cycle
number: C1- C6
0.4 W - Acoustic power

Time of treatment in the
cycle: 0-30 min status

Working mode
(Idle period)



Each cycle has an active period
of 30 minutes followed by an
inactive (idle) period of 30
minutes. The PainShield
battery allows for six
treatment cycles and then
shuts down automatically.

Treatment patch is
disconnected or damaged

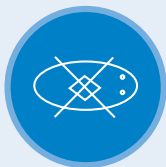

Screensaver screens:

1. In Charging mode

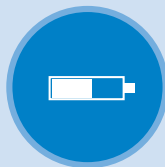

2. In Working mode



Battery is empty and
requires charging

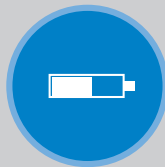
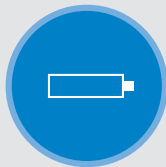

Charging in progress